

NORTH TEXAS MUNICIPAL WATER DISTRICT

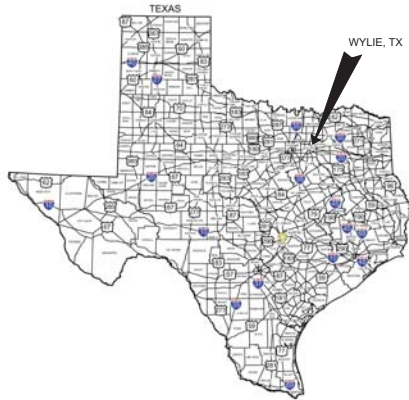

MUDDY CREEK WASTEWATER TREATMENT PLANT EXPANSION TO 12.5 MGD

100% DESIGN - NOT FOR CONSTRUCTION



AREA MAP
NO SCALE



EXHIBITS

NTMWD PROJECT NO. 310-0592A-21

GARVER PROJECT NO. 20W05231

DECEMBER 2023



3000 Internet Boulevard
Suite 400
Frisco, TX 75034
(972) 377-7480

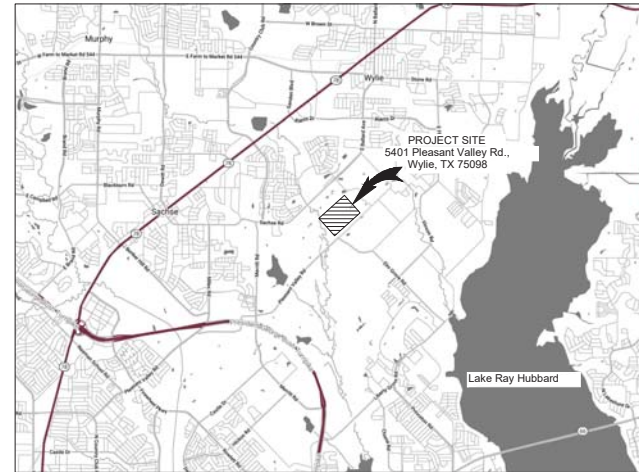

VICINITY MAP
NO SCALE



© 2023 GARVER, LLC
THIS DOCUMENT, ALONG WITH THE IDEAS AND DESIGNS CONVEYED HEREIN, SHALL BE CONSIDERED INSTRUMENTS OF PROFESSIONAL SERVICE AND ARE PROPERTY OF GARVER, LLC. ANY USE, REPRODUCTION, OR DISTRIBUTION OF THIS DOCUMENT, ALONG WITH THE IDEAS AND DESIGNS CONTAINED HEREIN, IS PROHIBITED UNLESS AUTHORIZED IN WRITING BY GARVER, LLC OR EXPLICITLY ALLOWED BY THE GOVERNING PROFESSIONAL SERVICES AGREEMENT FOR THIS WORK.

REGISTRATION NO. F-5713
100% DESIGN - NOT FOR CONSTRUCTION
THIS DOCUMENT IS RELEASED FOR THE PURPOSE OF INTERIM REVIEW UNDER THE AUTHORITY OF MICHAEL S. GARVER, P.E. IT IS NOT TO BE USED FOR CONSTRUCTION, BIDDING, OR PERMITTING PURPOSES.

REV.	DATE	DESCRIPTION	BY

NORTH TEXAS MUNICIPAL WATER DISTRICT
MUDDY CREEK WASTEWATER TREATMENT PLANT EXPANSION TO 12.5 MGD

COVER

JOB NO.: 20W05231
DATE: DEC. 2023
DESIGNED BY: CDG
DRAWN BY: BDP
CHECKED BY: CDG

BAR IS ONE INCH ON ORIGINAL DRAWING
IF NOT ONE INCH ON THIS SHEET, ADJUST SCALES ACCORDINGLY

DRAWING NUMBER

SHEET NUMBER

File: L:\2020\20W05230 - NTMWD Muddy Creek WWTP Plant Expansion\Drawings\EXHIBITS\Title\NTMWD\WTP - Cover Exhibit.dwg Last Save: 12/12/2023 10:43 AM Last saved by: AGD/pew
Last plotted by: Dpew, Alexander G. Plot Scale: 1" Plot Date: 12/12/2023 3:49 PM Printer used: ----

File: L:\2020\20W05230 - NTMWD Muddy Creek WWTP Plant Expansion\Drawings\BTS\Utilities\ACVWTP - Site Exhibit.dwg - Last Saved: 12/12/2023 3:47 PM - Last Saved by: AGDpew
 Last plotted by: dpew, Alexander G. Pico, Date: 12/12/2023 3:48 PM - Printer used: ...

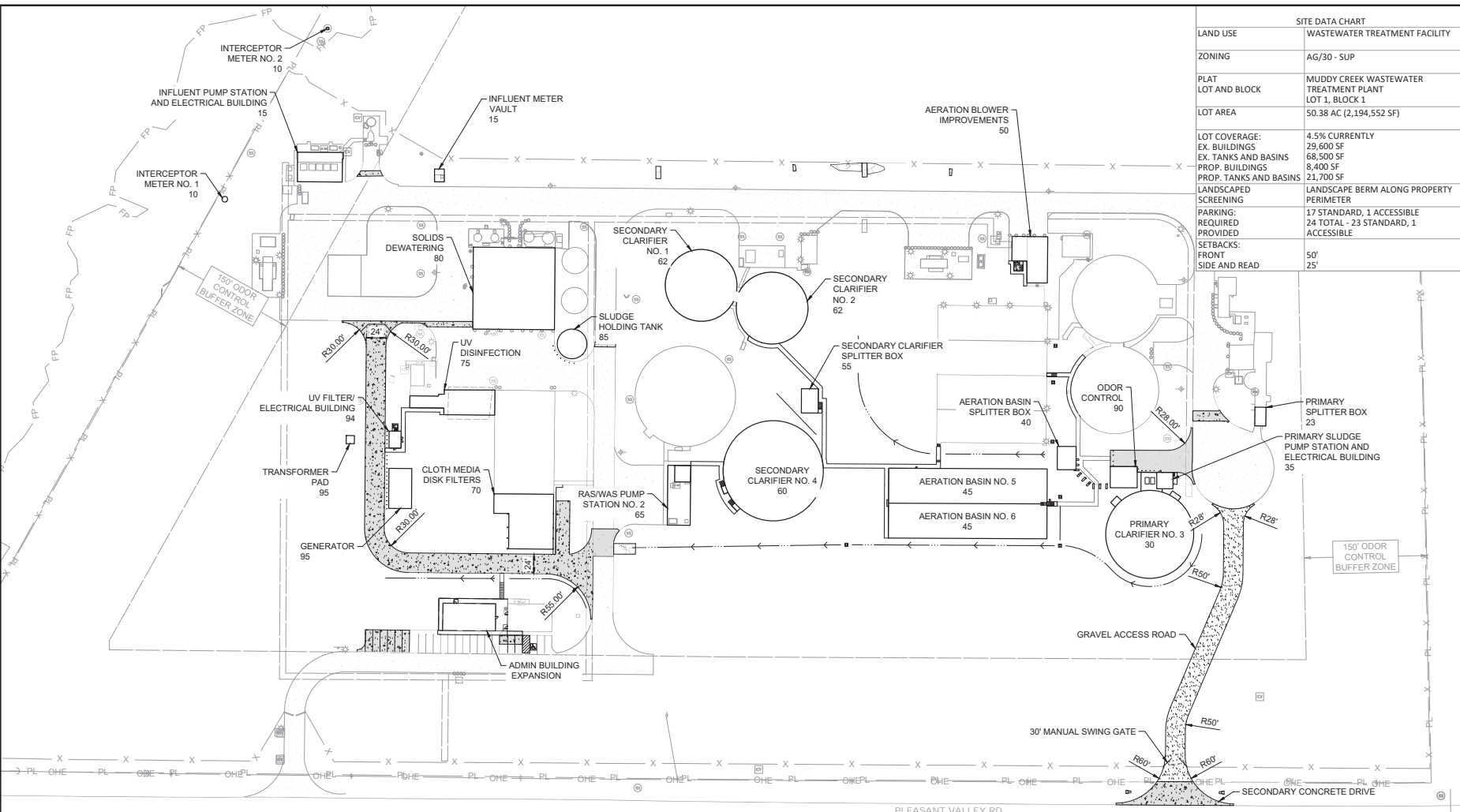

SITE DATA CHART	
LAND USE	WASTEWATER TREATMENT FACILITY
ZONING	AG/30 - SUP
PLAT LOT AND BLOCK	MUDDY CREEK WASTEWATER TREATMENT PLANT LOT 1, BLOCK 1
LOT AREA	50.38 AC (2,194,552 SF)
LOT COVERAGE:	4.5% CURRENTLY
EX. BUILDINGS	29,600 SF
EX. TANKS AND BASINS	68,500 SF
PROP. BUILDINGS	8,400 SF
PROP. TANKS AND BASINS	21,700 SF
LANDSCAPED SCREENING PERIMETER	LANDSCAPE BERM ALONG PROPERTY PERIMETER
PARKING: REQUIRED PROVIDED	17 STANDARD, 1 ACCESSIBLE
SETBACKS: FRONT SIDE AND REAR	24 TOTAL - 23 STANDARD, 1 ACCESSIBLE
	50' 25'



©2023 GARVER, LLC
 THIS DOCUMENT, ALONG WITH THE SEAL AND SIGNATURE CONVEYED HEREIN, SHALL BE CONSIDERED INSTRUMENTS OF PROFESSIONAL SERVICE AND ARE PROPERTY OF GARVER, LLC AND ANY USE, REPRODUCTION OR DISTRIBUTION OF THIS DOCUMENT, ALONG WITH THE SEAL AND SIGNATURE CONVEYED HEREIN, IS PROHIBITED UNLESS AUTHORIZED IN WRITING BY GARVER, LLC OR EXPLICITLY ALLOWED IN THE CORRESPONDING PROFESSIONAL SERVICES AGREEMENT FOR THIS WORK.

100% DESIGN - NOT FOR CONSTRUCTION
 THIS DOCUMENT IS RELEASED FOR THE PURPOSE OF INTERIM REVIEW UNDER THE AUTHORITY OF MICHAEL S. MEYER AND IS NOT TO BE USED FOR CONSTRUCTION, BIDDING, OR PERMITTING PURPOSES.

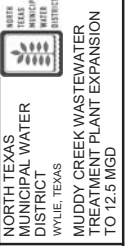

NORTH TEXAS MUNICIPAL WATER DISTRICT
 WYILE, TEXAS
 MUDDY CREEK WASTEWATER TREATMENT PLANT EXPANSION TO 12.5 MGD

PROPOSED SITE EXHIBIT

JOB NO.: 20W05231
 DATE: DEC. 2023
 DESIGNED BY: CDG
 DRAWN BY: BDP
 CHECKED BY: CDG

BAR IS ONE INCH ON ORIGINAL DRAWING 1" IF NOT ONE INCH ON THIS SHEET, ADJUST SCALES ACCORDINGLY.
 DRAWING NUMBER
 SHEET NUMBER

EXISTING FACILITY IDENTIFIER
 4:1 TO DAYLIGHT UNLESS OTHERWISE NOTED IN PLANS

NOTES:
 1. SEE DRAWING 05-C101 FOR LIST OF EXISTING FACILITY NAMES.

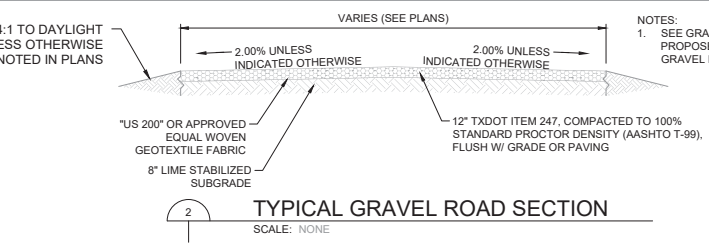
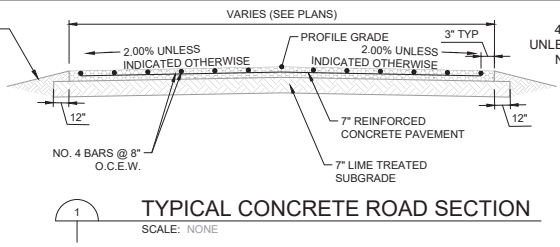

NOTES:
 1. SEE GRADING PLANS FOR FINAL PROPOSED GRADE SLOPES AND GRAVEL DRIVE ROAD WIDTHS.

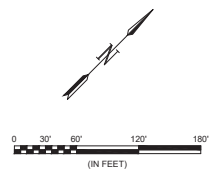

File: L:\2020\20W05230 - NT MWD Muddy Creek WWTP Plant Expansion\Drawings\EXHIBITS\Utilities\MCWWT - Landscaping\Exhibit.dwg Last Saved: 12/7/2023 5:17 PM Last saved by: AG/Deppw
 Last plotted by: Deppw, Alexander G. Plot Date: 12/29/2023 11:35 AM Plotter used:

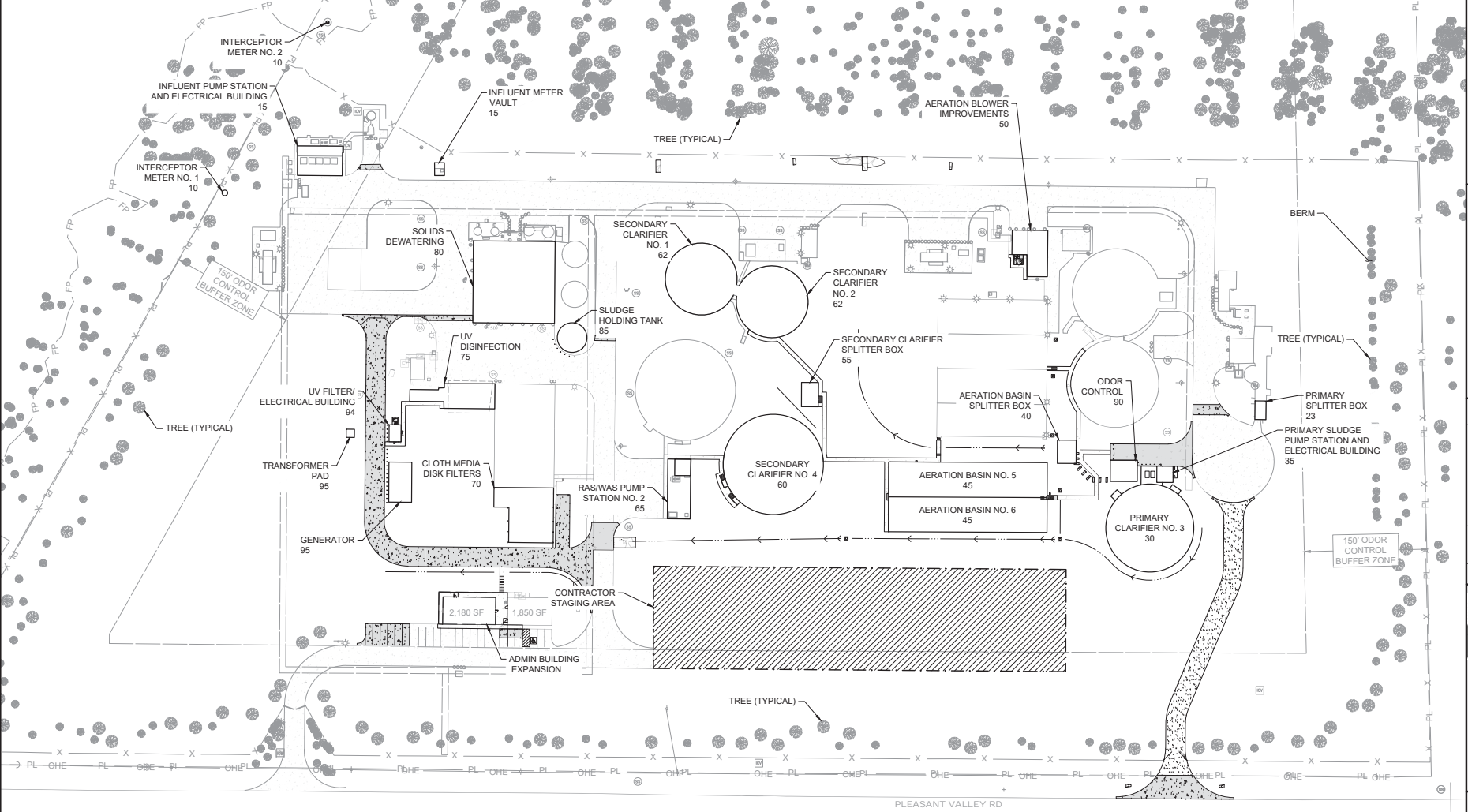

EXISTING FACILITY IDENTIFIER

- NOTES:**
- SEE DRAWING 05-C101 FOR LIST OF EXISTING FACILITY NAMES.

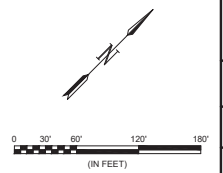



THIS DOCUMENT, ALONG WITH THE SEAL AND DESIGN CONTAINED HEREIN, SHALL BE CONSIDERED INSTRUMENTS OF PROFESSIONAL SERVICE AND ARE PROPERTY OF GARVER, LLC AND ANY USE, REPRODUCTION, OR DISTRIBUTION OF THIS DOCUMENT, ALONG WITH THE SEAL AND DESIGN CONTAINED HEREIN, IS PROHIBITED UNLESS AUTHORIZED IN WRITING BY GARVER, LLC OR EXPLICITLY ALLOWED IN THE GOVERNING PROFESSIONAL SERVICES AGREEMENT FOR THIS WORK.

REGISTRATION NO. F-5713

100% DESIGN - NOT FOR CONSTRUCTION
 THIS DOCUMENT IS RELEASED FOR THE PURPOSE OF INTERIM REVIEW UNDER THE AUTHORITY OF MICHAEL S. WYLLIE, P.E. IT IS NOT TO BE USED FOR CONSTRUCTION, BIDDING, OR PERMITTING PURPOSES.

REV.	DATE	DESCRIPTION	BY



NORTH TEXAS MUNICIPAL DISTRICT
 MUDDY CREEK WASTEWATER TREATMENT PLANT EXPANSION TO 12.5 MGD

PROPOSED LANDSCAPING EXHIBIT

JOB NO.: 20W05231
 DATE: DEC. 2023
 DESIGNED BY: MSM
 DRAWN BY: BDP
 CHECKED BY: CDG

BAR IS ONE INCH ON ORIGINAL DRAWING
 IF NOT ONE INCH ON THIS SHEET, ADJUST SCALES ACCORDINGLY

DRAWING NUMBER
 SHEET NUMBER

File: L:\2020\20W05230 - NT MWD Muddy Creek WWTP Plant Expansion\Drawings\EXHIBITS\Utilities\MCWVTP - Utility Exhibits.dwg | Last Save: 12/12/2023 10:34 AM | Last saved by: AGDppw
 Last plotted by: Deepav, Alexander G. | Plot Scale: 1" = 100'-0" | Plot Date: 12/12/2023 11:35 AM | Plotter used: ...

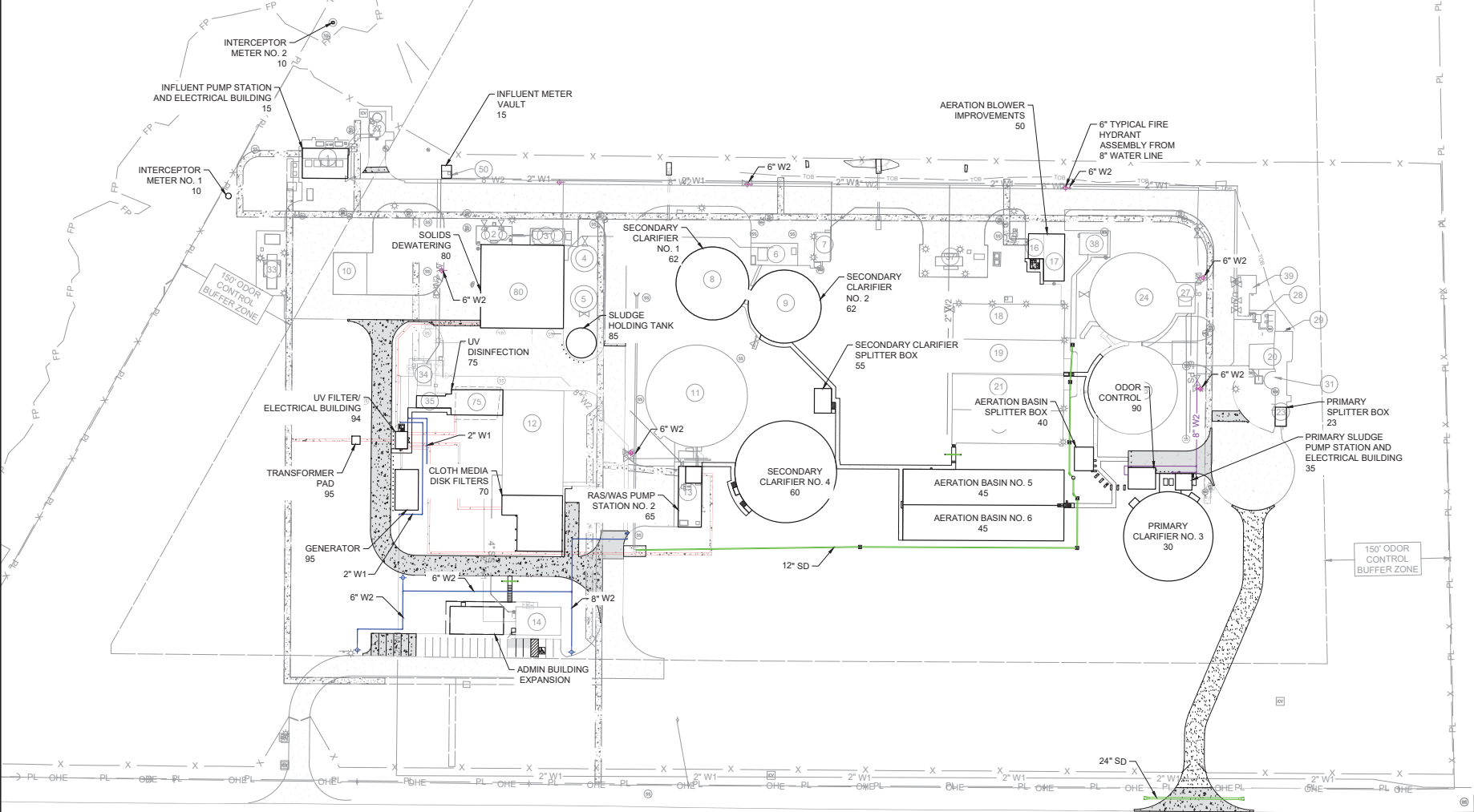

- PROPOSED UTILITY LEGEND:**
- STORM DRAIN - —
 - POTABLE WATER - —
 - NON-POTABLE WATER - —
 - ELECTRIC - —
 - EXISTING FIRE HYDRANT - ⊕
 - PROPOSED FIRE HYDRANT - ⊕

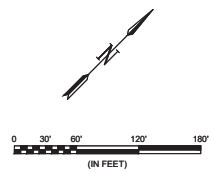

THIS DOCUMENT, ALONG WITH THE
 IDEAS AND DESIGN CONCEPTS
 HEREIN, SHALL BE CONSIDERED
 INSTRUMENTS OF PROFESSIONAL
 SERVICE AND ARE PROPERTY OF
 GARVER, LLC AND ANY USE,
 REPRODUCTION, OR DISTRIBUTION
 OF THIS DOCUMENT, ALONG WITH
 THE IDEAS AND DESIGN CONCEPTS
 HEREIN, IS PROHIBITED UNLESS
 AUTHORIZED IN WRITING BY
 GARVER, LLC OR EXPLICITLY
 ALLOWED IN THE CORRESPONDING
 PROFESSIONAL SERVICES
 AGREEMENT FOR THIS WORK.

REGISTRATION NO.
 F-5713

**100% DESIGN - NOT FOR
 CONSTRUCTION**
 THIS DOCUMENT IS RELEASED FOR THE
 PURPOSE OF INTERIM REVIEW UNDER
 THE AUTHORITY OF MICHAEL S.
 GARVER, P.E. THIS DOCUMENT IS
 NOT TO BE USED FOR CONSTRUCTION,
 BIDDING, OR PERMITTING PURPOSES.

REV.	DATE	DESCRIPTION	BY



**NORTH TEXAS
 MUNICIPAL WATER
 DISTRICT**
 WYILE, TEXAS
**MUDDY CREEK WASTEWATER
 TREATMENT PLANT EXPANSION
 TO 12.5 MGD**

**PROPOSED UTILITY
 EXHIBIT**

JOB NO.: 20W05231
DATE: DEC. 2023
DESIGNED BY: MSM
DRAWN BY: BDP
CHECKED BY: CDG

BAR IS ONE INCH ON
 ORIGINAL DRAWING
 0" = 1" OR 1" = 100'-0"
 IF NOT ONE INCH ON THIS SHEET,
 ADJUST SCALES ACCORDINGLY.
DRAWING NUMBER

**SHEET
 NUMBER**



**NTMWD
MUDDY
CREEK ADMIN
BUILDING
IMPROVEMENT
& EXPANSION**
5401 Pleasant Valley Rd.
Wylie, Texas 75098

PROJECT NO.: R311609.01

DRAWN BY: JAF, MMS

REVIEWED BY: SS

APPROVED BY:

ISSUE DRAWING LOG:

MARK	DATE	DESCRIPTION
1	10/29/23	ISSUE FOR PERMIT

EXTERIOR
ELEVATIONS

A-201

COPYRIGHT 2020 HUITT-ZOLLARS INC.

D
C
B
A
 C:\Users\jzollars\Documents\Projects\A-201\Muddy Creek Improvement_Civil\A-201\A-201.dwg
 10/27/2023 3:03:59 PM

