

**INDIVIDUAL PROJECT ORDER (IPO) #8**  
**EUBANKS EASEMENT AND ROW COORDINATION**  
**DATE PREPARED: JUNE 16, 2023**

Describing a specific agreement between Kimley-Horn and Associates, Inc. (Consultant), and the Wylie Economic Development Corporation (Client) in accordance with the terms of the Master Agreement for Continuing Professional Services dated October 4, 2022, which is incorporated herein by reference.

**Identification of Project:**

Kimley-Horn and Associates, Inc. (“Kimley-Horn”, “KH” or “the Consultant”) is pleased to submit this professional services agreement to the Wylie Economic Development Corporation (“WEDC” or “the Client”) for providing professional civil engineering services for Eubanks gas easement coordination.

The ultimate right of way (ROW) for Eubanks Lane has not been determined. If the City of Wylie confirms the ultimate ROW width prior to KH receiving survey data, the gas easement will be prepared on the east side of the ultimate ROW. If the ultimate ROW width cannot be confirmed by the time KH receives survey, we will use the west line of the properties on the east side of Eubanks Lane as the east line of the gas easement.

The City of Wylie has water infrastructure in the area. We do not know whether or not the water line is in an easement or inside the Eubanks ROW. Adjustments to the easement location may be necessary depending on where the water line is actually located based on survey.

**Scope of Services:**

The tasks outlined below are the professional services to be provided by KH requested by the Client. The Scope of Services described for Lump Sum (LS) tasks will be completed for the lump sum fee indicated and those for Projected Hourly (HR) will be billed per the effort expended on an hourly basis per our current Rate Schedule. The total Projected Hourly number shown is a budget number only.

LS = Lump Sum Fee Type  
HR = Projected Hourly Fee Type

**Task 1 – ROW Determination / Boundary Survey** **\$ 7,000 LS**

KH (through a sub-consultant) will prepare a boundary survey of the study area. The boundary survey is to be used for easement preparation and design only and will not be issued as a stand-alone survey document. The survey will identify existing ROW, edge of pavement (Eubanks) and observed (only if clearly visible from the surface) locations of existing water, sewer, storm drain, and franchised utility facility appurtenances on the east side of Eubanks. We will coordinate with Texas 811 to locate existing utilities prior to mobilizing the survey crew. The City of Wylie datum will be used.

**Task 2 – Easement Documents** **\$ 6,125 LS**

KH (through a sub-consultant) will prepare up to seven easement exhibits. The easement exhibits will include legal descriptions. Additional easement exhibits can be prepared for an additional \$875 each.

Below is an exhibit showing the survey extents.

The remainder of this page intentionally left blank.

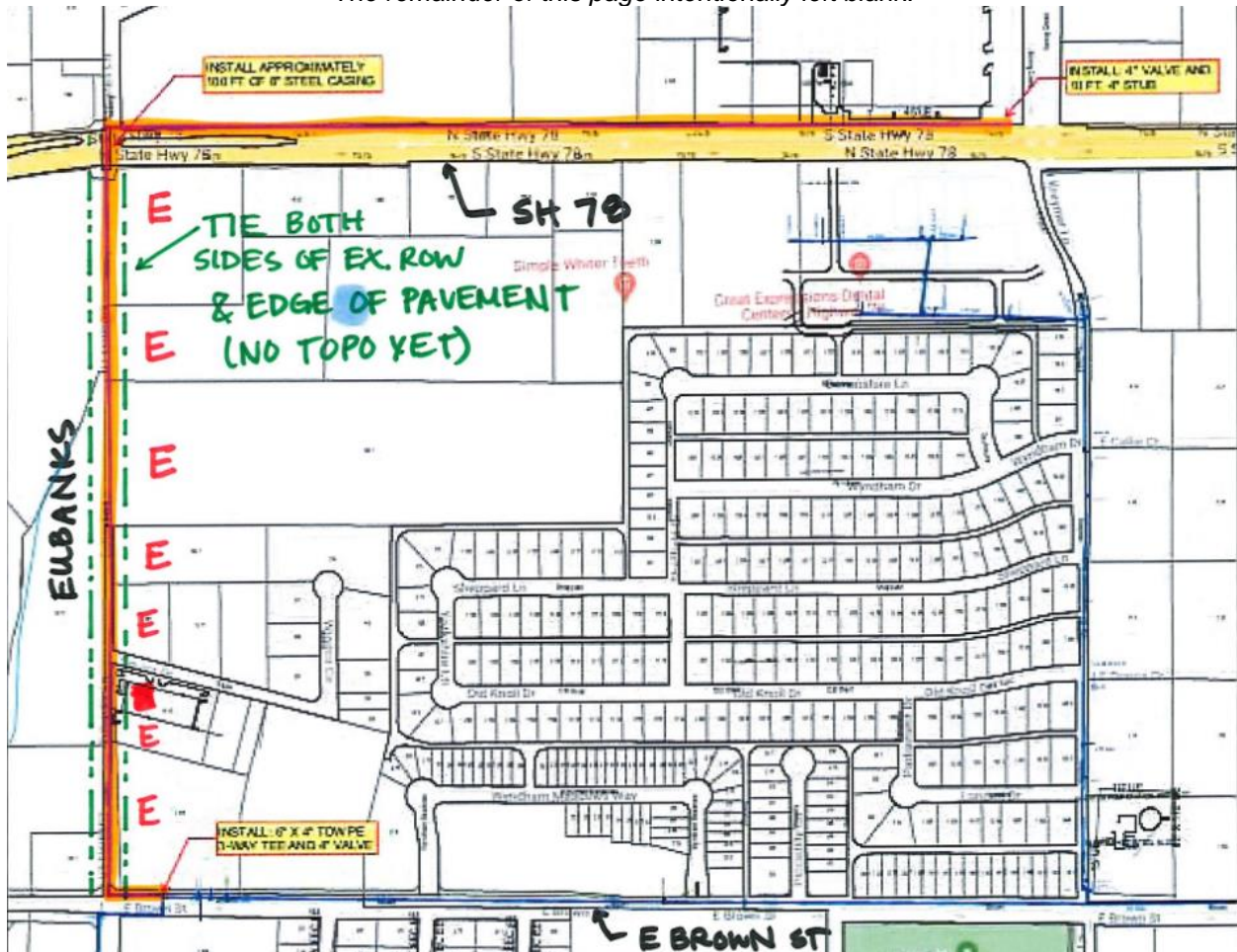

**Task 3 - Meetings/Project Coordination**

**\$10,000 HR**

We will prepare for and attend meetings with the WEDC staff and City of Wylie staff and provide general project coordination. We have budgeted up to 50 hours of effort for this task.

**Additional Services if required:** Services not specifically identified in the Scope of Services above shall be considered additional and shall be performed on an individual basis upon authorization by the WEDC.

**Schedule:** Project to begin upon receipt of signed IPO #8. We will provide our services as expeditiously as practicable.

**Terms of compensation:** Kimley-Horn will perform the tasks identified in the Scope of Services for the fee type shown as follows:

LS = Lump Sum Fee Type  
HR = Projected Hourly Fee Type

<b>Task 1 – ROW Determination / Boundary Survey</b>	<b>\$7,000 LS</b>
<b>Task 2 – Easement Documents</b>	<b>\$6,125 LS</b>
<b>Task 3 – Meetings/Project Coordination</b>	<b>\$10,000 HR</b>
<b>Projected Total</b>	<b>\$23,125</b>

Compensation for Services and Method of Payment shall be as referenced in the Master Agreement.

Invoices will be submitted with Lump Sum Tasks shown as a percentage of work completed and projected Hourly Tasks shown as effort expended.

**Other special terms of Individual Project Order:** None

**ACCEPTED:**

WYLIE ECONOMIC DEVELOPMENT  
CORPORATION

KIMLEY-HORN AND ASSOCIATES, INC.



BY: \_\_\_\_\_

BY: \_\_\_\_\_

TITLE: \_\_\_\_\_

TITLE: Senior Vice President

DATE: \_\_\_\_\_

DATE: June 16, 2023