

Dog Park & Splashpads

Schematic Design

August 9, 2022





Project Schedule

Site Evaluation & Programming *complete*

Topographic Survey *complete*

Schematic Design..... **August**

- ☐ *Layout Plans for All 3 Site w/ Cost Opinions*
- ☐ *Review w/ City Staff*

Design Development..... **Sept. – Oct.**

- ☐ *50% CDs & Cost Opinion*

Final Construction Documents..... **Nov. – Dec.**

Bidding & Construction Phase **TBD**

Potential Openings*

Splashpads: *Summer 2023*

Dog Park: *Fall 2023*





Dog Park



Initial Program List*

- 3 Dog Park Paddocks
 - 1 Small Dog
 - 2 Large Dog
- Fencing with Bull Pen Entries
- Dog Wash Stations
- Agility Equipment
- Small Group Pavilion(s)
- Site Furnishings
- Concrete Parking
- Parking Lot Lighting
- Trail Connections
- Landscape Plantings
- Irrigation System per City Ordinance Requirements

**Current Construction
Budget \$700,000**

*as budget allows



Prairie Tails Dog Park



- 3 Dog Park Paddocks
 - 1 Small Dog
 - 2 Large Dog
- Fencing with Bull Pen Entries
- Dog Wash Stations
- Agility Equipment
- Pavilions (3)

Prairie Tails Dog Park

• Blackland Prairie

- Tall Grasses & Wildflowers
- Home for Small Game/Songbirds
- Tree Groves provide respite from the Sun
- Exposed rocks and trees line creek corridors



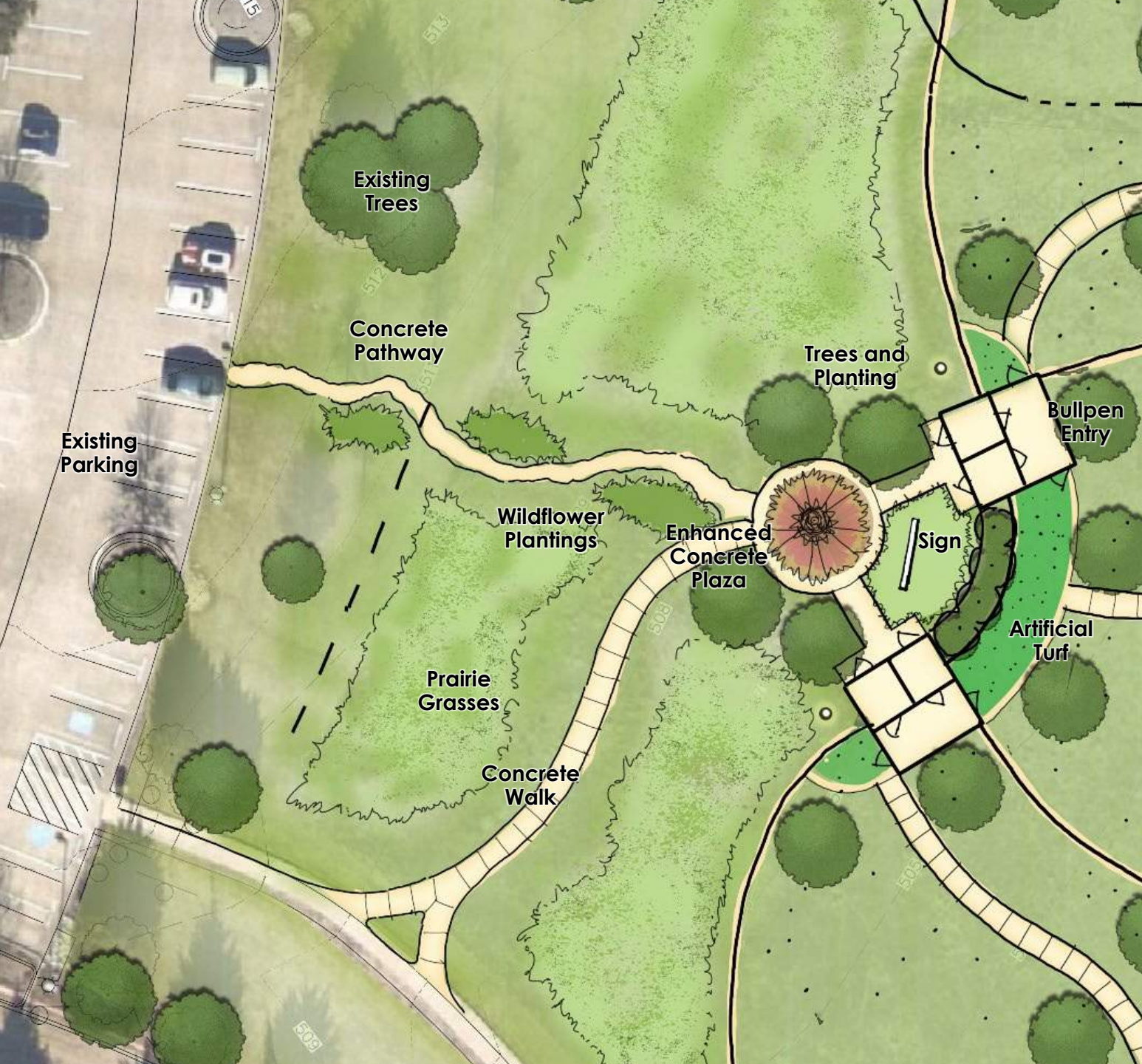

Wildflower Plantings



Concrete Plaza



Site Furnishings

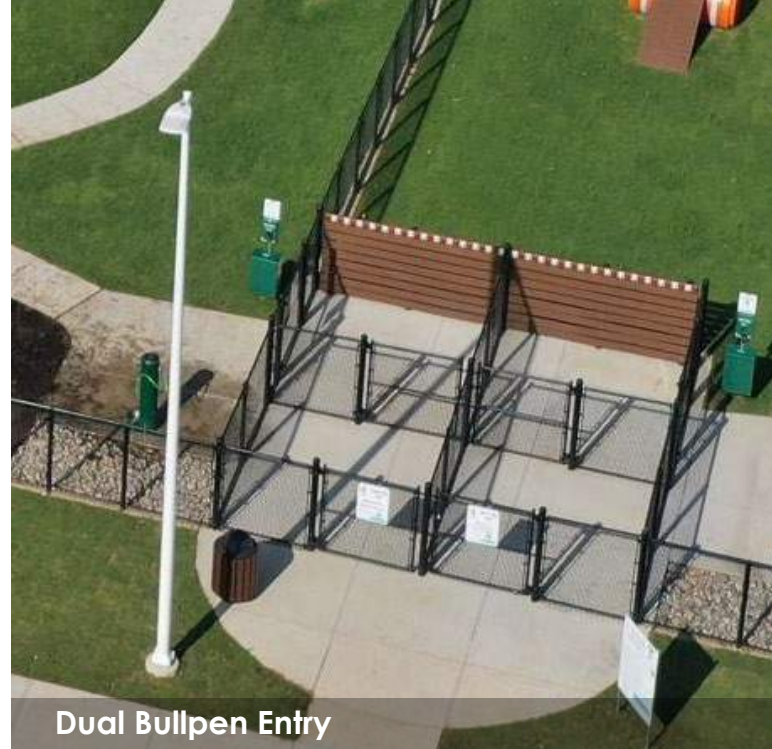

Dual Bullpen Entry



Ledgestone Block



Limestone Boulders



Dog Wash Stations



Pavilion w/ Wildflower Theming



Agility Equipment



Doggie Crossing / Pedestrian Bridge

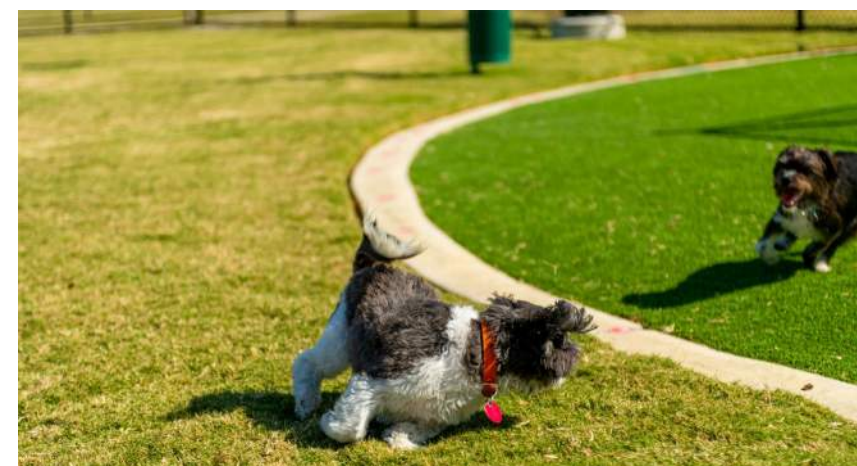

Artificial Turf





Cost Estimate

GENERAL SITE ITEMS	\$165,000
SITE IMPROVEMENTS	\$456,000
FENCING	\$160,000
PAVILIONS	\$120,000
CONCRETE PAVING	\$56,000
BRIDGE CROSSINGS	\$20,000
ENHANCED ENTRY	\$50,000
ARTIFICIAL TURF	\$15,000
MONUMENT SIGN	\$35,000
LAWN & TREES	\$100,000
IRRIGATION	\$115,000
SECURITY LIGHTING ALLOWANCE	\$50,000
<hr/>	
BASE SUBTOTAL	\$886,000
+/- 15% CONTINGENCY	\$134,000
<hr/>	
CONSTRUCTION TOTAL:	\$1,020,000

Prairie Tails Dog Park



- 2 Dog Park Paddocks
 - 1 Small Dog
 - 1 Large Dog
- Fencing with Bull Pen Entries
- Dog Wash Stations
- Agility Equipment



Base Project

GENERAL SITE ITEMS	\$150,000
SITE IMPROVEMENTS	\$285,000
FENCING	\$160,000
CONCRETE PAVING	\$30,000
ENHANCED ENTRY	\$50,000
ARTIFICIAL TURF	\$10,000
MONUMENT SIGN	\$35,000
LAWN	\$100,000
IRRIGATION	\$115,000
SECURITY LIGHTING ALLOWANCE	\$15,000
<hr/>	
BASE SUBTOTAL	\$665,000
+/- 15% CONTINGENCY	\$100,000
<hr/>	
CONSTRUCTION TOTAL:	\$765,000

A photograph of a person splashing in water, with a dark blue overlay. The person's head and shoulders are visible, and they are surrounded by white water spray. The background is a deep blue, and the overall image has a textured, painterly quality.

Splashpads

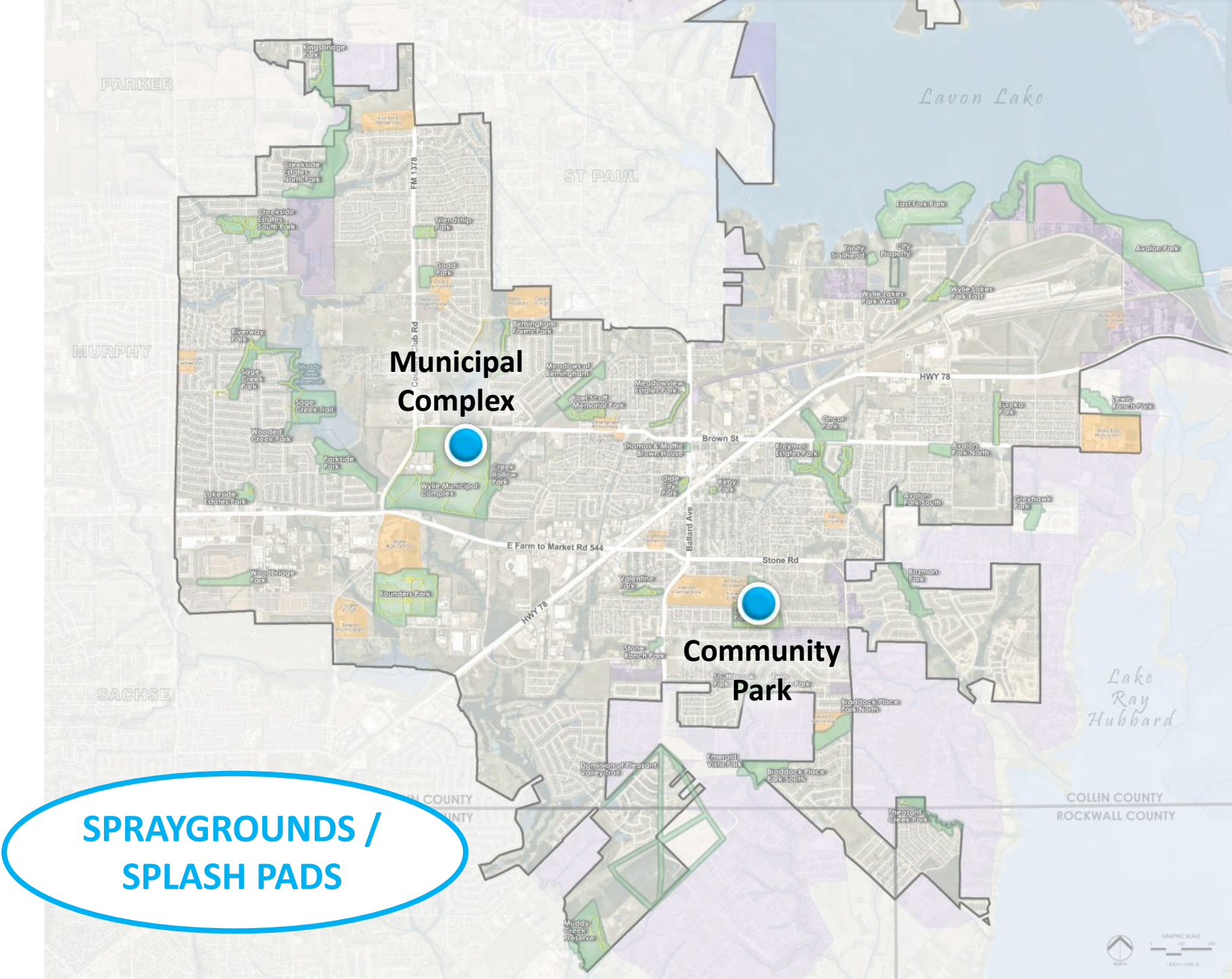



Initial Program List*



- Splashpad (1,500 sf) & Play Equipment
- Prefabricated Restroom Building with Pump & Filtration Room
- Shade Structure
- Concrete Parking
- Parking Lot Lighting
- Trail Connections
- Landscape Plantings
- Irrigation System per City Ordinance Requirements

**Current Construction
Budget \$1.2 Million**
(includes both sites)

*as budget allows



East Meadow Sprayground

Key Features:

- Sprayground
 - *Signature Feature*
 - *Bubbler Sprays*
- Stamped Concrete
- Seat Walls / Stone Block Seating
- Group Shelter
- Arrival Plaza
- Gateway
- Restroom & Filtration Building
- Drop Off
- Connection to Existing Trails

East Meadow Sprayground

Key Features:

- Sprayground
 - *Signature Feature*
 - *Bubbler Sprays*
- Stamped Concrete
- Seat Walls / Stone Block Seating
- Group Shelter
- Arrival Plaza
- Gateway
- Restroom & Filtration Building
- Drop Off
- Connection to Existing Trails

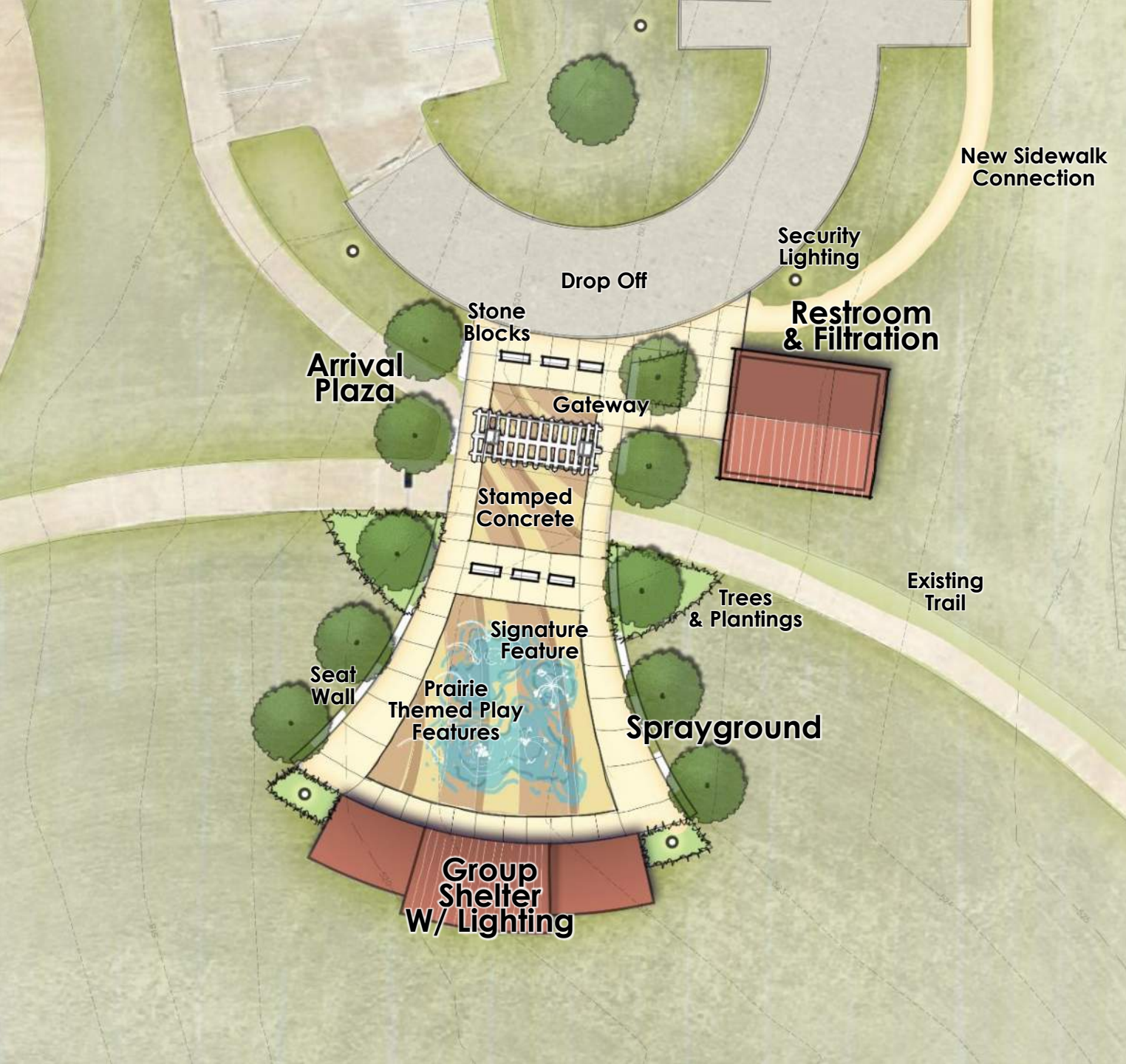







Prairie

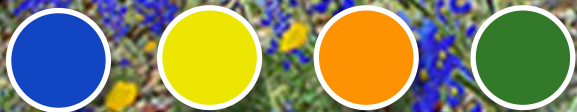

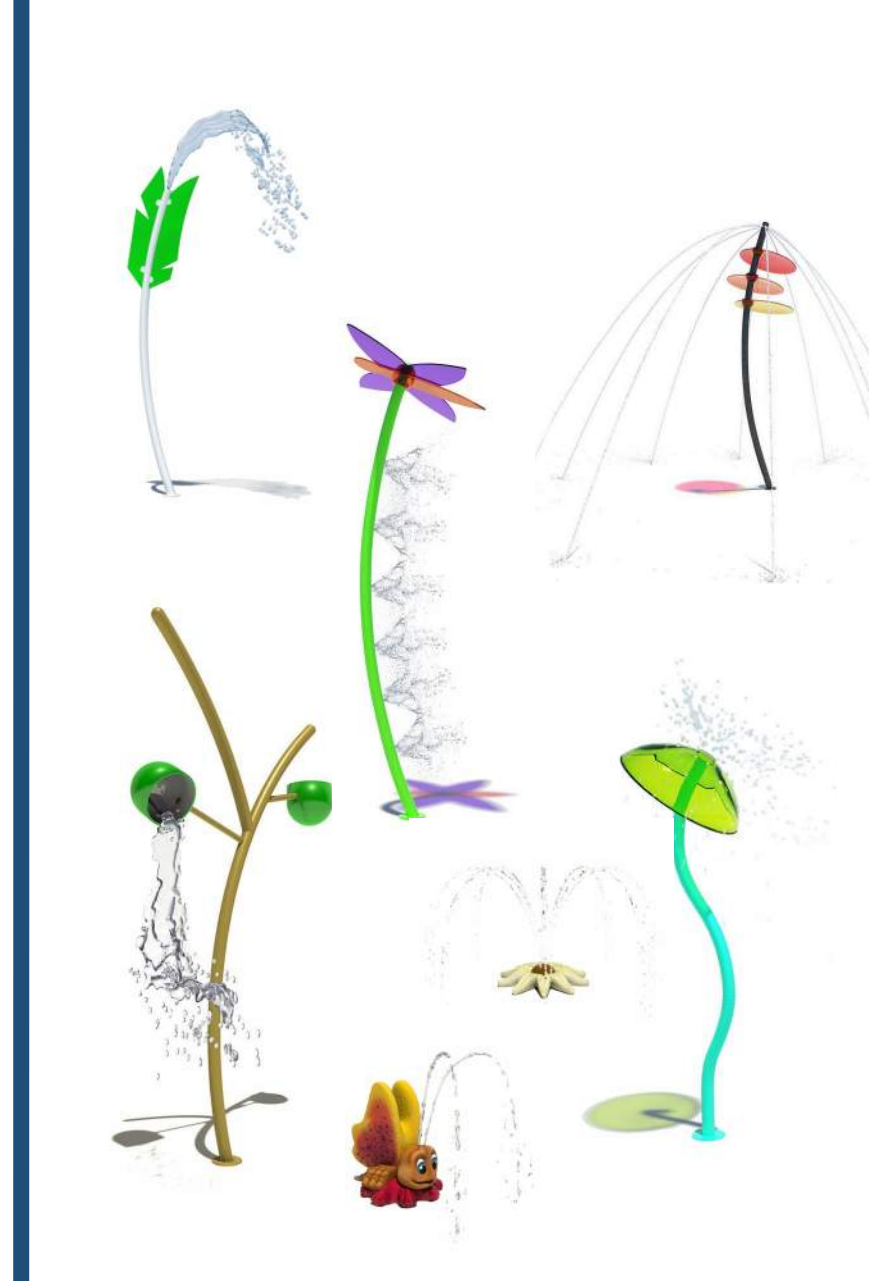

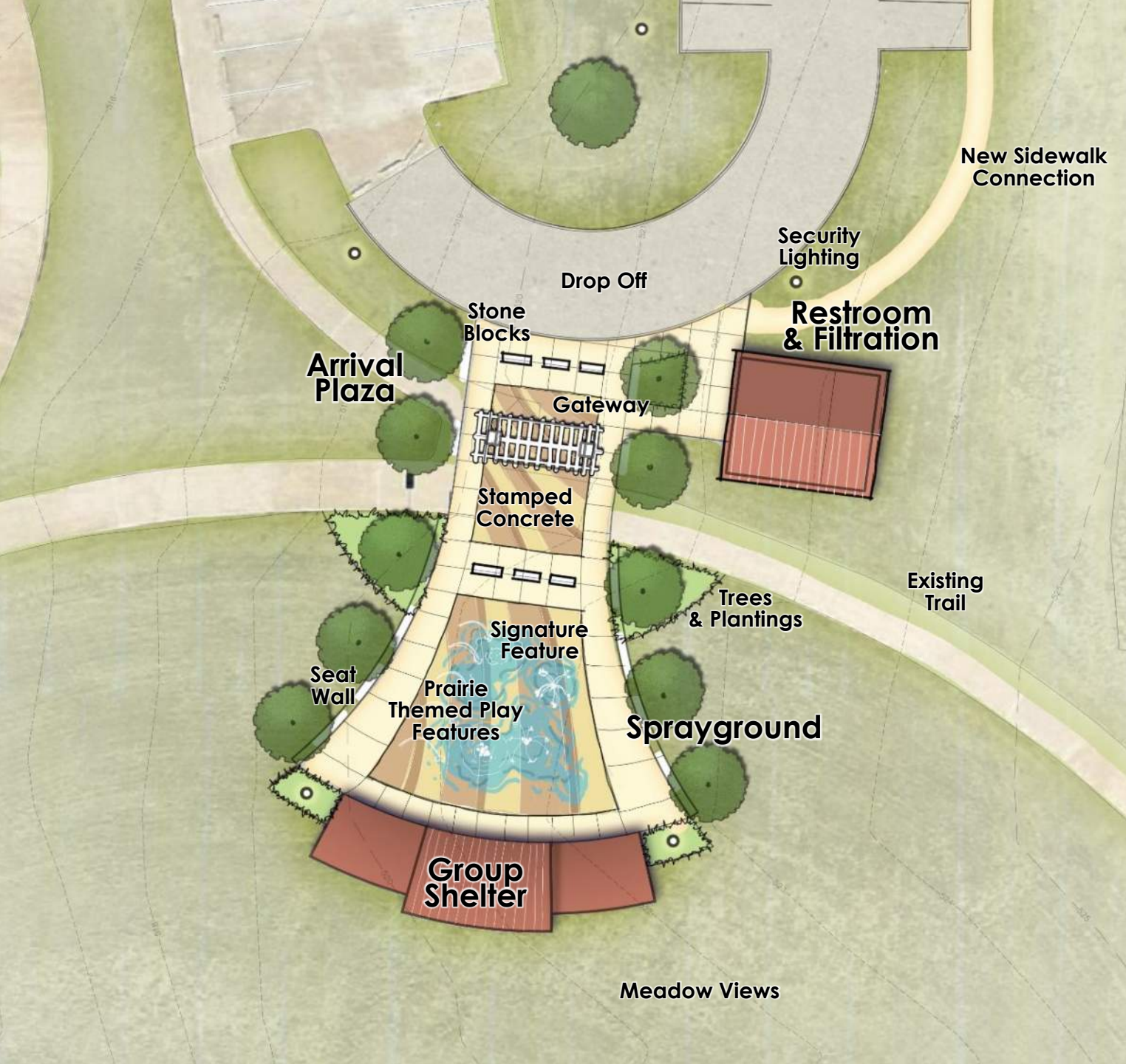

Cost Estimate

GENERAL SITE ITEMS	\$120,000
SITE IMPROVEMENTS	\$305,000
CONCRETE PAVING	\$50,000
PLAZA ENHANCEMENTS	\$25,000
GROUP PAVILION	\$75,000
SEAT WALLS	\$50,000
PARKING LOT	\$80,000
SPRAYGROUND	\$475,000
SPRAYGROUND EQUIPMENT & INSTALLATION	\$250,000
FILTRATION	\$150,000
SURFACING & SLAB	\$75,000
LANDSCAPE & IRRIGATION & SITE FURNISHINGS	By City
RESTROOM BUILDING	\$250,000
SECURITY LIGHTING	\$40,000
<hr/>	
BASE SUBTOTAL	\$1,190,000
+/- 15% CONTINGENCY	\$180,000
<hr/>	
CONSTRUCTION TOTAL:	\$1,370,000

East Meadow Sprayground

Key Features:

- Sprayground
 - *Signature Feature*
 - *Bubbler Sprays*
- Seat Walls / Stone Block Seating
- Shade Fabric
- Restroom & Filtration Building





Base Project

GENERAL SITE ITEMS	\$120,000
SITE IMPROVEMENTS	\$75,000
CONCRETE PAVING	\$25,000
SHADE FABRIC	\$50,000
SPRAYGROUND	\$475,000
SPRAYGROUND EQUIPMENT & INSTALLATION	\$250,000
FILTRATION	\$150,000
SURFACING & SLAB	\$75,000
LANDSCAPE & IRRIGATION & SITE FURNISHINGS	By City
RESTROOM BUILDING	\$250,000
SECURITY LIGHTING	\$20,000
<hr/>	
BASE SUBTOTAL	\$940,000
+/- 15% CONTINGENCY	\$140,000
<hr/>	
CONSTRUCTION TOTAL:	\$1,080,000

A photograph of a person, likely a child, playing in a water spray at a park. The person is seen from the back, wearing a dark cap and a dark jacket, and is reaching out towards a large, dense spray of water. The background is a lush green landscape with trees and a path. The image has a blue tint and a slightly grainy texture.

Community Park Sprayground

Community Park

Key Features:

- Sprayground
 - *Signature Feature*
 - *Bubbler Sprays*
- Stamped Concrete
- Seat Walls
- Shade Fabric
- Arrival Plaza
- Mechanical Enclosure
- Drop Off
- Connection to Existing Trails

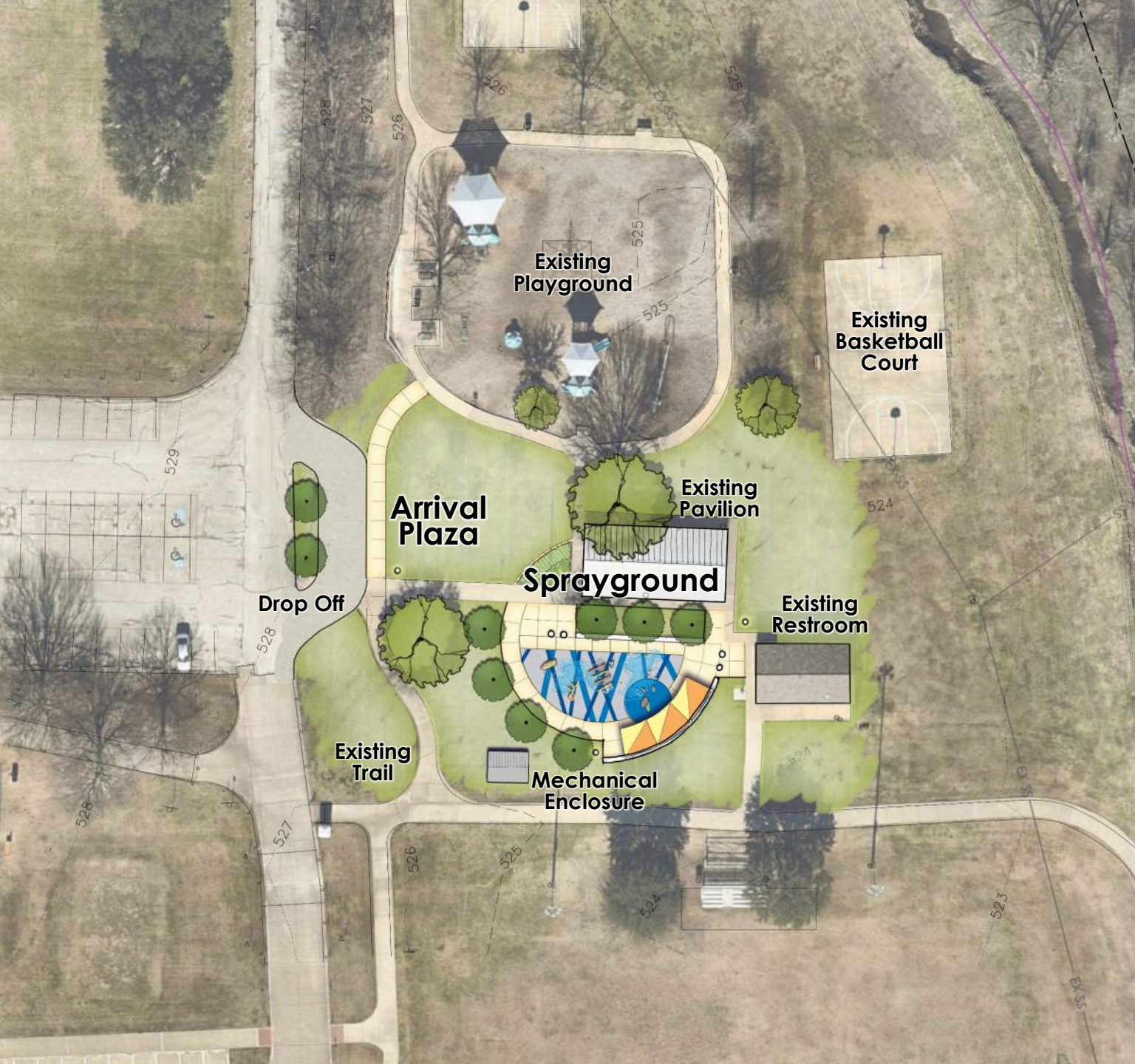

Community Park

Key Features:

- Sprayground
 - *Signature Feature*
 - *Bubbler Sprays*
- Stamped Concrete
- Seat Walls
- Shade Fabric
- Arrival Plaza
- Mechanical Enclosure
- Drop Off
- Connection to Existing Trails

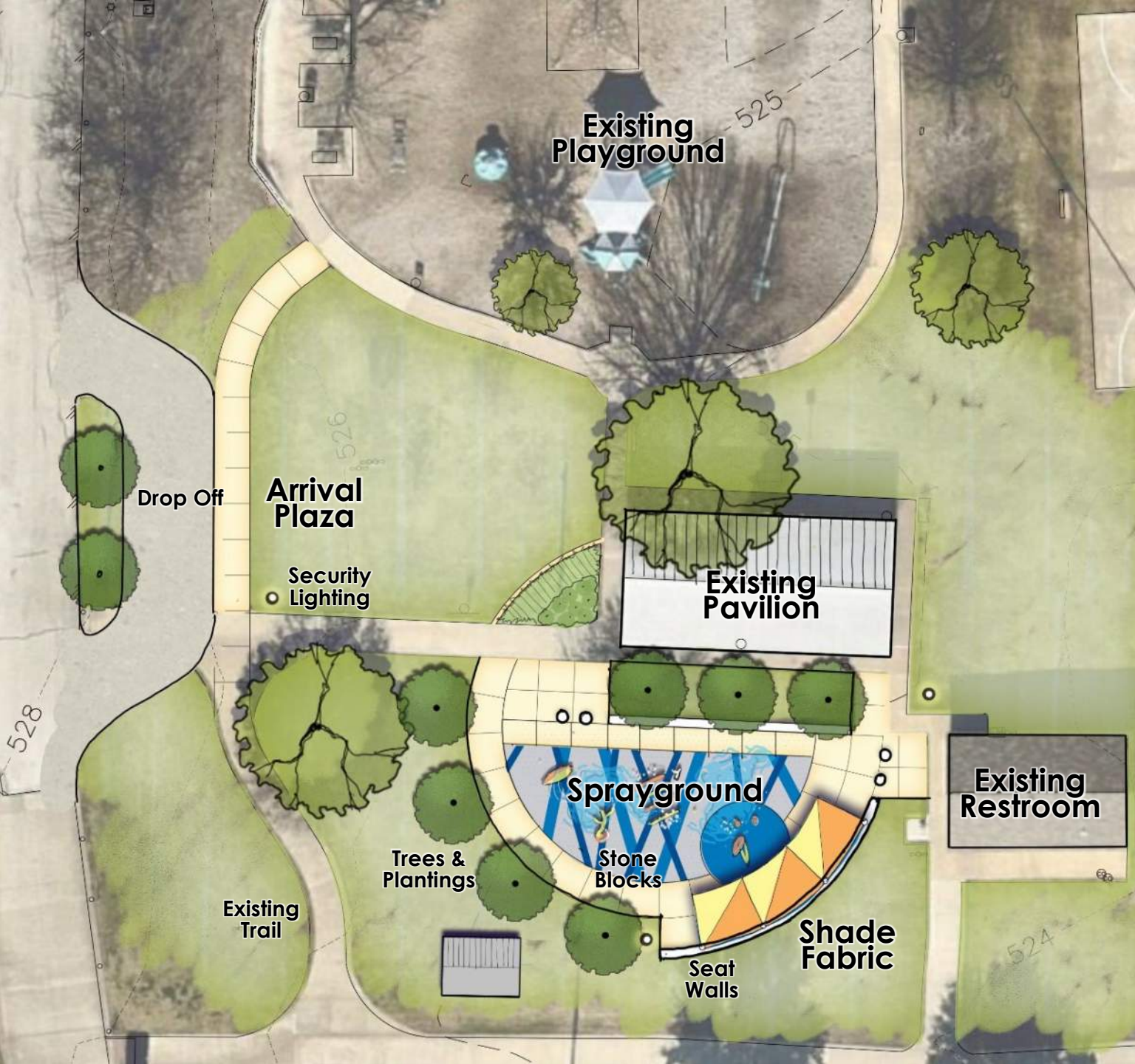





Futuristic



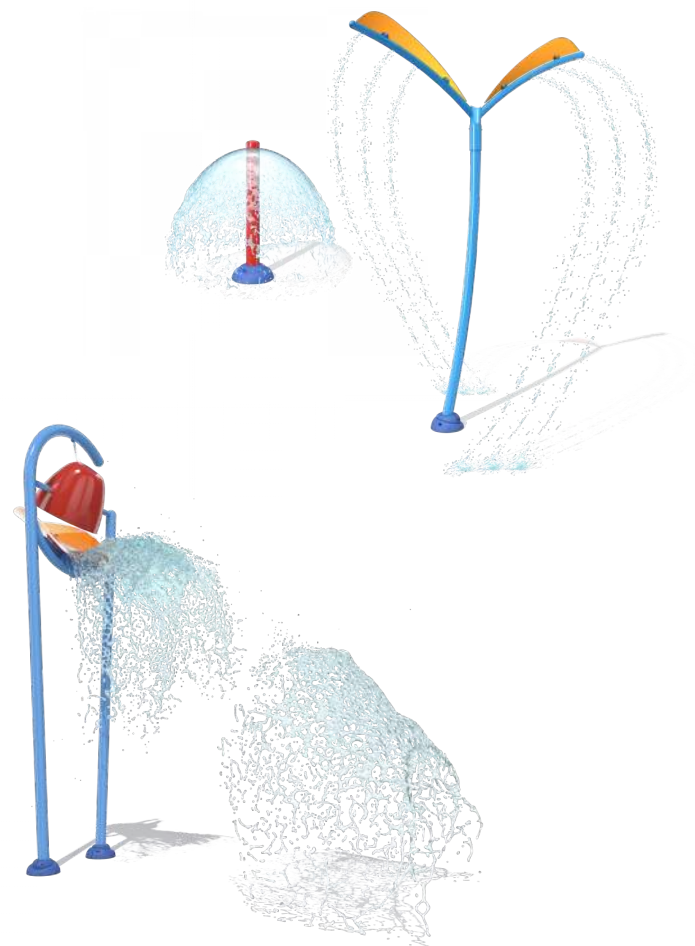

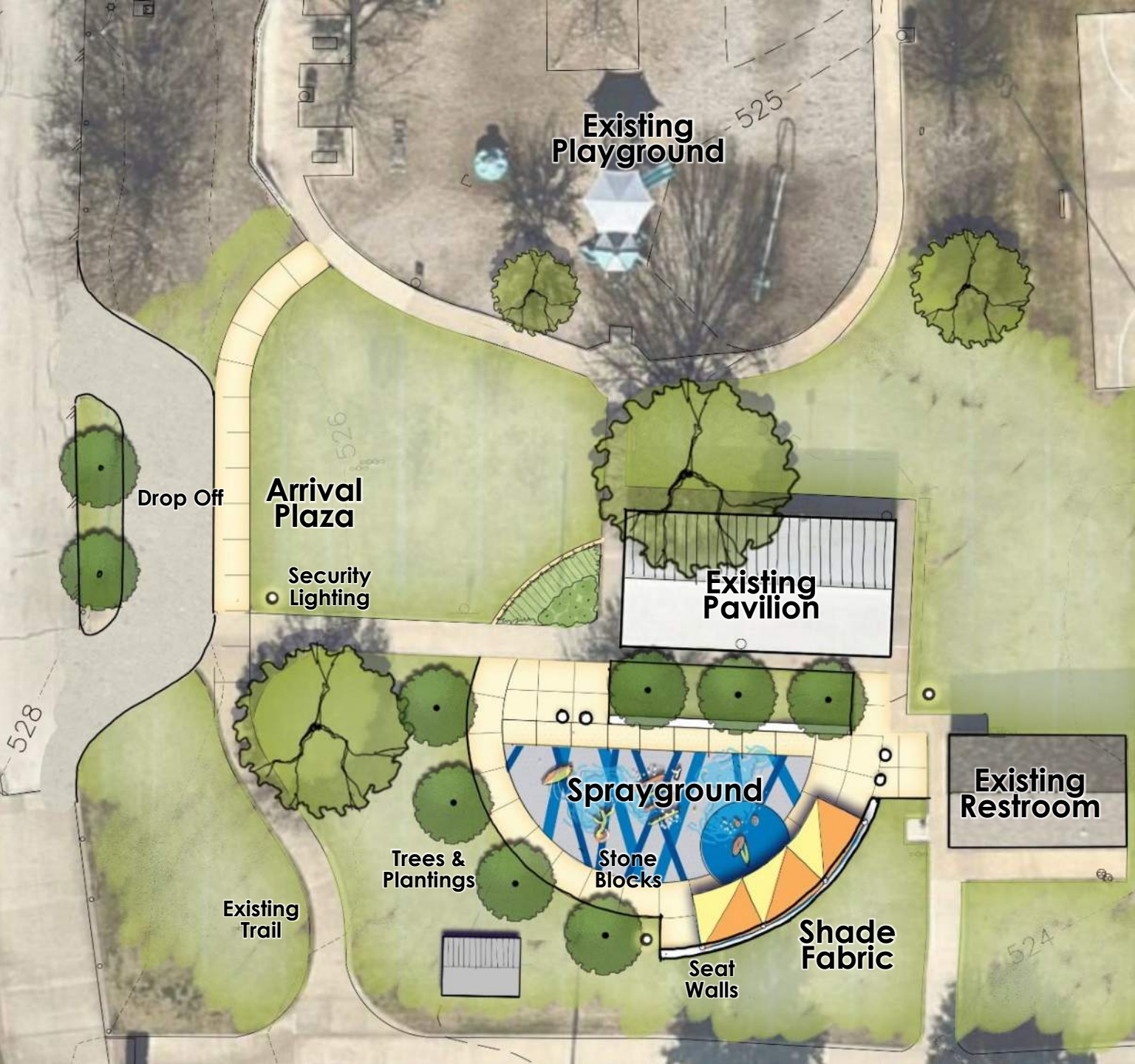

Cost Estimate

GENERAL SITE ITEMS	\$100,000
SITE IMPROVEMENTS	\$110,000
CONCRETE PAVING	\$25,000
FABRIC SHADE STRUCTURE	\$50,000
SEAT WALLS	\$20,000
DROP OFF	\$15,000
SPRAYGROUND	\$475,000
SPRAYGROUND EQUIPMENT & INSTALLATION	\$250,000
FILTRATION	\$150,000
SURFACING & SLAB	\$75,000
LANDSCAPE & IRRIGATION & SITE FURNISHINGS	By City
MECHANICAL ENCLOSURE	\$75,000
<hr/>	
BASE SUBTOTAL	\$760,000
+/- 15% CONTINGENCY	\$115,000
<hr/>	
CONSTRUCTION TOTAL:	\$875,000

Community Park

Key Features:

- Sprayground
 - *Signature Feature*
 - *Bubbler Sprays*
- Stamped Concrete
- Seat Walls
- Mechanical Enclosure
- Connection to Existing Trails

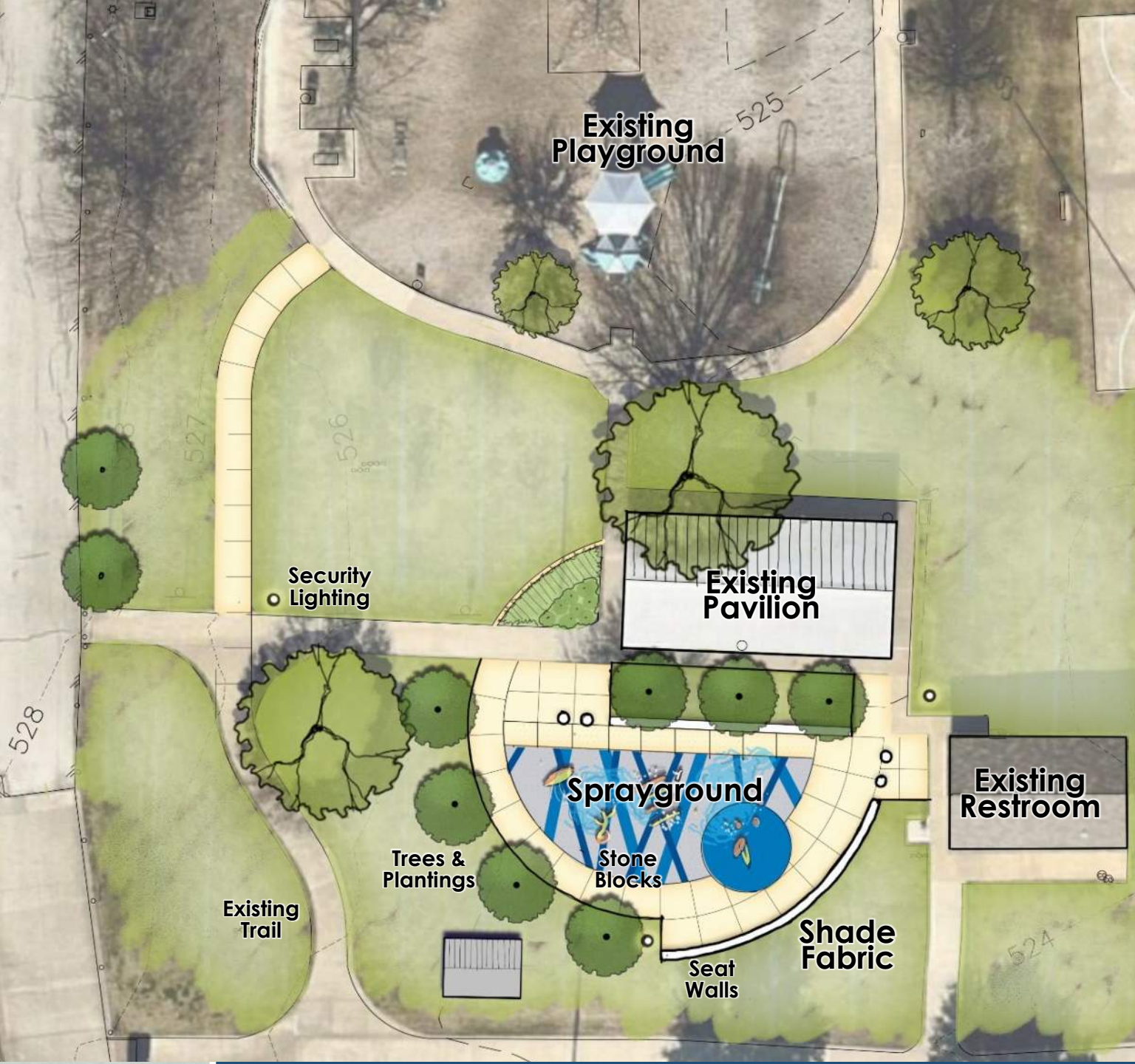

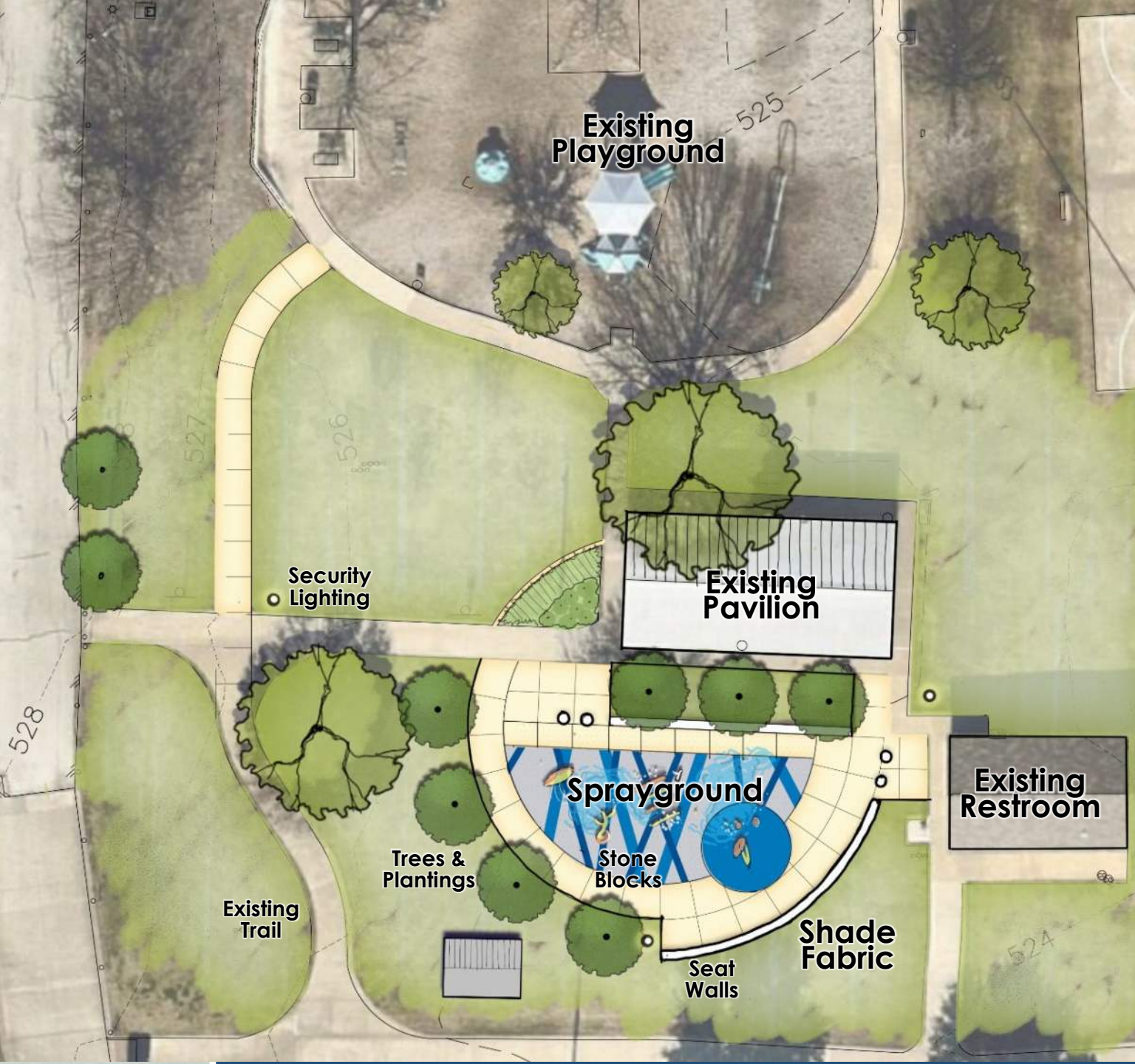

Base Project

GENERAL SITE ITEMS	\$100,000
SITE IMPROVEMENTS	\$50,000
CONCRETE PAVING	\$30,000
SEAT WALLS	\$20,000
SPRAYGROUND	\$475,000
SPRAYGROUND EQUIPMENT & INSTALLATION	\$250,000
FILTRATION	\$150,000
SURFACING & SLAB	\$75,000
LANDSCAPE & IRRIGATION & SITE FURNISHINGS	By City
MECHANICAL ENCLOSURE	\$75,000
<hr/>	
BASE SUBTOTAL	\$700,000
+/- 15% CONTINGENCY	\$110,000
<hr/>	
CONSTRUCTION TOTAL:	\$810,000



Project Schedule

Site Evaluation & Programming *complete*

Topographic Survey *complete*

Schematic Design..... August

- ☐ *Layout Plans for All 3 Site w/ Cost Opinions*
- ☐ *Review w/ City Staff*

Design Development..... Sept. – Oct.

- ☐ *50% CDs & Cost Opinion*

Final Construction Documents..... Nov. – Dec.

Bidding & Construction Phase TBD

Potential Openings*

Splashpads: *Summer 2023*

Dog Park: *Fall 2023*

