



*Honoring our past; Embracing
our present; Planning our future*



Wastewater Treatment Plant Demolition Options

CITY COUNCIL MEETING
NOVEMBER 8, 2022

Clayton C. Barnard, PE

Agenda

- Current Status
- NTMWD Facilities
- WW Interceptor Improvement Option
- Demolition Options
- Questions



Current Status – Permit Closed

- Received TCEQ cancellation notification on August 2, 2021
- Closed as a “clean site”

TEXAS COMMISSION ON ENVIRONMENTAL QUALITY



CANCELLATION OF

TEXAS COMMISSION ON ENVIRONMENTAL QUALITY

PERMIT NO. WQ0010384001

EPA ID: TX0025950

ISSUED TO: North Texas MWD

ISSUED January 30, 2018

The holder of Permit No. WQ0010384001 has consented to the cancellation of the permit. The permit was issued to Wylie Wastewater Treatment Plant, located at 806 Alans Drive, in Collin County, Texas. The activities authorized by the registration have terminated, as confirmed by the staff of the Texas Commission on Environmental Quality.

THEREFORE:

1. Pursuant to the provisions of 30 Texas Administrative Code Section 305.67, Permit No. WQ0010384001 is revoked.
2. A copy of this revocation shall be sent to the holder of this permit.

Effective Date: August 2, 2021

A handwritten signature in black ink, appearing to read "T. B. Baker", is written over a horizontal line.

For The Commission

Current Status – NTMWD Injection



Current Status – NTMWD Injection



Demolition Options – No Demo



Demolition Options – WW Interceptor with no Demo





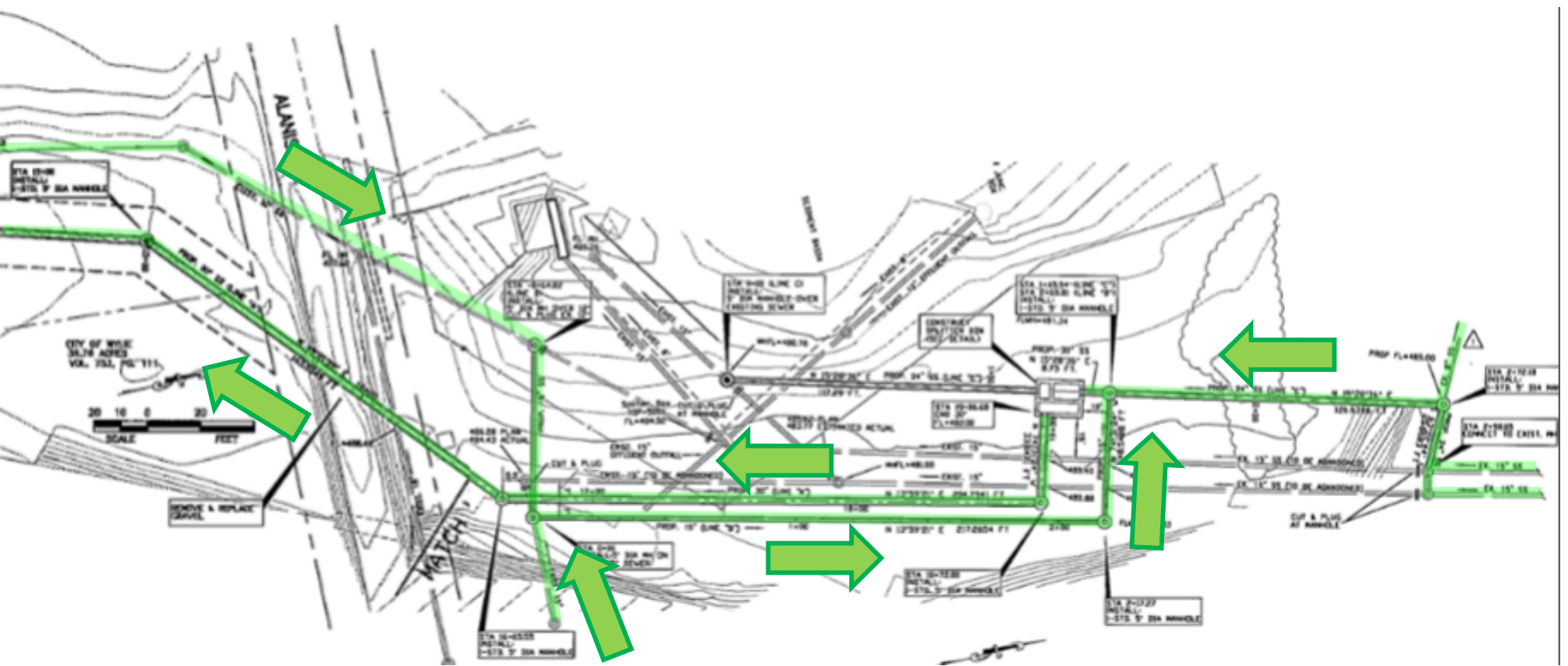

Demolition Options – WW Interceptor with no Demo

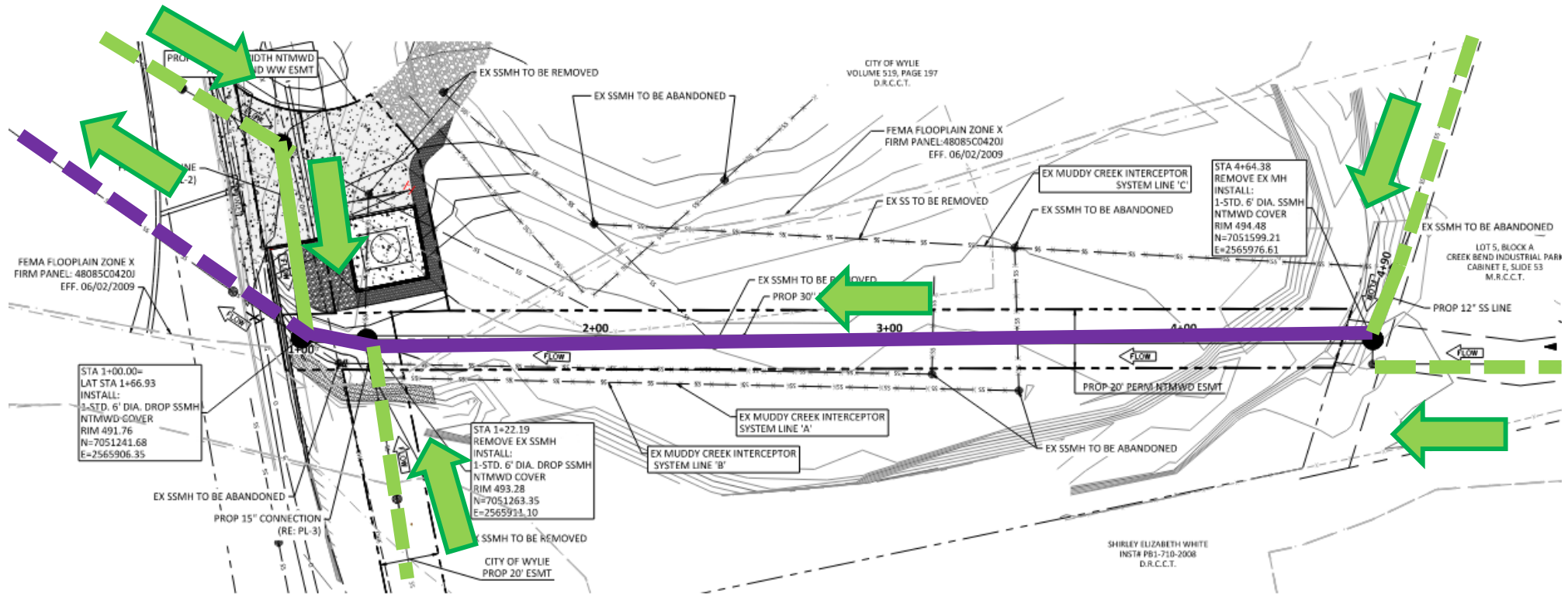

Demolition Options – WW Interceptor with no Demo



-  Existing City of Wylie
 Proposed City of Wylie
 Existing NTMWD
 Proposed NTMWD

Demolition Options – WW Interceptor with no Demo



\$775,000

Demolition Options

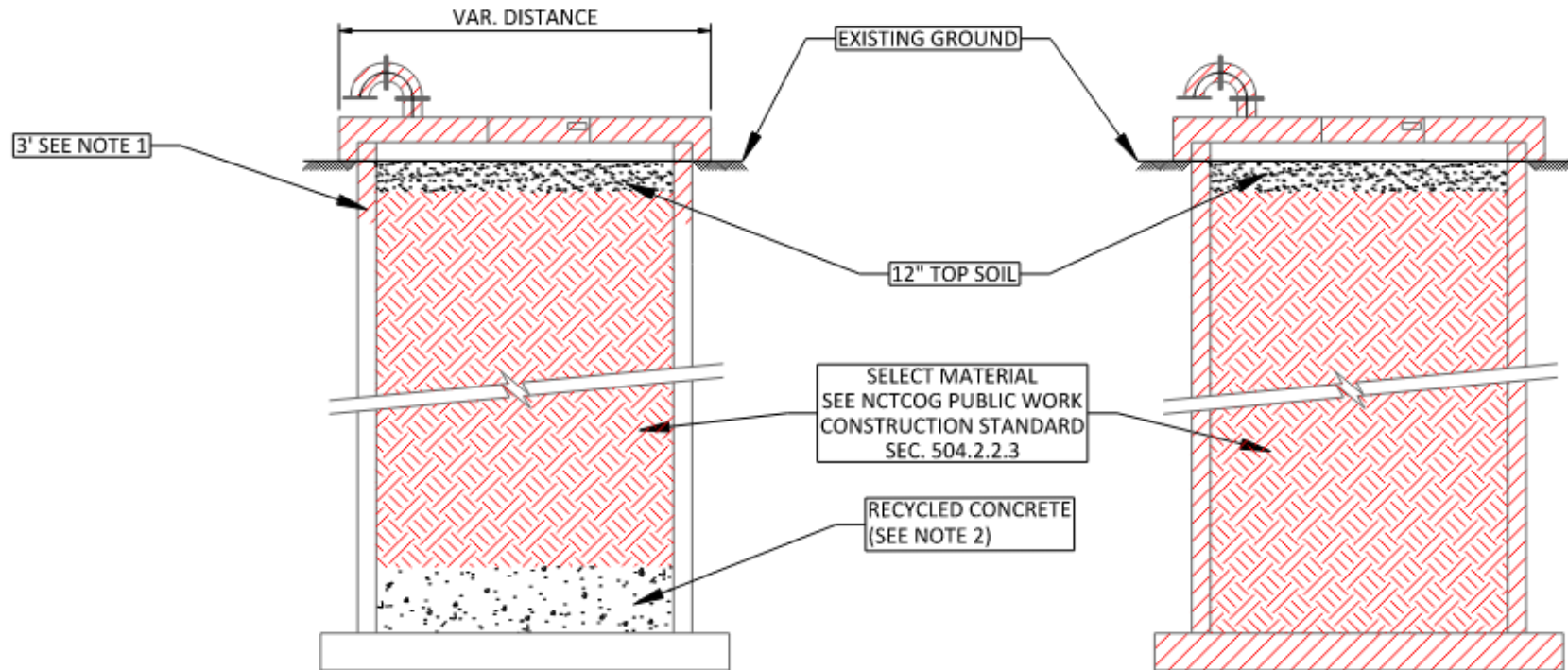

Option 1 – Top Removal

Option 2 – Full Removal

Demolition Options – Basin Removal



Demolition Options – Basin Removal



Demolition Options – Removal All structures

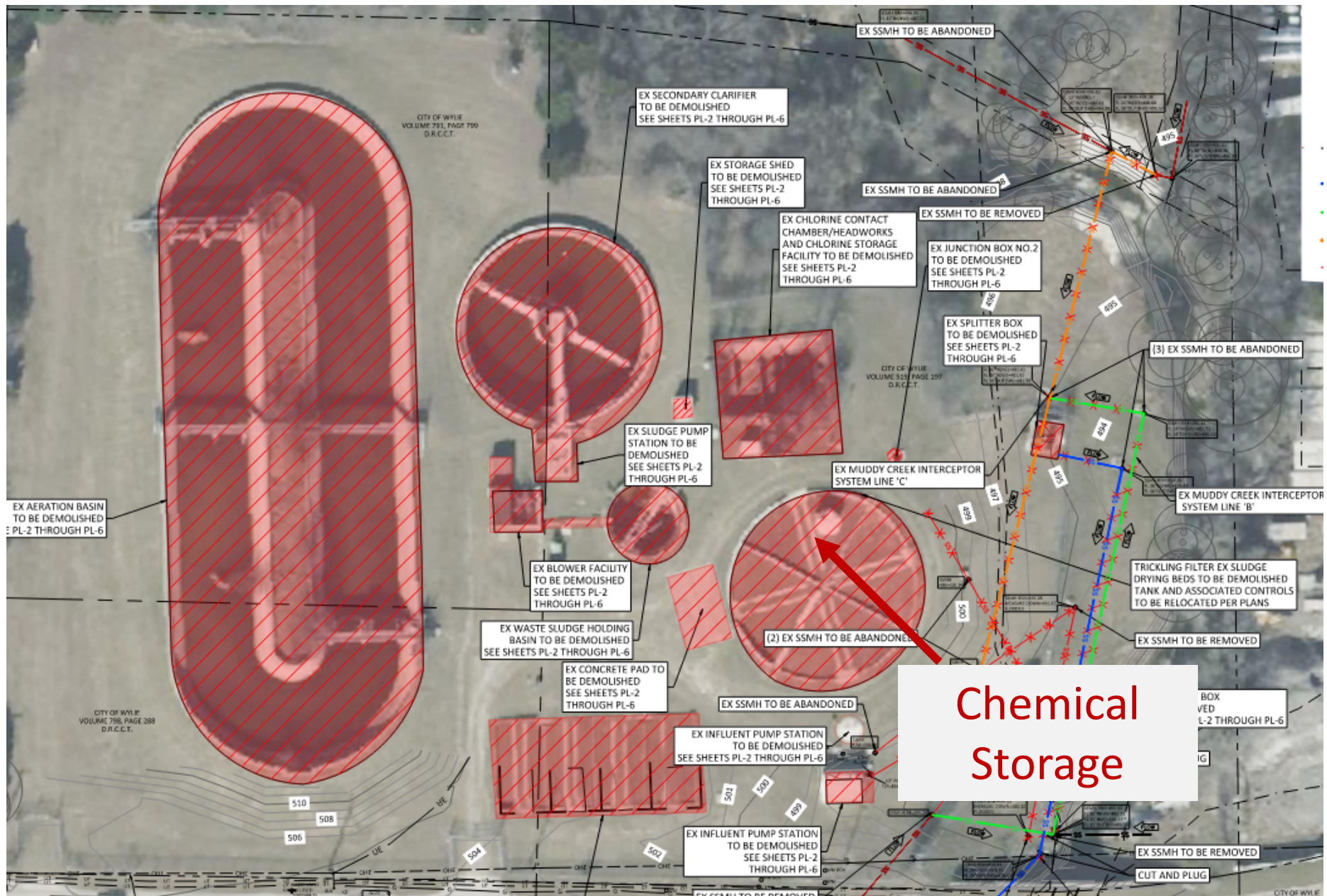

Demolition Options – Removal All structures

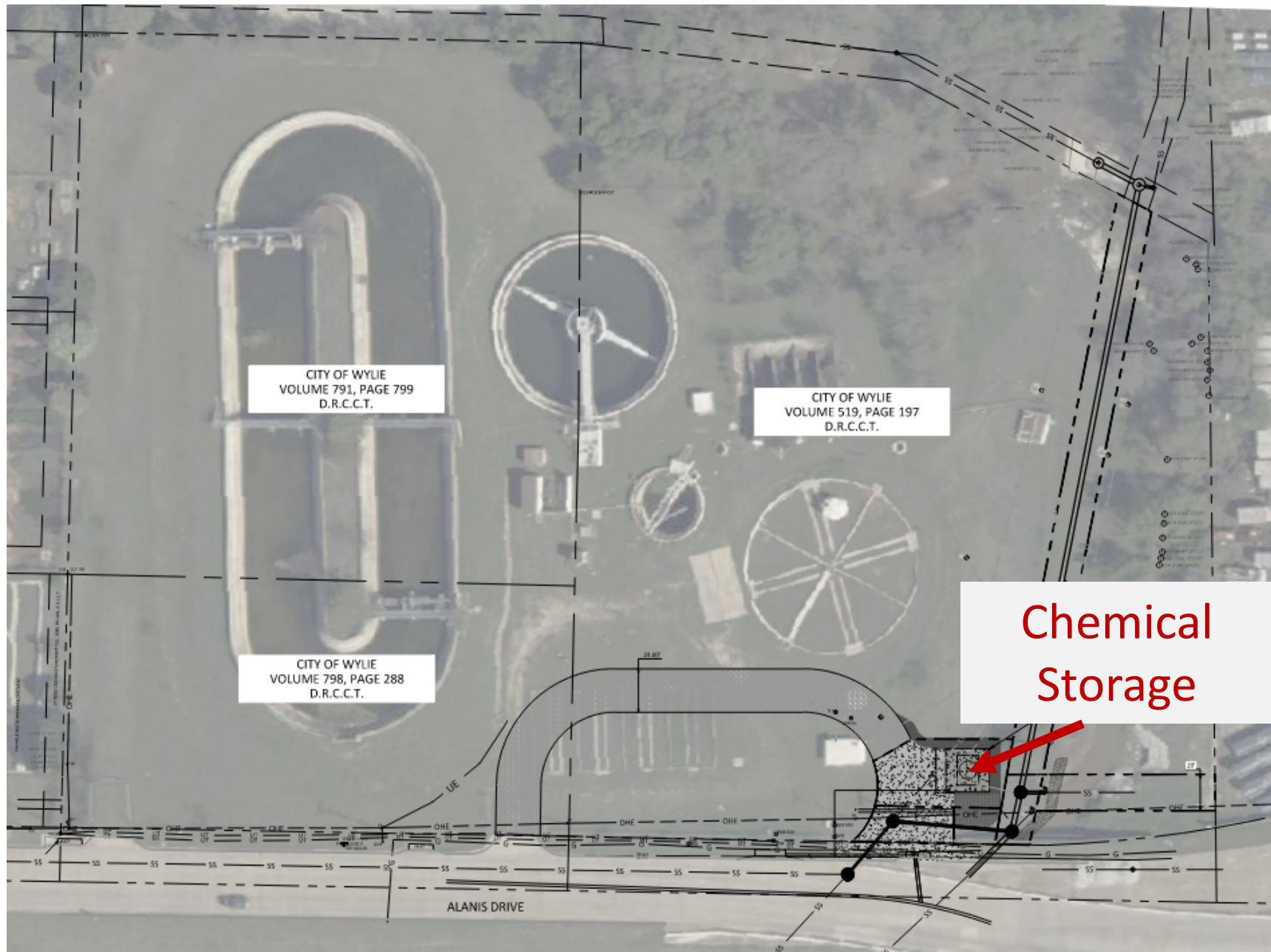

Demolition Options – Removal All structures

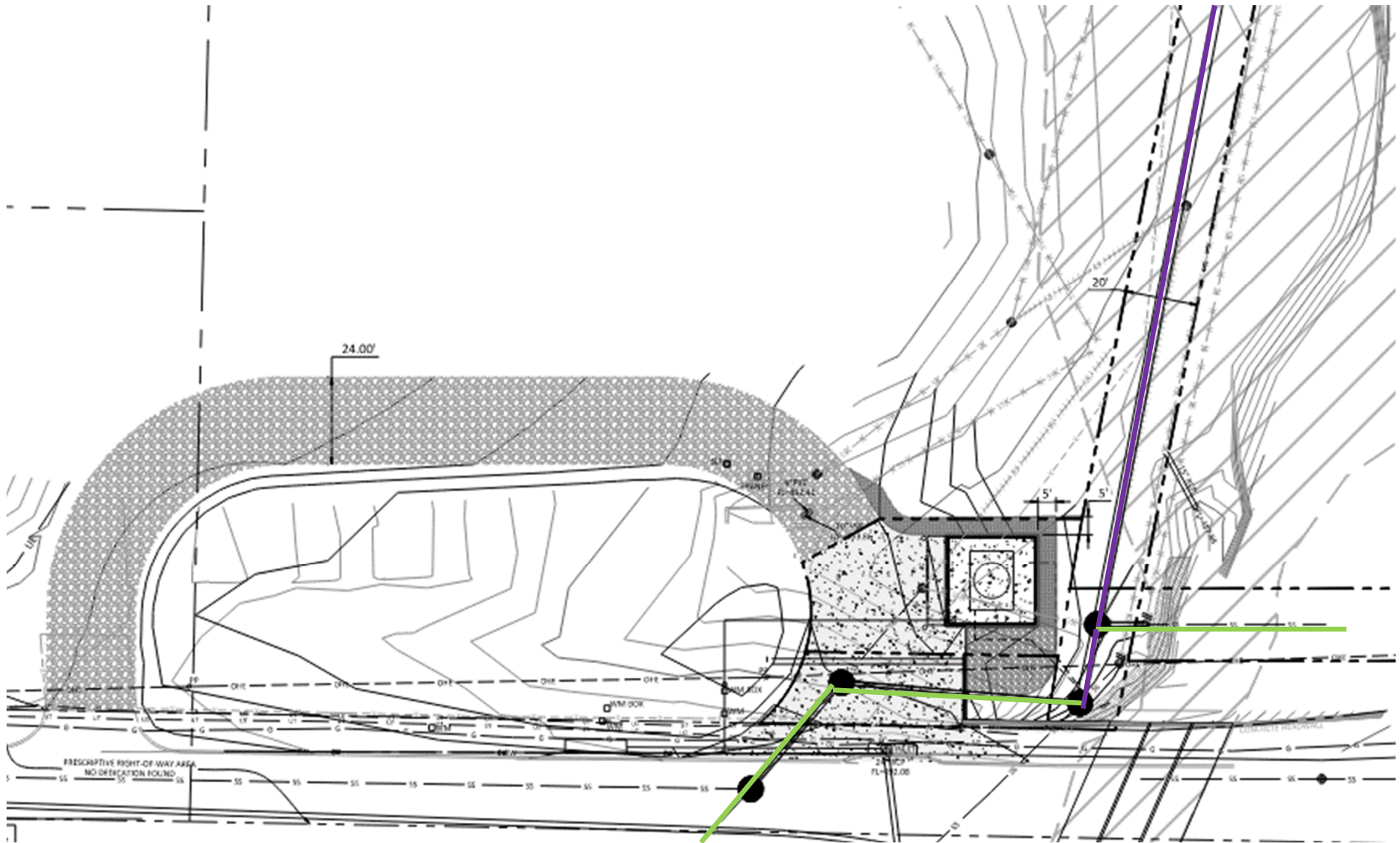

Demolition Options – Removal All structures – Proposed Easements

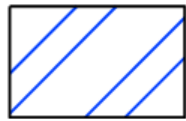

NTMWD ESMT



CITY OF WYLIE ESMT



NTMWD ACCESS AND WW ESMT

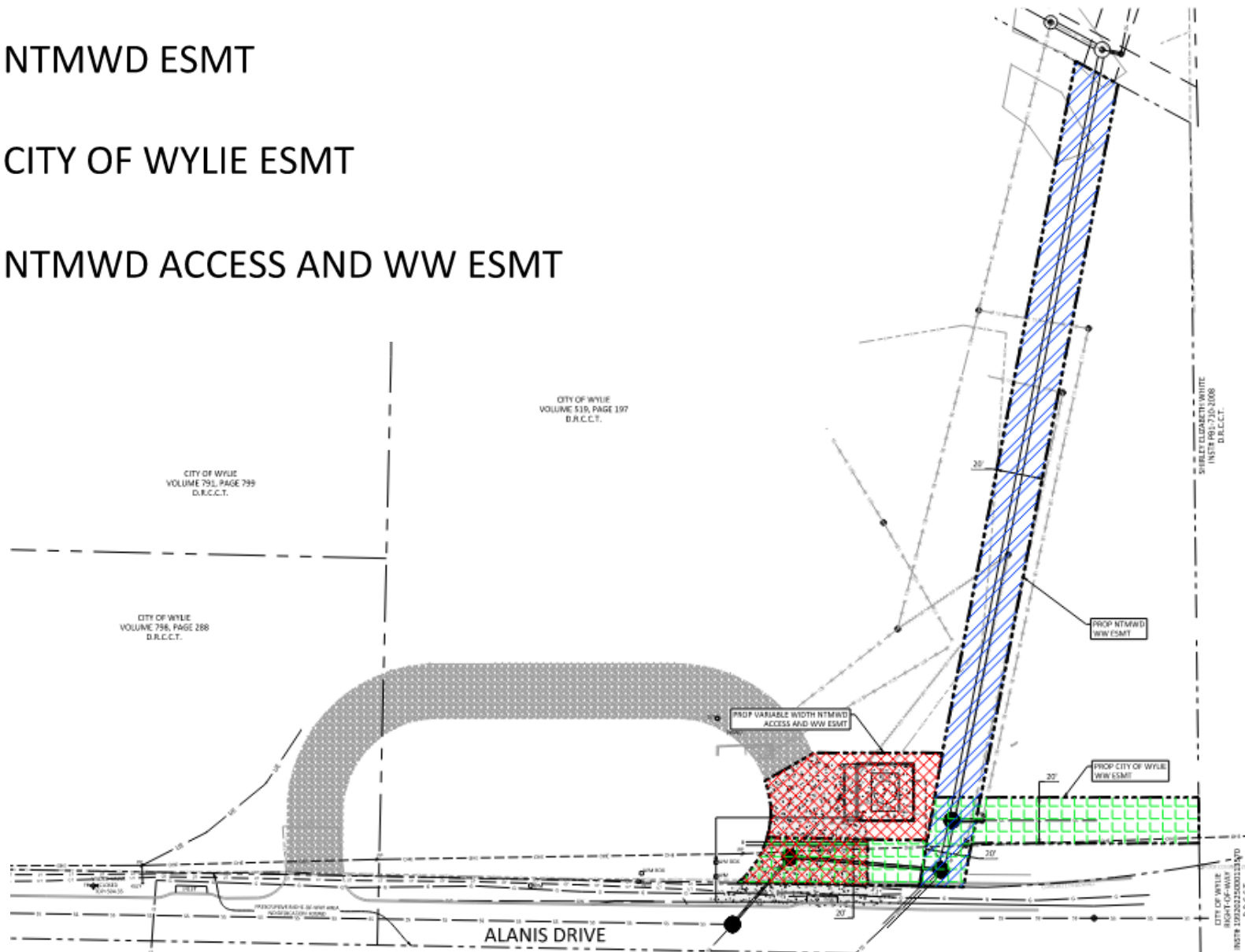

Demolition Options – Removal All structures

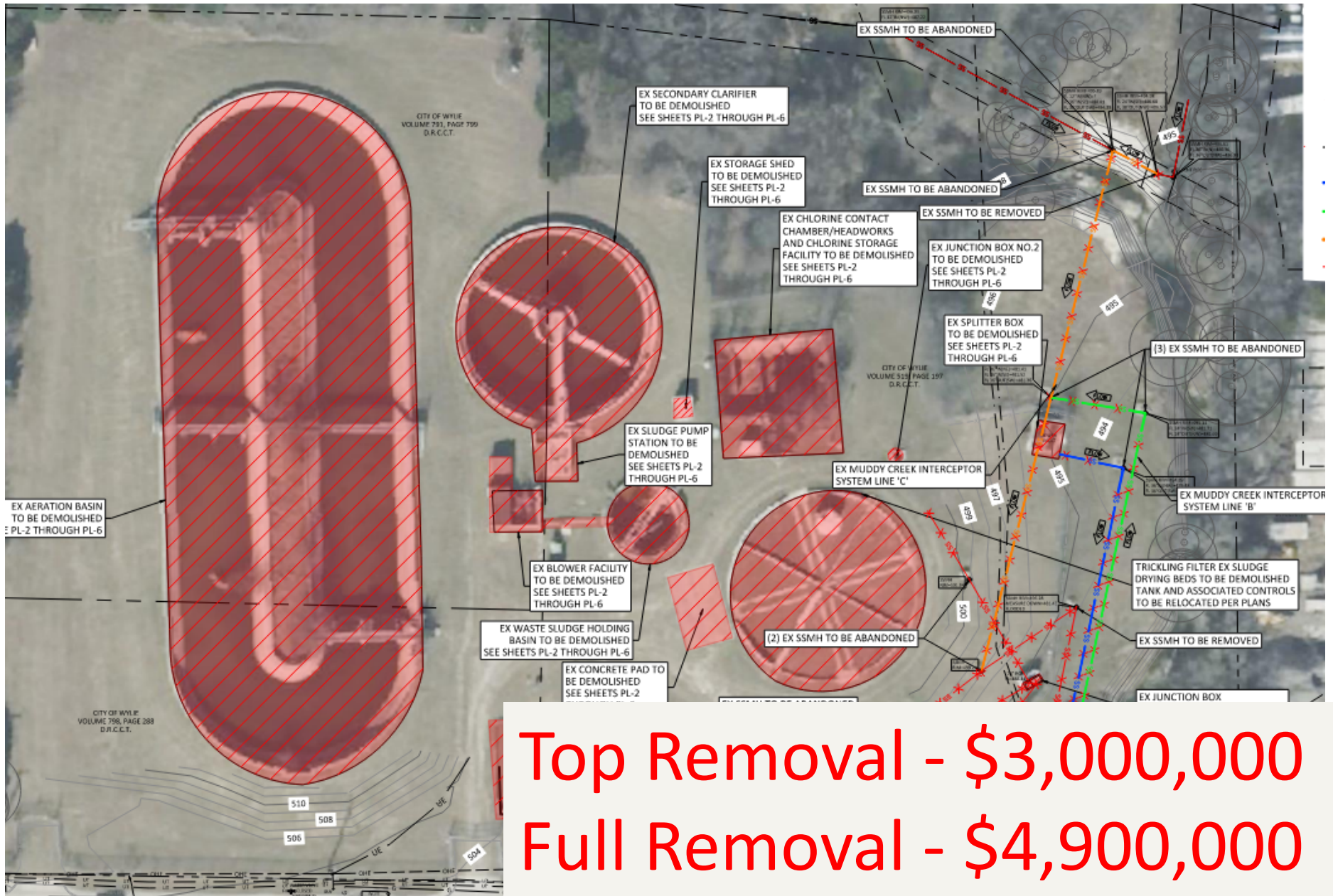

Top Removal - \$3,000,000
Full Removal - \$4,900,000

Demolition Options – Summary

NO DEMOLITION/ REMAIN AS IS - \$0

WW INTERCEPTOR IMPROVEMENTS - \$775,000

BASIN DEMOLITION – TOP REMOVAL - \$1,952,000

BASIN DEMOLITION – FULL REMOVAL - \$4,630,000

BASIN AND STRUCTURE DEMOLITION – TOP REMOVAL - \$3,000,000

BASIN AND STRUCTURE DEMOLITION – FULL REMOVAL - \$4,900,000



*Honoring our past; Embracing
our present; Planning our future*

Wastewater Treatment Plant Demolition Options

QUESTIONS

