

RECEIVED  
VILLAGE OF WESLEY HILLS  
FEB 26 2025  
BUILDING,  
PLANNING & ZONING

6 Jeremy Ct, Suffern, NY 10901

SBL: 32.19 - 2 - 4.1

Attached you will find an application to the Planning Board and Architectural Review Board for the above address. We are looking to construct a new single family home on this property, which is located within a subdivision.

We are proposing roof shingles by GAF HDZ, charcoal in color. The siding will be Hardi Plank in arctic white. There will be 5" aluminum gutters and downspouts, black in color. The windows will be from Sierra Pacific, black framed. We are proposing Fiberglass garage doors, Clopay Canton Ridge Elements or equal, black.

**PART I**

RECEIVED  
VILLAGE OF WESLEY HILLS  
FEB 26 2025  
BUILDING,  
PLANNING & ZONING

Name of Municipality VILLAGE OF WESLEY HILLS

Date 2/24/25

Please check all that apply:

<input checked="" type="checkbox"/> Planning Board	<input type="checkbox"/> Municipal Board
<input type="checkbox"/> Zoning Board of Appeals* (Fill out Part II of this form.)	<input type="checkbox"/> Historical Board
	<input checked="" type="checkbox"/> Architectural Review
<input type="checkbox"/> Subdivision	<input type="checkbox"/> Pre-preliminary/Sketch
<input type="checkbox"/> Number of Lots	<input type="checkbox"/> Preliminary
<input type="checkbox"/> Site Plan	<input type="checkbox"/> Final
<input type="checkbox"/> Special Permit	<input type="checkbox"/> Conditional Use
<input type="checkbox"/> Zoning Code Amendment	<input type="checkbox"/> Zone Change
<input type="checkbox"/> Variance	

Applicant: Nancy Rubin

Phone # 845-424-0244

Address: 16 Squadron Blvd, Suite 104, New City, NY 10956

Street Name & Number (Post Office)

Project Name: 6 Jeremy Ct, Suffern, NY 10901

Tax Map Lot No. 32.19 - 2 - 4.1

Map Date

Current Zoning R-50

Location: On the South side of Jeremy,  
500 feet East of Powder Horn in the  
town of Ramapo hamlet/village of Wesley Hills.

Acreage of Parcel 1.010 Acre

Zoning District R-50

School District East Ramapo

Postal District 10901

Fire District Hillcrest

Ambulance District Ramapo Valley

Water District Veolia

Sewer District Town of Ramapo

Project Description: (If additional space required, please attach a narrative summary.)

We are looking to construct a new single family  
home, within a subdivision.



**If subdivision:**

- 1) Is any variance from the subdivision regulations required? No
- 2) Is any open space being offered? No If so, what amount? \_\_\_\_\_
- 3) Is this a standard or average density subdivision? yes

**If site plan:**

- 1) Total size of building(s) in square feet \_\_\_\_\_
- 2) Proposed addition \_\_\_\_\_
- 3) Number of dwelling units \_\_\_\_\_

If **special permit**, list special permit use and what the property will be used for.

Are there **slopes greater than 25%**? If yes, please indicate the amount and show the gross and net area. No

Are there **streams** on the site? If yes, please provide the names. No

Are there **wetlands** on the site? If yes, please provide the names and type. No

**Project History:** Has this project ever been reviewed before? No

If so, provide a narrative, including the list case number, name, date, and the board you appeared before.

List tax map section, block & lot numbers for all other abutting properties in the same ownership as this project.

Property Owner: Zev Westreich Phone # 718-288-1653  
Address 2 Belmar Ct., Suffern, NY 10901  
Street Name & Number (Post Office) State Zip code

Engineer/Architect/Surveyor: Paul Gdansk, PE, PLLC Phone # 917-418-0999  
Address 3512 Whittier Ct., Mahwah, NJ 07430  
Street Name & Number (Post Office) State Zip code

Attorney: N/A Phone # \_\_\_\_\_  
Address \_\_\_\_\_  
Street Name & Number (Post Office) State Zip code

Contact Person: Nancy Rubin Phone # 845-424-0244  
Address 16 Squadron Blvd, Suite 104, New City, NY 10956  
Street Name & Number (Post Office) State Zip code

This property is within **500 feet** of:  
(Check all that apply)

IF ANY ITEM IS CHECKED, A REVIEW MUST BE DONE BY THE ROCKLAND COUNTY COMMISSIONER OF PLANNING UNDER THE  
STATE GENERAL MUNICIPAL LAW, SECTIONS 239 K, L, M, AND N.

<input type="checkbox"/> State or County Road	<input type="checkbox"/> State or County Park
<input type="checkbox"/> County/State Land or Right-of-Way	<input type="checkbox"/> County Stream
<input type="checkbox"/> Municipal Boundary	<input type="checkbox"/> County Facility

List name(s) of facility checked above. \_\_\_\_\_  
\_\_\_\_\_

Location of Parcel(s) \_\_\_\_\_  
\_\_\_\_\_

**Referral Agencies:** *(Please check with the Village Office to make sure that the appropriate agencies, as needed, receive copies of your application and plans for their review.)*

<input type="checkbox"/> RC Highway Department	<input type="checkbox"/> Town of Ramapo Dept. of Public Works
<input type="checkbox"/> RC Drainage Agency	<input type="checkbox"/> RC Dept. of Planning
<input type="checkbox"/> RC Soil and Water Cons. Dist.	<input type="checkbox"/> RC Dept. of Environmental Health
<input type="checkbox"/> NYS Dept. of Transportation	<input type="checkbox"/> NYS Dept. of Environmental Conservation
<input type="checkbox"/> RC Sewer District #1	<input type="checkbox"/> Town of Ramapo Building Dept.
<input type="checkbox"/> Rockland County 911	

Adjacent Municipality \_\_\_\_\_  
\_\_\_\_\_

(AS APPLICABLE)

**TO ALL APPLICANTS - YOU MUST SEND A COPY OF APPLICATIONS AND PLANS TO:**

Regional Manager  
Orange and Rockland  
75 West Route 59  
Spring Valley, NY 10977

I have informed the above checked agencies and Orange and Rockland on \_\_\_\_\_.

\_\_\_\_\_  
Signature

\_\_\_\_\_  
Date



**VILLAGE OF WESLEY HILLS**

432 Route 306  
Wesley Hills, New York 10952  
(845) 354-0400 Fax: (845) 354-4097

**AFFIDAVIT OF OWNERSHIP**

STATE OF NEW YORK }  
COUNTY OF ROCKLAND } SS:  
VILLAGE OF WESLEY HILLS }

Zev Westreich being duly sworn, deposes and  
says that he/she resides at 2 Belmar Ct, Suffern  
NY 10901

in the County of Rockland, State of New York; that he/she is the owner in  
fee of all that certain lot, piece or parcel of land situated, lying and being  
in the Village of Wesley Hills, and designated on the Town of Ramapo  
Map as Section No. 32.19 Lot No. 4.1 and that he/she hereby  
authorizes the attached application to be submitted in his/her behalf and  
that the statements of fact contained in said application are true.

The applicant is the (owner) (contract vendee) of the said property

Owner: [Signature]  
Address: 2 Belmar Ct  
Suffern, NY 10901

Sworn to before me this

24 day of FEB. 2025  
[Signature]  
Notary Public

FASIL A. YILMA  
Notary Public, State of New York  
No. 01Y18342601  
Qualified in New York County  
Commission Expires May 23, 2028

## Applicant's Signature and Certification

State of New York)

County of Rockland) SS.:

Town/Village of Wesley Hills)

I, Nancy Rubin, hereby depose and say that all the above statements contained in the papers submitted herewith are true.

Mailing Address

16 Squadron Blvd

Suite 104

New City, NY 10956

SWORN to before this

25 day of February, 2025

[Signature]  
Notary Public

YEHUDA ABBOUDI  
NOTARY PUBLIC  
STATE OF NEW JERSEY  
MY COMMISSION EXPIRES JUNE 17, 2025  
COMMISSION: #50017921

## Owner/Applicant's Consent Form to Visit Property

I, Nancy Rubin, owner/applicant of the property described in application submitted to the town/village board, planning board, zoning board of appeals, and/or supporting staff, do hereby give permission to members of said boards and/or supporting staff to visit the property in question for the purposes incidental to the within application at a reasonable time during the day and upon reasonable notice to the owner or tenant in possession.

NR  
Owner/Applicant

SWORN to before this

25th day of February, 2025

[Signature]  
Notary Public

YEHUDA ABBOUDI  
NOTARY PUBLIC  
STATE OF NEW JERSEY  
MY COMMISSION EXPIRES JUNE 17, 2025  
COMMISSION: #50017921



## Affidavit of Ownership/Owner's Consent

State of New York)  
County of Rockland) SS.:  
Town/Village of Wesley Hills

I, Zev Wastreich being duly sworn, hereby  
depose and say that I reside at: 2 Belmar Ct. Suffern NY 10901

in the county of Rockland in the state of New York

I am the (\*                     ) owner in fee simple of premises located at:  
6 Jeremy Court, Suffern, NY 10901

described in a certain deed of said premises recorded in the Rockland County Clerk's  
Office in Liber                      of conveyances, page                     .

Said premises have been in my/its possession since 2024. Said premises are  
also known and designated on the Town of Ramapo

Tax Map Lot - No. 32.19 - 2 - 4.1 Map Date                       
Current Zoning R-50

I hereby authorize the within application on my behalf, and that the statements of fact  
contained in said application are true, and agree to be bound by the determination of the  
board. Also, I do hereby give permission to the Village of Wesley Hills, its agents,  
servants and employees to enter upon the above described property solely for the  
purposes incidental to the within application at reasonable times upon reasonable notice  
to the owner or tenant in possession.

Owner  
Mailing Address

2 Belmar Ct. Suffern  
NY, 10901

SWORN to before this

24 day of Feb., 20 25

[Signature]  
Notary Public

FASIL A. YILMA  
Notary Public, State of New York  
No. 01Y16342601  
Qualified in New York County  
Commission Expires May 23, 20 28

\* If owner is a corporation, fill in the office held by deponent and name of corporation,  
and provide a list of all directors, officers and stockholders owning more than 5% of  
any class of stock.



## Affidavit Pursuant to Section 809 of the General Municipal Law

State of New York)

County of Rockland) SS.:

Town/Village of Westey Hills)

I, Nancy Rubin, being duly <sup>affirms</sup> ~~sworn~~, hereby depose and say that all the following statements and the statements contained in the papers submitted herewith are true and that the nature and extent of any interests set forth are disclosed to the extent that they are known to the applicant.

1. Print or type full name and post office address

Nancy Rubin  
16 Squadron Blvd, Suite 104  
New City, NY 10956

certifies that he is owner or agent of all that certain lot, piece or parcel of land and/or building described in this application **and if not the owner that he has been duly and properly authorized to make this application and to assume responsibility for the owner** in connection with this application for the relief below set forth:

2. To the Architectural / Planning Board of the Town/Village of  
(Board, Commission or Agency)  
Westey Hills, Rockland County, New York:

Application, petition or request is hereby submitted for:

- ☐ Variance or modification from the requirement of Section \_\_\_\_\_;
- ☐ Special permit per the requirements of Section \_\_\_\_\_;
- ☐ Review and approval of proposed subdivision plat;
- ☐ Exemption from a plat or official map;
- ☒ An order to issue a certificate, permit or license;
- ☐ An amendment to the Zoning Ordinance or Official Map or change thereof;
- ☐ Other (explain) \_\_\_\_\_;

To permit construction, maintenance and use of a single family home.

3. Premises affected are in a R-50 zone and from the town of  
Ramapo tax map, the property is know as:

Tax Map Lot - No. 32.19 - 2 - 4.1



4. There is no state officer, Rockland County Officer or employee or town/village officer or employee nor his or her spouse, brother, sister, parent, child or grandchild, or a spouse of any of these relatives who is the applicant or who has an interest in the person, partnership or association making this application, petition or request, or is an officer, director, partner or employee of the applicant, or that such officer or employee, if this applicant is a corporation, legally or beneficially owns or controls any stock of the applicant in excess of 5% of the total of the corporation if its stock is listed on the New York or American Stock Exchanges; or is a member or partner of the applicant, if the applicant is an association or a partnership; nor that such town/village officer or employee nor any member of his family in any of the foregoing classes is a party to an agreement with the applicant, express or implied, whereby such officer or employee may receive any payment or other benefit, whether or not for service rendered, which is dependent or contingent upon the favorable approval of this application, petition or request.

5. That to the extent that the same is known to your applicant, and to the owner of the subject premises **there is disclosed herewith** the interest of the following officer or employee of the State of New York or the County of Rockland or of the Town/Village of Wesley Hills in the petition, request or application or in the property or subject matter to which it relates:  
(if none, so state)

a. Name and address of officer or employee \_\_\_\_\_

b. Nature of interest \_\_\_\_\_

c. If stockholder, number of shares \_\_\_\_\_

d. If officer or partner, nature of office and name of partnership \_\_\_\_\_

e. If a spouse or brother, sister, parent, child, grandchild or the spouse of any of these blood relatives of such state, county or town/village officer or employee, state name and address of such relative and nature of relationship to officer and employee and nature and extent of office, interest or participation or association having an interest in such ownership or in any business entity sharing in such ownership. \_\_\_\_\_

f. In the event of corporate ownership: A list of all directors, officers and stockholders of each corporation owning more than five (5%) percent of any class of stock, must be attached, if any of these are officers or employees of the State of New York, or of the County of Rockland, or of the Town/Village of \_\_\_\_\_.

I, Nancy Rubin, do hereby depose and say that all the above statements and statements contained in the papers submitted herewith are true, knowing that a person who knowingly and intentionally violates this section is guilty of a misdemeanor.

Mailing Address

Nancy Rubin  
16 Squadron Blvd, Suite 104  
New City, NY 10950

SWORN to before this

25th day of February, 2025

[Signature]  
Notary Public

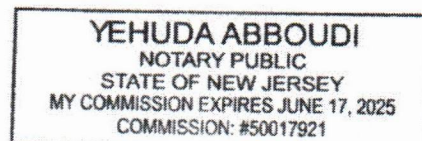

**DISCLAIMER**

APPLICANT TAKES FULL RESPONSIBILITY FOR RESEARCHING THE TAX MAP FOR THE LIST OF NAMES OF PROPERTY OWNERS ON THE ENCLOSED **AFFIDAVIT OF MAILING LIST**, AND SUPPLYING THE NECESSARY AMOUNT OF LABELED STAMPED ENVELOPES.

THE APPLICANT'S ENVELOPES MUST COINCIDE WITH THE LIST. THE CLERK'S RESPONSIBILITY IS LIMITED TO CHECKING NAMES ON THE ENVELOPES AGAINST THE AFOREMENTIONED AFFIDAVIT BEFORE MAILING THEM.

RECEIPT OF THIS DISCLAIMER IS ACKNOWLEDGED

Nancy Rubin  
APPLICANT

2/24/25  
DATED







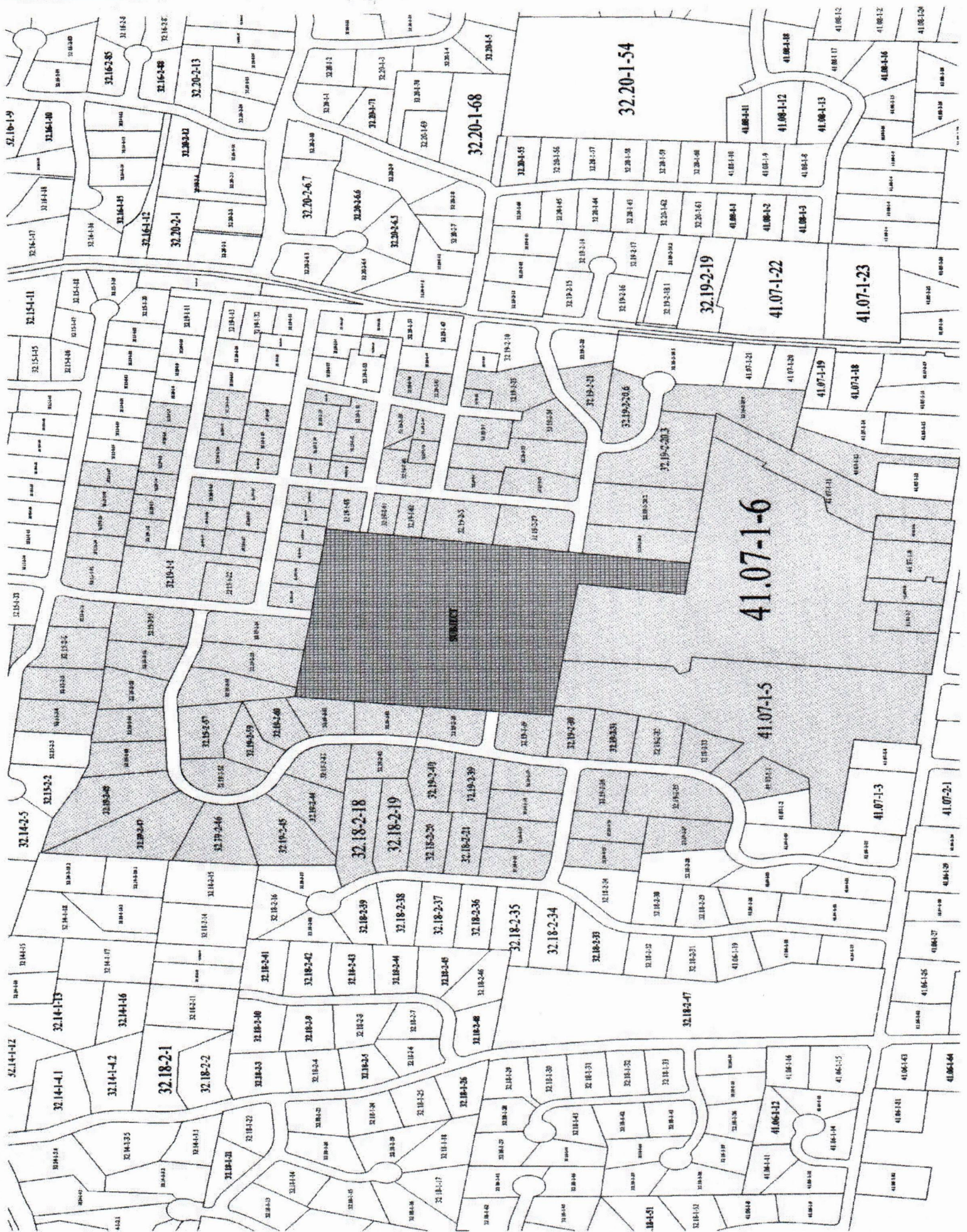



11/41.07-1-1  
ZIVARI BEHROOZ & SOHAYLA  
S  
7 POWDER HORN DR  
SUFFERN, NY 10901

11/41.07-1-10  
BERKOWITZ JEROME &  
MARALYN  
25 LIME KILN RD  
SUFFERN, NY 10901

11/41.07-1-13  
STEINER DAVID A & LANA  
19 LIME KILN RD  
SUFFERN, NY 10901

11/32.19-2-20.4  
ROZENBERG KENNETH & BETH  
3 HUNTERS RUN  
SUFFERN, NY 10901

11/32.19-2-35  
BELSKY FRANCES  
12 POWDER HORN DR  
SUFFERN, NY 10901

11/32.19-2-31  
KIGLER MARVIN J & IRENE G  
17 POWDER HORN DR  
SUFFERN, NY 10901

11/32.19-2-36  
BENDRIHEM YOSEF &  
SHOSHANA  
14 POWDER HORN DR  
SUFFERN, NY 10901

11/41.07-1-6  
CNTRL SCHL DSTRIC NO  
245-302 OF THE TOWNS OF R  
105 SO MADISON AV  
SPRING VALLEY, NY 10977

11/32.19-2-30  
WAITMAN ROBERT M &  
PRINCE SHIRA  
19 POWDER HORN DR  
SUFFERN, NY 10901

11/32.19-2-29  
JILLEBA FREDERICK &  
UGHETTA  
21 POWDER HORN DR  
SUFFERN, NY 10901

11/32.18-2-19  
KERN FAMILY 2020 TRUST  
20 ROBLE RD  
WESLEY HILLS, NY 10901

11/41.07-1-9  
STREICHER NAOMI  
PO BOX 343  
POMONA, NY 10970

11/41.07-1-11  
WESLEY HILLS SYNAGOGUE  
C/O J. CHESIR  
23 LIME KILN RD  
SUFFERN, NY 10901

11/32.18-2-27  
ZAKARIN HERBERT & HANNA  
8 POWDER HORN DR  
SUFFERN, NY 10901

11/32.19-2-20.6  
KAHAN ELLIOT & ATARA  
REVOCABLE LIVING TRUSTS  
2 HUNTERS RUN  
SUFFERN, NY 10901

11/32.19-2-20.2  
LEMPER ESTHER  
11 ROCKWOOD LN  
SUFFERN, NY 10901

11/32.18-2-26  
BOUSKILA ARIEL & CHAYA  
1 MARISA DR  
SPRING VALLEY, NY 10977

11/32.19-2-21  
FETMAN JESSICA &  
SHERMAN RALPH & SUSAN  
26 CORTLAND RD  
MONSEY, NY 10952

11/32.19-2-24  
ZOLDAN SHIRA  
6 ROCKWOOD LA  
SUFFERN, NY 10901

11/32.19-2-27  
AWE LEGACY TRUST  
12 ROCKWOOD LA  
SUFFERN, NY 10901

11/41.07-1-7  
HATZLUCHA BRUCHA 31 LLC  
1145 45TH STREET  
BROOKLYN, NY 11219

11/41.07-1-8  
REZNIK DAVID & HELENE  
29 LIME KILN RD  
SUFFERN, NY 10901

11/32.19-2-33  
COHEN AARON M & GOLDA R  
9 POWDER HORN DR  
SUFFERN, NY 10901

11/32.19-2-32  
ADAMS MITRA & ZIVARI  
SOHAYLA S  
11 POWDER HORN DR  
SUFFERN, NY 10901

11/32.19-2-20.3  
HAGLER DARYL  
1 HUNTERS RUN  
SUFFERN, NY 10901

11/32.19-2-20.1  
GROSS JONATHAN E  
15 ROCKWOOD LN  
SUFFERN, NY 10901

11/32.18-2-25  
LEVIN SETH A & MARLA T  
6 ARI DR  
SUFFERN, NY 10901

11/41.07-1-5  
WESLEY HILLS VILLAGE OF  
432 ROUTE 306  
MONSEY, NY 10952

11/32.19-2-26  
10 ROCKWOOD HOLDINGS LLC  
C/O KELMAN LEVI  
18 SKYLARK DRIVE  
SPRING VALLEY, NY 10977

11/32.19-2-37  
CHESIR JOSHUA & FRANCINE  
16 POWDER HORN DR  
SUFFERN, NY 10901



11/32.19-2-38  
RATZKER GARY & ARLENE  
3 ARI DR  
SUFFERN, NY 10901

11/32.19-2-23  
HYMAN SIMCHA & RACHEL  
4 ROCKWOOD LANE  
SUFFERN, NY 10901

11/32.19-2-25  
SCHRIER JEANY  
8 ROCKWOOD LN  
SUFFERN, NY 10901

11/32.18-2-21  
ADLER MARK & JEAN  
16 ROBLE RD  
SUFFERN, NY 10901

11/32.19-2-28  
KUNSTLINGER DANIEL &  
WEISSMAN REBECCA  
23 POWDER HORN DR  
WESLEY HILLS, NY 10901

11/32.18-2-20  
FRIEDMAN SANDRA & JACOB  
18 ROBLE RD  
SUFFERN, NY 10901

11/32.19-1-58  
DAVID STEINER  
3 SERVEN RD  
WESLEY HILLS, NY 10901

11/32.19-1-59  
SIEGEL JEFFREY & KIM  
4 SERVEN RD  
SUFFERN, NY 10901

11/32.19-1-52  
ROTH RYAN & RIVKA  
8 CHRISTMAS HILL RD  
AIRMONT, NY 10952

11/32.19-1-50  
HALPERT SHMUEL & AVIVA  
2 CAINS RD  
SUFFERN, NY 10901

11/32.18-2-23  
TYH THE ARI LLC  
C/O APFEL STEVEN  
5 ARI DR  
SUFFERN, NY 10901

11/32.19-2-8  
MC NAMARA JOSEPH E &  
DOROTHY M  
9 POMONA RD  
SUFFERN, NY 10901

11/32.19-2-39  
OLLECH MARCEL & BARBARA L  
18 POWDER HORN DR  
SUFFERN, NY 10901

11/32.19-2-5  
JUNGREIS DAVID  
9 CAINS RD  
SUFFERN, NY 10901

11/32.19-1-63  
FIRST NATHANEL &  
KATZ CHAYA  
4 OLD POMONA RD  
WESLEY HILLS, NY 10901

11/32.19-1-61  
SANDOVAL PABLO & YESVELI  
ROXANNA  
5 CAINS RD  
SUFFERN, NY 10901

11/32.19-1-62  
ORLANSKY AVROHOM &  
HOFFMAN SHIRA  
7 CAINS RD  
SUFFERN, NY 10901

11/32.19-1-60  
FOGEL MOSHE & CYNTHIA  
4 CAINS RD  
SUFFERN, NY 10901

11/32.18-2-18  
WASSERMAN NEAL I &  
ELEANOR N  
22 ROBLE RD  
SUFFERN, NY 10901

11/32.19-1-49  
HALPERT SHMUEL & AVIVA  
2 CAINS RD  
SUFFERN, NY 10901

11/32.18-2-22  
LEVIN-WALDMAN OREN &  
RENEE  
14 ROBLE RD  
SUFFERN, NY 10901

11/32.19-2-7  
ARM MAIER  
7 POMONA RD  
SUFFERN, NY 10901

11/32.19-2-6  
WEIL NATHANIEL REV LIVING  
TRUST, THE  
571 CYPRESS AVE  
LOS ANGELES, CA 90065

11/32.19-1-65  
LIEBOWITZ ELIAS & SARA  
1 SERVEN RD  
SUFFERN, NY 10901

11/32.19-2-40  
KOTCH BRETT & EVA  
REVOCABLE TRUST  
20 POWDER HORN DR  
SUFFERN, NY 10901

11/32.19-2-62  
SCHEINFELD MEIR &  
STERN ALISA  
536 ROUTE 306  
MONSEY, NY 10952

11/32.19-1-64  
FRIEDMAN ALEX & NECHAMA S  
6 OLD POMONA RD  
SUFFERN, NY 10901

11/32.19-2-42  
COHEN LEVY SUSAN DIANE  
LEGACY TRUST  
24 POWDER HORN DR  
WESLEY HILLS, NY 10901

11/32.19-1-51  
MAKOWSKY PHILIP A  
& SARA M  
72 EDISON CT  
MONSEY, NY 10952

11/32.19-1-48  
ROZENBERG KENNETH  
3 CAINS RD  
SUFFERN, NY 10901



11/32.19-1-38  
SHMUL OHAD  
10 SERVEN RD  
SUFFERN, NY 10901

11/32.19-1-40  
DARSHAN NAVEENA & PAMELA  
12 BUENA VISTA RD  
SUFFERN, NY 10901

11/32.19-2-61  
YANIV DANIEL & RAIZEL  
27 POWDER HORN DR  
SUFFERN, NY 10901

11/32.19-1-44  
ZOLDAN DAVID  
65 CARTERET ST  
WEST ORANGE, NJ 07052

11/32.19-1-47  
WEG LEGACY TRUST  
26 BUENA VISTA RD  
SUFFERN, NY 10901

11/32.19-2-60  
SPITZ ABRAHAM  
& RACHEL  
29 POWDER HORN DR  
WESLEY HILLS, NY 10901

11/32.19-1-26  
KAHANA PINCHAS & HALPERT  
CHANA  
15 BUENA VISTA RD  
SUFFERN, NY 10901

11/32.19-2-59  
BEACON SEVEN INC  
C/O ROSENBERG SUSAN  
130 ROUTE 59  
SPRING VALLEY, NY 10977

11/32.19-2-54  
REICHMANN MARC & TOVAH  
MIRYAM TZIPPORAH  
47 POWDER HORN LN  
SUFFERN, NY 10901

11/32.19-1-18  
OSEN JANET  
12 ONDERDONK RD  
SUFFERN, NY 10901

11/32.19-1-39  
ABEL MICHAEL B &  
LISA S  
10 BUENA VISTA RD  
SUFFERN, NY 10901

11/32.19-1-41  
MANN ELIEZER M &  
BAKER ZEHAVA  
14 BUENA VISTA ROAD  
SUFFERN, NY 10901

11/32.19-2-43  
26 POWDERHORN DRIVE  
REVOCABLE TRUST  
26 POWDER HORN LN  
SUFFERN, NY 10901

11/32.19-1-45  
KOHN SHOSHANA  
22 BUENA VISTA RD  
WESLEY HILLS, NY 10901

11/32.19-2-44  
HOLZBERG BASYA & RONALD  
PO BOX 500  
MONTVALE, NJ 07645

11/32.19-1-27  
KAHAN MORDECHAI &  
KAHANA CHAYA  
13 BUENA VISTA ROAD  
WESLEY HILLS, NY 10901

11/32.19-1-25  
KLEIN JACK W & PAULINE  
17 BUENA VISTA RD  
SUFFERN, NY 10901

11/32.19-1-23  
JACOBSON BARBARA & JONAH  
21 BUENA VISTA RD  
SUFFERN, NY 10901

11/32.19-1-17  
MATOS CADMO B & FLOR M  
10 ONDERDONK RD  
SUFFERN, NY 10901

11/32.19-2-55  
FLORANS MOSHE &  
TSINMAN FEIGA  
45 POWDER HORN DR  
SUFFERN, NY 10901

11/32.19-2-4  
DAHAN NEIL SHAI &  
ALEXANDER HEDVA Y  
24 SCENIC DR  
SUFFERN, NY 10901

11/32.19-1-42  
SHTAYGRUD YEHUDAH &  
FUCHS HINDY MIRIAM  
1 CAINS RD  
SUFFERN, NY 10901

11/32.19-1-43  
GOLDBERGER SHARON  
18 BUENA VISTA RD  
SUFFERN, NY 10901

11/32.19-1-46  
GROSS FAIGY  
1448 50TH ST  
BROOKLYN, NY 11219

11/32.19-1-28  
SHUCHT DAVID & BEN-DOV  
ESTER  
11 BUENA VISTA RD  
SUFFERN, NY 10901

11/32.19-2-45  
POWDER HORN DEVELOPMENT  
LLC  
SUITE 339  
46 MAIN ST  
MONSEY, NY 10952  
11/32.19-1-24  
SOSOVER MOSHE  
6654 SELFRIDGE ST  
FOREST HILLS, NY 11375

11/32.19-1-16  
GROLL JANICE G  
8 ONDERDONK RD  
SUFFERN, NY 10901

11/32.19-1-22  
WEISSBERG BELINDA  
23 BUENA VISTA RD  
SUFFERN, NY 10901

11/32.19-1-19  
HEFFLER MARK & MARY  
14 ONDERDONK RD  
SUFFERN, NY 10901



11/32.19-1-20  
KERZNER JOSEPH A  
& LICHTER RACHEL M  
16 ONDERDONK RD  
WESLEY HILLS, NY 10901

11/32.19-2-57  
41 POWDERHORN LLC  
41 POWDERHORN LLC  
SUFFERN, NY 10901

11/32.19-1-7  
NENNER MARK & SIMONE  
9 ONDERDONK RD  
SUFFERN, NY 10901

11/32.19-1-4  
BLISKO YAAKOV &  
SPITZ ESTHER  
17 ONDERDONK RD  
SUFFERN, NY 10901

11/32.19-1-1  
25 ONDERDONK LLC  
527 MARCY AVE  
BROOKLYN, NY 11206

11/32.19-2-51  
SHAPIRO HADASSAH  
44 POWDER HORN DR  
SUFFERN, NY 10901

09/32.15-1-27  
SPITZ JOEL M & MIRIAM  
18 SCENIC DRIVE  
SUFFERN, NY 10901

09/32.15-1-30  
DAHAN NEIL S &  
ALEXANDER-DAHAN HEDVA  
24 SCENIC DR  
SUFFERN, NY 10901

11/32.19-2-47  
POWDER HORN DEVELOPMENT  
LLC  
46 MAIN STREET #339  
MONSEY, NY 10952

89/32.15-2-5  
SCENIC DRIVE QUALIFIED  
PERSONAL ESIDENCE TRUST  
30 SCENIC DR  
SUFFERN, NY 10901

11/32.19-2-58  
CAREN MARK S & VANESSA B  
33 POWDER HORN DR  
SUFFERN, NY 10901

11/32.19-2-56  
HURWITZ CHAYA BRACHA  
43 POWDERHORN DR  
WESLEY HILLS, NY 10977

11/32.19-1-6  
HOFFMAN MORDECHAI S  
11 ONDERDONK RD  
SUFFERN, NY 10901

11/32.19-1-3  
KAUFMAN ELIYAHU & BINA  
19 ONDERDONK RD  
SUFFERN, NY 10901

11/32.19-2-53  
RATNER JOSHUA S & AMY R &  
RATNER ROBERT & CAMILLE  
48 POWDER HORN DR  
SUFFERN, NY 10901

11/32.19-2-50  
SCHOCHET CHAIM & SARAH  
42 POWDER HORN DR  
WESLEY HILL, NY 10901

09/32.15-1-28  
ERBLICH YOSEF & ESTHER  
KAGAN  
20 SCENIC DR  
SUFFERN, NY 10901

09/32.15-1-31  
SILVERBERG YEHOASHUA &  
DEBRA  
26 SCENIC DR  
SUFFERN, NY 10901

11/32.19-2-48  
WEINBERGER STUART &  
HADASSAH  
38 POWDER HORN LN  
SUFFERN, NY 10901

89/32.15-2-4  
ROUTE 304 DEVELOPMENT INC  
C/O MILTON SHAPIRO  
75 N MIDDLETOWN RD  
NANUET, NY 10954

11/32.19-1-21  
GUZELGUL MICHAEL &  
TROPPER NECHOMA GILA  
53 EDISON COURT  
MONSEY, NY 10952

11/32.19-2-46  
POWDER HORN DEVELOPMENT  
LLC  
SUITE 339  
46 MAIN ST  
MONSEY, NY 10952  
11/32.19-1-5  
TANG KATHY &  
ACOSTA HARRY  
15 ONDERDONK RD  
SUFFERN, NY 10901

11/32.19-1-2  
ONDERDONK 21 LLC  
C/O LAUFER ISSAC  
120 STRAWBERRY LANE  
NEWBURGH, NY 12550

11/32.19-2-52  
LIPOFF LAWRENCE & LAUREN  
46 POWDER HORN LN  
SUFFERN, NY 10901

11/32.19-2-49  
HEINEMANN SAMUEL &  
CHASIDA  
40 POWDER HORN LN  
SUFFERN, NY 10901

09/32.15-1-29  
TAPPER NISSON &  
RUBINSTEIN GOLDIE  
40 POWDER HORN DR  
SUFFERN, NY 10901

09/32.15-1-32  
SHEINKOPF ADINA & GOLOMB  
MICHAEL  
27 HIDDEN VALLEY DR  
SUFFERN, NY 10901

89/32.15-2-6  
MERMELSTEIN JOSHUA &  
BETH S  
28 SCENIC DR  
SUFFERN, NY 10901