

## ADDENDUM #1

**Date:** 09-05-2024

**Subject:** 2024 Safety Enhancement Program Pre-Bid Meeting

### Part 1

Pre-bid meeting minutes are attached.

### Part 2

Construction plan sheets listed below have been revised due to modifying a digital speed sign location and adding a fourth location:

- C0.02 – Revised special specification notes for “Install Provided Digital Speed Signs”
- C2.00 – Revised digital speed sign locations
- C2.09 – Revised digital speed sign locations

Bid tab has been revised accordingly per the above listed plan revisions to remove Item 644-6068 for relocating a sign.

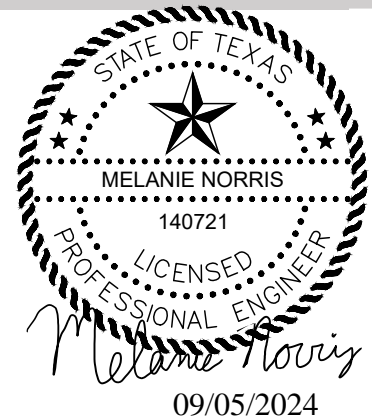

## MEETING AGENDA

**Date:** 09-04-2024

**Subject:** 2024 Safety Enhancement Program Pre-Bid Meeting

**Agenda below:**

1. Owner's Representatives – City of Woodcreek, Freeland Turk Engineering Group
  - a. City – Jim Burton, City Administrator
  - b. FTEG – Melanie Norris, PE – Owners Rep, PM, EOR
  - c. FTEG – Tom Turk, PE – Owners Rep
  
2. Project Documents
  - a. Found on [www.civcastusa.com](http://www.civcastusa.com) and include:
    - i. Project Manual
    - ii. Plans – 2024 Safety Enhancement Program
    - iii. Bid Form
      1. Click the green “Bid” tab to export bid form
  
3. Project Introduction
  - a. Project locations include various streets within the City of Woodcreek City Limits (See plan sheet C2.00):
    - i. Augusta Drive
    - ii. Brookhollow Drive
    - iii. Brookmeadow Drive
    - iv. Deerfield Drive
    - v. Shady Grove Lane
    - vi. Tremont Trace
    - vii. Woodcreek Drive
  - b. Project includes:
    - i. Repairing asphalt driveways
    - ii. HMAC level-up and 2” overlay of Deerfield Dr
    - iii. Modifying ~28 lf of metal guardrail
    - iv. Installing 10 speed cushions at 5 locations
    - v. Various roadway signs including:
      1. Provide and install various small signs
      2. Install provided small signs (Locations TBD)

3. Install provided digital speed signs (Locations to be updated in addendum prior to bid)
            - vi. Pavement striping – stop bars and crosswalks
          - c. TxDOT Specifications (with some special specifications)
          - d. Special specifications to note (see plan sheet C0.1):
            - i. Hot-mix will be measured by the square yard and tack coat will be its subsidiary
            - ii. Level-up on Deerfield is special spec: “Blade Level-Up With Asphalt Concrete”
          - e. The work area is within City of Woodcreek owned property and ROW
          - f. Use caution with existing utilities within street
          - g. Please read notes within plans, contract documents and specifications
4. Bid
  - a. Basis of award – Base bid only - bids received online only through Civcast
  - b. Bid Opening September 25<sup>th</sup> 3pm – ONLINE bid, read publicly from City Hall
5. Contractor’s Construction Schedule
  - a. NTP – TBD
  - b. Substantial Completion = 90 days (plus 30 days final acceptance)
  - c. LDs - \$500/day
6. Questions and Answers
  - a. Basic questions only – please submit technical questions to [mnorris@freelandturk.com](mailto:mnorris@freelandturk.com)
  - b. Questions due by email 7 days prior to bid, questions received after that deadline may not be answered.

**CONSTRUCTION SPECIFICATIONS**

THE CONTRACTOR SHALL PERFORM ALL WORK AND CONSTRUCT THE IMPROVEMENTS PER TXDOT STANDARD SPECIFICATIONS FOR CONSTRUCTION AND MAINTENANCE OF HIGHWAYS, STREETS, AND BRIDGES (ADOPTED BY TXDOT NOVEMBER 1, 2014) AND ANY APPLICABLE SPECIAL PROVISIONS AND SPECIFICATIONS.

**ITEM 100 - PREPARING ROW**

THIS SPECIFICATION SHALL GOVERN AND INCLUDE THE PREPARATION OF THE PROJECT SITE FOR CONSTRUCTION.

**ITEM 105 - REMOVING TREATED AND UNTREATED BASE AND ASPHALT PAVEMENT**

THE CONTRACTOR SHALL REMOVE THE EXISTING ASPHALT AND BASE MATERIAL PER THE LIMITS SHOWN ON THE PLANS TO A DEPTH NO GREATER THAN THE EXISTING SUBGRADE. THE CONTRACTOR SHALL NOT STOCK PILE REMOVED MATERIALS AND SHALL HAUL OFF REMOVED MATERIALS IMMEDIATELY.

**ITEM 247 - FLEXIBLE BASE**

THE CONTRACTOR SHALL FURNISH AND INSTALL TYPE A, GRADE I-II FLEXIBLE BASE MATERIAL PER DEPTH SHOWN ON PLANS.

**ITEM 500 - MOBILIZATION**

**ITEM 502 - BARRICADES, SIGNS, AND TRAFFIC HANDLING**

THE CONTRACTOR SHALL MAINTAIN ONE-LANE TWO-WAY TRAFFIC USING FLAGGERS AT ALL TIMES DURING ACTIVE CONSTRUCTION AND WORKING HOURS. TWO-WAY TRAFFIC MUST BE MAINTAINED WHEN THE CONTRACTOR IS NOT ACTIVELY WORKING ON-SITE.

THE CONTRACTOR SHALL PROVIDE ADDITIONAL TRAFFIC CONTROL SIGNS AT ALL INTERSECTIONS TO IDENTIFY ROAD WORK AHEAD.

**ITEM 506 - TEMPORARY EROSION, SEDIMENTATION, AND WATER POLLUTION PREVENTION AND CONTROLS**

SEE PLANS.

**ITEM 644 - SMALL ROADSIDE SIGN ASSEMBLIES**

SEE PLANS.

**ITEM 666 - RETROREFLECTORIZED PAVEMENT MARKINGS**

TYPE II TRAFFIC PAINT SHALL BE INSTALLED AS A SEALER/BASE COAT BEFORE INSTALLING TYPE I HOT-APPLIED THERMOPLASTIC.

**SPECIAL SPECIFICATION 3076 - DENSE-GRADED HOT-MIX ASPHALT**

**HMAC SHALL BE INSTALLED WHERE INDICATED ON THE PLANS, VARIOUS DRIVEWAYS AND OVERLAY ON DEERFIELD DRIVE**

HMAC SHALL BE TYPE AND DEPTH AS SPECIFIED ON PLANS.

TACK COAT SHALL BE CBC-1H APPLIED AT A RATE OF 0.10 GAL/SY.

MODIFICATIONS ADDED TO SPECIFICATION ARE AS FOLLOWS:

PARAGRAPH 5

- 1. HOT MIX WILL BE MEASURED BY THE SQUARE YARD.

PARAGRAPH 6

- 1. PAYMENT WILL BE PAID FOR AT THE UNIT BID PRICE PER SQUARE YARD.
- 2. TACK COAT WILL BE SUBSIDIARY TO THIS ITEM.

**SPECIAL SPECIFICATION - INSTALL PROVIDED DIGITAL SPEED SIGNS**

SEE PLAN SHEETS FOR LOCATIONS. THE GOVERNING SPECIFICATION FOR THIS ITEM IS TXDOT ITEM 644 - SMALL ROADSIDE SIGN ASSEMBLIES.

THE CITY OF WOODCREEK WILL PROVIDE THE SOLAR POWERED DIGITAL SPEED SIGNS. THE CONTRACTOR SHALL FULLY FURNISH ALL POSTS, HARDWARE, BASE ETC TO APPROPRIATELY MOUNT THE PROVIDED SIGNS.

**SPECIAL SPECIFICATION - INSTALL PROVIDED SIGNS**

THE CITY OF WOODCREEK HAS VARIOUS SMALL SIGNS TO BE INSTALLED, LOCATIONS WILL BE DETERMINED DURING CONSTRUCTION. THE GOVERNING SPECIFICATION FOR THIS ITEM IS TXDOT ITEM 644 - SMALL ROADSIDE SIGN ASSEMBLIES.

THE CITY OF WOODCREEK WILL PROVIDE VARIOUS SMALL SIGNS. THE CONTRACTOR SHALL FULLY FURNISH ALL POSTS, HARDWARE, BASE ETC. TO APPROPRIATELY MOUNT THE PROVIDED SIGNS.

**SPECIAL SPECIFICATION - GUARDRAIL MODIFICATION**

SEE PLANS. THE GOVERNING SPECIFICATIONS FOR THIS WORK ARE LISTED BELOW:  
TXDOT ITEM 540 - METAL BEAM GUARD FENCE  
TXDOT ITEM 542 - REMOVING METAL BEAM GUARD FENCE

ALL WORK INCLUDING REMOVING THE EXISTING GUARD FENCE, PORTABLE RESTROOM RELOCATION, AND INSTALLATION SHALL BE SUBSIDIARY TO THIS ITEM. THIS WORK WILL BE PAID BY THE LUMP SUM, AND WILL INCLUDE ALL NECESSARY WORK FOR FINAL COMPLETION.

**SPECIAL SPECIFICATION - SPEED CUSHION**

COMPLETE IN PLACE TO INCLUDE ALL NECESSARY FURNISHINGS FOR INSTALLATION PER DETAIL INCLUDED IN PLANS AND MANUFACTURER INSTALLATION RECOMMENDATIONS. MARKING PATTERN IS TO BE SC-070603-M. THIS WORK WILL BE PAID BY EACH INDIVIDUAL SPEED CUSHION.

**SPECIAL SPECIFICATION - BLADE LEVEL-UP WITH ASPHALT CONCRETE**

SEE PLANS.

**SUBMITTALS**

THE CONTRACTOR SHALL PROVIDE SUBMITTALS TO THE ENGINEER FOR APPROVAL FOR ALL MATERIALS FOR ITEMS SPECIFIED.



18830 FORTY SIX PKWY, BLDG 2, STE B (830) 438-0329  
SPRING BRANCH, TX 76070  
TBPE FIRM F-21047



CITY OF WOODCREEK  
2024 SAFETY ENHANCEMENT PROGRAM  
GENERAL NOTES SHT 2

JOB:	154-102
DATE:	2024/09/03
DRAWN: TN	PM: MN
DESIGN:	DM:
PEER:	OTHER:

REVISIONS:	
DELTA	DESCRIPTION

SHEET:  
**C0.02**

Date: Sep 03, 2024, 9:32am User ID: shepp  
 File: Z:\eng - prof\1154 - city of woodcreek\1102 - to 3 - 2024 safety enhancement program - CAD.dwg 1154.102-ROUTE-PIN-001.dwg

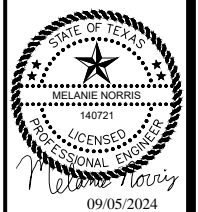
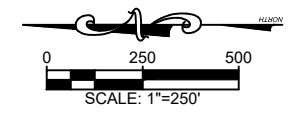
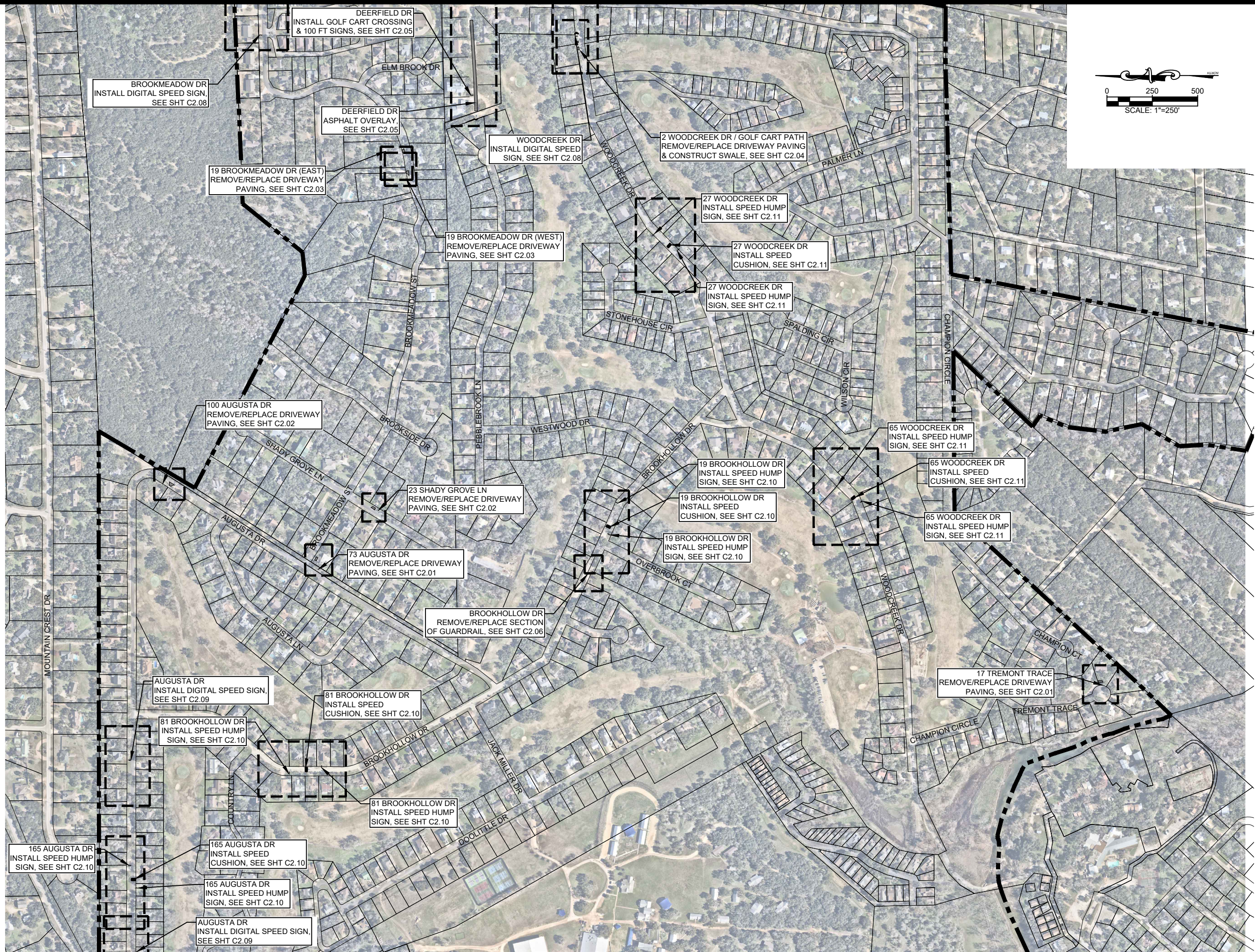

18830 FORTY SIX PKWY, BLDG 2, STE B (830) 438-0329  
 SPRING BRANCH, TX 78070 TBPE FIRM F-21047

CITY OF WOODCREEK  
 2024 SAFETY ENHANCEMENT PROGRAM  
**OVERALL (P)SITE PLAN**

JOB: 154-102	
DATE: 2024/09/03	
DRAWN: TN	PM: MN
DESIGN: DM	
PEER:	OTHER:
REVISIONS:	
DELTA	DESCRIPTION
SHEET:	<b>C2.00</b>

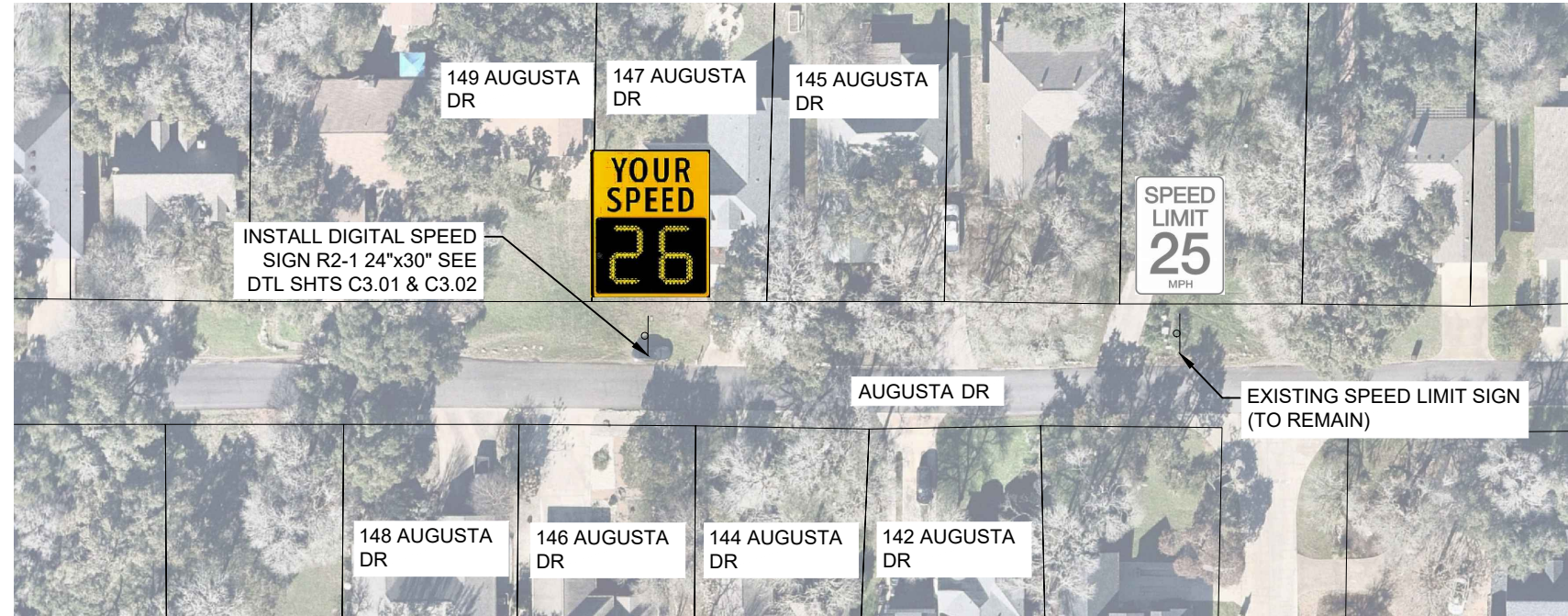

**NOTES:**

1. THE CONTRACTOR SHALL ASSEMBLE AND INSTALL SOLAR POWERED DIGITAL SPEED SIGNS PROVIDED BY THE CITY OF WOODCREEK.
2. THE CONTRACTOR SHALL FURNISH AND INSTALL THE POSTS AND PROVIDE REQUIRED MOUNTING HARDWARE AS NECESSARY FOR THE SOLAR POWERED DIGITAL SPEED SIGNS.
3. THE SIGN LOCATIONS ARE APPROXIMATE, CONTRACTOR SHALL PLACE SIGNS WHERE THEY WILL BE FULLY VISIBLE. CONTRACTOR TO NOTIFY ENGINEER OF ANY DISCREPANCIES. CONTRACTOR SHALL TRIM ANY TREE LIMBS OR SHRUBS THAT WILL BLOCK THE VIEW OF THE INSTALLED SIGNS AT NO ADDITIONAL COST.

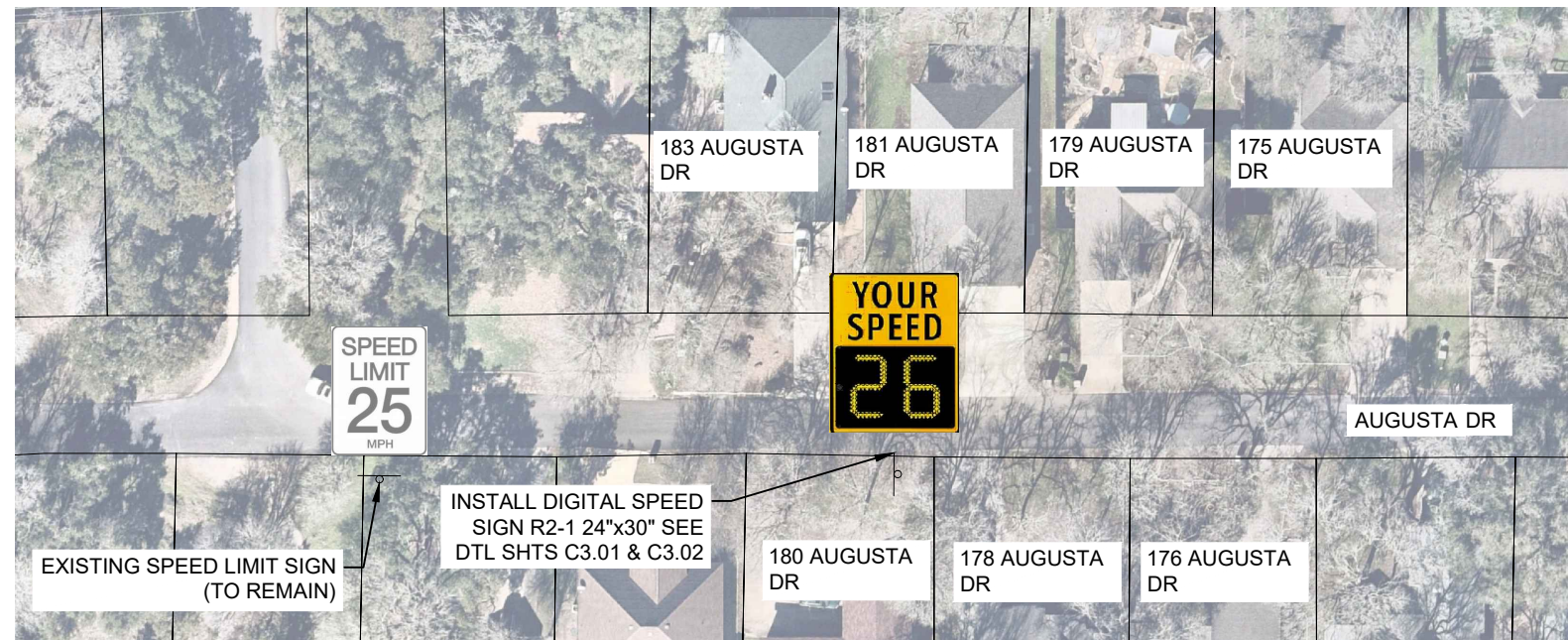

18830 FORTY SIX PKWY, BLDG 2, STE B (830) 438-0329  
 SPRING BRANCH, TX 76070  
 TBPE FIRM F-21047



CITY OF WOODCREEK  
 2024 SAFETY ENHANCEMENT PROGRAM  
**DIGITAL SPEED SIGN  
 LOCATIONS SHT 2**

JOB: 154-102	
DATE: 2024/09/05	
DRAWN: TN	PM: MN
DESIGN: DM	OTHER:
PEER:	OTHER:

REVISIONS:	
DELTA	DESCRIPTION

SHEET:  
**C2.09**