



Parks and Recreation Report | November 2021

Directors Report:

The parks team has been busy installing holiday lights to celebrate the season and add beauty to some of our parks during the shorter days that winter brings.

New this year, the lights at Town Center Park accompany a winter themed and family friendly Storywalk, "Ten Ways to Hear Snow" by Cathy Camper. Other programs that have kicked off our 2021 Winterfest include our annual Toy Drive and Senior Stockings. We are especially grateful this time of year to have the privilege of serving such a generous, giving community.

-Kris Ammerman



Recreation Updates:

Wilsonville Winterfest:

The annual Wilsonville Winterfest kicked off just after the Thanksgiving Holiday with a Hunt for the Gingerbread Family Scavenger Hunt, a Letters to Santa Station, and the toy drive. Participants have until December 17 to write their letter to Santa and drop it in the big red mailbox at the Parks and Rec Admin Office in order to get a reply letter from Santa to their home. The annual toy drive runs through December 8, with both Wilsonville Subaru and Wilsonville Orthodontics as additional toy drop off locations during regular business hours.

The Hunt for the Gingerbread family has proven to be a big hit again this year, with many families already entering the drawing. A total of 8 gingerbread people are hidden throughout the City. Clues posted to Wilsonville Parks and Rec Social media hint to their locations. Participants need to take a picture of at least 5 of the gingerbread and they are entered into a drawing for a \$100 REI gift card. Three winners will be chosen on Monday, December 20.

The Obaldia Family, who took part in the scavenger hunt over the weekend of December 4 wrote in an email, "Happy holidays from the de Obaldia family! We had so much fun doing the scavenger hunt together today! Thank you to whoever put this together. It was truly an adventure looking around Wilsonville and the kids were just so proud and excited every time they found a Gingerbread person! Hope this is something we can look forward to every year. Thanks for creating these memories for our family!!"



Families have through Sunday, December 19 to take part in the hunt for the gingerbread family. A list of clues may be found at WilsonvilleParksandRec.com/Winterfest



Upcoming Virtual Event:

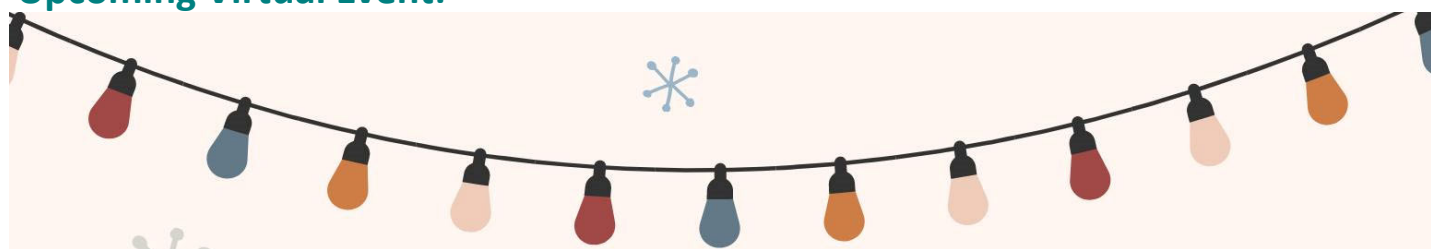

VIRTUAL CRAFT
NATURAL ORNAMENTS

DECEMBER 12 10AM FACEBOOK LIVE

SUPPLIES LIST

- Twine, String or Floral Wire
- Scissors
- Natural Greenery like Rosemary, Holly, Lavender, or Pine Foliage
- Dried Orange
- Cinnamon Sticks or Twigs
- Hot Glue Gun and Hot Glue Sticks



CNVFILLM FF1



Parks & Rec 2021



Community Center Updates:

Indoor Fitness Classes Resume:

November brought the long awaited return of one of the Community Center's most popular fitness classes. Healthy Bones and Balance, taught by Fitness Specialist Brad More, returned to the Community Center for the first time since March 2020. The two sessions of the class each filled with 16 participants and both had a waitlist. The total capacity for the class was reduced from its usual 20+ in an effort to give participants more room to spread out and maneuver. Additionally, Community Center staff was able to secure the services of a new Tai Chi Instructor following the retirement of the Center's long-tenured instructor. Two levels of Tai Chi classes will return to the Community Center in January.

Piecemakers Placemats:

The Wilsonville Piecemakers, a Parks and Recreation Department supported quilting group, recently made holiday placemats for the Community Center's Home Delivered Meal Clients. With help from SMART drivers, the placemats were delivered to home-bound seniors during the month of November.



ID Theft & Scams and Fall Prevention lectures a success:

The Community Center welcomed Officer Sara McClurg and Officer Julie Fanger from the Clackamas County Sheriff's Office as they presented a free lecture on ID Theft and Scams. Attendees were made aware of current scams, the tactics thieves use, and how to keep themselves safe. Also in November, Dr. Dave Duemling of Family Chiropractic and NW Wellness Center presented a fall prevention workshop. The workshop helped attendees to determine their risk of falling through a personal risk assessment and gave those in attendance a toolbox of strength and mobility building exercises.

Korean War Memorial Interpretive Center design moves forward:

The design committee met with Formations to review the 50% design plans. The committee was generally in agreement and happy with the elements presented. Small revisions and additions are being sent back to Formations for integration into a future "final" design. (See design on next page)



EX05

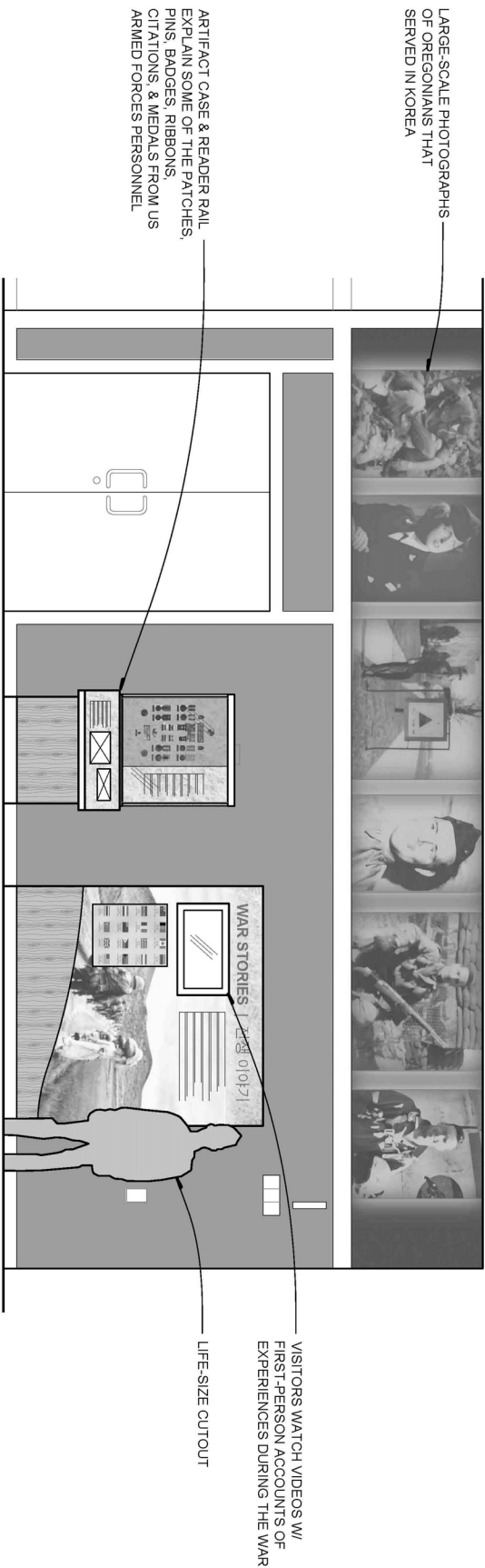

1 ELEVATION @ EX02: OREGONIANS IN KOREA & EX05: OREGONIAN VETERANS FRIEZE
SCALE: 3/8" = 1'-0"

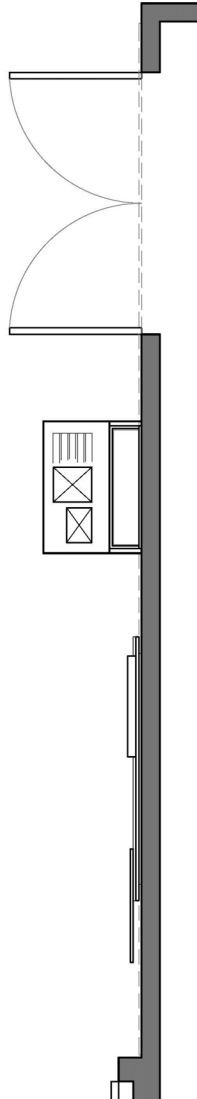

2 PLAN @ EX02: OREGONIANS IN KOREA & EX05: OREGONIAN VETERANS FRIEZE
SCALE: 3/8" = 1'-0"

COPYRIGHT WARNING
THIS DRAWING IS THE PROPERTY OF FORMATIONS INC. WITHOUT WHOSE CONSENT IT MAY NOT BE REPRODUCED OR TRANSMITTED IN ANY FORM OR BY ANY MEANS, ELECTRONIC OR MECHANICAL, INCLUDING PHOTOCOPYING, RECORDING, OR BY ANY INFORMATION STORAGE AND RETRIEVAL SYSTEM. ORIGINAL DRAWING IS 11x17. SCALE ACCORDING TO REDUCED.

FORMATIONS
EXHIBITS + GRAPHICS + TECHNOLOGY

821 SE 322nd Ave
Portland, OR 97214
503.666.7110 main
503.666.7188 fax

DESIGNER: CJ
DRAWN BY: JMP

PROJECT: OREGON KOREAN WAR MEMORIAL INTERPRETIVE CENTER

TITLE: PLAN & ELEVATION @ EX02: OREGONIANS IN KOREA EX05: OREGONIAN VETERANS FRIEZE

JOB NO.: 656
PHASE: 2A CONCEPT DESIGN 50%

ISSUE DATE: 11.22.21

REVISIONS: SHEET: 03

Board Highlights

Kitakata Sister City Advisory Board: The Kitakata Sister City Advisory Board met in November to discuss a number of upcoming plans for programs and events including Cherry Blossom Week in early April and a tea ceremony class in 2022. The board also discussed partnering with local organizations such as Sake One and the Japanese American Society of Oregon to run programs that highlight the sister city relationship. The board will meet virtually with Kitakata, Japan on December 8 to discuss a near future pen-pal program.

Other General Updates:

Winter/Spring 2022 Registration Opens December 13

The Winter/Spring Activity Guide is complete, and registration begins on December 13! This activity guide covers rental opportunities, special events, no-school day programs, exercise classes and more! New this year are a series of green workshops taught by our very own Parks Maintenance Specialist, Chris Delk, as well as, a series of Sound Bath Meditation classes taught by a new instructor, Melanie Meherin.

Nature Play Grand Opening

The Parks team held a wonderful Grand Opening Ceremony for the completion of the Nature Play area in Memorial Park this month. The team provided free apple cider and donuts and invited community members, staff, and council members to join in a ribbon cutting ceremony. Several families and their kids turned out for the event, which provided staff a great opportunity to take some wonderful photos— check out the cover of our newest activity guide!

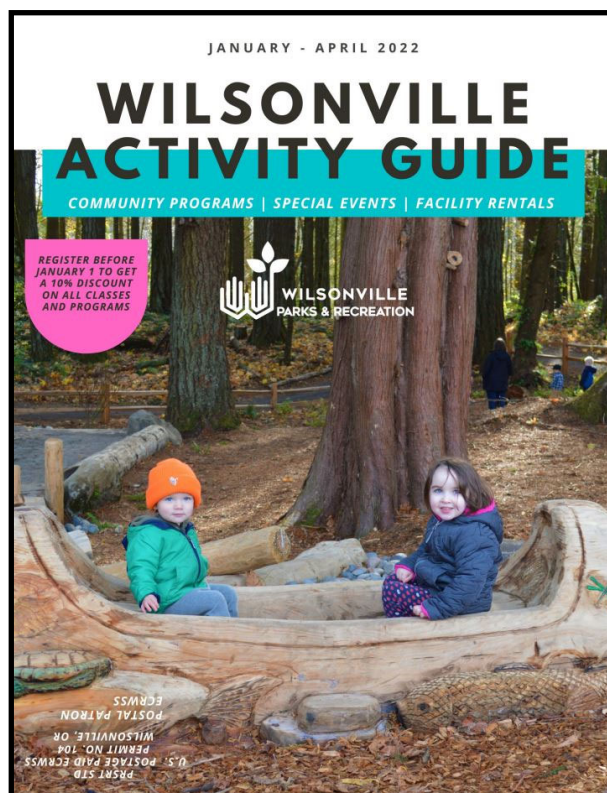

Parks Team

Wilsonville Winterfest Lights

The Parks team spent the month of November getting set up for the Wilsonville Winterfest Lights. This year the team worked to develop a new light display. The display this year was installed with a desire to create an inclusive and accessible holiday light display for the community. This year it took almost 150 team hours to complete the light installation in Town Center Park.



Shelter Preparations



Shelter Completed

Working With The Community

The Parks team has had the great privilege of working with Wilsonville High School's Adult Transition Services, over the last four months. Jose and Alex have worked alongside Chris Delk on landscaping projects in Memorial Park and Murase Plaza. Jose and Alex have been an excellent addition to our team, working three days a week for a three hours each day. Please join our team in thanking Jose and Alex for all of their help serving the community.



Prepping For The Project



Newly Planted Tree