

Equipment List For Areas Shown								
Pole				Luminaires				
QTY	LOCATION	SIZE	GRADE ELEVATION	ABOVE GRADE LEVEL	LUMINAIRE TYPE	QTY/POLE	THIS GRID	OTHER GRIDS
2	A5-A6	60'	-	59.7'	TLC-LED-1200	1	1	0
				59.7'	TLC-LED-900	2	2	0
				15.5'	TLC-BT-575	1	1	0
2	B5-B6	60'	-	59.7'	TLC-LED-1200	4	4	0
				15.5'	TLC-BT-575	1	1	0
				59.7'	TLC-LED-1200	3	3	0
2	C7-C8	60'	-	59.7'	TLC-LED-900	1	1	0
				59.7'	TLC-LED-1200	3	3	0
				15.5'	TLC-BT-575	1	1	0
6	Totals					28	28	0

*Above Grade level relative to the field

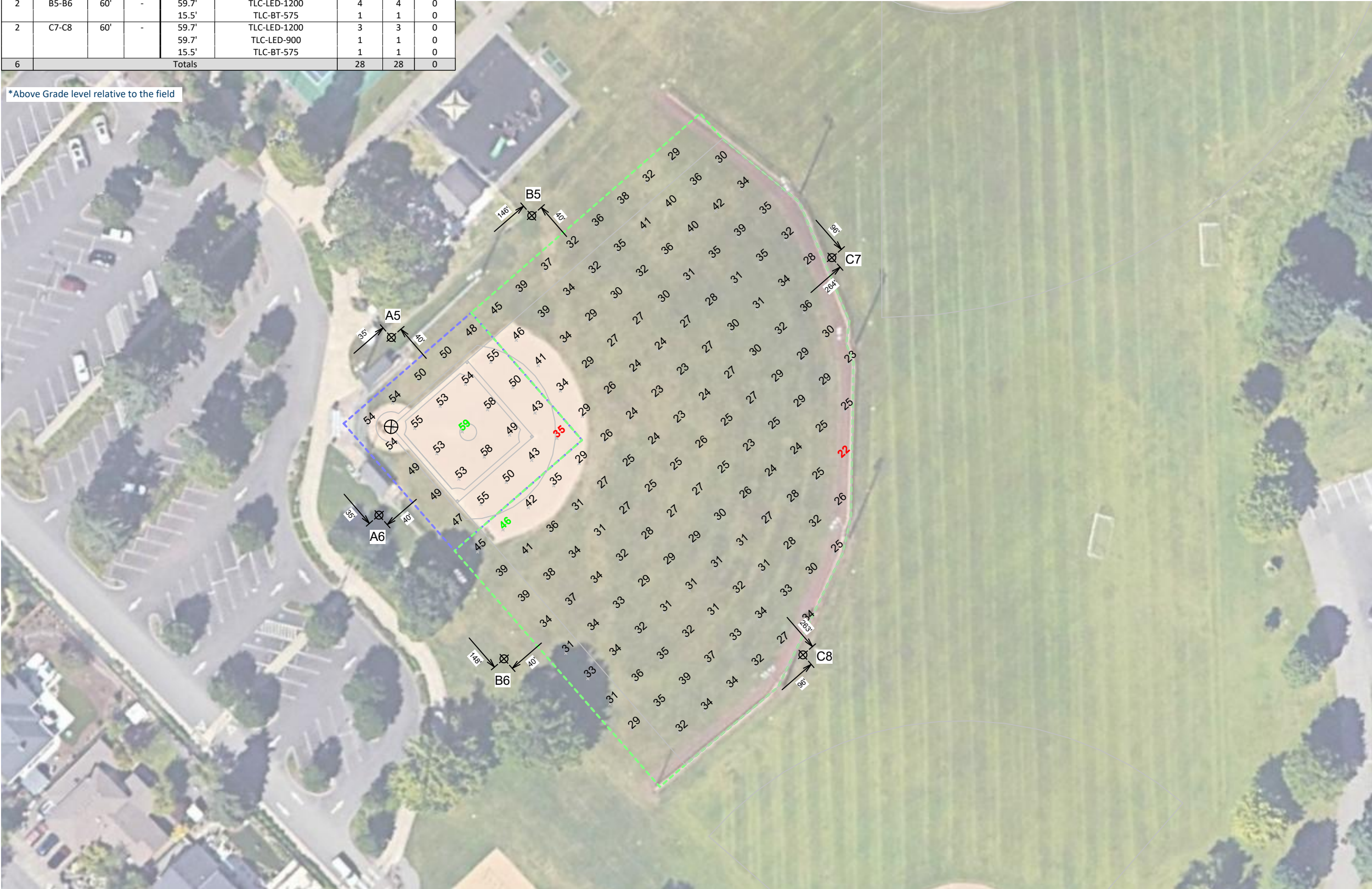

Memorial Park SB BB Field Relight

Wilsonville, OR

Grid Summary	
Name	Field #4
Size	Irregular 261'/275'/267'
Spacing	20.0' x 20.0'
Height	3.0' above grade

	MAINTAINED HORIZONTAL FOOTCANDLES	
	Infield	Outfield
Guaranteed Average	50	30
Scan Average	51.19	31.35
Maximum	59	46
Minimum	35	22
Avg/Min	1.44	1.46
Guaranteed Max/Min	2	2.5
Max/Min	1.68	2.13
UG (adjacent pts)	1.21	1.28
CU	0.70	
No. of Points	25	146
LUMINAIRE INFORMATION		
Applied Circuits	D	
No. of Luminaires	28	
Total Load	27.45 kW	

Guaranteed Performance: The ILLUMINATION described above is guaranteed per your Musco Warranty document and includes a 0.95 dirt depreciation factor.

Field Measurements: Individual field measurements may vary from computer-calculated predictions and should be taken in accordance with IESNA RP-6-15.

Electrical System Requirements: Refer to Amperage Draw Chart and/or the "Musco Control System Summary" for electrical sizing.

Installation Requirements: Results assume ± 3% nominal voltage at line side of the driver and structures located within 3 feet (1m) of design locations.

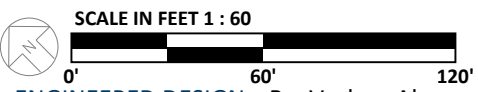

Pole location(s) ⊕ dimensions are relative to 0,0 reference point(s) ⊗



We Make It Happen.

Equipment List For Areas Shown								
Pole				Luminaires				
QTY	LOCATION	SIZE	GRADE ELEVATION	ABOVE GRADE LEVEL	LUMINAIRE TYPE	QTY/POLE	THIS GRID	OTHER GRIDS
2	A7-A8	60'	-	59.7'	TLC-LED-1200	1	1	0
				59.7'	TLC-LED-900	2	2	0
				15.5'	TLC-BT-575	1	1	0
2	B7-B8	70'	-	70.3'	TLC-LED-1500	4	4	0
				15.5'	TLC-BT-575	1	1	0
4	Totals					18	18	0

*Above Grade level relative to the field



Memorial Park SB BB Field Relight

Wilsonville, OR

Grid Summary	
Name	Field #5
Size	200'/200'/200' - basepath 60'
Spacing	20.0' x 20.0'
Height	3.0' above grade

	MAINTAINED HORIZONTAL FOOTCANDLES	
	Infield	Outfield
Guaranteed Average	50	30
Scan Average	51.31	33.69
Maximum	60	47
Minimum	40	20
Avg/Min	1.28	1.65
Guaranteed Max/Min	2	2.5
Max/Min	1.50	2.29
UG (adjacent pts)	1.19	1.24
CU	0.63	
No. of Points	25	73
LUMINAIRE INFORMATION		
Applied Circuits	E	
No. of Luminaires	18	
Total Load	19.44 kW	

Guaranteed Performance: The ILLUMINATION described above is guaranteed per your Musco Warranty document and includes a 0.95 dirt depreciation factor.

Field Measurements: Individual field measurements may vary from computer-calculated predictions and should be taken in accordance with IESNA RP-6-15.

Electrical System Requirements: Refer to Amperage Draw Chart and/or the "Musco Control System Summary" for electrical sizing.

Installation Requirements: Results assume ± 3% nominal voltage at line side of the driver and structures located within 3 feet (1m) of design locations.

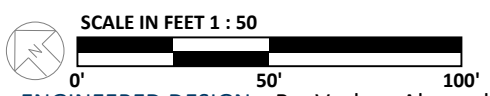

ENGINEERED DESIGN By: Vashon Alexander • File #228489B_R1 • 12-Jan-24

Pole location(s) ⊕ dimensions are relative to 0,0 reference point(s) ⊗



We Make It Happen.

Not to be reproduced in whole or part without the written consent of Musco Sports Lighting, LLC. ©1981, 2023 Musco Sports Lighting, LLC.

ILLUMINATION SUMMARY