

**APPLICATION FOR VARIANCE
WILLOWICK BOARD OF ZONING APPEALS**

NAME OF PROPERTY OWNER: Marty Connell

ADDRESS: 111 Larimar Dr.

PHONE: 614-507-0409

NAME OF APPLICANT
IF DIFFERENT FROM OWNER: _____

ADDRESS: _____

PHONE: _____

REASON AND JUSTIFICATION FOR REQUEST:

GENERATOR FUMES WOULD BLOW INTO LOWER LEVEL WHEN
PATIO DOOR IS OPEN.
TWO OTHER LARIMAR 3 STORY UNITS HAVE LOCATED THEIR
GENERATORS IN THE SAME PROPOSED LOCATION.

DATE: 5/12/25 SIGNED: Marty Connell
APPLICANT

APPLICANT

FOR OFFICE USE ONLY

CASE NO. 259

PROPERTY ZONED FOR
(STATE DISTRICT): Single family

APPLICABLE SECTION OF
CODIFIED ORDINANCES: 1167.01(c)(i)(ii)(iii)

VARIANCE SOUGHT: 1167.01(c)(i) - to place a generator in the side yard.
1167.01(c)(ii) - to place a generator 3' from side property line
or 29' from the rear property line.
1167.01(c)(i)(ii)(iii) - 6' to place a generator 9' from
neighbors residence

Pursuant to Section 1169.05(b) of the Codified Ordinances, a check in the amount of \$150.00 made payable to the City of Willowick, together with a drawing showing where the requested variance will be located and all measurements of same, must accompany this request for variance. All pertinent information must be submitted to the building department no later than 3 weeks prior to the meeting date, which is the second Wednesday of each month.

Meeting 6:30 pm 6-11-25 at 30435 Lakeshore Blvd. City Hall Council Chambers, 2nd floor

19-20-21

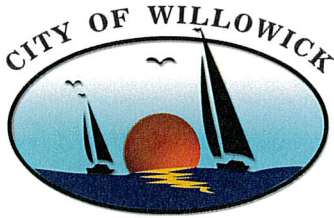

BUILDING DEPARTMENT

31230 VINE ST

WILLOWICK OH 44095

PHONE: 440-516-3000

FAX: 440-585-3776

EMAIL: sbrennan@cityofwillowick.com

Marty Connell

111 Larimar Dr

Willowick Oh 44095

RE: PERMIT APPLICATION AT: 111 Larimar Dr

DEAR SIR AND / OR MADAM:

THIS LETTER IS TO INFORM YOU THAT YOUR BUILDING PERMIT APPLICATION WAS DENIED FOR THE FOLLOWING REASON (S) :

1167.01 DEFINED; PERMITS; LOCATION; INSPECTION. (c) In a Single Family or Multi Family District no unit shall be installed, placed or set (i) within a side or front yard; (ii) determination of the number of feet within any side or rear lot line will be at the discretion of the Board of Zoning Appeals; (iii) within fifteen feet of any residence other than the one being served by such air conditioning unit.

Variances Needed : 1) To place a generator in the side yard.

2) To place a generator 3 feet from the side property line or 29 feet from the rear property line.

3) 6 foot to place a generator 9 feet from neighbors residence.

* Home owner wants install a generator in the side yard .

IF YOU WISH TO APPEAL THIS RULING, AN APPLICATION FOR THE BOARD OF ZONING APPEALS CAN BE OBTAINED AT THE WILLOWICK BUILDING DEPARTMENT. THE BOARD OF ZONING APPEALS MEETS THE SECOND WEDNESDAY OF EVERY MONTH AT CITY HALL, 30435 LAKE SHORE BLVD. , UPSTAIRS IN COUNCIL CHAMBERS AT 7:30 PM. APPLICATIONS MUST BE RECEIVED THREE (3) WEEKS PRIOR TO THE DATE OF THE MEETING.

IF YOU HAVE ANY QUESTIONS, PLEASE DO NOT HESITATE TO CONTACT ME.

SINCERELY,

SEAN BRENNAN

CHIEF HOUSING AND ZONING INSPECTOR

 5/21/25

APPLICANTS SIGNATURE DATE

Sketch

Parcel Number 28A043VCC00440

Parcel Owner: CONNELL MARTIN DANIEL TR

Parcel Address: 111 LARIMAR DR

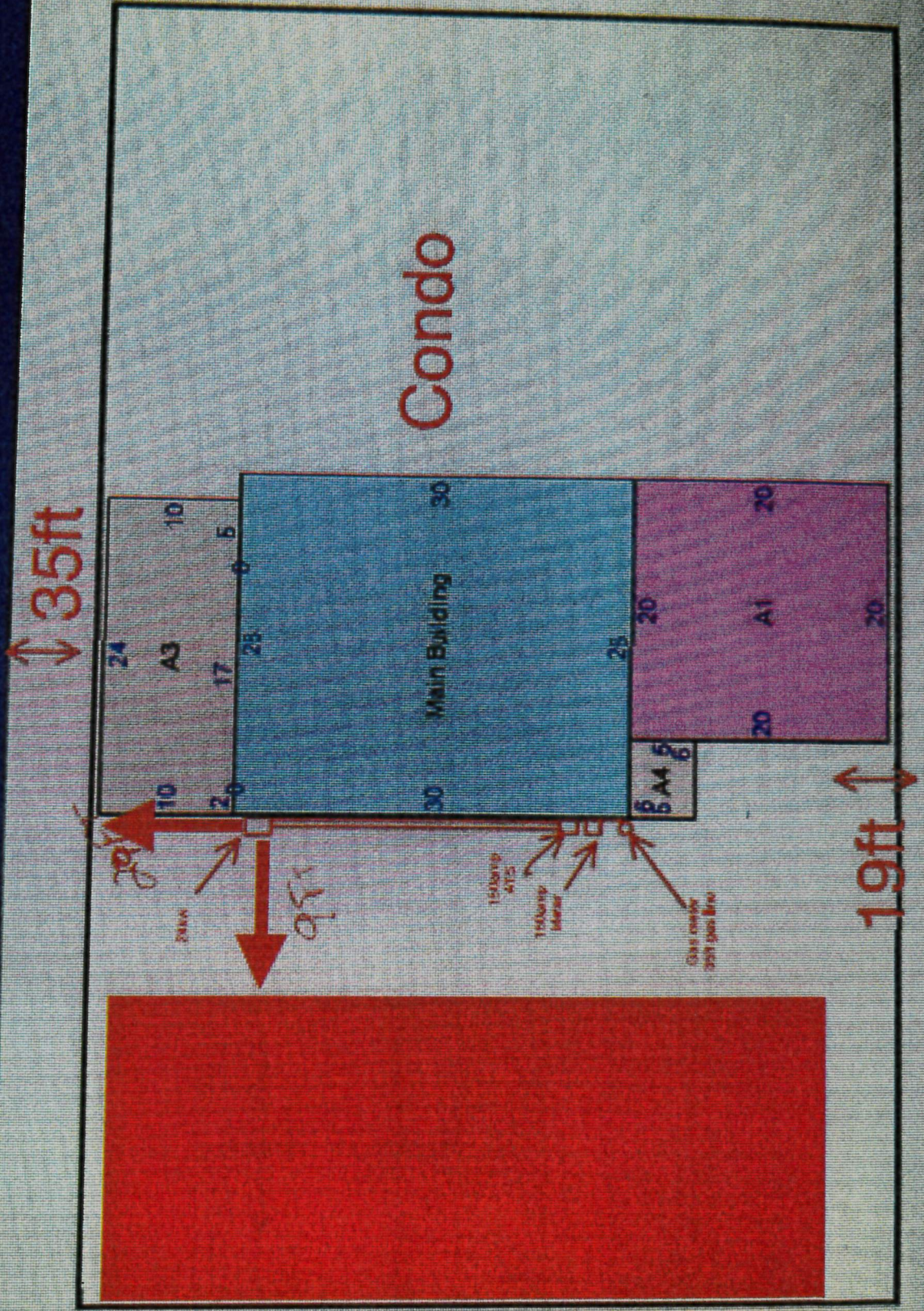

20/22/24 kW

GENERAC®

GUARDIAN® SERIES
Residential Standby Generators
Air-Cooled Gas Engine

20/22/24 kW

1 of 6

INCLUDES:

- True Power™ Electrical Technology
 - Two-line multilingual digital LCD Evolution™ controller (English/Spanish/French/Portuguese)
 - 200 amp service rated transfer switch available
 - Electronic governor
 - Standard Wi-Fi® connectivity
 - System status & maintenance interval LED indicators
 - Sound attenuated enclosure
 - Flexible fuel line connector
 - Natural gas or LP gas operation
 - 5 Year limited warranty
 - Listed and labeled for installation as close as 18 in (457 mm) to a structure.*
- *Must be located away from doors, windows, and fresh air intakes and in accordance with local codes.*

Standby Power Rating

G007038-1, G007039-1, G007038-3, G007039-3 (Aluminum - Bisque) - 20 kW 60 Hz
G007042-10, G007042-11, G007043-10, G007043-11 (Aluminum - Bisque) - 22 kW 60 Hz
G007209-10, G007210-10 (Aluminum - Bisque) - 24 kW 60 Hz



Product shown with optional fascia kit



QUIET-TEST™



Note: CUL or CUL certification only applies to unbundled units and units packaged with limited circuit switches. Units packaged with the Smart Switch are ETL or UL certified in the USA only.

FEATURES

- **INNOVATIVE ENGINE DESIGN & RIGOROUS TESTING** are at the heart of Generac's success in providing the most reliable generators possible. Generac's G-Force engine lineup offers added peace of mind and reliability for when it's needed the most. The G-Force series engines are purpose built and designed to handle the rigors of extended run times in high temperatures and extreme operating conditions.
- **TRUE POWER™ ELECTRICAL TECHNOLOGY:** Superior harmonics and sine wave form produce less than 5% Total Harmonic Distortion for utility quality power. This allows confident operation of sensitive electronic equipment and micro-chip based appliances, such as variable speed HVAC systems.
- **TEST CRITERIA:**
 - ✓ PROTOTYPE TESTED
 - ✓ NEMA MG1-22 EVALUATION
 - ✓ SYSTEM TORSIONAL TESTED
 - ✓ MOTOR STARTING ABILITY
- **MOBILE LINK® CONNECTIVITY:** FREE with select Guardian Series Home standby generators, Mobile Link Wi-Fi allows users to monitor generator status from anywhere in the world using a smartphone, tablet, or PC. Easily access information such as the current operating status and maintenance alerts. Users can connect an account to an authorized service dealer for fast, friendly, and proactive service. With Mobile Link, users are taken care of before the next power outage.
- **SOLID-STATE, FREQUENCY COMPENSATED VOLTAGE REGULATION:** This state-of-the-art power maximizing regulation system is standard on all Generac models. It provides optimized FAST RESPONSE to changing load conditions and MAXIMUM MOTOR STARTING CAPABILITY by electronically torque-matching the surge loads to the engine. Digital voltage regulation at $\pm 1\%$.
- **SINGLE SOURCE SERVICE RESPONSE** from Generac's extensive dealer network provides parts and service know-how for the entire unit, from the engine to the smallest electronic component.
- **GENERAC TRANSFER SWITCHES:** Long life and reliability are synonymous with GENERAC POWER SYSTEMS. One reason for this confidence is that the GENERAC product line is offered with its own transfer systems and controls for total system compatibility.

THE GENERAC
PROMISE



20/22/24 kW

Available Accessories

Model #	Product	Description
G007101-0	Battery Pad Warmer	Pad warmer rests under the battery. Recommended for use if temperature regularly falls below 0 °F (-18 °C). (Not necessary for use with AGM-style batteries).
G007102-0	Oil Warmer	Oil warmer slips directly over the oil filter. Recommended for use if temperature regularly falls below 0 °F (-18 °C).
G007103-1	Breather Warmer	Breather warmer is for use in extreme cold weather applications. For use with Evolution controllers only in climates where heavy icing occurs.
G005621-0	Auxiliary Transfer Switch Contact Kit	The auxiliary transfer switch contact kit allows the transfer switch to lock out a single large electrical load that may not be needed. Not compatible with 50 amp pre-wired switches.
G007027-0 - Bisque	Fascia Base Wrap Kit	The fascia base wrap snaps together around the bottom of the new air-cooled generators. This offers a sleek, contoured appearance as well as offering protection from rodents and insects by covering the lifting holes located in the base.
G005703-0 - Bisque	Touch-Up Paint Kit	If the generator enclosure is scratched or damaged, it is important to touch up the paint to protect from future corrosion. The touch-up paint kit includes the necessary paint to correctly maintain or touch up a generator enclosure.
G006485-0	Scheduled Maintenance Kit	Generac's scheduled maintenance kit provides all the items necessary to perform complete routine maintenance on a Generac automatic standby generator (oil not included).
G007005-0	Wi-Fi LP Tank Fuel Level Monitor	The Wi-Fi enabled LP tank fuel level monitor provides constant monitoring of the connected LP fuel tank. Monitoring the LP tank's fuel level is an important step in verifying the generator is ready to run during an unexpected power failure. Status alerts are available through a free application to notify users when the LP tank is in need of a refill.
G007000-0 (50 amp) G007006-0 (100 amp)	Smart Management Module	Smart Management Modules (SMM) are used to optimize the performance of a standby generator. It manages large electrical loads upon startup and sheds them to aid in recovery when overloaded. In many cases, using SMM's can reduce the overall size and cost of the system.
G007169-0 - 4G LTE G007170-0 - Wi-Fi/ Ethernet	Mobile Link [™] Cellular Accessories	The Mobile Link family of Cellular Accessories allow users to monitor generator status from anywhere in the world, using a smart phone, tablet, or PC. Easily access information such as the current operating status and maintenance alerts. Users can connect an account with an authorized service dealer for fast, friendly, and proactive service. With Mobile Link, users are taken care of before the next power outage.
G007220-0 - Bisque	Base Plug Kit	Base plugs snap into the lifting holes on the base of air-cooled home standby generators. This offers a sleek, contoured appearance, as well as offers protection from rodents and insects by covering the lifting holes located in the base. Kit contains four plugs, sufficient for use on a single air-cooled home standby generator.

Dimensions & UPCs

Model	UPC
G007038	696471074185
G007039	696471074192
G007042	696471074208
G007043	696471074215
G007209	696471071511
G007210	696471084801

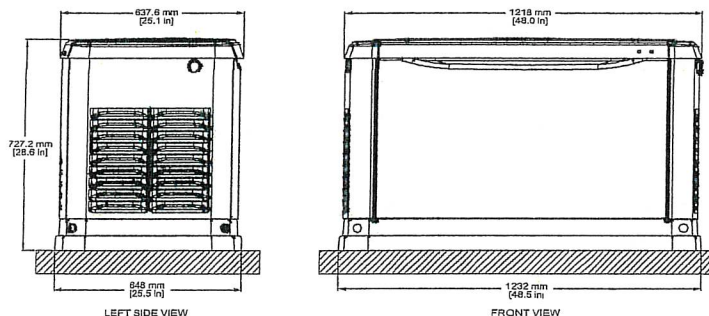

Dimensions shown are approximate. See installation manual for exact dimensions. DO NOT USE THESE DIMENSIONS FOR INSTALLATION PURPOSES.

Contractor submit

②

20/22/24 kW

GENERAC®

GUARDIAN® SERIES
Residential Standby Generators
Air-Cooled Gas Engine

20/22/24 kW

1 of 6

INCLUDES:

- True Power™ Electrical Technology
- Two-line multilingual digital LCD Evolution™ controller (English/Spanish/French/Portuguese)
- 200 amp service rated transfer switch available
- Electronic governor
- Standard Wi-Fi® connectivity
- System status & maintenance interval LED indicators
- Sound attenuated enclosure
- Flexible fuel line connector
- Natural gas or LP gas operation
- 5 Year limited warranty
- Listed and labeled for installation as close as 18 in (457 mm) to a structure.*
**Must be located away from doors, windows, and fresh air intakes and in accordance with local codes.*

Standby Power Rating

G007038-1, G007039-1, G007038-3, G007039-3 (Aluminum - Bisque) - 20 kW 60 Hz
G007042-10, G007042-11, G007043-10, G007043-11 (Aluminum - Bisque) - 22 kW 60 Hz
G007209-10, G007210-10 (Aluminum - Bisque) - 24 kW 60 Hz



Product shown with optional fascia kit



QUIET-TEST™



Note: CUL or CUL certification only applies to unbundled units and units packaged with limited circuit switches. Units packaged with the Smart Switch are ETL or UL certified in the USA only.

FEATURES

- **INNOVATIVE ENGINE DESIGN & RIGOROUS TESTING** are at the heart of Generac's success in providing the most reliable generators possible. Generac's G-Force engine lineup offers added peace of mind and reliability for when it's needed the most. The G-Force series engines are purpose built and designed to handle the rigors of extended run times in high temperatures and extreme operating conditions.
- **TRUE POWER™ ELECTRICAL TECHNOLOGY:** Superior harmonics and sine wave form produce less than 5% Total Harmonic Distortion for utility quality power. This allows confident operation of sensitive electronic equipment and micro-chip based appliances, such as variable speed HVAC systems.
- **TEST CRITERIA:**
 - ✓ **PROTOTYPE TESTED**
 - ✓ **SYSTEM TORSIONAL TESTED**
 - ✓ **NEMA MG1-22 EVALUATION**
 - ✓ **MOTOR STARTING ABILITY**
- **MOBILE LINK® CONNECTIVITY:** FREE with select Guardian Series Home standby generators, Mobile Link Wi-Fi allows users to monitor generator status from anywhere in the world using a smartphone, tablet, or PC. Easily access information such as the current operating status and maintenance alerts. Users can connect an account to an authorized service dealer for fast, friendly, and proactive service. With Mobile Link, users are taken care of before the next power outage.
- **SOLID-STATE, FREQUENCY COMPENSATED VOLTAGE REGULATION:** This state-of-the-art power maximizing regulation system is standard on all Generac models. It provides optimized **FAST RESPONSE** to changing load conditions and **MAXIMUM MOTOR STARTING CAPABILITY** by electronically torque-matching the surge loads to the engine. Digital voltage regulation at $\pm 1\%$.
- **SINGLE SOURCE SERVICE RESPONSE** from Generac's extensive dealer network provides parts and service know-how for the entire unit, from the engine to the smallest electronic component.
- **GENERAC TRANSFER SWITCHES:** Long life and reliability are synonymous with GENERAC POWER SYSTEMS. One reason for this confidence is that the GENERAC product line is offered with its own transfer systems and controls for total system compatibility.

THE GENERAC
PROMISE



20/22/24 kW

Available Accessories

Model #	Product	Description
G007101-0	Battery Pad Warmer	Pad warmer rests under the battery. Recommended for use if temperature regularly falls below 0 °F (-18 °C). (Not necessary for use with AGM-style batteries).
G007102-0	Oil Warmer	Oil warmer slips directly over the oil filter. Recommended for use if temperature regularly falls below 0 °F (-18 °C).
G007103-1	Breather Warmer	Breather warmer is for use in extreme cold weather applications. For use with Evolution controllers only in climates where heavy icing occurs.
G005621-0	Auxiliary Transfer Switch Contact Kit	The auxiliary transfer switch contact kit allows the transfer switch to lock out a single large electrical load that may not be needed. Not compatible with 60 amp pre-wired switches.
G007027-0 - Bisque	Fascia Base Wrap Kit	The fascia base wrap snaps together around the bottom of the new air-cooled generators. This offers a sleek, contoured appearance as well as offering protection from rodents and insects by covering the lifting holes located in the base.
G005703-0 - Bisque	Touch-Up Paint Kit	If the generator enclosure is scratched or damaged, it is important to touch up the paint to protect from future corrosion. The touch-up paint kit includes the necessary paint to correctly maintain or touch up a generator enclosure.
G008485-0	Scheduled Maintenance Kit	Generac's scheduled maintenance kit provides all the items necessary to perform complete routine maintenance on a Generac automatic standby generator (oil not included).
G007005-0	Wi-Fi LP Tank Fuel Level Monitor	The Wi-Fi enabled LP tank fuel level monitor provides constant monitoring of the connected LP fuel tank. Monitoring the LP tank's fuel level is an important step in verifying the generator is ready to run during an unexpected power failure. Status alerts are available through a free application to notify users when the LP tank is in need of a refill.
G007000-0 (60 amp) G007006-0 (100 amp)	Smart Management Module	Smart Management Modules (SMM) are used to optimize the performance of a standby generator. It manages large electrical loads upon startup and sheds them to aid in recovery when overloaded. In many cases, using SMM's can reduce the overall size and cost of the system.
G007169-0 - 4G LTE G007170-0 - Wi-Fi/ Ethernet	Mobile Link [®] Cellular Accessories	The Mobile Link family of Cellular Accessories allow users to monitor generator status from anywhere in the world, using a smart phone, tablet, or PC. Easily access information such as the current operating status and maintenance alerts. Users can connect an account with an authorized service dealer for fast, friendly, and proactive service. With Mobile Link, users are taken care of before the next power outage.
G007220-0 - Bisque	Base Plug Kit	Base plugs snap into the lifting holes on the base of air-cooled home standby generators. This offers a sleek, contoured appearance, as well as offers protection from rodents and insects by covering the lifting holes located in the base. Kit contains four plugs, sufficient for use on a single air-cooled home standby generator.

Dimensions & UPCs

Model	UPC
G007038	696471074185
G007039	696471074192
G007042	696471074208
G007043	696471074215
G007209	696471071511
G007210	696471084801

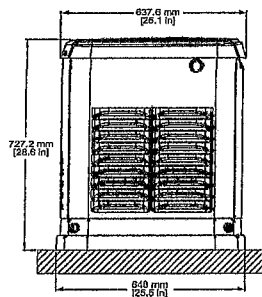

LEFT SIDE VIEW

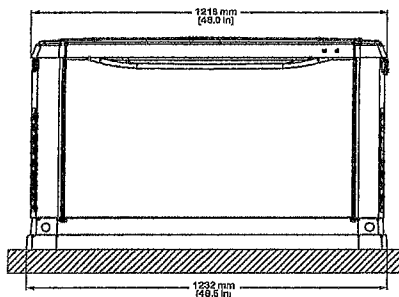

FRONT VIEW

Dimensions shown are approximate. See installation manual for exact dimensions. DO NOT USE THESE DIMENSIONS FOR INSTALLATION PURPOSES.

Contractor submits

②