



**CITY OF WILLOWICK PLAN REVIEW BOARD
APPLICATION FOR PERMIT TO OCCUPY FOR
BUSINESS, COMMERCIAL, INDUSTRIAL, ETC.
YOU MUST FILL OUT ENTIRE APPLICATION
440-516-3000**

PERMIT FEE: \$60.00
DATE: 3/10/26

Location of Occupancy: 30525 Euclid Av Business Name: Sound stage Tavern
(ADDRESS)

Business Owner's Name & Address: Dominic Apolito 30220 Forest Grove Rd

CITY/STATE/ZIP: Willowick Ohio 44095

Telephone Number: 440 669 7406 Fax Number: _____ Federal ID Number: 278-70-3491
Or Social Security Number

OWNER OF PROPERTY/NAME/ADDRESS/TELEPHONE NUMBER: Mike Camillo
216-316-3958

SUBMIT NEW DETAILED FLOOR PLAN: SQ. FT. HABITABLE FLOOR AREA FOR OCCUPANCY: 4000

Building Size: 60 x 90 Total Number Of Employees: 2

Intended Number of Occupants: _____ Total Number of Seating: 80 inside 45 outside

Site Plan With Number of Paved Parking Spaces: Submitted Hours Of Operation: 11 - 2:30

Letter of Intent: Previous Use: _____ Proposed Use: Bar & Restaurant

NAME OF PRINCIPAL OR CONTACT PERSON FOR NEW BUSINESS: _____

Home Address/City/Zip: _____ Telephone Number: _____

I hereby certify that the above questions have been answered correctly by me and that the premises will be used for the purpose stated above. Any change in the purpose of occupancy will not be made without approval from Lake County Building, Willowick Fire & Willowick Zoning Department. A final approval by The Willowick Building Dept. (440)516-3000 or a representative thereof, must be complied with before opening of business. I do hereby further agree to maintain the above premises in compliance with the ordinances of the City of Willowick.

Applicant's Signature: [Signature] Date: 3/10/26

Office use only:

Zoning District: _____ Authorized Occupants: _____

TEMPORARY APPROVED BY: _____ Date: _____

Zoning Dept. Inspected by: _____ DATE: _____

Zoning Permit # _____ Zoning Permit Fee \$ _____

Fire Dept. Inspected By: _____ Date: _____

**CITY OF WILLOWICK-APPLICATION FOR COMMERCIAL ESTABLISHMENT LICENSE REQUIRED AFTER APPROVAL
Note* A separate permit is required for all new signs from the Willowick Building Department.**

To whom it may concern,

We here at Sound Stage Tavern are interested in developing brand new bocce and cornhole courts on our property. Our intention is to create more of a family friendly atmosphere as well as draw more customers into the city of Willowick.

We currently have several interested parties in moving these leagues from other cities, as well as bringing their families to these events. Our goal here has always been to create a safe and inviting environment for members of our community, and this construction will allow us to further achieve these goals.

Thank you for your time and consideration,

Dom Apolito

A stylized, cursive handwritten signature of Dom Apolito, consisting of several overlapping loops and a long horizontal stroke extending to the right.

Owner
Sound Stage Tavern

Dominic Apolito

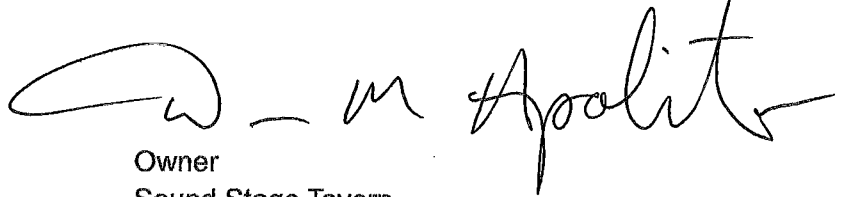
A handwritten signature of Dominic Apolito, featuring a large, rounded initial 'D' followed by a horizontal line and the name 'Apolito' written in a cursive script.

Owner
Sound Stage Tavern

Euclid Ave

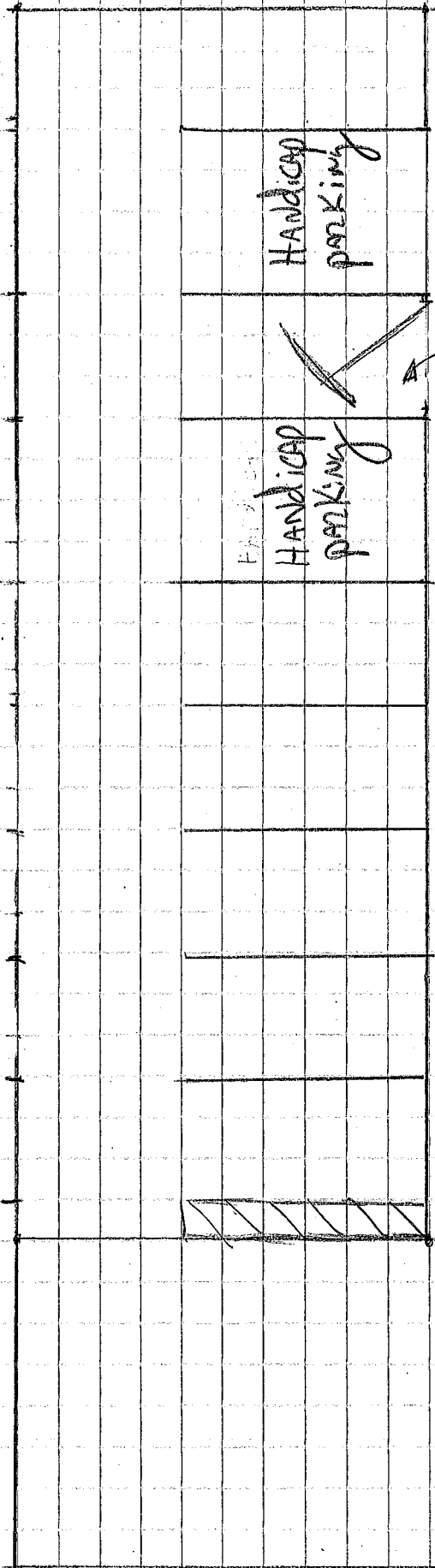

Building
Entrance

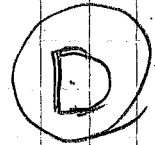

Drive way side



2 HANDICAP PARKING
6 REGULAR PARKING

1 SQ = 3 FT

Courts 4x4

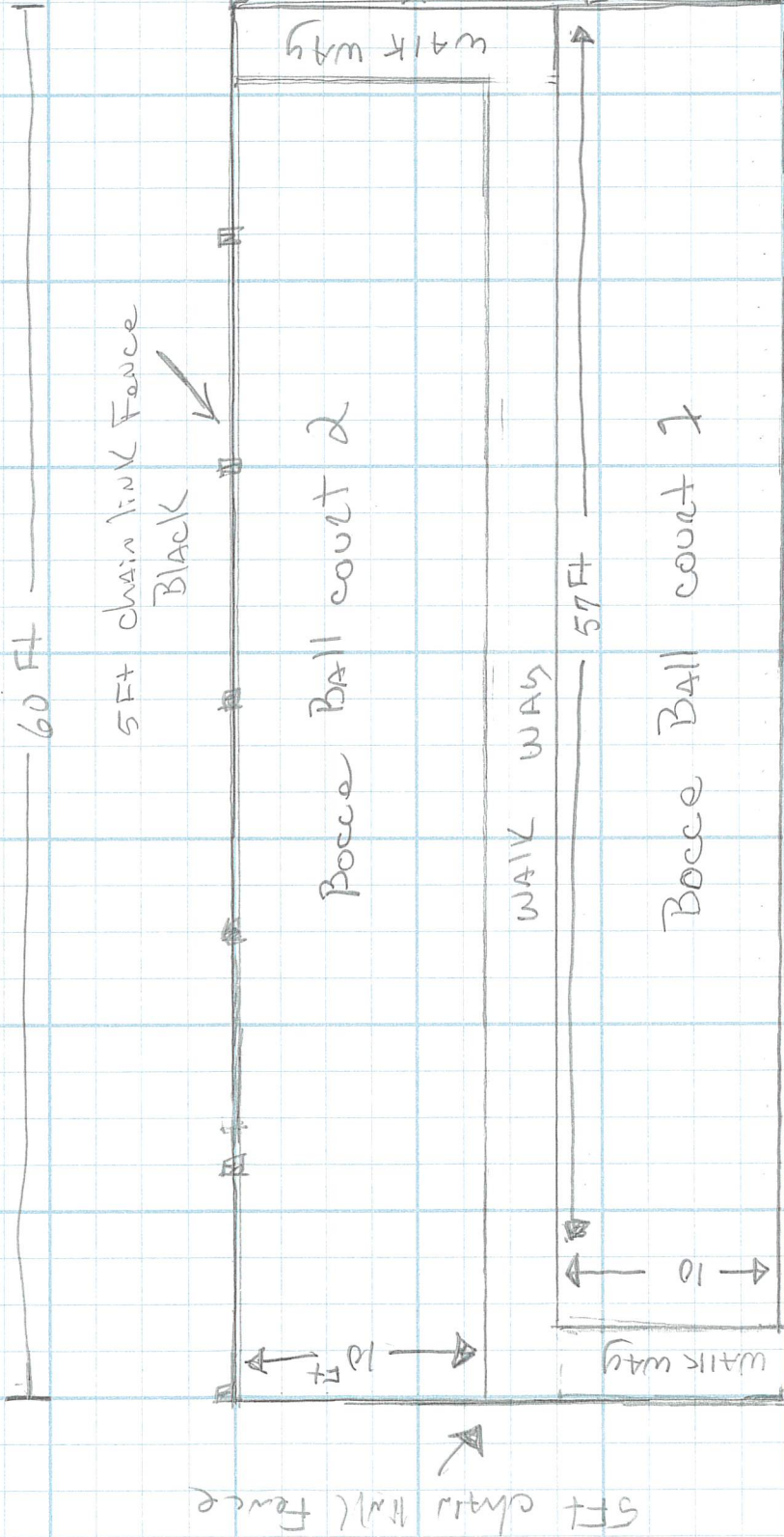

DMS
sound stage
30525 Euclid
Willowick,

1 Block = 2 FT

OUT side Deck

4x4



5 FT chain link Fence
BLACK

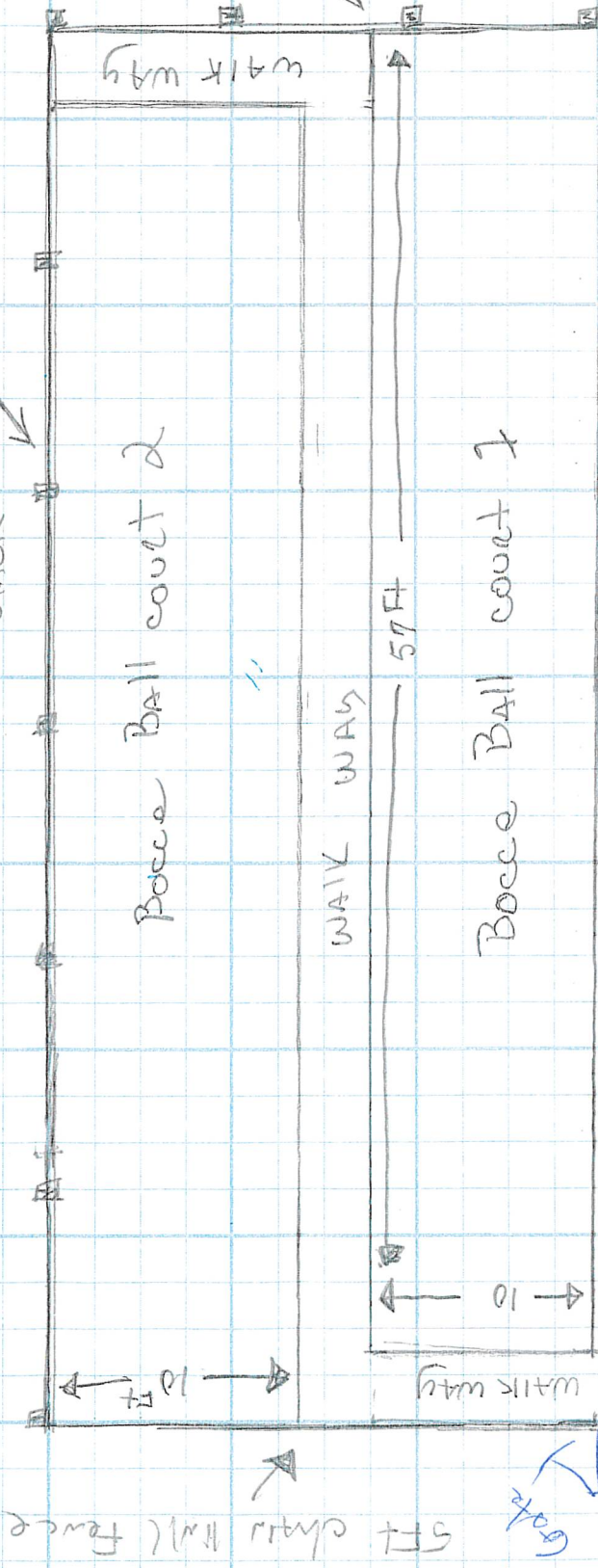

5 FT chain link Fence

DMS
sound stage
30525 Euclid
Willowick

1 Block = 2 FT

Bocce Ball court 2

WALK WAY

Bocce Ball court 1

OUT SIDE Deck

27 - Drawing

Door

5 FT chain link Fence

Gate

WALK WAY

10

57 FT

60 FT

4x4 construction 2 High set on existing ASPHALT
Rebar set to the 4x4 in to ASPHALT
5' chain link Fence To surround court

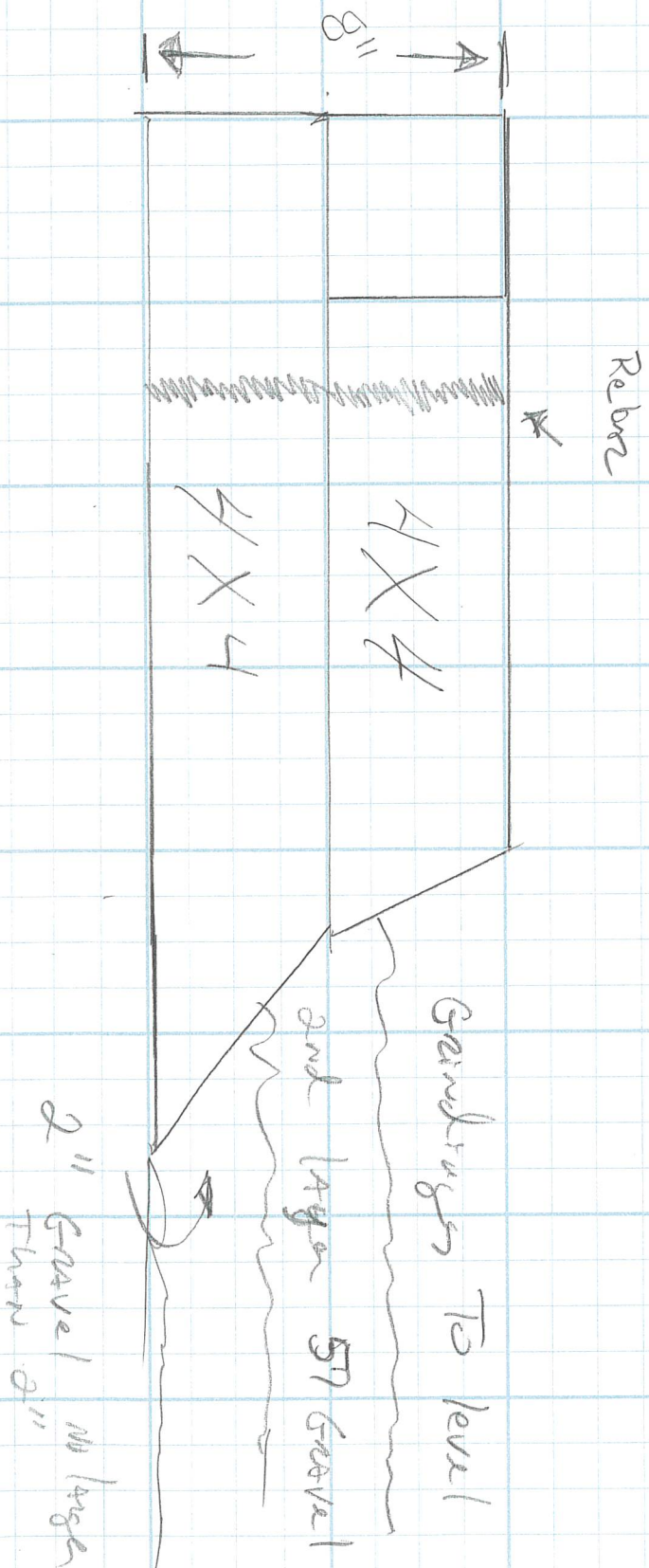

Stage

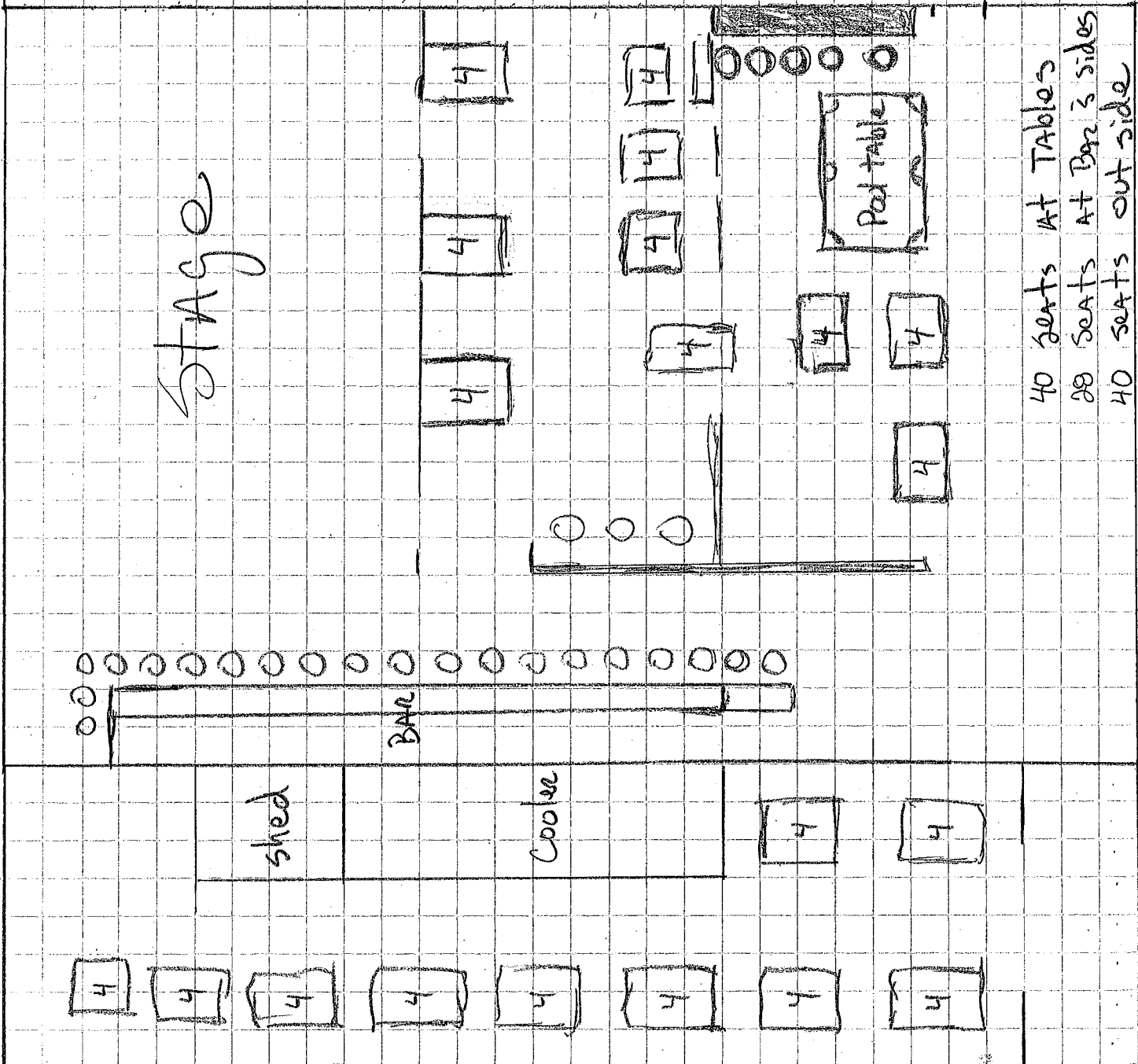

See Drawing 27

150 = 3 FT

40 seats AT TABLES
 88 SEATS AT BAR 3 SIDES
 40 SEATS OUTSIDE

seating chart
 (E)

Approved Construction Documents



Lake County, Ohio

Lake County Building Department



ASPHALT
Already
Done

2 new parking
spaces

parallel parking 7 spaces + 2
regular parking 55 spaces

PARKING AREA ROAD
62-SPACES

NOT IN (E)

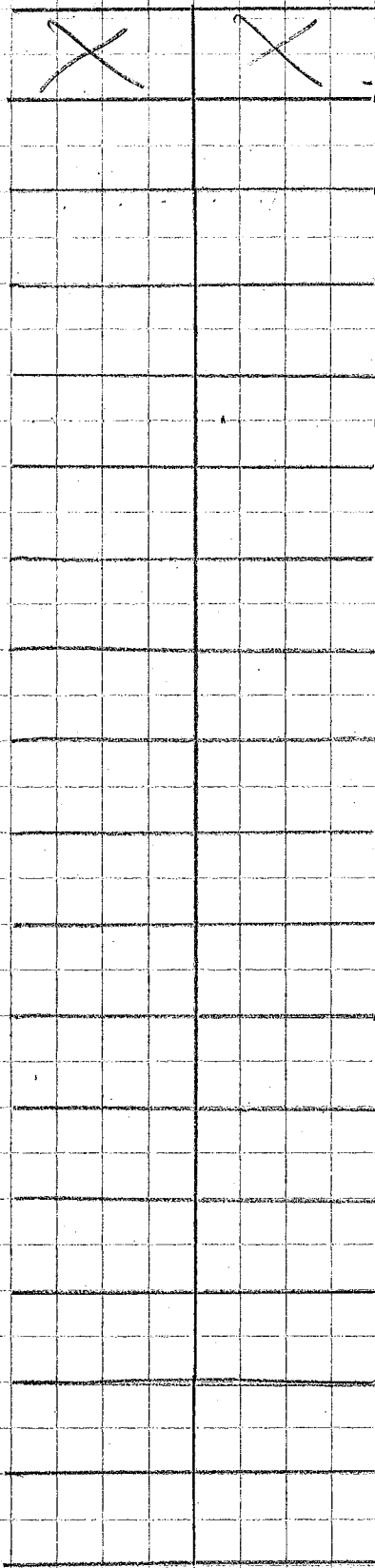
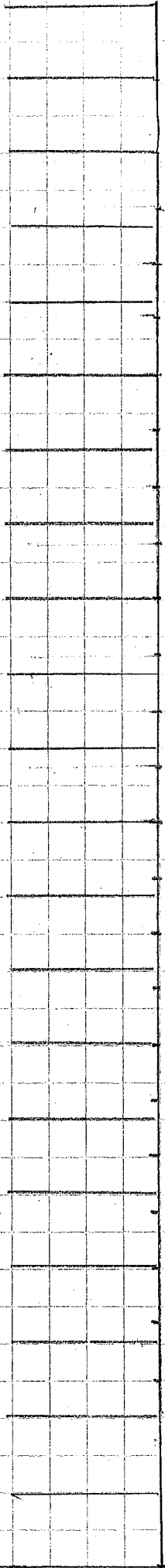

2 more parking spaces

parallel parking 7 spaces
 Regular parking 55 spaces

Parking Area Road
 62-5 spaces

Drawings (C)