

**NOTES:**

- 1) VERTICAL DATUM IS MEAN LOWER LOW WATER (MLLW = 0.00')
- 2) BASIS OF VERTICAL DATUM FOR THIS SURVEY IS FROM THE C.O.E. "WEST CAMP 4" MONUMENT ELEVATION 20.64' MLLW (SEE NOTE 1). FOR LOCATION AND DESCRIPTION REFER TO THE CORPS OF ENGINEERS JULY 1995 CONDITION SURVEY OF THE WHITTIER BOAT HARBOR.
- 3) BASIS OF BEARING FOR THIS SURVEY IS S72°22'30"E AND IS BASED ON THE FOUND C.O.E. MONUMENTS "WEST CAMP 3" & "WEST CAMP 4" LOCATED ALONG THE WHITTIER HARBOR BREAKWATER AS SHOWN ON C.O.E. JULY 1995 CONDITION SURVEY. COORDINATE VALUES LISTED ON SAID DRAWING WERE USED TO ESTABLISH BEARING BETWEEN "WEST CAMP 3 & 4".
- 4) UTILITIES NOT SHOWN FOR CLARITY
- 5) CONTOURS ARE IN FEET, WITH TWO FOOT INTERVALS.
- 6) FIELD SURVEY PERFORMED APRIL 14-29, 2005. EAST RAMP PARTIAL SURVEY PERFORMED DEC 15, 2008. BATHYMETRY IN FRONT OF THE BULKHEAD IS UNVERIFIED AND BASED ON 2011 DESIGN DRAWINGS
- 7) ALL EXISTING FLOATS ARE CONCRETE. ALL EXISTING FLOAT PILES ARE TIMBER

**LEGEND**

- ⊕ FOUND MONUMENT
- ⊕ TH# TEST HOLE
- ⊕ FOUND C.O.E. MONUMENT
- ▨ PAVED AREA
- ⊙ SET REBAR W/ PND YPC
- ▨ CONCRETE WALK
- \* SET NAIL W/ PND SHINER
- - - PROPERTY LINE

PROJECT CONTROL				
POINT #	NORTHING	EASTING	ELEV.	DESCRIPTION
30	2478111.651	1874030.066	24.35	SET NAIL & SHINER
40	2478026.733	1874659.054	22.12	SET NAIL & SHINER
50	2478074.095	1875364.893	20.23	SET NAIL & SHINER
60	2478566.843	1875389.133	20.34	SET REBAR w/ YPC
61	2478825.114	1874765.998	16.71	FND C.O.E. MONUMENT
62	2478626.939	1875389.779	20.64	FND C.O.E. MONUMENT

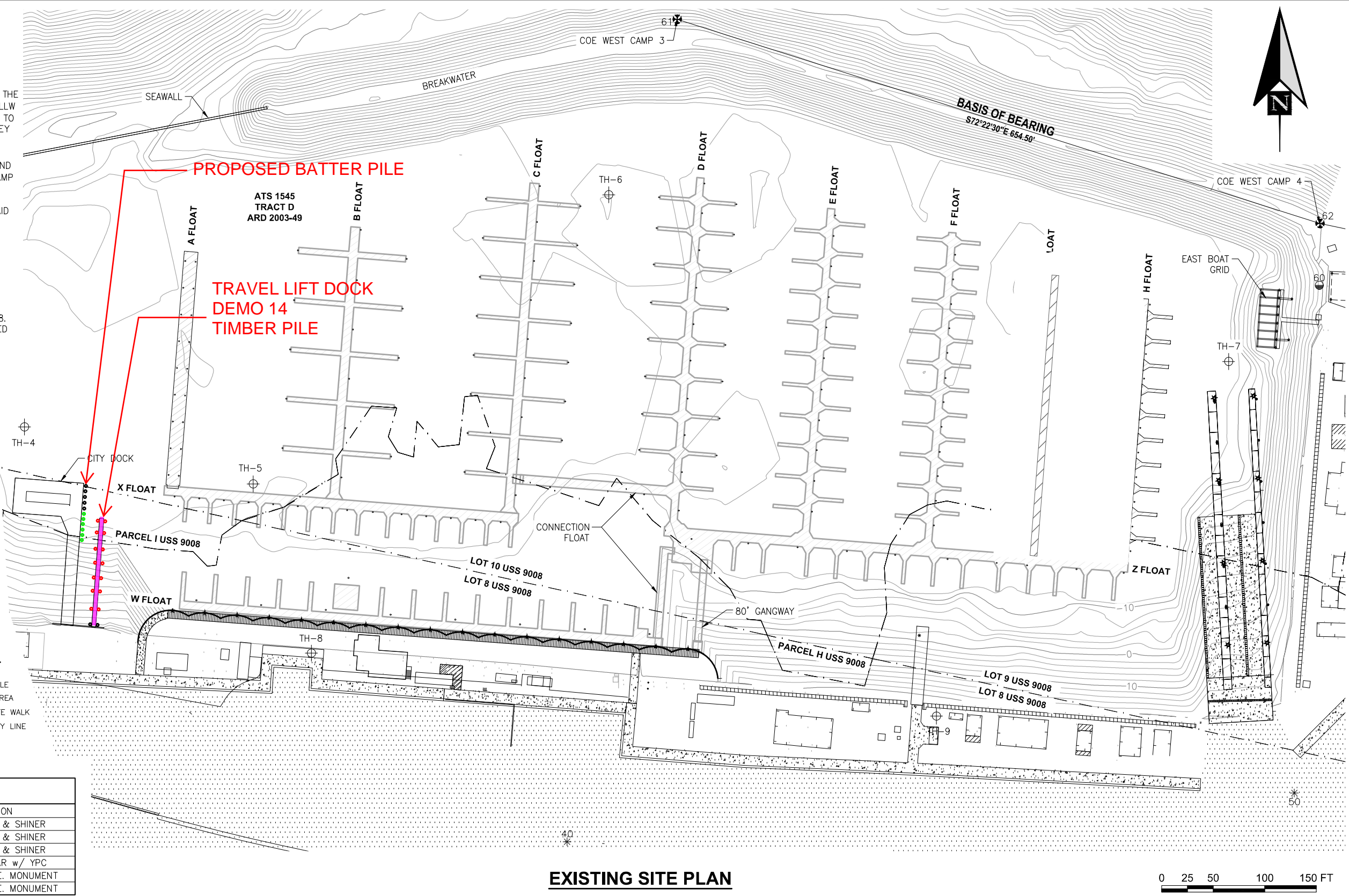

CITY OF WHITTIER  
 PO BOX 608  
 WHITTIER, ALASKA 99693  
 PHONE: (907) 472-2327  
 FAX: (907) 472-2404

PND Engineers, Inc. is not responsible for safety programs, methods or procedures of operation, or the construction of the design shown on these drawings. Where specifications are general or not called out, the specifications shall conform to standards of industry. Drawings are for use on this project only and are not intended for reuse without written approval from PND. Drawings are also not to be used in any manner that would constitute a detriment directly or indirectly to PND.

REV	DATE	DESCRIPTION



DATE: 5/14/25

1506 West 36th Avenue  
 Anchorage, Alaska 99503  
 Phone: 907.561.1011  
 Fax: 907.563.4220  
 www.pndengineers.com

**PND ENGINEERS, INC.**

PROJECT: WHITTIER HARBOR PHASE III REBUILD  
 TITLE: EXISTING SITE PLAN & SURVEY  
 SHEET NO: G102

DESIGNED BY: BJ	DATE: 5/14/25
CHECKED BY: CC	PROJECT NO: 241087





DEMO TRAVEL LIFT  
FINGER PIER

PROPOSED  
BATTER PILE PILE

EXISTING BATTER  
PILE





