



PROPOSAL FOR:

City of Whitewater Police Department
Evidence Garage Storage Equipment and Stainless
Steel Worktables
Chief Dan Meyer

Prepared By:

Ken Pahlke





CUSTOMER: City of Whitewater Police Department
 312 W. Whitewater St.
 Whitewater, WI 53190

SHIP TO: City of Whitewater Police Department
 312 W. Whitewater St.
 Whitewater, WI 53190

Contact : Dan Meyer
 Phone : 262-473-1371
 Terms : Net 30 Days with Credit Approval

Shipping : Prepay & Add
 Lead Time : 4-6 weeks at time of quote
 FOB : Factory

Quote Date	Quote No.	Rev	County	Prepared By
5/5/2026	QUO-83956-N2N5X9	0	55127 - Walworth	Ken Pahlke

We would like to thank you for the opportunity to quote on your Material Handling Equipment requirements. We propose to furnish the equipment, parts or service described herein, in accordance with the specifications, terms and conditions outlined. We are pleased to offer the following:

Mfr	Model	Description	Qty	Sell Each	Total
Evidence 101					
<i>Evidence 101 Equipment Subtotal</i>					\$21,600.00
	Stainless Steel Solid Top Tables	72" w x 30" d x 36" h freestanding work tables, Type 430 16 gauge stainless steel top with sound deadening, 1 5/8" legs with C-Channel Frame. 750 lbs. capacity, adjustable feet.	10	\$1,320.00	\$13,200.00
	Bulk Rack Shelving	(5) SH1 Units Single Range 374" L x 36" D x 84" H with 3 levels of storage evenly spaced, Corrugated Steel Deck on each level, Starter/Adder Configuration with shared uprights. (6) SH2 Units Single Range 448" L x 24" D x 84" H with 4 levels of storage evenly spaced. Corrugated Steel Deck on each level, Starter/Adder Configuration with shared uprights.	1	\$8,400.00	\$8,400.00
Evidence Mezzanine 201					
<i>Evidence Mezzanine 201 Equipment Subtotal</i>					\$14,191.04
	Bulk Rack Shelving	(5) SH1 Units Single Range 374" W x 36" D x 84" H and (5) SH1 Units Single Range 362" W x 36" D x 84" H both with 3 level of storage evenly spaced, Corrugated Steel Deck on each level, Starter/Adder Configuration with shared uprights. (5) SH2 Units Single Range 362" W x 24" D x 84" H, (3) SH2 Units Single Range 225" W x 24" D x 84" H, (2) SH2 Units Single Range 151" W x 24" D x 84" H all with 4 levels of storage evenly spaced, Corrugated Steel	1	\$14,191.04	\$14,191.04





Deck on each level, Starter/Adder Configuration with shared uprights.

Non-union Installation & Freight for Project

Non-union Install and Freight for Project Subtotal **\$8,580.00**

Installation	Non-union Installation as per assumptions below	1	\$5,440.00	\$5,440.00
Freight	Dock to Dock - client to receive shipments and unload at worksite. Requires Full Size Dock that will accept a semi with 52' trailer.	1	\$3,140.00	\$3,140.00

Total Net Price: \$44,371.04

Whitewater Police Evidence Garage Storage Evidence 101

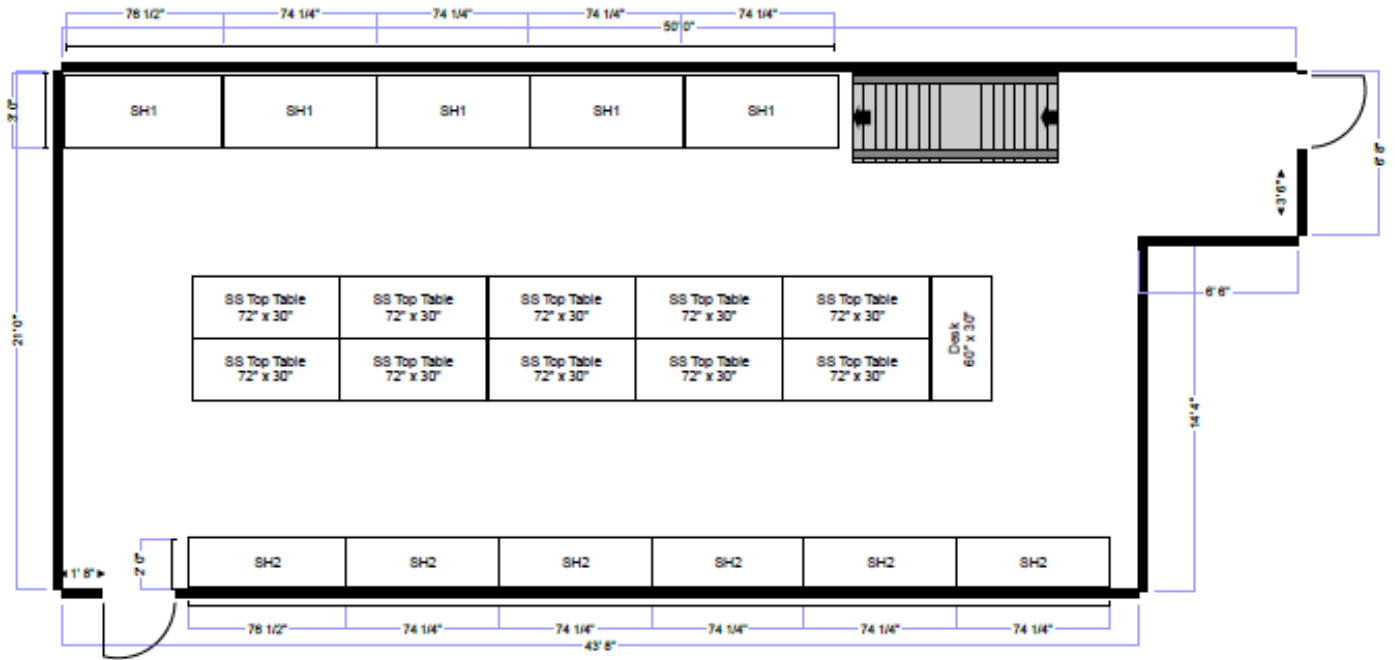

Material Handling



Automation & Robotics



Cranes & Hoists



Integrated Solutions



Industrial Storage & Handling



Power Systems



Workplace Storage



Dock & Door



Whitewater Police Evidence Garage Storage Evidence Mezzanine 201

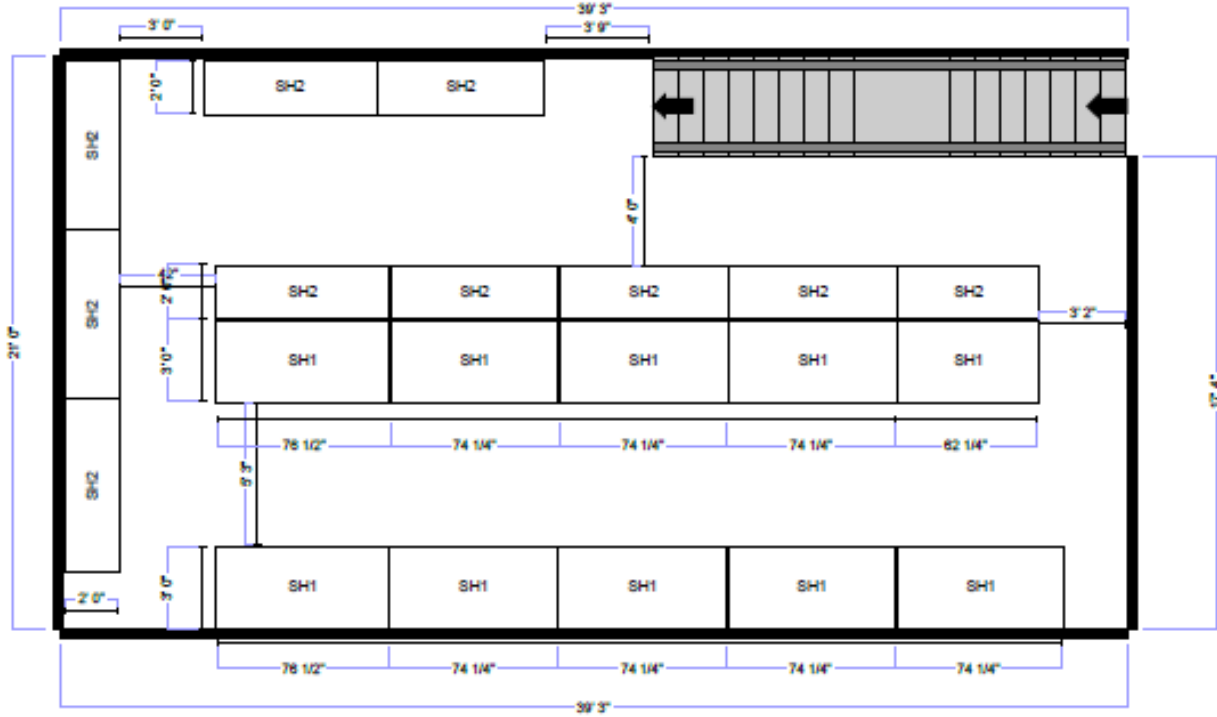

Material Handling



Automation & Robotics



Cranes & Hoists



Integrated Solutions



Industrial Storage & Handling



Power Systems



Workplace Storage



Dock & Door



SH1

Parts List		
BALLOON	QTY	DESCRIPTION
1	9	BPS-36
2	6	BPB-72 (Sold in Pairs)
3	18	BSD-7236 (12in wide sections)
4	2	BUF-3684

WOLTER
Accelerate Your Productivity

NOTE: STARTER SHOWN.
ADDER SIMILAR.
STARTER USES (2) BUF-3684.
ADDER USES (1) BUF-3684.

SH2

Parts List		
BALLOON	QTY	DESCRIPTION
1	12	BPS-24
2	8	BPB-72 (SOLD IN PAIRS)
3	24	BSD-24
4	2	BUF-2484

WOLTER
Accelerate Your Productivity

NOTE: STARTER SHOWN.
ADDER SIMILAR.
STARTER USES (2) BUF-84.
ADDER USES (1) BUF-84.





We have priced out each room separately in case budget will not allow for both rooms to be purchased in a single phase. The Stainless Steel Worktables use a 430 Stainless Steel, the top front and back edges are rolled over, the top side s edges are flat with legs that have adjustable feet.

We quoted Steel Bulk Storage Racking with a Corrugated Steel Decking, this is the by far the strongest most durable configuration with each shelf designed to store up to 2,750 lbs. evenly distributed. There are cheaper solutions such as particle board or wire but they will deflect over time and can sometimes damage what is stored. Shelves are fully adjustable on 3" increments if the configuration of evidence stored require them to be moved. These units can also be placed on Mobile Shelving in the future should more capacity be needed.

Pricing assumes direct shipments to the building and that the client receives the product using a fork lift from the back of a truck. Once on site the installers will come out and install all the equipment at the same time.

Additional Notes:

*Project pricing is good until 6/1/26 after that date pricing must be reviewed. This does not automatically mean the pricing will increase, simply that the steel mills and freight companies will not hold their pricing longer due to market volatility.

*This proposal to become an attachment to the Contract or Purchase Order.

*This proposal is based on our standard insurance coverage levels. Extra or special requests may be accommodated, however there may be an extra costs associated with those requests that are not included in this pricing.

*Non-standard components are non-cancellable and non-returnable.

*Any approved returns are subject to return freight and applicable restock fees.

*Freight is estimated at the time of quote, actual to be billed at the time of shipment.

*Sales Tax is not included and will be added at the time of invoice. To avoid paying sales tax the client must submit an approved "Sales Tax Exemption Certificate" or "Sales Tax Resale Certificate" with the purchase order. Our tax department will review and confirm the paperwork meets parameters set by the state in which the project is being performed.

*If you have questions or need additional information, please contact Ken Pahlke at 630-220-4216.

*Please Email purchase orders to mrstorage@wolterinc.com or fax to (262) 781-2531.

Installation Notes:

*One Phase Installation – Non-union (union available at extra cost).

*Work Performed During Normal Business Hours (after hours available at extra cost).

*Assumes client receives product from back of truck at the site, our installers will do the stair carry.

*If delivery location is a construction site, assumes a paved surface capable of holding a full size semi-truck and trailer and a paved surface from the point of unload into the building without any steps or obstacles that require us to remove equipment from dollies and hand carry.

*Clear Path to Room of Install with No Stairs or Obstacles.

*Area of Install is Finished with Working Lighting, HVAC, Floor Covering, Painted, Etc.

*Area of Install is Empty with Adequate Space to for Installers to Maneuver During Assembly.



Material Handling



Automation & Robotics



Cranes & Hoists



Integrated Solutions



Industrial Storage & Handling



Power Systems



Workplace Storage



Dock & Door



*Temporary Staging Space Outside the Install Area During Time of Install.

*All Packing Materials to Client Provided Dumpster (removal from site available at extra cost).

*If we take delivery of equipment but are unable to install, there will be extra labor costs to receive and stage the product as this becomes a double handling event. The cost cannot be determined ahead of time and will be based on conditions present at the time the event occurs.

The parameters above are what the installation cost for the project was based on. We can accommodate variances in these conditions. Depending on the variance, costs may increase or decrease. It is the client's responsibility to make sure all conditions are in place on the days of delivery and installation. Should we find conditions are not as described, we will do our best to make the client aware of the issue as soon as is practical. Sometimes when it is clear nothing can be immediately done to correct the situation (power outage, broken elevator, etc.), or the client is not responding within 15 minutes, we will select the best alternative solution and move forward. Client agrees that in these situations they defer to our best judgment and will cover any additional costs.



Material Handling



Automation & Robotics



Cranes & Hoists



Integrated Solutions



Industrial Storage & Handling



Power Systems



Workplace Storage



Dock & Door



Buyer hereby grants to Seller a security interest in all equipment and materials listed herein to secure payment in full of the purchase price of all such equipment and materials, and performance of all other obligations by Buyer under this agreement; Buyer authorizes the Seller to file a UCC financing statement with respect to this security interest.

This Proposal is subject to Wolter, Inc's Standard Terms and Conditions, which are incorporated herein by reference. Buyer expressly agrees to such Standard Terms and Conditions and any inconsistent or additional terms submitted by Buyer are rejected. See: <https://www.wolterinc.com/terms-and-conditions/>

APPROVED AND ACCEPTED BY: City of Whitewater Police Department

PRINTED NAME: _____

TITLE: _____

EMAIL ADDRESS: _____

DATE: _____

AUTHORIZED SIGNATURE: X _____

ACCEPTED BY SELLER:

QUOTATION SUBMITTED BY: Ken Pahlke
(Salesperson)

SIGNATURE: X _____

TITLE: _____

(This Quotation shall become a contract only upon signature by the Sales Manager of Seller at its business offices.)

If you have any questions, please contact us:

Sales Rep: **Ken Pahlke**
Cell Phone: **630-220-4216**
Email Address: **mrstorage@wolterinc.com**

Inside Sales:
Branch Phone:
Email Address:

Company: **Wolter, Inc.**
Address: **490 W North Frontage Rd**
City/State/Zip: **Bolingbrook, IL 60440**

Customer Name: **City of Whitewater Police Department**
Quote Number: **QUO-83956-N2N5X9**
Quote Date: **5/5/2026**

