

LOT C PROPOSAL

PUBLIC WORKS COMMITTEE—NOVEMBER 12, 2024

- Investigate possibility of designing a plaza in front of “The Prairie Tillers” Mural.

BACKGROUND



- The mural was created 20 years ago.
- Caryl Yasko (Internationally known muralist) lead the charge.
- The creation of the mural lead to the establishment of the Whitewater Arts Alliance.

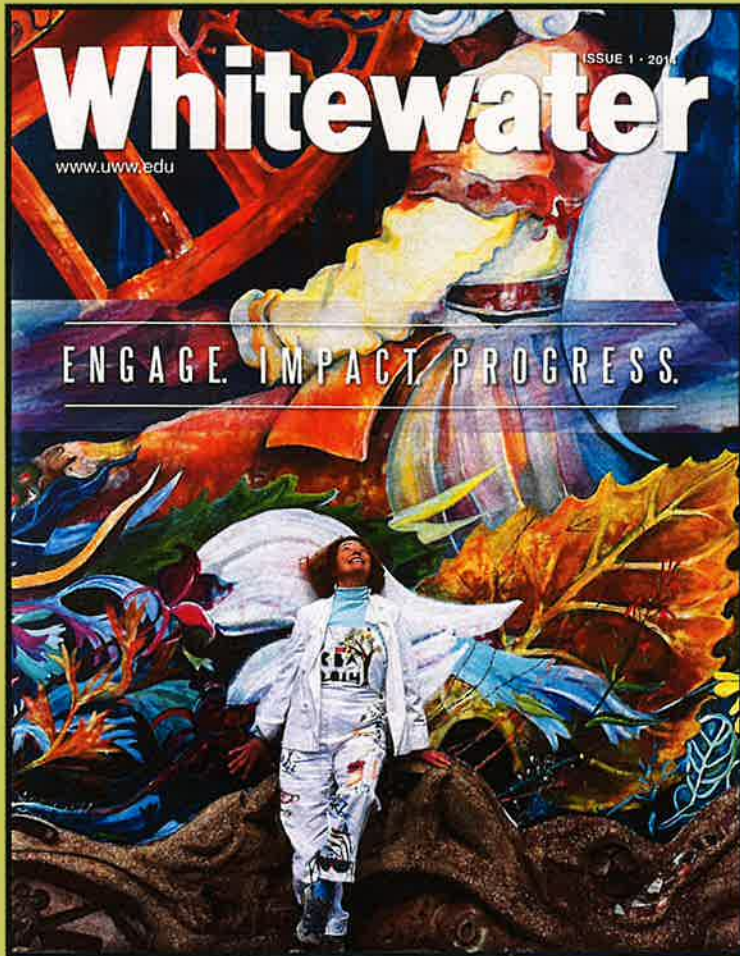

* The refurbishing of the mural was a collaboration between the City and the University.



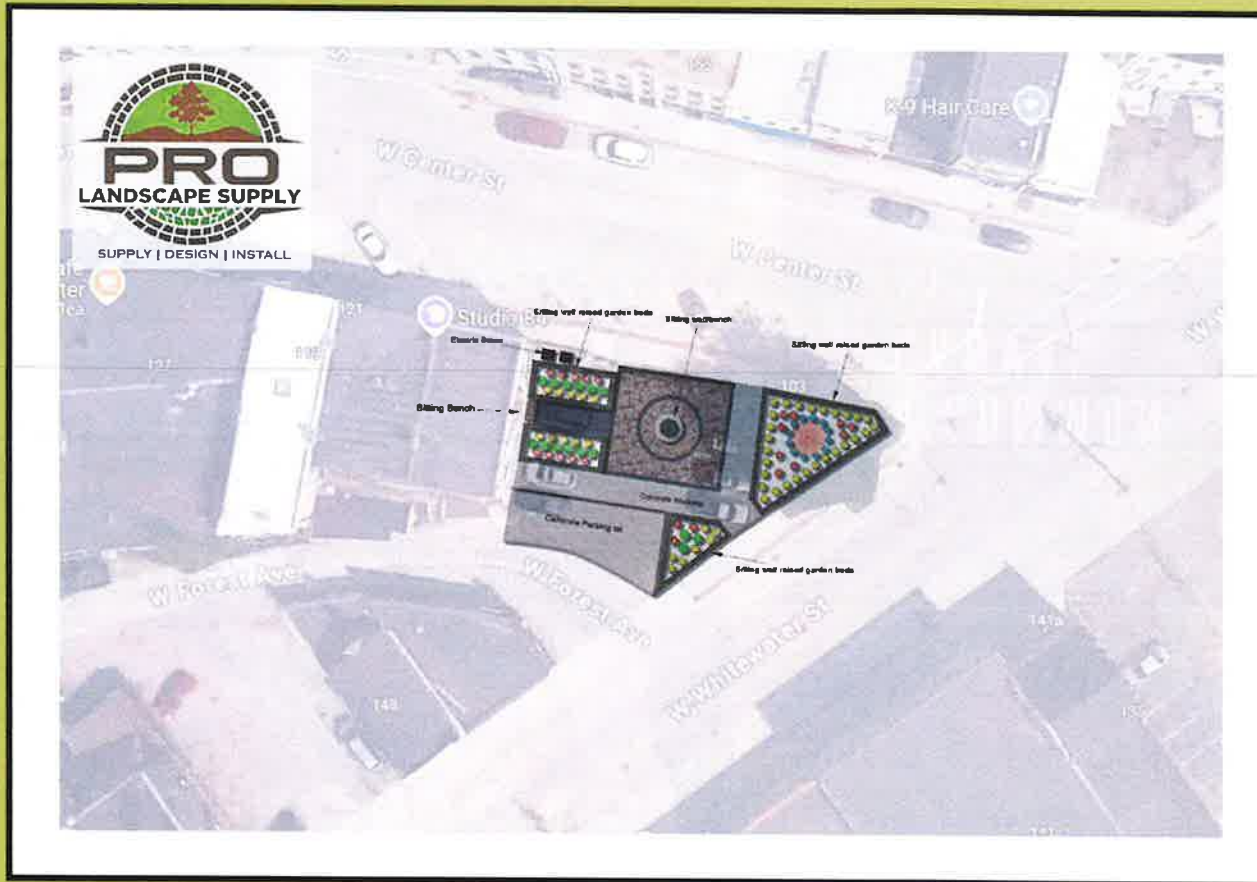

* Proposal by Pro Landscapes includes converting Lot C to a pocket park/plaza.

* The project could eliminate all or only some of the parking stalls.

* Mural Committee could assist with fundraising and possible grant writing.

* High visibility artwork contributes to tourism/stimulation to economy.

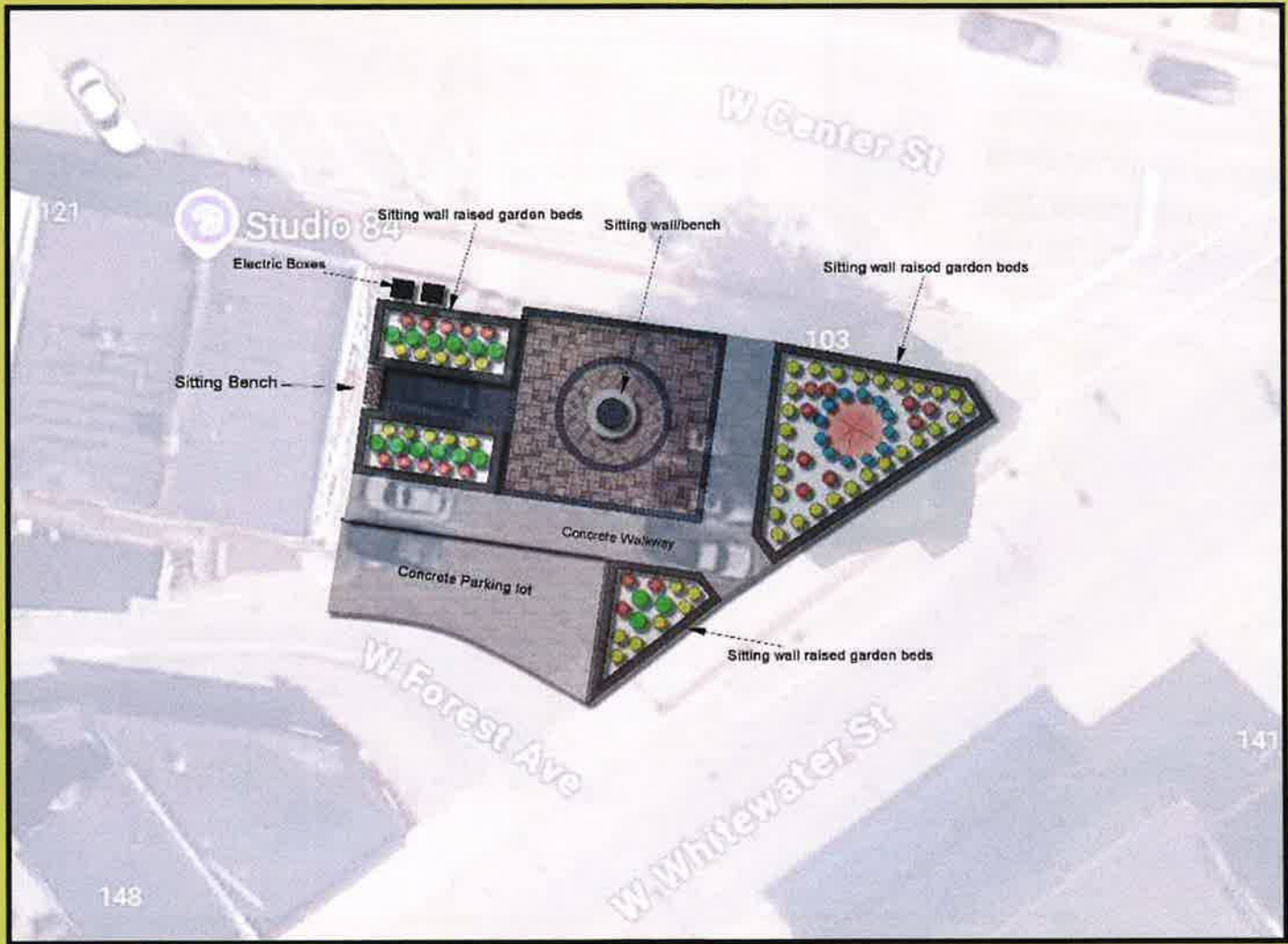



Example from Lemont, Illinois

*This mural is titled "Lemont Quarry Workers," and was originally painted in 1975. The mural was refurbished to honor the southwest suburb's limestone-cutting history.

Chicago's murals & mosaics

Part of a [series](#) on public art. More murals added every week.

MURALS AND MOSAICS ENTERTAINMENT AND CULTURE NEWS

Now 80, Caryl Yasko restores iconic 1975 mural honoring Lemont quarries, stone-cutting past

After creating it nearly half a century ago, she came back to the southwest suburb for a third time to refresh the iconic mural.

By Jeff W. Huebner | For the Sun-Times | Nov 17, 2021, 11:35am CST



Example from Chippewa Falls, WI

* This mural is titled "Harmony Court." It was painted in memory of the individuals in the Chi Hi bus crash on October 16, 2005 (killing many of the students and directors), and is located at 215. N. Bridge Street. A small meditation area with seating was set up by the mural.

NEXT STEPS

- * Determine if a mural plaza is something the City is willing to support.
- * Investigate how the “Prairie Tillers Mural” fits into the City’s current Public Art Plan. WAA has some maintenance monies set aside for the mural.
- * If there is interest, a collaborative fundraising plan could be developed.
- * Determine a maintenance plan for the plaza (could include an MOU with UW-Whitewater student organizations).
 - * Analyze other nearby parking to support downtown businesses/engagement.