

**GRADING LEGEND**

- 820 — EXISTING MAJOR CONTOUR
- 820 — PROPOSED MAJOR CONTOUR
- - - 821 - - - EXISTING MINOR CONTOUR
- - - 821 - - - PROPOSED MINOR CONTOUR
- 821.00  
X PROPOSED SPOT GRADE

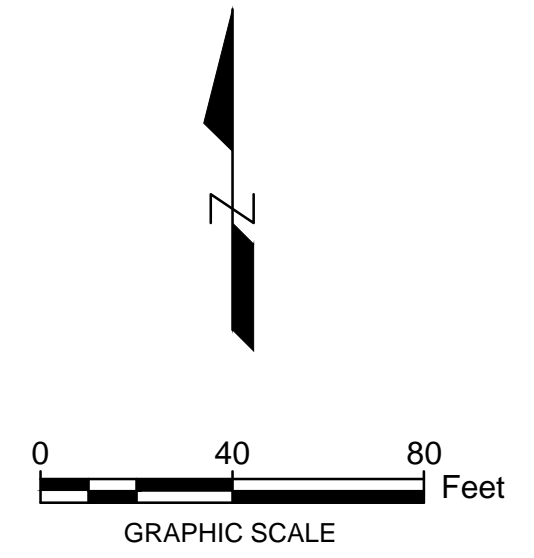

**GENERAL NOTES:**

1. CONTRACTOR SHALL PROVIDE EROSION CONTROL FACILITIES IN ACCORDANCE WITH THE MUNICIPALITY EROSION CONTROL ORDINANCE AND THE WISCONSIN DEPARTMENT OF NATURAL RESOURCES TECHNICAL STANDARDS.
2. THE LOCATIONS OF EXISTING UTILITY INSTALLATIONS AS SHOWN ON THIS PLAN ARE APPROXIMATE. THERE MAY BE OTHER UNDERGROUND UTILITY INSTALLATIONS WITHIN THE PROJECT AREA THAT ARE NOT SHOWN. THE CONTRACTOR SHALL BE RESPONSIBLE FOR VERIFYING THE EXISTENCE AND LOCATION OF ALL UNDERGROUND UTILITIES.
3. R.A. SMITH NATIONAL, INC. ASSUMES NO RESPONSIBILITY FOR DAMAGES, LIABILITY OR COSTS RESULTING FROM CHANGES OR ALTERATIONS MADE TO THIS PLAN WITHOUT THE EXPRESSED WRITTEN CONSENT OF R.A. SMITH NATIONAL, INC.

FF ELEV = 830.0

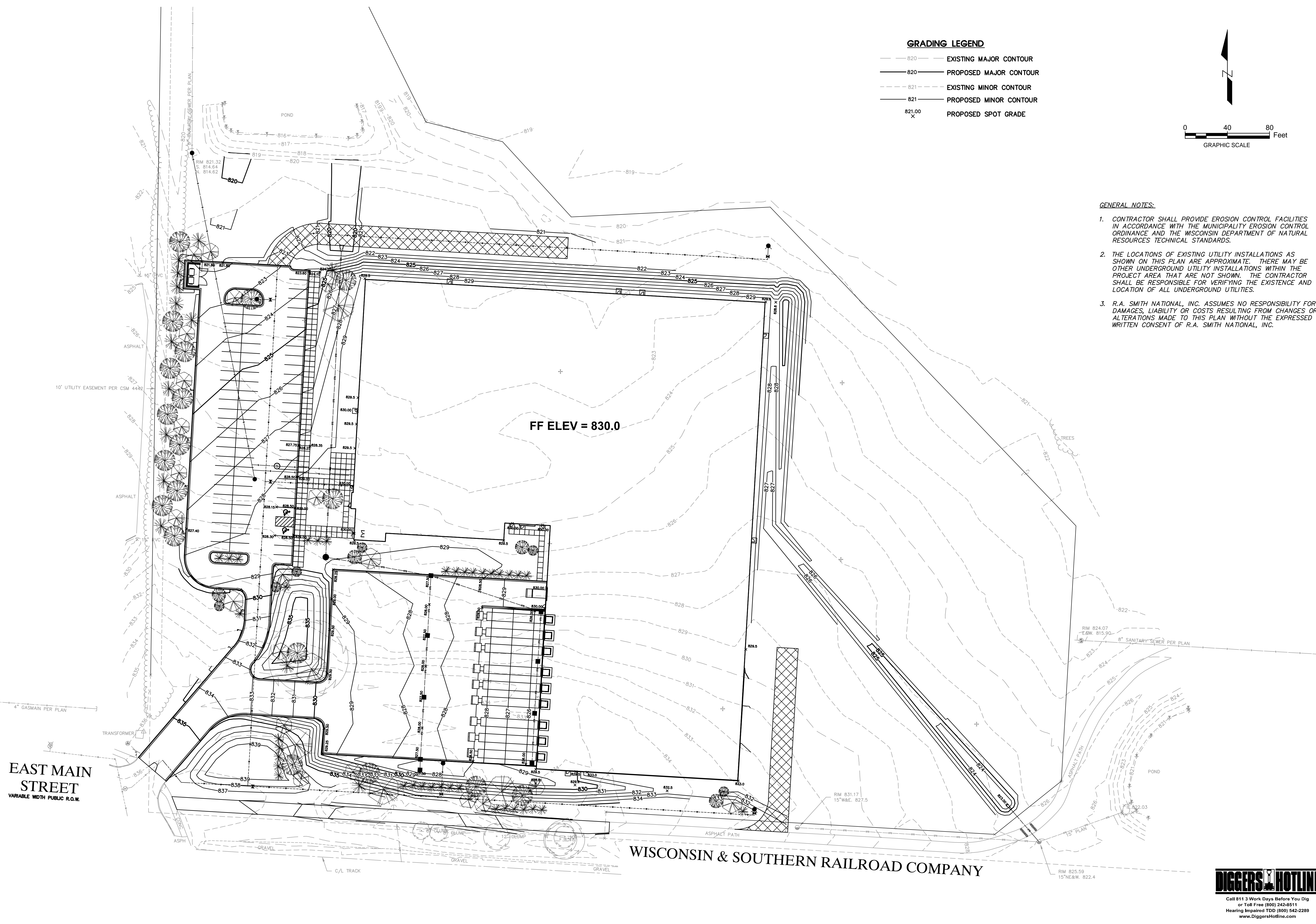

DATE	DESCRIPTION

**R.A. Smith National**  
Beyond Surveying  
and Engineering  
www.rasmithnational.com

DP ELECTRONIC RECYCLING, INC.  
WHITEWATER, WISCONSIN

**GRADING PLAN**

© COPYRIGHT 2015 R.A. Smith National, Inc.
DATE: 11/6/15
SCALE: 1" = 40'
JOB NO. 1150567
PROJECT MANAGER: TROY T. HARTJES, P.E.
DESIGNED BY/PTA
CHECKED BY: TTH
<b>SHEET NUMBER</b>
C-3



H:\1150567\Drawings\Plan\_Site\1150567.dwg, Grading Plan, 11/6/2015 11:00:19 AM, p10