



INNOVATIVE IDEAS
EXCEPTIONAL DESIGN
UNMATCHED CLIENT SERVICE

June 13, 2024

Mr. Rik Kowall
Supervisor
Charter Township of White Lake
7525 Highland Road
White Lake, MI 48383

RE: Elizabeth Lake Road Reconstruction – Sanitary Sewer Lead Installation

Dear Mr. Kowall

In anticipation of the future Township Civic Center Campus, White Lake Township requested a quote from the Contractor performing the Elizabeth Lake Road Reconstruction to complete four (4) pressure sanitary sewer crossings of Elizabeth Lake Road before completion of the new roadway construction. DLZ reached out to Springline Excavating for the quote, which was provided on June 4, 2024 and totals \$116,960.00. (The breakdown of the quote is attached).

The four (4) pressure sanitary sewer crossings include two pressure sanitary sewer services for the proposed Town Hall building and the proposed Public Services building, as well as two services to be capped for future development on the Civic Center site and a future connection to be utilized by Stanley Park.

DLZ is aware that the quote provided is higher than would likely be received if a similar project were put out to bids. However, to avoid cutting through a brand-new roadway and potentially shortening its lifespan, the work must be completed prior to the completion of the project. This additional work will continue to help set the stage for additional upcoming projects the Township has planned. As such, DLZ recommends approving Springline Excavating to complete the additional work as part of the project.

Please feel free to call me if you have any questions on this information.

Sincerely,

Leigh Merrill, P.E.
Project Manager

CC: Sean O’Neil, Director, Community Development Department, White Lake Township

Attachments: Springline Excavating - Sanitary Sewer Crossings Proposal

PLOT DATE: 5/13/2024 12:08:01 PM
 SAVE DATE: 5/13/2024 8:45:16 AM
 D:\Projects\2024\2245\753700\MT - Eliz Lake Rd Reconstruction\01_Construction\CAD\Sheet Files\2245-753700-ROADWAY PLAN - B08 Services.dwg
 D:\Projects\2024\2245\753700\MT - Eliz Lake Rd Reconstruction\01_Construction\CAD\Sheet Files\2245-753700-ROADWAY PLAN - B08 Services.dwg

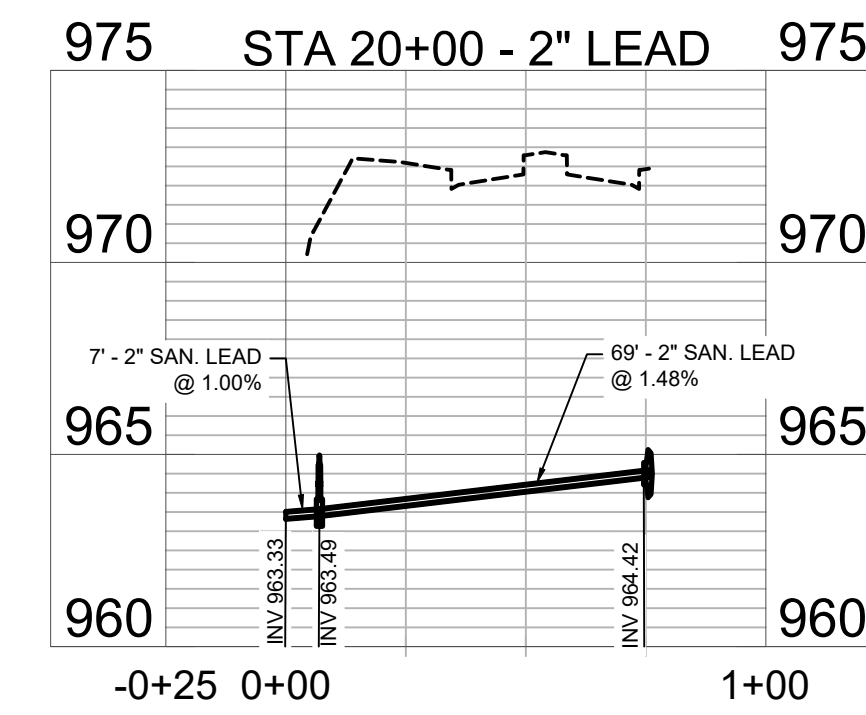
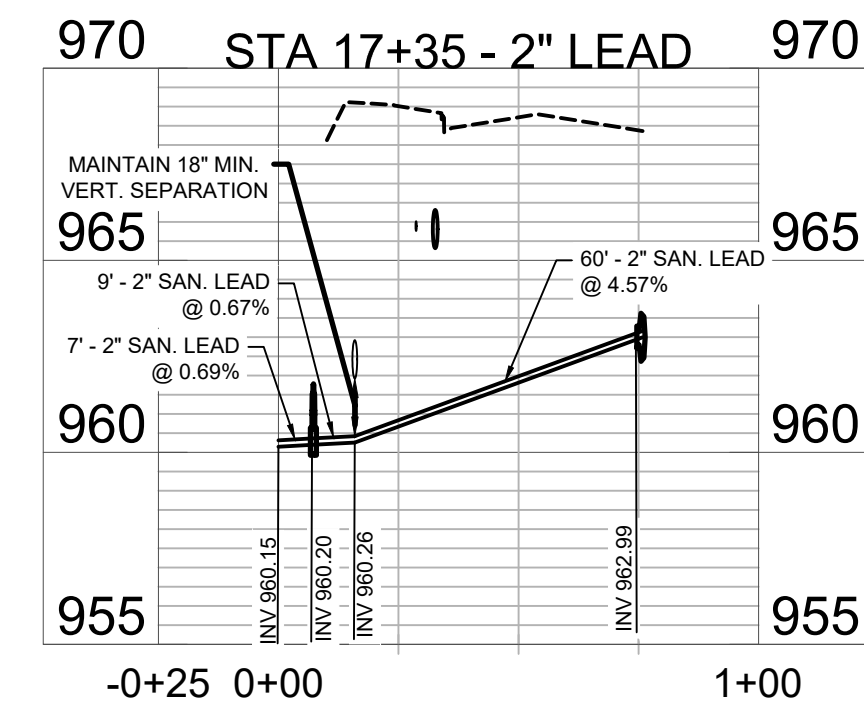
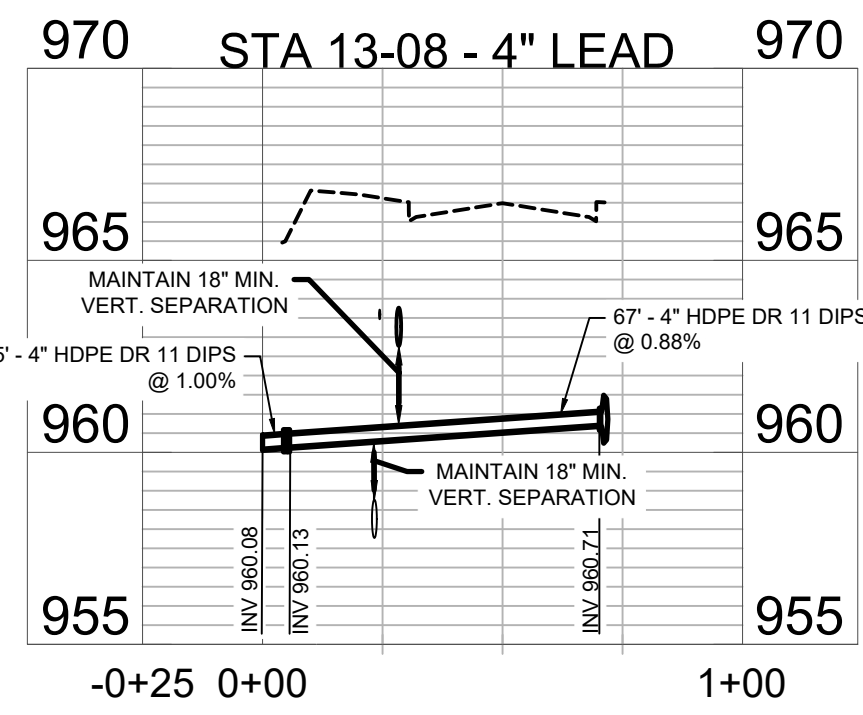
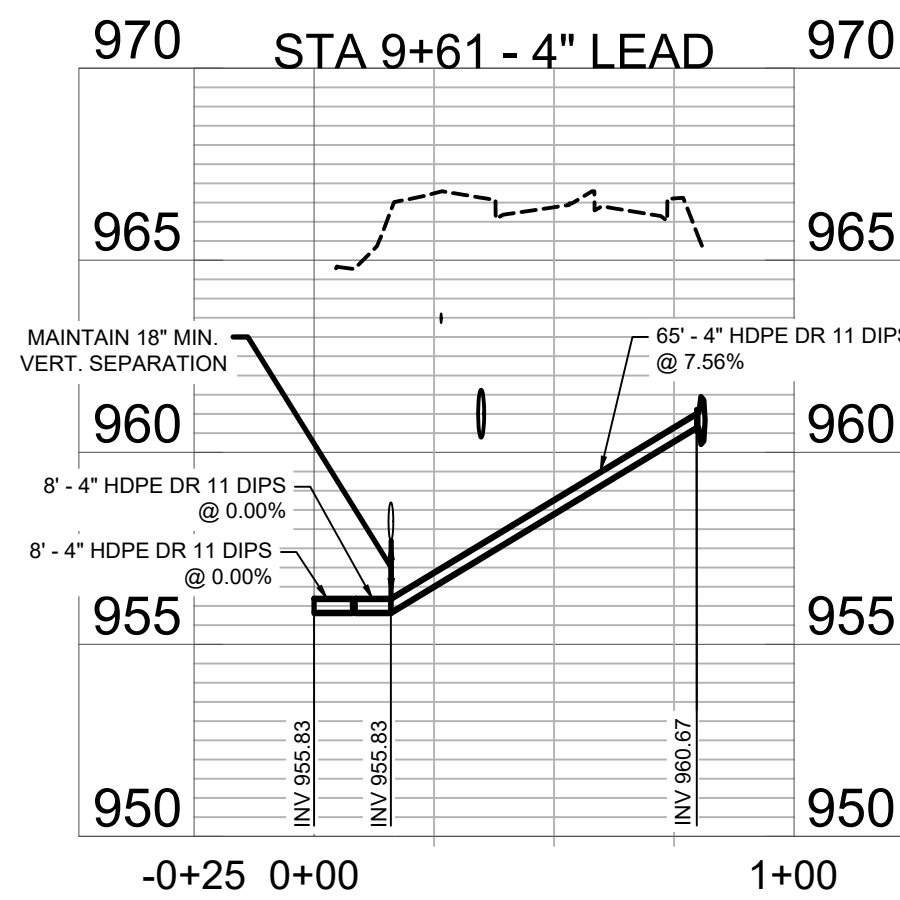
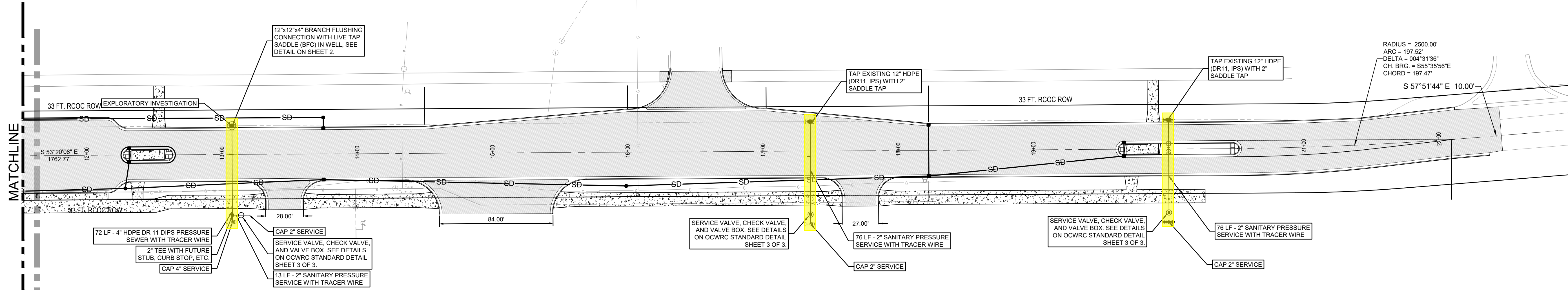
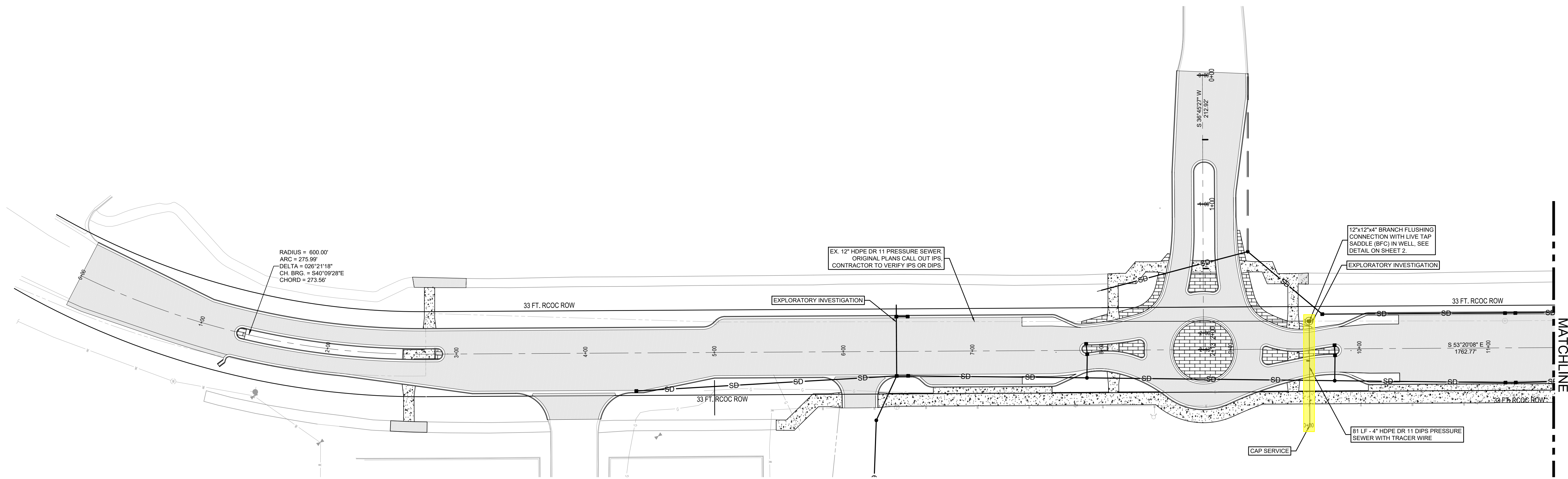

ESTIMATED QUANTITIES ADDENDUM #3

DESCRIPTION	QUANTITY
HDPE DR 11 DIPS PRESSURE SEWER, 4 INCH	153 FT
HDPE DR 9 DIPS PRESSURE SEWER, 2 INCH	165 FT
TRACER WIRE	636 FT
CAP SERVICE, 4 INCH	2 EA
CAP SERVICE, 2 INCH	3 EA
TEE, 4 INCH X 4 INCH X 2 INCH	1 EA
EXPLORATORY INVESTIGATION, VERTICAL	30 FT
TAP CONNECTION WITH 2 INCH SADDLE TAP	2 EA
12"x12"x4" BRANCH FLUSHING CONNECTION WITH LIVE TAP SADDLE (BFC) IN WELL	2 EA
SERVICE VALVE, CHECK VALVE, AND VALVE BOX, 2 INCH	3 EA

WARNING
 UTILITY LOCATIONS ARE NOT CONFIRMED. THOSE SHOWN WERE OBTAINED FROM UTILITY OWNERS OR PLANS. THE CONTRACTOR SHALL NOTIFY UTILITY OWNERS TO HAVE WORK AREA STAKED AND RELOCATED AS NOTED IN THE SPECIFICATIONS. ALL UTILITIES THAT MIGHT INTERFERE WITH CONSTRUCTION.



Township of White Lake
 7525 Highland Road
 White Lake, Michigan 48383

**ELIZABETH LAKE RD. RECONSTRUCTION
 SANITARY SERVICE PLAN**

White Lake, Michigan

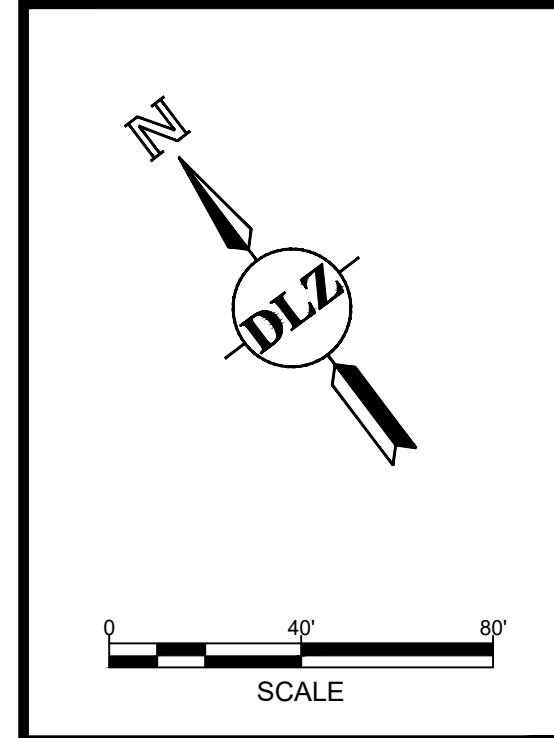

ADDENDUM NO.1	1-26-2024
ADDENDUM NO.2	1-31-2024
ADDENDUM NO.3	5-10-2024
-	-
-	-
-	-
-	-
-	-
-	-

DRAWN BY: DLZ
 DESIGN BY: -
 CHECKED BY: -

DLZ JOB NUMBER: 2245-7537-00

SHEET NO.
 1

Know what's below
 Call before you dig
811 BEFORE YOU DIG CALL
 MISS/DIG SYSTEM, LLC
 1-800-482-7171 www.missdig.net

DLZ
 ARCHITECTURE • ENGINEERING • PLANNING
 SURVEYING • CONSTRUCTION SERVICES

INNOVATIVE IDEAS
 EXCEPTIONAL DESIGN
 UNMATCHED CLIENT SERVICE

Elizabeth Lake Road Sanitary Sewer Crossings

Springline Excavating LLC

32945 Folsom Road

Farmington Hills MI 48336

Contact: Andy Smith

Phone: 586-801-4102

Fax: 248-957-8757

Quote To:

Job Name:

Phone:

Date of Plans:

Fax:

Revision Date:

Springline is a Union Contractor

ITEM	DESCRIPTION	QUANTITY	UNIT	UNIT PRICE	AMOUNT
10	4" HDPE DR 11 DIPS Pressure Sewer	153.00	FT	151.00	23,103.00
20	2" HDPE DR 9 DIPS Pressure Sewer	165.00	FT	132.00	21,780.00
30	Cap Service 4 inch	2.00	EA	1,178.00	2,356.00
40	Cap Service 2 inch	3.00	EA	1,120.00	3,360.00
50	Tee 4 Inchx4 inch x2 inch	1.00	EA	1,635.00	1,635.00
60	Tap Connection with 2 inch Saddle	2.00	EA	4,240.00	8,480.00
70	12"x12"x4" BFC w/ Live Tap in Well	2.00	EA	16,825.00	33,650.00
80	Service Valve Check Valve and Valve Box 2 inch	3.00	EA	3,132.00	9,396.00
90	Exploratory Investigation Vertical	30.00	FT	440.00	13,200.00
GRAND TOTAL					\$116,960.00

NOTES:

Price Does not Include:

Bonds, Dues, Permits, Inspection Fees, Municipal Utility Tap Costs, Quality Control Testing, Surveying or layout. Supply and Handling of Traffic Control Devices. Dewatering, Rock Excavation or blasting.

Price is based upon a mutually agreed upon schedule.