

- LAYOUT NOTES:**
1. THE CONTRACTOR SHALL FIELD VERIFY ALL DIMENSIONS AND QUANTITIES AND SHALL RECORD "AS-BUILT" DIMENSIONS OR LOCATIONS OF ANY APPURTENANCES IF THEY DIFFER FROM THE PLANS.
 2. ALL HANDICAPPED SITE FEATURES SHALL BE CONSTRUCTED TO MEET ALL STATE, LOCAL, AND ADA SPECIFICATIONS AS CURRENTLY IN EFFECT.
 3. CONTACT AFFECTED OWNER(S) A MINIMUM OF 24 HOURS PRIOR TO HALTING OF UTILITY SERVICES. UNDER NO CIRCUMSTANCE SHALL ANY UTILITY SERVICE BE DISCONTINUED FOR MORE THAN ONE (1) 12-HOUR PERIOD.
 4. ALL DISTURBED OFFSITE CONDITIONS SHALL BE REPLACED TO THEIR PREVIOUS CONDITION(S). ANY DAMAGE TO OR REMOVAL OF EXISTING CONDITIONS OCCURRING UPON ADJACENT PROPERTY DURING CONSTRUCTION SHALL BE REPAIRED OR REPLACED TO THEIR PREVIOUS CONDITION(S).
 5. CARE SHALL BE EXERCISED BY THE CONTRACTOR TO PRESERVE AND/OR PROTECT ANY EXISTING VEGETATION OUTSIDE OF AREAS TO BE GRADED. THE PERSON(S) WHO DAMAGES ANY OF THESE AREAS SHALL BE HELD RESPONSIBLE FOR ALL COSTS OF REPLACEMENT MATERIALS AND LABOR.
 6. CONTRACTOR SHALL MAINTAIN POSITIVE DRAINAGE DURING CONSTRUCTION.
 7. ALL ROUTING AND INSTALLATION OF PROPOSED UTILITIES (TELEPHONE, GAS, WATER, ETC.) SHALL BE COORDINATED BETWEEN THE GENERAL CONTRACTOR AND THE APPROPRIATE UTILITY PROVIDER. ALL UTILITY ROUTING SHALL BE APPROVED BY THE OWNER/ENGINEER AND THE APPROPRIATE UTILITY PROVIDER PRIOR TO INSTALLATION. ANY PROPOSED UTILITY ROUTING DESIGNATED ON THESE DOCUMENTS ARE FOR GENERAL GUIDELINES ONLY UNLESS OTHERWISE SPECIFIED. BARTLETT & WEST, INC. ASSUMES NO LIABILITY FOR IMPROPER ROUTING OR CONNECTIONS TO EXISTING UTILITIES.
 8. ALL METHODS AND MEANS OF CONSTRUCTION PERFORMED ON THIS PROJECT SHALL CONFORM TO THE DESIGN CRITERIA FOR THE CITY OF WESTWOOD, KS.
 9. REFER TO SHEET C0.05 FOR UTILITY NOTES, ROUTING, CONNECTIONS, ETC.

- DETAILS & PAVEMENT JOINTING NOTE:**
1. CONTRACTOR SHALL OBTAIN A COPY OF THE CITY OF WESTWOOD ENGINEERING DEPARTMENT STANDARD DETAILS AS SOME PERTAIN TO THIS PROJECT.
 2. CONTRACTOR SHALL SUPPLY TO THE OWNER AND PROJECT ENGINEER FOR REVIEW A JOINTING PLAN FOR ALL CONCRETE PAVEMENT PRIOR TO PLACING ANY CONCRETE ON PROJECT SITES.
 3. REFER TO SHEETS C0.07 - C0.08 FOR SITE DETAILS & CITY OF WESTWOOD, KS DETAILS.

PAVEMENT LEGEND

	INSTALL 8" OF CONCRETE (NON-REINFORCED) ON 8" OF ROCK ON COMPACTED SUBGRADE
	INSTALL 4" OF CONCRETE SIDEWALK PAVEMENT ON 6" OF COMPACTED SUBGRADE

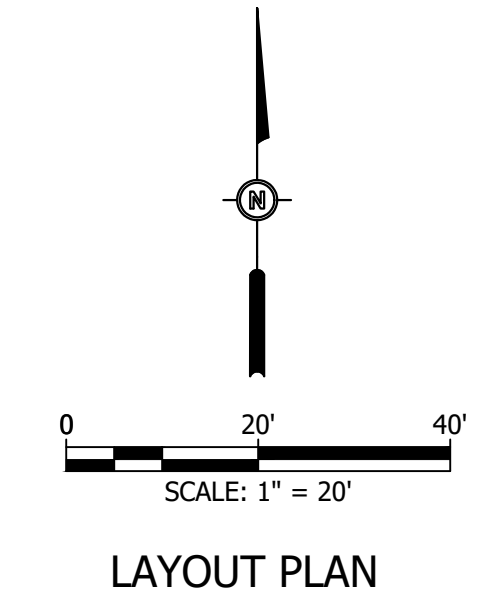

Drawing Name: W:\Proj\10000\19976\19976.001\AutoCAD\Plan Set\19976.00.C.LAYOUT PLAN.dwg
 Layout Name: LAYOUT PLAN
 Printed on: 10/14/2020 2:15:29 PM
 Last edit on: 10/14/2020 12:29 PM by: PR070452