

WINDOW TYPES

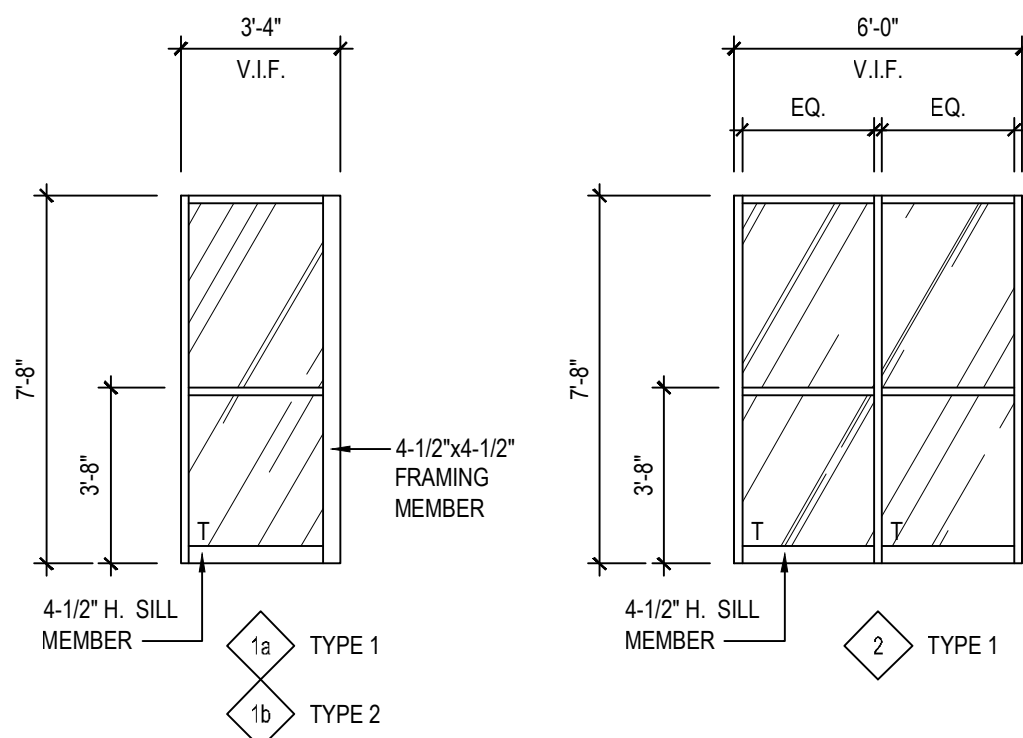

STOREFRONT SYSTEMS

TYPE 1
KAWNEER 451T (2'x4-1/2') w/ THERMAL BREAK, CENTER GLAZED
COLOR: CLEAR ANODIZED
THERMAL PERFORMANCE:
SHGC=0.35 U=0.36

1" INSUL. CLEAR GLAZING SOLARBAN 60 CLEAR - CLEAR w/ ARGON (OR APPROVED EQUAL)
SHGC=0.39 U=0.24

TYPE 2
KAWNEER 450 (2'x4-1/2')
CENTER GLAZED
COLOR: CLEAR ANODIZED
1/4" CLEAR GLAZING

NOTES:
1. ALL DIMENSIONS TO BE FIELD VERIFIED BEFORE FABRICATION
2. 'T' - DENOTES TEMPERED GLAZING

ROOM FINISH SCHEDULE

ROOM #	ROOM NAME	FLOOR	WALLS	BASE	CEILING	COMMENTS
101	VESTIBULE	POLISHED CONC.	CMU P-1	-	ACT-2	-
102	SALES	POLISHED CONC. LVT-2	CMU P-1, P-3, P-6	VB-1	EXP. SHOP PRIME (GRAY)	NOTES 1, 2, 3, 5 & 9
104	DRESSING ROOM	LVT-2	CMU / GYP P-1, P-4	VB-1	OPEN	NOTES 1, 4 & 8
105	STOCKROOM	POLISHED CONC.	CMU P-1, P-3	VB-1	EXP. SHOP PRIME (GRAY)	NOTES 3 & 5
106	HALL	POLISHED CONC.	CMU / GYP P-2, P-3, FRP-1	VB-1	8" AFF	NOTES 3 & 7
107	MANAGER	POLISHED CONC.	CMU / GYP P-2, P-3	VB-1	ACT-1 8" AFF	NOTE 3
108	EMPLOYEE LOUNGE	POLISHED CONC.	CMU / VR GYP FRP-1, P-2	VB-1	ACT-1 8" AFF	NOTE 3
109	MEN	POLISHED CONC.	CMU / VR GYP FRP-1, P-2	VB-1	ACT-1 8" AFF	NOTE 6
110	WOMEN	POLISHED CONC.	CMU / VR GYP FRP-1, P-2	VB-1	ACT-1 8" AFF	NOTE 6
111	IT / ELEC	POLISHED CONC.	CMU / FLY P-1, P-3	VB-1	EXP. SHOP PRIME (GRAY)	-
112	PET WASH	EPOXY	WR GYP FRP-1	EPOXY	ALUM. MESH 10" AFF	-

- REFER TO VENDOR TERRITORY MAP ON A0.0 FOR LUXURY VINYL TILE VENDOR INFORMATION. DELIVERED BY TSC; SUPPLIED, PURCHASED & INSTALLED BY G.C.
- 12" H. ACCENT STRIPE @ 10'-3" FROM FINISH FLOOR TO BOTTOM OF STRIPE; PAINT P-6
- DOORS & FRAMES; PAINT P-3
- DOOR & FRAME; PAINT P-4
- EXPOSED COLUMNS; PAINT P-3
- FRP FROM FLOOR TO 48" AFF. PAINT FROM 48" AFF TO CEILING. FRP WAINSCOT ON NON-MASONRY WALLS ONLY.
- FRP @ WATER COOLER ALCOVE TO 48" AFF
- SALES SIDE OF DRESSING ROOM WALLS TO BE PREPARED & PRIMED AS SCHEDULED. WALL COVERING PROVIDED & INSTALLED BY TSC.
- EXPOSED CONDUIT TO BE PAINTED TO MATCH ADJACENT WALL FINISH.

MATERIAL SCHEDULE

MATERIAL	SYMBOL	DESCRIPTION	NUMBER	COLOR	MFG.	COMMENTS
METAL	MTL-1	CORRUGATED METAL PANELS w/ EXPOSED FASTENERS	-	GALVALUME PLUS	MBCI	26GA, MATCHING TRIM & ACCESSORIES
	MTL-2	LOKSEAM (12") STANDING SEAM METAL ROOF PANELS	-	GALVALUME PLUS	MBCI	26GA, MATCHING TRIM & ACCESSORIES
	MTL-3	w/ EXPOSED FASTENERS	-	DESERT SAND	MBCI	26GA, MATCHING TRIM & ACCESSORIES
WALL COVERING	WC-1	SUPPLIED & INSTALLED BY TSC	-	-	-	PREPARE SURFACES AS SCHEDULED
	LVT-1	EARTHWORKS WOOD CLASSIC PLANK	-	SEVORA	SWIFF-TRAIN	7.24" x 37.4"; GLUE-DOWN
LUXURY VINYL TILE	LVT-2	SOMA LUXURY VINYL PLANK	-	RUSSET	NORTH STAR	7.24" x 37.4"; GLUE-DOWN
	VB-1	4" VINYL COVED	CS-40	BLACK	JOHNSONITE	PROVIDE PRE-FORMED CORNERS
WALL COVERING	WC-1	STYLE: UPPER HAND	CAJ-3001	GOLDEN OCHRE	GILFORD	
	P-1	REFER TO APPLICATION SCHEDULE	SW7005	PURE WHITE	SHERWIN WILLIAMS	
	P-2	REFER TO APPLICATION SCHEDULE	SW7036	ACCESSIBLE BEIGE	SHERWIN WILLIAMS	
	P-3	REFER TO APPLICATION SCHEDULE	SW1012	POWER GREY	SHERWIN WILLIAMS	
	P-4	REFER TO APPLICATION SCHEDULE	SW7513	SANDERLING	SHERWIN WILLIAMS	
	P-5	REFER TO APPLICATION SCHEDULE	SW7532	URBAN PUTTY	SHERWIN WILLIAMS	
	P-6	REFER TO APPLICATION SCHEDULE	SW4081	SAFETY RED	SHERWIN WILLIAMS	
	P-7	REFER TO APPLICATION SCHEDULE	SW4084	SAFETY YELLOW	SHERWIN WILLIAMS	
	P-8	REFER TO APPLICATION SCHEDULE	SW6196	FROSTY WHITE	SHERWIN WILLIAMS	
	P-9	REFER TO APPLICATION SCHEDULE	SW7658	GRAY CLOUDS	SHERWIN WILLIAMS	
	P-10	REFER TO APPLICATION SCHEDULE	SW7067	CITYSCAPE	SHERWIN WILLIAMS	
PLASTIC LAMINATE	LAMA-1	PLASTIC LAMINATE	4857-60	SHADOW ZEPHER	WILSONART	
ACOUSTIC TILE	ACT-1	2x4 DUNE - SQUARE EDGE	1776	WHITE	ARMSTRONG	PRELUDE 15/16" EXPOSED T-GRID, COLOR: WHITE
	ACT-2	1/2x2x4 GRIDSTONE GYPSUM CEILING PANELS	-	WHITE	GOLD BOND / ARMSTRONG	PRELUDE 15/16" EXPOSED T-GRID, COLOR: WHITE
FRP	FRP-1	GLASLINER	XA	WHITE	GLASTEEL	TEXTURED

FINISH APPLICATION SCHEDULE

CONCRETE MASONRY UNITS (EXTERIOR)
SHEEN: FLAT
1ST COAT: SHERWIN WILLIAMS LOXON ACRYLIC BLOCK SURFACER, LX01W0200 (50-100 SQ FT/ GAL @ 16 MILS WET; 8 MILS DRY)
2ND COAT: SHERWIN WILLIAMS CONFLX XL SMOOTH HIGH BUILD ACRYLIC COATING, CF11 SERIES
3RD COAT: SHERWIN WILLIAMS CONFLX XL SMOOTH HIGH BUILD ACRYLIC COATING, CF11 SERIES (16 MILS WET, 7.5 MILS PER DRY COAT) (ACCEPTABLE TOLERANCE IS 9-10 PINHOLES PER SQ. FT.)

CONCRETE MASONRY UNITS (INTERIOR)
SHEEN: SEMI-GLOSS
1ST COAT: SHERWIN WILLIAMS PREPRITE BLOCK FILLER B25W25 (75-125 SQ. FT./GAL @ 16 MILS WET, 8 MILS DRY)
2ND COAT: SHERWIN WILLIAMS PROMAR 400 ZERO VOC INTERIOR LATEX SEMI-GLOSS, B31W04651 SERIES
3RD COAT: SHERWIN WILLIAMS PROMAR 400 ZERO VOC INTERIOR LATEX SEMI-GLOSS, B31W04651 SERIES (4 MILS WET, 1.3 MILS DRY PER COAT)

INTERIOR COLUMNS
SHEEN: GLOSS
1ST COAT: SHERWIN WILLIAMS KEM KROMIK UNIVERSAL METAL PRIMER, B50Z SERIES (6.0 MILS WET, 3.0 - 4.0 MILS DRY PER COAT)
2ND COAT: SHERWIN WILLIAMS PROMAR 400 ZERO VOC INTERIOR LATEX SEMI-GLOSS, B31W04651 SERIES
3RD COAT: SHERWIN WILLIAMS PROMAR 400 ZERO VOC INTERIOR LATEX SEMI-GLOSS, B31W04651 SERIES (4 MILS WET, 1.3 MILS DRY PER COAT)

GYPSUM BOARD PREPARATION TO RECEIVE WALLCOVERING
1 COAT: SHERWIN WILLIAMS PREPRITE 200 ZERO VOC INTERIOR LATEX PRIMER, B28W02600

GYPSUM BOARD & PLYWOOD
SHEEN: SEMI-GLOSS
1ST COAT: SHERWIN WILLIAMS PROMAR 200 ZERO VOC INTERIOR LATEX PRIMER, B28W02600 (4 MILS WET, 1.3 MILS DRY PER COAT)
2ND COAT: SHERWIN WILLIAMS PROMAR 400 ZERO VOC INTERIOR LATEX SEMI-GLOSS, B31W04651 SERIES
3RD COAT: SHERWIN WILLIAMS PROMAR 400 ZERO VOC INTERIOR LATEX SEMI-GLOSS, B31W04651 SERIES (4 MILS WET, 1.3 MILS DRY PER COAT)

HOLLOW METAL DOORS & FRAMES
SHEEN: GLOSS
1ST COAT: FACTORY PRIMED
2ND COAT: SHERWIN WILLIAMS PROMAR 400 ZERO VOC INTERIOR LATEX SEMI-GLOSS, B31W04651 SERIES
3RD COAT: SHERWIN WILLIAMS PROMAR 400 ZERO VOC INTERIOR LATEX SEMI-GLOSS, B31W04651 SERIES (4 MILS WET, 1.3 MILS DRY PER COAT)

WOOD DOORS
SHEEN: SEMI-GLOSS
1ST COAT: SHERWIN WILLIAMS PREPRITE 200 ZERO VOC INTERIOR LATEX PRIMER, B28W02600 (4 MILS WET, 1.3 MILS DRY PER COAT)
2ND COAT: SHERWIN WILLIAMS PROMAR 400 ZERO VOC INTERIOR LATEX SEMI-GLOSS, B31W04651 SERIES
3RD COAT: SHERWIN WILLIAMS PROMAR 400 ZERO VOC INTERIOR LATEX SEMI-GLOSS, B31W04651 SERIES (4 MILS WET, 1.3 MILS DRY PER COAT)

POLISHED CONCRETE
(VESTIBULE SALES, RESTROOMS, CORRIDOR, MANAGER'S OFFICE & EMPLOYEE LOUNGE)
SLAB PREPARATION:
A. JOINT FILLER: THE EUCLID CHEMICAL COMPANY QWIK JOINT POLYUREA JOINT FILLER
B. CRACK REPAIR MATERIAL: THE EUCLID CHEMICAL COMPANY EUCCO 700 EPOXY JOINT FILLER
C. PATCHING MATERIAL
a. MULTIPLE MINOR SURFACE DEFECTS & IRREGULARITIES: HI-TECH TX-3
b. FEATHEREDGE PATCHES: ARDEX SD-P BY ARDEX ENGINEERED CEMENTS, SELF-DRYING, FAST SETTING CONCRETE UNDERLAYMENT FOR PATCHES 0"-1" DEEP WITH ADDITION OF APPROPRIATE AGGREGATE TO MATCH EXISTING.
c. FLOOR TRENCHES (WHERE APPLICABLE); REFER TO STRUCTURAL

MECHANICALLY GRIND & POLISH
1. 100 GRIT RESIN BONDED DIAMONDS
2. 200 GRIT RESIN BONDED DIAMONDS
3. APPLY ONE COAT OF CONCRETE DENSIFIER AT A RATE OF APPROXIMATELY 400-800SF PER GALLON MAKING SURE TO KEEP WET FOR 30 MINUTES.
4. 400 GRIT RESIN BONDED DIAMONDS
5. 800 GRIT RESIN BONDED DIAMONDS (MID-LEVEL GLOSS)
6. INSTALL JOINT/CRACK FILLER

SEALED CONCRETE
(STOCKROOM & IT/ELEC)
1. SINGLE-CUT GRIND
2. APPLY SEALER

EPOXY FLOORING
SLAB PREPARATION:
A. NEWLY PLACED CONCRETE SURFACES SHOULD BE CURED FOR A MINIMUM OF 28 DAYS PRIOR TO COATING. CONCRETE SURFACES MUST BE STRUCTURALLY SOUND, FREE OF LOOSE OR DETERIORATED CONCRETE AND FREE OF DUST, DIRT, PAINT EFFLORESCENCE, OIL AND OTHER CONTAMINANTS. MECHANICALLY ABRASE THE SURFACE TO ACHIEVE A SURFACE PROFILE EQUAL TO CSP 2-3 IN ACCORDANCE WITH ICR GUIDELINE 310.2. PROPERLY CLEAN PROFILED AREA. THE PH OF THE SURFACE SHOULD BE CHECKED ACCORDING TO ASTM D 4922. FOLLOWING SURFACE PREPARATION, THE CLEANED SURFACE SHOULD HAVE A MINIMUM SURFACE-TENSILE STRENGTH OF 200 PSI WHEN TESTED WITH AN ELCOMETER OR SIMILAR PULL TESTER (ASTM D 4541).
B. CURE USING "KUREZ DR VOX" OR "KUREZ DR 100" AT AN APPLICATION RATE OF 400 SF/GALLON
C. JOINT FILLER: THE EUCLID CHEMICAL COMPANY QWIK JOINT POLYUREA JOINT FILLER
D. EPOXY PRODUCTS:
1. INITIAL COAT: "INCRETE HIGH PERFORMANCE EPOXY" 1 GALLON KIT (GRAY COLOR) BY EUCLID CHEMICAL
2. PIGMENTED CHIPS: "INCRETE GRANITE COAT CHIPS" (MICA COLOR) BY EUCLID CHEMICAL
3. GROUT COAT: "INCRETE HIGH PERFORMANCE EPOXY" 1 GALLON KIT (CLEAR COLOR) BY EUCLID CHEMICAL
4. FINAL WEAR COAT: "INCRETE POLYSEAL POLYASPARTIC" 2 GALLON KIT (CLEAR COLOR) BY EUCLID CHEMICAL
E. MIX & APPLY PRODUCTS PER MANUFACTURER REQUIREMENTS
F. COVE BASE: PROVIDE 4" COVE BASE FROM THE FLOOR TO THE FRP WALL TRANSITION. REFER TO DRAWINGS FOR DETAILS.

PAINT NOTES:
A. APPLICATORS MAY UTILIZE BRUSH, ROLLER OR AIRLESS SPRAYER METHODS
B. ALL COATS MUST BE BACK-ROLLED
C. REFER TO SHERWIN WILLIAMS DATA SHEET APPLICATION RECOMMENDATIONS

DOOR & FRAME SCHEDULE

NO.	DOORS				FRAMES		HARDWARE	COMMENTS
	TYPE	DESCRIPTION	SIZE	FINISH	MATERIAL	FINISH		
101	A1	BI-PART AUTOMATIC SLIDING	PKG 14'-0" x 7'-8"	CLEAR ANODIZED	ALUMINUM	CLEAR ANODIZED	1A	NOTES 3 & 10
102A	A1	BI-PART AUTOMATIC SLIDING	PKG 14'-0" x 7'-8"	CLEAR ANODIZED	ALUMINUM	CLEAR ANODIZED	1B	NOTES 3 & 10
102B	A2	AUTOMATIC SLIDER	PKG 9'-0" x 7'-8"	CLEAR ANODIZED	ALUMINUM	CLEAR ANODIZED	1A	NOTES 3 & 10
102C	B	ALUMINUM / GLASS	3'-0" x 7'-0"	CLEAR ANODIZED	ALUMINUM w/ 4" HEAD	CLEAR ANODIZED	1C	NOTES 4, 5 & 10
104	H	SOLID WOOD	3'-0" x 5'-8"	PAIR	P-4	HOLLOW METAL w/ 4" HEAD	P-4	4
105A	C	INSUL	3'-0" x 7'-0"	P-3 (INT)	HOLLOW METAL	P-3 (EXT)	P-3 (INT) P-9 (EXT)	5
105B	G	SOLID WOOD	3'-0" x 7'-0"	P-3	HOLLOW METAL	P-3	P-3	6
105C	E	SECTIONAL O.H.D.	10'-0" x 10'-0"	-	-	-	-	2
105D	E	SECTIONAL O.H.D.	10'-0" x 10'-0"	-	-	-	-	2
105E	D	SWINGING IMPACT	3'-0" x 8'-0"	PAIR	SUPPLIED BY TSC	-	-	2
106	C	INSUL HOLLOW METAL	4'-0" x 7'-0"	P-3 (INT) P-8 (EXT)	HOLLOW METAL w/ 4" HEAD	-	-	P-3 (INT) P-8 (EXT)
107	C	SOLID WOOD	3'-0" x 7'-0"	-	HOLLOW METAL	-	-	7
108	C	SOLID WOOD	3'-0" x 7'-0"	-	HOLLOW METAL	-	-	6
109	C	SOLID WOOD	3'-0" x 7'-0"	-	HOLLOW METAL	-	-	7
110	C	SOLID WOOD	3'-0" x 7'-0"	-	HOLLOW METAL	-	-	8
111	C	SOLID WOOD	3'-0" x 7'-0"	-	HOLLOW METAL	-	-	7
112	F	ALUMINUM / GLASS MEDIUM STYLE	3'-0" x 7'-0"	CLEAR ANODIZED	ALUMINUM	CLEAR ANODIZED	1D	NOTES 6 & 10
R01	J	HOLLOW METAL	3'-0" x 3'-0"	P-8	HOLLOW METAL (WELDED)	-	P-8	9

- INSULATED SECTIONAL DOOR w/ ELECTRIC OPERATOR, (2) RADIO REMOTES, TIMER, CHAIN KEEPER AND REVERSING SAFETY EDGE. OVERRIDE BUTTON TO BE SUPPLIED BY OVERHEAD DOOR VENDOR & INSTALLED BY G.C. COLOR: FACTORY FINISHED WHITE.
- INSTALL PLASTIC AIR CURTAIN (PROVIDE BY OHD VENDOR) w/ 50% PANEL OVERLAP AT MASONRY OPENING INSIDE DOOR OPENING.
- FLAT THRESHOLD PROVIDED BY SLIDING DOOR MANUFACTURER
- STOREFRONT FRAMING SYSTEM - KAWNEER 451T (2'x4-1/2") w/ THERMAL BREAK. PROVIDE 4" HEAD @ MASONRY
- (2) - 2" H. CRASH RAILS (PUSH SIDE) EACH DOOR
- STOREFRONT FRAMING SYSTEM - KAWNEER 451T (2'x4-1/2") w/ THERMAL BREAK. 1/4" TEMPERED GLASS SIDELIGHTS
- IMPACT DOORS
72" x 96", 72" x 84" OR 36" x 96" OPENINGS - ELIASON #P11 PLUS, w/ 10" x 30" ADA COMPLIANT ACRYLIC WINDOWS, 18" TALL BUMPERS, COLOR: RED
96" x 120" OPENINGS - DURULITE STANDARD w/ 20" x 30" ADA COMPLIANT POLYCARBONATE WINDOWS, 36" TALL BUMPERS, COLOR: RED.
- VISION PANEL - WINDOW KIT w/ 1/4" CLEAR TEMPERED GLASS w/ GLAZING TAPE BY ANEMOSTAT. PROVIDED BY DOOR & HARDWARE VENDOR. PAINT FRAME SW7513 SANDERLING BY SHERWIN WILLIAMS KEYSIDE
- PROVIDE & INSTALL "EMPLOYEES ONLY" SIGN AS DIRECTED BY TSC PM
- KEYED ALIKE

HARDWARE NOTES:
ALL HANDLES, PULLS, LATCHES, LOCKS AND OTHER OPERATING DEVICES ON ACCESSIBLE DOORS SHALL HAVE A SHAPE THAT IS EASY TO GRASP WITH ONE HAND AND DOES NOT REQUIRE TIGHT GRASPING, PINCHING OR TWISTING TO OPERATE.
MAXIMUM EFFORT TO OPERATE DOORS SHALL NOT EXCEED FIVE (5) POUNDS; PUSH & PULL HARDWARE FOR PAIRS OF DOORS IS FOR EACH LEAF, UNLESS NOTED.
FIRE & SMOKE RATED DOOR ASSEMBLIES SHALL HAVE SMOKE GASKETS & SWEEP AS NECESSARY TO PASS UL 1784.
LOCKSET INSTRUCTIONS
LOCKSETS SHALL BE PROVIDED w/ CONSTRUCTION CORES.
PRIOR TO TURN-OVER, G.C. SHALL REMOVE & REPLACE CONSTRUCTION CORES w/ PERMANENT "INSTAKEY" CORES SUPPLIED BY VENDOR.
CONSTRUCTION CORES SHALL BE COLLECTED, PACKAGED IN VENDOR PROVIDED CARTON, OBTAIN SIGNATURE (ON INCLUDED RECEIPT) OF TSC RM.
CARTON SHALL BE SEALED AND RETURNED TO VENDOR.

DOOR TYPES

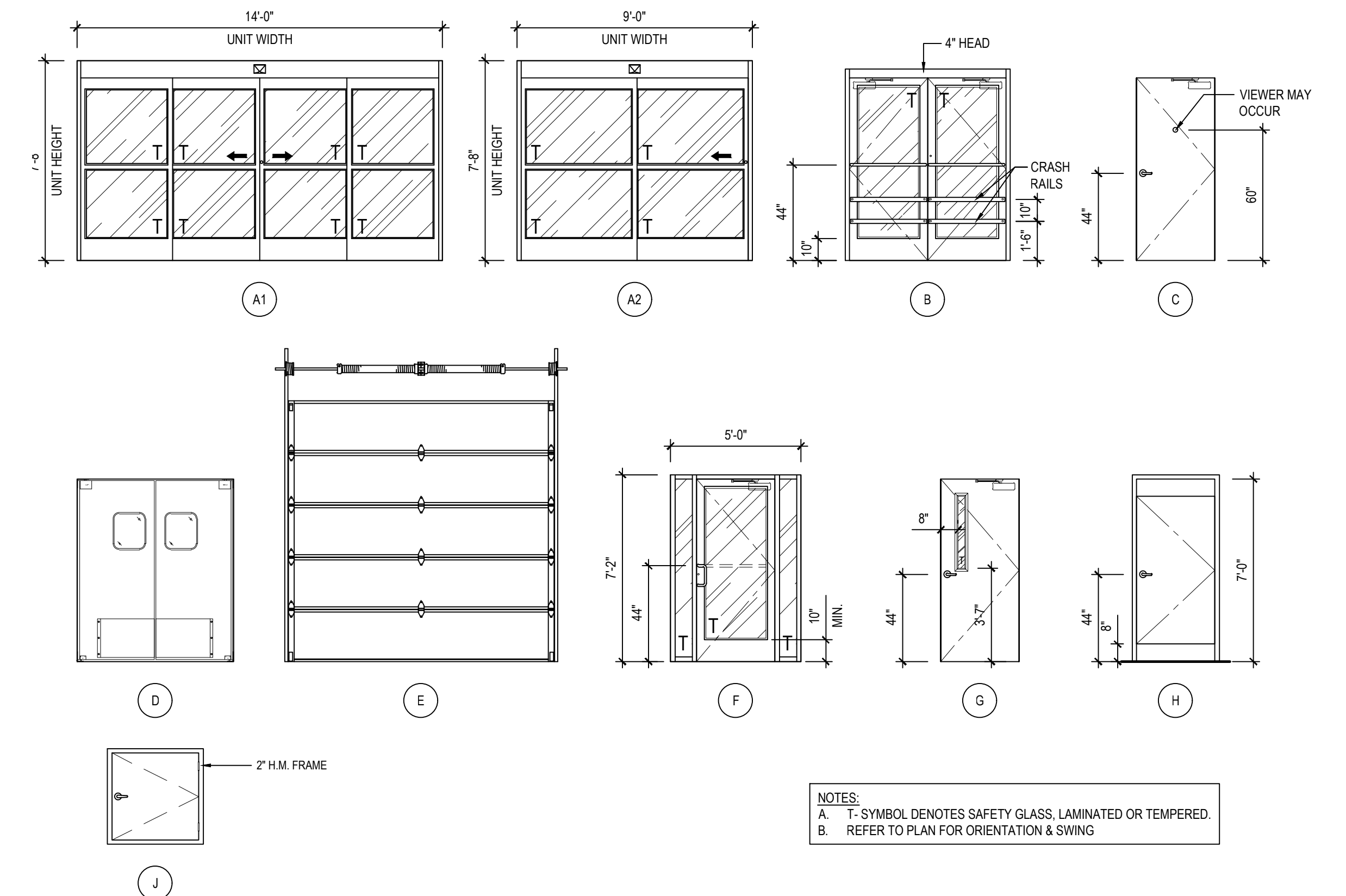

HARDWARE SCHEDULE

SET #	QUANTITY	ITEM	MFG.	SET #	QUANTITY	ITEM	MFG.
1A	1 EA	MORTISE CYLINDER 28107-1-26D	ILC	5B	3 EA	HINGES MPB79 4 1/2 X 4 1/2 NRP-26D	MCK
	1 EA	10C7A2 (GREEN CONSTRUCTION CORE)-GREEN	BEST		1 EA	RIM EXIT DEVICE V40 X DC X EE X TSC-711	DET
	1 EA	MORTISE THUMB TURN CYLINDER-26D	ILC		1 EA	POWER TRANSFER P75	DET
1B	2EA	DUMMY CYLINDER 71600-26D	ILC	1 EA	MORTISE CYLINDER 28107-1-26D	ILC	
	1 EA	BALANCE OF HARDWARE BY DOOR SUPPLIER	-	1 EA	CLOSER, PARALLEL ARM SC81A X DS X SLIM-689	FAL	
	1 EA	BALANCE OF HARDWARE BY DOOR SUPPLIER	-	1 EA	THRESHOLD 896 V- MILL	NAT	
1C	1 EA	THUMB TURN -CYLINDER -26D	ILC	1 EA	WEATHER STRIPING 160V- MILL	NAT	
	1 EA	MORTISE CYLINDER 28107-1-26D	ILC	1 EA	D RIP CAP 16A-A	NAT	
	1 EA	D RIP CAP 16A X 76 - A	NAT	6	3 EA	HINGES MPB79 4 1/2 X 4 1/2 NRP-26D	MCK
1D	1 EA	MORTISE CYLINDER 28107-1-26D	ILC	1 EA	OFFICE LOCKSET T511 X D X 23981137 X 5164 X 1 3/4-626	FAL	
	1 EA	THUMB TURN -CYLINDER -26D	ILC	1 EA	CLOSER SC81A X RWIPA X SLIM-689	FAL	
	1 EA	CYLINDER CORE 10C7A2 (GREEN CONSTRUCTION CORE)	BEST	1 EA	WALL STOP WS407-CCV-US32D	IVE	
2	1 EA	BALANCE OF HARDWARE BY DOOR SUPPLIER	-	3 EA	SILENCERS SR64-GRY	IVE	
3	1 EA	ALL HARDWARE BY DOOR SUPPLIER	-	7	3 EA	HINGES MPB79 4 1/2 X 4 1/2 NRP-26D	MCK
4	1 EA	NOT USED	-	1 EA	OFFICE LOCKSET T511 X D X 23981137 X 5164 X 1 3/4-626	FAL	
	1 EA	CONTINUOUS HINGE 22HD	MCK	1 EA	CLOSER SC81A X RWIPA X SLIM-689 (DOOR 11 ONLY)	FAL	
	3 EA	PRIVATE LOCK T301S X D X 23981137 X 5164 X 1 3/4-626	FAL	1 EA	WALL STOP WS407-CCV-US32D	IVE	
5A	3 EA	SILENCERS SR64-GRY	IVE	3 EA	SILENCERS SR64-GRY	IVE	
	1 EA	HINGES MPB79 4 1/2 X 4 1/2 NRP-26D	MCK	8	3 EA	HINGES MPB79 4 1/2 X 4 1/2 NRP-26D	MCK
	2 EA	ALARMED EXIT DEVICE EOL-290D-GRAY	DET	1 EA	OFFICE LOCKSET T301S X D X 23981137 X 5164 X 1 3/4-626	FAL	
1 EA	1 EA	RIM CYLINDER R28207-9	ILC	1 EA	CLOSER SC81A X RWIPA X SLIM-689	FAL	
	1 EA	SURFACE PULL 8N US28 (INTERIOR)	HAG	1 EA	WALL STOP WS407-CCV-US32D	IVE	
	1 EA	CLOSER, PARALLEL ARM SC81A X DS X SLIM-689	FAL	3 EA	SILENCERS SR64-GRY	IVE	
1 EA	1 EA	THRESHOLD 896V- MILL	NAT	9	2 EA	HINGES MPB79 4 1/2 X 4 1/2 NRP-26D	MCK
	1 EA	DOOR BOTTOM 795WH- MILL	NAT	1 EA	OFFICE LOCKSET T511 X D X 23981137 X 5164 X 1 3/4-626	FAL	
	1 EA	WEATHERSTRIP 160V- MILL	NAT	1 EA	WEATHER STRIPING 160V-MILL	NAT	
1 EA	D RIP CAP 16A-A	NAT					
1 EA	VIEWER U698 B26D (MOUNT 60" F.F.)	IVE					

MANUFACTURER ABBREVIATIONS
BEST - BEST ACCESS ILC - ILC HAG - HAGER MCK - MCKINNEY
DET - DETEX ILO - ILO NAT - NATIONAL GUARD
FAL - FALCON IVE - IVE

onyx creative
25001 Emory Road, Suite 400
Cleveland, Ohio 44128
216.222.3220
onyxcreative.com
FL, L.L.C. AR 95693

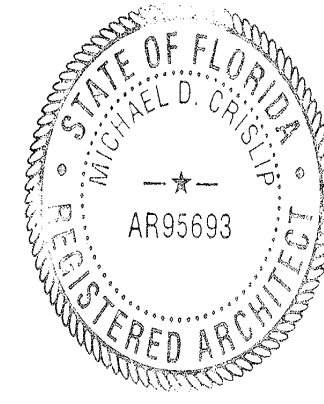

Design and construction documents are instruments of service and are given in confidence and remain the property of Michael Drisp, Architect. The use of this design and/or construction documents for purposes other than the specific project named herein is strictly prohibited without expressed written consent of Michael Drisp, Architect.

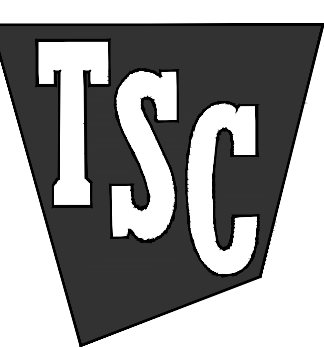

PROPOSED NEW
TRACTOR SUPPLY
PERSIMMON BLVD & SEMINOLE PRATT WHITNEY RD.
WESTLAKE, FL

Project No.: 24-0043
Drawn By: CFM

Date: Issue
2-8-2024 City Submission

A0.1

DOOR & FINISH SCHEDULES