

Plotted By: Gerard, Cameron. Sheet Set: GROVE MARKETPLACE_CHASE Layout: TM PLAN December 16, 2024 05:46:54pm K:\STP_Civil\145538 - Premier Developers\000 - Grove Marketplace\CADD\PlanSheets\TM-Tree Mitigation.dwg
 This document, together with the concepts and designs presented herein, is intended only for the specific purpose and client for which it was prepared. Reuse of and improper reliance on this document without written authorization and adaptation by Kimley-Horn and Associates, Inc. shall be without liability to Kimley-Horn and Associates, Inc.

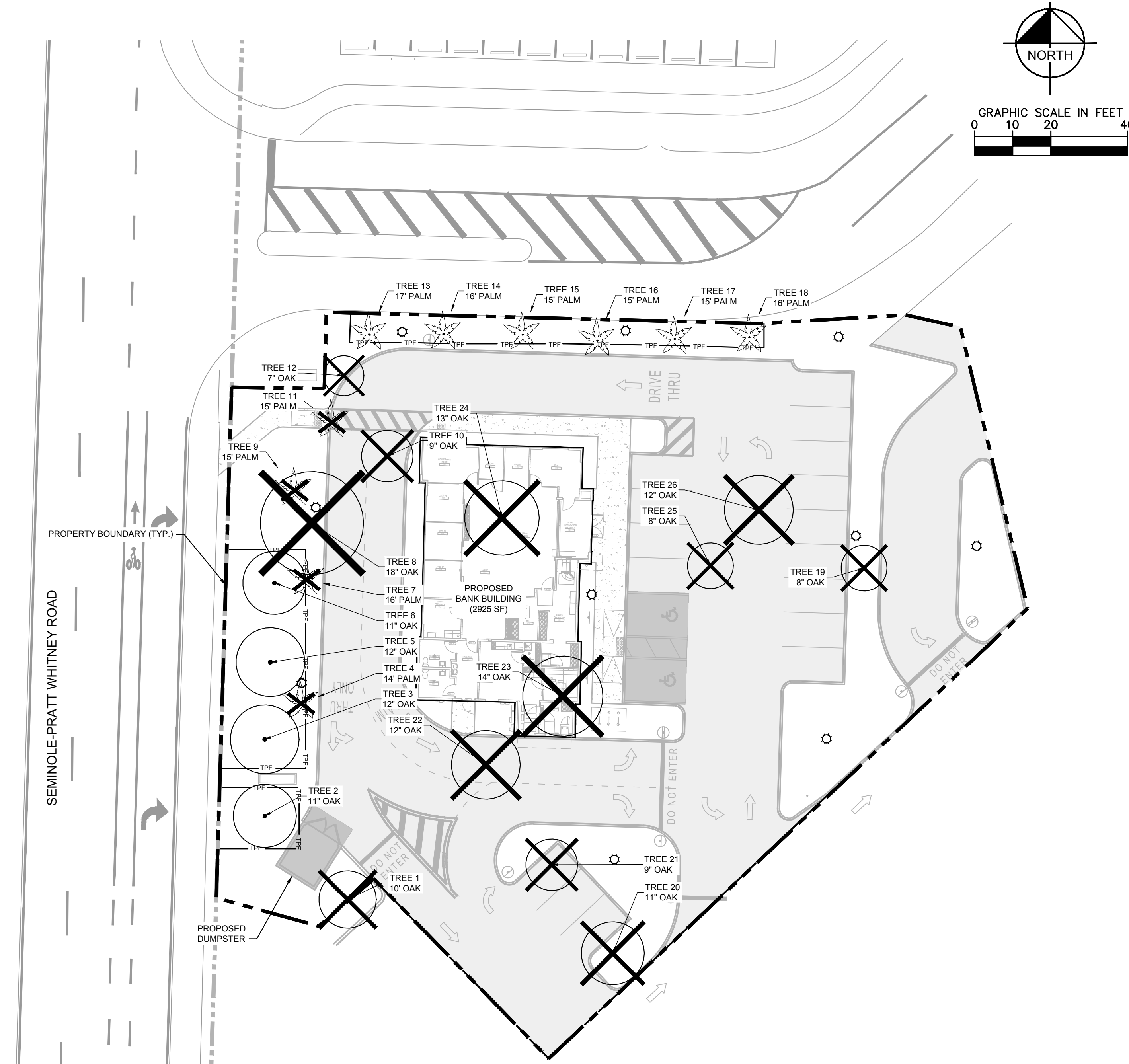

Point #	SPECIES	DBH	STATUS
1	OAK	10	REMOVE
2	OAK	11	PRESERVE
3	OAK	12	PRESERVE
4	PALM	N/A	REMOVE
5	OAK	12	PRESERVE
6	OAK	11	PRESERVE
7	PALM	N/A	REMOVE
8	OAK	18	REMOVE
9	PALM	N/A	REMOVE
10	OAK	9	REMOVE
11	PALM	N/A	REMOVE
12	OAK	7	REMOVE
13	PALM	N/A	PRESERVE
14	PALM	N/A	PRESERVE
15	PALM	N/A	PRESERVE
16	PALM	N/A	PRESERVE
17	PALM	N/A	PRESERVE
18	PALM	N/A	PRESERVE
19	OAK	8	REMOVE
20	OAK	11	REMOVE
21	OAK	9	REMOVE
22	OAK	12	REMOVE
23	OAK	14	REMOVE
24	OAK	13	REMOVE
25	OAK	8	REMOVE
26	OAK	12	REMOVE

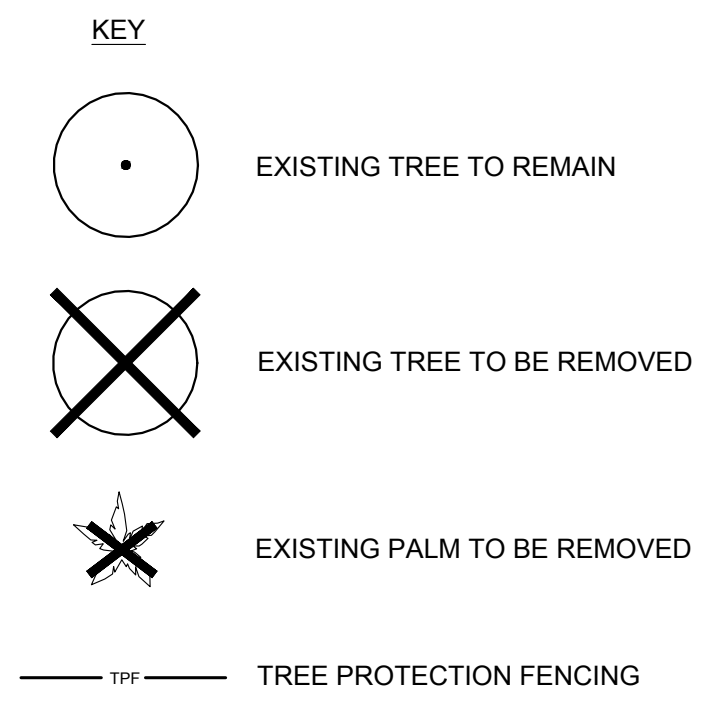

GROVE MARKETPLACE CITY OF WESTLAKE FLORIDA	TREE MITIGATION PLAN	SCALE: AS SHOWN DESIGNED BY: KHA DRAWN BY: KHA CHECKED BY: JLD	
DATE: DECEMBER 2024 PROJECT NO.: 145538000 SHEET NUMBER: TM-100		REVISIONS No. BY DATE	
CITY OF WESTLAKE REV 3 CITY OF WESTLAKE REV 2 CITY OF WESTLAKE REV 1		REVISIONS No. BY DATE	
© 2024 KIMLEY-HORN AND ASSOCIATES, INC. 2800 N. W. 111th Ave., Suite 100 Ft. Lauderdale, FL 33322 PHONE: 772-547-8999 WWW.KIMLEY-HORN.COM REGISTRY NO. 35108			

Plotted By: Gerard, Compton. Street: Grove MarketPlace, CHASE. Layout: TM-101. December 16, 2024. 08:47:09pm. K:\STP - CIVIL\14538 - Premier Developers\000 - Grove MarketPlace\CADD\PlanSheets\TM-Tree Mitigation. Notes.dwg. This document, together with the concepts and designs presented herein, is an instrument of service, as intended only for the specific purpose and client for which it was prepared. Reuse of and improper reliance on this document without written authorization and adaptation by Kimley-Horn and Associates, Inc. shall be without liability to Kimley-Horn and Associates, Inc.

TREE MITIGATION SPECIFICATIONS

- A. GENERAL
1. OWNER IS RESPONSIBLE TO SELECT A PROJECT ARBORIST, AS NEEDED, UNLESS ONE IS CURRENTLY PART OF DESIGN TEAM.
2. CONTRACTOR SHALL ADHERE TO ALL TREE PROTECTION REQUIREMENTS LISTED IN THESE SPECIFICATIONS AND/OR THOSE LISTED IN THE CITY OR COUNTY ZONING CODE, TREE PROTECTION (LATEST EDITION), WHICHEVER IS MORE STRINGENT SHALL APPLY.
...
C. ROOT PRUNING/TRENCHING
1. THE STANDARDS FROM AMERICAN NATIONAL STANDARDS INSTITUTE (ANSI): A300 (PART 8):2013 ROOT MANAGEMENT WITH SPECIAL ATTENTION TO SECTION 84 SHALL APPLY TO THIS WORK, IF REQUESTED. THE CONTRACTOR SHALL PROVIDE TO THE ENGINEER ONE COPY OF THIS REFERENCE. PROVISION OF REFERENCE SHALL BE INCIDENTAL TO THIS ITEM.

- D. CLEARING
1. ANY BRUSH CLEARING REQUIRED WITHIN THE TREE PROTECTION ZONE SHALL BE ACCOMPLISHED WITH HAND-OPERATED EQUIPMENT.
2. CONTRACTOR SHALL CLEAR ALL TREE PROTECTION AREAS OF VINES, SHRUBS, GROUND COVERS, WEEDS, SAPLINGS, AND INVASIVES LISTED ON THE LATEST EDITION OF THE FLORIDA EXOTIC PEST PLANT COUNCIL'S LIST OF INVASIVE SPECIES.
...
G. INSECTICIDE
1. NOTIFY PROJECT ARBORIST IF ANY INFESTATION IS NOTICED.
2. FOLLOW PROJECT ARBORIST'S RECOMMENDED PROCEDURES.

- H. IRRIGATION
1. EVERY EFFORT SHALL BE MADE TO WATER THE PRESERVED TREES AND TRANSPLANTS. CONTRACTOR SHALL IRRIGATE BY HAND OR BY TEMPORARY IRRIGATION.
2. IRRIGATE AS REQUIRED BY PROJECT ARBORIST UNTIL PERMANENT IRRIGATION IS INSTALLED AND OPERATING.
...
M. REPAIR OF DAMAGED TREES
1. IF DAMAGE TO ANY TREE SHOULD OCCUR BY ACCIDENT OR NEGLIGENCE DURING THE CONSTRUCTION PERIOD, THE PROJECT ARBORIST SHALL APPRAISE THE DAMAGE AND MAKE RECOMMENDATIONS TO THE OWNER FOR REPAIR BY THE CONTRACTOR.

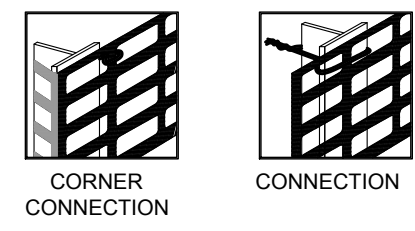
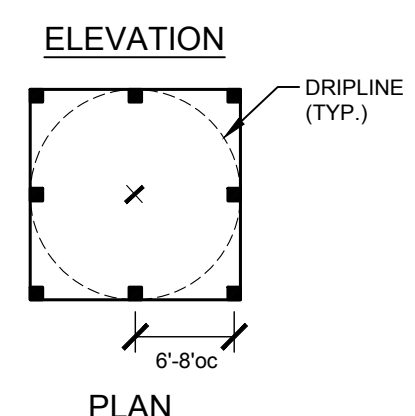
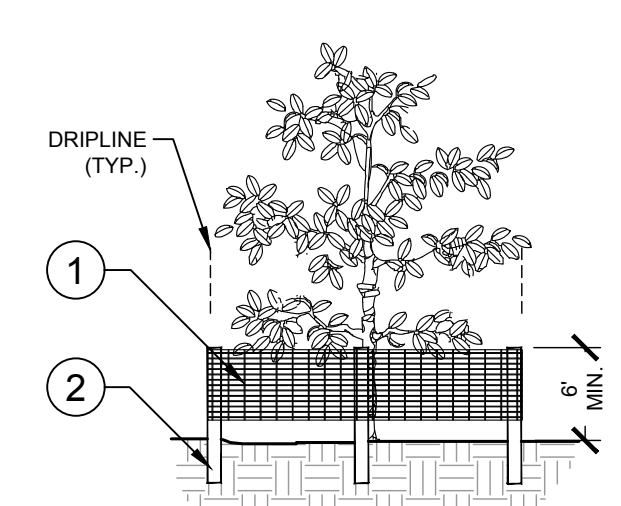

INSTALLATION NOTES:
A. POST SELECTION SHOULD BE BASED ON EXPECTED STRENGTH NEEDS AND THE LENGTH OF TIME FENCE WILL BE IN PLACE. FLEXIBLE FIBERGLASS ROD POSTS ARE RECOMMENDED FOR PARKS, ATHLETIC EVENTS AND CROWD CONTROL INSTALLATIONS. METAL 'T' POSTS OR TREATED WOOD POSTS ARE TYPICALLY USED FOR CONSTRUCTION AND OTHER APPLICATIONS.
B. POSTS SHOULD BE DRIVEN INTO THE GROUND TO A DEPTH OF 1/3 OF THE HEIGHT OF THE POST. FOR EXAMPLE, A 6' POST SHOULD BE SET AT LEAST 2' INTO THE GROUND.
C. SPACE POSTS EVERY 6' (MIN.) TO 8' (MAX.).
D. SECURE FENCING TO POST WITH NYLON CABLE TIES (AVAILABLE FROM CONWED PLASTICS). WOOD STRIPS MAY BE ALSO USED TO PROVIDE ADDITIONAL SUPPORT AND PROTECTION BETWEEN TIES AND POSTS.

NOTE: IF WIRE TIES ARE USED, AVOID DIRECT CONTACT WITH FENCE. WIRE MAY DAMAGE FENCE OVER TIME.

1 TREE PROTECTION FENCING
ELEVATION / PLAN
TM-101

NTS
P-PR1-T2

Scale: AS SHOWN
DESIGNED BY: KHA
DRAWN BY: KHA
CHECKED BY: JLD
TREE MITIGATION NOTES
GROVE MARKETPLACE
FLORIDA
CITY OF WESTLAKE
DATE: DECEMBER 2024
PROJECT NO.: 145538000
SHEET NUMBER: TM-101
Kimley-Horn logo and contact information.

Plotted By: Gerard, Cameron. Street: GROVE MARKETPLACE CHASE. Layout: Landscape Plan. December 16, 2024. 08:47:46pm. K:\STP_Civil\145538 - Premier Developers\000 - Grove MarketPlace_CADD\PlanSheets\Landscape Details.dwg. This document, together with the concepts and designs presented herein, is intended only for the specific purpose and client for which it was prepared. Reuse of and improper reliance on this document without written authorization and adaptation by Kimley-Horn and Associates, Inc. shall be without liability to Kimley-Horn and Associates, Inc.

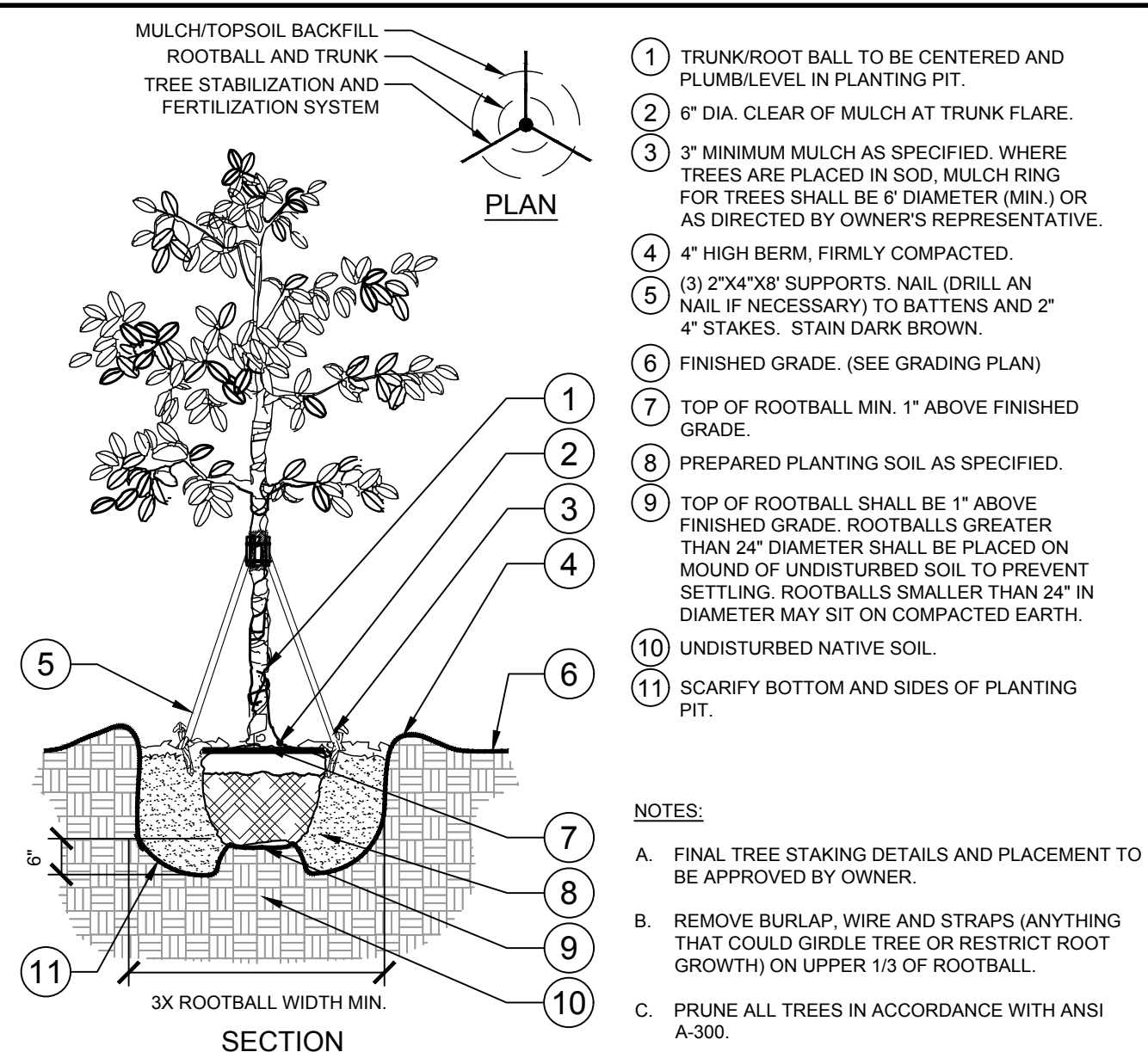

1 TREE PLANTING WITH STAKING
NTS P-PR1-24

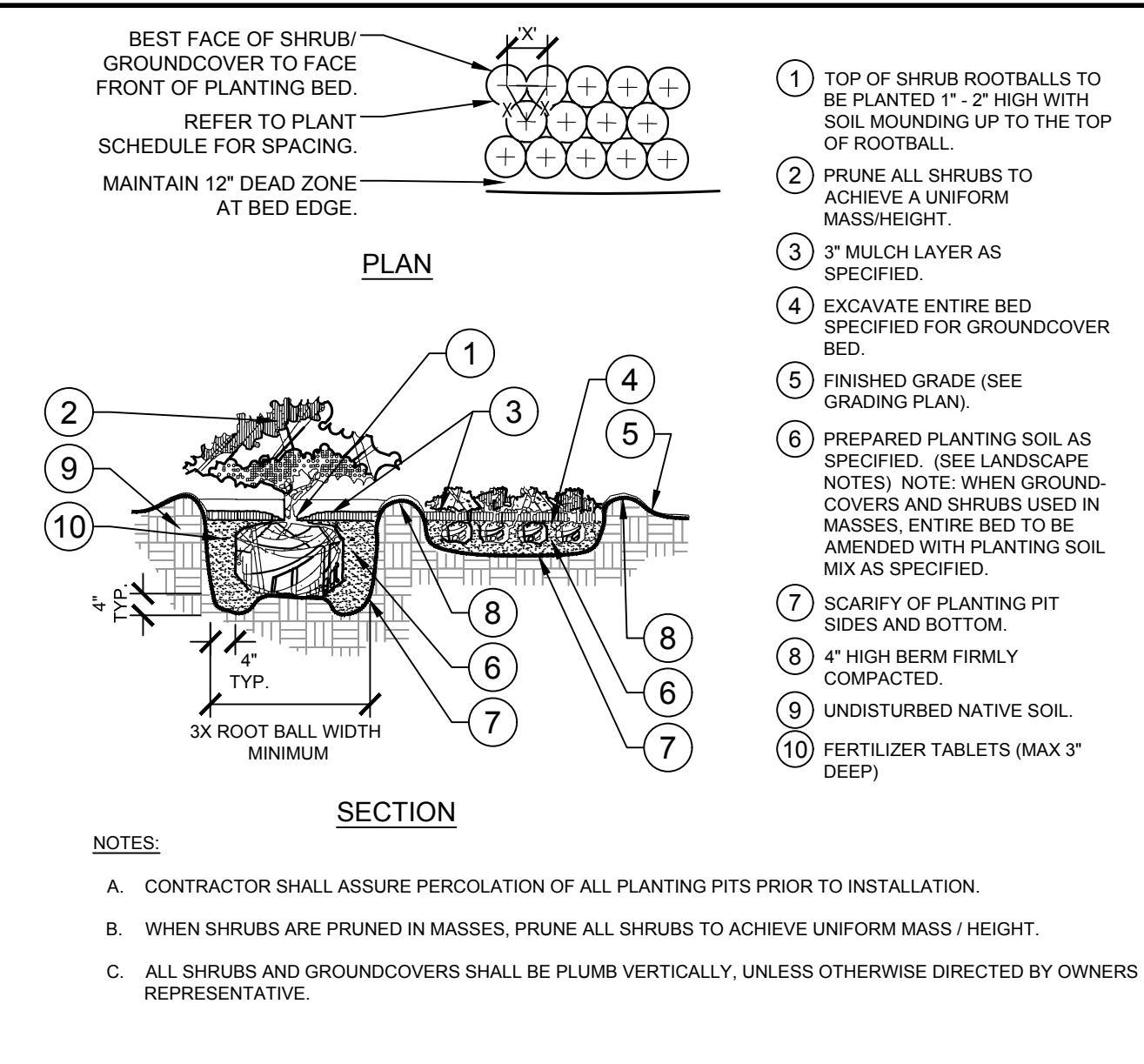

2 SHRUB/GROUNDCOVER PLANTING
NTS P-PR1-25

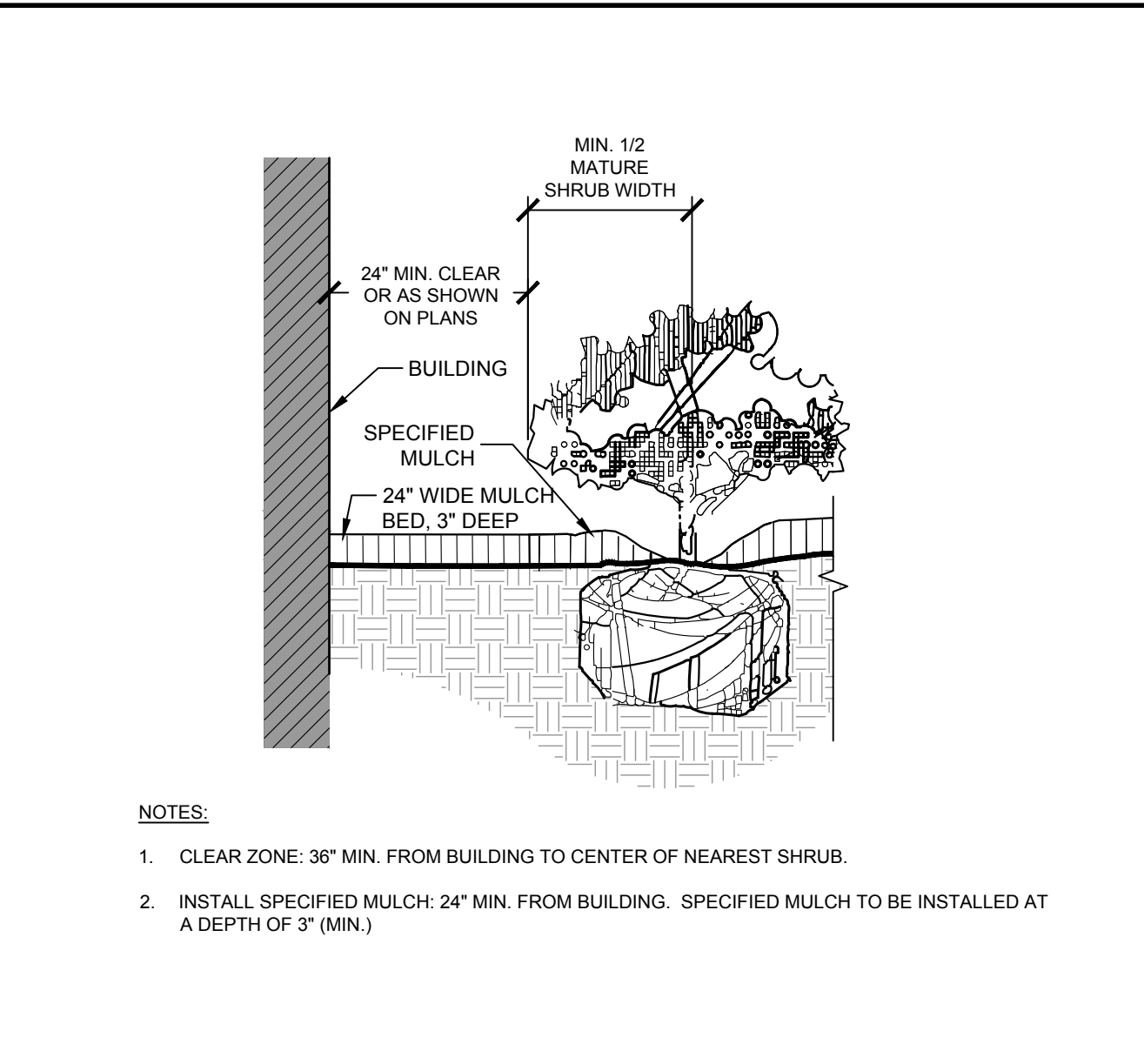

3 PLANTINGS ADJACENT TO BUILDINGS
NTS P-PR1-26

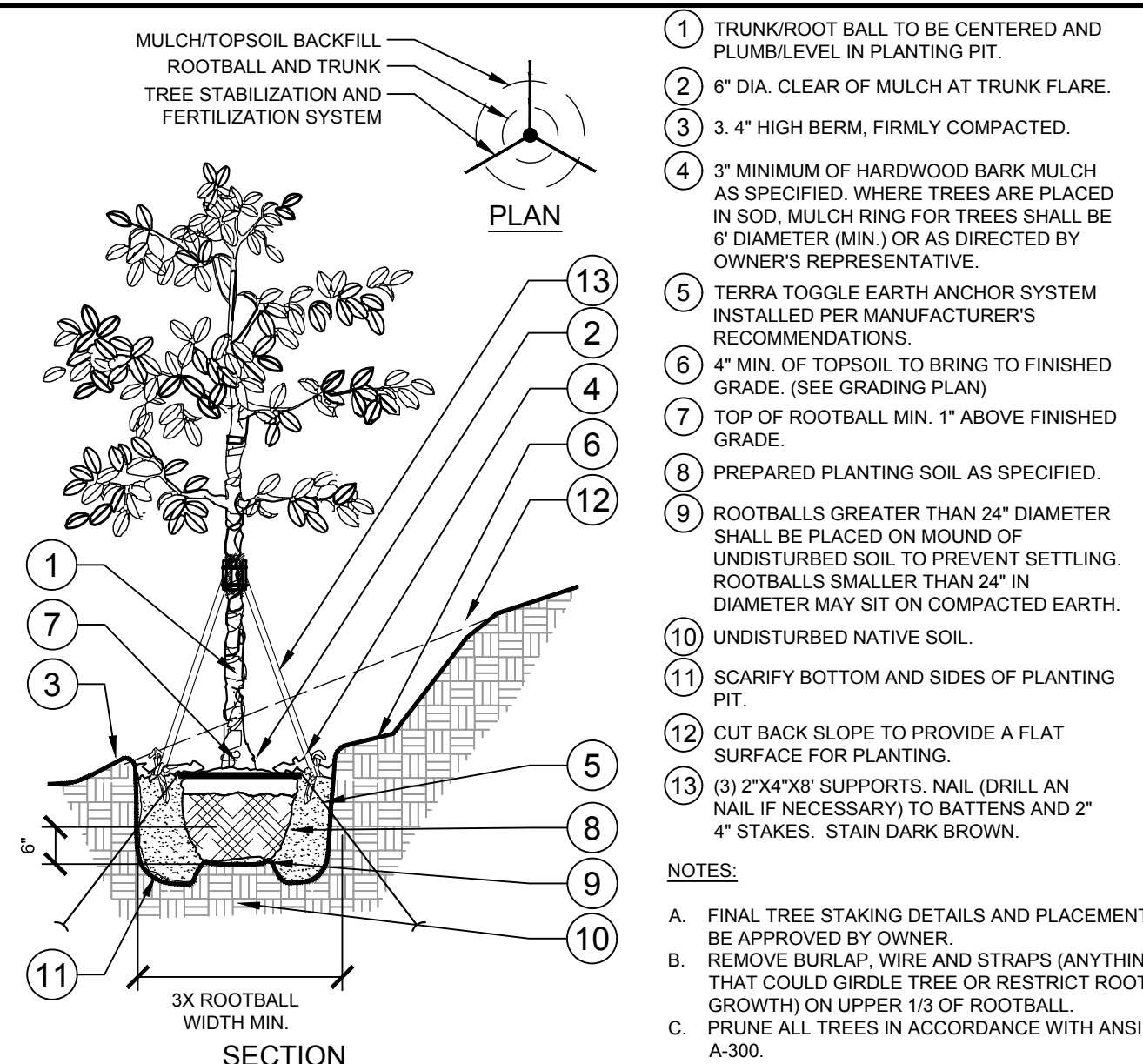

4 TREE PLANTING ON A SLOPE WITH STAKING
NTS P-PR1-27

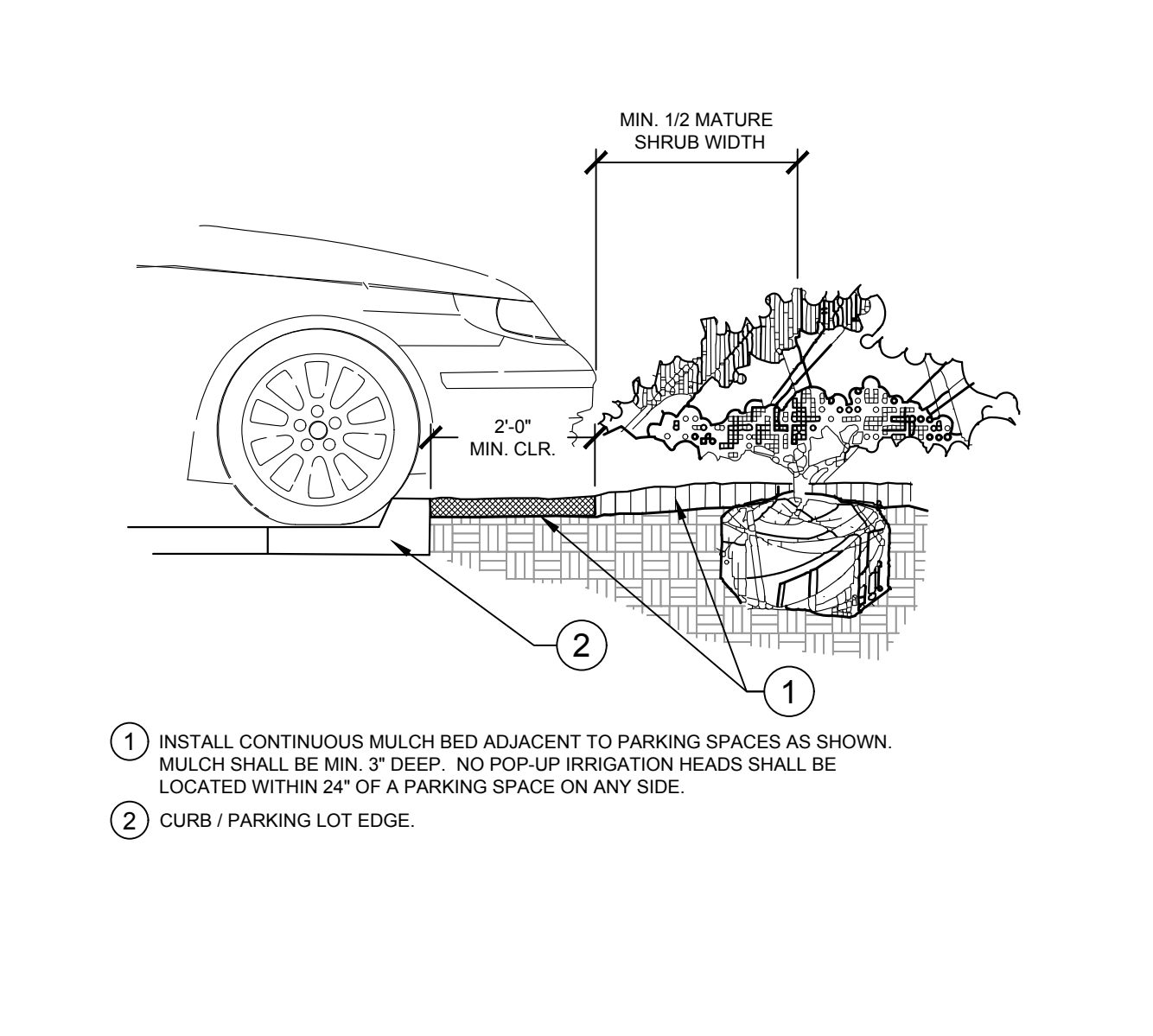

5 PARKING SPACE/CURB PLANTING
NTS P-PR1-28

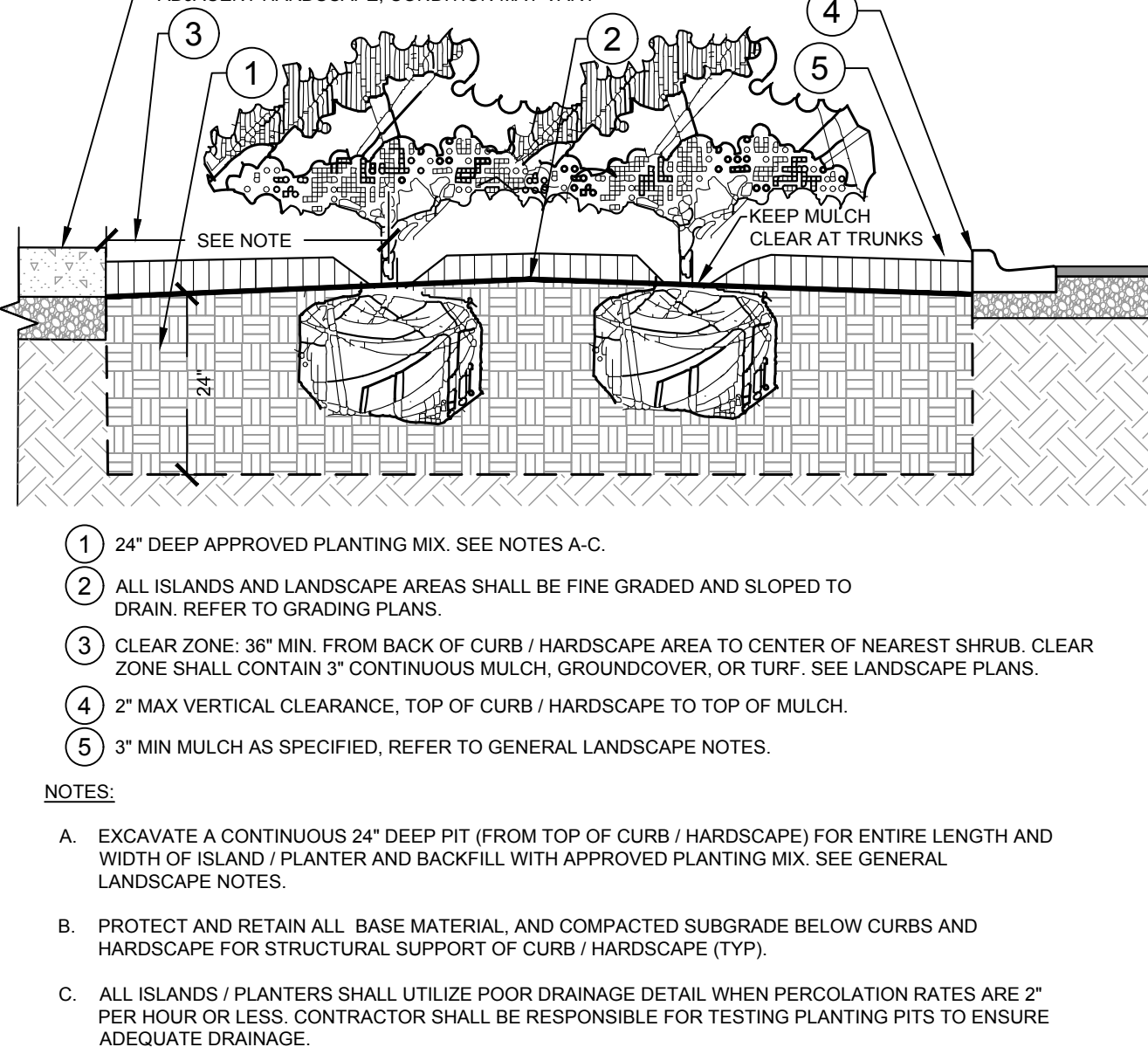

6 PLANTED PARKING LOT ISLANDS/MEDIANS
NTS P-PR1-29

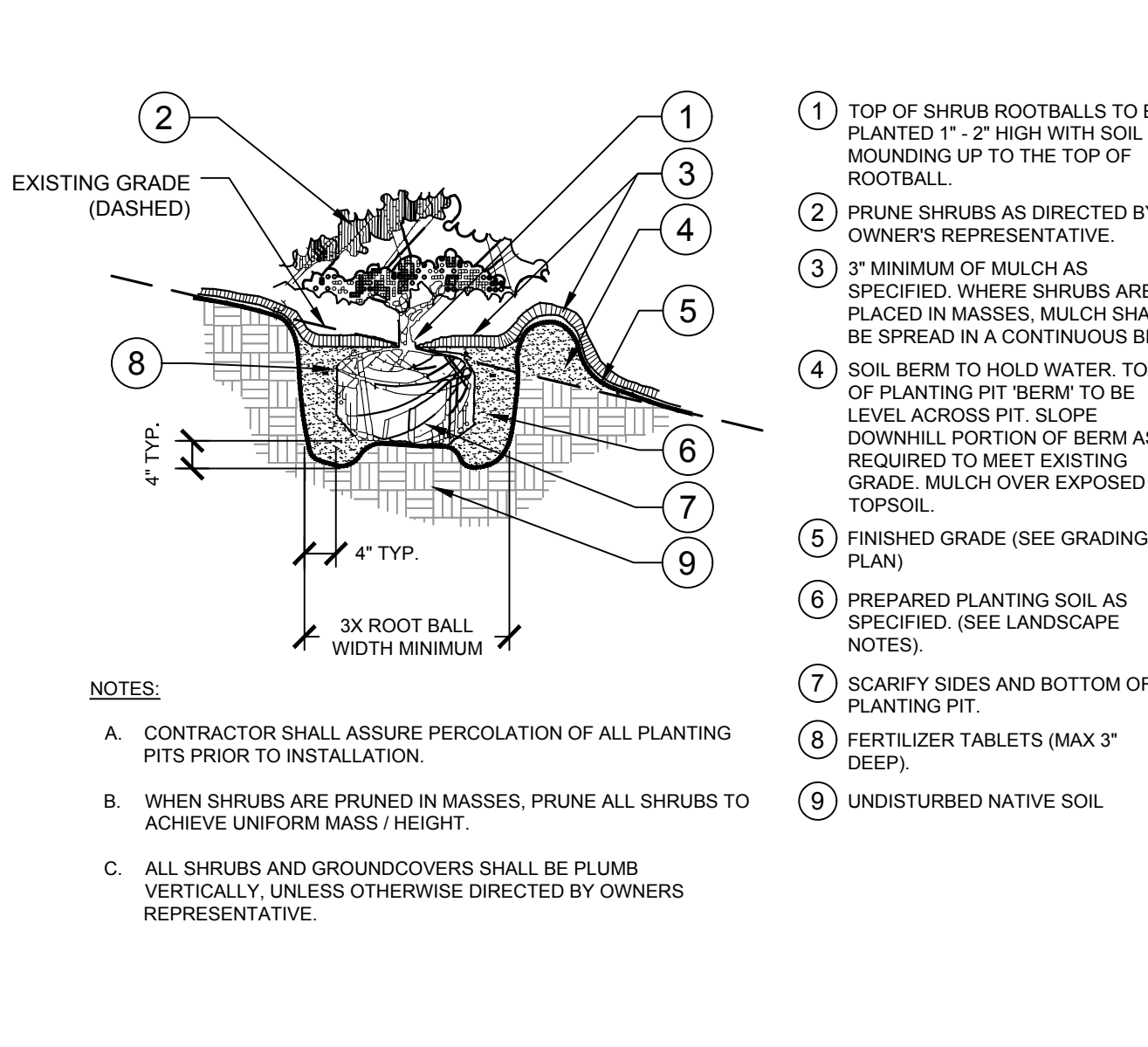

7 SHRUB/GROUNDCOVER PLANTING ON A SLOPE
NTS P-PR1-30

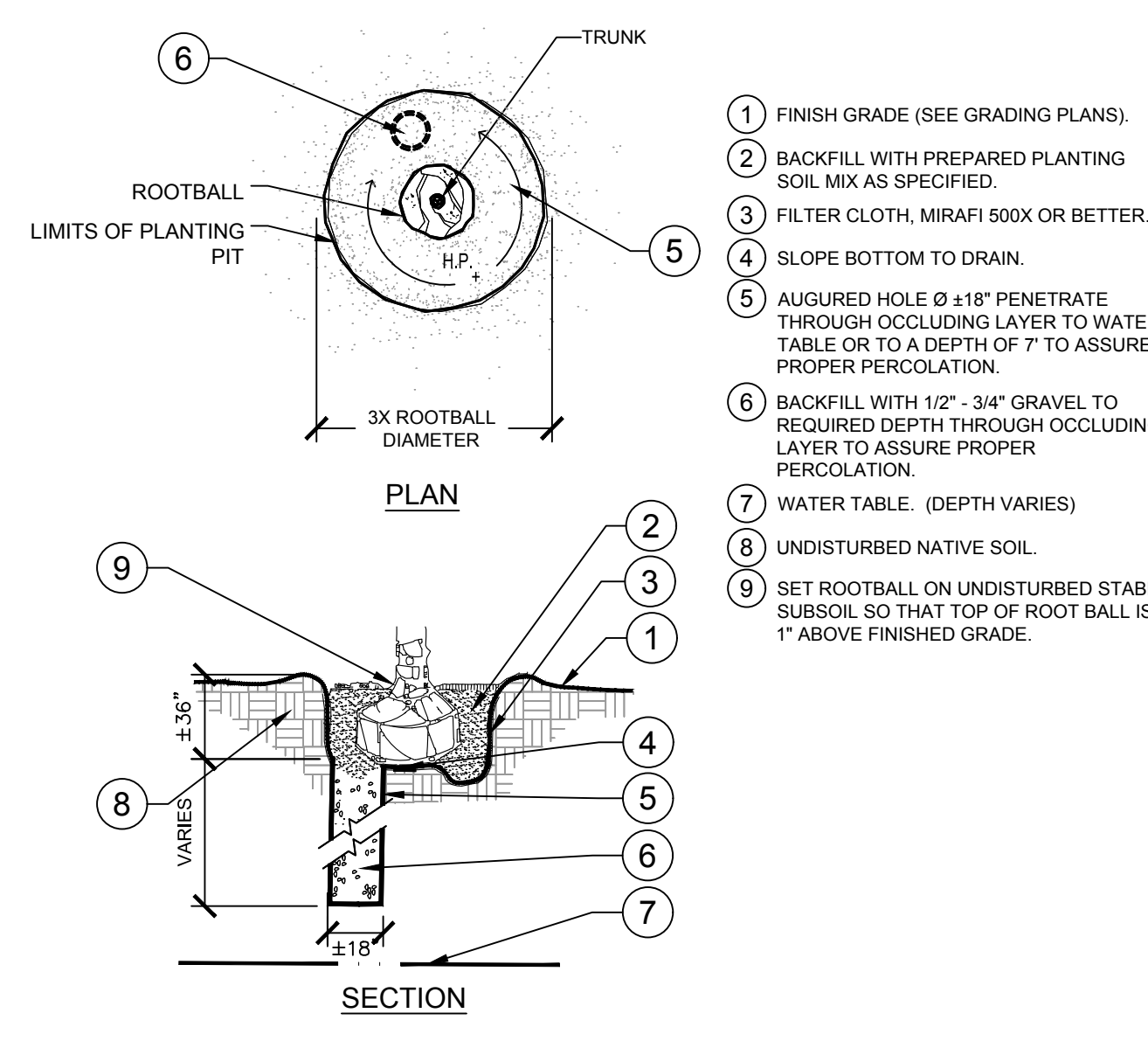

8 POOR DRAINAGE CONDITIONS
NTS P-PR1-31

NO.	REVISIONS	DATE

Kimley >>> Horn
© 2024 KIMLEY-HORN AND ASSOCIATES, INC.
200 N. W. 10TH AVENUE, SUITE 100
ST. PETERSBURG, FL 33701
PHONE: 727-547-5898 WWW.KIMLEY-HORN.COM
REGISTRY NO. 35106

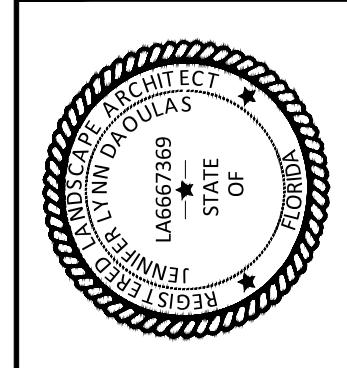

SCALE	AS SHOWN
DESIGNED BY	KHA
DRAWN BY	KHA
CHECKED BY	JLD

LANDSCAPE DETAILS

GROVE MARKETPLACE
CITY OF WESTLAKE
FLORIDA

DATE	DECEMBER 2024
PROJECT NO.	145538000
SHEET NUMBER	L-102

