

MATCH LINE

SEE SHEET UP-1

ELEVATIONS ARE BASED ON NORTH AMERICAN VERTICAL DATUM (NAVD) OF 1988.

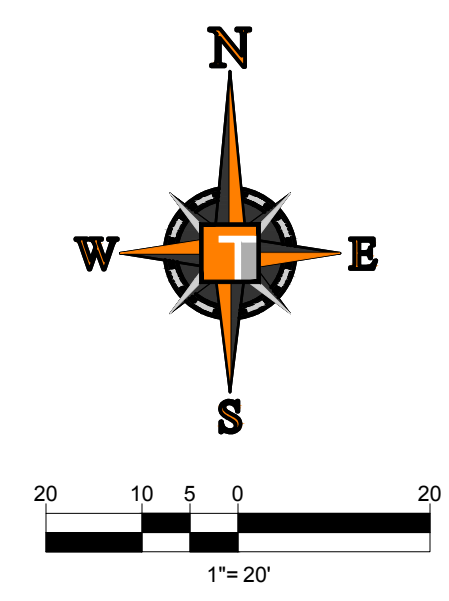

UTILITY NOTES:

- 1. CONTRACTOR IS RESPONSIBLE FOR VERIFYING ALL UTILITIES AND NOTIFYING THE APPROPRIATE UTILITY COMPANY PRIOR TO BEGINNING CONSTRUCTION.
2. THE LOCATION AND/OR ELEVATION OF EXISTING UTILITIES AS SHOWN ON THESE PLANS IS BASED ON RECORDS OF THE VARIOUS UTILITY COMPANIES AND, WHERE POSSIBLE, MEASUREMENTS TAKEN IN THE FIELD. THE INFORMATION IS NOT TO BE RELIED ON AS BEING EXACT OR COMPLETE. THE CONTRACTOR MUST CALL THE APPROPRIATE UTILITY COMPANY AT LEAST 48 HOURS BEFORE ANY EXCAVATION TO REQUEST EXACT FIELD LOCATION OF THE UTILITIES. IT SHALL BE THE RESPONSIBILITY OF THE CONTRACTOR TO RELOCATE ALL EXISTING UTILITIES WHICH CONFLICT WITH THE PROPOSED IMPROVEMENTS SHOWN ON THE PLANS.
3. CONTRACTOR SHALL VERIFY HORIZONTAL AND VERTICAL LOCATION OF ALL EXISTING STORM SEWER STRUCTURES, PIPES, AND ALL UTILITIES PRIOR TO CONSTRUCTION.
4. CONTRACTOR IS RESPONSIBLE FOR REPAIRS OF DAMAGE TO ANY EXISTING IMPROVEMENTS DURING CONSTRUCTION, SUCH AS, BUT NOT LIMITED TO, UTILITIES, PAVEMENT, STRIPING, CURBS, ETC. REPAIRS SHALL BE EQUAL TO OR BETTER THAN EXISTING CONDITIONS.
5. CONTRACTOR SHALL REFER TO ARCHITECTS PLANS AND SPECIFICATIONS FOR ACTUAL LOCATION OF ALL UTILITY ENTRANCES. CONTRACTOR SHALL COORDINATE INSTALLATION OF UTILITIES IN SUCH A MANNER AS TO AVOID CONFLICTS AND ASSURE PROPER DEPTHS ARE ACHIEVED AS WELL AS COORDINATING WITH CITY UTILITY REQUIREMENTS AS TO LOCATIONS AND SCHEDULING FOR TIE-INS/CONNECTIONS PRIOR TO CONNECTING EXISTING FACILITIES.
6. CONTRACTOR SHALL COORDINATE WITH ARCHITECTURAL PLANS, POWER COMPANY, & TELEPHONE COMPANY FOR ACTUAL ROUTING OF POWER AND TELEPHONE SERVICE TO BUILDING.
7. SEE DETAIL SHEETS FOR BACKFILLING AND COMPACTION REQUIREMENTS ON UTILITY TRENCHES.
8. CONTRACTOR SHALL COMPLY TO THE FULLEST EXTENT WITH THE LATEST STANDARD OF OSHA DIRECTIVES OR ANY OTHER AGENCY HAVING JURISDICTION FOR EXCAVATION AND TRENCHING PROCEDURES. THE CONTRACTOR SHALL USE SUPPORT SYSTEMS, SLOPING, BENCHING, AND OTHER MEANS OF PROTECTION. THIS TO INCLUDE BUT NOT LIMITED TO, ACCESS AND EGRESS FROM ALL EXCAVATION AND TRENCHING. CONTRACTOR IS RESPONSIBLE TO COMPLY WITH PERFORMANCE CRITERIA FOR OSHA.
9. CONTRACTOR SHALL COORDINATE WITH OTHER UTILITIES TO ASSURE PROPER DEPTH AND PREVENT ANY CONFLICT OF UTILITIES.
10. CONTRACTOR SHALL GROUT AROUND ALL PIPE ENTRANCES TO SANITARY SEWER MANHOLES WITH NON-SHRINKING GROUT TO ASSURE CONNECTION IS WATER TIGHT.
11. CONTRACTOR SHALL ON ALL UTILITIES, COORDINATE INSPECTION WITH THE APPROPRIATE AUTHORITIES PRIOR TO COVERING TRENCHES AT INSTALLATION.
12. THE CONTRACTOR SHALL CONDUCT ALL REQUIRED TESTS TO THE SATISFACTION OF THE RESPECTIVE UTILITY COMPANIES AND OWNERS INSPECTING AUTHORITIES.
13. SITE CONTRACTOR TO COORDINATE PROPOSED RECONNECTION OF ALL UTILITIES WITH ARCHITECTURAL PLANS AS WELL AS UTILITY COMPANIES AND BUILDING CONTRACTOR. THE GENERAL CONTRACTOR IS RESPONSIBLE FOR ANY AND ALL EXPENSES THAT RESULT FROM DELAYED OR FAILED TEST DURING ANY PHASE OF THE CONSTRUCTION PROCESS.
14. EXISTING UTILITY LINES SHOWN ARE APPROXIMATE LOCATIONS ONLY. THE CONTRACTOR SHALL FIELD VERIFY ALL EXISTING UTILITY LINE LOCATIONS PRIOR TO ANY CONSTRUCTION. ANY DEVIATIONS FROM THE DESIGN LOCATIONS SHALL BE REPORTED TO THE OWNER OR ENGINEER PRIOR TO CONSTRUCTION.
15. CONTRACTOR SHALL REFER TO PLANS BY OTHERS FOR ENTRY LOCATION OF ALL WATER, SEWER SERVICE, ELECTRICAL, AND TELEPHONE SERVICE. CONTRACTOR SHALL COORDINATE INSTALLATION OF UTILITIES IN SUCH A MANNER AS TO AVOID CONFLICTS AND ASSURE PROPER DEPTHS ARE ACHIEVED AS WELL AS COORDINATING WITH THE REGULATORY AGENCY AS TO THE LOCATION AND TIE-INS/CONNECTIONS TO THEIR FACILITIES.
16. SEE COVER SHEET FOR LIST OF UTILITY COMPANIES AND CONTACT PERSONS.
17. THE CONTRACTOR SHALL COORDINATE THE INSTALLATION OF ALL UNDERGROUND UTILITIES WITH HIS WORK. ALL UNDERGROUND UTILITIES (WATER, SANITARY SEWER, STORM SEWER, ELECTRICAL CONDUIT, IRRIGATION SYSTEMS, AND ANY OTHER MISC. UTILITIES) SHALL BE IN PLACE PRIOR TO THE PLACEMENT OF BASE COURSE MATERIAL, AND THE PLACEMENT OF ANY APPROPRIATE SOIL STABILIZATION TECHNIQUE.
18. CONTRACTOR SHALL PROVIDE BOLLARDS FOR PROTECTION OF ALL ABOVE GROUND UTILITIES AND APPURTENANCES ADJACENT TO DRIVE AREAS.
19. CONTRACTOR TO VERIFY LOCATION AND ELEVATION OF EXISTING UTILITIES AND NOTIFY ENGINEER OF RECORD OF ANY DISCREPANCIES.
20. PROVIDE MINIMUM 18" VERTICAL AND 2' HORIZONTAL CLEARANCE OF ELECTRIC CONDUITS TO ANY OTHER UTILITY LINE.

HOMAS ENGINEERING GROUP logo and contact information: 4850 W. KENNEDY BLVD., TAMPA, FL 33609, P: 813-379-4100, F: 813-379-4100

REVISIONS table with columns for REV, DATE, COMMENT, and BY.

811 KNOW WHATS BELOW ALWAYS CALL 811 BEFORE YOU DIG logo and website: www.callsunshine.com

PROJECT INFORMATION table with fields for PROJECT No., DRAWN BY, CHECKED BY, DATE, CAD I.D., and F210039-UTILITY PLAN

PROJECT: SHOPPES AT WESTLAKE LANDINGS PARCELS C & D FOR KONOVER

Digitally signed by Michael Troxell, DN: c=US, o=Florida, dnQualifier=A01410D0000017A14818EA600003313, cn=Michael Troxell, Date: 2021.10.01 16:44:08 -0400

HOMAS ENGINEERING GROUP logo and address: 6300 NW 31ST AVENUE, FORT LAUDERDALE, FL 33309, PH: (954) 202-7000, FX: (954) 202-7070, www.ThomasEngineeringGroup.com

MICHAEL A. TROXELL PROFESSIONAL ENGINEER, October 1, 2021, FLORIDA LICENSE No. 50572, FLORIDA BUSINESS CERT. OF AUTH. No. 27528

SHEET TITLE: PRELIMINARY UTILITY PLAN SHEET NUMBER: UP-2

UTILITY LEGEND table with columns for EXISTING NOTE, TYPICAL NOTE TEXT, and PROPOSED NOTE. Includes symbols for UNDERGROUND WATER LINE, UNDERGROUND ELECTRIC LINE, UNDERGROUND TELEPHONE LINE, STORM SEWER, SANITARY SEWER MAIN, OVERHEAD WIRE, HYDRANT, SANITARY MANHOLE, STORM MANHOLE, CATCH BASIN, WATER METER, BACKFLOW PREVENTER, and CLEAN OUT.

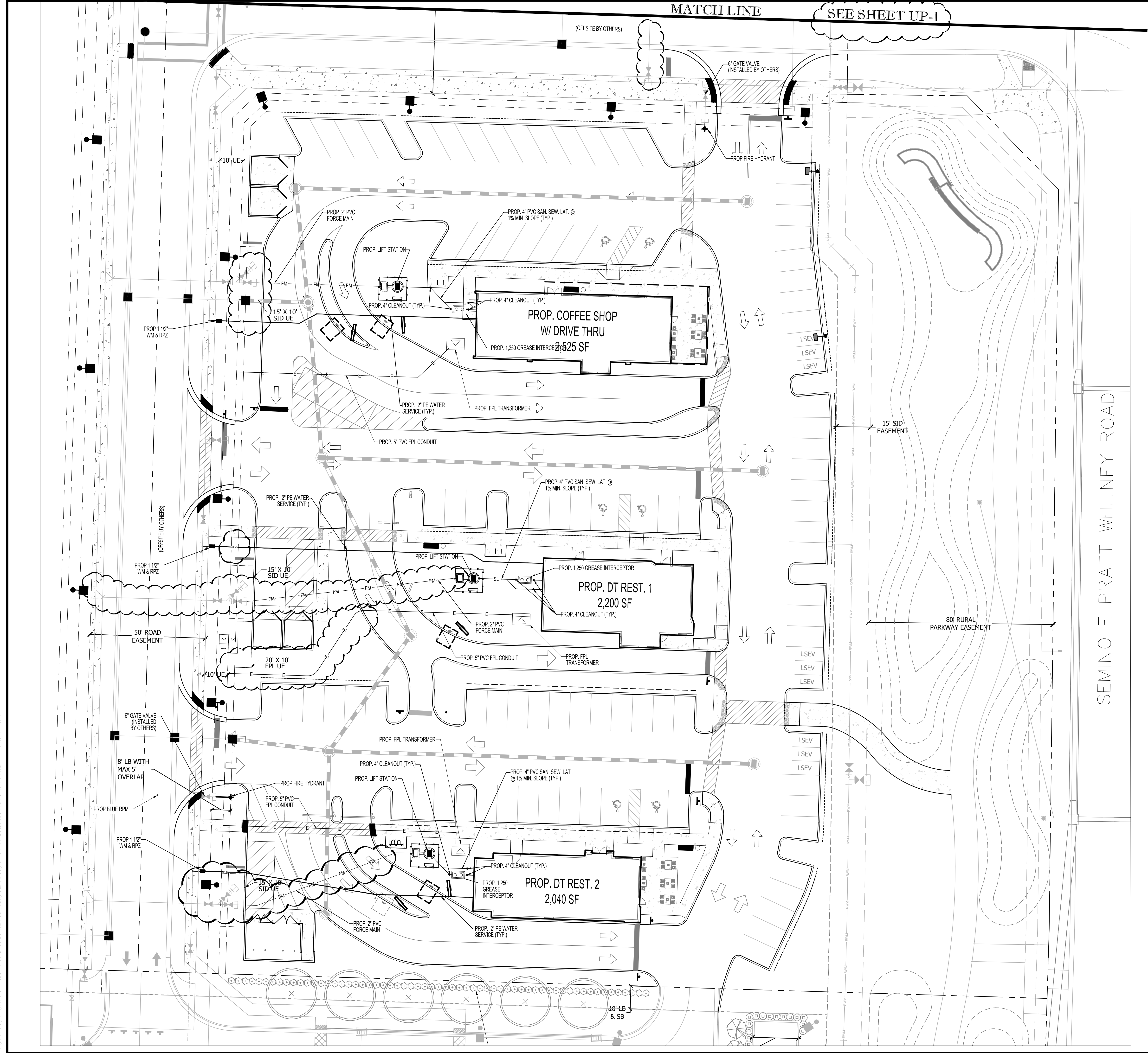

Printed on Friday, October 01, 2021, 3:49 PM by Cesar Delacruz