

SHEET MAP

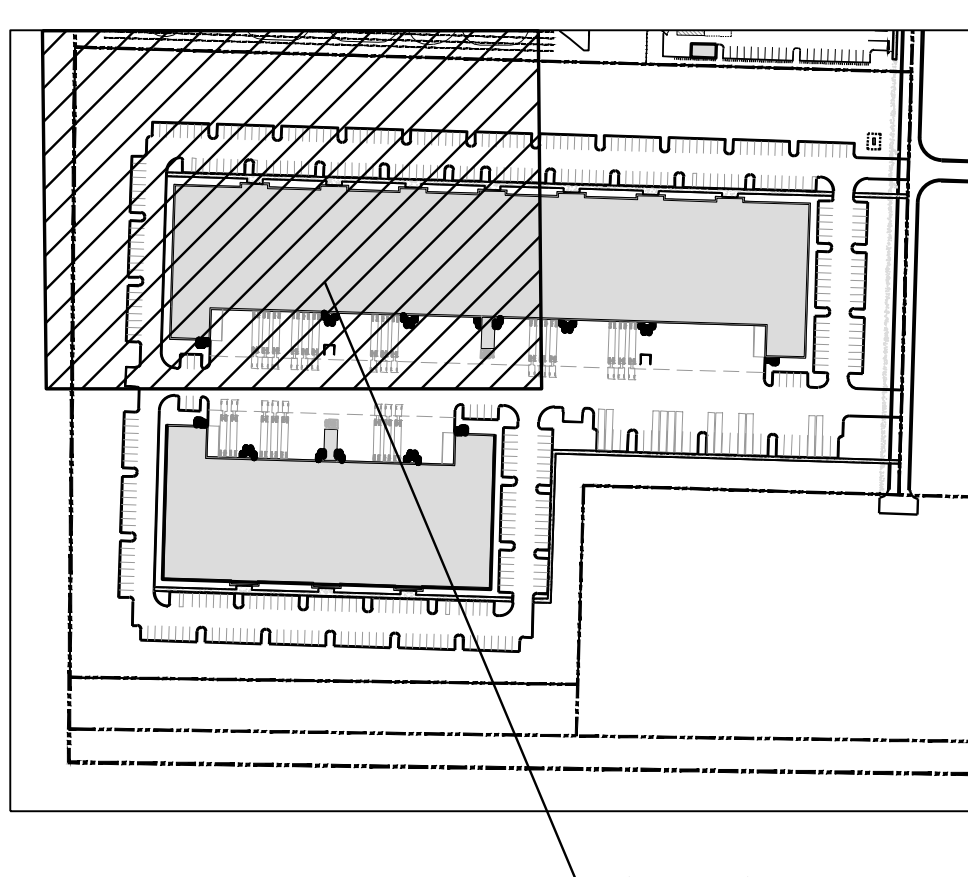

KEY MAP

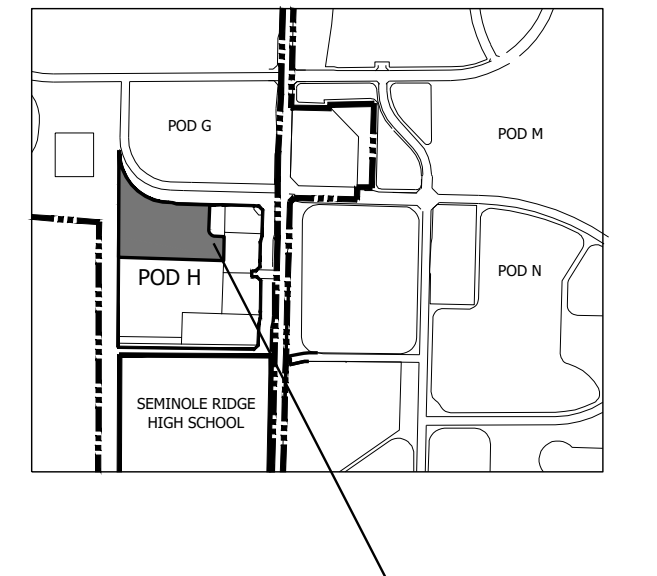

LOCATION MAP

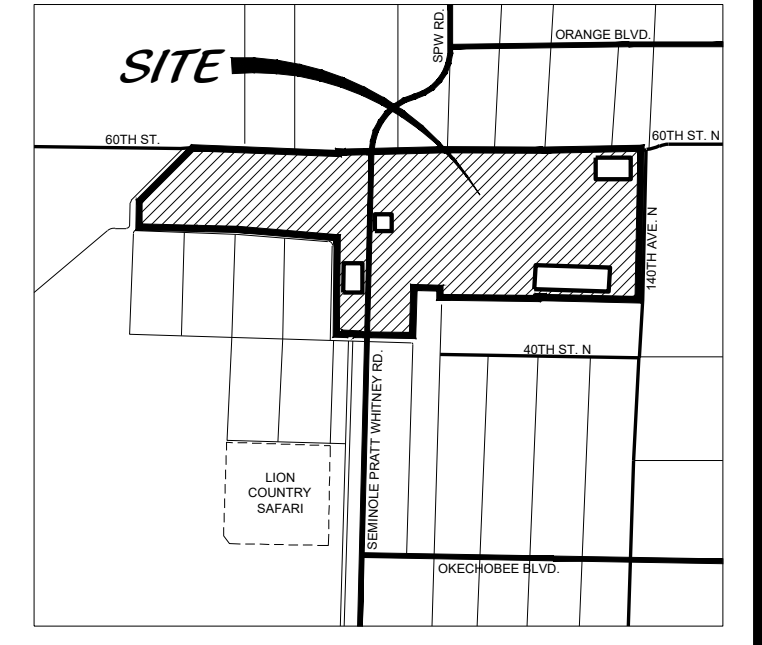

LANDSCAPE DATA

AREA CALCULATIONS	S.F.	AC.	%
BUILDING FOOTPRINT	227,000.00	5.211	29.93%
VEHICULAR USE AREA	268,649.73	6.167	35.42%
SIDEWALKS & ENTRY STOOPS	24,008.40	0.551	3.17%
LANDSCAPE BUFFER AREA	47,185.64	1.083	6.22%
FOUNDATION PLANTING AREA	27,525.00	0.632	3.63%
INTERIOR LANDSCAPE AREA	164,034.00	3.766	21.65%
<b>TOTAL SITE AREA</b>	<b>758,403</b>	<b>17.41</b>	<b>100.00%</b>

LANDSCAPE DATA	CODE	REQ.	PROV.
<b>INTERIOR LANDSCAPE (SECTION 4, TABLE 4-3)</b>			
TOTAL TREES FOR GROSS SITE AREA	1/3000 SF	253	284
TOTAL SHRUBS FOR GROSS SITE AREA	3/1250 SF	1820	2344
<b>FOUNDATION PLANTING - FRONT FAÇADE - 400 LF (SECTION 4.15)</b>			
TREES - (1/20 LF OF 40% FAÇADE LENGTH)	1/20 OF 96 LF	4	7
SHRUBS - (8' WIDTH PLANTING AREA FOR 40% FAÇADE LENGTH)	1/10 OF 96 SF	76	85
<b>FOUNDATION PLANTING - SIDE FAÇADES - 1846 LF (SECTION 4.16)</b>			
TREES - (1/20 LF OF 40% FAÇADE LENGTH)	1/20 OF 738 LF	37	16
SHRUBS - (5' WIDTH PLANTING AREA FOR 40% FAÇADE LENGTH)	1/10 OF 738 SF	74	181
<b>NORTH BUFFER - 1080 LF (SECTION 4.13)</b>			
TREES **	1/25 LF	43	43
CONTINUOUS HEDGE	3' HT.	YES	YES
<b>SOUTH BUFFER - 1063 LF (SECTION 4.13)</b>			
TREES	1/25 LF	43	44
CONTINUOUS HEDGE	3' HT.	YES	YES
<b>WEST BUFFER - 812 LF (SECTION 4.13)</b>			
TREES	1/25 LF	32	33
CONTINUOUS HEDGE	3' HT.	YES	YES
<b>TREE SPECIES MIX (SECTION 4.12)</b>			
M.N. NO. OF TREE SPECIES	284 TREES	6	13
<b>PLANT SPECIES (SECTION 4.12)</b>			
NATIVE TREE SPECIES	60% OF REQ. MIN.	152	205
NATIVE SHRUB SPECIES	60% OF REQ. MIN.	1092	2254

LEGEND

- ADA AMERICAN DISABILITIES ACT
- LB LANDSCAPE BUFFER
- R RADIUS
- SB SETBACK
- SW SIDEWALK
- TYP TYPICAL
- ADA SIGN ADA SIGN
- STOP SIGN STOP SIGN
- PEDESTRIAN CROSSING PEDESTRIAN CROSSING

**Cotleur & Hearing**  
 Landscape Architects  
 Land Planners  
 Environmental Consultants  
 1934 Commerce Lane  
 Suite 1  
 Jupiter, Florida 33458  
 561.747.6336 · Fax 747.1377  
 www.cotleurhearing.com  
 Lic# LC-C000239

**WESTLAKE LANDINGS**  
 WESTLAKE WARE HOUSE  
 PALM BEACH COUNTY, FL

DESIGNED	DEH/JCO
DRAWN	JCO
APPROVED	DEH
JOB NUMBER	13-0518.60
DATE	12-21-21
REVISIONS	01-20-22

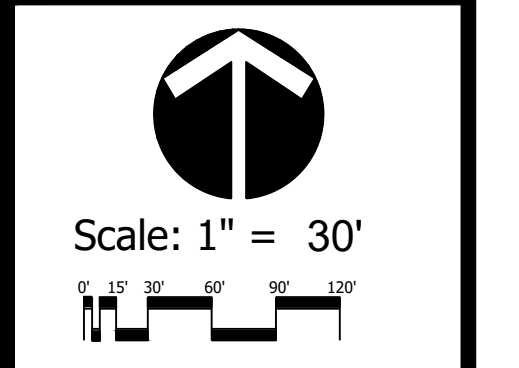

January 18, 2022 9:06:42 a.m.  
 Drawing: 13-0518.60.05 LP.DWG

*Conceptual  
 Landscape Plan*

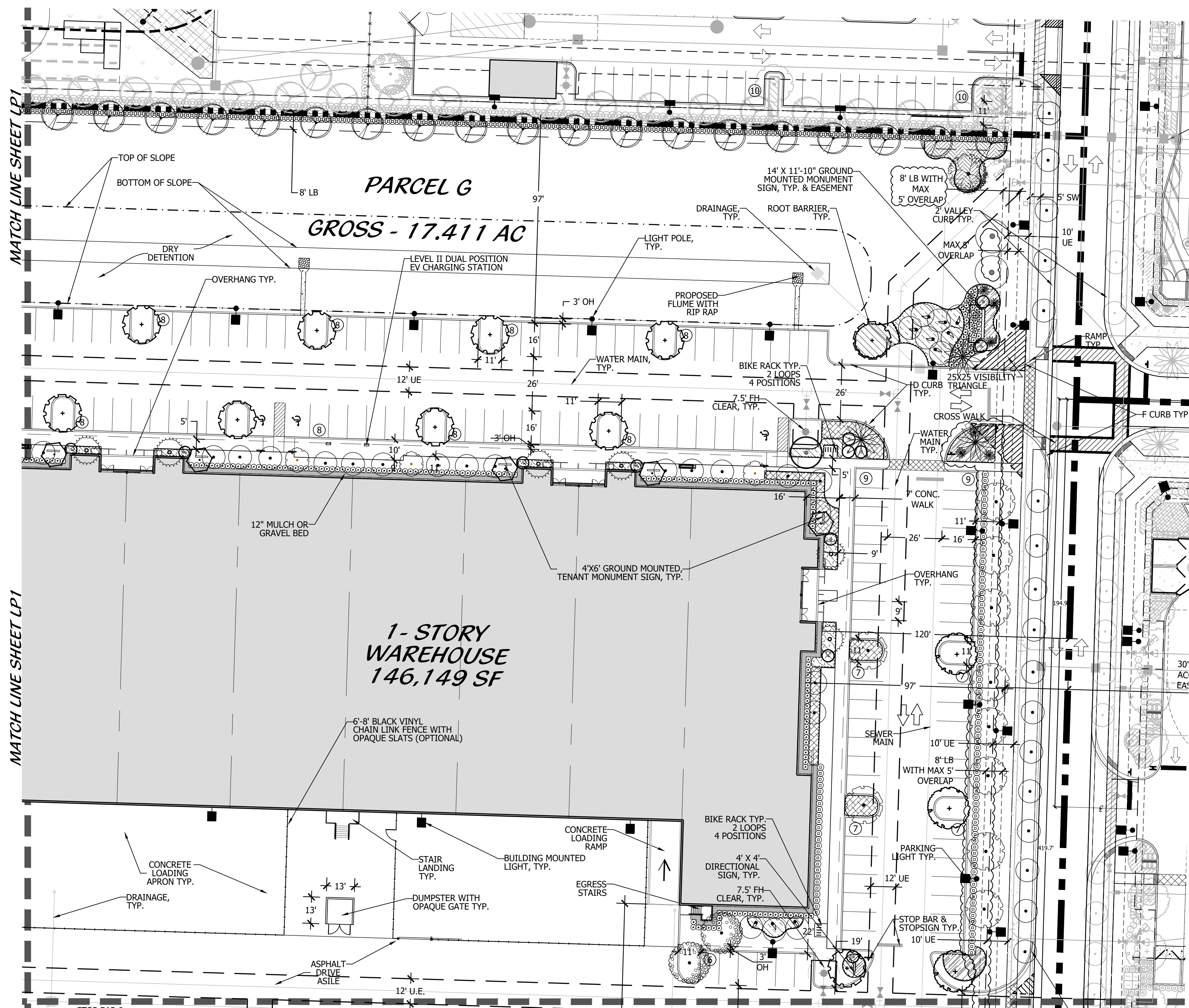

**SHEET MAP**

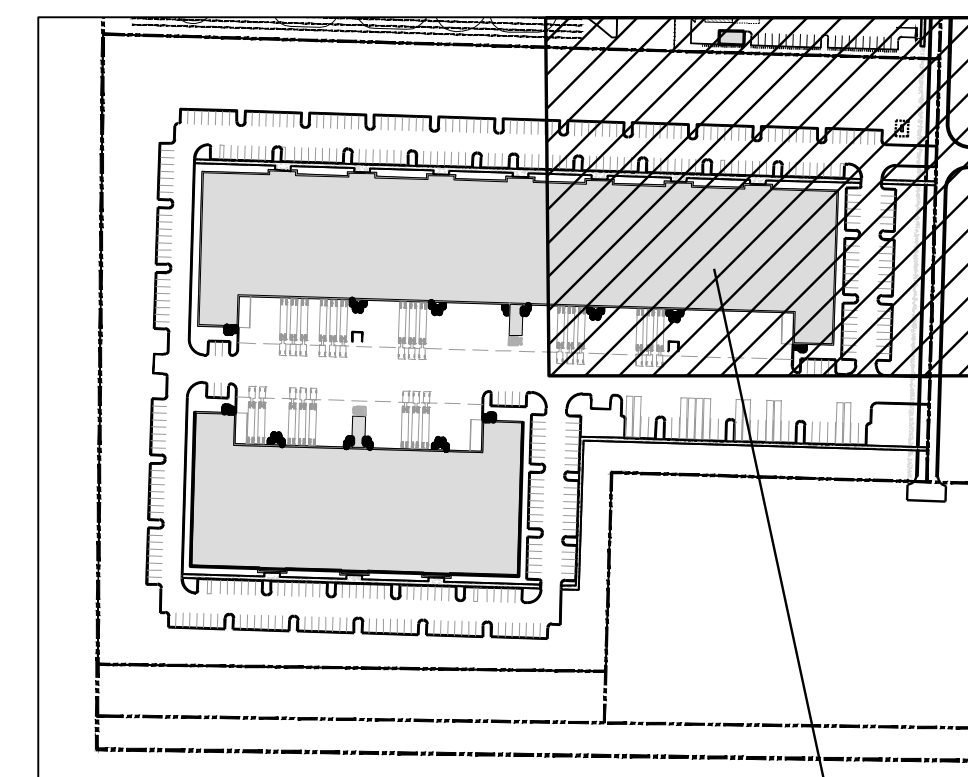

**KEY MAP**

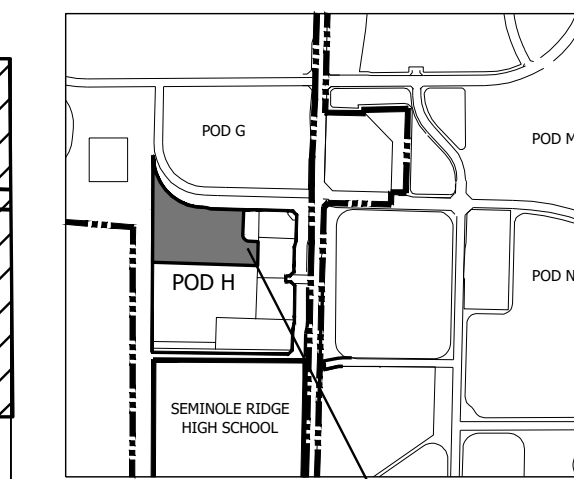

**LOCATION MAP**

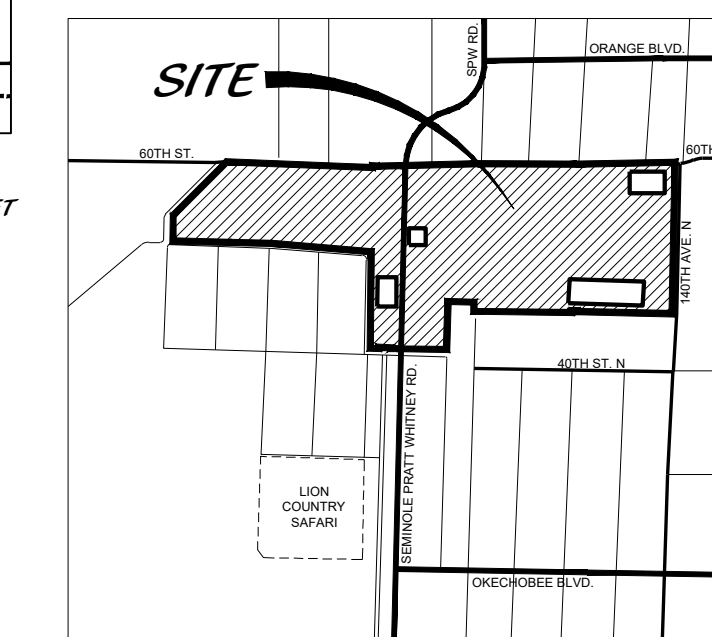

**LANDSCAPE DATA**

AREA CALCULATIONS	S.F.	AC.	%
BUILDING FOOTPRINT	227,000.00	5.211	29.93%
VEHICULAR USE AREA	268,649.73	6.167	35.42%
SIDEWALKS & ENTRY STOOPS	24,008.40	0.551	3.17%
LANDSCAPE BUFFER AREA	47,185.64	1.083	6.22%
FOUNDATION PLANTING AREA	27,525.00	0.632	3.63%
INTERIOR LANDSCAPE AREA	164,034.00	3.766	21.65%
<b>TOTAL SITE AREA</b>	<b>758,403</b>	<b>17.41</b>	<b>100.00%</b>

**LEGEND**

- ADA LANDSCAPE BUFFER
- AMERICAN DISABILITIES ACT
- R LANDSCAPE BUFFER
- SB SETBACK
- SW SIDEWALK
- TYP TYPICAL
- ADA SIGN
- STOP SIGN
- PEDESTRIAN CROSSING

GROSS AFFECTED AREA	758,403 SF		
CATEGORY	CODE	REQ.	PROV.
<b>INTERIOR LANDSCAPE (SECTION 4, TABLE 4-3)</b>			
TOTAL TREES FOR GROSS SITE AREA	1/3000 SF	253	284
TOTAL SHRUBS FOR GROSS SITE AREA	3/1250 SF	1820	2344
<b>FOUNDATION PLANTING - FRONT FAÇADE - 400 LF (SECTION 4.15)</b>			
TREES - (1/20 LF OF 40% FAÇADE LENGTH)	1/20 OF 96 LF	4	7
SHRUBS - (8' WIDTH PLANTING AREA FOR 40% FAÇADE LENGTH)	1/10 OF 96 SF	76	85
<b>FOUNDATION PLANTING - SIDE FAÇADES - 1846 LF (SECTION 4.16)</b>			
TREES - (1/20 LF OF 40% FAÇADE LENGTH)	1/20 OF 738 LF	37	16
SHRUBS - (5' WIDTH PLANTING AREA FOR 40% FAÇADE LENGTH)	1/10 OF 738 SF	74	181
<b>NORTH BUFFER - 1080 LF (SECTION 4.13)</b>			
TREES **	1/25 LF	43	43
CONTINUOUS HEDGE	3' HT.	YES	YES
<b>SOUTH BUFFER - 1063 LF (SECTION 4.13)</b>			
TREES	1/25 LF	43	44
CONTINUOUS HEDGE	3' HT.	YES	YES
<b>WEST BUFFER - 812 LF (SECTION 4.13)</b>			
TREES	1/25 LF	32	33
CONTINUOUS HEDGE	3' HT.	YES	YES
<b>TREE SPECIES MIX (SECTION 4.12)</b>			
M.N. NO. OF TREE SPECIES	284 TREES	6	13
NATIVE SHRUB SPECIES	60% OF REQ. MIN.	1092	2254

\* NOTE: EAST BUFFER LANDSCAPE REQUIREMENTS ARE SATISFIED BY EXISTING LANDSCAPE BUFFER.  
 \*\* CANOPY TREE SUBSTITUTE IS 3:1 RATIO. EXCEPTION FOR ROYAL BISMARCK, PHOENIX, AND CANARY. (7.D.28) [ORD. 2018-002]  
 NOTE: A MINIMUM OF 3' OF LANDSCAPE SHALL BE PROVIDED SURROUNDING ALL GROUND MOUNTED SIGNS

**Cotleur & Hearing**  
 Landscape Architects  
 Land Planners  
 Environmental Consultants  
 1934 Commerce Lane  
 Suite 1  
 Jupiter, Florida 33458  
 561.747.6336 · Fax 747.1377  
 www.cotleurhearing.com  
 Lic# LC-C000239

**WESTLAKE LANDINGS**  
**WESTLAKE WARE HOUSE**  
**PALM BEACH COUNTY, FL**

DESIGNED	DEH/JCO
DRAWN	JCO
APPROVED	DEH
JOB NUMBER	13-0518.60
DATE	12.21.21
REVISIONS	01-20-22

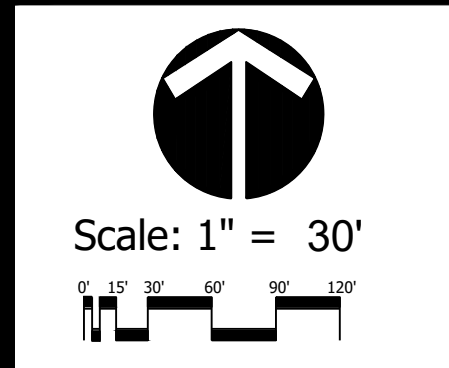

January 18, 2022 9:06:42 a.m.  
 Drawing: 13-0518.60.05 LP.DWG

*Conceptual  
 Landscape Plan*

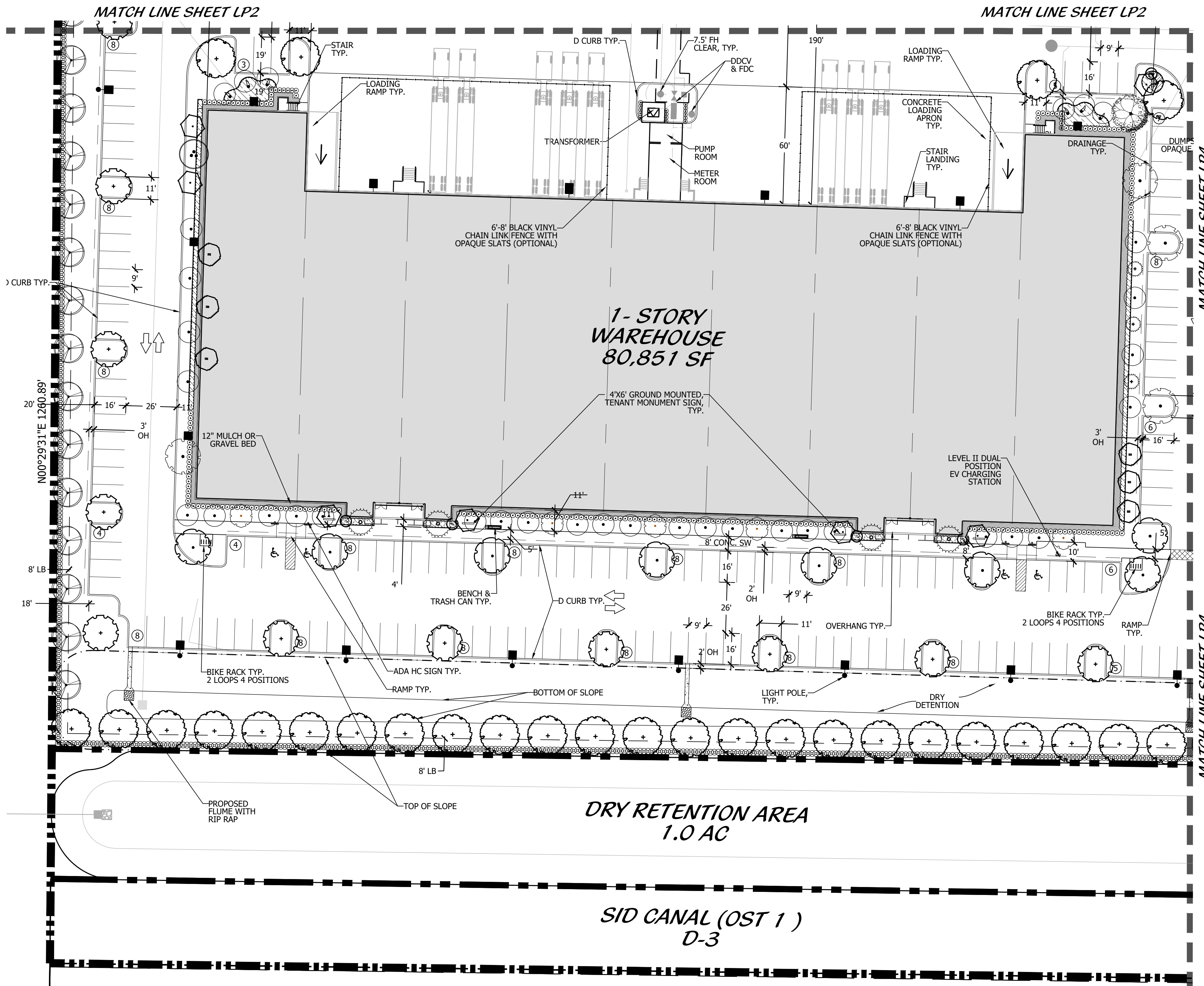

**SHEET MAP**

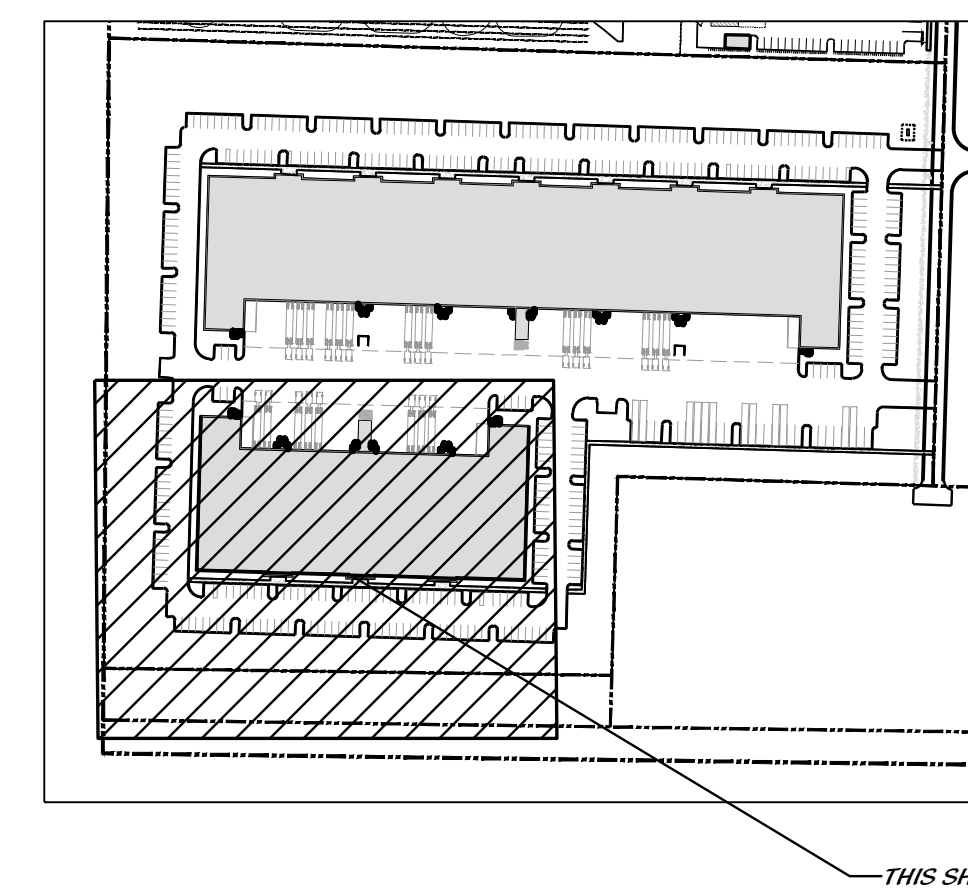

**KEY MAP**

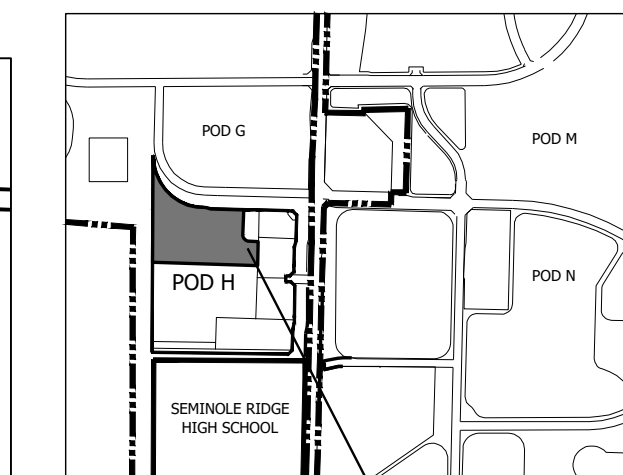

**LOCATION MAP**

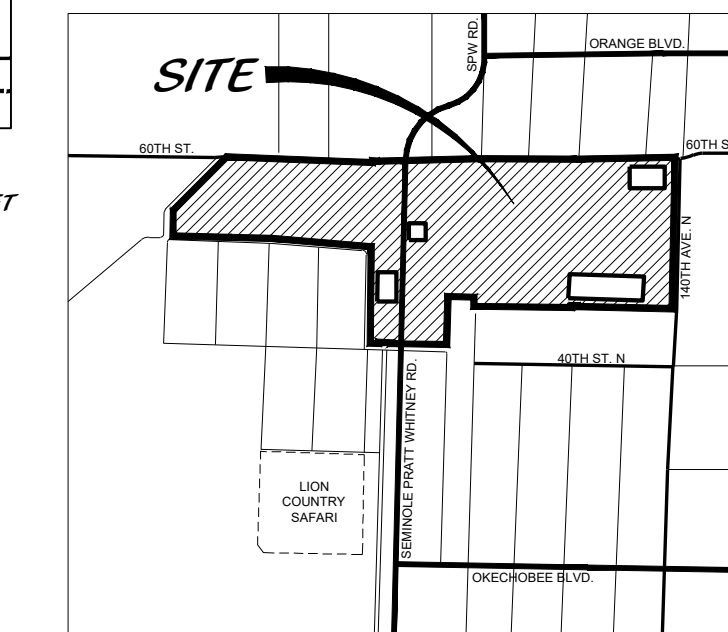

**LANDSCAPE DATA**

AREA CALCULATIONS	S.F.	AC.	%
BUILDING FOOTPRINT	227,000.00	5.211	29.93%
VEHICULAR USE AREA	268,649.73	6.167	35.42%
SIDEWALKS & ENTRY STOOPS	24,008.40	0.551	3.17%
LANDSCAPE BUFFER AREA	47,185.64	1.083	6.22%
FOUNDATION PLANTING AREA	27,525.00	0.632	3.63%
INTERIOR LANDSCAPE AREA	164,034.00	3.766	21.65%
<b>TOTAL SITE AREA</b>	<b>758,403</b>	<b>17.41</b>	<b>100.00%</b>

GROSS AFFECTED AREA			
758,403 SF			
CATEGORY	CODE	REQ.	PROV.
<b>INTERIOR LANDSCAPE (SECTION 4, TABLE 4-3)</b>			
TOTAL TREES FOR GROSS SITE AREA	1/3000 SF	253	284
TOTAL SHRUBS FOR GROSS SITE AREA	3/1250 SF	1820	2344
<b>FOUNDATION PLANTING - FRONT FAÇADE - 400 LF (SECTION 4.15)</b>			
TREES - (1/20 LF OF 40% FAÇADE LENGTH)	1/20 OF 96 LF	4	7
SHRUBS - (8' WIDTH PLANTING AREA FOR 40% FAÇADE LENGTH)	1/10 OF 96 SF	76	85
<b>FOUNDATION PLANTING - SIDE FAÇADES - 1846 LF (SECTION 4.16)</b>			
TREES - (1/20 LF OF 40% FAÇADE LENGTH)	1/20 OF 738 LF	37	16
SHRUBS - (5' WIDTH PLANTING AREA FOR 40% FAÇADE LENGTH)	1/10 OF 738 SF	74	181
<b>NORTH BUFFER - 1080 LF (SECTION 4.13)</b>			
TREES **	1/25 LF	43	43
CONTINUOUS HEDGE	3' HT.	YES	YES
<b>SOUTH BUFFER - 1063 LF (SECTION 4.13)</b>			
TREES	1/25 LF	43	44
CONTINUOUS HEDGE	3' HT.	YES	YES
<b>WEST BUFFER - 812 LF (SECTION 4.13)</b>			
TREES	1/25 LF	32	33
CONTINUOUS HEDGE	3' HT.	YES	YES
<b>TREE SPECIES MIX (SECTION 4.12)</b>			
M.N. NO. OF TREE SPECIES	284 TREES	6	13
<b>PLANT SPECIES (SECTION 4.12)</b>			
NATIVE TREE SPECIES	60% OF REQ. MIN.	152	205
NATIVE SHRUB SPECIES	60% OF REQ. MIN.	1092	2254

**LEGEND**

- ADA AMERICAN DISABILITIES ACT
- LB LANDSCAPE BUFFER
- R RADIUS
- SB SETBACK
- SW SIDEWALK
- TYP TYPICAL
- ADA SIGN
- STOP SIGN
- PEDESTRIAN CROSSING

**Cotleur & Hearing**  
 Landscape Architects  
 Land Planners  
 Environmental Consultants  
 1934 Commerce Lane  
 Suite 1  
 Jupiter, Florida 33458  
 561.747.6336 · Fax 747.1377  
 www.cotleurhearing.com  
 Lic# LC-C000239

**WESTLAKE LANDINGS**  
**WESTLAKE WARE HOUSE**  
**PALM BEACH COUNTY, FL**

DESIGNED	DEH/JCO
DRAWN	JCO
APPROVED	DEH
JOB NUMBER	13-0518.60
DATE	12-21-21
REVISIONS	01-20-22

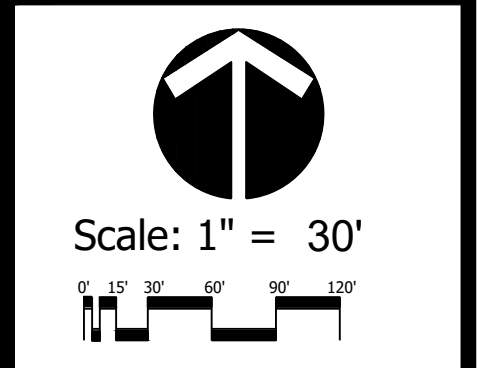

January 18, 2022 9:06:42 a.m.  
 Drawing: 13-0518.60.05 LP.DWG

**Conceptual  
 Landscape Plan**

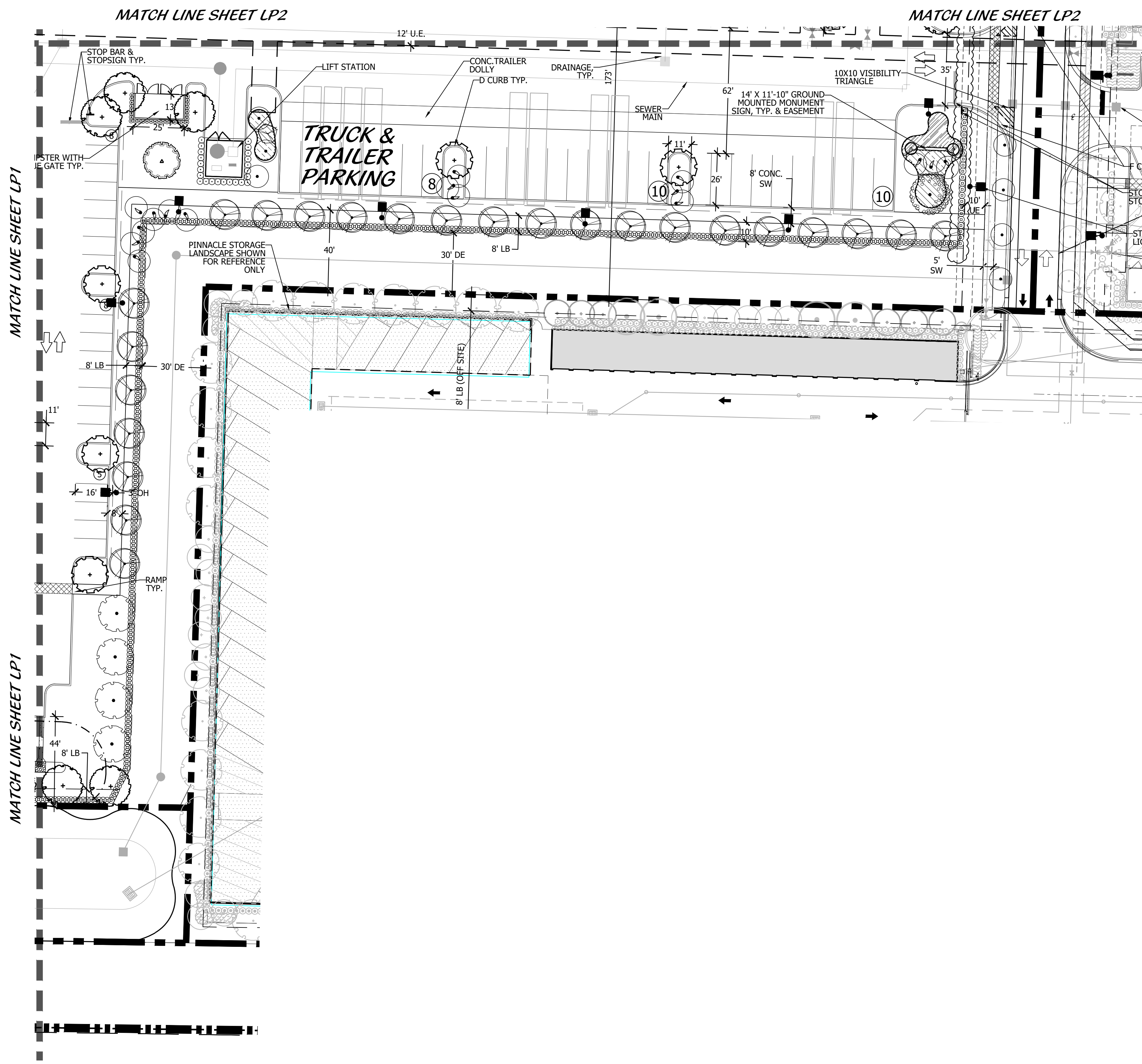

**SHEET MAP**

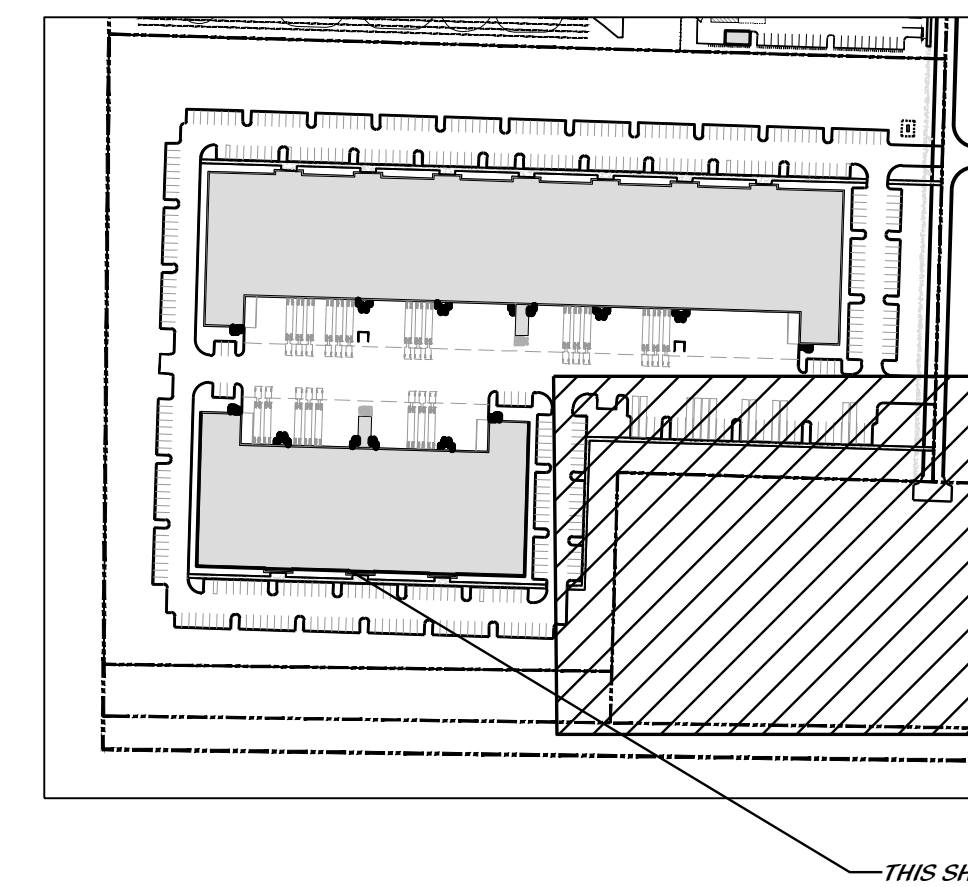

**KEY MAP**

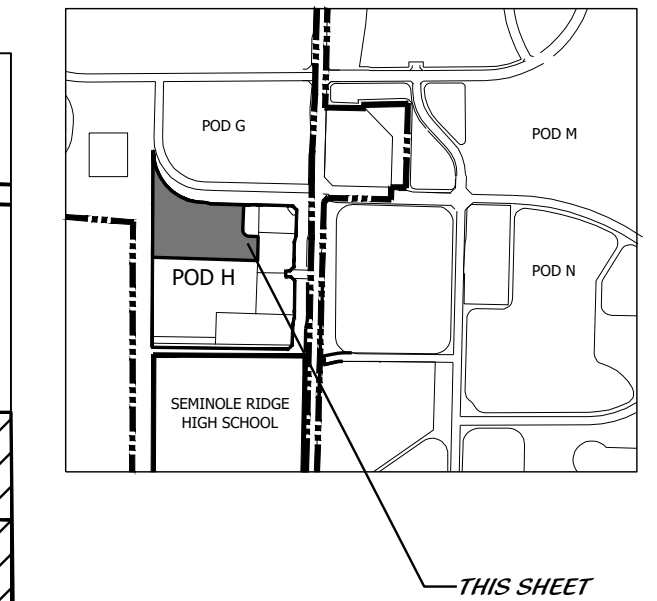

**LOCATION MAP**

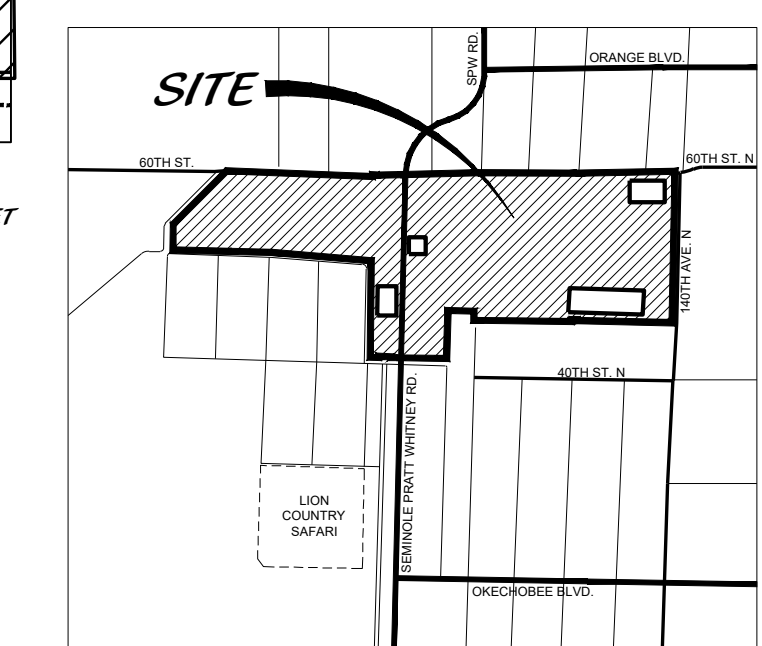

**LANDSCAPE DATA**

AREA CALCULATIONS	S.F.	AC.	%
BUILDING FOOTPRINT	227,000.00	5.211	29.93%
VEHICULAR USE AREA	268,649.73	6.167	35.42%
SIDEWALKS & ENTRY STOOPS	24,008.40	0.551	3.17%
LANDSCAPE BUFFER AREA	47,185.64	1.083	6.22%
FOUNDATION PLANTING AREA	27,525.00	0.632	3.63%
INTERIOR LANDSCAPE AREA	164,034.00	3.766	21.65%
<b>TOTAL SITE AREA</b>	<b>758,403</b>	<b>17.41</b>	<b>100.00%</b>

  

LANDSCAPE DATA	CODE	REQ.	PROV.
<b>INTERIOR LANDSCAPE (SECTION 4. TABLE 4-3)</b>			
TOTAL TREES FOR GROSS SITE AREA	1/3000 SF	253	284
TOTAL SHRUBS FOR GROSS SITE AREA	3/1250 SF	1820	2344
<b>FOUNDATION PLANTING: FRONT FAÇADE - 400 LF (SECTION 4.15)</b>			
TREES - (1/20 LF OF 40% FAÇADE LENGTH)	1/20 OF 96 LF	4	7
SHRUBS - (8' WIDTH PLANTING AREA FOR 40% FAÇADE LENGTH)	1/10 OF 96 SF	76	85
<b>FOUNDATION PLANTING - SIDE FAÇADES - 1846 LF (SECTION 4.16)</b>			
TREES - (1/20 LF OF 40% FAÇADE LENGTH)	1/20 OF 738 LF	37	16
SHRUBS - (5' WIDTH PLANTING AREA FOR 40% FAÇADE LENGTH)	1/10 OF 738 SF	74	181
<b>NORTH BUFFER - 1080 LF (SECTION 4.13)</b>			
TREES **	1/25 LF	43	43
CONTINUOUS HEDGE	3' HT.	YES	YES
<b>SOUTH BUFFER - 1063 LF (SECTION 4.13)</b>			
TREES	1/25 LF	43	44
CONTINUOUS HEDGE	3' HT.	YES	YES
<b>WEST BUFFER - 812 LF (SECTION 4.13)</b>			
TREES	1/25 LF	32	33
CONTINUOUS HEDGE	3' HT.	YES	YES
<b>TREE SPECIES MIX (SECTION 4.12)</b>			
MIN. NO. OF TREE SPECIES	284 TREES	6	13
<b>PLANT SPECIES (SECTION 4.12)</b>			
NATIVE TREE SPECIES	60% OF REQ. MIN.	152	205
NATIVE SHRUB SPECIES	60% OF REQ. MIN.	1092	2254

**LEGEND**

- ADA AMERICAN DISABILITIES ACT
- LB LANDSCAPE BUFFER
- R RADIUS
- SB SETBACK
- SW SIDEWALK
- TYP TYPICAL
- STOP SIGN STOP SIGN
- PEDESTRIAN CROSSING PEDESTRIAN CROSSING

\* NOTE: EAST BUFFER LANDSCAPE REQUIREMENTS ARE SATISFIED BY EXISTING LANDSCAPE BUFFER.  
 \*\* CANOPY TREE SUBSTITUTE IS 3:1 RATIO, EXCEPTION FOR ROYAL BISMARCK, PHOENIX, AND CANARY. (7.D.28) (ORD. 2018-002)  
 NOTE: A MINIMUM OF 3' OF LANDSCAPE SHALL BE PROVIDED SURROUNDING ALL GROUND MOUNTED SIGNS

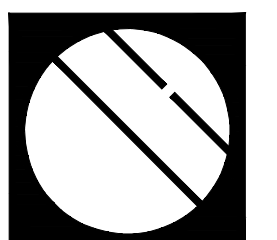

**Cotleur & Hearing**

Landscape Architects  
 Land Planners  
 Environmental Consultants  
 1934 Commerce Lane  
 Suite 1  
 Jupiter, Florida 33458  
 561.747.6336 · Fax 747.1377  
 www.cotleurhearing.com  
 Lic# LC-C000239

**WESTLAKE LANDINGS**  
 WESTLAKE WARE HOUSE  
 PALM BEACH COUNTY, FL

DESIGNED	DEH/JCO
DRAWN	JCO
APPROVED	DEH
JOB NUMBER	13-0518.60
DATE	12-21-21
REVISIONS	01-20-22

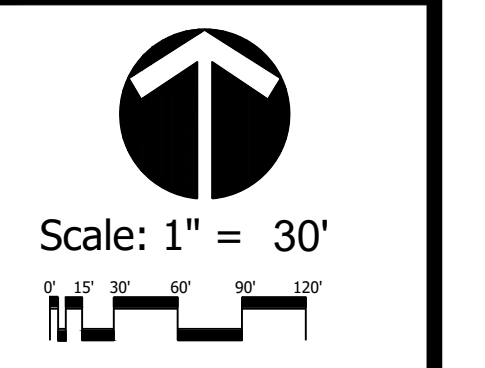

January 18, 2022 9:06:42 a.m.  
 Drawing: 13-0518.60.05 LP.DWG

**Conceptual Landscape Plan**

TREES	BOTANICAL / COMMON NAME	CONT	CAL	SIZE	NATIVE	QTY
	CLUSIA FLAVA / SMALL LEAF CLUSIA TREE FULL CANOPY, COLUMNAR, MATCHED.	65 GAL	3" CAL	12' HT X 6' SPRD	N	2
	ILEX X ATTENUATA 'EAGLESTON' / EAGLESTON HOLLY FULL CANOPY, 5' CT. SOUTH GROWN, MATCHED, FLORIDA FANCY, FULL TO BASE	45 GAL	2.5" CAL	12' HT X 4' SPRD	Y	13
	JUNIPERUS SILICICOLA 'BRODIE' ~ / BRODIE SOUTHERN RED CEDAR FULL & THICK, FULL TO BASE.	45 GAL	NA	12' OA	Y	3
	LAGERSTROEMIA INDICA 'MUSKOGEE' OR 'TUSKEGEE' / CREPE MYRTLE MULTI, LIMB UP 5'. CHERRY LAKE NURSERY.	30 GAL	NA	12' HT X 4' SPRD	N	9
	PODOCARPUS HENKELII / PLUM PINE FULL TO BASE	FIELD GROWN	2" CAL	14'-16' OA	N	14
CANOPY TREES	BOTANICAL / COMMON NAME	CONT	CAL	SIZE	NATIVE	QTY
	BUCIDA BUCERAS 'SHADY LADY' / SHADY LADY BLACK OLIVE FULL CANOPY MATCHED	45 GAL	3" CAL	12' OA	N	19
	BULNESIA ARBOREA / VERAWOOD SINGLE STRAIGHT TRUNK, FULL CANOPY.	65 GAL	2.5" CAL	12'-14' HT, 6'-8' SPRD	N	2
	BURSERIA SIMARUBA / GUMBO LIMBO FULL CANOPY	45 GAL	3.5" CAL	12' HT X 6' SPRD	Y	8
	CONOCARPUS ERECTUS 'MOMBA' / GREEN BUTTWOOD TREE FULL CANOPY, SINGLE STRAIGHT TRUNK.	30 GAL	2.5" CAL	12' -14' OA	Y	98
	DELONIX REGIA / ROYAL POINCIANA FULL CANOPY, SPECIMEN.	B & B	3.5" CAL	12'-14' OA	N	1
	ELAEOCARPUS DECIPENS / JAPANESE BLUEBERRY TREE STANDARD, FULL & THICK CANOPY, SINGLE STRAIGHT TRUNK, MATCHED, CHERRY LAKE	45 GAL	N.A.	12-14' HT X 7' SPRD	N	2
	FICUS RUBIGINOSA / RUSTY LEAF FIG FULL CANOPY, SPECIMEN	FIELD GROWN	3.5" CAL	12' HT X 4' SPRD	Y	3
	QUERCUS VIRGINIANA / LIVE OAK 6' C.T. MIN., FULL CANOPY, SYMMETRICAL, MATCHED, TREE SHALL BE GROWN FROM SEED, NOT FROM GRAFTED CULTIVAR OR CLONE VARIETIES	65 GAL	3" CAL	12' - 14' x 7' SPRD	Y	42
	SWIETENIA MAHAGONI / WEST INDIAN MAHOGANY FULL CANOPY, GRADE #1	45 GAL	3" CAL	12' - 14' X 6' SPRD	Y	38
PALM TREES	BOTANICAL / COMMON NAME	CONT	CAL	SIZE	NATIVE	QTY
	PHOENIX SYLVESTRIS / SYLVESTER DATE PALM FULL CANOPY, STRAIGHT TRUNK, CT SPECIFIED ON PLANS, MATCHED, RELOCATED FROM ON SITE. (FISH BRANCH)	FIELD GROWN	NA	12' GW	N	3
	SABAL PALMETTO / SABAL PALMETTO SEE PLAN FOR SIZES, SLICK TRUNK, PERFECTLY MATCHED.	NA	NA	10', 12', 14', 18, CT STG HTS	Y	96
	SABAL PALMETTO / CURVED CABBAGE PALM EACH SIZE, SLICK TRUNKS	NA	NA	12', 18', 24', 26', 28' CT STG HTS	Y	35
	VEITCHIA MONTGOMERYANA ~ / MONTGOMERY PALM TRIPLE TRUNK, FULL CANOPY	B & B	NA	18' OA	N	2
SMALL PALMS	BOTANICAL / COMMON NAME	CONT	CAL	SIZE	NATIVE	QTY
	CHAMAEROPS HUMILIS 'SILVER SELECT' / EUROPEAN FAN PALM SILVER SELECT MULTI TRUNK, FULL CANOPY	30 GAL	NA	4'-5' OA	N	23
SMALL TREES	BOTANICAL / COMMON NAME	CONT	CAL	SIZE	NATIVE	QTY
	LIGUSTRUM JAPONICUM / LIGUSTRUM TREE FORM MATCHED, MULTI TRUNK, LIMB UP PER L.A.	45 GAL	NA	8' OA HT X 7' SPRD	N	18
	MYRICA CERIFERA / WAX MYRTLE FULL CANOPY, GENERALLY MATCHED IN FORM AND SHAPE.	30 GAL	NA	8' HT X 8' SPRD	Y	1
SHRUBS	BOTANICAL / COMMON NAME	CONT	SIZE	SPACE	NATIVE	QTY
	AGAVE AMERICANA 'GAINESVILLE BLUE' / BLUE CENTURY PLANT FULL & THICK	15 GAL	30" x 30"	AS	N	6
	CLUSIA FLAVA / SMALL LEAF CLUSIA FULL & THICK	7 GAL	36" X 24"	30" OC	Y	653
	CLUSIA GLUTTIFERA / CLUSIA FULL & THICK.	7 GAL	4'-5" OA	3' OC	Y	23
	EUGENIA FOETIDA / SPANISH STOPPER FULL & THICK.	3 GAL	NA	24" OC	Y	1,679
	PODOCARPUS MACROPHYLLUS / PODOCARPUS FULL & THICK	10 GAL	5'-6" OA	2' OC	N	59

GROUND COVERS	BOTANICAL / COMMON NAME	CONT	SIZE	SPACE	NATIVE	QTY
	PODOCARPUS MACROPHYLLUS / PODOCARPUS FULL AND THICK	15 GAL	4'-5" OA	30" OC	N	25
	CHRYSOBALANUS ICACO / COCOPLUM FULL & THICK	3 GAL	18" X 18"	24" OC	Y	129
	CHRYSOBALANUS ICACO 'HORIZONTAL' / DWARF COCOPLUM FULL & THICK, NOT STRETCHED, FLORIDA FANCY	3 GAL	12" X 12"	24" OC	Y	100
	ILEX VOMITORIA 'STOKES DWARF' / DWARF YAUPON HOLLY FULL & THICK	3 GAL	14" X 14"	24" OC	Y	123
	MUHLENBERGIA CAPILLARIS / MUHLY GRASS FULL & THICK	3 GAL	18" X 18"	30" OC	Y	56
	PODOCARPUS MACR. 'PRINGLES' OR 'META' / DWARF PODOCARPUS FULL & THICK	7 GAL	18" x 24"	24" OC	N	238
	TRIPSACUM FLORIDANA / DWARF FAKAHATCHEE GRASS FULL & THICK	3 GAL	18" X 18"	24" OC	Y	197

# Conceptual Landscape Schedule



**Cotleur & Hearing**  
Landscape Architects  
Land Planners  
Environmental Consultants  
1934 Commerce Lane  
Suite 1  
Jupiter, Florida 33458  
561.747.6336 - Fax 747.1377  
www.cotleurhearing.com  
Lic# LC-C000239

## WESTLAKE LANDINGS WESTLAKE WARE HOUSE PALM BEACH COUNTY, FL

DESIGNED	DEH/JCO
DRAWN	JCO
APPROVED	DEH
JOB NUMBER	13-0518.60
DATE	12-21-21
REVISIONS	01-20-22

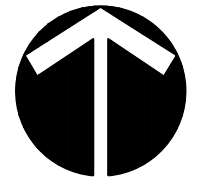

Scale: 1" = 30'

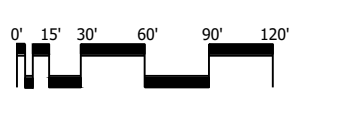

January 18, 2022 9:06:42 a.m.  
Drawing: 13-0518.60.05 LP.DWG