

ALL REPORTS, PLANS, SPECIFICATIONS, COMPUTER FILES, FIELD DATA, NOTES & OTHER DOCUMENTS ARE INSTRUMENTS OF SERVICE PREPARED BY CUHACI PETERSON, (CP) AS INSTRUMENTS OF SERVICE REMAIN THE PROPERTY OF CP. CP SHALL RETAIN ALL COMMON LAW, STATUTORY, AND OTHER RESERVED RIGHTS, INCLUDING THE COPYRIGHT THEREON. ANY USE OR REPRODUCTION OF THIS DOCUMENT WITHOUT WRITTEN PERMISSION FROM CP IS A VIOLATION OF FEDERAL COPYRIGHT LAWS.

DO NOT SCALE PLANS

Copying, Printing, Software and other processes required to produce these prints can stretch or shrink the actual paper or layout. Therefore, scaling of this drawing may be inaccurate. Contact CuHaci Peterson with any need for additional dimensions or clarifications.

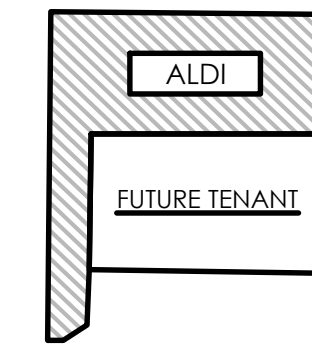

FLOOR FINISH SCHEDULE

- ① POLISHED CONCRETE (PC/PC-GRAY) PER ALDI SPECIFICATION. GRIND AND POLISH EXISTING SLAB OR POUR NEW SLAB WHERE REQUIRED. SEE STRUCTURAL SHEETS FOR SLAB REQUIREMENTS.
- ② CLEAN, PATCH, AND GRIND AS REQD. AT AREAS OF OLD FLOORING RESIDUE. PROVIDE SMOOTH FINISH. WHERE REQD. POUR NEW SLAB AND HARD TROWEL SMOOTH SEAL PER ALDI SPECIFICATION.
- ③ POUR NEW FREEZER SLAB PER DETAILS AND PROVIDE HEAVY BROOM FINISH. SEAL PER ALDI SPECIFICATION.
- ④ POUR NEW RECESSED SLAB. FINISH AS REQD FOR PORCELAIN TILE FLOORING. SEE STRUCTURAL SHEETS FOR NEW SLAB REGS. SEE DETAILS FOR SLAB RECESS.

NOTES

- 1. REFER TO DRAWING A-603 FOR COLOR/ FINISH MATERIAL SCHEDULES.
- 2. ALL PARTITION DIMENSIONS ARE TO FACE OF STUD UNLESS NOTED OTHERWISE (IE. CLEAR)
- 3. PROVIDE BLOCKING AS NEEDED FOR ALL WALL MOUNTED ITEMS
- 4. FLAT STEEL IS REQD AT MERCH. FIXTURES COORD LOCATIONS W/ ALDI REP.
- 5. REFER TO DRAWING A-603 FOR INTERIOR METAL STUD INFORMATION
- 6. ALL CONCRETE SLABS SHALL HAVE A SMOOTH FINISH. ALL EXISTING CONCRETE SLABS TO BE CLEANED AND ACID WASHED.
- 7. FILL ALL HOLES IN CMU WALLS AFTER DEMOLITION WORK.
- ⑧ INDICATES COLUMN DESIGNATION

GC TO REVIEW SLAB CONDITION WITH THE ALDI DIRECTOR OF REAL ESTATE AND CONSTRUCTION PROJECT MANAGER IMMEDIATELY FOLLOWING LVT THE REMOVAL TO ASSESS SLAB CONDITION TO SEE IF POLISHED CONCRETE IS AN OPTION IN LIEU OF MVT.

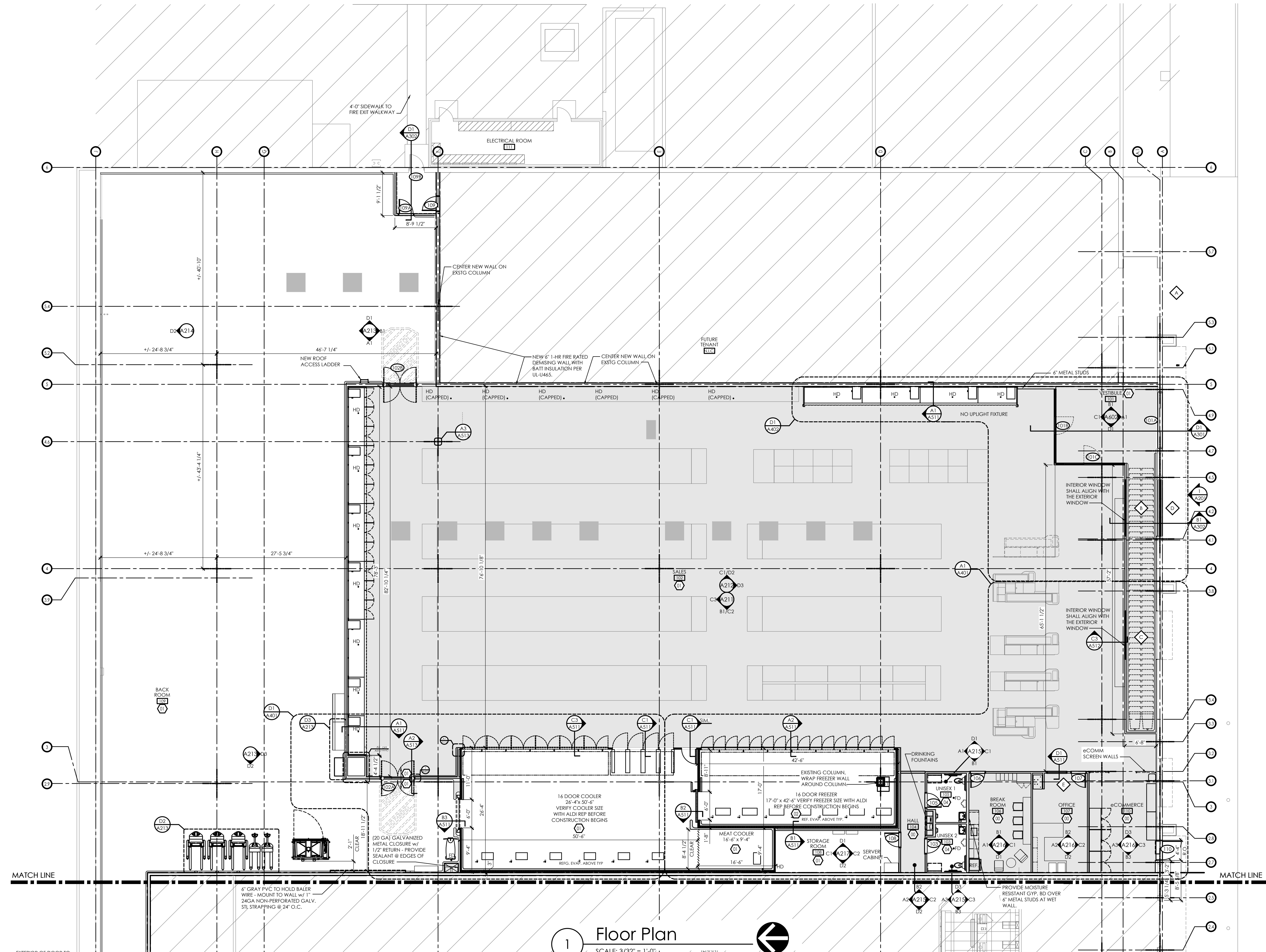

1 Floor Plan
SCALE: 3/32" = 1'-0"
PLAN NORTH

PLOTTED: 6/3/2024 11:39 AM

Issued:	Date:
A OWNER SET	04-29-2024
B PERMIT SET	05-30-2024
C	
D	
E	

Revisions:	Date:
1	
2	
3	
4	
5	
6	
7	
8	
9	
10	
11	
12	

PROJECT ARCHITECT/ENGINEER	DATE
MARCUS J. BOYLE	05-30-2024
PROJECT LEAD	DATE
JUSTIN MAY	05-30-2024

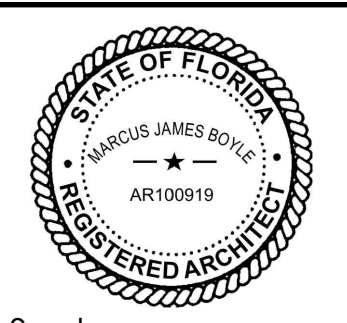

Seal Seal

ALDI Inc.
1171 North State Road 7
Royal Palm Beach, FL 33411
(561) 640-8000

ALDI Inc. Store #:0213
Westlake, FL
5060 Seminole Pratt Whitney Rd
Westlake, FL 33470
West Palm Beach County
Project Name & Location:

Floor Plan	
Drawing Name:	Project No.
Prototype: V9.1	20240003
Type: RETROFIT	
Drawn By: MS	A-101
Scale: As Noted	Drawing No.

Issued:	Date:
A OWNER SET	04-29-2024
B PERMIT SET	05-30-2024
C	
D	
E	

Revisions:	Date:
1	
2	
3	
4	
5	
6	
7	
8	
9	
10	
11	
12	

PROJECT ARCHITECT/ENGINEER	DATE
MARCUS J. BOYLE	05-30-2024
PROJECT LEAD	DATE
JUSTIN MAY	05-30-2024

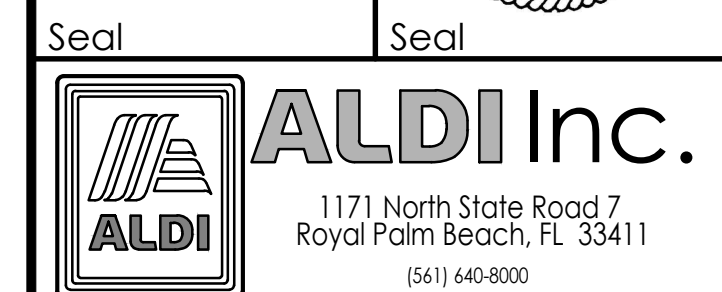
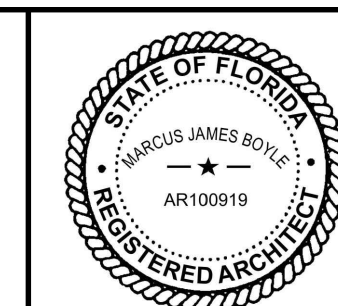

ALDI Inc. Store #:0213
Westlake, FL
5060 Seminole Pratt Whitney Rd
Westlake, FL 33470
West Palm Beach County
Project Name & Location:

Floor Plan

Drawing Name:	Project No.
Prototype:	20240003
v9.1	
Type:	A-101.1
RETROFIT	
Drawn By:	MS
Scale:	As Noted
	Drawing No.

FLOOR FINISH SCHEDULE

- 1. POLISHED CONCRETE (P/CONC-SHADED) PER ALDI SPECIFICATION. GRIND AND POLISH EXISTING SLAB OR POUR NEW SLAB WHERE REQUIRED. SEE STRUCTURAL SHEETS FOR SLAB REQUIREMENTS.
- 2. CLEAN, PATCH, AND GRIND AS REQD. AT AREAS OF OLD FLOORING RESIDUE. PROVIDE SMOOTH FINISH. WHERE REQD. POUR NEW SLAB AND HARD TROWEL SMOOTH SEAL PER ALDI SPECIFICATION.
- 3. POUR NEW FREEZER SLAB PER DETAILS AND PROVIDE HEAVY BROOM FINISH. SEAL PER ALDI SPECIFICATION.
- 4. POUR NEW RECESSED SLAB. FINISH AS REQD FOR PORCELAIN TILE FLOORING. SEE STRUCTURAL SHEETS FOR NEW SLAB REQS. SEE DETAILS FOR SLAB RECESS.

NOTES:

- 1. REFER TO DRAWING A-603 FOR COLOR/ FINISH MATERIAL SCHEDULES.
- 2. ALL PARTITION DIMENSIONS ARE TO FACE OF STUD UNLESS NOTED OTHERWISE (IE CLEAR) PROVIDE BLOCKING AS NEEDED FOR ALL WALL MOUNTED ITEMS.
- 3. FLAT STEEL IS REQD AT MERCH. FIXTURES COORD LOCATIONS W/ ALDI REF.
- 4. REFER TO DRAWING A-603 FOR INTERIOR METAL STUD INFORMATION.
- 5. ALL CONCRETE SLABS SHALL HAVE A SMOOTH FINISH. ALL EXISTING CONCRETE SLABS TO BE CLEANED AND ACID WASHED.
- 6. FILL ALL HOLES IN CMU WALLS AFTER DEMOLITION WORK.
- 7. ○ INDICATES COLUMN DESIGNATION

IC2 TO REVIEW SLAB CONDITION WITH THE ALDI DIRECTOR OF REAL ESTATE AND CONSTRUCTION PROJECT MANAGER IMMEDIATELY FOLLOWING UTILE REMOVAL TO ASSESS SLAB CONDITION TO SEE IF POLISHED CONCRETE IS AN OPTION IN LIEU OF MVT.

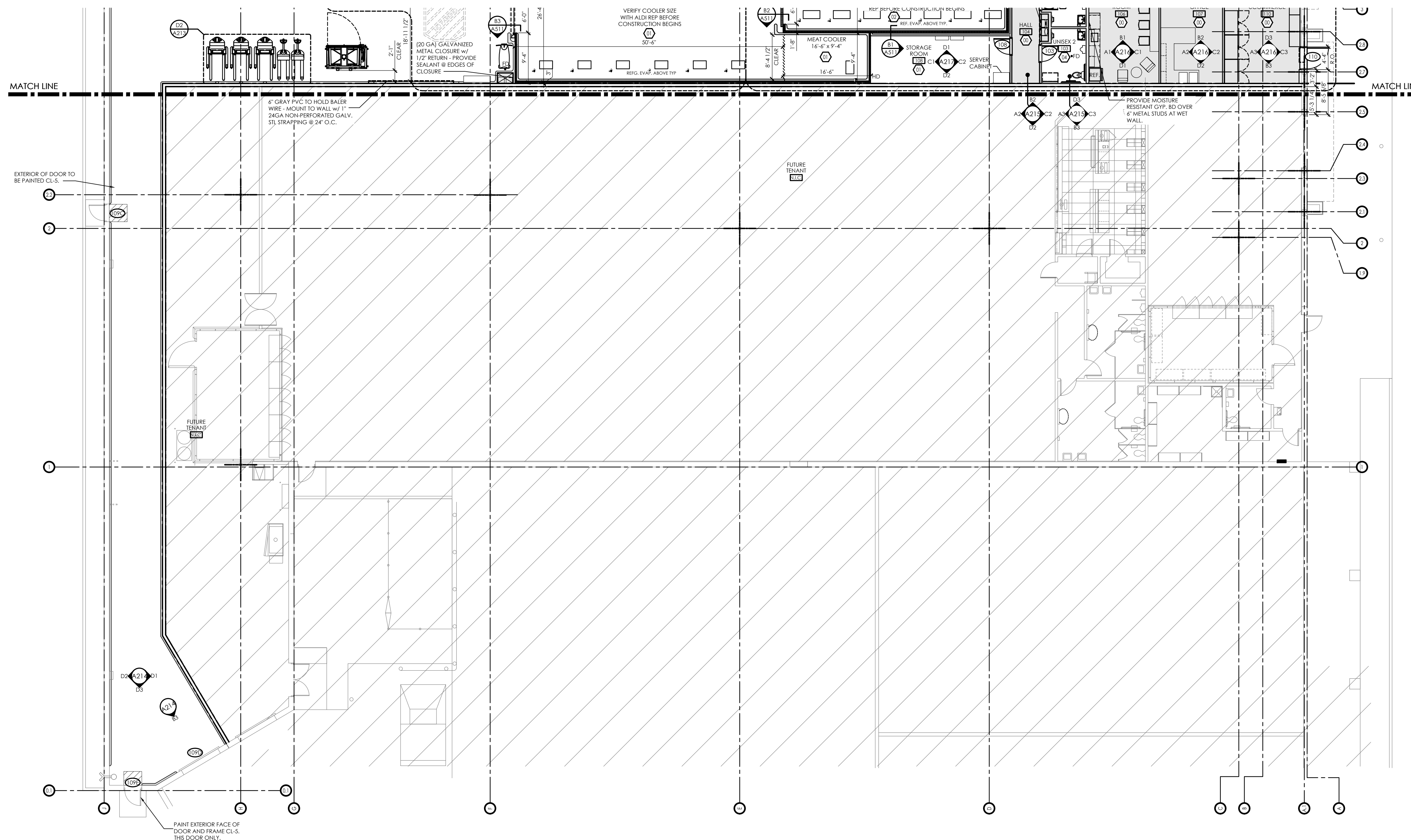
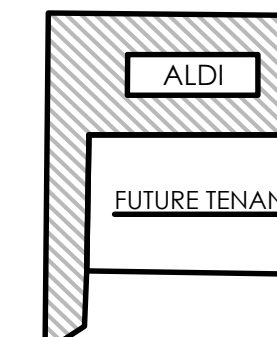

1 Floor Plan
SCALE: 3/32" = 1'-0"



AREA SUMMARY		
OCCUPANCY USE	ROOM NAME	SQUARE FOOTAGE
MERCANTILE (M)	SALES / VESTIBULE	13,563
	UNISEX 2	78
	UNISEX 1	79
	HALL	118
SUBTOTAL (MERCANTILE)		13,838
BUSINESS (B)	OFFICE	243
	BREAK ROOM	277
	eCOMMERCE	304
	CART STORAGE	824
SUBTOTAL (BUSINESS)		824
STORAGE / STOCK (S-2)	BACKROOM	10,500
	COOLER	1,439
	FREEZER	674
	STORAGE ROOM	234
SUBTOTAL (STORAGE / STOCK)		12,847
SUBTOTAL (OCCUPANCIES)		27,509
EXTERIOR / INTERIOR WALLS / UNOCCUPIED SPACE		1,085
ALDI SQUARE FOOTAGE		28,594
ELECTRICAL ROOM		327
EXTERIOR CANOPY		250
TOTAL SQUARE FOOTAGE (INCLUDING CANOPY)		29,171

OPERATIONS DATA	
ITEM	QUANTITY
LINEAR FOOTAGE OF BASE (PRODUCE INCLUDED)	830'-0"
ASSUMED PALLET STORAGE	50
BUILDING DIMENSIONS	250'-0" x 220'-0"
SALES FLOOR DIMENSIONS	81'-11" x 171'-9 1/2"
LENGTH OF MULTIDECK	120'
COOLER MILK DOORS	4
COOLER GENERAL DOORS	12
FREEZER GENERAL DOORS	16
SPOT MERCHANDISERS	12
CART STORAGE	84

NOTES:
 1. THIS DRAWING IS FOR GENERAL FIXITURING LAYOUT AND REFERENCE TO EQUIPMENT ONLY. ALL INFORMATION IS FOR ALDI OPERATIONAL USE ONLY AND SHALL NOT BE USED FOR CONSTRUCTION OR BIDDING PURPOSES.
 2. ALL DIMENSIONS TO WALLS ARE TO FACE OF STUD UNO.
 3. GONDOLA LOCATIONS ARE MEASURED FROM THE FACE OF THE STAINLESS STEEL PRICE TAG MOLDING (SSPTM).

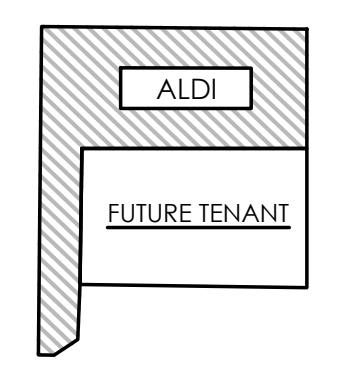

Key Plan
 NORTH

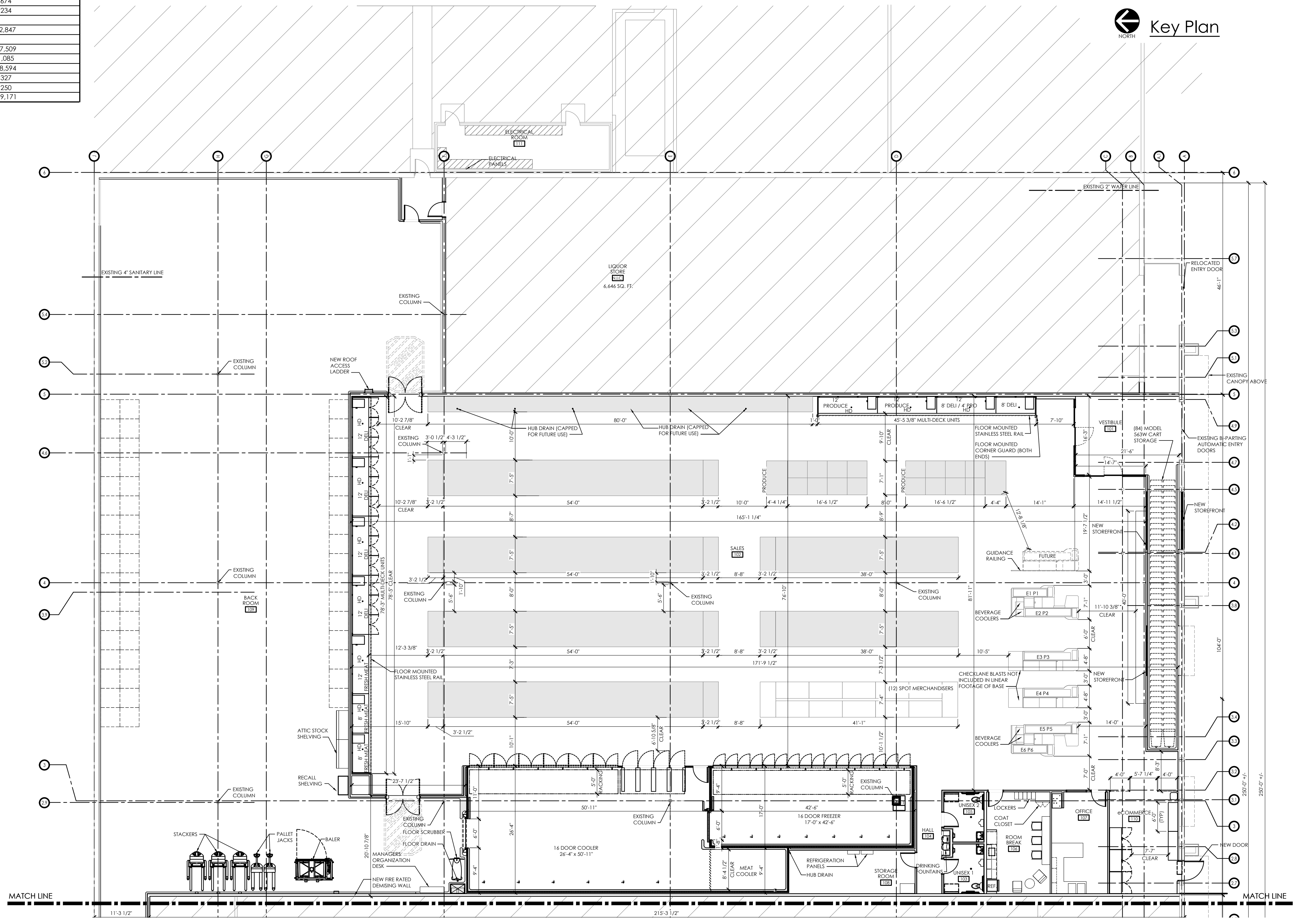

CUHACI PETERSON
 2600 Mallard Center Parkway
 Suite #200
 Maitland, FL 32751
 P (407) 661-9100
 F (407) 661-9101
 c-p.com
 Florida Certificate #FA 000026

Copyright © 2024
 ALL REPORTS, PLANS, SPECIFICATIONS, COMPUTER FILES, FIELD DATA, NOTES & OTHER DOCUMENTS ARE INSTRUMENTS OF SERVICE PREPARED BY CUHACI PETERSON, (CP) AS INSTRUMENTS OF SERVICE REMAIN THE PROPERTY OF CP. CP SHALL RETAIN ALL COMMON LAW, STATUTORY, AND OTHER RESERVED RIGHTS, INCLUDING THE COPYRIGHT THEREON. ANY USE OR REPRODUCTION OF THIS DOCUMENT WITHOUT WRITTEN PERMISSION FROM CP IS A VIOLATION OF FEDERAL COPYRIGHT LAWS.

DO NOT SCALE PLANS
 Copying, Printing, Software and other processes required to produce these prints can stretch or shrink the actual paper or layout. Therefore, scaling of this drawing may be inaccurate. Contact Cuhaci Peterson with any need for additional dimensions or clarifications.

Issued:	Date:
A OWNER SET	04-29-2024
B PERMIT SET	05-30-2024
C	
D	
E	

Revisions:	Date:
1	
2	
3	
4	
5	
6	
7	
8	
9	
10	
11	
12	

PROJECT ARCHITECT/ENGINEER DATE
 MARCUS J. BOYLE 05-30-2024
 PROJECT LEAD DATE
 JUSTIN MAY 05-30-2024

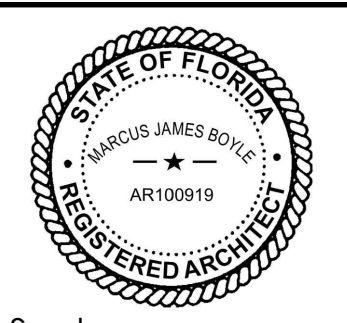

Seal Seal
ALDI Inc.
 1171 North State Road 7
 Royal Palm Beach, FL 33411
 (561) 640-8000

ALDI Inc. Store #:0213
 Westlake, FL
 5060 Seminole Pratt Whitney Rd
 Westlake, FL 33470
 West Palm Beach County
 Project Name & Location:

Operations Plan	
Drawing Name:	Project No.
Prototype:	20240003
Type:	RETROFIT
Drawn By:	JS/MS
Scale:	A-131
As Noted	Drawing No.

1 Operations Plan
 SCALE: 3/32" = 1'-0"
 PLAN NORTH

PLOTTED: 6/3/2024 11:50 AM

NOTES:
 1. THIS DRAWING IS FOR GENERAL FIXTURING LAYOUT AND REFERENCE TO EQUIPMENT ONLY. ALL INFORMATION IS FOR ALDI OPERATIONAL USE ONLY AND SHALL NOT BE USED FOR CONSTRUCTION OR BIDDING PURPOSES.
 2. ALL DIMENSIONS TO WALLS ARE TO FACE OF STUD UNO.
 3. GONDOLA LOCATIONS ARE MEASURED FROM THE FACE OF THE STAINLESS STEEL PRICE TAG MOLDING (SSPTM).



2600 Mallard Center Parkway
 Suite #200
 Mallard, FL 32751
 P (407) 661-9100
 F (407) 661-9101
 c-p.com
 Florida Certificate #AA 000026

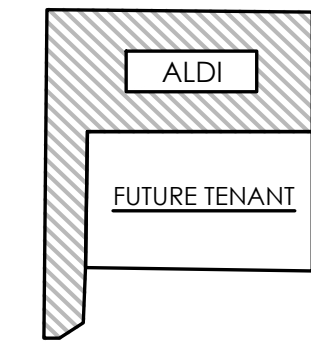

Copyright © 2024
 ALL REPORTS, PLANS, SPECIFICATIONS, COMPUTER FILES, FIELD DATA, NOTES & OTHER DOCUMENTS ARE INSTRUMENTS OF SERVICE PREPARED BY CUHACI PETERSON, (CP) AS INSTRUMENTS OF SERVICE REMAIN THE PROPERTY OF CP. CP SHALL RETAIN ALL COMMON LAW, STATUTORY, AND OTHER RESERVED RIGHTS, INCLUDING THE COPYRIGHT THEREON. ANY USE OR REPRODUCTION OF THIS DOCUMENT WITHOUT WRITTEN PERMISSION FROM CP IS A VIOLATION OF FEDERAL COPYRIGHT LAWS.

DO NOT SCALE PLANS
 Copying, Printing, Software and other processes required to produce these prints can stretch or shrink the actual paper or layout. Therefore, scaling of this drawing may be inaccurate. Contact CuHaci Peterson with any need for additional dimensions or clarifications.

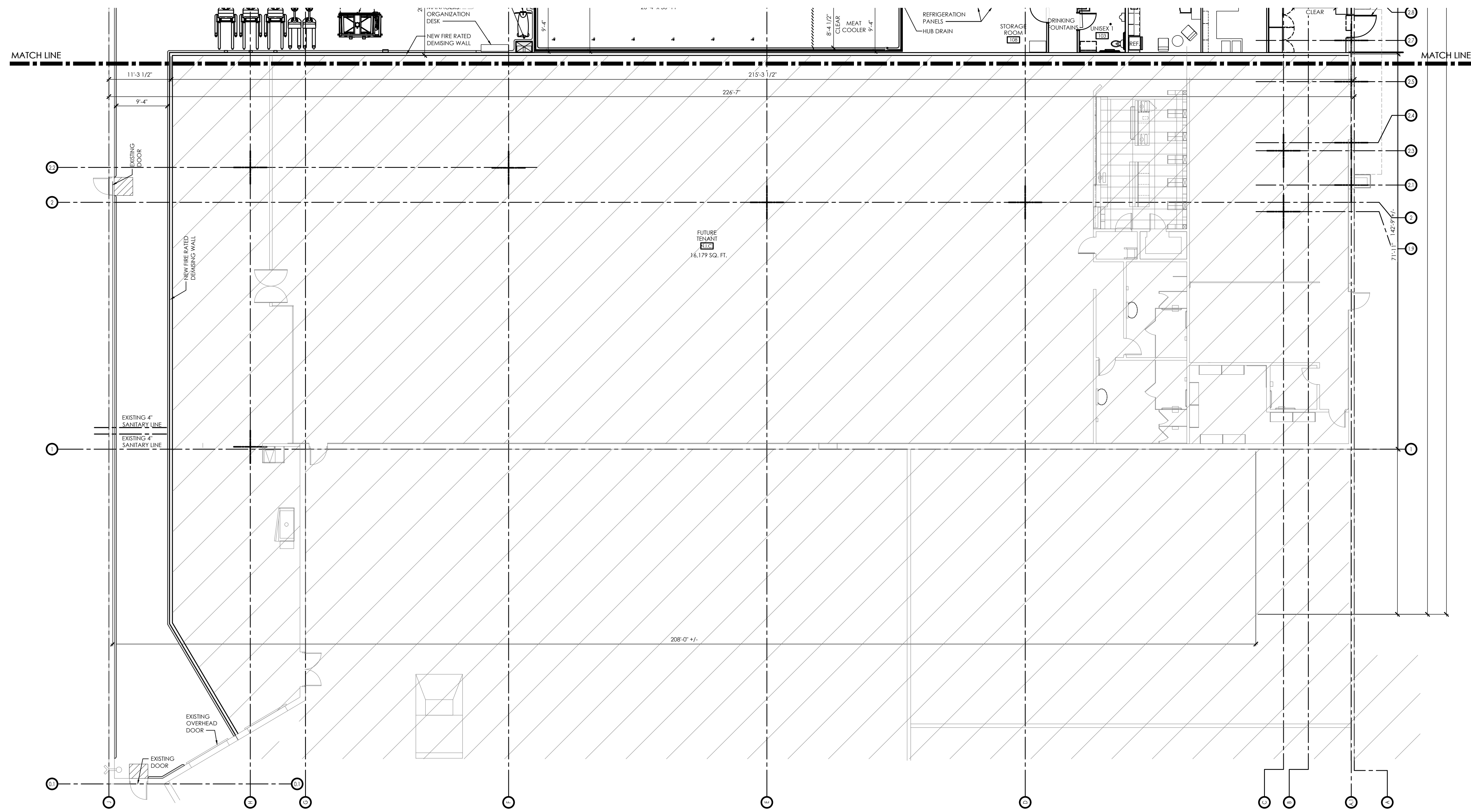

Issued:	Date:
A OWNER SET	04-29-2024
B PERMIT SET	05-30-2024
C	
D	
E	

Revisions:	Date:
1	
2	
3	
4	
5	
6	
7	
8	
9	
10	
11	
12	

PROJECT ARCHITECT/ENGINEER	DATE
MARCUS J. BOYLE	05-30-2024
PROJECT LEAD	DATE
JUSTIN MAY	05-30-2024

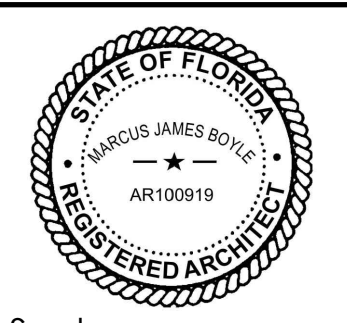

Seal Seal

ALDI Inc.
 1171 North State Road 7
 Royal Palm Beach, FL 33411
 (561) 640-8000

ALDI Inc. Store #:0213
 Westlake, FL
 5060 Seminole Pratt Whitney Rd
 Westlake, FL 33470
 West Palm Beach County
 Project Name & Location:

Operations Plan	
Drawing Name:	
Prototype:	Project No.
v9.1	20240003
Type:	
RETROFIT	
Drawn By:	
TD/MS	A-131.1
Scale:	Drawing No.
As Noted	