



Christ Fellowship CHURCH

MSP-2022-04 Master Sign Plan Amendment

SIGN PACKAGE

City of Westlake

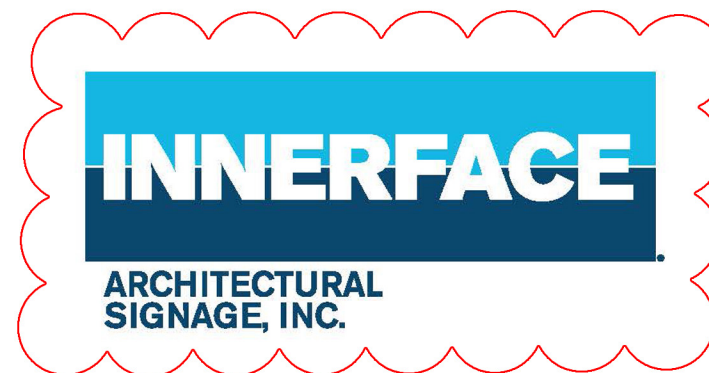

AMENDMENT DATE:
JANUARY 19, 2023

MAP LEGEND

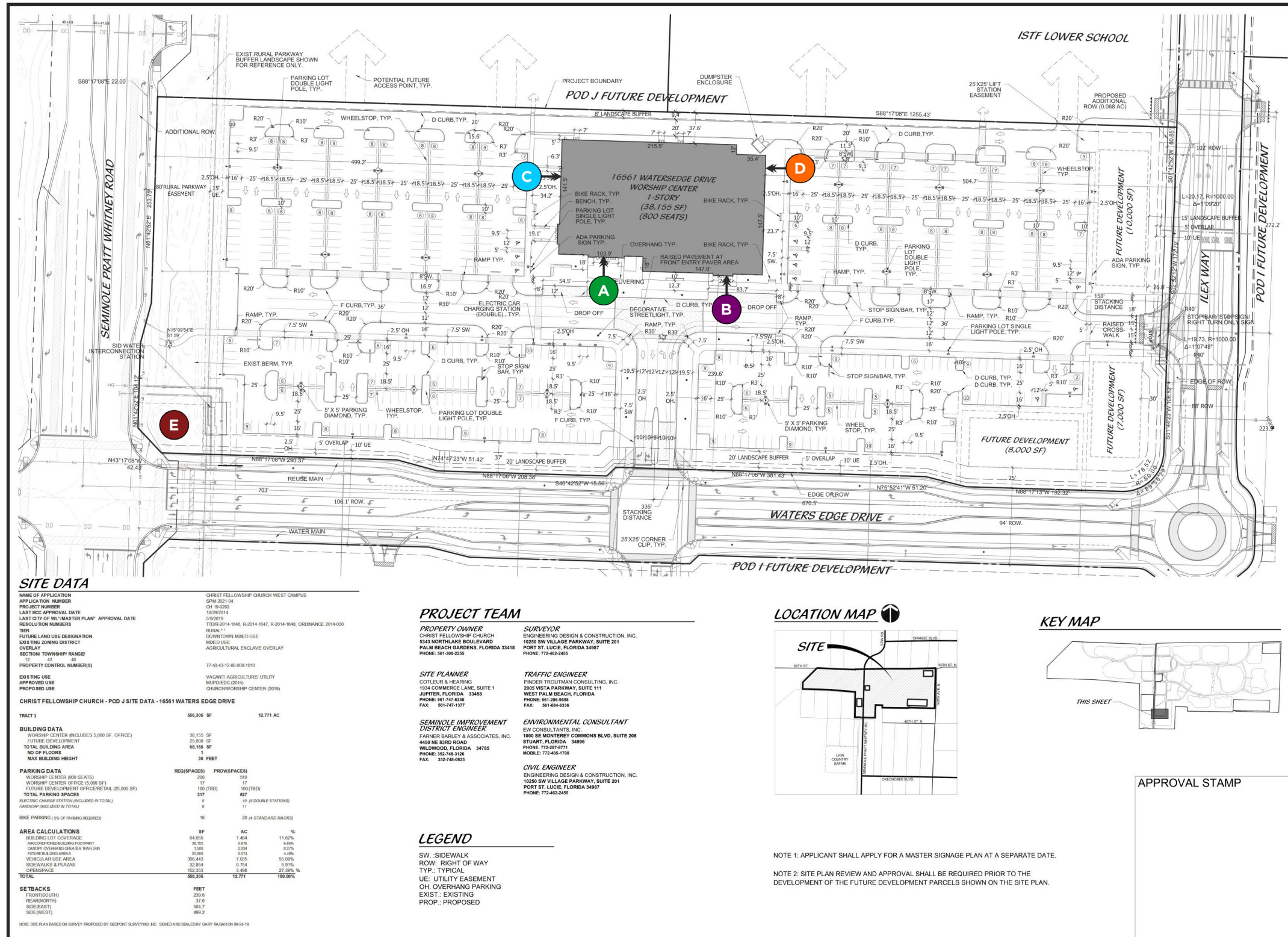

SITE DATA

NAME OF APPLICATION	CHRIST FELLOWSHIP CHURCH WEST CAMPUS
APPLICATION NUMBER	SPR 2021-04
PROJECT NUMBER	OH 19-0002
LAST BCC APPROVAL DATE	10/29/2014
LAST CITY OF W/L MASTER PLAN APPROVAL DATE	5/9/2019
RESOLUTION NUMBER	1708-2014-0546, R-2014-0547, R-2014-0548, ORDINANCE 2014-030
TIER	RURAL-1
FUTURE LAND USE DESIGNATION	COMMERCIAL MEDIUM DENSITY
EXISTING ZONING DISTRICT	MIXED USE
OVERLAY	AGRICULTURAL ENCLAVE OVERLAY
SECTION / TOWNSHIP / RANGE	12 / 43
PROPERTY CONTROL NUMBER(S)	77-40-43-12-000-1010
EXISTING USE	VACANT AGRICULTURE UTILITY
APPROVED USE	MUP/EDC (2014)
PROPOSED USE	CHURCH WORSHIP CENTER (2019)

CHRIST FELLOWSHIP CHURCH - POD J SITE DATA - 16561 WATER EDGE DRIVE

TRACT 1	956,306 SF	12.771 AC
---------	------------	-----------

BUILDING DATA

WORSHIP CENTER (INCLUDES 5,000 SF OFFICE)	38,155 SF
FUTURE DEVELOPMENT	25,000 SF
TOTAL BUILDING AREA	63,155 SF
NO OF FLOORS	1
MAX BUILDING HEIGHT	30 FEET

PARKING DATA

WORSHIP CENTER (800 SEATS)	700	REQ(SPACES)	700	PROV(SPACES)	500
WORSHIP CENTER OFFICE (5,000 SF)	17		17		17
FUTURE DEVELOPMENT OFFICE/RETAIL (25,000 SF)	100	(TICK)	100	(TICK)	100
TOTAL PARKING SPACES	817		817		817
ELECTRIC CHARGE STATION (INCLUDED IN TOTAL)	8		8		8
BIKE PARKING (5% OF PARKING SPACES)	41		41		41

AREA CALCULATIONS

SP	AC	%
BUILDING LOT COVERAGE	4.864	11.62%
ARC COVERED BUILDING FOOTPRINT	0.816	6.8%
CANOPY COVERED PARKING TRANSFER	1.866	0.2%
FUTURE BUILDING AREA	25,000	6.0%
VEHICULAR USE AREA	305,443	35.0%
SIDEWALKS & PLAZAS	32,854	5.91%
GREENSPACE	192,353	22.25%
TOTAL	956,306	100.00%

SETBACKS

FRONT(SOUTH)	239.6
REAR(NORTH)	37.6
SIDE(EAST)	504.7
SIDE(WEST)	499.2

PROJECT TEAM

PROPERTY OWNER CHRIST FELLOWSHIP CHURCH 5343 NORTHLAKE BOULEVARD PALM BEACH GARDENS, FLORIDA 33418 PHONE: 561-366-2255	SURVEYOR ENGINEERING DESIGN & CONSTRUCTION, INC. 16250 SW VILLAGE PARKWAY, SUITE 201 PORT ST. LUCIE, FLORIDA 34987 PHONE: 772-462-2455
SITE PLANNER COTLEUR & HEARING 1934 COMMERCE LANE, SUITE 1 JUPITER, FLORIDA 33458 PHONE: 561-747-6336 FAX: 561-747-1377	TRAFFIC ENGINEER PINDER TROUTMAN CONSULTING, INC. 2888 VISTA PARKWAY, SUITE 111 WEST PALM BEACH, FLORIDA PHONE: 561-296-8688 FAX: 561-664-6338
SEMINOLE IMPROVEMENT DISTRICT ENGINEER FARMER BASKLEY & ASSOCIATES, INC. 4450 NE 83RD ROAD WILDLAND, FLORIDA 34785 PHONE: 352-748-3126 FAX: 352-748-0823	CIVIL ENGINEER ENGINEERING DESIGN & CONSTRUCTION, INC. 16250 SW VILLAGE PARKWAY, SUITE 201 PORT ST. LUCIE, FLORIDA 34987 PHONE: 772-462-2455

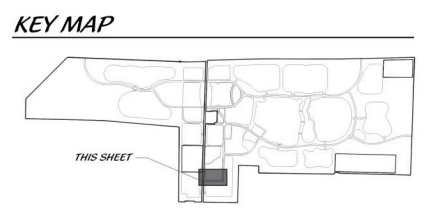

NOTE 1: APPLICANT SHALL APPLY FOR A MASTER SIGNAGE PLAN AT A SEPARATE DATE.
NOTE 2: SITE PLAN REVIEW AND APPROVAL SHALL BE REQUIRED PRIOR TO THE DEVELOPMENT OF THE FUTURE DEVELOPMENT PARCELS SHOWN ON THE SITE PLAN.

APPROVAL STAMP

Cotleur & Hearing
Landscape Architects
Land Planners
Environmental Consultants
1934 Commerce Lane
Suite 1
Jupiter, Florida 33458
561.747.6336 · Fax 747.1377
www.cotleurhearing.com
Lic# LC-C000239

MINTO WESTLAKE
Christ Fellowship-Pod J
SITE PLAN
City of Westlake, Florida

- A** CHANNEL LETTERS
- B** PUSH THRU CABINET
- C** CHANNEL LETTERS
- D** CHANNEL LETTERS
- E** MONUMENT
- F** WAYFINDING

SHEET 01 - WAYFINDING SITE LOCATIONS
SHEET 02 - SIGN TYPE D
SHEET 03 - SIGN TYPE P

DESIGNED	DEH
DRAWN	MCR
APPROVED	DEH
JOB NUMBER	19-0202
DATE	08-24-19
REVISIONS	10-18-19
	11-08-19
	11-21-19
	04-02-21
	05-18-21

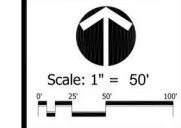

May 18, 2021 11:55:57 a.m.
Drawing: 190202 BASE.DWG

SHEET 1 of 1



ART SIGN CO INC
835 NW 6TH AVE.
FT. LAUDERDALE, FL 33311
954.763.4410 | artsignfl.com

FILE: ChristFellowship_Exterior Signage_SM_V18
ADDRESS:
MUNICIPALITY: City of Westlake

SITE LOCATION PLAN

CLIENT APPROVAL:
START DATE: 08/05/2021 **SALE REP:** Tina **ARTIST:** Alisha
AMENDMENT DATE: 01/19/2023

Colors shown on drawing are for presentation purposes. All colors must be confirmed initialed by project manager before painting. Any party accepting this document does so in confidence and agrees that it should not be duplicated, in whole or in part, nor disclose to others without the written consent of Art Sign Company, Inc. Reference copy list for copy/graphic specific to each sign location. Contractor shall verify all conditions on site and notify any variation from what is shown on the drawings before proceeding with fabrication.

FRONT-LIT CHANNEL LETTERS

NO CHANGE

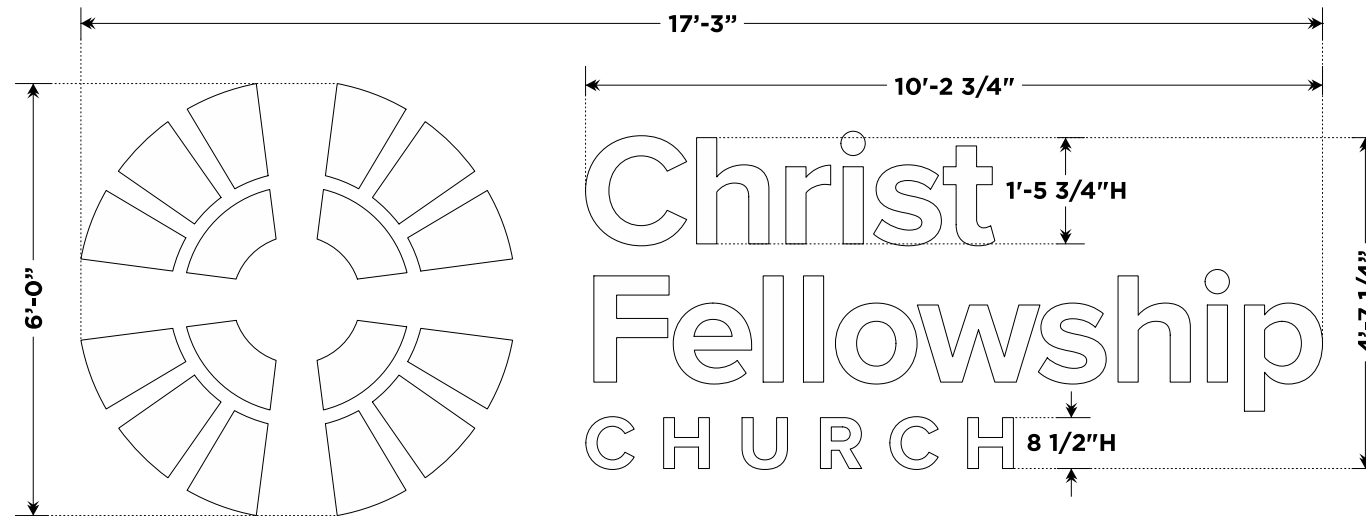

A2 MEASUREMENTS & SPECS
Scale: 3/8"= 1'

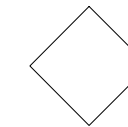

- Faces:** White
- Returns:** White
- Letter Style:** Avenir Heavy
- Allowed Sq. Ft:** 90 per elevation
- Proposed Sq. Ft:** 106.88



A1 SOUTH ELEVATION
Scale: 1/8"= 1'

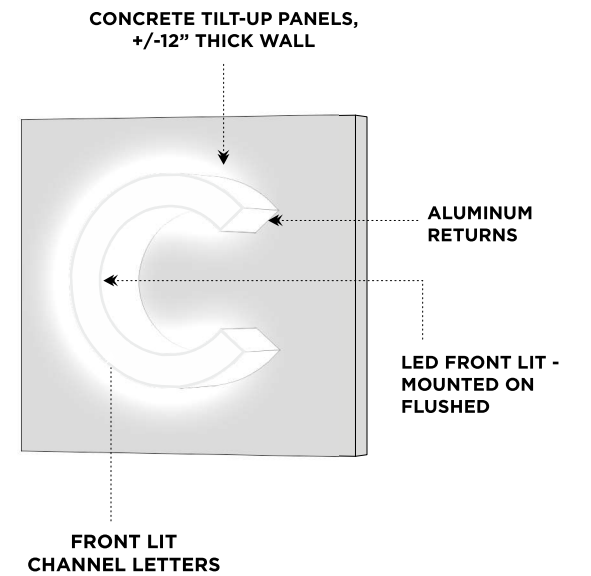

PUSH THRU CABINET

push thru aluminum cabinet faced w/ vinyl

NO CHANGE



B2 MEASUREMENTS & SPECS
Scale: 1/2" = 1'

- Faces:** Teal
- Copy:** White / Blue
- Returns:** To match face
- Letter Style:** Logo
- Allowed Sq. Ft:** 90 per elevation
- Proposed Sq. Ft:** 29



B1 SOUTH ELEVATION
Scale: 1/8" = 1'

ART SIGN CO INC
835 NW 6TH AVE.
FT. LAUDERDALE, FL 33311
954.763.4410 | artsignfl.com

FILE: ChristFellowship_Exterior Signage_SM_V18
ADDRESS:
MUNICIPALITY: City of Westlake

CLIENT APPROVAL:
START DATE: 08/05/2021 **SALE REP:** Tina **ARTIST:** Alisha

Colors shown on drawing are for presentation purposes. All colors must be confirmed initialed by project manager before painting. Any party accepting this document does so in confidence and agrees that it should not be duplicated, in whole or in part, nor disclose to others without the written consent of Art Sign Company, Inc. Reference copy list for copy/graphic specific to each sign location. Contractor shall verify all conditions on site and notify any variation from what is shown on the drawings before proceeding with fabrication.

FRONT-LIT CHANNEL LETTERS

NO CHANGE

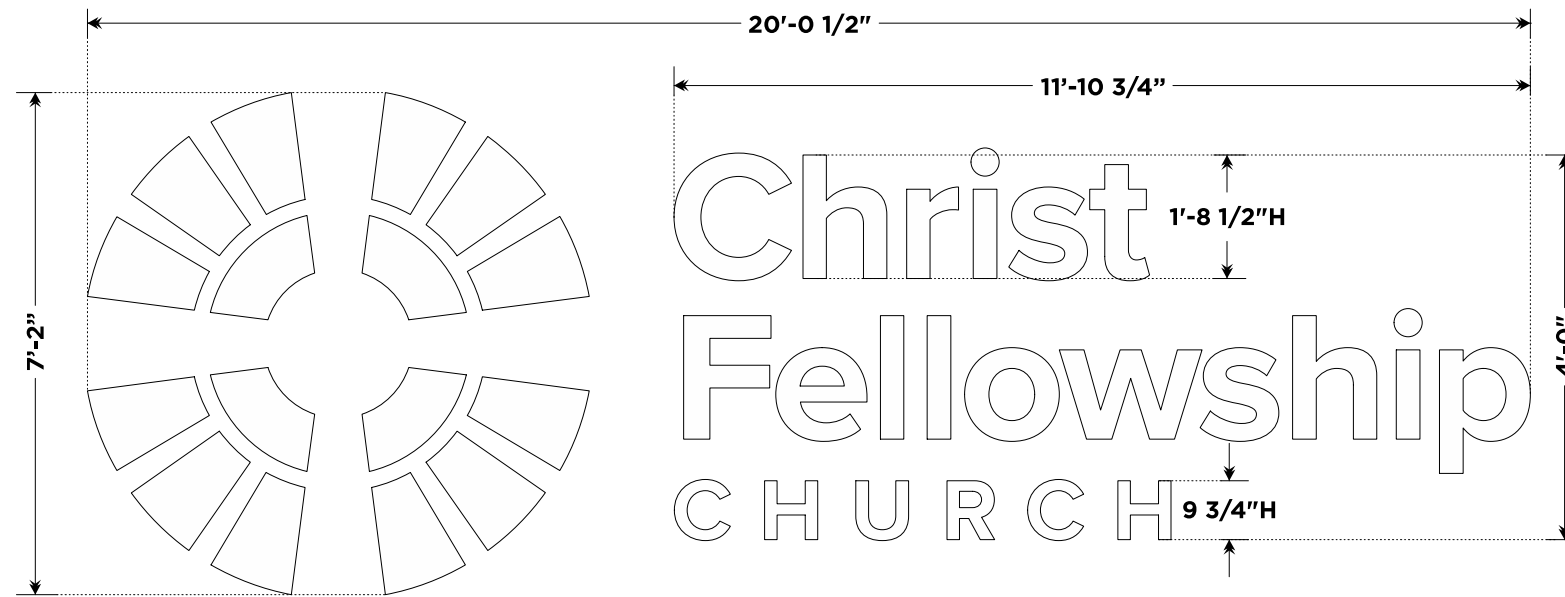

C2 MEASUREMENTS & SPECS
Scale: 3/8"= 1'

- Faces:** White
- Returns:** White
- Letter Style:** Avenir Heavy
- Allowed Sq. Ft:** 90 per elevation
- Proposed Sq. Ft:** 144.37

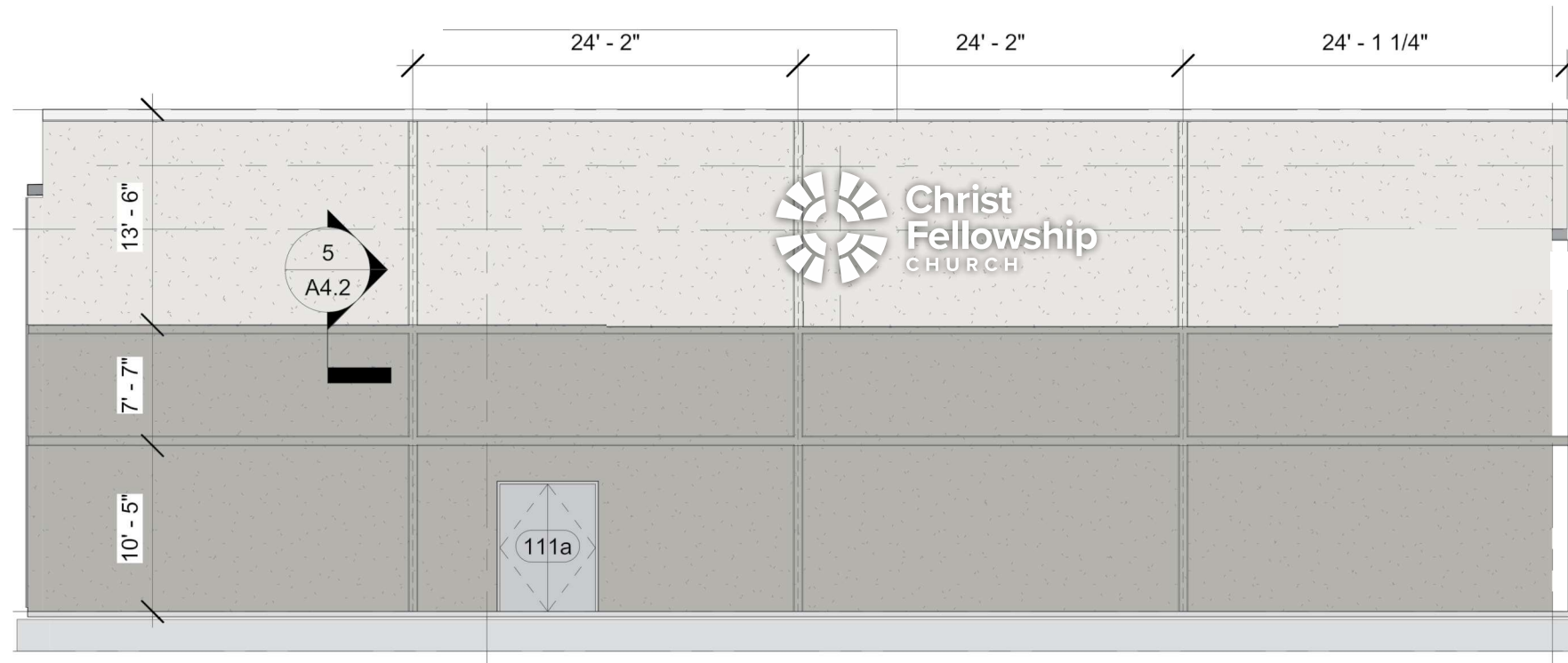

C1 WEST ELEVATION
Scale: 3/32"= 1'

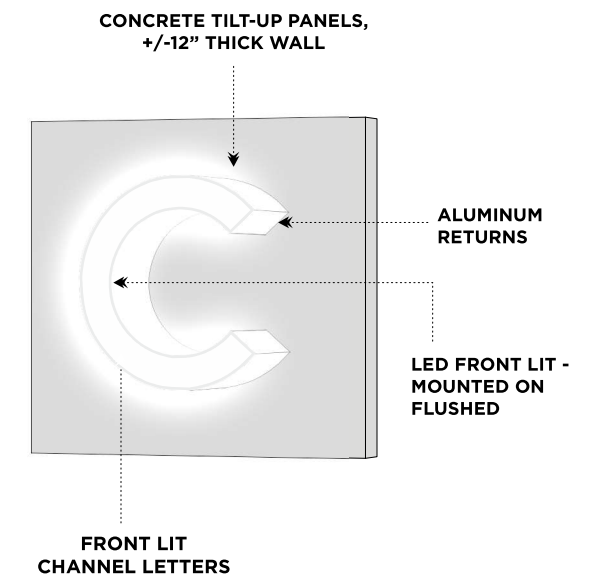

FRONT-LIT CHANNEL LETTERS

NO CHANGE

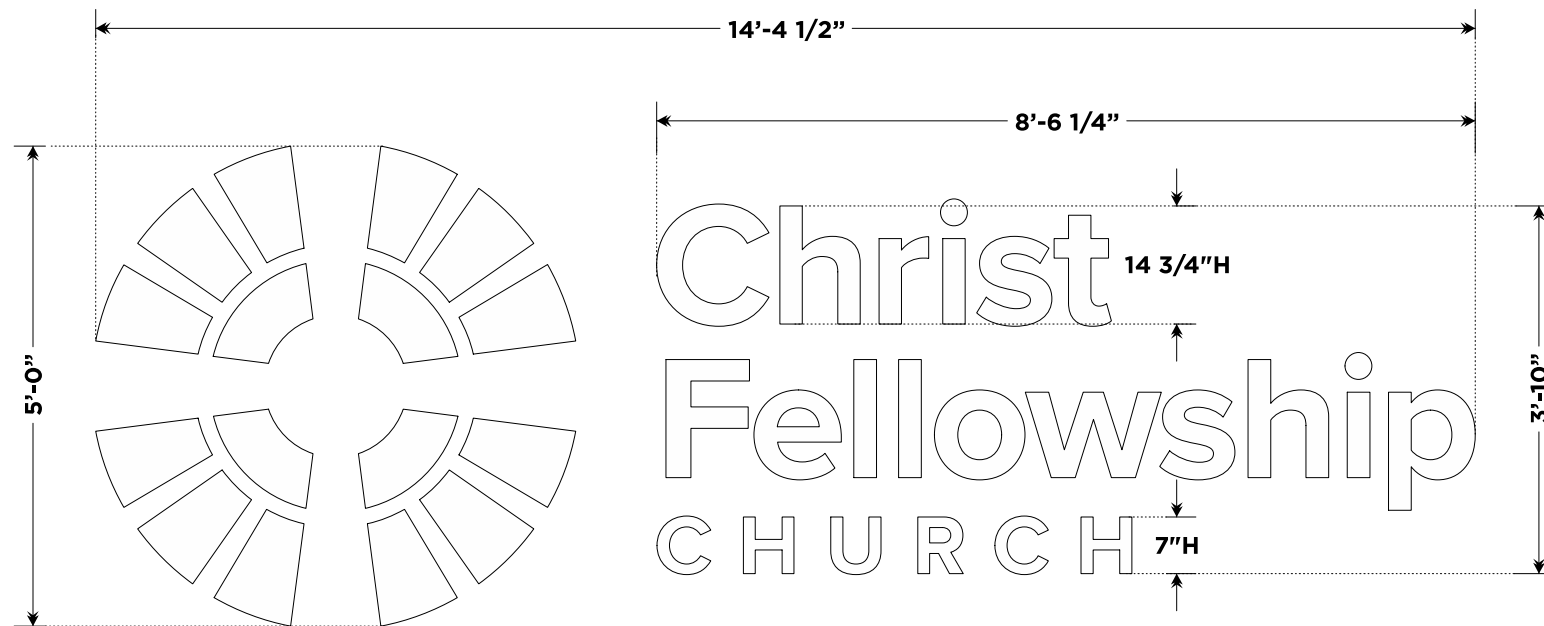

D2 MEASUREMENTS & SPECS
Scale: 3/8" = 1'

- Faces:** White
- Returns:** White
- Letter Style:** Avenir Heavy
- Allowed Sq. Ft:** 90 per elevation
- Proposed Sq. Ft:** 71.875

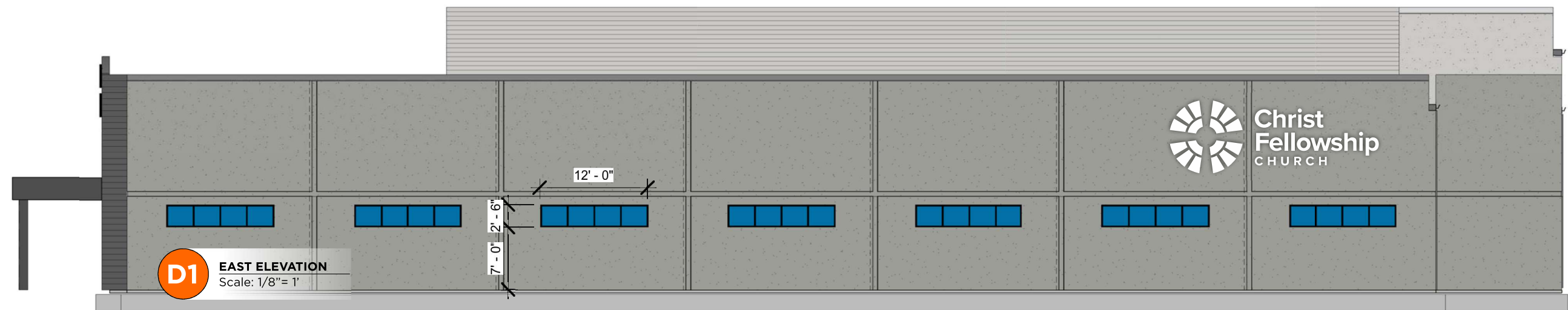
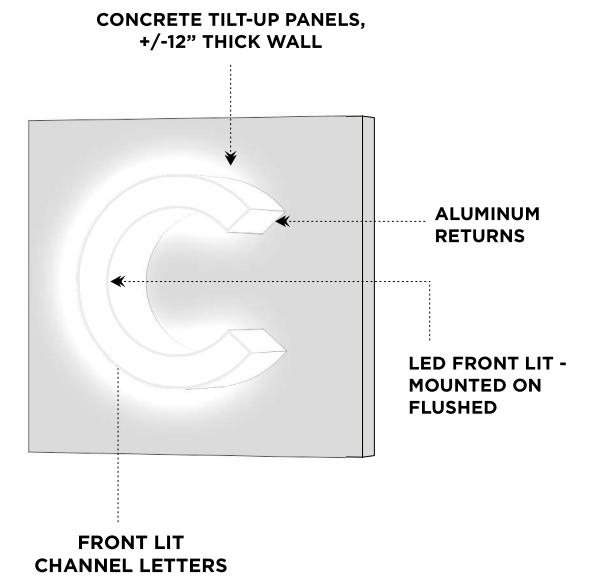

D1 EAST ELEVATION
Scale: 1/8" = 1'

FILE: ChristFellowship_Exterior Signage_SM_V18
ADDRESS:
MUNICIPALITY: City of Westlake

CLIENT APPROVAL:
START DATE: 08/05/2021 **SALE REP:** Tina **ARTIST:** Alisha

INTERNALLY-ILLUMINATED SINGLE SIDED MONUMENT SIGN W/ REVERSE CHANNEL LETTERS

NO CHANGE

E1 MONUMENT
Scale: 1/8" = 1'

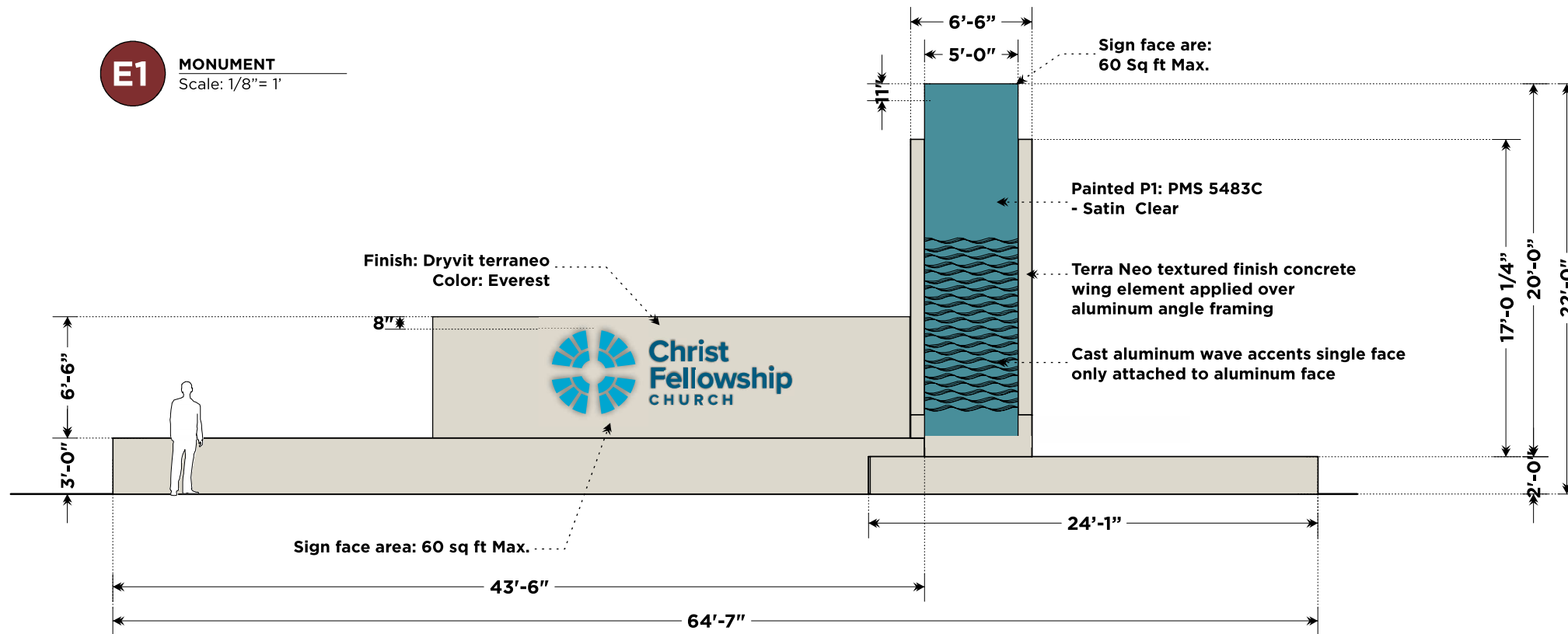

E2 MEASUREMENTS & SPECS
Scale: 1/8" = 1'



- Main cabinet color:** Dryvit Terraneo Everest
- Header color:** Grey PMS 3005
- Pole cover:** PMS 5483
- Embellishments:** Dryvit Terraneo
- Allowed Sq. Sign Area Ft.:** 60
- Proposed Sq. Sign Area Ft:** 59.56



E3 COPY MEASUREMENTS
Scale: 1/4" = 1'

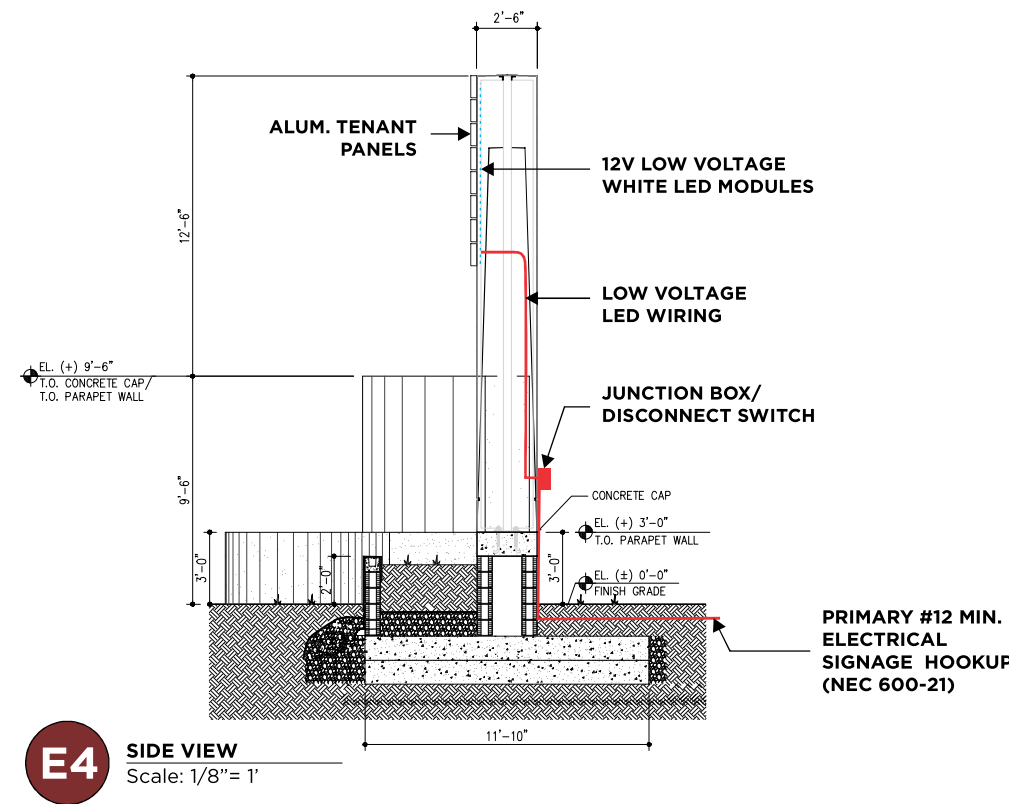

E4 SIDE VIEW
Scale: 1/8" = 1'

Broward & North Freestanding

- Design, fabrication and construction to the following codes and specifications:
 - The Florida Building Code (2020) 7th edition
 - American Welding Society AWS D1.1-04 & D1.2
 - American Concrete Institute building code requirements for structural concrete ACI 318-11
- Structural Steel requirements:
 - Plates, rolled shapes and bars shall be ASTM A36, or equal
 - Standard pipe shall be ASTM A53, Grade B or equal (Fy=35 KSI)
 - Structural tubing shall be ASTM A500, Grade B or equal (Fy=46 KSI)
 - All bolted connections shall be made with ASTM A307 bolt or equal
 - All anchors bolts shall be ASTM A307 or equal (flat washers at nut)
 - All welds shall be made with E70XX electrodes or equal
 - Structural steel shall be shop prime coated with a rust inhibitive primer
- All field welds shall comply with AWS code by a AWS certified welder
- NEC 2017 compliant.
- All concrete shall have a minimum compressive strength at 28 days/ 3000 PSI
- Grout shall be non-metallic and non-shrink with a minimum comprehensive strength of 5000 PSI at one day
- All reinforced steel shall have a minimum yield strength of 60,000 PSI and shall conform to ASTM A615
All reinforcement steel shall be installed in accordance with ACI 318-11 with a minimum concrete cover of 3 inches
- H.V.H.Z., section 1620 F.B.C., ASCE 7-16 170 MPH, exposure C, Category 2, Chapter 16.
- All ferrous to non ferrous surfaces shall be separated by 3M #355 polyester clear tape or equal

Exterior Wayfinding

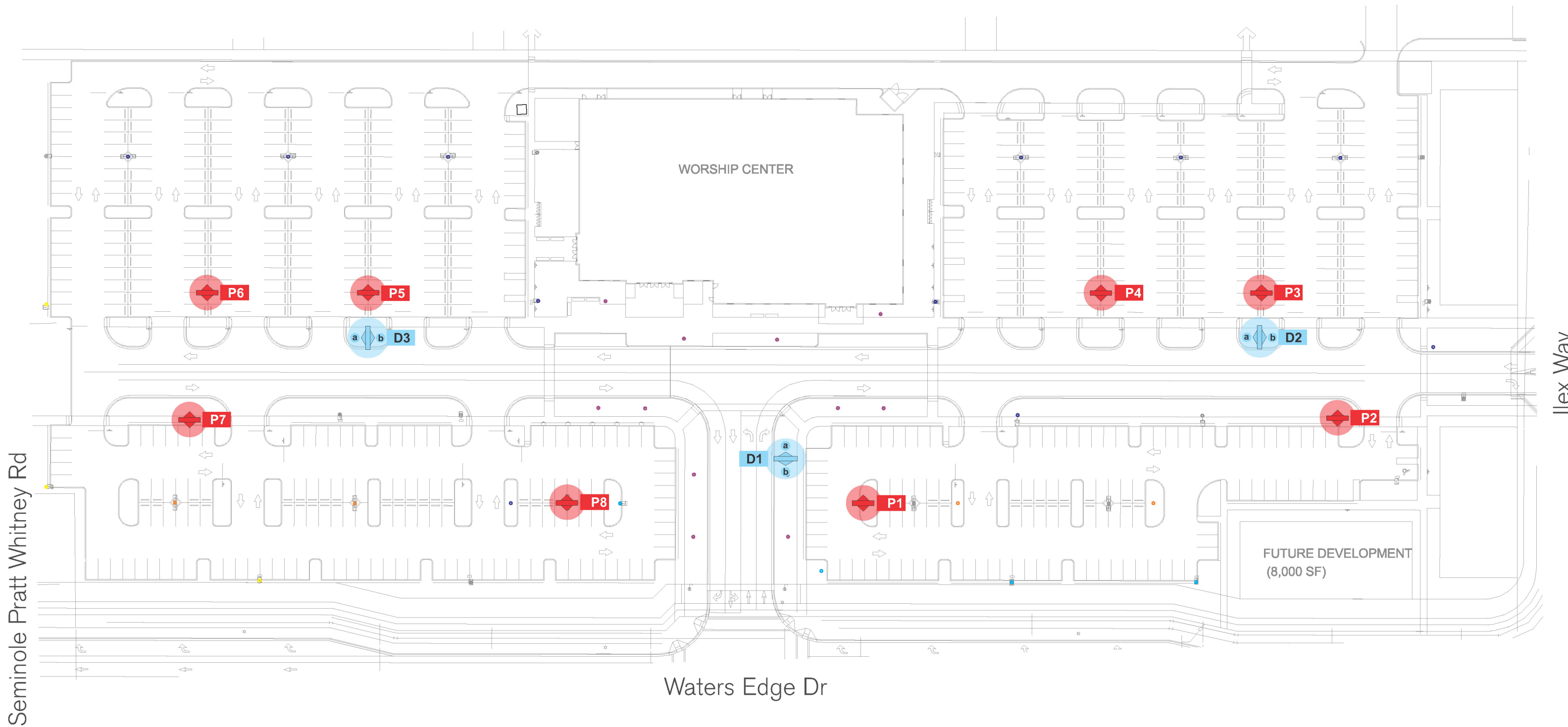
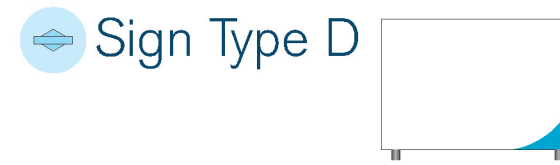

Seminole Pratt Whitney Rd

Illex Way

Waters Edge Dr



INNERFACE
ARCHITECTURAL
SIGNAGE, INC.

5849 Peachtree Road | Atlanta, GA 30349
1.800-445-4796 | innerfacesign.com

06.28.22 - rev. 0, ema
07.27.22 - rev. 1, ema
08.05.22 - rev. 2, ema
09.27.22 - rev. 3, ema
12.09.22 - rev. 4, ema
12.15.22 - rev. 5, ema
12.27.22 - rev. 6, ema
01.16.23 - rev. 7, ema

This drawing and the ideas expressed remain the confidential property of INNERFACE. This drawing and its ideas are not to be reproduced, copied or disclosed to any other person or entity without the express written consent of a representative of INNERFACE. All dimensions shown are approximate. Actual dimensions could vary due to the practical limitations of fabrication. Colors shown are for illustrative purposes only. Actual colors are to be determined by client specification.

Westlake Interior / Exterior Signage
Christ Fellowship Church
Designer: Edith Aponte
File Name: cfc westlake - exterior

Exterior Sign Type - D

$$\frac{40'' \times 56''}{144} = 15.55 \text{ sq.ft.}$$

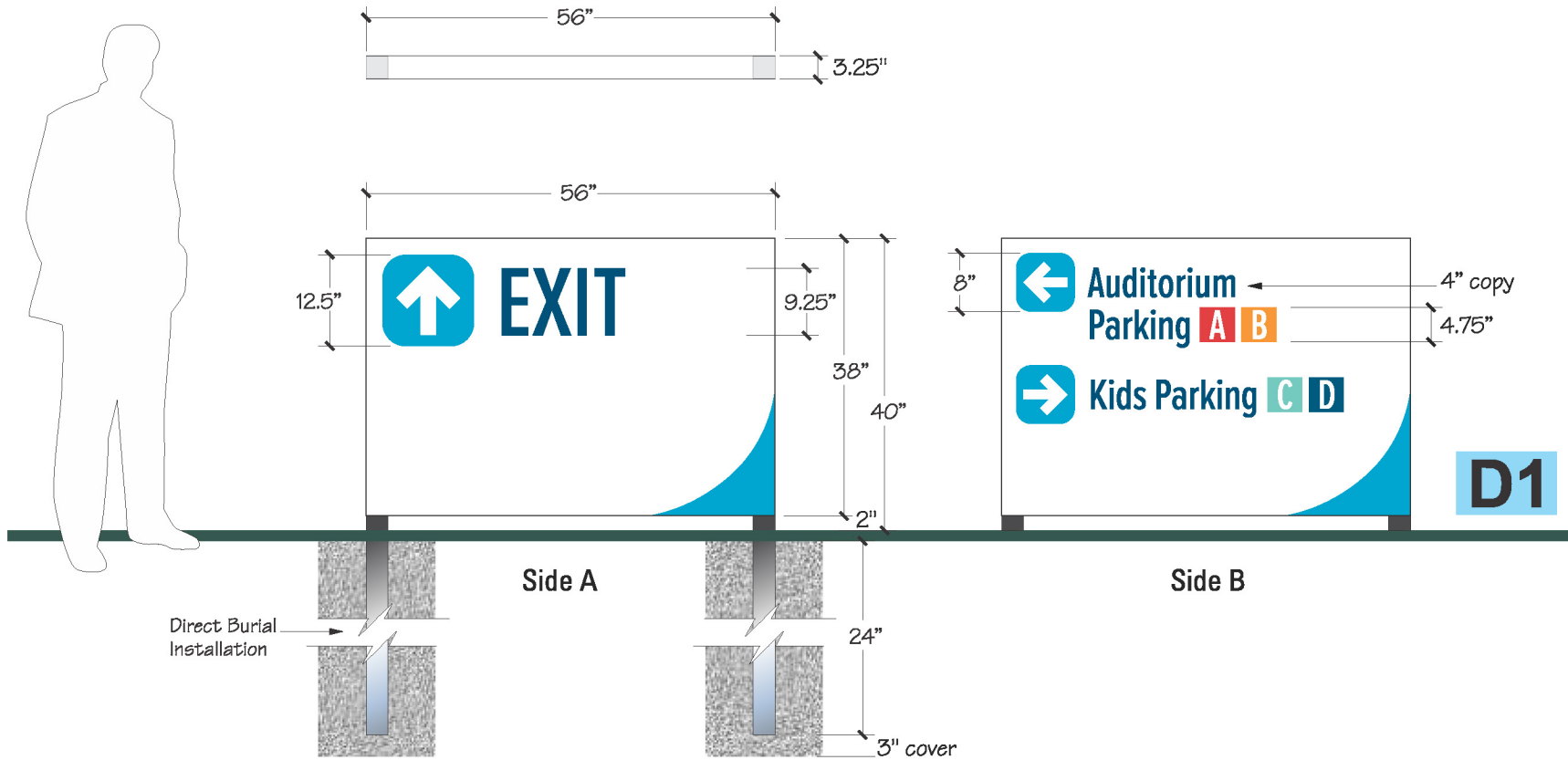

- DOUBLE SIDE SKIN & FRAME - POST & PANEL - Non Illuminated
- 38"h. x 56"w. x 3 1/4" deep double face custom skin & frame
 - Dual 3" square posts, 40" grade to top of sign, extended 24" for direct burial installation into dirt
 - Cabinet will be painted two(2) colors: MAP Natural White & Light Blue (TBD)
 - Posts painted MAP Black
 - Arrows, Letters & Parking Lots color code will be digitally printed HP vinyl applied



	Project #: R22412	<input checked="" type="checkbox"/> Contour Cut
	Date In: -	Need by: -
	Substrate: White HP vinyl	<input checked="" type="checkbox"/> Surface Print
	Color: -	<input type="checkbox"/> Flat bed
Loc.: -	Qty. -	<input type="checkbox"/> Reverse Print
		<input type="checkbox"/> Laminated

X _____ Date: _____



INNERFACE
ARCHITECTURAL SIGNAGE, INC.
5849 Peachtree Road | Atlanta, GA 30349
1.800-445-4796 | innerfacesign.com

MAP 11477 Natural White
Pantone 313C
Pantone 3025C
Pantone 313C
Pantone 711C
Pantone 570C
Pantone 1495C
Font: Proxima Nova ExCn Medium

Project: R22412
Drawn By: TB

Location: D1, D2, D3
Qty: 03
Scale: 3/4" = 1'-0"

06.28.22 - rev. 0, ema
07.27.22 - rev. 1, ema
08.05.22 - rev. 2, ema
09.27.22 - rev. 3, ema
12.09.22 - rev. 4, ema
12.15.22 - rev. 5, ema
12.27.22 - rev. 6, ema
01.16.23 - rev. 7, ema

This drawing and the ideas expressed remain the confidential property of INNERFACE. This drawing and its ideas are not to be reproduced, copied or disclosed to any other person or entity without the express written consent of a representative of INNERFACE. All dimensions shown are approximate. Actual dimensions could vary due to the practical limitations of fabrication. Colors shown are for illustrative purposes only. Actual colors are to be determined by client specification.

Westlake Interior / Exterior Signage
Christ Fellowship Church
Designer: Edith Aponte
File Name: cfc westlake - exterior

Exterior Sign Type - P

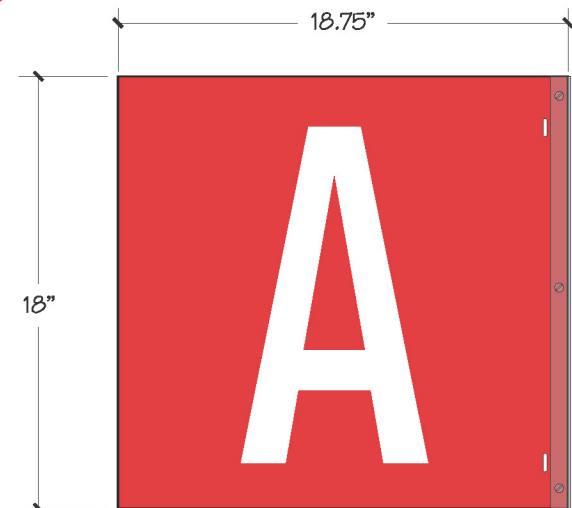
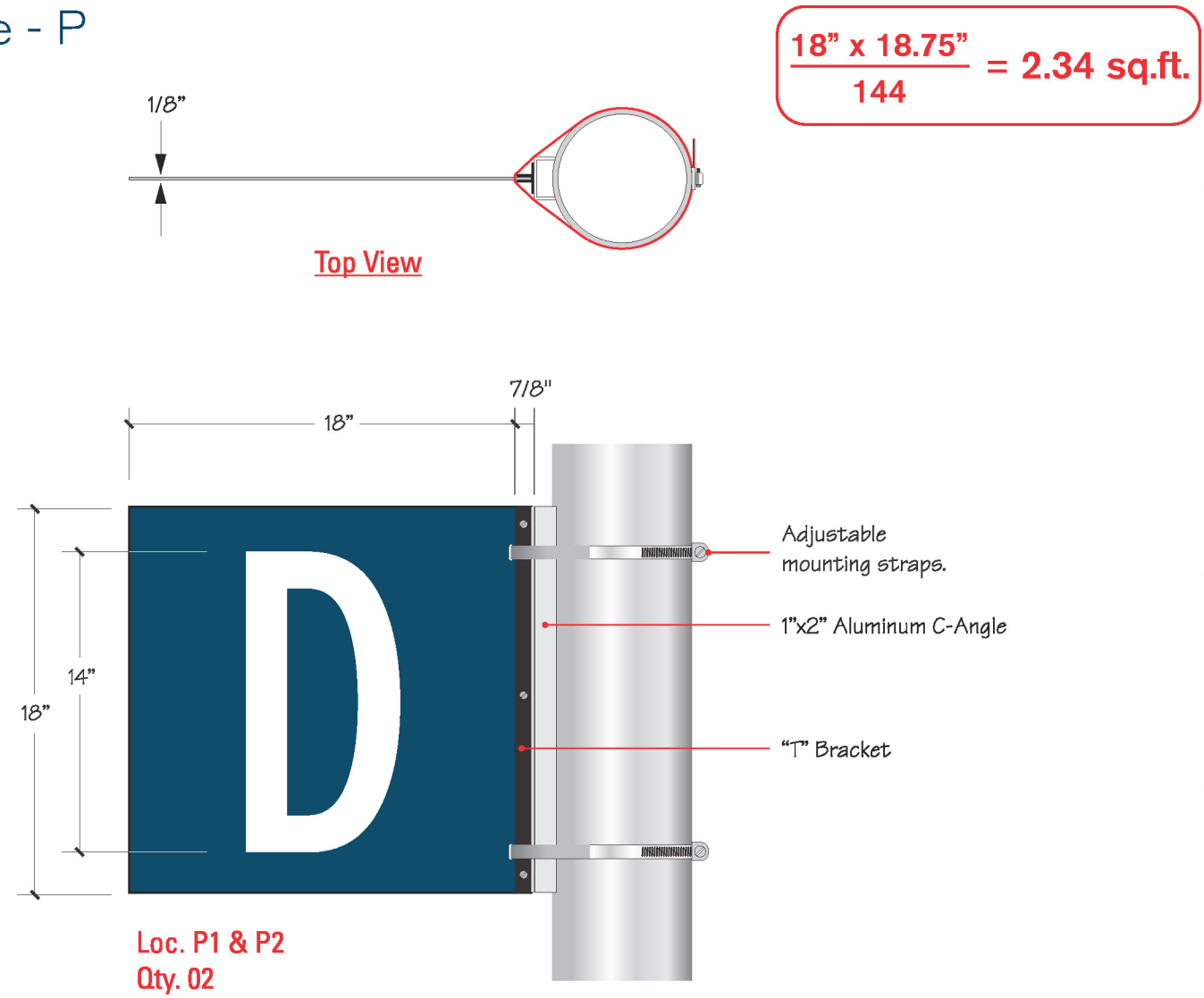

Loc. P7 & P8
Qty. 02

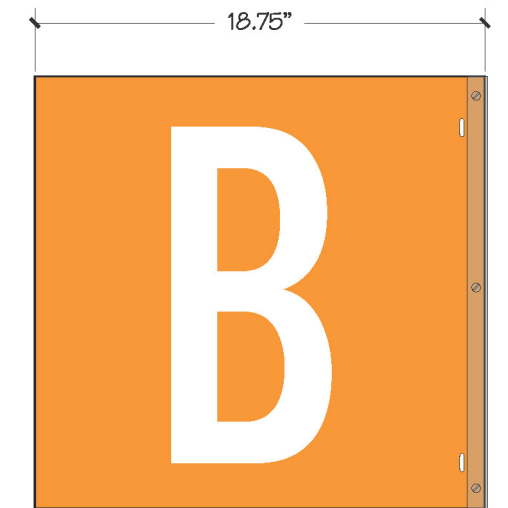

Loc. P5 & P6
Qty. 02

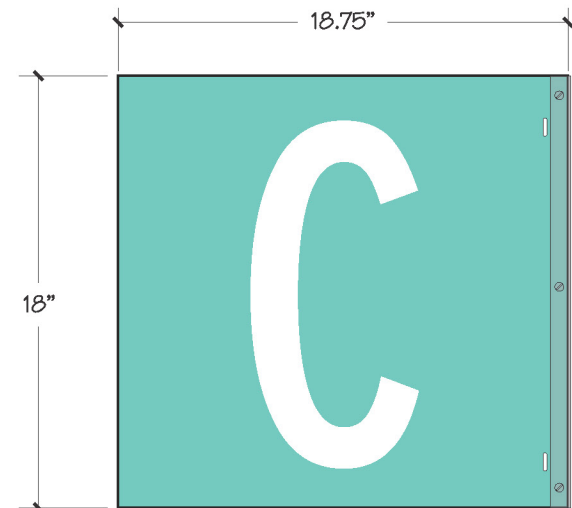

Loc. P3 & P4
Qty. 02

FLAT ALUMINUM PANEL - D/F - LIGHT POLE MOUNTED
 - 18"h. x 18"w. x 1/8" thick flat aluminum panel with bracket and mounting straps to be mounted to existing light pole.
 - Panels be painted with parking color code: PMS 3025C Blue, PMS 711C Red, PMS 1495C Orange & PMS 570C
 - Letters to be White Reflective vinyl applied

X _____ Date: _____

