

Google Maps

Warning if Yellow Route is too long

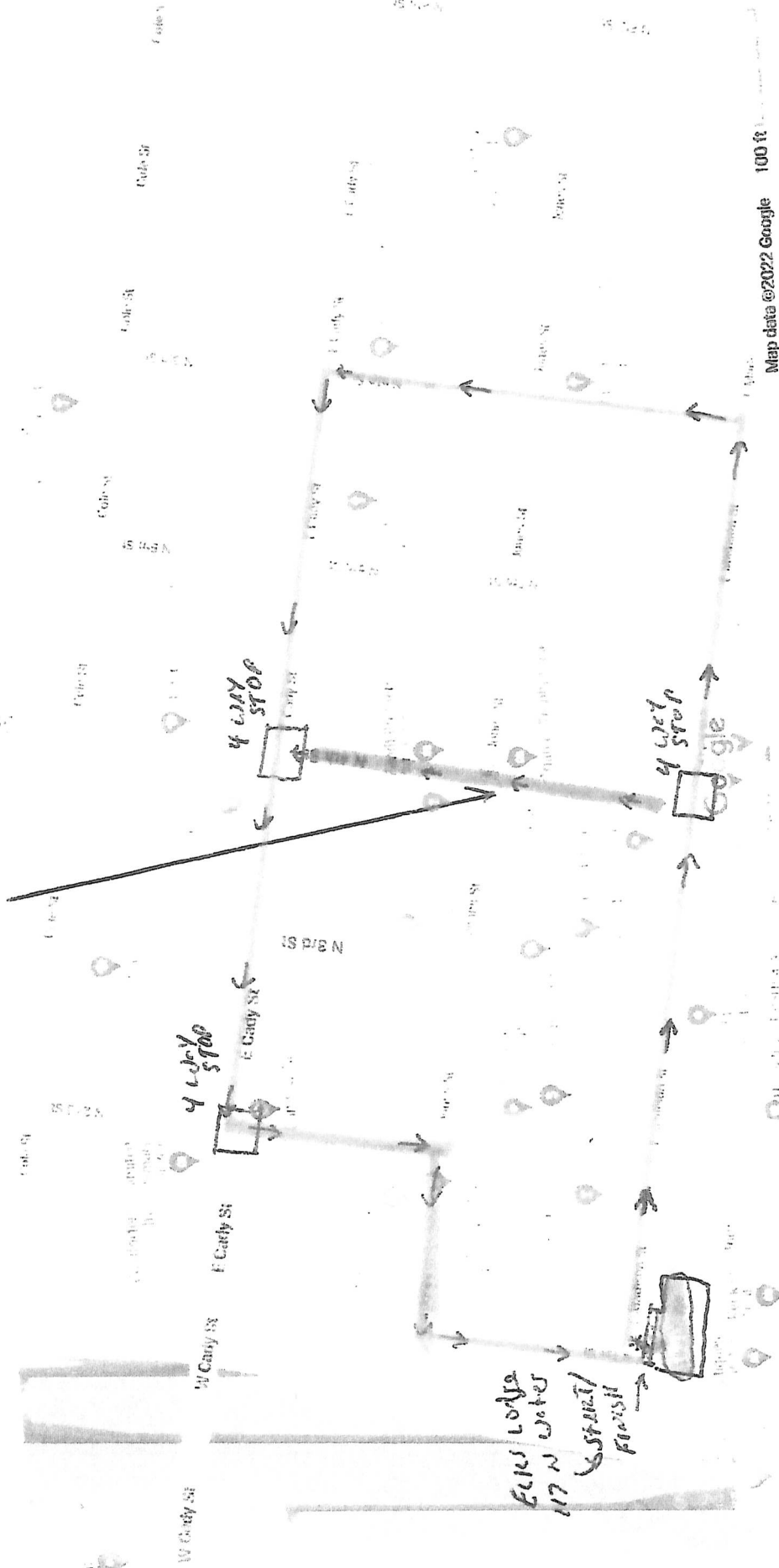

{ 4 way stop sign intersection  
for safety  
[plan for Yellow Route]

**Path of Horse drawn vehicle;**

- Start on curb by Elks building on Madison Street
- Pull out and head East on Madison St
- Utilizing 4 way stop sign on 4<sup>th</sup> St continue on Madison St to N 6<sup>th</sup> St
- Make a left and head North on N 6<sup>th</sup> Street
- Continue on N 6th Street to Cady St
- Make a left onto Cady St and proceed West to 4 way Stop sign on 4<sup>th</sup> St
- Continue forward to 4 way stop sign on N 2<sup>nd</sup> St
- Make a left onto N 2<sup>nd</sup> St and continue South to Jones St by the Police Station
- Make a right onto Jones St and proceed West to N 1<sup>st</sup> St
- Make a left onto N 1<sup>st</sup> St and continue South to Madison St intersection
- Make a left onto Madison St and pull over onto curb for unloading and loading for next trip

**Note; This is the path we used last year, however if the police recommend a shorter or different path please just draw it on the map and we will make the necessary changes.**

**Thank you,**

---