

**EXHIBIT A**  
**ELEONORE BLACKWELL**  
**TPN 12702222500**

**PARCEL:**

THE WEST 165 FEET OF THAT PART OF THE NORTHWEST QUARTER OF THE NORTHWEST QUARTER OF SECTION 2, TOWNSHIP 17 NORTH, RANGE 2 WEST, W.M. LYING NORTH OF EAST W STREET AND SOUTH OF A LINE RUNNING NORTH 89°01'30" EAST FROM A POINT ON THE WEST LINE OF SAID SECTION 2, 1650.10 FEET NORTH OF ITS WEST QUARTER CORNER; EXCEPTING THEREFROM THE WEST 36 FEET FOR CAPITOL BOULEVARD;

IN THURSTON COUNTY, WASHINGTON.

**RIGHT OF WAY DEDICATION DESCRIPTION:**

BEGINNING AT THE SOUTHWEST CORNER OF THE ABOVE DESCRIBED PARCEL, SAID POINT BEING AT THE INTERSECTION OF THE EAST RIGHT-OF-WAY MARGIN OF CAPITOL BLVD AND THE NORTH RIGHT-OF-WAY MARGIN OF EAST W STREET; THENCE NORTHERLY ALONG SAID EAST MARGIN, NORTH 02°11'41" EAST, 37.93 FEET; THENCE SOUTH 12°12'10" EAST, 22.22 FEET; THENCE SOUTH 44°15'57" EAST, 10.87 FEET; THENCE SOUTH 67°35'09" EAST, 22.65 FEET TO THE NORTH RIGHT-OF-WAY MARGIN OF SAID EAST W STREET; THENCE WESTERLY ALONG SAID NORTH MARGIN, NORTH 89°36'59" WEST, 34.67 FEET TO THE POINT OF BEGINNING;

CONTAINING 338 SQUARE FEET, MORE OR LESS;

SITUATE IN THE COUNTY OF THURSTON, STATE OF WASHINGTON.

**TEMPORARY CONSTRUCTION EASEMENT DESCRIPTION:**

COMMENCING AT THE SOUTHWEST CORNER OF THE ABOVE DESCRIBED PARCEL, SAID POINT BEING AT THE INTERSECTION OF THE EAST RIGHT-OF-WAY MARGIN OF CAPITOL BLVD AND THE NORTH RIGHT-OF-WAY MARGIN OF EAST W STREET; THENCE NORTHERLY ALONG SAID EAST MARGIN, NORTH 02°11'41" EAST, 37.93 FEET TO THE TRUE POINT OF BEGINNING; THENCE SOUTH 12°12'10" EAST, 22.22 FEET; THENCE SOUTH 44°15'57" EAST, 10.87 FEET; THENCE SOUTH 67°35'09" EAST, 22.65 FEET TO THE NORTH RIGHT-OF-WAY MARGIN OF SAID EAST W STREET; THENCE LEAVING SAID NORTH LINE, NORTH 00°26'28" EAST, 10.58 FEET; THENCE NORTH 73°35'25" WEST, 21.46 FEET; THENCE NORTH 07°14'18" WEST, 21.57 FEET; THENCE NORTH 02°11'57" EAST, 49.75 FEET; THENCE SOUTH 88°46'49" EAST, 5.65 FEET; THENCE NORTH 00°29'52" EAST, 10.00 FEET TO THE NORTH LINE OF THE ABOVE DESCRIBED PARCEL; THENCE WESTERLY ALONG SAID NORTH LINE, NORTH 88°46'49" WEST, 15.36 FEET TO THE EAST RIGHT-OF-WAY MARGIN OF CAPITOL BLVD; THENCE SOUTHERLY ALONG SAID EAST MARGIN, SOUTH 02°11'41" WEST, 59.86 FEET TO THE POINT OF BEGINNING;

CONTAINING 1,075 SQUARE FEET, MORE OR LESS;

SITUATE IN THE COUNTY OF THURSTON, STATE OF WASHINGTON.

PREPARED BY: PAUL E. BOUGHAL JR., PLS  
MTN2COAST, LLC  
10/22/2025



**EXHIBIT A**  
**CAPITOL CITY PROPERTIES LLC**  
**TPN 56600000100**

**PARCEL:**

PARCEL A OF BOUNDARY LINE ADJUSTMENT NO. BLA 7250, AS RECORDED JUNE 8, 1992 UNDER RECORDING NO. 9206080272;

IN THURSTON COUNTY, WASHINGTON.

**RIGHT OF WAY DEDICATION DESCRIPTION:**

THAT PORTION OF THE ABOVE DESCRIBED PARCEL LYING NORTH AND WEST OF THE FOLLOWING DESCRIBED LINE:

COMMENCING AT THE CENTERLINE INTERSECTION OF CAPITOL BOULEVARD AND EAST X STREET, SAID POINT ALSO BEING THE SOUTHWEST CORNER OF THE NORTHWEST QUARTER OF THE NORTHWEST QUARTER OF SECTION 2, TOWNSHIP 17 NORTH, RANGE 2 WEST, W.M.;  
THENCE NORTHERLY ALONG THE CENTERLINE OF CAPITOL BOULEVARD AND THE WEST LINE OF SAID NORTHWEST QUARTER, NORTH 02°11'41" EAST, 96.75 FEET;  
THENCE SOUTH 87°48'19" EAST, 36.00 FEET TO THE SOUTHWEST CORNER OF THE ABOVE DESCRIBED PARCEL AND THE POINT OF BEGINNING;  
THENCE EASTERLY ALONG THE SOUTH LINE OF THE ABOVE DESCRIBED PARCEL, SOUTH 89°32'15" EAST, 12.55 FEET;  
THENCE NORTH 15°06'44" WEST, 9.92 FEET;  
THENCE NORTH 01°54'38" EAST, 93.59 FEET;  
THENCE NORTH 67°23'47" EAST, 25.57 FEET TO THE NORTH LINE OF THE ABOVE DESCRIBED PARCEL AND THE TERMINUS OF THIS LINE DESCRIPTION;

CONTAINING 1,189 SQUARE FEET, MORE OR LESS.

SITUATE IN THE COUNTY OF THURSTON, STATE OF WASHINGTON.

**TEMPORARY CONSTRUCTION EASEMENT DESCRIPTION:**

THAT PORTION OF THE ABOVE DESCRIBED PARCEL DESCRIBED AS FOLLOWS:

COMMENCING AT THE CENTERLINE INTERSECTION OF CAPITOL BOULEVARD AND EAST X STREET, SAID POINT ALSO BEING THE SOUTHWEST CORNER OF THE NORTHWEST QUARTER OF THE NORTHWEST QUARTER OF SECTION 2, TOWNSHIP 17 NORTH, RANGE 2 WEST, W.M.;  
THENCE NORTHERLY ALONG THE CENTERLINE OF CAPITOL BOULEVARD AND THE WEST LINE OF SAID NORTHWEST QUARTER, NORTH 02°11'41" EAST, 96.75 FEET;  
THENCE SOUTH 87°48'19" EAST, 36.00 FEET TO THE SOUTHWEST CORNER OF THE ABOVE DESCRIBED PARCEL;  
THENCE EASTERLY ALONG THE SOUTH LINE OF THE ABOVE DESCRIBED PARCEL, SOUTH 89°32'15" EAST, 12.55 FEET;

THENCE NORTH 15°06'44" WEST, 2.90 FEET AND THE POINT OF BEGINNING;  
THENCE CONTINUING NORTH 15°06'44" WEST, 7.02 FEET;  
THENCE NORTH 01°54'38" EAST, 93.59 FEET;  
THENCE NORTH 67°23'47" EAST, 25.57 FEET TO THE NORTH LINE OF THE ABOVE DESCRIBED  
PARCEL;  
THENCE LEAVING SAID NORTH LINE, SOUTH 01°23'44" EAST, 10.73 FEET;  
THENCE SOUTH 67°25'10" WEST, 21.29 FEET;  
THENCE SOUTH 04°41'58" WEST, 51.66 FEET;  
THENCE SOUTH 01°49'45" WEST, 39.78 FEET TO THE POINT OF BEGINNING;

CONTAINING 497 SQUARE FEET, MORE OR LESS.

SITUATE IN THE COUNTY OF THURSTON, STATE OF WASHINGTON.

PREPARED BY: PAUL E. BOUGHAL JR., PLS  
MTN2COAST, LLC  
10/22/2025

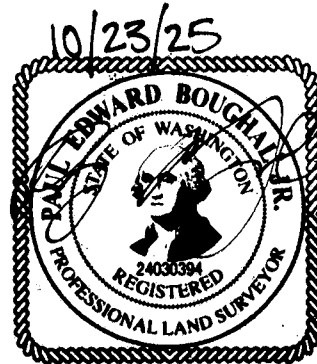

**EXHIBIT A**  
**NUT TREE, LLC**  
**TPN 12703140500**

**PARCEL:**

THE NORTH 270 FEET OF THE EAST 180 FEET OF THE SOUTHEAST QUARTER OF THE NORTHEAST QUARTER OF SECTION 3, TOWNSHIP 17 NORTH, RANGE 2 WEST, W.M.;

EXCEPTING THE NORTH 30 FEET FOR WEST X STREET AND THE EAST 30 FEET FOR CAPITOL BOULEVARD;

ALSO EXCEPTING THOSE PORTIONS CONVEYED TO THE CITY OF TUMWATER BY DEEDS RECORDED UNDER AUDITOR'S FILE NO. 1101265 AND 9510250095;

IN THURSTON COUNTY, WASHINGTON.

**RIGHT OF WAY DESCRIPTION:**

COMMENCING AT THE NORTHWEST CORNER OF THE ABOVE DESCRIBED PARCEL, SAID POINT BEING ON THE SOUTHERLY RIGHT-OF-WAY MARGIN OF WEST X STREET; THENCE EASTERLY ALONG SAID SOUTHERLY MARGIN, SOUTH 87°38'57" EAST, 70.56 FEET TO THE TRUE POINT OF BEGINNING; THENCE SOUTH 83°19'42" EAST, 13.38 FEET TO THE BEGINNING OF A CURVE TO THE RIGHT WHOSE RADIUS BEARS SOUTH 006°40'18" WEST, 33.50 FEET; THENCE ALONG SAID CURVE THROUGH A CENTRAL ANGLE OF 46°35'24", AN ARC DISTANCE OF 27.24 FEET; THENCE SOUTH 36°44'19" EAST, 22.77 FEET; THENCE SOUTH 09°46'46" EAST, 17.12 FEET; THENCE SOUTH 02°17'05" WEST, 90.79 FEET; THENCE SOUTH 87°48'19" EAST, 11.03 FEET; THENCE SOUTH 04°38'42" EAST, 10.93 FEET; THENCE SOUTH 01°47'42" WEST, 90.69 FEET TO THE SOUTH LINE OF THE ABOVE DESCRIBED PARCEL; THENCE EASTERLY ALONG SAID SOUTH LINE, SOUTH 87°38'57" EAST, 5.97 FEET TO THE WESTERLY RIGHT-OF-WAY MARGIN OF CAPITOL BLVD AS DEDICATED IN DEED RECORDED UNDER AFN 9510250095; THENCE NORTHERLY ALONG SAID MARGIN, NORTH 02°11'41" EAST, 216.08 FEET; THENCE NORTH 42°48'59" WEST, 33.93 FEET TO THE SOUTHERLY RIGHT-OF-WAY MARGIN OF WEST X STREET; THENCE WESTERLY ALONG SAID SOUTHERLY MARGIN, NORTH 87°38'57" WEST, 49.44 FEET TO THE POINT OF BEGINNING;

CONTAINING 3,554 SQUARE FEET, MORE OR LESS;

SITUATE IN THE COUNTY OF THURSTON, STATE OF WASHINGTON.

**TEMPORARY CONSTRUCTION EASEMENT DESCRIPTION:**

BEGINNING AT THE NORTHWEST CORNER OF THE ABOVE DESCRIBED PARCEL, SAID POINT BEING ON THE SOUTHERLY RIGHT-OF-WAY MARGIN OF WEST X STREET; THENCE EASTERLY ALONG SAID SOUTHERLY MARGIN, SOUTH 87°38'57" EAST, 70.56 FEET; THENCE SOUTH 83°19'42" EAST, 13.38 FEET TO THE BEGINNING OF A CURVE TO THE RIGHT WHOSE RADIUS BEARS SOUTH 006°40'18" WEST, 33.50 FEET; THENCE ALONG SAID CURVE THROUGH A CENTRAL ANGLE OF 46°35'24", AN ARC DISTANCE OF 27.24 FEET; THENCE SOUTH 36°44'19" EAST, 22.77 FEET; THENCE SOUTH 09°46'46" EAST, 17.12 FEET; THENCE SOUTH 02°17'05" WEST, 90.79 FEET; THENCE SOUTH 87°48'19" EAST, 11.03 FEET; THENCE SOUTH 04°38'42" EAST, 10.93 FEET; THENCE SOUTH 01°47'42" WEST, 90.69 FEET TO THE SOUTH LINE OF THE ABOVE DESCRIBED PARCEL; THENCE WESTERLY ALONG SAID SOUTH LINE, NORTH 87°38'57" WEST, 18.22 FEET; THENCE NORTH 02°17'49" EAST, 208.38 FEET; THENCE NORTH 87°42'51" WEST, 64.38 FEET; THENCE NORTH 02°35'15" EAST, 21.69 FEET; THENCE NORTH 87°38'57" WEST, 55.95 FEET TO THE WEST LINE OF THE ABOVE DESCRIBED PARCEL; THENCE NORTHERLY ALONG SAID WEST LINE, NORTH 2°11'41" EAST, 10.00 FEET, TO THE POINT OF BEGINNING;

CONTAINING 4,511 SQUARE FEET, MORE OR LESS;

SITUATE IN THE COUNTY OF THURSTON, STATE OF WASHINGTON.

PREPARED BY: PAUL E. BOUGHAL JR., PLS  
MTN2COAST, LLC  
10/22/2025

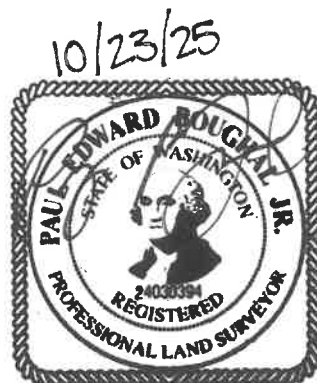

**EXHIBIT A**  
**RDK INVESTMENTS, LLC**  
**TPN 551000000100**

**PARCEL:**

LOT 1 OF HOLM'S ADDITION TO TUMWATER, AS RECORDED IN VOLUME 11 OF PLATS, PAGE 86;  
  
IN THURSTON COUNTY, WASHINGTON.

**RIGHT OF WAY DEDICATION DESCRIPTION:**

BEGINNING AT THE SOUTHEAST CORNER OF THE ABOVE DESCRIBED PARCEL, SAID POINT BEING ON THE WESTERLY RIGHT-OF-WAY MARGIN OF CAPITOL BLVD S; THENCE WESTERLY ALONG THE SOUTH LINE OF SAID LOT 1, NORTH 87°38'57" WEST, 11.50 FEET; THENCE NORTH 02°43'31" EAST, 82.74 FEET; THENCE NORTH 56°32'00" WEST, 4.66 FEET; THENCE NORTH 56°32'00" WEST, 5.12 FEET; THENCE NORTH 02°43'42" EAST, 20.00 FEET; THENCE NORTH 61°17'17" EAST, 9.59 FEET; THENCE NORTH 02°07'17" EAST, 99.95 FEET TO THE NORTH LINE OF SAID LOT 1; THENCE EASTERLY ALONG SAID NORTH LINE, SOUTH 87°32'49" EAST, 10.81 FEET TO THE NORTHEAST CORNER OF SAID LOT 1, SAID POINT ALSO BEING ON THE WESTERLY RIGHT-OF-WAY MARGIN OF CAPITOL BLVD S; THENCE SOUTHERLY ALONG SAID WESTERLY MARGIN, SOUTH 02°11'41" WEST, 212.67 FEET TO THE POINT OF BEGINNING;

CONTAINING 2,523 SQUARE FEET, MORE OR LESS;

SITUATE IN THE COUNTY OF THURSTON, STATE OF WASHINGTON.

**TEMPORARY CONSTRUCTION EASEMENT DESCRIPTION:**

COMMENCING AT THE SOUTHEAST CORNER OF THE ABOVE DESCRIBED PARCEL, SAID POINT BEING ON THE WESTERLY RIGHT-OF-WAY MARGIN OF CAPITOL BLVD S; THENCE WESTERLY ALONG THE SOUTH LINE OF SAID LOT 1, NORTH 87°38'57" WEST, 11.50 FEET TO THE TRUE POINT OF BEGINNING; THENCE CONTINUING NORTH 87°38'57" WEST, 5.00 FEET; THENCE NORTH 02°11'41" EAST, 73.26 FEET; THENCE NORTH 10°44'43" EAST, 12.02 FEET; THENCE SOUTH 56°32'00" EAST, 4.66 FEET; THENCE SOUTH 02°43'31" WEST, 82.74 FEET TO THE POINT OF BEGINNING;

CONTAINING 445 SQUARE FEET, MORE OR LESS;

SITUTATE IN THE COUNTY OF THURSTON, STATE OF WASHINGTON.

PREPARED BY:     PAUL E. BOUGHAL JR., PLS  
                         MTN2COAST, LLC  
                         10/22/2025

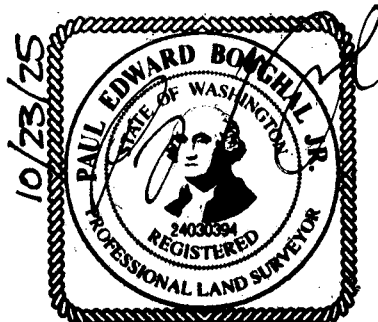

**EXHIBIT A**  
**SCHWAB PROPERTIES LTD**  
**TPN 72850300100**

**PARCEL:**

PARCEL A OF CITY OF TUMWATER BOUNDARY LINE ADJUSTMENT NO. BLA 98-7382 TW RECORDED JANUARY 21, 1999 UNDER RECORDING NO. 3205999 AND 3206000;

IN THURSTON COUNTY, WASHINGTON.

**RIGHT OF WAY DESCRIPTION:**

BEGINNING AT THE NORTHEAST CORNER OF THE ABOVE DESCRIBED PARCEL, SAID POINT BEING ON THE SOUTHERLY RIGHT-OF-WAY MARGIN OF X STREET; THENCE WESTERLY ALONG THE NORTH LINE OF THE ABOVE DESCRIBED PARCEL, NORTH 89°16'04" WEST, 194.81 FEET TO THE BEGINNING OF A CURVE TO THE LEFT WHOSE RADIUS BEARS, SOUTH 00°43'56" WEST, 30.00 FEET; THENCE ALONG SAID CURVE THROUGH A CENTRAL ANGLE OF 10°04'28", AN ARC DISTANCE OF 5.27 FEET; THENCE SOUTH 46°57'53" WEST, 33.28 FEET TO THE BEGINNING OF A NON-TANGENT CURVE TO THE LEFT WHOSE RADIUS BEARS, SOUTH 76°43'41" EAST, 30.00 FEET; THENCE ALONG SAID CURVE THROUGH A CENTRAL ANGLE OF 11°04'37", AN ARC DISTANCE OF 5.80 FEET; THENCE SOUTH 02°11'41" WEST, 167.34 FEET TO THE SOUTHWEST CORNER OF THE ABOVE DESCRIBED PARCEL; THENCE NORTH 16°52'32" EAST, 29.56 FEET; THENCE NORTH 2°11'41" EAST, 109.01 FEET; THENCE NORTH 24°37'37" EAST, 13.50 FEET; THENCE SOUTH 87°47'42" EAST, 10.06 FEET; THENCE NORTH 35°57'34" EAST, 45.52 FEET; THENCE NORTH 57°14'12" EAST, 9.80 FEET; THENCE NORTH 87°03'16" EAST, 22.98 FEET; THENCE SOUTH 89°16'04" EAST, 31.22 FEET; THENCE SOUTH 89°16'04" EAST, 113.89 FEET TO THE EAST LINE OF THE ABOVE DESCRIBED PARCEL; THENCE NORTHERLY ALONG SAID EAST LINE, NORTH 2°11'41" EAST, 3.00 FEET TO THE POINT OF BEGINNING;

CONTAINING 3,115 SQUARE FEET, MORE OR LESS;

SITUATE IN THE COUNTY OF THURSTON, STATE OF WASHINGTON.

**TEMPORARY CONSTRUCTION EASEMENT DESCRIPTION 1:**

COMMENCING AT THE NORTHEAST CORNER OF THE ABOVE DESCRIBED PARCEL, SAID POINT BEING ON THE SOUTHERLY RIGHT-OF-WAY MARGIN OF X STREET; THENCE SOUTHERLY ALONG THE EAST LINE OF THE ABOVE DESCRIBED PARCEL, SOUTH 2°11'41" WEST, 3.00 FEET; THENCE WESTERLY PARALLEL WITH THE NORTH LINE OF THE ABOVE DESCRIBED PARCEL, NORTH 89°16'04" WEST, 113.89 FEET TO THE TRUE POINT OF BEGINNING; THENCE SOUTH 78°03'56" WEST, 12.21 FEET; THENCE SOUTH 88°44'29" WEST, 30.19 FEET; THENCE SOUTH 84°39'30" WEST, 14.94 FEET; THENCE SOUTH 00°48'18" WEST, 24.25 FEET; THENCE SOUTH 46°21'46" WEST, 31.65 FEET; THENCE SOUTH 78°23'26" WEST, 21.17 FEET; THENCE SOUTH 02°04'30" WEST, 36.62 FEET; THENCE SOUTH 02°06'31" WEST, 100.92 FEET TO THE SOUTH LINE OF THE ABOVE DESCRIBED PARCEL; THENCE WESTERLY ALONG SAID SOUTH LINE, NORTH 88°18'20" WEST, 11.55 FEET TO THE SOUTHWEST CORNER OF THE ABOVE DESCRIBED PARCEL; THENCE NORTH 16°52'32" EAST, 29.56 FEET; THENCE NORTH 02°11'41" EAST, 109.01 FEET; THENCE NORTH 24°37'37" EAST, 13.50 FEET; THENCE SOUTH 87°47'42" EAST, 10.06 FEET; THENCE NORTH 35°57'34" EAST, 45.52 FEET; THENCE NORTH 57°14'12" EAST, 9.80 FEET; THENCE NORTH 87°03'16" EAST, 22.98 FEET; THENCE SOUTH 89°16'04" EAST, 31.22 FEET TO THE POINT OF BEGINNING;

CONTAINING 1,646 SQUARE FEET, MORE OR LESS;

SITUATE IN THE COUNTY OF THURSTON, STATE OF WASHINGTON.

**TEMPORARY CONSTRUCTION EASEMENT DESCRIPTION 2:**

COMMENCING AT THE NORTHEAST CORNER OF THE ABOVE DESCRIBED PARCEL, SAID POINT BEING ON THE SOUTHERLY RIGHT-OF-WAY MARGIN OF X STREET; THENCE SOUTHERLY ALONG THE EAST LINE OF THE ABOVE DESCRIBED PARCEL, SOUTH 02°11'41" WEST, 3.00 FEET; THENCE WESTERLY PARALLEL WITH THE NORTH LINE OF THE ABOVE DESCRIBED PARCEL, NORTH 89°16'04" WEST, 117.19 FEET, THENCE SOUTH 00°43'56" WEST 5.00 FEET TO THE TRUE POINT OF BEGINNING; THENCE NORTH 89°59'42" EAST, 44.94 FEET; THENCE SOUTH 00°00'12" EAST, 35.00 FEET; THENCE SOUTH 89°59'42" WEST, 5.00 FEET; THENCE NORTH 00°00'12" WEST, 30.00 FEET; THENCE SOUTH 89°59'42" WEST, 40.00 FEET; THENCE NORTH 00°43'56" EAST, 5.00 FEET TO THE POINT OF BEGINNING;

CONTAINING 375 SQUARE FEET, MORE OR LESS;

SITUATE IN THE COUNTY OF THURSTON, STATE OF WASHINGTON.

PREPARED BY: PAUL E. BOUGHAL JR., PLS  
MTN2COAST, LLC  
10/22/2025

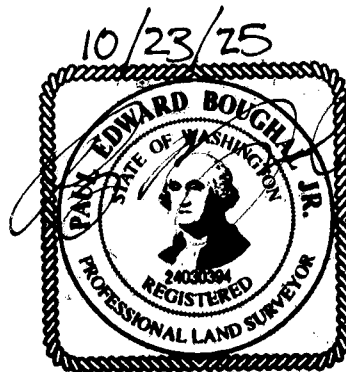

## **EXHIBIT A**

### **STEVEN PROCHNAU REVOCABLE TRUST**

**TPN 12702222800**

**PARCEL:**

THAT PART OF THE NORTHWEST QUARTER OF THE NORTHWEST QUARTER OF SECTION 2, TOWNSHIP 17 NORTH, RANGE 2 WEST, W.M., DESCRIBED AS FOLLOWS:

BEGINNING AT A POINT ON THE WEST LINE OF SAID SECTION 2, NORTH 0°25'45" EAST 1325.38 FEET FROM ITS WEST QUARTER CORNER; RUNNING THENCE SOUTH 89°42' EAST 30 FEET TO THE INTERSECTION OF THE NORTH LINE OF EAST X STREET WITH THE EAST LINE OF CAPITOL BOULEVARD AND THE INITIAL POINT OF THIS DESCRIPTION; THENCE NORTH 0°25'45" EAST ALONG SAID EAST LINE OF CAPITOL BOULEVARD 78 FEET; THENCE NORTH 88°47'45" EAST 125 FEET AND SOUTH 0°25'45" WEST 75 FEET TO SAID NORTH LINE OF EAST X STREET; THENCE SOUTH 88°47'45" WEST ALONG SAID NORTH LINE OF STREET 125 FEET TO SAID INITIAL POINT;

EXCEPTING THEREFROM THE WEST 6 FEET AS DEEDED TO THE CITY OF TUMWATER BY DEEDS RECORDED UNDER RECORDING NOS. 1111658, 1111659, AND 1120988;

ALSO EXCEPTING THEREFROM THAT PORTION DEEDED TO THE CITY OF TUMWATER BY DEED RECORDED UNDER RECORDING NO. 9509110161;

IN THURSTON COUNTY, WASHINGTON.

**RIGHT OF WAY DEDICATION DESCRIPTION:**

THAT PORTION OF THE ABOVE DESCRIBED PARCEL LYING SOUTH AND WEST OF THE FOLLOWING DESCRIBED LINE:

COMMENCING AT THE CENTERLINE INTERSECTION OF CAPITOL BOULEVARD AND EAST X STREET, SAID POINT ALSO BEING THE SOUTHWEST CORNER OF THE NORTHWEST QUARTER OF THE NORTHWEST QUARTER OF SECTION 2, TOWNSHIP 17 NORTH, RANGE 2 WEST, W.M.;  
THENCE NORTHERLY ALONG THE CENTERLINE OF CAPITOL BOULEVARD AND THE WEST LINE OF SAID NORTHWEST QUARTER, NORTH 02°11'41" EAST, 96.75 FEET;  
THENCE SOUTH 87°48'19" EAST, 36.00 FEET TO THE NORTHWEST CORNER OF THE ABOVE DESCRIBED PARCEL AND THE POINT OF BEGINNING;  
THENCE EASTERLY ALONG THE NORTH LINE OF THE ABOVE DESCRIBED PARCEL, SOUTH 89°32'15" EAST, 12.55 FEET;  
THENCE SOUTH 22°10'15" EAST, 43.16 FEET;  
THENCE SOUTH 01°14'58" EAST, 9.51 FEET;  
THENCE SOUTH 42°22'23" EAST, 6.40 FEET;  
THENCE SOUTH 56°33'22" EAST, 10.34 FEET;  
THENCE SOUTH 74°44'40" EAST, 25.28 FEET;  
THENCE SOUTH 89°16'04" EAST, 50.14 FEET TO THE EAST LINE OF THE ABOVE DESCRIBED PARCEL AND THE TERMINUS OF THIS LINE DESCRIPTION;

CONTAINING 2,218 SQUARE FEET, MORE OR LESS;

SITUATE IN THE COUNTY OF THURSTON, STATE OF WASHINGTON.

**TEMPORARY CONSTRUCTION EASEMENT DESCRIPTION:**

THAT PORTION OF THE ABOVE DESCRIBED PARCEL DESCRIBED AS FOLLOWS:

COMMENCING AT THE CENTERLINE INTERSECTION OF CAPITOL BOULEVARD AND EAST X STREET, SAID POINT ALSO BEING THE SOUTHWEST CORNER OF THE NORTHWEST QUARTER OF THE NORTHWEST QUARTER OF SECTION 2, TOWNSHIP 17 NORTH, RANGE 2 WEST, W.M.;  
THENCE NORTHERLY ALONG THE CENTERLINE OF CAPITOL BOULEVARD AND THE WEST LINE OF SAID NORTHWEST QUARTER, NORTH 02°11'41" EAST, 96.75 FEET;  
THENCE SOUTH 87°48'19" EAST, 36.00 FEET TO THE NORTHWEST CORNER OF THE ABOVE DESCRIBED PARCEL;  
THENCE EASTERLY ALONG THE NORTH LINE OF THE ABOVE DESCRIBED PARCEL, SOUTH 89°32'15" EAST, 12.55 FEET TO THE POINT OF BEGINNING;  
THENCE SOUTH 22°10'15" EAST, 43.16 FEET;  
THENCE SOUTH 01°14'58" EAST, 9.51 FEET;  
THENCE SOUTH 42°22'23" EAST, 6.40 FEET;  
THENCE SOUTH 56°33'22" EAST, 10.34 FEET;  
THENCE SOUTH 74°44'40" EAST, 25.28 FEET;  
THENCE SOUTH 89°16'04" EAST, 50.14 FEET TO THE EAST LINE OF THE ABOVE DESCRIBED PARCEL;  
THENCE NORTHERLY ALONG SAID EAST LINE, NORTH 02°11'41" EAST, 5.39 FEET;  
THENCE NORTH 89°10'00" WEST, 50.01 FEET;  
THENCE NORTH 41°55'57" WEST, 7.68 FEET;  
THENCE NORTH 86°38'27" WEST, 28.03 FEET;  
THENCE NORTH 42°22'23" WEST, 6.01 FEET;  
THENCE NORTH 01°14'58" WEST, 9.33 FEET;  
THENCE NORTH 20°08'43" WEST, 15.97 FEET;  
THENCE NORTH 88°03'35" EAST, 32.03 FEET;  
THENCE NORTH 01°56'25" WEST, 10.00 FEET;  
THENCE SOUTH 88°03'35" WEST, 35.32 FEET;  
THENCE NORTH 20°08'43" WEST, 2.38 FEET;  
THENCE NORTH 28°04'20" WEST, 14.56 FEET TO THE NORTH LINE OF THE ABOVE DESCRIBED PARCEL AND THE POINT OF BEGINNING;

CONTAINING 874 SQUARE FEET, MORE OR LESS.

SITUATE IN THE COUNTY OF THURSTON, STATE OF WASHINGTON.

PREPARED BY: PAUL E. BOUGHAL JR., PLS  
MTN2COAST, LLC  
10/22/2025

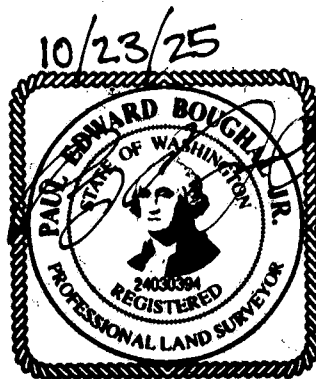

## EXHIBIT A

### Parcel: Slater Enterprises Phase III, LLC 12703112000

The South 176.2 feet of the East 150 feet of the Northeast quarter of the Northeast quarter of Section 3, Township 17 North, Range 2 West, W.M.;

Excepting therefrom the East 30 feet for Capitol Boulevard;

Also excepting therefrom the South 30 feet for West "X" Street;

And also excepting therefrom that portion conveyed to the City of Tumwater by deed recorded September 18, 1995 under Recording No. 9509180191;

In Thurston County, Washington

### Right of Way:

The South 176.2 feet of the East 150 feet of the Northeast quarter of the Northeast quarter of Section 3, Township 17 North, Range 2 West, W.M.;

Excepting therefrom the East 30 feet for Capitol Boulevard;

Also excepting therefrom the South 30 feet for West "X" Street;

And also excepting therefrom that portion conveyed to the City of Tumwater by deed recorded September 18, 1995 under Recording No. 9509180191;

In Thurston County, Washington

Containing 17,305 sq.ft.



(Description prepared by or under the direction of Rynea L. Edwards on 06-29-2023)

## EXHIBIT A

**Parcel: Slater Enterprises Phase III, LLC 12703112400**

The North 50 feet the South 226.2 feet of the East 150 feet of the Northeast quarter of the Northeast quarter of Section 3,

Township 17 North, Range 2 West, W.M.;

Excepting therefrom the East 30 feet for Capitol Boulevard;

In Thurston County, Washington

**Right of Way:**

The North 50 feet the South 226.2 feet of the East 150 feet of the Northeast quarter of the Northeast quarter of Section 3,

Township 17 North, Range 2 West, W.M.;

Excepting therefrom the East 30 feet for Capitol Boulevard;

In Thurston County, Washington

Containing 5,999 sq.ft.



(Description prepared by or under the direction of Rynea L. Edwards on 06-29-2023)