

**VAR 21-0002**

**To development standard:  
TDC Table 64-2**

**PGE Substation  
12150 SW Tualatin-Sherwood  
Road**

**VAR 21-0002  
PGE Substation Fence Variance**

**TUALATIN PLANNING COMMISSION  
May 20, 2021**



# SITE BACKGROUND



VAR 21-0002  
PGE Substation Fence Variance

TUALATIN PLANNING COMMISSION  
May 20, 2021





# SITE BACKGROUND



**VAR 21-0002**  
**PGE Substation Fence Variance**

**TUALATIN PLANNING COMMISSION**  
**May 20, 2021**



# SITE BACKGROUND



**VAR 21-0002**  
**PGE Substation Fence Variance**

**TUALATIN PLANNING COMMISSION**  
**May 20, 2021**



# Variance

## **Variations:**

- Variations may be granted to the requirements of the TDC...when it can be shown that, owing to special and unusual circumstances related to a specific piece of property, the literal interpretation of the TDC would cause an undue or unnecessary hardship.





# VARIANCE

**Table 64-2 Development Standards in the MBP Zone**

<i>Standard</i>	Requirement	Limitations and Code Reference
<i>Fences</i>	50 feet	From public right-of-way.

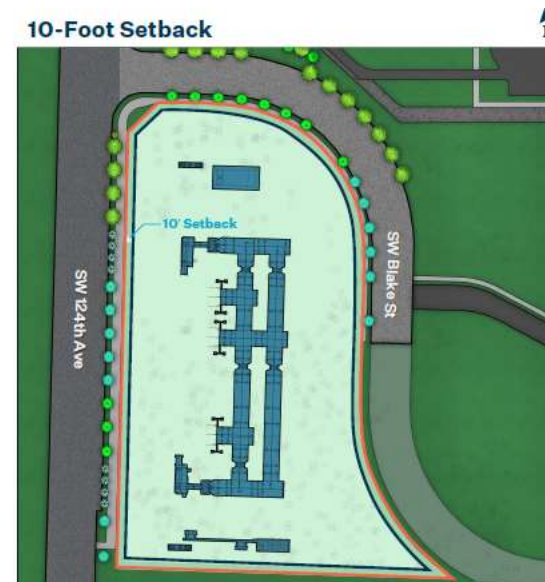
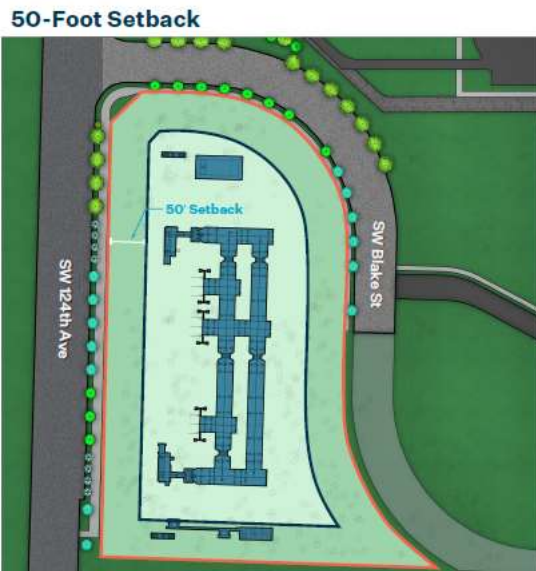

**VAR 21-0002**  
**PGE Substation Fence Variance**

**TUALATIN PLANNING COMMISSION**  
**May 20, 2021**



# VARIANCE



**VAR 21-0002**  
**PGE Substation Fence Variance**

**TUALATIN PLANNING COMMISSION**  
**May 20, 2021**



# RECOMMENDATION

- The findings (Exhibit A) demonstrate that the proposal meets the applicable criteria of the Tualatin Development Code.
- Staff respectfully recommends approval of Variance (VAR 21-0002) application.
- Questions?