

## ALLEN WEST BUSINESS PARK

Beaverton, Oregon

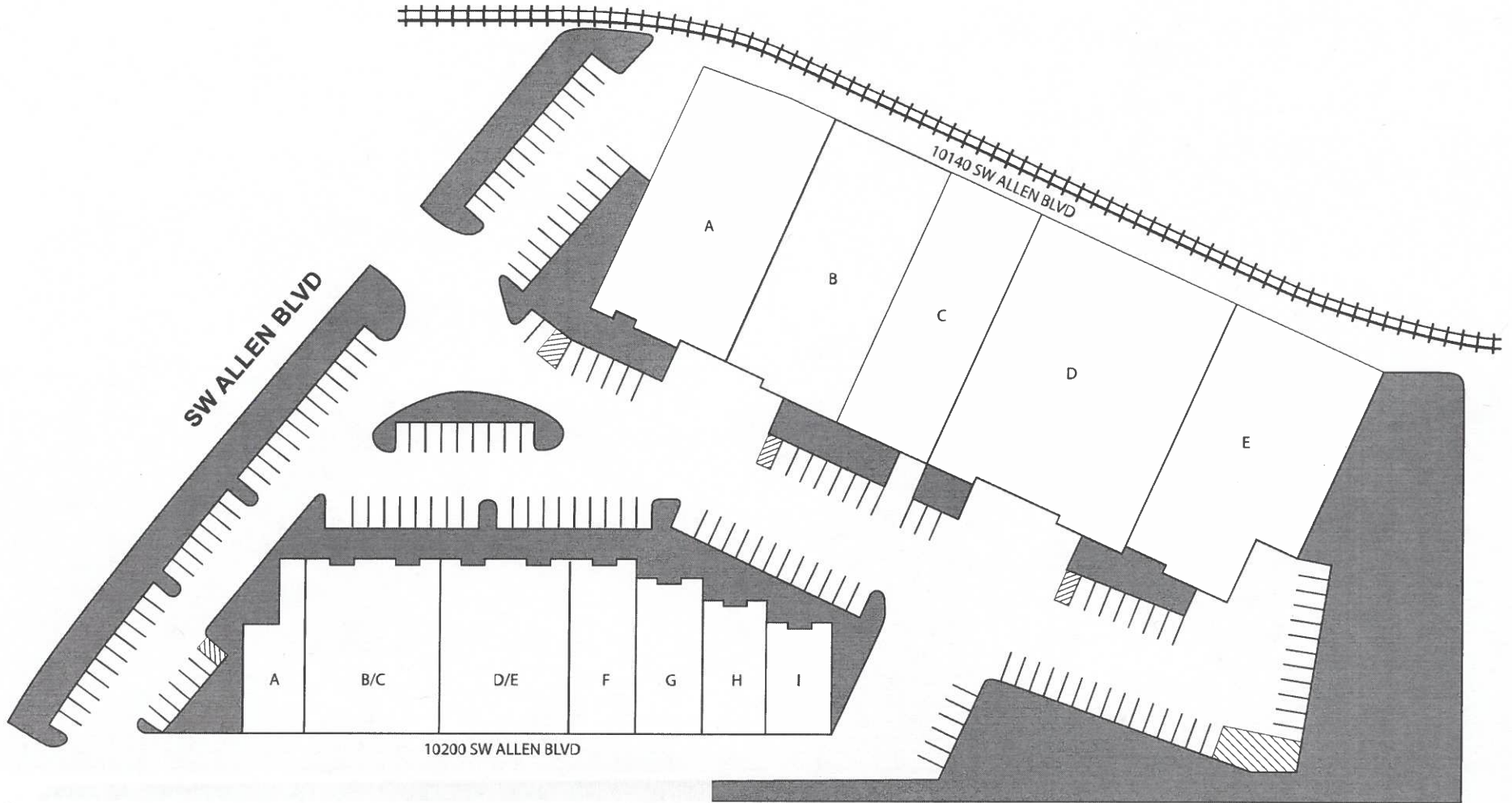

|                          |           |
|--------------------------|-----------|
| Infinity Financial       | 7,899 SF  |
| Apantac                  | 6,256 SF  |
| Cedar House Media        | 3,740 SF  |
| CBOE Office Technology   | 3,506 SF  |
| Brooks Pest Control      | 3,300 SF  |
| Pro Drain & Rooter Serv. | 2,860 SF  |
| Cote d'Or Imports        | 2,420 SF  |
| All Points Media         | 22,572 SF |
| CNW, Inc.                | 17,214 SF |
| Epiq Class Action        | 10,673 SF |

|                                      |
|--------------------------------------|
| Financial services                   |
| Design/development imaging equipment |
| Media                                |
| Printer/laptop assembly              |
| Exterminators                        |
| Plumbers                             |
| Wine storage                         |
| Outdoor advertising                  |
| Consignment furniture sales          |
| Document storage                     |

# DENNEY ROAD INDUSTRIAL

Beaverton, Oregon

HIGHWAY 217

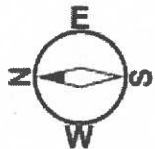
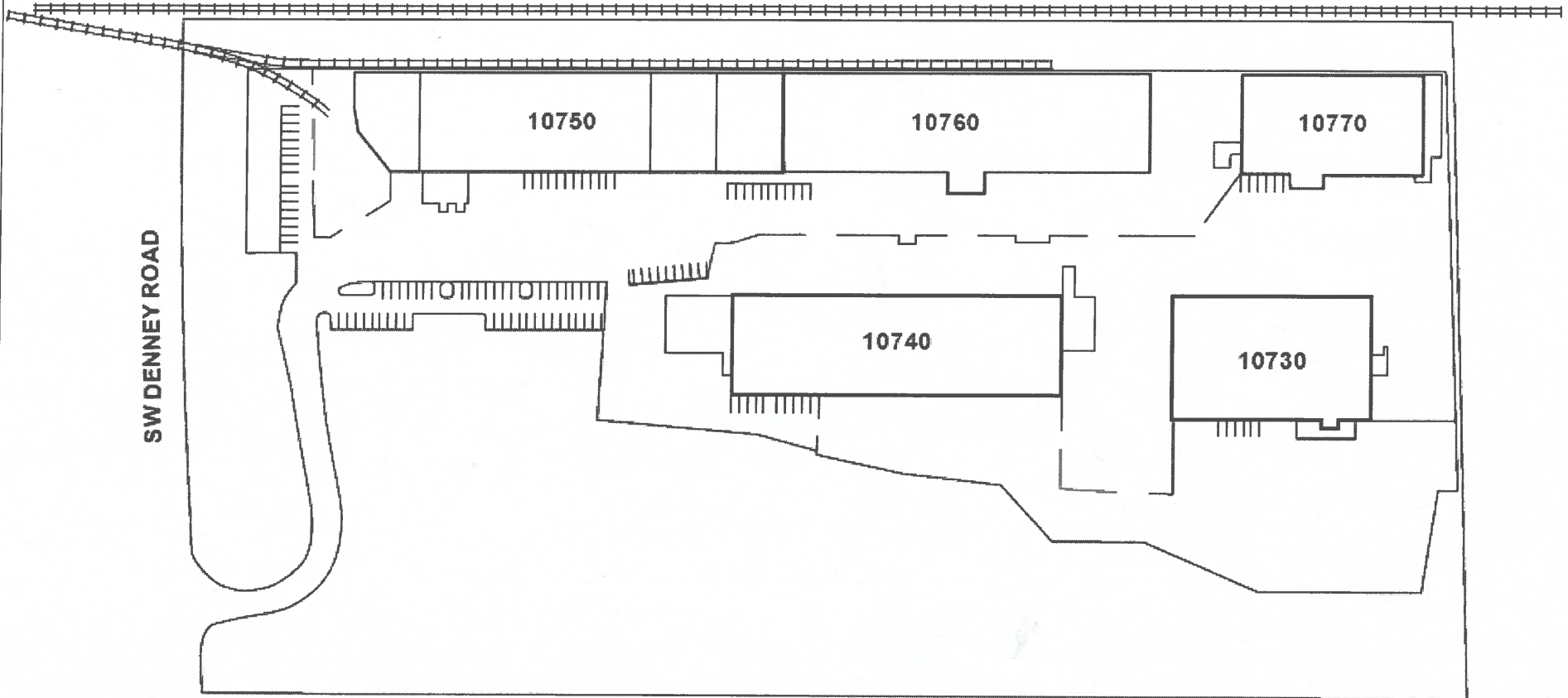

|                          |           |
|--------------------------|-----------|
| Circus Trix              | 33,528 SF |
| Tillamook Country Smoker | 75,082 SF |
| Ness & Campbell Crane    | 27,200 SF |
| Shift Operations         | 36,200 SF |
| Arizona Tile             | 48,000 SF |

|                                       |
|---------------------------------------|
| Family amusement center               |
| Food production                       |
| Crane/rigging/large equipment         |
| Auto service and reconditioning       |
| Tile, stone, quartz showroom & distr. |

# WILSONVILLE COMMERCE CENTER

27120-27180 SW 95th Avenue, Wilsonville, 97070

SW NIKE DRIVE

SW 95TH AVE

WEST FRONTAGE ROAD

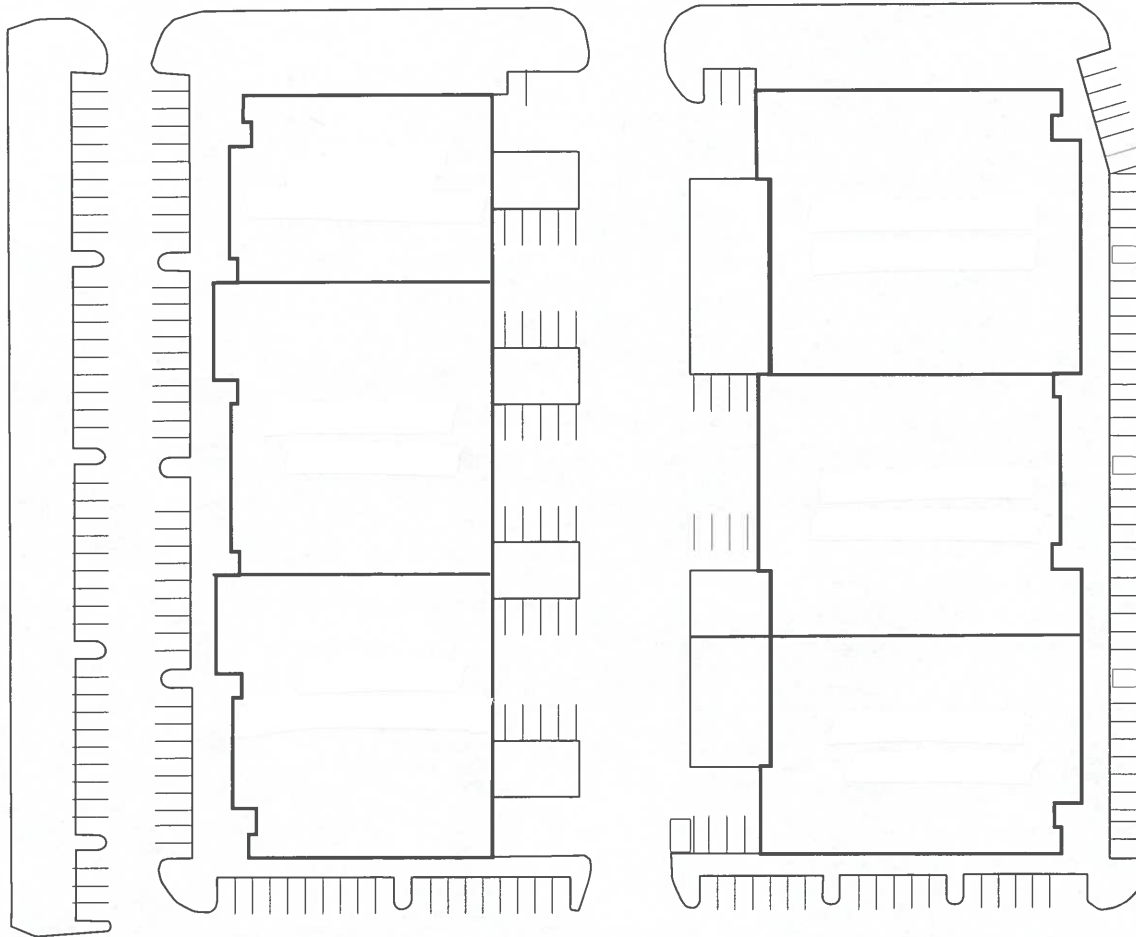
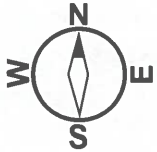

|                            |           |
|----------------------------|-----------|
| Mitchell, Lewis & Staver   | 21,724 SF |
| Allied Technologies        | 21,012 SF |
| Commercial Furniture Dist. | 19,663 SF |
| Century Wheel & Rim        | 23,524 SF |
| Proctor Sales              | 19,665 SF |

|  |
|--|
| Pumping equipment & service            |
| High-tech manufacturing                |
| Furniture warehousing/distribution     |
| Auto/truck/trailer parts & accessories |
| Boiler/steam/hydrionic product sales   |



**Schnitzer**  
PROPERTIES