







Legend

-  Proposed Right-of-Way
-  Public Utility Easement (PUE)
-  Slope Easement (SE)
-  Proposed Stormwater Easement (PSWE)
-  Property Line
-  Edge Of Pavement



Helenius
 2S127D001400
 21215 SW 105th Ave.
 Tualatin, Or.

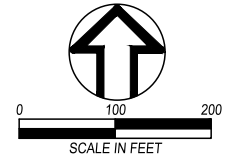
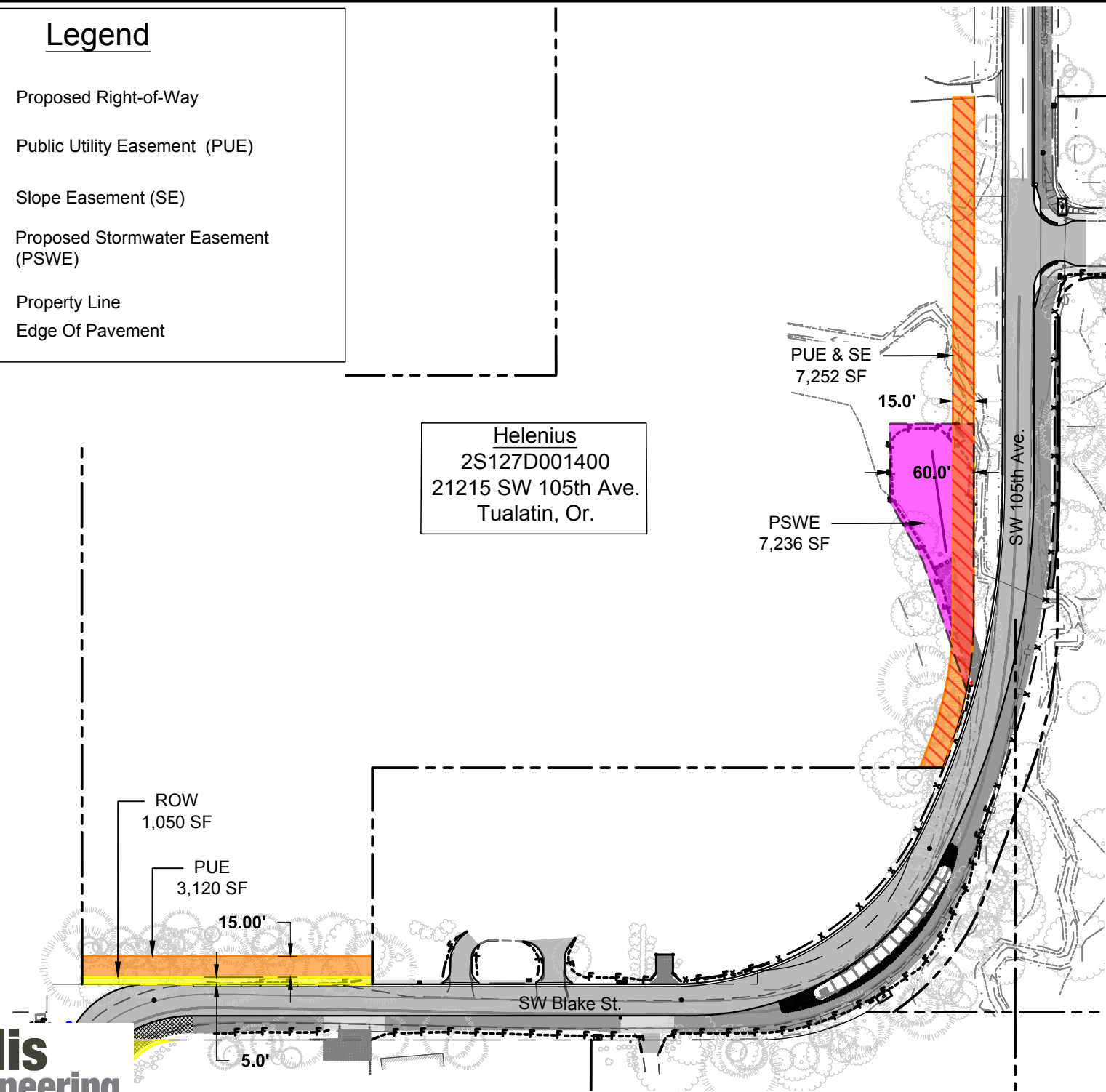

P:\141470A_Garden_Corner_Curves\Imp_P1600_DWG\505 Exhibit\Right of way\RIGHT OF WAY ACQUISITION.dwg, 3/31/2020 1:02:08 PM, David Brokaw



March 2020