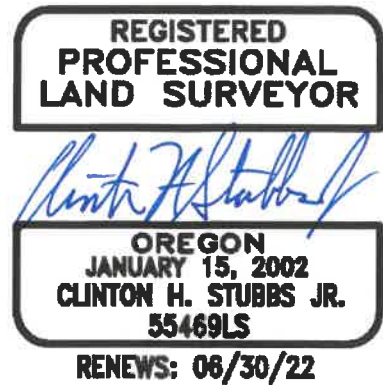

Exhibit 1. Legal Description



1815 NW 169th Place, Suite 2090
Beaverton, OR 97006
Telephone: 503-848-2127



Annexation Description

July 15, 2021

NWS Project Number 2029

A tract of land located in the southwest one-quarter of Section 27, Township 2 South, Range 1 West, Willamette Meridian, Washington County, Oregon, and being more particularly described as follows:

Commencing at a 2 inch brass disk marking the west one-quarter corner of said Section 27; Thence along the northerly line of the southwest one-quarter of said Section 27, South 88°27'34" East 1298.76 feet to its intersection with the westerly right-of-way line of SW 120th Avenue (20.00 feet westerly from the centerline thereof, when measured at right angles); Thence along the said westerly right-of-way line, South 01°45'23" West 20.00 feet to the southerly right-of-way of SW Itel Street; Thence along the southerly right-of-way line of said SW Itel Street, South 88°27'34" East 10.00 feet to the northwest corner of that property conveyed to Ashwood Construction, Inc. by a deed recorded on April 21, 1988 as Document Number 88-016661, Washington County Deed Records, and the Point of Beginning;

Thence continuing along the southerly right-of-way line of SW Itel Street, South 88°27'34" East 10.10 feet to an angle point thereon; Thence continuing along the southerly right-of-way line of SW Itel Street, South 88°34'58" East 290.08 feet to the westerly right-of-way line of SW 120th Avenue; Thence along the westerly right-of-way line of said SW 120th Avenue, South 01°14'05" West 547.98 feet to the southeast corner of said Ashwood Construction, Inc. property; Thence along the south line of said Ashwood Construction, Inc. property, North 88°34'58" West 335.79 feet to the southwest corner thereof; Thence along westerly boundary of said Ashwood Construction, Inc. property, North 01°36'45" East 368.00 feet to an angle point thereon; Thence continuing along said westerly boundary, South 88°34'58" East 32.00 feet to an angle point thereon; Thence continuing along said westerly boundary, North 01°36'45" East 180.00 feet to the Point of Beginning.

The above described tract of land contains 4.07 acres, more or less.

The basis of bearings for this description is the Oregon State Plane Coordinate System, North Zone, NAD (83).