

Recording Requested By:
and

Return to: Town of Truckee
Judy Price, Town Clerk
10183 Truckee Airport Road
Truckee CA 96161

Not Subject to Fees: GCS 27383

Nevada County Recorder
Gregory J. Diaz
Document#: 20140003827
Friday February 28 2014, at 03:19:31 PM

Paid:
Recorded By: CP

26
NP

CERTIFICATE OF CORRECTION PARCEL MAP 01-076B, PIONEER COMMERCE CENTER PHASE III

NOTICE IS HEREBY GIVEN: That the Parcel Map No. 01-076B, Pioneer Commerce Center Phase III, filed for record on October 20, 2005 in Book 19 of Parcel Maps at Page 175 N.C.R., Nevada County Records, is hereby corrected in accordance with Section 8770.5 of the Professional Land Surveyor's Act and Sections 66469, 66470, and 66472.1 of the Subdivision Map Act as follows:

NOTE 6 ON MAP SHEET 5 OF 5 SHALL BE CORRECTED TO READ:

6. ALL OUTDOOR ACTIVITY, OUTDOOR RETAIL ACTIVITY, EQUIPMENT, MATERIALS, AND VEHICLE STORAGE, SHALL BE PROHIBITED ON THE REAR PORTION OF LOTS 4-9. OUTDOOR STORAGE AND RELATED OUTDOOR USES MAY ONLY BE PERMITTED IN THE FRONT OF BUILDINGS, UNLESS A ZONING CLEARANCE IS APPROVED BY THE PLANNING COMMISSION.

This correction is being made to delete the original Note 6 on Map Sheet 5 of 5 of Parcel Map No. 01-076B, Pioneer Commerce Center Phase III, filed for record on October 20, 2005, and replace it with the corrected note as approved by the Truckee Planning Commission with adoption of Planning Commission Resolution No. 2010-01 on September 8, 2010.

The present fee owners of real property affected by such corrections are:

Gregory F. Hovorka, Lot 4, APN 19-920-05
Aaron Jensen and Simone Jensen, Lot 5, APN 19-920-06
Jeremy Jones and Tiffany Jones, Lot 6, APN 19-920-07
Ritchie S E Corp, Lot 7, APN 19-920-08
Ryan R. Holland and Judy A. Holland, Lot 8, APN 19-920-09
Angel Food Land LLC, Lot 9, APN 19-920-10

The fee owner at the time of recordation of Parcel Map was Pendrell Truckee, LLC, A California Limited Liability Company and Hidden Lake Properties, Inc., A California Corporation.

CERTIFICATE OF SURVEYOR

THIS IS TO CERTIFY that the above certificate of correction was prepared by or under the direction and control of the undersigned registered land surveyor.

DEC 12, 2013
DATE

John Rietjens, Town Surveyor
LS4323, License Expires 06/30/14

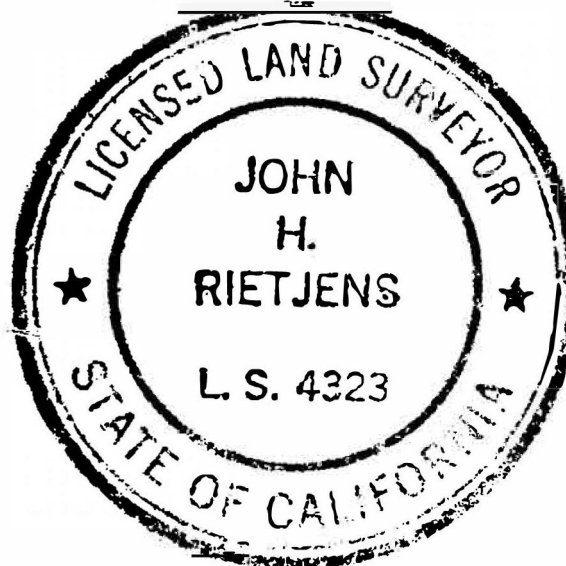

CERTIFICATE OF OWNER

THIS IS TO CERTIFY that undersigned owners of record title interest hereby consent to the above certificate of correction:

DATE Gregory F. Hovorka

DATE Aaron Jensen

DATE Simone Jensen

DATE Jeremy Jones

DATE Tiffany Jones

DATE Ritchie S E Corp
Scott Ritchie

DATE Ryan R. Holland

DATE Judy A. Holland

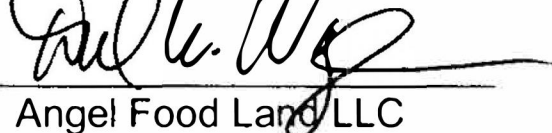
12/2/13
DATE 
Angel Food Land LLC
Dave Wayda

CERTIFICATE OF TOWN ENGINEER

THIS IS TO CERTIFY that the above Certificate of Correction was approved by the Town Engineer and that the Town Engineer hereby requests the Town of Truckee Surveyor to transmit said certificate to the Nevada County Recorder for recordation.

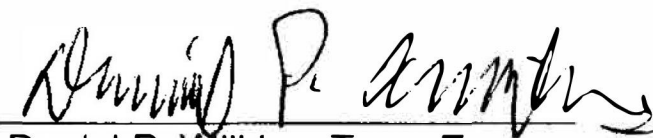
2-25-14
DATE 
Daniel P. Wilkins, Town Engineer
R.C.E. 56267, Renewal Date: 12/31/12

CERTIFICATE OF TOWN SURVEYOR

THIS IS TO CERTIFY that the above certificate of correction has been examined this 12 day of DECEMBER, 2012 for conformance with the requirements of Section 8770.5 of the Land Surveyor's Act and Chapter 3 Article 7, Sections 66469, 66470 and 66472.1 of the subdivision map act.

DEC 12, 2013
DATE
John Rietjens
John Rietjens, Town Surveyor
LS4323, License Expires 06/30/14

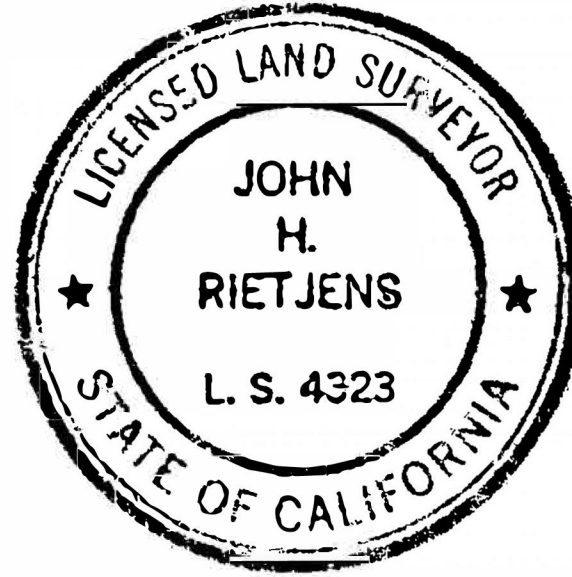

All-purpose Acknowledgment

STATE OF Oregon, COUNTY OF Jackson

On December 2, 2013 before me, the undersigned, a Notary Public
in and for said State, personally appeared

David Wayda

☐ personally known to me -OR- ☒ proved to me on the basis of satisfactory evidence/ to be the person(s)
whose name(s) ~~is/are~~ subscribed to the within instrument and acknowledged to me that he/~~she/they~~
executed the same in his/~~her/their~~ authorized capacity(~~ies~~), and that by his/~~her/their~~ signature(~~s~~) on the
instrument the person(~~s~~), or the entity upon behalf of which the person(~~s~~) acted, executed the instrument.

WITNESS my hand and official seal.

Signature

Name (type or printed)

My commission expires:

Dec 26, 2014



(Seal)

Recording Requested By:
and

Return to: Town of Truckee
Judy Price, Town Clerk
10183 Truckee Airport Road
Truckee CA 96161

Not Subject to Fees: GCS 27383

CERTIFICATE OF CORRECTION PARCEL MAP 01-076B, PIONEER COMMERCE CENTER PHASE III

NOTICE IS HEREBY GIVEN: That the Parcel Map No. 01-076B, Pioneer Commerce Center Phase III, filed for record on October 20, 2005 in Book 19 of Parcel Maps at Page 175 N.C.R., Nevada County Records, is hereby corrected in accordance with Section 8770.5 of the Professional Land Surveyor's Act and Sections 66469, 66470, and 66472.1 of the Subdivision Map Act as follows:

NOTE 6 ON MAP SHEET 5 OF 5 SHALL BE CORRECTED TO READ:

6. ALL OUTDOOR ACTIVITY, OUTDOOR RETAIL ACTIVITY, EQUIPMENT, MATERIALS, AND VEHICLE STORAGE, SHALL BE PROHIBITED ON THE REAR PORTION OF LOTS 4-9. OUTDOOR STORAGE AND RELATED OUTDOOR USES MAY ONLY BE PERMITTED IN THE FRONT OF BUILDINGS, UNLESS A ZONING CLEARANCE IS APPROVED BY THE PLANNING COMMISSION.

This correction is being made to delete the original Note 6 on Map Sheet 5 of 5 of Parcel Map No. 01-076B, Pioneer Commerce Center Phase III, filed for record on October 20, 2005, and replace it with the corrected note as approved by the Truckee Planning Commission with adoption of Planning Commission Resolution No. 2010-01 on September 8, 2010.

The present fee owners of real property affected by such corrections are:

Gregory F. Hovorka, Lot 4, APN 19-920-05
Aaron Jensen and Simone Jensen, Lot 5, APN 19-920-06
Jeremy Jones and Tiffany Jones, Lot 6, APN 19-920-07
Ritchie S E Corp, Lot 7, APN 19-920-08
Ryan R. Holland and Judy A. Holland, Lot 8, APN 19-920-09
Angel Food Land LLC, Lot 9, APN 19-920-10

The fee owner at the time of recordation of Parcel Map was Pendrell Truckee, LLC, A California Limited Liability Company and Hidden Lake Properties, Inc., A California Corporation.

CERTIFICATE OF SURVEYOR

THIS IS TO CERTIFY that the above certificate of correction was prepared by or under the direction and control of the undersigned registered land surveyor.

10/31/13
DATE

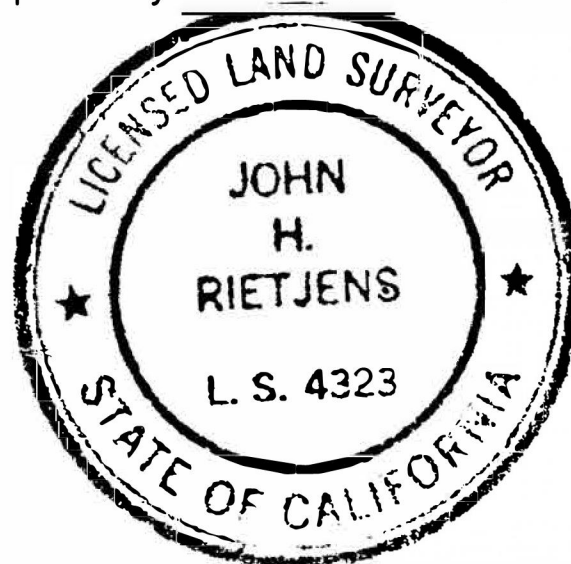

John Rietjens, Town Surveyor
LS4323, License Expires 06/30/14



CERTIFICATE OF OWNER

THIS IS TO CERTIFY that undersigned owners of record title interest hereby consent to the above certificate of correction:

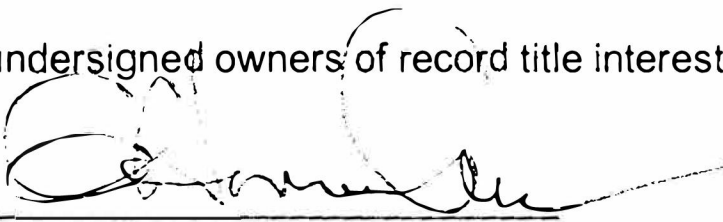
5-29-12
DATE



Gregory F. Hovorka

DATE

Aaron Jensen

DATE

Simone Jensen

DATE

Jeremy Jones

DATE

Tiffany Jones

DATE

Ritchie S E Corp
Scott Ritchie

DATE

Ryan R. Holland

DATE

Judy A. Holland

DATE

Angel Food Land LLC
Dave Wayda

CERTIFICATE OF TOWN ENGINEER

THIS IS TO CERTIFY that the above Certificate of Correction was approved by the Town Engineer and that the Town Engineer hereby requests the Town of Truckee Surveyor to transmit said certificate to the Nevada County Recorder for recordation.

2-25-14
DATE



Daniel P. Wilkins, Town Engineer
R.C.E. 56267, Renewal Date: 12/31/12

CALIFORNIA ALL-PURPOSE ACKNOWLEDGMENT

State of California }
County of Nevada }
On 5-29-12 before me, Shanna D. Kuhlemier, Notary Public,
Date Here Insert Name and Title of the Officer
personally appeared Gregory F. Kovorka
Name(s) of Signer(s)



who proved to me on the basis of satisfactory evidence to be the person(s) whose name(s) is/are subscribed to the within instrument and acknowledged to me that he/she/they executed the same in his/her/their authorized capacity(ies), and that by his/her/their signature(s) on the instrument the person(s), or the entity upon behalf of which the person(s) acted, executed the instrument.

I certify under PENALTY OF PERJURY under the laws of the State of California that the foregoing paragraph is true and correct.

WITNESS my hand and official seal.

Signature Shanna D. Kuhlemier
Signature of Notary Public

Place Notary Seal Above

OPTIONAL

Though the information below is not required by law, it may prove valuable to persons relying on the document and could prevent fraudulent removal and reattachment of this form to another document.

Description of Attached Document

Title or Type of Document: _____
Document Date: _____ Number of Pages: _____
Signer(s) Other Than Named Above: _____

Capacity(ies) Claimed by Signer(s)

Signer's Name: _____
☐ Individual
☐ Corporate Officer — Title(s): _____
☐ Partner — ☐ Limited ☐ General
☐ Attorney in Fact
☐ Trustee
☐ Guardian or Conservator
☐ Other: _____



Signer Is Representing: _____

Signer's Name: _____
☐ Individual
☐ Corporate Officer — Title(s): _____
☐ Partner — ☐ Limited ☐ General
☐ Attorney in Fact
☐ Trustee
☐ Guardian or Conservator
☐ Other: _____



Signer Is Representing: _____

CERTIFICATE OF TOWN SURVEYOR

THIS IS TO CERTIFY that the above certificate of correction has been examined this 31 day of Oct,
2012³ for conformance with the requirements of Section 8770.5 of the Land Surveyor's Act and Chapter 3 Article 7,
Sections 66469, 66470 and 66472.1 of the subdivision map act.

10/31/13
DATE

John Rietjens
John Rietjens, Town Surveyor
LS4323, License Expires 06/30/14

Recording Requested By:
and

Return to: Town of Truckee
Judy Price, Town Clerk
10183 Truckee Airport Road
Truckee CA 96161

Not Subject to Fees: GCS 27383

CERTIFICATE OF CORRECTION PARCEL MAP 01-076B, PIONEER COMMERCE CENTER PHASE III

NOTICE IS HEREBY GIVEN: That the Parcel Map No. 01-076B, Pioneer Commerce Center Phase III, filed for record on October 20, 2005 in Book 19 of Parcel Maps at Page 175 N.C.R., Nevada County Records, is hereby corrected in accordance with Section 8770.5 of the Professional Land Surveyor's Act and Sections 66469, 66470, and 66472.1 of the Subdivision Map Act as follows:

NOTE 6 ON MAP SHEET 5 OF 5 SHALL BE CORRECTED TO READ:

6. ALL OUTDOOR ACTIVITY, OUTDOOR RETAIL ACTIVITY, EQUIPMENT, MATERIALS, AND VEHICLE STORAGE, SHALL BE PROHIBITED ON THE REAR PORTION OF LOTS 4-9. OUTDOOR STORAGE AND RELATED OUTDOOR USES MAY ONLY BE PERMITTED IN THE FRONT OF BUILDINGS, UNLESS A ZONING CLEARANCE IS APPROVED BY THE PLANNING COMMISSION.

This correction is being made to delete the original Note 6 on Map Sheet 5 of 5 of Parcel Map No. 01-076B, Pioneer Commerce Center Phase III, filed for record on October 20, 2005, and replace it with the corrected note as approved by the Truckee Planning Commission with adoption of Planning Commission Resolution No. 2010-01 on September 8, 2010.

The present fee owners of real property affected by such corrections are:

Gregory F. Hovorka, Lot 4, APN 19-920-05
Aaron Jensen and Simone Jensen, Lot 5, APN 19-920-06
Jeremy Jones and Tiffany Jones, Lot 6, APN 19-920-07
Ritchie S E Corp, Lot 7, APN 19-920-08
Ryan R. Holland and Judy A. Holland, Lot 8, APN 19-920-09
Angel Food Land LLC, Lot 9, APN 19-920-10

The fee owner at the time of recordation of Parcel Map was Pendrell Truckee, LLC, A California Limited Liability Company and Hidden Lake Properties, Inc., A California Corporation.

CERTIFICATE OF SURVEYOR

THIS IS TO CERTIFY that the above certificate of correction was prepared by or under the direction and control of the undersigned registered land surveyor.

Nov 5, 2013
DATE

John Rietjens, Town Surveyor
LS4323, License Expires 06/30/14



CERTIFICATE OF OWNER

THIS IS TO CERTIFY that undersigned owners of record title interest hereby consent to the above certificate of correction:

DATE_____
Gregory F. Hovorka10-30-13
DATE_____
Aaron Jensen10/30/13
DATE_____
Simone Jensen_____
DATE_____
Jeremy Jones_____
DATE_____
Tiffany Jones_____
DATE_____
Ritchie S E Corp
Scott Ritchie_____
DATE_____
Ryan R. Holland_____
DATE_____
Judy A. Holland_____
DATE_____
Angel Food Land LLC
Dave Wayda**CERTIFICATE OF TOWN ENGINEER**

THIS IS TO CERTIFY that the above Certificate of Correction was approved by the Town Engineer and that the Town Engineer hereby requests the Town of Truckee Surveyor to transmit said certificate to the Nevada County Recorder for recordation.

2-25-14
DATE

Daniel P. Wilkins, Town Engineer
R.C.E. 56267, Renewal Date: 12/31/12

CERTIFICATE OF TOWN SURVEYOR

THIS IS TO CERTIFY that the above certificate of correction has been examined this ____ day of _____, 2012 for conformance with the requirements of Section 8770.5 of the Land Surveyor's Act and Chapter 3 Article 7, Sections 66469, 66470 and 66472.1 of the subdivision map act.

Nov 9, 2012
DATE
John Rietjens
John Rietjens, Town Surveyor
LS4323, License Expires 06/30/14



CALIFORNIA ALL-PURPOSE ACKNOWLEDGMENT

State of California }
 County of Nevada }

On October 30 2013 before me, Alison Cunha

personally appeared Aaron Jensen

who proved to me on the basis of satisfactory evidence to be the persons(s) whose name(s) is/are subscribed to the within instrument and acknowledged to me that he/she/they executed the same in his/her/their authorized capacity (ies), and that by his/her/their signature(s) on the instrument the person(s), or the entity upon behalf of which the person(s) acted, executed the instrument.

I certify under PENALTY OF PERJURY under the laws of the State of California that the foregoing paragraph is true and correct.

WITNESS my hand and official seal.

Alison Cunha
 Signature of Notary

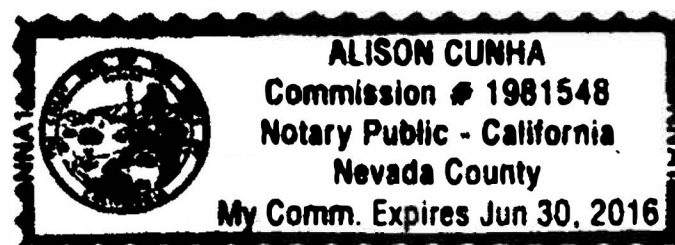

CALIFORNIA ALL-PURPOSE ACKNOWLEDGMENT

State of California }
County of Nevada }

On October 30, 2013 before me, Alison Cunha
personally appeared Simone Jensen

who proved to me on the basis of satisfactory evidence to be the person(s) whose name(s) is/are subscribed to the within instrument and acknowledged to me that he/she/they executed the same in his/her/their authorized capacity (ies), and that by his/her/their signature(s) on the instrument the person(s), or the entity upon behalf of which the person(s) acted, executed the instrument.

I certify under PENALTY OF PERJURY under the laws of the State of California that the foregoing paragraph is true and correct.

WITNESS my hand and official seal.

Alison Cunha

Signature of Notary

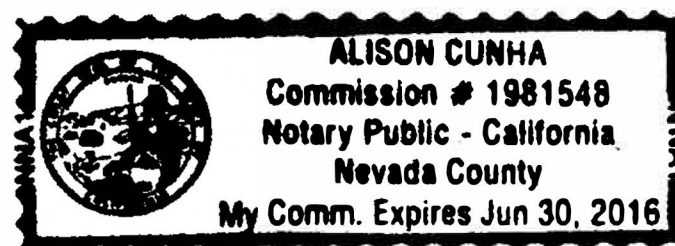

Recording Requested By:
and

Return to: Town of Truckee
Judy Price, Town Clerk
10183 Truckee Airport Road
Truckee CA 96161

Not Subject to Fees: GCS 27383

CERTIFICATE OF CORRECTION
PARCEL MAP 01-076B, PIONEER COMMERCE CENTER PHASE III

NOTICE IS HEREBY GIVEN: That the Parcel Map No. 01-076B, Pioneer Commerce Center Phase III, filed for record on October 20, 2005 in Book 19 of Parcel Maps at Page 175 N.C.R., Nevada County Records, is hereby corrected in accordance with Section 8770.5 of the Professional Land Surveyor's Act and Sections 66469, 66470, and 66472.1 of the Subdivision Map Act as follows:

NOTE 6 ON MAP SHEET 5 OF 5 SHALL BE CORRECTED TO READ:

6. ALL OUTDOOR ACTIVITY, OUTDOOR RETAIL ACTIVITY, EQUIPMENT, MATERIALS, AND VEHICLE STORAGE, SHALL BE PROHIBITED ON THE REAR PORTION OF LOTS 4-9. OUTDOOR STORAGE AND RELATED OUTDOOR USES MAY ONLY BE PERMITTED IN THE FRONT OF BUILDINGS, UNLESS A ZONING CLEARANCE IS APPROVED BY THE PLANNING COMMISSION.

This correction is being made to delete the original Note 6 on Map Sheet 5 of 5 of Parcel Map No. 01-076B, Pioneer Commerce Center Phase III, filed for record on October 20, 2005, and replace it with the corrected note as approved by the Truckee Planning Commission with adoption of Planning Commission Resolution No. 2010-01 on September 8, 2010.

The present fee owners of real property affected by such corrections are:

Gregory F. Hovorka, Lot 4, APN 19-920-05
Aaron Jensen and Simone Jensen, Lot 5, APN 19-920-06
Jeremy Jones and Tiffany Jones, Lot 6, APN 19-920-07
Ritchie S E Corp, Lot 7, APN 19-920-08
Ryan R. Holland and Judy A. Holland, Lot 8, APN 19-920-09
Angel Food Land LLC, Lot 9, APN 19-920-10

The fee owner at the time of recordation of Parcel Map was Pendrell Truckee, LLC, A California Limited Liability Company and Hidden Lake Properties, Inc., A California Corporation.

CERTIFICATE OF SURVEYOR

THIS IS TO CERTIFY that the above certificate of correction was prepared by or under the direction and control of the undersigned registered land surveyor.

10/31/13
DATE

John Rietjens, Town Surveyor
LS4323, License Expires 06/30/14

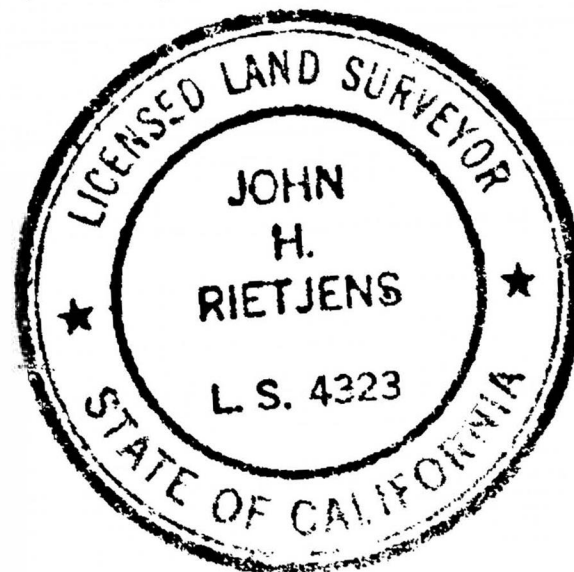

CERTIFICATE OF OWNER

THIS IS TO CERTIFY that undersigned owners of record title interest hereby consent to the above certificate of correction:

DATE

Gregory F. Hovorka

DATE

Aaron Jensen

DATE

Simone Jensen

DATE

Jeremy Jones

DATE

Tiffany Jones

DATE

Ritchie S E Corp
Scott Ritchie

DATE

Ryan R. Holland

DATE

Judy A. Holland

DATE

Angel Food Land LLC
Dave Wayda**CERTIFICATE OF TOWN ENGINEER**

THIS IS TO CERTIFY that the above Certificate of Correction was approved by the Town Engineer and that the Town Engineer hereby requests the Town of Truckee Surveyor to transmit said certificate to the Nevada County Recorder for recordation.

2-25-14
DATE

Daniel P. Wilkins, Town Engineer
R.C.E. 56267, Renewal Date: 12/31/12

ACKNOWLEDGMENT

State of California

County of Nevada

On 06/08/2012 before me, Brent Matlock, Notary Public
(insert name and title of the officer)

personally appeared Jeremy Jones
who proved to me on the basis of satisfactory evidence to be the person(s) whose name(s) is/are subscribed to the within instrument and acknowledged to me that he/she/they executed the same in his/her/their authorized capacity(ies), and that by his/her/their signature(s) on the instrument the person(s), or the entity upon behalf of which the person(s) acted, executed the instrument.

I certify under PENALTY OF PERJURY under the laws of the State of California that the foregoing paragraph is true and correct.

WITNESS my hand and official seal.

Signature Brent Matlock (Seal)

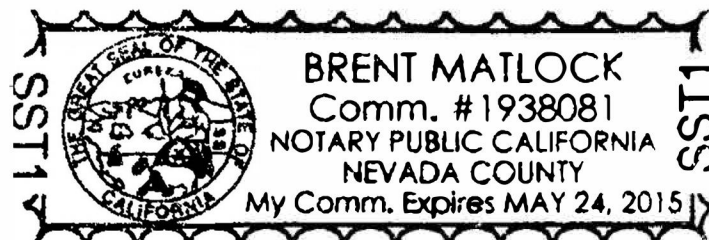

CALIFORNIA ALL-PURPOSE ACKNOWLEDGMENT

State of California

County of NevadaOn 6-13-2012 before me, Shanna D. Kuhlemier, Notary Public,
Date Here Insert Name and Title of the Officerpersonally appeared Tiffany Jones
Name(s) of Signer(s)

who proved to me on the basis of satisfactory evidence to be the person~~(s)~~ whose name~~(s)~~ is/~~are~~ subscribed to the within instrument and acknowledged to me that he/~~she/they~~ executed the same in his/~~her/their~~ authorized capacity~~(ies)~~, and that by his/~~her/their~~ signature~~(s)~~ on the instrument the person~~(s)~~, or the entity upon behalf of which the person(s) acted, executed the instrument.

I certify under PENALTY OF PERJURY under the laws of the State of California that the foregoing paragraph is true and correct.

WITNESS my hand and official seal.

Signature

Signature of Notary Public

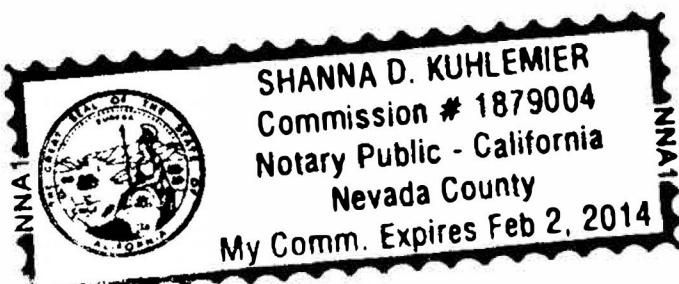

Place Notary Seal Above

OPTIONAL

Though the information below is not required by law, it may prove valuable to persons relying on the document and could prevent fraudulent removal and reattachment of this form to another document.

Description of Attached Document

Title or Type of Document: _____

Document Date: _____ Number of Pages: _____

Signer(s) Other Than Named Above: _____

Capacity(ies) Claimed by Signer(s)

Signer's Name: _____

- ☐ Individual
☐ Corporate Officer — Title(s): _____
☐ Partner — ☐ Limited ☐ General
☐ Attorney in Fact
☐ Trustee
☐ Guardian or Conservator
☐ Other: _____

Signer Is Representing: _____

**RIGHT THUMBPRINT
OF SIGNER**
Top of thumb here

Signer's Name: _____

- ☐ Individual
☐ Corporate Officer — Title(s): _____
☐ Partner — ☐ Limited ☐ General
☐ Attorney in Fact
☐ Trustee
☐ Guardian or Conservator
☐ Other: _____

Signer Is Representing: _____

**RIGHT THUMBPRINT
OF SIGNER**
Top of thumb here

CERTIFICATE OF TOWN SURVEYOR

THIS IS TO CERTIFY that the above certificate of correction has been examined this 31 day of Dec, 2012 for conformance with the requirements of Section 8770.5 of the Land Surveyor's Act and Chapter 3 Article 7, Sections 66469, 66470 and 66472.1 of the subdivision map act.

10/31/12
DATE

John Rietjens
John Rietjens, Town Surveyor
LS4323, License Expires 06/30/14



Recording Requested By:
and

Return to: Town of Truckee
Judy Price, Town Clerk
10183 Truckee Airport Road
Truckee CA 96161

Not Subject to Fees: GCS 27383

CERTIFICATE OF CORRECTION
PARCEL MAP 01-076B, PIONEER COMMERCE CENTER PHASE III

NOTICE IS HEREBY GIVEN: That the Parcel Map No. 01-076B, Pioneer Commerce Center Phase III, filed for record on October 20, 2005 in Book 19 of Parcel Maps at Page 175 N.C.R., Nevada County Records, is hereby corrected in accordance with Section 8770.5 of the Professional Land Surveyor's Act and Sections 66469, 66470, and 66472.1 of the Subdivision Map Act as follows:

NOTE 6 ON MAP SHEET 5 OF 5 SHALL BE CORRECTED TO READ:

6. ALL OUTDOOR ACTIVITY, OUTDOOR RETAIL ACTIVITY, EQUIPMENT, MATERIALS, AND VEHICLE STORAGE, SHALL BE PROHIBITED ON THE REAR PORTION OF LOTS 4-9. OUTDOOR STORAGE AND RELATED OUTDOOR USES MAY ONLY BE PERMITTED IN THE FRONT OF BUILDINGS, UNLESS A ZONING CLEARANCE IS APPROVED BY THE PLANNING COMMISSION.

This correction is being made to delete the original Note 6 on Map Sheet 5 of 5 of Parcel Map No. 01-076B, Pioneer Commerce Center Phase III, filed for record on October 20, 2005, and replace it with the corrected note as approved by the Truckee Planning Commission with adoption of Planning Commission Resolution No. 2010-01 on September 8, 2010.

The present fee owners of real property affected by such corrections are:

Gregory F. Hovorka, Lot 4, APN 19-920-05
Aaron Jensen and Simone Jensen, Lot 5, APN 19-920-06
Jeremy Jones and Tiffany Jones, Lot 6, APN 19-920-07
Ritchie S E Corp, Lot 7, APN 19-920-08
Ryan R. Holland and Judy A. Holland, Lot 8, APN 19-920-09
Angel Food Land LLC, Lot 9, APN 19-920-10

The fee owner at the time of recordation of Parcel Map was Pendrell Truckee, LLC, A California Limited Liability Company and Hidden Lake Properties, Inc., A California Corporation.

CERTIFICATE OF SURVEYOR

THIS IS TO CERTIFY that the above certificate of correction was prepared by or under the direction and control of the undersigned registered land surveyor.

06/30/14
DATE

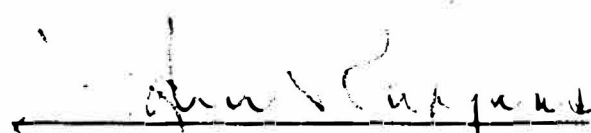
John Rietjens, Town Surveyor
LS4323, License Expires 06/30/14

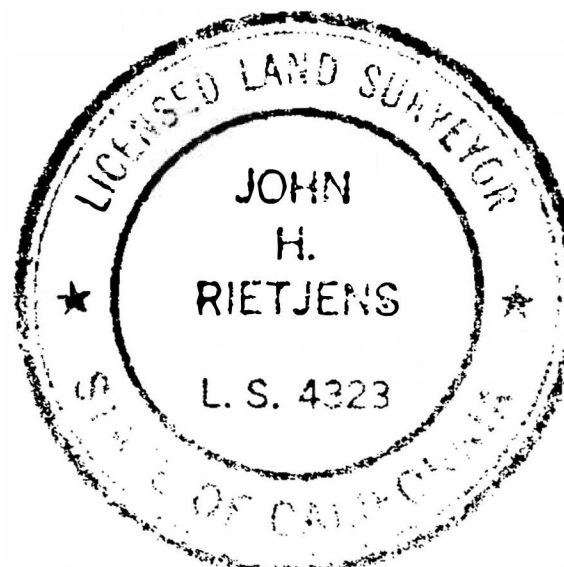

CERTIFICATE OF OWNER

THIS IS TO CERTIFY that undersigned owners of record title interest hereby consent to the above certificate of correction:

DATE Gregory F. Hovorka

DATE Aaron Jensen

DATE Simone Jensen

DATE Jeremy Jones

DATE Tiffany Jones

8/23/13
DATE 
Ritchie S E Corp
Scott Ritchie

DATE Ryan R. Holland

DATE Judy A. Holland

DATE Angel Food Land LLC
Dave Wayda

CERTIFICATE OF TOWN ENGINEER

THIS IS TO CERTIFY that the above Certificate of Correction was approved by the Town Engineer and that the Town Engineer hereby requests the Town of Truckee Surveyor to transmit said certificate to the Nevada County Recorder for recordation.

2-25-14
DATE 
Daniel P. Wilkins, Town Engineer
R.C.E. 56267, Renewal Date: 12/31/12

CALIFORNIA ALL-PURPOSE ACKNOWLEDGMENT

Arizona
State of ~~California~~ }
County of ~~Nevada~~
Yavapai

On August 23, 2013 before me, Matthew R. Cartia
personally appeared Scott E. Ritchie

who proved to me on the basis of satisfactory evidence to be the persons(s) whose name(s) is/are subscribed to the within instrument and acknowledged to me that he/she/they executed the same in his/her/their authorized capacity (ies), and that by his/her/their signature(s) on the instrument the person(s), or the entity upon behalf of which the person(s) acted, executed the instrument.

I certify under PENALTY OF PERJURY under the laws of the State of California that the foregoing paragraph is true and correct.

WITNESS my hand and official seal.

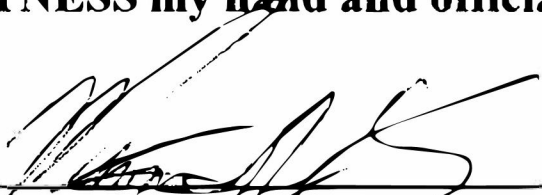
Signature of Notary

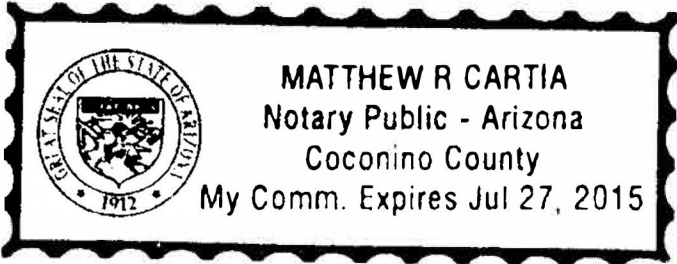

CERTIFICATE OF TOWN SURVEYOR

THIS IS TO CERTIFY that the above certificate of correction has been examined this 20 day of Oct, 2012 for conformance with the requirements of Section 8770.5 of the Land Surveyor's Act and Chapter 3 Article 7, Sections 66469, 66470 and 66472.1 of the subdivision map act.

10/31/12
DATE

John Rietjens
John Rietjens, Town Surveyor
LS4323, License Expires 06/30/14

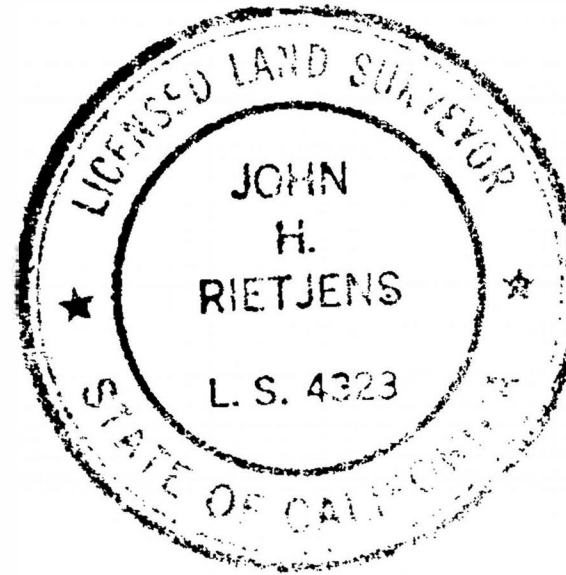

Recording Requested By:
and

Return to: Town of Truckee
Judy Price, Town Clerk
10183 Truckee Airport Road
Truckee CA 96161

Not Subject to Fees: GCS 27383

CERTIFICATE OF CORRECTION
PARCEL MAP 01-076B, PIONEER COMMERCE CENTER PHASE III

NOTICE IS HEREBY GIVEN: That the Parcel Map No. 01-076B, Pioneer Commerce Center Phase III, filed for record on October 20, 2005 in Book 19 of Parcel Maps at Page 175 N.C.R., Nevada County Records, is hereby corrected in accordance with Section 8770.5 of the Professional Land Surveyor's Act and Sections 66469, 66470, and 66472.1 of the Subdivision Map Act as follows:

NOTE 6 ON MAP SHEET 5 OF 5 SHALL BE CORRECTED TO READ:

6. ALL OUTDOOR ACTIVITY, OUTDOOR RETAIL ACTIVITY, EQUIPMENT, MATERIALS, AND VEHICLE STORAGE, SHALL BE PROHIBITED ON THE REAR PORTION OF LOTS 4-9. OUTDOOR STORAGE AND RELATED OUTDOOR USES MAY ONLY BE PERMITTED IN THE FRONT OF BUILDINGS, UNLESS A ZONING CLEARANCE IS APPROVED BY THE PLANNING COMMISSION.

This correction is being made to delete the original Note 6 on Map Sheet 5 of 5 of Parcel Map No. 01-076B, Pioneer Commerce Center Phase III, filed for record on October 20, 2005, and replace it with the corrected note as approved by the Truckee Planning Commission with adoption of Planning Commission Resolution No. 2010-01 on September 8, 2010.

The present fee owners of real property affected by such corrections are:

Gregory F. Hovorka, Lot 4, APN 19-920-05
Aaron Jensen and Simone Jensen, Lot 5, APN 19-920-06
Jeremy Jones and Tiffany Jones, Lot 6, APN 19-920-07
Ritchie S E Corp, Lot 7, APN 19-920-08
Ryan R. Holland and Judy A. Holland, Lot 8, APN 19-920-09
Angel Food Land LLC, Lot 9, APN 19-920-10

The fee owner at the time of recordation of Parcel Map was Pendrell Truckee, LLC, A California Limited Liability Company and Hidden Lake Properties, Inc., A California Corporation.

CERTIFICATE OF SURVEYOR

THIS IS TO CERTIFY that the above certificate of correction was prepared by or under the direction and control of the undersigned registered land surveyor.

Nov 5, 2013
DATE

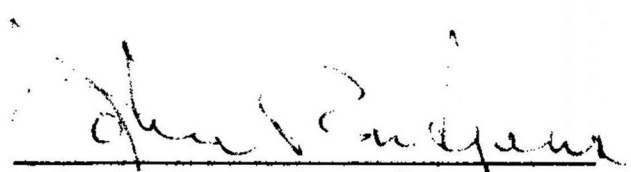
John Rietjens, Town Surveyor
LS4323, License Expires 06/30/14

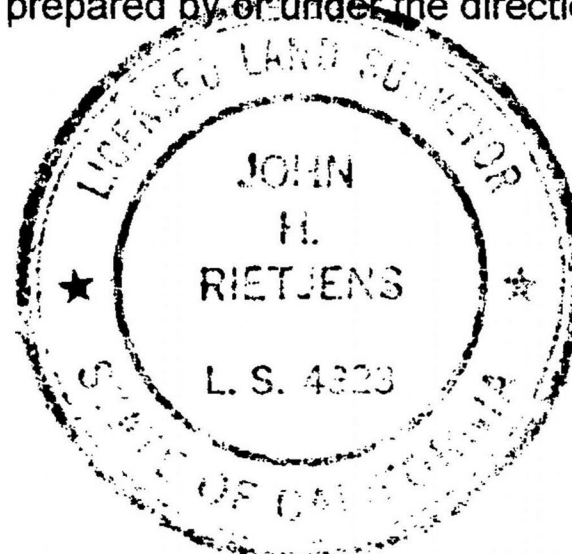

CERTIFICATE OF OWNER

THIS IS TO CERTIFY that undersigned owners of record title interest hereby consent to the above certificate of correction:

DATE Gregory F. Hovorka

DATE Aaron Jensen

DATE Simone Jensen

DATE Jeremy Jones

DATE Tiffany Jones

DATE Ritchie S E Corp
Scott Ritchie

10-30-2013

DATE Ryan R. Holland

10-30-2013 Judy A. Holland
DATE Judy A. Holland

DATE Angel Food Land LLC
Dave Wayda

CERTIFICATE OF TOWN ENGINEER

THIS IS TO CERTIFY that the above Certificate of Correction was approved by the Town Engineer and that the Town Engineer hereby requests the Town of Truckee Surveyor to transmit said certificate to the Nevada County Recorder for recordation.

2-25-14

DATE

Daniel P. Wilkins
Daniel P. Wilkins, Town Engineer
R.C.E. 56267, Renewal Date: 12/31/12

CALIFORNIA ALL-PURPOSE ACKNOWLEDGMENT

State of California }
County of Nevada }

On 10-30-13 before me, Shanna D. Kuhlemier, Notary Public
personally appeared Judy Holland

who proved to me on the basis of satisfactory evidence to be the person(s) whose name(s) is/are subscribed to the within instrument and acknowledged to me that he/she/they executed the same in his/her/their authorized capacity (ies), and that by his/her/their signature(s) on the instrument the person(s), or the entity upon behalf of which the person(s) acted, executed the instrument.

I certify under PENALTY OF PERJURY under the laws of the State of California that the foregoing paragraph is true and correct.

WITNESS my hand and official seal.

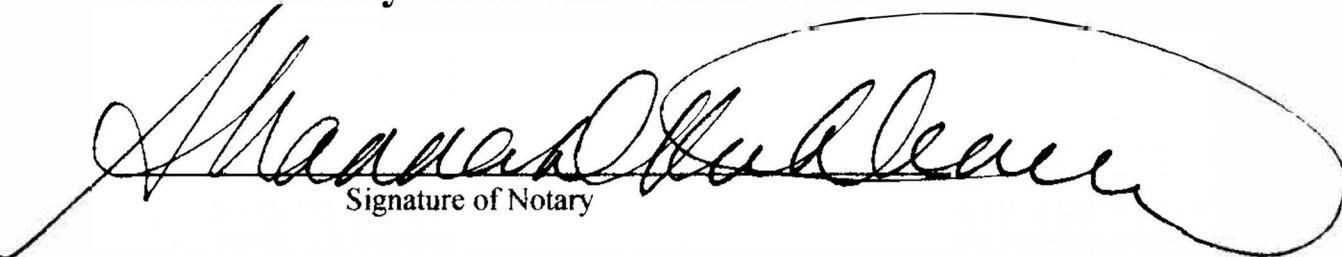
Signature of Notary



CALIFORNIA ALL-PURPOSE ACKNOWLEDGMENT

State of California }
 County of Nevada }

On 10-30-13 before me Shanna D. Kuhlemier, Notary Public
 personally appeared Ryan L. Hilland

who proved to me on the basis of satisfactory evidence to be the persons(~~s~~) whose name(~~s~~) is/~~are~~ subscribed to the within instrument and acknowledged to me that he/~~she~~/~~they~~ executed the same in his/~~her~~/~~their~~ authorized capacity (~~ies~~), and that by his/~~her~~/~~their~~ signature(~~s~~) on the instrument the person(~~s~~), or the entity upon behalf of which the person(~~s~~) acted, executed the instrument.

I certify under PENALTY OF PERJURY under the laws of the State of California that the foregoing paragraph is true and correct.

WITNESS my hand and official seal.

Shanna D. Kuhlemier
 Signature of Notary

