

# **Capital Improvement Projects Advisory Committee Impact Fee & Project Update**

**June 13, 2022**



# Agenda

- Impact Fees
  - Current Rate Structure
  - Impact Fees Collected to Date
  - Impact Fee Fund Balances
- Capital Improvement Projects
  - Overview & Status of Impact Fee, Bond and Grant Funded Projects



# Current Impact Fees

## BUILDING PERMIT FEES

### IMPACT FEES PER CITY OF TOMBALL ORDINANCE NO. 2019-24 Effective October 1, 2021 – September 30, 2022\*

<u>LUE'S</u>	<u>WATER</u> <u>METER SIZE</u>	<u>WATER</u>	<u>SEWER</u>	<u>TOTAL</u>
1.0	3/4"	\$ 3,372.64	\$2,521.00	\$ 5,893.64
2.5	1"	\$ 5,632.31	\$4,210.07	\$ 9,842.38
5.0	1 1/2"	\$ 11,230.89	\$8,394.93	\$ 19,625.82
8.0	2"	\$ 17,976.17	\$13,436.93	\$ 31,413.10
16.0	3"	\$ 39,358.71	\$29,420.07	\$ 68,778.78
25.0	4"	\$ 67,452.80	\$50,420.00	\$117,872.80
50.0	6"	\$151,768.80	\$113,445.00	\$265,213.80
80.0	8"	\$179,862.89	\$134,444.93	\$314,307.82

Drainage effective August 18, 2014:

M118 per acre	\$5,757.81
M121E per acre	\$7,886.69
M121W per acre	\$6,692.00
M125 per acre	\$ 436.88



# Impact Fees Collected

Fiscal Year	New Residential	New Commercial	Water	Sanitary Sewer	Drainage
2018/2019	77	22	\$362,000	\$361,000	\$192,000
2019/2020	231	19	\$726,000	\$658,000	\$358,000
2020/2021	474	14	\$1,571,435	\$1,306,859	\$387,132
2021/2022 (as of 5/31/2022)	261	21	\$1,040,849	\$816,081	\$249,159



# Impact Fee Fund Balances

- Fund Balances (as of June 1, 2022)

Water	Sanitary Sewer	Drainage
\$5,201,922	\$4,165,645	\$249,159



# Current Projects



# Medical Complex Dr. Extension Segment 4



## Description:

Segment 4 of the proposed Medical Complex Corridor commences at Cherry Street and continues easterly to South Persimmon and ends at Hufsmith-Kohrville as well as from South Persimmon to the Project includes extending City utilities and drainage in the ROW.

## Progress:

Construction is approximately 95% complete. The signal light will be energized and road opened once the substantial walkthrough is completed.



# Mulberry & Agg Drainage Improvements

## **Description:**

The City has design plans from Odyssey Engineering for the construction of drainage improvements along Mulberry and Agg.

## **Progress:**

Construction was completed in February 2022 with all improvements and maintenance accepted by the City. We are currently within our one-year maintenance bond period.





# Jerry Matheson Park Revitalization

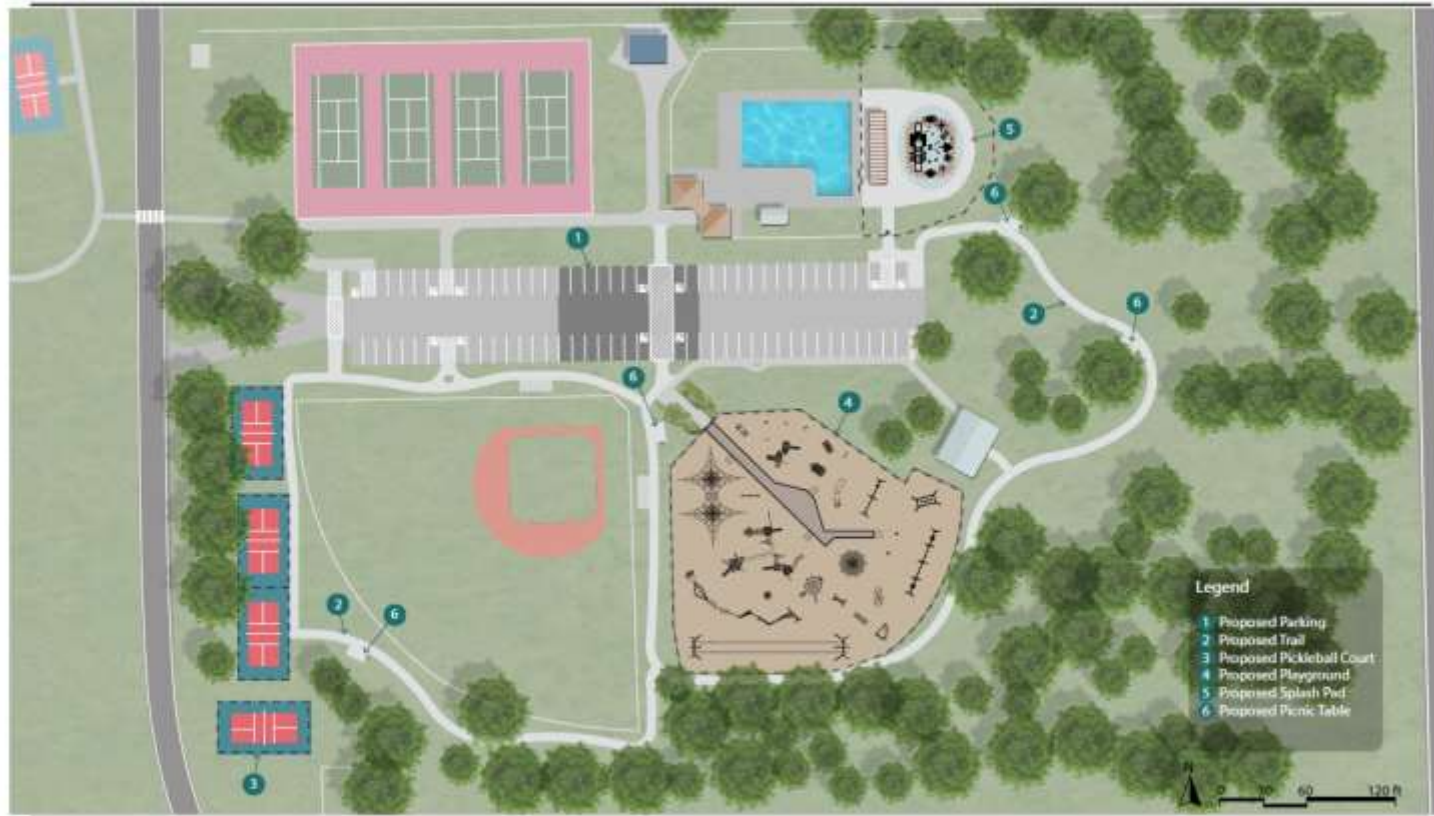

October 2020  
Conceptual Master Plan

Matheson Park  
City of Tomball



# Jerry Matheson Park Revitalization

## Description:

The City will be completing a revitalization of Jerry Matheson Park to include the installation of Pickleball Courts, a splashpad with features, walking trail and new playground equipment. Additionally, maintenance will be completed on the existing pool baseball field and tennis courts.

The City has been selected to receive a grant from Texas Parks and Wildlife for \$750,000 to assist in the completion of the revitalization

- Additional funding sources include: Tomball Economic Development Corporation, Tomball Regional Health Foundation & HCA-Tomball



# Jerry Matheson Park Revitalization

## Progress:

City is still awaiting the contract from TPWD before we can begin any construction activities.

- Staff is currently working to develop the design of the Splashpad.
- Playground equipment has been ordered and is pending installation once the contract is received.
- Staff has been working with the design consultant to finalize the overall plan of the park for submission to TPWD for final approval.



# Elevated Storage Tank – Lovett Industrial

- Description:
  - As agreed upon in the Development Agreement for Lovett Industrial, the City will construct a 1.0MG Elevated Storage Tank (EST) and approximately 500LF of 16-inch water line to connect the existing 12-inch line near the site location
    - Staff is currently working with the design consultant for the design and specifications of the tank and water line extension
  - The Development Agreement does call for 50% cost sharing of all cost associated with the design and construction of the EST.



# Questions?

