



CITY OF SWEENEY

Rev. 03/2025

102 W. Ashley Wilson Rd. • PO Box 248 • Sweeny, Texas 77480 • P: (979) 548-3321

Zoning and/or Variance Application

Please complete each field. Incomplete applications will **not** be accepted.

TYPE OF APPLICATION:

- Zoning Change (from zone) _____ (to zone) _____
- Variance Request to P & Z Exhibit, Section § _____
- Variance Request to Ordinance, Section § _____
- Re-Plat Type: _____

*Plat Types include: Amending, Replats, Combination, Subdivide, Subdivision, Preliminary, Final

**Re-plats/Mylars can only be accepted the 1st thru the 5th business day of each month to comply with HB 3167.

PROJECT INFORMATION:

- Residential
 - Commercial
 - Survey attached?
 - Drawing attached?
- Project Name/Owners Name: Ruben Renobato
 Brazoria County Appraisal District Property ID # 250619
 Project Address/Location: Travis Avenue
 Subdivision: Sutherland Addition No. of Lots: # 44
 Total Acreage &/or Square Footage: 6250

(Any additional supporting information can be submitted and attached with this request.)

Brief Description of Property & Reason for Proposed Request:

50' X 125' Vacant Lot. Flooding due to inadequate drainage.

Administration and/or their designee reserves the right to delay the item to the following regularly scheduled meeting if it is determined that more time is needed in order to compile information specific to the request.

PROPERTY OWNER'S INFORMATION:

Name: Ruben Renobato
 Mailing Address: _____
 City: Freeport State: Tx Zip: 77541
 Phone: _____
 Email: _____

APPLICANT OR AGENT'S INFORMATION:

Name: _____
 Mailing Address: _____
 City: _____ State: _____ Zip: _____
 Phone: _____
 Email: _____

**Property owner must be the current owner of the property at the time of submittal of the application, and not the party that has the property under contract.

As owner and applicant, I hereby request approval of the above described request as provided for by The City of Sweeny.

Zoning Change Requests are charged an advertisement fee per the official newspaper rate plus a \$20.00 administrative fee. Additional fees assessed for additional pages and/or additional administrative duties required. Current advertisement rates start at \$265.00. Any advertisement rate completed that is over the current minimum rate will be invoiced to the requestor. All zone change requests are subject to the discretion of the P&Z Board of Commissions and City Council.

Replats and variances are \$50.00 each. Re-plat and variance requests are not a guaranteed approval. All replats and variance requests are at the discretion of the City Council.

**Owner's Signature: Ruben Renobato Date: 3-5-26

Agent's/Applicant's Signature: _____ Date: _____

Fees Paid: _____ General Receipt No. _____ Date: _____

OFFICE USE ONLY:

Date Received: _____ Amount Collected: _____ City Representative: _____

MY NAME IS RUBEN RENOBATO, I OWN LOT 44 , SOUTHEND ADDITION SUBDIVISION ON TRAVIS AVENUE. LOT 44 IS LOCATED IN RESIDENTIAL ZONING DISTRICT R – 2B.

CITY OF SWEENEY BUILDING CODE ORDINANCE SECTION 110.69.2 – STATES SINGLE FAMILY RESIDENCE LOTS PLATTED PRIOR TO THE DATE OF THE ORDINANCE, “THE FOLLOWING REGULATIONS SHALL BE APPLICABLE:

ONE FAMILY DEWELLING

MINIMUM LOT AREA: 5000 SF

MINIMUM LIVING AREA: 800 SF

MINIMUM PERCENTAGE OF LOT TO BE USED FOR BUILDING: 45%

MAXIMUM HEIGHT OF BUILDING: 2 ½ STORIES OR 35 FEET

MINIMUM FRONTAGE OF LOT: 50 FEET

MINIMUM LOT DEPTH: 80 FEET

MINIMUM YARD SETBACKS: FRONT 15 FEET, SIDES 5 FEET, REAR 15 FEET

MINIMUM OFF STREET PARKING: 400 SF

PER CITY RESIDENTIAL BUILDING CODE 153.26 – NEW CONSTRUCTION AND SUBSTANTIAL IMPROVEMENT OF ANY RESIDENTIAL STRUCTURE SHALL HAVE THE LOWEST FLOOR ELEVATED 24 INCHES ABOVE THE BASE FLOOD ELEVATION AS PER FEMA AND BRAZORIA COUNTY FLOODPLAIN MANAGEMENT.

MY PROPERTY IS NOT IN A FLOOD ZONE AND IS NOT IN A DESIGNATED FLOOR HAZARD AREA. THERE IS A DRAINAGE DITCH IN FRONT OF MY PROPERTY. THE DRAINAGE DITCH TERMINATES 142 FEET FROM MY PROPERTY AT THE ST. L.B.M. RAILROAD TRACK AND THE REAR OF MY PROPERTY IS 20 FEET FROM THE ST. L.B.M. RAILROAD TRACK. THE RAILROAD TRACK IS A PROBLEM TO ADEQUATE DRAINAGE OF MY PROPERTY.

DURING HEAVY RAINS THE WATER IN THE DRAINAGE DITCH BACKS UP AND WATER OVERFLOWS AND STANDS ON MY PROPERTY. DUE TO THIS ENVIRONMENTAL CIRCUMSTANCE UNIQUE TO MY PROPERTY, I AM ASKING FOR A VARIANCE OF ZONING CODE 151.02 – MOBILE HOME PROHIBITED.

A PERMANENT RESIDENTIAL FOUNDATION WILL CAUSE UNDUE HARDHIP IN THE USE AND DEVELOPMENT OF MY PROPERTY. A PORTABLE STRUCTURE THAT CAN BE MOVED WITH ADEQUATE NOTICE DURING A CRISIS, IS A VIABLE SOLUTION ,AS OPPOSED TO LOT BUILD UP AND PERMANENT FOUNDATION BUILD UP.

PORTABLE STRUCTURES INCLUDE TINY HOUSES, TRAVEL TRAILERS, PARK MODEL HOMES, AND MOBILE HOMES.

MY NEIGHBOR WHO OWNS LOTS 45, 46, 47 HAS VOICED HIS CONCERN REGARDING THE CIRCUMSTANCE OF INADVERTINGLY REDIRECTING WATER OVER FLOW UNTO HIS PROPERTY WHICH HAS A BRICK HOME.

I RESPECTFULLY ASK YOUR CONSIDERATION



CITY OF SWEENY

Rev. 0 (4/2/2020)

102 W. Ashley Wilson Rd. • PO Box 248 • Sweeny, Texas 77480 • P: (979) 548-3321 • F: (979) 548-7745

Zoning Application

Please complete each field. Incomplete applications will **not** be accepted.

TYPE OF APPLICATION:

- Zoning Change (from) _____ (to) _____ *Plat Types include: Amending, Replat, Finals
- P & Z Variance
- Special Exception
- Re-Plat Type: _____ * All plats require an agenda request

PROJECT INFORMATION:

- Residential
- Commercial

Project Name/Owners Name: Ruben Renobato
 Brazoria County Appraisal District Property ID # 250619
 Project Address/Location: Travis Avenue
 Subdivision: Southend Addition No. of Lots: #44
 Total Acreage &/or Square Footage: 6250

Brief Description of Property & Reason for Proposed Request:

50' x 125' Vacant Lot. Flooding due to inadequate drainage

When a completed application packet/package has been accepted and reviewed, additional information may be required by staff as a result of the review, therefore it may be necessary to postpone the proposed project and remove it from the scheduled agenda and place it on a future agenda. Zoning Changes are charged an advertisement fee of \$250.00 + an administrative fee of \$15.00 for a total of \$265.00. Additional fees assessed for additional pages. Re-plats/Mylars can only be accepted the 1st thru the 5th business day of the each month.

PROPERTY OWNER'S INFORMATION:

Name: Ruben Renobato
 Address: [REDACTED]
 City: Freeport State: Tx Zip: 77541
 Phone: [REDACTED]
 Email: [REDACTED]

APPLICANT OR AGENT'S INFORMATION:

Name: _____
 Address: _____
 City: _____ State: _____ Zip: _____
 Phone: _____ Fax: _____
 Email: _____

**Property owner must be the current owner of the property at the time of submittal of the application, and not the party that has the property under contract.

As owner and applicant, I hereby request approval of the above described request as provided for by The City of Sweeny.

**Owner's Signature: Ruben Renobato Date: 3-5-26

Agent's/Applicant's Signature: _____ Date: _____

OFFICE USE ONLY:

Date Received: 3/5/26 Amount Collected: \$50.00 City Representative: SM

0

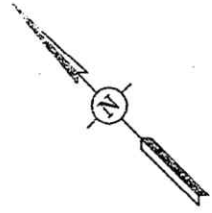

my

ST. L.B.&M. RAILROAD

SOUTHWESTERN BELL COMPANY EASEMENT
VOLUME 434, PAGE 327 DEED RECORDS

LOT 1
VOLUME 1763 PAGE 363
DEED RECORDS

LOT 45
VOLUME 1128, PAGE 141
DEED RECORDS

LOT 44

LOT 43
VOLUME 567, PAGE 753
DEED RECORDS

LOT 42

LOT 41

1-1/2" IRON PIPE
1/2" IRON ROD
S 45° 00' E
50.00'
FOUND 1/2" IRON ROD

0.67'
30.09' 30.41' 30.30'
FOUND 1/2" IRON ROD

N 45° 00' E 125.00'
S 45° 00' W 125.00'

FOUND 1/2" IRON ROD
4.12'
FOUND 1" IRON PIPE BENT
N 45° 00' W
28.68' 50.00' 28.60'
REFERENCE BEARING

FOUND 1/2" IRON ROD

3/4" IRON PIPE

31.01'CL 30.94'CL
T R A V I S A V E N U E

60' RIGHT OF WAY
VOLUME 6, PAGE 24 PLAT RECORDS

60'

ELEVATION CERTIFICATE

IMPORTANT: MUST FOLLOW THE INSTRUCTIONS ON INSTRUCTION PAGES 1-11

Copy all pages of this Elevation Certificate and all attachments for (1) community official, (2) insurance agent/company, and (3) building owner.

SECTION A – PROPERTY INFORMATION

FOR INSURANCE COMPANY USE

A1. Building Owner's Name: Ruben Renobato 4t 27,287A.ei

Policy Number: _____

A2. Building Street Address (including Apt., Unit, Suite, and/or Bldg. No.) or P.O. Route and Box No.
Travis Avenue

Company NAIC Number: _____

City: Sweeny State: TX ZIP Code: 77480

A3. Property Description (e.g., Lot and Block Numbers or Legal Description) and/or Tax Parcel Number:
Lot 44, Southend Addition

A4. Building Use (e.g., Residential, Non-Residential, Addition, Accessory, etc.): Proposed

A5. Latitude/Longitude: Lat. 29.036317deg Long. 95.703317deg Horiz. Datum: NAD 1927 NAD 1983 WGS 84

A6. Attach at least two and when possible four clear color photographs (one for each side) of the building (see Form pages 7 and 8).

A7. Building Diagram Number: _____

A8. For a building with a crawlspace or enclosure(s):

a) Square footage of crawlspace or enclosure(s): _____ sq. ft.

b) Is there at least one permanent flood opening on two different sides of each enclosed area? Yes No N/A

c) Enter number of permanent flood openings in the crawlspace or enclosure(s) within 1.0 foot above adjacent grade:
Non-engineered flood openings: _____ Engineered flood openings: _____

d) Total net open area of non-engineered flood openings in A8.c: _____ sq. in.

e) Total rated area of engineered flood openings in A8.c (attach documentation – see Instructions): _____ sq. ft.

f) Sum of A8.d and A8.e rated area (if applicable – see Instructions): _____ sq. ft.

A9. For a building with an attached garage:

a) Square footage of attached garage: _____ sq. ft.

b) Is there at least one permanent flood opening on two different sides of the attached garage? Yes No N/A

c) Enter number of permanent flood openings in the attached garage within 1.0 foot above adjacent grade:
Non-engineered flood openings: _____ Engineered flood openings: _____

d) Total net open area of non-engineered flood openings in A9.c: _____ sq. in.

e) Total rated area of engineered flood openings in A9.c (attach documentation – see Instructions): _____ sq. ft.

f) Sum of A9.d and A9.e rated area (if applicable – see Instructions): _____ sq. ft.

SECTION B – FLOOD INSURANCE RATE MAP (FIRM) INFORMATION

B1.a. NFIP Community Name: City of Sweeny B1.b. NFIP Community Identification Number: 485512

B2. County Name: Brazoria B3. State: TX B4. Map/Panel No.: 48039C / 0565 B5. Suffix: K

B6. FIRM Index Date: 12-30-2020 B7. FIRM Panel Effective/Revised Date: 12-30-2020

B8. Flood Zone(s): X B9. Base Flood Elevation(s) (BFE) (Zone AO, use Base Flood Depth): +2' over NG

B10. Indicate the source of the BFE data or Base Flood Depth entered in Item B9:

FIS FIRM Community Determined Other: _____

B11. Indicate elevation datum used for BFE in Item B9: NGVD 1929 NAVD 1988 Other/Source: _____

B12. Is the building located in a Coastal Barrier Resources System (CBRS) area or Otherwise Protected Area (OPA)? Yes No
Designation _____ CBRS OPA

B13. Is the building located seaward of the Limit of Moderate Wave Action (LIMWA)? Yes No

ELEVATION CERTIFICATE

IMPORTANT: MUST FOLLOW THE INSTRUCTIONS ON INSTRUCTION PAGES 1-11

Building Street Address (including Apt., Unit, Suite, and/or Bldg. No.) or P.O. Route and Box No.:

Travis Avenue

City: Sweeny

State: TX

ZIP Code: 77480

FOR INSURANCE COMPANY USE

Policy Number: _____

Company NAIC Number: _____

SECTION C – BUILDING ELEVATION INFORMATION (SURVEY REQUIRED)

C1. Building elevations are based on: Construction Drawings* Building Under Construction* Finished Construction
 *A new Elevation Certificate will be required when construction of the building is complete.

C2. Elevations – Zones A1–A30, AE, AH, AO, A (with BFE), VE, V1–V30, V (with BFE), AR, AR/A, AR/AE, AR/A1–A30, AR/AH, AR/AO, A99. Complete Items C2.a–h below according to the Building Diagram specified in Item A7. In Puerto Rico only, enter meters.

Benchmark Utilized: NGS D-52

Vertical Datum: NAVD 1988

Indicate elevation datum used for the elevations in items a) through h) below.

NGVD 1929

NAVD 1988

Other: _____

Datum used for building elevations must be the same as that used for the BFE. Conversion factor used?

Yes No

If Yes, describe the source of the conversion factor in the Section D Comments area.

Check the measurement used:

a) Top of bottom floor (including basement, crawlspace, or enclosure floor): _____

feet meters

b) Top of the next higher floor (see Instructions): _____

feet meters

c) Bottom of the lowest horizontal structural member (see Instructions): _____

feet meters

d) Attached garage (top of slab): _____

feet meters

e) Lowest elevation of Machinery and Equipment (M&E) servicing the building (describe type of M&E and location in Section D Comments area): _____

feet meters

f) Lowest Adjacent Grade (LAG) next to building: Natural Finished 30.2

feet meters

g) Highest Adjacent Grade (HAG) next to building: Natural Finished 30.9

feet meters

h) Finished LAG at lowest elevation of attached deck or stairs, including structural support: _____

feet meters

SECTION D – SURVEYOR, ENGINEER, OR ARCHITECT CERTIFICATION

This certification is to be signed and sealed by a land surveyor, engineer, or architect authorized by state law to certify elevation information. I certify that the information on this Certificate represents my best efforts to interpret the data available. I understand that any false statement may be punishable by fine or imprisonment under 18 U.S. Code, Section 1001.

Were latitude and longitude in Section A provided by a licensed land surveyor? Yes No

Check here if attachments and describe in the Comments area.

Certifier's Name: Randy L. Stroud

License Number: 2112

Title: Registered Professional Land Surveyor

Company Name: Randy L. Stroud, P.E.

Address: 201 South Velasco

City: Angleton

State: TX

ZIP Code: 77480

Telephone: 9798493141

Ext.: _____

Email: r_stroud@sbcglobal.net

Randy L. Stroud

Date: 3-5-2024

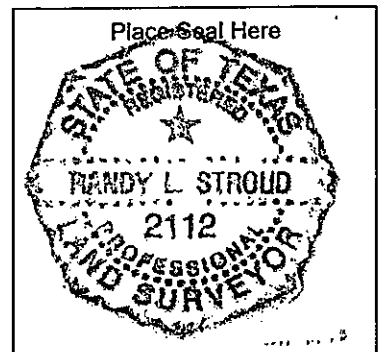

Copy all pages of this Elevation Certificate and all attachments for (1) community official, (2) insurance agent/company, and (3) building owner.

Comments (including source of conversion factor in C2; type of equipment and location per C2.e; and description of any attachments):
 For a benchmark we set a 60d nail in a 40" diameter Oak tree near the Southwest corner of the lot. The elevation of the nail is 32.9' which is 2 feet above high natural ground.

ELEVATION CERTIFICATE

IMPORTANT: MUST FOLLOW THE INSTRUCTIONS ON INSTRUCTION PAGES 1-11

Building Street Address (including Apt., Unit, Suite, and/or Bldg. No.) or P.O. Route and Box No.: <u>Travis Avenue</u>	FOR INSURANCE COMPANY USE
City: <u>Sweeny</u> State: <u>TX</u> ZIP Code: <u>77480</u>	Policy Number: _____ Company NAIC Number: _____

SECTION E – BUILDING MEASUREMENT INFORMATION (SURVEY NOT REQUIRED) FOR ZONE AO, ZONE AR/AO, AND ZONE A (WITHOUT BFE)

For Zones AO, AR/AO, and A (without BFE), complete Items E1–E5. For Items E1–E4, use natural grade, if available. If the Certificate is intended to support a Letter of Map Change request, complete Sections A, B, and C. Check the measurement used. In Puerto Rico only, enter meters.

Building measurements are based on: Construction Drawings* Building Under Construction* Finished Construction
 *A new Elevation Certificate will be required when construction of the building is complete.

E1. Provide measurements (C.2.a in applicable Building Diagram) for the following and check the appropriate boxes to show whether the measurement is above or below the natural HAG and the LAG.

a) Top of bottom floor (including basement, crawlspace, or enclosure) is: _____ feet meters above or below the HAG.

b) Top of bottom floor (including basement, crawlspace, or enclosure) is: _____ feet meters above or below the LAG.

E2. For Building Diagrams 6–9 with permanent flood openings provided in Section A Items 8 and/or 9 (see pages 1–2 of Instructions), the next higher floor (C2.b in applicable Building Diagram) of the building is: _____ feet meters above or below the HAG.

E3. Attached garage (top of slab) is: _____ feet meters above or below the HAG.

E4. Top of platform of machinery and/or equipment servicing the building is: _____ feet meters above or below the HAG.

E5. Zone AO only: If no flood depth number is available, is the top of the bottom floor elevated in accordance with the community's floodplain management ordinance? Yes No Unknown The local official must certify this information in Section G.

SECTION F – PROPERTY OWNER (OR OWNER'S AUTHORIZED REPRESENTATIVE) CERTIFICATION

The property owner or owner's authorized representative who completes Sections A, B, and E for Zone A (without BFE) or Zone AO must sign here. *The statements in Sections A, B, and E are correct to the best of my knowledge*

Check here if attachments and describe in the Comments area.

Property Owner or Owner's Authorized Representative Name: _____

Address: _____

City: _____ State: _____ ZIP Code: _____

Telephone: _____ Ext.: _____ Email: _____

Date: _____

Comments:

ELEVATION CERTIFICATE

IMPORTANT: MUST FOLLOW THE INSTRUCTIONS ON INSTRUCTION PAGES 1-11

Building Street Address (including Apt., Unit, Suite, and/or Bldg. No.) or P.O. Route and Box No.:

Travis Avenue

City: Sweeny

State: TX

ZIP Code: 77480

FOR INSURANCE COMPANY USE

Policy Number: _____

Company NAIC Number: _____

SECTION G – COMMUNITY INFORMATION (RECOMMENDED FOR COMMUNITY OFFICIAL COMPLETION)

The local official who is authorized by law or ordinance to administer the community's floodplain management ordinance can complete Section A, B, C, E, G, or H of this Elevation Certificate. Complete the applicable item(s) and sign below when:

- G1. The information in Section C was taken from other documentation that has been signed and sealed by a licensed surveyor, engineer, or architect who is authorized by state law to certify elevation information. (Indicate the source and date of the elevation data in the Comments area below.)
- G2.a. A local official completed Section E for a building located in Zone A (without a BFE), Zone AO, or Zone AR/AO, or when item E5 is completed for a building located in Zone AO.
- G2.b. A local official completed Section H for insurance purposes.
- G3. In the Comments area of Section G, the local official describes specific corrections to the information in Sections A, B, E and H.
- G4. The following information (Items G5–G11) is provided for community floodplain management purposes.
- G5. Permit Number: _____ G6. Date Permit Issued: _____
- G7. Date Certificate of Compliance/Occupancy Issued: _____
- G8. This permit has been issued for: New Construction Substantial Improvement
- G9.a. Elevation of as-built lowest floor (including basement) of the building: _____ feet meters Datum: _____
- G9.b. Elevation of bottom of as-built lowest horizontal structural member: _____ feet meters Datum: _____
- G10.a. BFE (or depth in Zone AO) of flooding at the building site: _____ feet meters Datum: _____
- G10.b. Community's minimum elevation (or depth in Zone AO) requirement for the lowest floor or lowest horizontal structural member: _____ feet meters Datum: _____
- G11. Variance issued? Yes No If yes, attach documentation and describe in the Comments area.

The local official who provides information in Section G must sign here. *I have completed the information in Section G and certify that it is correct to the best of my knowledge. If applicable, I have also provided specific corrections in the Comments area of this section.*

Local Official's Name: _____ Title: _____

NFIP Community Name: _____

Telephone: _____ Ext.: _____ Email: _____

Address: _____

City: _____ State: _____ ZIP Code: _____

Date: _____

Comments (including type of equipment and location, per C2.e; description of any attachments; and corrections to specific information in Sections A, B, D, E, or H):

Building Street Address (including Apt., Unit, Suite, and/or Bldg. No.) or P.O. Route and Box No.: <u>Travis Avenue</u>	FOR INSURANCE COMPANY USE
City: <u>Sweeny</u> State: <u>TX</u> ZIP Code: <u>77480</u>	Policy Number: _____ Company NAIC Number: _____

**SECTION H – BUILDING'S FIRST FLOOR HEIGHT INFORMATION FOR ALL ZONES
(SURVEY NOT REQUIRED) (FOR INSURANCE PURPOSES ONLY)**

The property owner, owner's authorized representative, or local floodplain management official may complete Section H for all flood zones to determine the building's first floor height for insurance purposes. Sections A, B, and I must also be completed. Enter heights to the nearest tenth of a foot (nearest tenth of a meter in Puerto Rico). *Reference the Foundation Type Diagrams (at the end of Section H Instructions) and the appropriate Building Diagrams (at the end of Section I Instructions) to complete this section.*

H1. Provide the height of the top of the floor (as indicated in Foundation Type Diagrams) above the Lowest Adjacent Grade (LAG):

a) For Building Diagrams 1A, 1B, 3, and 5–8. Top of bottom _____ feet meters above the LAG floor (include above-grade floors only for buildings with crawlspaces or enclosure floors) is:

b) For Building Diagrams 2A, 2B, 4, and 6–9. Top of next higher floor (i.e., the floor above basement, crawlspace, or enclosure floor) is: _____ feet meters above the LAG

H2. Is all Machinery and Equipment servicing the building (as listed in Item H2 Instructions) elevated to or above the floor indicated by the H2 arrow (shown in the Foundation Type Diagrams at end of Section H instructions) for the appropriate Building Diagram?

Yes No

SECTION I – PROPERTY OWNER (OR OWNER'S AUTHORIZED REPRESENTATIVE) CERTIFICATION

The property owner or owner's authorized representative who completes Sections A, B, and H must sign here. *The statements in Sections A, B, and H are correct to the best of my knowledge. Note: If the local floodplain management official completed Section H, they should indicate in Item G2.b and sign Section G.*

Check here if attachments are provided (including required photos) and describe each attachment in the Comments area.

Property Owner or Owner's Authorized Representative Name: _____

Address: _____

City: _____ State: _____ ZIP Code: _____

Telephone: _____ Ext.: _____ Email: _____

Date: _____

Comments:

ELEVATION CERTIFICATE

IMPORTANT: MUST FOLLOW THE INSTRUCTIONS ON INSTRUCTION PAGES 1-11

BUILDING PHOTOGRAPHS

See Instructions for Item A6.

Building Street Address (Including Apt., Unit, Suite, and/or Bldg. No.) or P.O. Route and Box No.:

Travis Avenue

FOR INSURANCE COMPANY USE

Policy Number: _____

Company NAIC Number: _____

City: Sweeny State: TX ZIP Code: 77480

Instructions: Insert below at least two and when possible four photographs showing each side of the building (for example, may only be able to take front and back pictures of townhouses/rowhouses). Identify all photographs with the date taken and "Front View," "Rear View," "Right Side View," or "Left Side View." Photographs must show the foundation. When flood openings are present, include at least one close-up photograph of representative flood openings or vents, as indicated in Sections A8 and A9.

Photo One

Photo One Caption:

Clear Photo One

Photo Two

Photo Two Caption:

Clear Photo Two

ELEVATION CERTIFICATE
IMPORTANT: MUST FOLLOW THE INSTRUCTIONS ON INSTRUCTION PAGES 1-11
BUILDING PHOTOGRAPHS

Continuation Page

Building Street Address (including Apt., Unit, Suite, and/or Bldg. No.) or P.O. Route and Box No.:

Travis Avenue

FOR INSURANCE COMPANY USE

Policy Number: _____

City: Sweeny State: TX ZIP Code: 77480

Company NAIC Number: _____

Insert the third and fourth photographs below. Identify all photographs with the date taken and "Front View," "Rear View," "Right Side View," or "Left Side View." When flood openings are present, include at least one close-up photograph of representative flood openings or vents, as indicated in Sections A8 and A9.

Photo Three

Photo Three Caption:

Clear Photo Three

Photo Four

Photo Four Caption:

Clear Photo Four

**WEST BRAZORIA COUNTY DRAINAGE DISTRICT
PRE-CONSTRUCTION LETTER OF NO OBJECTION**

PROJECT NAME AND LOCATION: Proposed residence on Lot 44, Southend Subdivision on Travis Avenue in Sweeny..

BRIEF DESCRIPTION OF PROJECT: Single family residence proposed. Lot must be graded so that all drainage will be to Travis Avenue which is the only available drainage...

APPLICANT AND CONTACT INFORMATION (including email): Ruben Renobato

OWNER NAME AND ADDRESS: Same

GENERAL CONDITIONS:

1. Maintenance of all detention facilities and on-site drainage structures and ditches is the responsibility of the owner/operator of the facility.
2. Use of this Letter of No Objection for obtaining construction permits must be exercised within 6 months of the date herein. In order to secure a building permit, submit this letter, along with construction plans to: City of Sweeny

AUTHORIZATION:

Randy L. Stroud, P. E. 50839 Firm No F-572, District Engineer

201 South Velasco
Angleton, TX 77515
979-248-0620

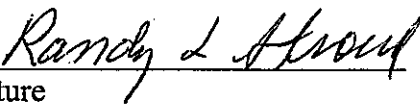
Signature

1-30-2026
Date

COPIES TO:

Applicant- Ruben Renobato
Michael Bendit, District Accountant
Natalie Broaddus, District's Attorney
Section Director- John Richers