



THE CULLIPHER GROUP, P.A.
ENGINEERING & SURVEYING SERVICES

December 3, 2021

Jennifer H. Ansell, CFM, CZO, Planner
Town of Swansboro
601 W. Corbett Avenue
Swansboro, NC 28584

Re: Warranty Opinion- Shipwright Pointe, Section II

Dear Ms. Ansell,

Based on your request, I have reviewed the Cost Opinion for Calculation of Warranty for Shipwright Pointe, Section II. This cost opinion was provided by Parker & Associates dated January 8, 2020. I find that the warranty in the amount of 90,479.23 to be adequate and in accordance with Town requirements.

If I can provide any additional assistance, please let me know.

Sincerely,

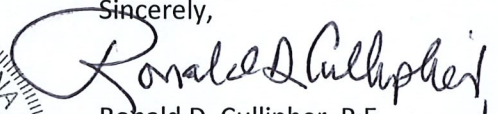

Ronald D. Cullipher, P.E.

12/3/21

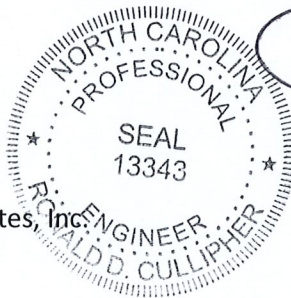

Cc:

Jonathan McDaniel, P.E., Tidewater Associates, Inc.
Jim Stipe, Town of Swansboro

HESTRON PLAZA TWO
151-A NC HWY 24
MOREHEAD CITY, NC 28557
(252) 773-0090



PARKER & ASSOCIATES, INC.
ENGINEERS • SURVEYORS • PLANNERS
JACKSONVILLE, NORTH CAROLINA

**COST OPINION FOR
CALCULATION OF WARRANTY
Shipwright Pointe Phase II
January 8, 2020**

OWNER: A. Sydes Construction, Inc.
P.O. Box 7122
Jacksonville, NC 28540

ENGINEER: Parker & Associates, Inc.
P.O. Box 976
Jacksonville, NC 28541

NOTE 1: The information contained herein represents the Preparers' opinion of the expected cost of construction based on the cost of similar types of work under similar working conditions. It is not an offer to perform the work at the stated prices, nor is it intended to represent more than the Preparers' opinion. The actual cost can be influenced by an infinite number of factors beyond the Preparers' control.

NOTE 2: Unit prices taken from Contract, where practical.

Part A - Public Works- Minus Sidewalks

ITEM	DESCRIPTION	UNIT	QUANTITY	UNIT PRICE	TOTAL
1	12" RCP	LF	393	\$17.00	\$6,681.00
2	15" RCP	LF	549	\$21.00	\$11,529.00
3	18" RCP	LF	1680	\$26.00	\$43,680.00
4	24" RCP	LF	1230	\$41.00	\$50,430.00
5	30" RCP	LF	150	\$46.00	\$6,900.00
6	36" RCP	LF	503	\$50.00	\$25,150.00
7	Yard Inlet	Each	10	\$1,400.00	\$14,000.00
8	Curb Inlet Catch Basin	Each	21	\$1,500.00	\$31,500.00
9	Valley Gutter	LF	135	\$13.00	\$1,755.00
10	24" Curb & Gutter	LF	5440	\$13.00	\$70,720.00
11	6" CABC Stone	SY	8635	\$10.00	\$86,350.00
12	1.5" Asphalt	SY	7422	\$9.90	\$73,477.80
13	Testing	LS	1	\$2,500.00	\$2,500.00
14	Dress up Site	LS	1	\$3,500.00	\$3,500.00
15	Stop Sign	Each	6	\$275.00	\$1,650.00
16	Street Sign	Each	6	\$200.00	\$1,200.00
17	Speed Limit Sign	Each	2	\$200.00	\$400.00
18	Temporary Seeding	Acre	3.5	\$1,200.00	\$4,200.00
19	Swales and Grassing	LF	1650	\$4.25	\$7,012.50
20	Mail Box Kiosk	LS	1	\$15,000.00	\$15,000.00
TOTAL PUBLIC WORKS					<u>\$457,635.30</u>

Part B. Public Utilities

a. Water

ITEM	DESCRIPTION	UNIT	QUANTITY	UNIT PRICE	TOTAL
1	Tie to existing	Each	1	\$2,038.00	\$2,038.00
2	2" Gate Valve	Each	2	\$553.00	\$1,106.00
3	2" Blow Off Assembly	Each	2	\$1,114.00	\$2,228.00
4	2" PVC Water	LF	280	\$5.00	\$1,400.00
5	6" Gate Valve	Each	12	\$903.00	\$10,836.00
6	6" X 6" Tee	Each	2	\$444.00	\$888.00
7	6" PT 2"	Each	2	\$194.00	\$388.00
8	6" 45 Degree Bend	Each	20	\$374.00	\$7,480.00
9	6" Hydrant Assembly	Each	5	\$3,146.00	\$15,730.00
10	6" PVC Water	LF	2096	\$13.00	\$27,248.00
11	6" Ductile Iron	LF	465	\$23.00	\$10,695.00
12	Water Services	Each	43	\$550.00	\$23,650.00
13	Testing	LS	1	\$1,300.00	\$1,300.00
TOTAL WATER					\$104,987.00

b. Sewer

ITEM	DESCRIPTION	UNIT	QUANTITY	UNIT PRICE	TOTAL
1	Tie to Existing (Core Drill)	Each	1	\$376.00	\$376.00
2	Manhole	Each	12	\$2,577.00	\$30,924.00
3	8" SDR35	LF	2515	\$19.00	\$47,785.00
4	8" Ductile Iron	LF	40	\$54.00	\$2,160.00
5	Sewer Trench Stone	Ton	750	\$45.00	\$33,750.00
6	Sewer Services	Each	42	\$427.00	\$17,934.00
7	Pump Station	LS	1	\$169,050.00	\$169,050.00
8	Force Main	LS	1	\$40,191.00	\$40,191.00
TOTAL SEWER					\$342,170.00

TOTAL PUBLIC UTILITIES **\$447,157.00**

TOTAL PROJECT **\$904,792.30**

10% WARRANTY **\$90,479.23**





THE CULLIPHER GROUP, P.A.
ENGINEERING & SURVEYING SERVICES

August 15, 2022

Jennifer H. Ansell, CFM, CZO, Planner
Town of Swansboro
601 W. Corbett Avenue
Swansboro, NC 28584

Re: Warranty Opinion- Shipwright Pointe, Phase II, Portion of Nellie Lane

Dear Ms. Ansell,

Based on your request, I have reviewed the Cost Opinion for Calculation of Warranty for Shipwright Pointe, Section II, portion of Nellie Lane. This cost opinion was provided by Tidewater Associates, Inc dated August 15, 2022. I find that the warranty in the amount of \$3182.50 to be adequate and in accordance with Town requirements.

If I can provide any additional assistance, please let me know.

Sincerely,

Ronald D. Cullipher, P.E.

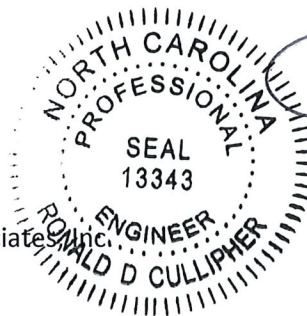

Cc:

Jonathan McDaniel, P.E., Tidewater Associates, Inc.

HESTRON PLAZA TWO
151-A NC HWY 24
MOREHEAD CITY, NC 28557
(252) 773-0090

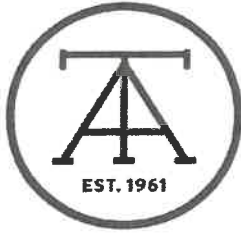

TIDEWATER ASSOCIATES, INC.
ENGINEERS • SURVEYORS • PLANNERS
JACKSONVILLE, NORTH CAROLINA

**COST OPINION FOR
CALCULATION OF WARRANTY
Shipwright Pointe Phase II
August 15, 2022**

OWNER: A. Sydes Construction, Inc.
P.O. Box 7122
Jacksonville, NC 28540

ENGINEER: Tidewater Associates, Inc.
P.O. Box 976
Jacksonville, NC 28541

NOTE 1: The information contained herein represents the Preparers' opinion of the expected cost of construction based on the cost of similar types of work under similar working conditions. It is not an offer to perform the work at the stated prices, nor is it intended to represent more than the Preparers' opinion. The actual cost can be influenced by an infinite number of factors beyond the Preparers' control.

NOTE 2: Unit prices taken from Contract, where practical.

Part A - Public Works (Portion of Nellie Lane)

ITEM	DESCRIPTION	UNIT	QUANTITY	UNIT PRICE	TOTAL
1	Clear and Rough Grade	LS	1	\$2,500.00	\$2,500.00
2	Fine Grade for Asphalt	LS	1	\$1,000.00	\$1,000.00
3	24" Curb & Gutter	LF	400	\$14.00	\$5,600.00
4	6" CABC Stone	SY	780	\$10.00	\$7,800.00
5	1.5" Asphalt	SY	670	\$10.00	\$6,700.00
6	Testing	LS	1	\$1,000.00	\$1,000.00
7	Dress Up Site	LS	1	\$1,000.00	\$1,000.00
8	4' Sidewalk	LF	400	\$14.00	\$5,600.00
9	Permanent Grassing	Acre	0.25	\$2,500.00	\$625.00

TOTAL PUBLIC WORKS **\$31,825.00**

TOTAL PROJECT **\$31,825.00**

10% WARRANTY **\$3,182.50**

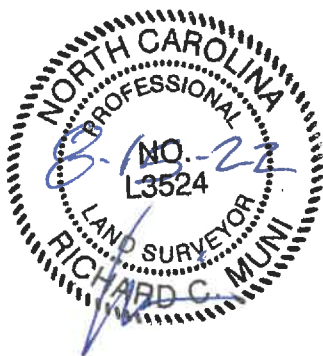

Secretary.C3.2022.Projects.ShipwrightPointeII.CostOpinion..08.12.22