

**JOHN G. CUMMINGS & ASSOCIATES**  
**PROFESSIONAL LAND SURVEYORS IN LOUISIANA & MISSISSIPPI**  
**503 NORTH JEFFERSON AVENUE**  
**COVINGTON, LA 70433**  
**johncummings108@charter.net**  
**(985) 892-1549 OFFICE (985) 892-9250 FAX**

**DESCRIPTION FOR PROPOSED HC-2**

A parcel of land located in Section 25, Township 6 South, Range 10 East, St. Tammany Parish, Louisiana and being more fully described as follows:

Commencing from the Section Corner common to Sections 23, 24, 25 & 26 in said township and range;

Thence South 00 degrees 07 minutes 34 seconds East 2667.84 feet to a point;

Thence South 00 degrees 06 minutes 02 seconds East 1033.28 feet to a point on the North Side of Ronald Reagan Highway (A.K.A. U. S. Highway No. 190);

Thence South 85 degrees 24 minutes 42 seconds East 1911.76 feet along the North Side of said Highway to the **Point of Beginning**,

Thence North 04 degrees 35 minutes 18 seconds East 500.0 feet to a point;

Thence South 85 degrees 14 minutes 56 seconds East 730.93 feet to a point;

Thence South 00 degrees 38 minutes 01 second East 500.0 feet to a point on the North Side of Ronald Reagan Highway (A.K.A. U. S. Highway No. 190);

Thence North 85 degrees 24 minutes 42 seconds West 776.44 feet along the North Side of said Highway to the **Point of Beginning**, containing 8.633 Acres.

  
John G. Cummings, P.L.S.

22022-D4

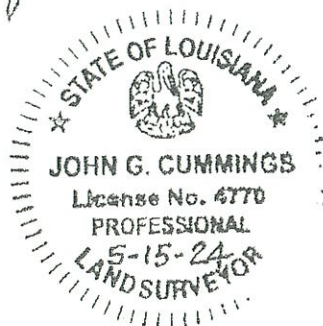

**JOHN G. CUMMINGS & ASSOCIATES**  
**PROFESSIONAL LAND SURVEYORS IN LOUISIANA & MISSISSIPPI**  
**503 NORTH JEFFERSON AVENUE**  
**COVINGTON, LA 70433**  
**johncumplings108@charter.net**  
**(985) 892-1549 OFFICE** **(985) 892-9250 FAX**

**DESCRIPTION FOR PROPOSED NC-4**

A parcel of land located in Section 25, Township 6 South, Range 10 East, St. Tammany Parish, Louisiana and being more fully described as follows:

Commencing from the Section Corner common to Sections 23, 24, 25 & 26 in said township and range;  
Thence South 00 degrees 07 minutes 34 seconds East 2667.84 feet to a point;  
Thence South 00 degrees 06 minutes 02 seconds East 1033.28 feet to a point on the North Side of Ronald Reagan Highway (A.K.A. U. S. Highway No. 190);  
Thence South 85 degrees 24 minutes 42 seconds East 100.34 feet along the North Side of said Highway to the **Point of Beginning**,

Thence North 00 degrees 06 minutes 02 seconds West 500.0 feet to a point;  
Thence South 85 degrees 41 minutes 19 seconds East 344.63 feet to a point on the West Side of Pruden Road;  
Thence South 04 degrees 17 minutes 11 seconds West 500.0 feet along the West Side of Pruden Road to a point on the North Side of Ronald Reagan Highway (A.K.A. U. S. Highway No. 190);  
Thence North 85 degrees 24 minutes 42 seconds West 306.39 feet along the North Side of said Highway to the **Point of Beginning**, containing 3.730 Acres.

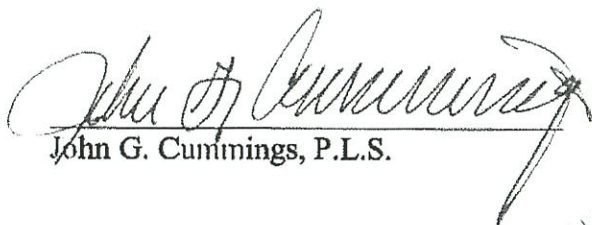
  
John G. Cummings, P.L.S.

22022-D1

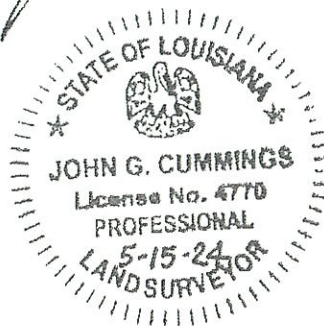

**JOHN G. CUMMINGS & ASSOCIATES**  
**PROFESSIONAL LAND SURVEYORS IN LOUISIANA & MISSISSIPPI**  
**503 NORTH JEFFERSON AVENUE**  
**COVINGTON, LA 70433**  
**johncummings108@charter.net**  
**(985) 892-1549 OFFICE** **(985) 892-9250 FAX**

**DESCRIPTION FOR PROPOSED HC-1**

A parcel of land located in Section 25, Township 6 South, Range 10 East, St. Tammany Parish, Louisiana and being more fully described as follows:

Commencing from the Section Corner common to Sections 23, 24, 25 & 26 in said township and range;  
Thence South 00 degrees 07 minutes 34 seconds East 2667.84 feet to a point;  
Thence South 00 degrees 06 minutes 02 seconds East 1033.28 feet to a point on the North Side of Ronald Reagan Highway (A.K.A. U. S. Highway No. 190);  
Thence South 85 degrees 24 minutes 42 seconds East 466.73 feet along the North Side of said Highway to a point on the East Side of Pruden Road being the **Point of Beginning**,

Thence North 04 degrees 17 minutes 11 seconds East 500.0 feet along the East Side of Pruden Road to a point;  
Thence South 85 degrees 24 minutes 48 seconds East 294.04 feet to a point;  
Thence South 04 degrees 35 minutes 18 seconds West 500.0 feet to a point on the North Side of Ronald Reagan Highway (A.K.A. U. S. Highway No. 190);  
Thence North 85 degrees 24 minutes 42 seconds West 291.41 feet along the North Side of said Highway to the **Point of Beginning**, containing 3.360 Acres.

  
John G. Cummings, P.L.S.

22022-D2

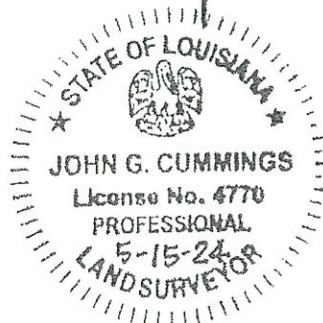

**JOHN G. CUMMINGS & ASSOCIATES**  
**PROFESSIONAL LAND SURVEYORS IN LOUISIANA & MISSISSIPPI**  
**503 NORTH JEFFERSON AVENUE**  
**COVINGTON, LA 70433**  
**johncummings108@charter.net**  
**(985) 892-1549 OFFICE** **(985) 892-9250 FAX**

**DESCRIPTION FOR PROPOSED HC-2**

A parcel of land located in Section 25, Township 6 South, Range 10 East, St. Tammany Parish, Louisiana and being more fully described as follows:

Commencing from the Section Corner common to Sections 23, 24, 25 & 26 in said township and range;

Thence South 00 degrees 07 minutes 34 seconds East 2667.84 feet to a point;  
Thence South 00 degrees 06 minutes 02 seconds East 1033.28 feet to a point on the North Side of Ronald Reagan Highway (A.K.A. U. S. Highway No. 190);  
Thence South 85 degrees 24 minutes 42 seconds East 1238.76 feet along the North Side of said Highway to the **Point of Beginning**,

Thence North 04 degrees 35 minutes 18 seconds East 237.0 feet to a point;  
Thence North 43 degrees 58 minutes 44 seconds West 284.10 feet to a point;  
Thence North 04 degrees 35 minutes 18 seconds East 75.0 feet to a point;  
Thence South 85 degrees 24 minutes 42 seconds East 686.00 feet to a point;  
Thence South 04 degrees 35 minutes 18 seconds West 500.0 feet to a point on the North Side of Ronald Reagan Highway (A.K.A. U. S. Highway No. 190);  
Thence North 85 degrees 24 minutes 42 seconds West 473.0 feet along the North Side of said Highway to the **Point of Beginning**, containing 6.256 Acres.

  
John G. Cummings, P.L.S.

22022-D3

