

# CAPITAL IMPROVEMENT PROGRAM

FY 2026 – 2030

St. Tammany Regional Airport



Prepared By:



Airport Name (LOC ID), ST: **St. Tammany Regional Airport (L31) Abita Springs** **CIP START YEAR: 2026**

\$11,900 2023 NPE (Expires FY26)      \$0 2023 AIG (Expires FY26)  
 \$150,000 2024 NPE (Expires FY27)      \$110,000 2024 AIG (Expires FY27)  
 \$150,000 2025 NPE (Expires FY28)      \$110,000 2025 AIG (Expires FY28)  
 \$150,000 Estimated NPE (for planning through 2030)      \$110,000 2026 AIG (for planning through 2026)

Fed FY	Available		Funding Source	ODO Project Component/Phase	Estimated Cost	Funding Plan				
	NPE	AIG				NPE	AIG	Additional AIP	Other	Match
2026	\$461,900	\$330,000	AIP State	Removal of Transition Surface Obstructions West (Trees) Ph II Const Land Acquisition - Runway 18 Approach (18 acres)	\$455,255 \$344,000	\$409,729	\$0	\$0	\$0	\$22,763 \$344,000
	<b>Total = \$791,900</b>									
	\$52,171	\$330,000	Remaining Funds		<b>2026 Annual Subtotals:</b>	<b>\$799,255</b>	<b>\$409,729</b>	<b>\$0</b>	<b>\$0</b>	<b>\$0</b>
2027	\$202,171	\$330,000	AIP/BIL AIP/BIL State	Obstruction Removal - Runway 18 Approach (3.3 Acres) Obstruction Removal - Runway 18 Approach (14.7 Acres) Land Acquisition Runway 36 Approach (14 acres)	\$78,632 \$347,368 \$270,000	\$70,768	\$330,000	\$0	\$0	\$3,932 \$17,368 \$270,000
	<b>Total = \$532,171</b>									
	\$131,403	\$0	Remaining Funds		<b>2027 Annual Subtotals:</b>	<b>\$696,000</b>	<b>\$70,768</b>	<b>\$330,000</b>	<b>\$0</b>	<b>\$291,300</b>
2028	\$281,403	\$0	AIP State	Obstruction Removal - Runway 36 Approach Airport Access Road Relocation (Obstruction)(Phase IIA - Const)	\$585,000 \$967,600	\$281,403		\$245,097		\$58,500 \$967,600
	<b>Total = \$281,403</b>									
	\$0	\$0	Remaining Funds		<b>2028 Annual Subtotals:</b>	<b>\$1,552,600</b>	<b>\$281,403</b>	<b>\$0</b>	<b>\$245,097</b>	<b>\$1,026,100</b>
2029	\$150,000	\$0	AIP State	Airport Layout Plan Update and Exhibit A Airport Access Road Relocation (Obstruction)(Phase IIB - Const)	\$335,000 \$933,700	\$150,000		\$151,500		\$33,500 \$933,700
	<b>Total = \$150,000</b>									
	\$0	\$0	Remaining Funds		<b>2029 Annual Subtotals:</b>	<b>\$1,268,700</b>	<b>\$150,000</b>	<b>\$0</b>	<b>\$151,500</b>	<b>\$967,200</b>
2030	\$150,000	\$0	AIP State AIP	Runway 18/36 Extension (1200') Airport Access Road Relocation (Obstruction)(Phase IIC - Const) Airfield Perimeter Fencing	\$5,501,257 \$695,870 \$699,120	\$150,000		\$4,801,131		\$550,126 \$695,870 \$69,912
	<b>Total = \$150,000</b>									
	\$1	\$0	Remaining Funds		<b>2030 Annual Subtotals:</b>	<b>\$6,896,247</b>	<b>\$149,999</b>	<b>\$0</b>	<b>\$5,430,339</b>	<b>\$1,315,907</b>
<b>5 Year CIP Totals:</b>						<b>\$11,212,802</b>	<b>\$1,061,899</b>	<b>\$330,000</b>	<b>\$0</b>	<b>\$3,967,269</b>

SPONSOR SIGNATURE: \_\_\_\_\_ DATE: \_\_\_\_\_

## St. Tammany Regional Airport – L31

### Elements of Capital Improvement Plan (CIP) FY 2025-2029

#### FY 2026

1. **Removal of Transition Surface Obstruction West (Trees) Phase II Construction**  
The objective of this project is to remove the trees adjacent to the fence line on the West side to clear the transition surface. Presently the airport fence line is approximately 160 ft from the runway centerline with 60 ft and taller pine trees at the fence line. The trees have been a transition surface obstruction for years as reported on the airport's annual inspection report.
2. **Land Acquisition Runway 18 Approach (18 Acres):** The 20:1 Approach surface on Runway 18 is penetrated by trees (Approximately 18 acres). It is necessary to acquire this land in order to mitigate the hazard to the approach surface for safe operations. The project consists of the acquisition of 18 acres, along with environmental, survey and land acquisitions services.

#### FY 2027

1. **Obstruction Removal – Runway 18 Approach:** A recent obstruction survey performed shows that there are multiple trees penetrating the 20:1 Approach Surface on Runway 18. This project consists of the clearing and grubbing of 18 acres beneath the Runway 18 Approach. The removal of these obstructions will allow for safer operations with proper clearances. The project also includes the estimated Wetlands Mitigation cost to perform this work in wetlands.
2. **Land Acquisition Runway 36 Approach (14 Acres):** Land Acquisition Runway 36 Approach- The 20:1 Approach surface on Runway 36 is penetrated by trees (Approximately 14 acres). It is necessary to acquire this land in order to mitigate the hazard to the approach surface for safe operations. The project consists of the acquisition of 14 acres, along with environmental, survey and land acquisition services.

#### FY 2028

1. **Obstruction Removal – Runway 36 Approach:** - A recent obstruction survey performed shows that there are multiple trees penetrating the 20:1 Approach Surface on Runway 36. This project consists of the clearing and grubbing of 28 acres beneath the Runway 36 Approach. The removal of these obstructions will allow for safer operations with proper clearances. The project also includes the estimated Wetlands Mitigation cost to perform this work in wetlands.

2. **Airport Access Road Relocation - Phase IIA - Construction:** Airport Road, which is the main access from Highway 36 to the airport terminal area falls within the Runway object Free zone. This project consists of the construction of a new airport access roadway along the eastern property line of the airport to access the new terminal area. The roadway will connect Highway 36 to the new terminal area and will eliminate a runway obstruction.

This project is broken out into three Construction Phases. Construction Phase IIA consists of clearing, grubbing, excavation, embankment damage work and roadway subbase and base.

#### FY 2029

1. **Airport Layout Plan Update and Exhibit A:** After the clearing of all obstructions, an AGIS survey will be conducted, and the ALP will be revised. The confirmation of obstructions being cleared will allow the Airport to request the development of non-precision instrument approach procedure. As part of the ALP update an Exhibit A property map will be completed.

2. **Airport Access Road Relocation - Phase IIB - Construction:** Airport Road, which is the main access from Highway 36 to the airport terminal area falls within the Runway object Free zone. This project consists of the construction of a new airport access roadway along the eastern property line of the airport to access the new terminal area. The roadway will connect Highway 36 to the new terminal area and will eliminate a runway obstruction.

Construction Phase IIB consists of excavation, embankment drainage work and roadway subbase and base.

#### FY 2030

1. **Runway 18/36 Extension (1200')** The Airport continues to have a growing need from the community and aircraft users requiring a runway length of 4,000 ft. This project will be a multi-year phased project to extend the existing runway to 4200' x 75'. The proposed 1200' extension would utilize a flexible pavement section and designed for the critical aircraft. The project would also include installation of edge lighting and required airfield signage. The proposed project includes design, environmental, bidding, grant administration, construction, and construction related professional services.

2. **Airport Access Road Relocation - Phase IIC - Construction** Airport Road, which is the main access from Highway 36 to the airport terminal area falls within the Runway object Free zone. This project consists of the construction of a new airport access roadway along the eastern property line of the airport to access the new terminal area. The roadway will connect Highway 36 to the new terminal area and will eliminate a runway obstruction.

Construction Phase IIC is the final phase and consists of Asphalt surface, aggregate shoulders, striping and removal of existing Airport Road.

3. **Airfield Perimeter Fencing:** Presently the St. Tammany Regional Airport does not have any perimeter fencing in place to prevent wildlife or pedestrians from entering the runway safety area. This is considered a safety issue whereas, wildlife has been spotted on the airfield. Recently the Sponsor installed an automated gate to control access on Airport Road, however the remaining perimeter of the airfield remains unsecured. This project consists of the design and construction of 14,200 linear feet of perimeter fencing around the airport property along with access gates and ditch crossings.

**Louisiana Airport Construction and Development Priority Program  
FISCAL YEAR 2026-2027  
Project Application**

<b>Airport Sponsor:</b>	St. Tammany Parish Government
<b>Airport:</b>	St. Tammany Regional Airport
<b>No. and Street/P.O. Box:</b>	21454 Koop Drive
<b>City, State, Zip Code:</b>	Mandeville, LA 70471

<b>PROJECT TITLE/DESCRIPTION:</b>	<b>Funding Year Requested:</b>
Removal of Transition Surface Obstruction (Trees) Phase II Construction	2026

**PROJECT SCOPE & JUSTIFICATION:**  
 The Airport Sponsor acquired 49 acres adjacent to the Airport on the West side of Runway 18-36 in 2014. At that time the land was cleared up to 120 ft away from the airport fence line. Presently the airport fence line is approximately 160 ft from the runway centerline with 60 ft and taller pine trees at the fence line. The trees have been a transition surface obstruction for years as reported on the airport's annual inspection report. The objective of this project is to remove the trees adjacent to the fence line to clear the transition surface.

**Estimated Project Cost:**  
 (If applicable, attach a detailed construction cost estimate)

Classification	Estimated Cost
Administrative Expenses	\$ 3,000.00
Land Acquisition Cost	
Engineering Fees	
Survey	
Geotechnical	
Estimated Construction Cost	\$ 305,255.00
Construction Inspection	\$ 19,000.00
Construction Administration Fees	\$ 10,000.00
Construction Testing	
Equipment Purchase Cost	
Other: (Grant Administration)	\$ 8,000.00
Other: (Wetland Mitigation)	\$ 110,000.00
<b>Total Estimated Project Cost</b>	<b>\$ 455,255.00</b>

**Funding Sources:**

Source	% Contribution	Funds
Federal Funds	95%	\$ 432,492.00
State Funds	5%	\$ 22,763.00
Local Contribution	0%	
Other: (define)	0%	
<b>Total Estimated Project Cost</b>		<b>\$ 455,255.00</b>

**Attach the following:** (as identified in Louisiana Administrative Code Title 70, Part IX §307 and §315)  
 Sketch of Project(s) on the airport's approved Airport Layout Plan  
 Any additional information necessary for prioritization, ie. Detailed Construction Cost Estimate, Resolution for Local Funds Contribution, Additional Documentation providing Justification for the Project, Environmental Clearance Documentation



**Engineer's Opinion of Probable Project Costs**  
**Removal of Obstructions - West Side Phase II Construction**  
**St. Tammany Regional Airport**  
**23-Jul-25**

Item No.	Description	Unit	Quantity	Unit Cost	Extension
C-105	Mobilization	Lump	1	\$35,000.00	\$35,000.00
P-151-4.2	Clearing and Grubbing	Acre	20.26	\$8,000.00	\$162,080.00
P-152-4.1	Unclassified Excavation	Cubic Yard	38	\$50.00	\$1,900.00
D-701-5.1	18 Inch RCPA Storm Drain Pipe	Linear Foot	100	\$180.00	\$18,000.00
T-901-5.1	Seeding	Acre	20.26	\$2,500.00	\$50,650.00
302-01-00300	Class II Base Course (Crushed Stone)	Cubic Yard	215	\$175.00	\$37,625.00
<b>Total Estimated Construction Costs</b>					<b>\$305,255.00</b>

**Probable Project Costs**

Total Estimated Construction Costs	<b>\$305,255.00</b>
Estimated Wetlands Mitigation Costs	<b>\$110,000.00</b>
Grant Administration	<b>\$8,000.00</b>
Construction Administration and Resident Inspector Administrative	<b>\$29,000.00</b>
Total Estimated Project Costs	<b>\$3,000.00</b>
	<hr/>
	<b>\$455,255.00</b>

**Louisiana Airport Construction and Development Priority Program  
FISCAL YEAR 2026-2027  
Project Application**

<b>Airport Sponsor:</b>	St. Tammany Parish Government
<b>Airport:</b>	St. Tammany Regional Airport
<b>No. and Street/P.O. Box:</b>	21454 Koop Drive
<b>City, State, Zip Code:</b>	Mandeville, LA 70471

<b>PROJECT TITLE/DESCRIPTION:</b> Land Acquisition - Runway 18 Approach (18 Acres)	<b>Funding Year Requested:</b> 2026
---	--

**PROJECT SCOPE & JUSTIFICATION:**  
Land Acquisition Runway 18 Approach- The 20:1 Approach surface on Runway 18 is penetrated by trees (Approximately 18 acres). It is necessary to acquire this land in order to mitigate the hazard to the approach surface for safe operations. The project consists of the acquisition of 18 acres, along with environmental, survey and land acquisitions services.

**Estimated Project Cost:**  
(If applicable, attach a detailed construction cost estimate)

Classification	Estimated Cost
Administrative Expenses	
Land Acquisition Cost	\$ 270,000.00
Engineering Fees	
Survey	\$ 12,000.00
Geotechnical	
Estimated Construction Cost	
Construction Inspection	
Construction Administration Fees	
Construction Testing	
Equipment Purchase Cost	
Other: (Environmental)	\$ 37,000.00
Other: (Legal)	\$ 25,000.00
<b>Total Estimated Project Cost</b>	<b>\$ 344,000.00</b>

**Funding Sources:**

Source	% Contribution	Funds
Federal Funds	0%	
State Funds	100%	\$ 344,000.00
Local Contribution	0%	
Other: (define)	0%	
<b>Total Estimated Project Cost</b>		<b>\$ 344,000.00</b>

**Attach the following:** (as identified in Louisiana Administrative Code Title 70, Part IX §307 and §315)  
 Sketch of Project(s) on the airport's approved Airport Layout Plan  
 Any additional information necessary for prioritization, ie. Detailed Construction Cost Estimate, Resolution for Local Funds Contribution, Additional Documentation providing Justification for the Project, Environmental Clearance Documentation



**Engineer's Opinion of Probable Project Costs**

**Land Acquisition Runway 18 Approach (18 acres)**

**St. Tammany Regional Airport**

**2-Sep-25**

<b>Land Purchase (18 Acres)</b>	<b>\$270,000.00</b>
<b>Property Survey</b>	<b>\$12,000.00</b>
<b>Environmental Assessment</b>	<b>\$18,000.00</b>
<b>Wetland Delineation</b>	<b>\$11,000.00</b>
<b>Phase I ESA</b>	<b>\$8,000.00</b>
<b>Land Acquisition Services</b>	<b>\$25,000.00</b>
<b>Total Estimated Project Costs</b>	<b><u>\$344,000.00</u></b>

**Louisiana Airport Construction and Development Priority Program  
FISCAL YEAR 2026-2027  
Project Application**

<b>Airport Sponsor:</b>	St. Tammany Parish Government
<b>Airport:</b>	St. Tammany Regional Airport
<b>No. and Street/P.O. Box:</b>	21454 Koop Drive
<b>City, State, Zip Code:</b>	Mandeville, LA 70471

<b>PROJECT TITLE/DESCRIPTION:</b>	<b>Funding Year Requested:</b>
Obstruction Removal - Runway 18 Approach	2027

**PROJECT SCOPE & JUSTIFICATION:**  
 A recent obstruction survey performed shows that there are multiple trees penetrating the 20:1 Approach Surface on Runway 18. This project consists of the clearing and grubbing of 18 acres beneath the Runway 18 Approach. The removal of these obstructions will allow for safer operations with proper clearances. The project also includes the estimated Wetlands Mitigation cost to perform this work in wetlands.

**Estimated Project Cost:**  
 (If applicable, attach a detailed construction cost estimate)

Classification	Estimated Cost
Administrative Expenses	\$ 3,000.00
Land Acquisition Cost	
Engineering Fees	\$ 60,000.00
Survey	
Geotechnical	
Estimated Construction Cost	\$ 224,000.00
Construction Inspection	\$ 19,000.00
Construction Administration Fees	\$ 10,000.00
Construction Testing	
Equipment Purchase Cost	
Other: (Grant Administration)	
Other: (Wetland Mitigation)	\$ 110,000.00
<b>Total Estimated Project Cost</b>	<b>\$ 426,000.00</b>

**Funding Sources:**

Source	% Contribution	Funds
Federal Funds	95%	\$ 404,700.00
State Funds	5%	\$ 21,300.00
Local Contribution	0%	
Other: (define)	0%	
<b>Total Estimated Project Cost</b>		<b>\$ 426,000.00</b>

**Attach the following:** (as identified in Louisiana Administrative Code Title 70, Part IX §307 and §315)  
 Sketch of Project(s) on the airport's approved Airport Layout Plan  
 Any additional information necessary for prioritization, ie. Detailed Construction Cost Estimate, Resolution for Local Funds Contribution, Additional Documentation providing Justification for the Project, Environmental Clearance Documentation



**Engineer's Opinion of Probable Project Costs**  
**Obstruction Removal - Runway 18 Approach**  
**St. Tammany Regional Airport**  
**2-Sep-25**

Item No.	Description	Unit	Quantity	Unit Cost	Extension
C-105	Mobilization	Lump	1	\$35,000.00	\$35,000.00
P-151-4.2	Clearing and Grubbing	Acre	18.00	\$8,000.00	\$144,000.00
T-901-5.1	Seeding	Acre	18.00	\$2,500.00	\$45,000.00
<b>Total Estimated Construction Costs</b>					<b>\$224,000.00</b>

**Probable Project Costs**

Total Estimated Construction Costs	\$224,000.00
Estimated Wetlands Mitigation Costs	\$110,000.00
Engineering and Environmental	\$60,000.00
Construction Administration and Resident Inspector	\$29,000.00
Administrative	\$3,000.00
<b>Total Estimated Project Costs</b>	<b>\$426,000.00</b>

**Louisiana Airport Construction and Development Priority Program  
FISCAL YEAR 2026-2027  
Project Application**

<b>Airport Sponsor:</b>	St. Tammany Parish Government
<b>Airport:</b>	St. Tammany Regional Airport
<b>No. and Street/P.O. Box:</b>	21454 Koop Drive
<b>City, State, Zip Code:</b>	Mandeville, LA 70471

<b>PROJECT TITLE/DESCRIPTION:</b> Land Acquisition Runway 36 Approach (14 Acres)	<b>Funding Year Requested:</b> 2027
---	--

**PROJECT SCOPE & JUSTIFICATION:**  
Land Acquisition Runway 36 Approach- The 20:1 Approach surface on Runway 36 is penetrated by trees (Approximately 14 acres). It is necessary to acquire this land in order to mitigate the hazard to the approach surface for safe operations. The project consists of the acquisition of 14 acres, along with environmental, survey and land acquisition services.

**Estimated Project Cost:**  
(If applicable, attach a detailed construction cost estimate)

Classification	Estimated Cost
Administrative Expenses	
Land Acquisition Cost	\$ 210,000.00
Engineering Fees	
Survey	\$ 10,000.00
Geotechnical	
Estimated Construction Cost	
Construction Inspection	
Construction Administration Fees	
Construction Testing	
Equipment Purchase Cost	
Other: (Environmental)	\$ 30,000.00
Other: (Legal)	\$ 20,000.00
<b>Total Estimated Project Cost</b>	<b>\$ 270,000.00</b>

**Funding Sources:**

Source	% Contribution	Funds
Federal Funds	0%	
State Funds	100%	\$ 270,000.00
Local Contribution	0%	
Other: (define)	0%	
<b>Total Estimated Project Cost</b>		<b>\$ 270,000.00</b>

**Attach the following:** (as identified in Louisiana Administrative Code Title 70, Part IX §307 and §315)  
 Sketch of Project(s) on the airport's approved Airport Layout Plan  
 Any additional information necessary for prioritization, ie. Detailed Construction Cost Estimate, Resolution for Local Funds Contribution, Additional Documentation providing Justification for the Project, Environmental Clearance Documentation

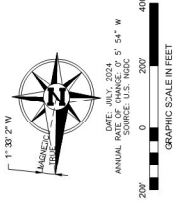
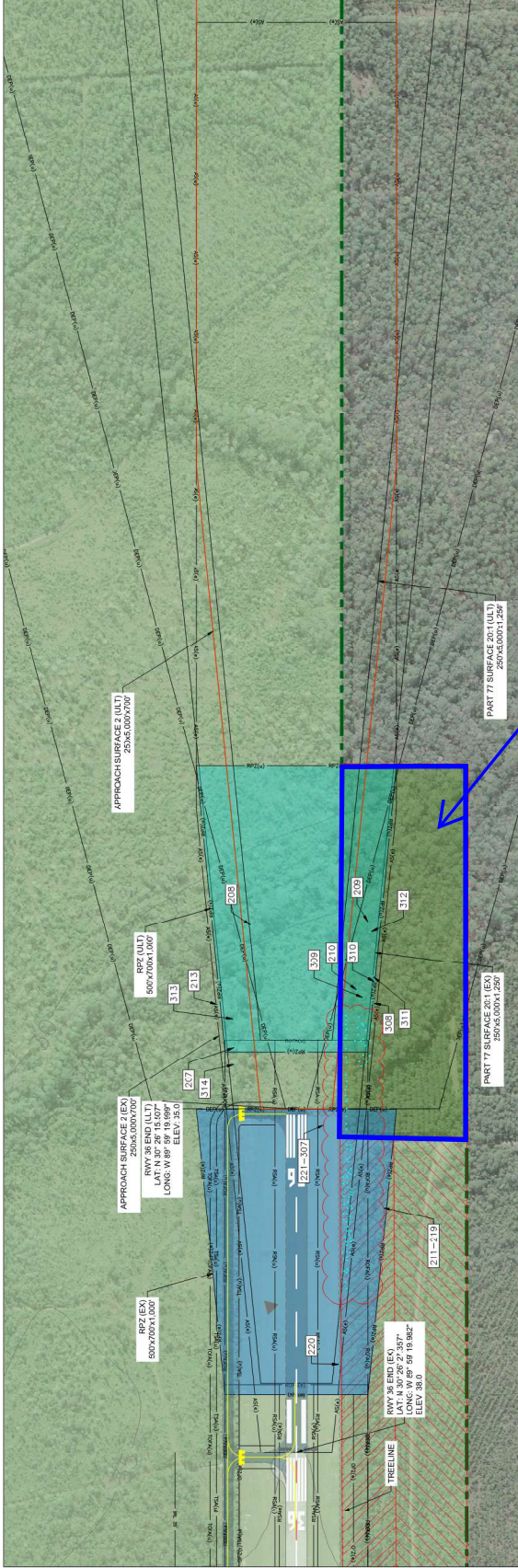

- NOTES:**
1. SEE SHEET 12-13 FOR TABLE OF OBSTACLES.
  2. THE SURFACE MASSING AND AERIAL MASS IS BASED ON THE PLANIMETRIC MAPPING AND ORTHO-IMAGERY INFORMATION COMPLETED BY NVS.
  3. CONSTRUCTION SURVEY DATA WAS OBTAINED IN 2024 AND COMPLETED ON NOVEMBER 4th, 2024.
  4. ALL HORIZONTAL COORDINATES ARE SHOWN IN LOUISIANA STATE PLANE NORTH ZONE US FOOT, NAD 83.
  5. ALL VERTICAL COORDINATES ARE SHOWN IN NAD 83.

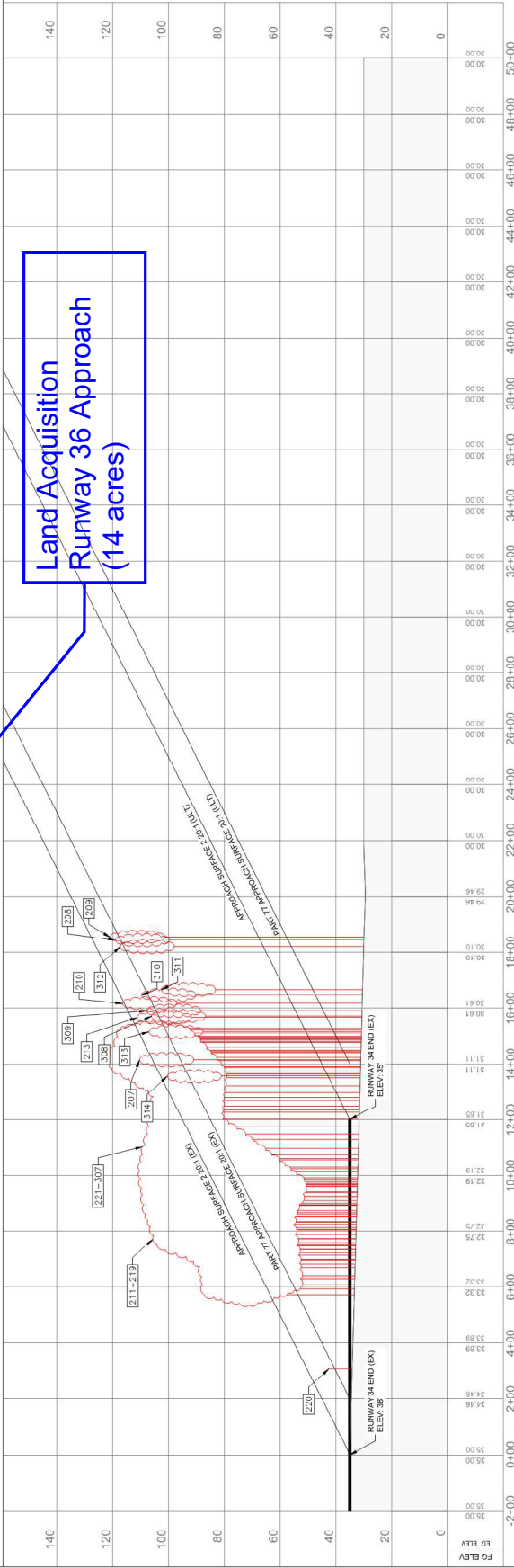



**ST. TAMMANY REGIONAL AIRPORT (L31)**  
ABITA SPRINGS, LA

**INNER PORTION APPROACH SURFACE DRAWING - RUNWAY 36**

**11**

DES: MM		NO. BY		DATE		ISSUE RECORD	
DR: CJM							
CH: LH							
APP: JF							

A/P GRANT NO.	KSA JOB NO.	DATE:
	101586	APR 17, 2025

SHEET NO. 11

\\sawingaweb\Projects\101586\01-ALP-36\ST TAMMANY REGIONAL AIRPORT\LIST\ST TAMMANY-ALP\PROFILES\ALP-36

**Engineer's Opinion of Probable Project Costs**

**Land Acquisition Runway 36 Approach (14 acres)**

**St. Tammany Regional Airport**

**2-Sep-25**

<b>Land Purchase (14 Acres)</b>	<b>\$210,000.00</b>
<b>Property Survey</b>	<b>\$10,000.00</b>
<b>Environmental Assessment</b>	<b>\$15,000.00</b>
<b>Wetland Delineation</b>	<b>\$9,000.00</b>
<b>Phase I ESA</b>	<b>\$6,000.00</b>
<b>Land Acquisition Services</b>	<b>\$20,000.00</b>
<b>Total Estimated Project Costs</b>	<b><u>\$270,000.00</u></b>

**Louisiana Airport Construction and Development Priority Program  
FISCAL YEAR 2026-2027  
Project Application**

<b>Airport Sponsor:</b>	St. Tammany Parish Government
<b>Airport:</b>	St. Tammany Regional Airport
<b>No. and Street/P.O. Box:</b>	21454 Koop Drive
<b>City, State, Zip Code:</b>	Mandeville, LA 70471

<b>PROJECT TITLE/DESCRIPTION:</b>	<b>Funding Year Requested:</b>
Obstruction Removal - Runway 36 Approach	2028

**PROJECT SCOPE & JUSTIFICATION:**  
 A recent obstruction survey performed shows that there are multiple trees penetrating the 20:1 Approach Surface on Runway 36. This project consists of the clearing and grubbing of 28 acres beneath the Runway 36 Approach. The removal of these obstructions will allow for safer operations with proper clearances. The project also includes the estimated Wetlands Mitigation cost to perform this work in wetlands.

**Estimated Project Cost:**  
 (If applicable, attach a detailed construction cost estimate)

Classification	Estimated Cost
Administrative Expenses	\$ 3,000.00
Land Acquisition Cost	
Engineering Fees	\$ 70,000.00
Survey	
Geotechnical	
Estimated Construction Cost	\$ 329,000.00
Construction Inspection	\$ 19,000.00
Construction Administration Fees	\$ 10,000.00
Construction Testing	
Equipment Purchase Cost	
Other: (Grant Administration)	
Other: (Wetland Mitigation)	\$ 154,000.00
<b>Total Estimated Project Cost</b>	<b>\$ 585,000.00</b>

**Funding Sources:**

Source	% Contribution	Funds
Federal Funds	90%	\$ 526,500.00
State Funds	10%	\$ 58,500.00
Local Contribution	0%	
Other: (define)	0%	
<b>Total Estimated Project Cost</b>		<b>\$ 585,000.00</b>

**Attach the following:** (as identified in Louisiana Administrative Code Title 70, Part IX §307 and §315)  
 Sketch of Project(s) on the airport's approved Airport Layout Plan  
 Any additional information necessary for prioritization, ie. Detailed Construction Cost Estimate, Resolution for Local Funds Contribution, Additional Documentation providing Justification for the Project, Environmental Clearance Documentation



**Engineer's Opinion of Probable Project Costs**  
**Obstruction Removal - Runway 36 Approach**  
**St. Tammany Regional Airport**  
**2-Sep-25**

Item No.	Description	Unit	Quantity	Unit Cost	Extension
C-105	Mobilization	Lump	1	\$35,000.00	\$35,000.00
P-151-4.2	Clearing and Grubbing	Acre	28	\$8,000.00	\$224,000.00
T-901-5.1	Seeding	Acre	28	\$2,500.00	\$70,000.00
<b>Total Estimated Construction Costs</b>					<b>\$329,000.00</b>

**Probable Project Costs**

Total Estimated Construction Costs	\$329,000.00
Estimated Wetlands Mitigation Costs	\$154,000.00
Engineering and Environmental	\$70,000.00
Construction Administration and Resident Inspector	\$29,000.00
Administrative	\$3,000.00
<b>Total Estimated Project Costs</b>	<b>\$585,000.00</b>

**Louisiana Airport Construction and Development Priority Program  
FISCAL YEAR 2026-2027  
Project Application**

<b>Airport Sponsor:</b>	St. Tammany Parish Government
<b>Airport:</b>	St. Tammany Regional Airport
<b>No. and Street/P.O. Box:</b>	21454 Koop Drive
<b>City, State, Zip Code:</b>	Mandeville, LA 70471

<b>PROJECT TITLE/DESCRIPTION:</b> Airport Access Road Relocation (Phase IIA Construction)	<b>Funding Year Requested:</b> 2028
--	--

**PROJECT SCOPE & JUSTIFICATION:**  
 Airport Road, which is the main access from Highway 36 to the airport terminal area falls within the Runway object Free zone. This project consists of the construction of a new airport access roadway along the eastern property line of the airport to access the new terminal area. The roadway will connect Highway 36 to the new terminal area and will eliminate a runway obstruction. This project is broken out into three Construction Phases. Construction Phase IIA consists of clearing, grubbing, excavation, embankment damage work and roadway subbase and base.

**Estimated Project Cost:**  
 (If applicable, attach a detailed construction cost estimate)

Classification	Estimated Cost
Administrative Expenses	\$ 3,000.00
Land Acquisition Cost	
Engineering Fees	\$ 6,000.00
Survey	
Geotechnical	
Estimated Construction Cost	\$ 717,389.00
Construction Inspection	\$ 75,000.00
Construction Administration Fees	\$ 30,000.00
Construction Testing	\$ 30,000.00
Equipment Purchase Cost	
Other: (Estimated Wetlands Mitigation)	\$ 106,200.00
Other: ()	
<b>Total Estimated Project Cost</b>	<b>\$ 967,589.00</b>

**Funding Sources:**

Source	% Contribution	Funds
Federal Funds	0%	
State Funds	100%	\$ 967,589.00
Local Contribution	0%	
Other: (define)	0%	
<b>Total Estimated Project Cost</b>		<b>\$ 967,589.00</b>

**Attach the following:** (as identified in Louisiana Administrative Code Title 70, Part IX §307 and §315)  
 Sketch of Project(s) on the airport's approved Airport Layout Plan  
 Any additional information necessary for prioritization, ie. Detailed Construction Cost Estimate, Resolution for Local Funds Contribution, Additional Documentation providing Justification for the Project, Environmental Clearance Documentation



NO.	DATE	REVISION OR CHANGE NUMBER	DESCRIPTION

PREPARED BY:  
 JACQUES F. FIALA  
 CIVIL ENGINEER  
 LICENSE # 18111  
 EXPIRES 10/15/19  
 CHECKED BY:  
 JOSEPH A. COTTER  
 LICENSE # 18111  
 EXPIRES 10/15/19

DESIGNED BY	CHECKED BY	DATE
JAC	CMB	04/2025

PROJECT	STATE	PROJECT NUMBER
ST. TAMMANY	LA	H.016209

SHEET NUMBER: 17



SCALE: 1"=100'

**OPINION OF PROBABLE PROJECT COST**

ST. TAMMANY REGIONAL AIRPORT  
AIRPORT ACCESS ROAD RELOCATION PHASE II A

REF NO.	ITEM DESCRIPTION	UNIT OF MEASURE	QUANTITY	UNIT PRICE	UNIT PRICE EXTENSION
201-01-00100	CLEARING AND GRUBBING	LUMP	1	\$ 50,000.00	\$ 50,000.00
203-01-00100	GENERAL EXCAVATION	CUYD	4064	\$ 23.00	\$ 93,472.00
203-03-00100	EMBANKMENT	CUYD	630	\$ 26.00	\$ 16,380.00
203-04-00200	NON-PLASTIC EMBANKMENT (SAND)	CUYD	2040	\$ 42.00	\$ 85,680.00
203-08-00100	GEOTEXTILE FABRIC	SOYD	3539	\$ 3.00	\$ 10,617.00
204-06-00100	TEMPORARY SILT FENCING	LNFT	2800	\$ 3.50	\$ 9,800.00
204-07-00100	TEMPORARY STONE CONSTRUCTION ENTRANCE	EACH	1	\$ 7,500.00	\$ 7,500.00
302-02-08020	CLASS II BASE COURSE (8" THICK)(CRUSHED STONE)	SOYD	4058	\$ 43.50	\$ 176,523.00
304-01-00100	LIME	TON	18	\$ 400.00	\$ 7,200.00
304-02-00200	LIME TREATMENT (TYPE B) (8-1/2" THICK)	SOYD	1915	\$ 4.00	\$ 7,660.00
701-03-01022	STORM DRAIN PIPE (18" RCP/RPVC)	LNFT	164	\$ 155.00	\$ 25,420.00
701-03-01082	STORM DRAIN PIPE (36" RCP/RPVC)	LNFT	60	\$ 198.00	\$ 11,880.00
701-04-01120	STORM DRAIN PIPE ARCH (48" EQUIV. RCPA)	LNFT	112	\$ 570.00	\$ 63,840.00
726-01-00100	BEDDING MATERIAL	CUYD	40	\$ 155.00	\$ 6,200.00
727-01-00100	MOBILIZATION	LUMP	1	\$ 50,000.00	\$ 50,000.00
739-01-00100	HYDRO-SEEDING	ACRE	1	\$ 5,000.00	\$ 5,000.00
740-01-00100	CONSTRUCTION LAYOUT	LUMP	1	\$ 25,000.00	\$ 25,000.00
<b>SUB-TOTAL ESTIMATED CONSTRUCTION COST</b>					<b>\$ 652,172.00</b>
<b>CONSTRUCTION CONTINGENCY (10%)</b>					<b>\$ 65,217.20</b>
<b>TOTAL ESTIMATED CONSTRUCTION COST</b>					<b>\$ 717,389.20</b>

Mitigation	\$106,200.00
Bidding	\$6,000.00
RI	\$75,000.00
Const. Admin	\$30,000.00
Testing	\$30,000.00
Administrative	\$3,000.00
	<u>\$967,589.20</u>

**Louisiana Airport Construction and Development Priority Program  
FISCAL YEAR 2026-2027  
Project Application**

<b>Airport Sponsor:</b>	St. Tammany Parish Government
<b>Airport:</b>	St. Tammany Regional Airport
<b>No. and Street/P.O. Box:</b>	21454 Koop Drive
<b>City, State, Zip Code:</b>	Mandeville, LA 70471

<b>PROJECT TITLE/DESCRIPTION:</b> Airport Layout Plan Update and Exhibit A	<b>Funding Year Requested:</b> 2029
---	--

**PROJECT SCOPE & JUSTIFICATION:**  
After the clearing of all obstructions, an AGIS survey will be conducted and the ALP will be revised. The confirmation of obstructions being cleared will allow the Airport to request the development of non-precision instrument approach procedure. As part of the ALP update an Exhibit A property map will be completed.

**Estimated Project Cost:**  
(If applicable, attach a detailed construction cost estimate)

Classification	Estimated Cost
Administrative Expenses	
Land Acquisition Cost	
Engineering Fees	\$ 250,000.00
Survey	\$ 70,000.00
Geotechnical	
Estimated Construction Cost	
Construction Inspection	
Construction Administration Fees	
Construction Testing	
Equipment Purchase Cost	
Other: (Project Management)	\$ 15,000.00
Other: (Legal)	
<b>Total Estimated Project Cost</b>	<b>\$ 335,000.00</b>

**Funding Sources:**

Source	% Contribution	Funds
Federal Funds	90%	\$ 301,500.00
State Funds	10%	\$ 33,500.00
Local Contribution	0%	
Other: (define)	0%	
<b>Total Estimated Project Cost</b>		<b>\$ 335,000.00</b>

**Attach the following:** (as identified in Louisiana Administrative Code Title 70, Part IX §307 and §315)  
 Sketch of Project(s) on the airport's approved Airport Layout Plan  
 Any additional information necessary for prioritization, ie. Detailed Construction Cost Estimate, Resolution for Local Funds Contribution, Additional Documentation providing Justification for the Project, Environmental Clearance Documentation

**Engineer's Opinion of Probable Project Costs**

**Airport Layout Plan Update  
St. Tammany Regional Airport  
2-Sep-25**

<b>AGIS Survey</b>	<b>\$130,000.00</b>
<b>ALP Update</b>	<b>\$120,000.00</b>
<b>Exhibit A Property Survey</b>	<b>\$70,000.00</b>
<b>Project Management</b>	<b>\$15,000.00</b>
<b>Total Estimated Project Costs</b>	<b><u>\$335,000.00</u></b>

**Louisiana Airport Construction and Development Priority Program  
FISCAL YEAR 2026-2027  
Project Application**

<b>Airport Sponsor:</b>	St. Tammany Parish Government
<b>Airport:</b>	St. Tammany Regional Airport
<b>No. and Street/P.O. Box:</b>	21454 Koop Drive
<b>City, State, Zip Code:</b>	Mandeville, LA 70471

<b>PROJECT TITLE/DESCRIPTION:</b> Airport Access Road Relocation (Phase IIB Construction)	<b>Funding Year Requested:</b> 2029
--	--

**PROJECT SCOPE & JUSTIFICATION:**  
 Airport Road, which is the main access from Highway 36 to the airport terminal area falls within the Runway object Free zone. This project consists of the construction of a new airport access roadway along the eastern property line of the airport to access the new terminal area. The roadway will connect Highway 36 to the new terminal area and will eliminate a runway obstruction. This project is broken out into three Construction Phases. Construction Phase IIB consists of excavation, embankment damage work and roadway subbase and base.

**Estimated Project Cost:**  
 (If applicable, attach a detailed construction cost estimate)

Classification	Estimated Cost
Administrative Expenses	\$ 3,000.00
Land Acquisition Cost	
Engineering Fees	\$ 6,000.00
Survey	
Geotechnical	
Estimated Construction Cost	\$ 789,693.00
Construction Inspection	\$ 75,000.00
Construction Administration Fees	\$ 30,000.00
Construction Testing	\$ 30,000.00
Equipment Purchase Cost	
Other: ()	
Other: ()	
<b>Total Estimated Project Cost</b>	<b>\$ 933,693.00</b>

**Funding Sources:**

Source	% Contribution	Funds
Federal Funds	0%	
State Funds	100%	\$ 933,693.00
Local Contribution	0%	
Other: (define)	0%	
<b>Total Estimated Project Cost</b>		<b>\$ 933,693.00</b>

**Attach the following:** (as identified in Louisiana Administrative Code Title 70, Part IX §307 and §315)  
 Sketch of Project(s) on the airport's approved Airport Layout Plan  
 Any additional information necessary for prioritization, ie. Detailed Construction Cost Estimate, Resolution for Local Funds Contribution, Additional Documentation providing Justification for the Project, Environmental Clearance Documentation



NO.	DATE	REVISION OR CHANGE NUMBER	DESCRIPTION

PREPARED BY:  
 JACQUES F. FIALA  
 DESIGNER  
 CHECKED BY:  
 JOSEPH A. COTTER  
 LICENSE # 18111  
 STATE OF LOUISIANA  
 MECHANICAL ENGINEERING  
 DATE: 04/2025

DESIGNED	CHECKED	DATE
JAC	CMB	04/2025

PROJECT	STATE	PROJECT NUMBER
H.016209	LA	

SHEET NUMBER: 17



SCALE: 1"=100'

**OPINION OF PROBABLE PROJECT COST**

ST. TAMMANY REGIONAL AIRPORT  
 AIRPORT ACCESS ROAD RELOCATION PHASE II B

REF NO.	ITEM DESCRIPTION	UNIT OF MEASURE	QUANTITY	UNIT PRICE	UNIT PRICE EXTENSION
201-01-00100	CLEARING AND GRUBBING	LUMP	1	\$ 50,000.00	\$ 50,000.00
203-01-00100	GENERAL EXCAVATION	CUYD	5586	\$ 23.00	\$ 128,478.00
203-03-00100	EMBANKMENT	CUYD	870	\$ 26.00	\$ 22,620.00
203-04-00200	NON-PLASTIC EMBANKMENT (SAND)	CUYD	2860	\$ 42.00	\$ 120,120.00
203-08-00100	GEOTEXTILE FABRIC	SOYD	4861	\$ 3.00	\$ 14,583.00
204-06-00100	TEMPORARY SILT FENCING	LNFT	4160	\$ 3.50	\$ 14,560.00
302-02-08020	CLASS II BASE COURSE (8" THICK)(CRUSHED STONE)	SOYD	5575	\$ 43.50	\$ 242,512.50
304-01-00100	LIME	TON	27	\$ 400.00	\$ 10,800.00
304-02-00200	LIME TREATMENT (TYPE B) (8-1/2" THICK)	SOYD	2585	\$ 4.00	\$ 10,340.00
701-03-01022	STORM DRAIN PIPE (18" RCP/RPVC)	LNFT	99	\$ 155.00	\$ 15,345.00
701-03-01082	STORM DRAIN PIPE (36" RCP/RPVC)	LNFT	52	\$ 198.00	\$ 10,296.00
726-01-00100	BEDDING MATERIAL	CUYD	15	\$ 155.00	\$ 2,325.00
727-01-00100	MOBILIZATION	LUMP	1	\$ 50,000.00	\$ 50,000.00
729-01-00100	SIGN (TYPE A)	SOFT	30.8	\$ 30.00	\$ 924.00
739-01-00100	HYDRO-SEEDING	ACRE	1	\$ 5,000.00	\$ 5,000.00
740-01-00100	CONSTRUCTION LAYOUT	LUMP	1	\$ 20,000.00	\$ 20,000.00
SUB-TOTAL ESTIMATED CONSTRUCTION COST					\$ 717,903.50
CONSTRUCTION CONTINGENCY (10%)					\$ 71,790.35
TOTAL ESTIMATED CONSTRUCTION COST					<b>\$789,693.85</b>

Bidding	\$6,000.00
RI	\$75,000.00
CA	\$30,000.00
Testing	\$30,000.00
Administrative	\$3,000.00
	<b>\$933,693.85</b>

# Louisiana Airport Construction and Development Priority Program FISCAL YEAR 2026-2027 Project Application

<b>Airport Sponsor:</b>	St. Tammany Parish Government		
<b>Airport:</b>	St. Tammany Regional Airport		
<b>No. and Street/P.O. Box:</b>	21454 Koop Drive		
<b>City, State, Zip Code:</b>	Mandeville, LA 70471		
<b>PROJECT TITLE/DESCRIPTION:</b>		<b>Funding Year Requested:</b>	
Runway 18/36 Extension (1200')		2030	
<b>PROJECT SCOPE &amp; JUSTIFICATION:</b>			
<p>The Airport continues to have a growing need from the community and aircraft users requiring a runway length of 4,000 ft. This project will be a multi-year phased project to extend the existing runway to 4200' x 75'. The proposed 1200' extension would utilize a flexible pavement section and designed for the critical aircraft. The project would also include installation of edge lighting and required airfield signage. The proposed project includes design, environmental, bidding, grant administration, construction, and construction related professional services.</p>			
<b>Estimated Project Cost:</b>			
(If applicable, attach a detailed construction cost estimate)			
	Classification	Estimated Cost	
	Administrative Expenses	\$	10,000.00
	Land Acquisition Cost		
	Engineering Fees	\$	330,000.00
	Survey	\$	50,000.00
	Geotechnical	\$	25,000.00
	Estimated Construction Cost	\$	4,180,957.00
	Construction Inspection	\$	200,000.00
	Construction Administration Fees	\$	95,300.00
	Construction Testing	\$	30,000.00
	Other: (Estimated Wetlands Mitigation)	\$	350,000.00
	Other: (Grant Administration)	\$	30,000.00
	Other: (Environmental Assessment and Permitting)	\$	200,000.00
	<b>Total Estimated Project Cost</b>	<b>\$</b>	<b>5,501,257.00</b>
<b>Funding Sources:</b>			
	Source	% Contribution	Funds
	Federal Funds	90%	\$ 4,951,131.30
	State Funds	10%	\$ 550,125.70
	Local Contribution	0%	
	Other: (define)	0%	
	<b>Total Estimated Project Cost</b>	<b>\$</b>	<b>5,501,257.00</b>
<b>Attach the following:</b> (as identified in Louisiana Administrative Code Title 70, Part IX §307 and §315)			
<p>Sketch of Project(s) on the airport's approved Airport Layout Plan  Any additional information necessary for prioritization, ie. Detailed Construction Cost Estimate, Resolution for Local Funds Contribution, Additional Documentation providing Justification for the Project, Environmental Clearance Documentation</p>			



**OPINION OF PROBABLE PROJECT COST**

ST. TAMMANY PARISH GOVERNMENT  
 PO BOX 628  
 COVINGTON, LA 70434

ST. TAMMANY REGIONAL AIRPORT  
 RUNWAY 13/36 EXTENSION (1200')

RUNWAY 18/36 RUNWAY REHABILITATION - SUMMARY OF ESTIMATED CONSTRUCTION COSTS					
REF NO.	ITEM DESCRIPTION	UNIT OF MEASURE	QUANTITY	UNIT PRICE	UNIT PRICE EXTENSION
105	MOBILIZATION	LUMP	1	\$ 235,000.00	\$ 235,000.00
P-151-4.3	GRUBBING	ACRE	21	\$ 6,000.00	\$ 126,000.00
P-152-4.1	UNCLASSIFIED EXCAVATION	CUYD	25,000	\$ 20.00	\$ 500,000.00
P-152-4.3	MUCK EXCAVATION	CUYD	4,500	\$ 25.00	\$ 112,500.00
P-152-4.5	BORROW EXCAVATION	CUYD	50000	\$ 27.00	\$ 1,350,000.00
P-154-5.1	SUBBASE COURSE	CUYD	3450	\$ 35.00	\$ 120,750.00
P-155-8.1	LIME TREATED SUBGRADE	SQYD	10300	\$ 6.00	\$ 61,800.00
P-155-8.2	LIME TREATED SUBGRADE	TON	114	\$ 250.00	\$ 28,500.00
P-156-5.1	TEMPORARY SEEDING	ACRE	12	\$ 1,000.00	\$ 12,000.00
P-156-5.3	TEMPORARY BAILED HAY SEDIMENT CHECK DAM	EACH	12	\$ 250.00	\$ 3,000.00
P-156-5.4	TEMPORARY SILT FENCING	LNFT	2700	\$ 3.50	\$ 9,450.00
P-209-5.1	CRUSHED AGGREGATE BASE COURSE (10" THICK)	SQYD	10300	\$ 35.00	\$ 360,500.00
P-401-8.1A	BITUMINOUS SURFACE COURSE	TON	2300	\$ 150.00	\$ 345,000.00
P-602-5.1	BITUMINOUS PRIME COAT	GAL	3900	\$ 5.00	\$ 19,500.00
P-603-5.1	BITUMINOUS TACK COAT	GAL	1000	\$ 5.00	\$ 5,000.00
P-620-5.1-1	RUNWAY AND TAXIWAY PAINTING	SQFT	12000	\$ 2.00	\$ 24,000.00
P-620-5.1-2	REFLECTIVE MEDIA	POUND	1020	\$ 4.00	\$ 4,080.00
T-901-5.1	HYDO SEEDING	ACRE	24	\$ 1,800.00	\$ 43,200.00
D-751	DRAINAGE STRUCTURES	LUMP	1	\$ 75,000.00	\$ 75,000.00
L-108-5.3A	UNDERGROUND CABLE #8 AWG 5 KV, INSTALLED IN DUCT OR CONDUIT	LNFT	7000	\$ 3.00	\$ 21,000.00
L-108-5.3B	UNDERGROUND CABLE 2 CONDUCTOR #14 AG TWISTED PAIR WITH GROUND, INSTALLED IN DUCT OR CONDUIT	LNFT	200	\$ 1.20	\$ 240.00
L-108-5.4	BARE COUNTERPOISE WIRE, INSTALLED IN TRENCH, INCLUDING GROUND RODS AND CONNECTORS	LNFT	3000	\$ 5.00	\$ 15,000.00
L-110-5.1	CONDUIT 2" SCH 40 PVC, DIRECT BURIED	LNFT	4700	\$ 11.00	\$ 51,700.00
L-110-5.4	TYPE I QUAZITE JUNCTION BOX	EACH	4	\$ 4,000.00	\$ 16,000.00
L-110-5.5	TYPE II L-867D JUNCTION BOX	EACH	4	\$ 3,000.00	\$ 12,000.00
L-125-5.1B	MEDIUM INTENSITY ELEVATED BASE MOUNTED RUNWAY EDGE LIGHT (L-861-Q WITH 45 WATT QUARTZ LAMP)	EACH	14	\$ 2,200.00	\$ 30,800.00
L-125-5.1C	MEDIUM INTENSITY ELEVATED BASE MOUNTED RUNWAY THRESHOLD LIGHT (L-861-Q WITH 45 WATT QUARTZ LAMP)	EACH	8	\$ 2,200.00	\$ 17,600.00
L-125-5.1D	RELOCATE PRECISION APPROACH PATH INDICATOR (PAPI-2) WITH CONCRETE PAD	EACH	2	\$ 20,000.00	\$ 40,000.00
L-125-5.1E	RELOCATE RUNWAY END IDENTIFIER LIGHTS (REILS) WITH CONCRETE PAD	EACH	2	\$ 9,000.00	\$ 18,000.00
L-125-5.1F	REMOVAL OF BASE MOUNTED LIGHTING FIXTURES AND CONCRETE PADS	EACH	8	\$ 800.00	\$ 6,400.00
S-1001	GEOTEXTILE FABRIC	SQYD	10300	\$ 3.50	\$ 36,050.00
S-1002	CONSTRUCTION HAUL ROAD	LNFT	700	\$ 120.00	\$ 84,000.00
S-1004	SPLICE AND REMOVE OR RECONNECT 2" CONDUIT	EACH	4	\$ 1,200.00	\$ 4,800.00
S-1005	TEMPORARY RUNWAY PAINTING	LUMP	1	\$ 12,000.00	\$ 12,000.00
<b>SUB-TOTAL ESTIMATED CONSTRUCTION COST</b>					<b>\$ 3,800,870.00</b>
<b>CONSTRUCTION CONTINGENCY (10%)</b>					<b>\$ 380,087.00</b>
<b>TOTAL ESTIMATED CONSTRUCTION COST</b>					<b>\$ 4,180,957.00</b>
<b>RESIDENT INSPECTION</b>					<b>\$ 200,000.00</b>
<b>MATERIALS TESTING</b>					<b>\$ 30,000.00</b>
<b>CONSTRUCTION ADMINISTRATION</b>					<b>\$ 95,300.00</b>
<b>TOTAL CONSTRUCTION</b>					<b>\$ 4,506,257.00</b>
<b>ENVIRONMENTAL ASSESSMENT AND PERMITTING ADMINISTRATION</b>					<b>\$ 200,000.00</b>
					<b>\$ 10,000.00</b>

ENGINEERING GRANT ADMINISTRATION (DESIGN & CONSTRUCTION)	\$ 30,000.00
ENGINEERING FEE & BIDDING	\$ 330,000.00
SURVEYING	\$ 50,000.00
GEOTECHNICAL INVESTIGATIONS	\$ 25,000.00
TOTAL ENGINEERING	<u>\$ 435,000.00</u>
WETLANDS MITIGATION	\$ 350,000.00

TOTAL ESTIMATED PROJECT COST	\$ 5,501,257.00
------------------------------	-----------------

**Louisiana Airport Construction and Development Priority Program  
FISCAL YEAR 2026-2027  
Project Application**

<b>Airport Sponsor:</b>	St. Tammany Parish Government
<b>Airport:</b>	St. Tammany Regional Airport
<b>No. and Street/P.O. Box:</b>	21454 Koop Drive
<b>City, State, Zip Code:</b>	Mandeville, LA 70471

<b>PROJECT TITLE/DESCRIPTION:</b> Airport Access Road Relocation (Phase IIC Construction)	<b>Funding Year Requested:</b> 2030
--	--

**PROJECT SCOPE & JUSTIFICATION:**  
 Airport Road, which is the main access from Highway 36 to the airport terminal area falls within the Runway object Free zone. This project consists of the construction of a new airport access roadway along the eastern property line of the airport to access the new terminal area. The roadway will connect Highway 36 to the new terminal area and will eliminate a runway obstruction. This project is broken out into three Construction Phases. Construction Phase IIC is the final phase and consists of Asphalt surface, aggregate sholders, striping and removal of existing Airport Road.

**Estimated Project Cost:**  
 (If applicable, attach a detailed construction cost estimate)

Classification	Estimated Cost
Administrative Expenses	\$ 3,000.00
Land Acquisition Cost	
Engineering Fees	\$ 6,000.00
Survey	
Geotechnical	
Estimated Construction Cost	\$ 596,867.00
Construction Inspection	\$ 50,000.00
Construction Administration Fees	\$ 20,000.00
Construction Testing	\$ 20,000.00
Equipment Purchase Cost	
Other: ()	
Other: ()	
<b>Total Estimated Project Cost</b>	<b>\$ 695,867.00</b>

**Funding Sources:**

Source	% Contribution	Funds
Federal Funds	0%	
State Funds	100%	\$ 695,867.00
Local Contribution	0%	
Other: (define)	0%	
<b>Total Estimated Project Cost</b>		<b>\$ 695,867.00</b>

**Attach the following:** (as identified in Louisiana Administrative Code Title 70, Part IX §307 and §315)  
 Sketch of Project(s) on the airport's approved Airport Layout Plan  
 Any additional information necessary for prioritization, ie. Detailed Construction Cost Estimate, Resolution for Local Funds Contribution, Additional Documentation providing Justification for the Project, Environmental Clearance Documentation



NO.	DATE	REVISION OR CHANGE	PREPARED BY

PREPARED BY:  
 JACQUES F. FIALA  
 CIVIL ENGINEER  
 LICENSE # LA 19811 - (M) - 05/19/2019  
 CHECKED BY:  
 JOSEPH A. COTTER  
 CIVIL ENGINEER  
 LICENSE # LA 19811 - (M) - 05/19/2019  
 DATE:  
 04/20/25

DESIGNED	CHECKED	DATE
JAC	CMB	

PROJECT	STATE	PROJECT
ST. TAMMANY	LA	H.016209

SHEET NUMBER: 17



SCALE: 1"=100'

**OPINION OF PROBABLE PROJECT COST**

ST. TAMMANY REGIONAL AIRPORT  
AIRPORT ACCESS ROAD RELOCATION PHASE IIC

REF NO.	ITEM DESCRIPTION	UNIT OF MEASURE	QUANTITY	UNIT PRICE	UNIT PRICE EXTENSION
202-02-02020	REMOVAL OF ASPHALT PAVEMENT	SOYD	4600	\$ 40.00	\$ 184,000.00
203-03-00100	EMBANKMENT	CUYD	300	\$ 26.00	\$ 7,800.00
301-04-00200	CLASS I BASE COURSE FOR SHOULDERS (6" THICK)	SOYD	2750	\$ 30.00	\$ 82,500.00
502-01-00100	ASPHALT CONCRETE	TON	1425	\$ 137.00	\$ 195,225.00
714-01-00600	SLAB SODDING (ST. AUGUSTINE)	SOYD	685	\$ 11.00	\$ 7,535.00
727-01-00100	MOBILIZATION	LUMP	1	\$ 40,000.00	\$ 40,000.00
729-01-00100	SIGN (TYPE A)	SOFT	30.8	\$ 30.00	\$ 924.00
732-01-02000	PLASTIC PAVEMENT STRIPING (4" WIDTH)(THERMOPLASTIC 125 MIL)	LNFT	1000	\$ 3.00	\$ 3,000.00
732-01-02080	PLASTIC PAVEMENT STRIPING (24" WIDTH)(THERMOPLASTIC 125 MIL)	LNFT	22	\$ 16.00	\$ 352.00
732-01-05000	PLASTIC PAVEMENT STRIPING (DOTTED LINE)(4" W)(2' L)(THERMO 125 MIL)	LNFT	2514	\$ 1.50	\$ 3,771.00
739-01-00100	HYDRO-SEEDING	ACRE	0.5	\$ 5,000.00	\$ 2,500.00
740-01-00100	CONSTRUCTION LAYOUT	LUMP	1	\$ 15,000.00	\$ 15,000.00
SUB-TOTAL ESTIMATED CONSTRUCTION COST					\$ 542,607.00
CONSTRUCTION CONTINGENCY (10%)					\$ 54,260.70
<b>TOTAL ESTIMATED CONSTRUCTION COST</b>					<b>\$ 596,867.70</b>

Bidding	\$6,000.00
RI	\$50,000.00
CA	\$20,000.00
Testing	\$20,000.00
Administrative	\$3,000.00
	<b>\$ 695,867.70</b>

**Louisiana Airport Construction and Development Priority Program  
FISCAL YEAR 2026-2027  
Project Application**

<b>Airport Sponsor:</b>	St. Tammany Parish Government
<b>Airport:</b>	St. Tammany Regional Airport
<b>No. and Street/P.O. Box:</b>	21454 Koop Drive
<b>City, State, Zip Code:</b>	Mandeville, LA 70471

<b>PROJECT TITLE/DESCRIPTION:</b> Airfield Perimeter Fencing	<b>Funding Year Requested:</b> 2030
---	--

**PROJECT SCOPE & JUSTIFICATION:**  
Presently the St. Tammany Regional Airport does not have any perimeter fencing in place to prevent wildlife or pedestrians from entering the runway safety area. This is considered a safety issue whereas, wildlife has been spotted on the airfield. Recently the Sponsor installed an automated gate to control access on Airport Road, however the remaining perimeter of the airfield remains unsecured. This project consists of the design and construction of 14,200 linear feet of perimeter fencing around the airport property along with access gates and ditch crossings.

**Estimated Project Cost:**  
(If applicable, attach a detailed construction cost estimate)

Classification	Estimated Cost
Administrative Expenses	
Land Acquisition Cost	
Engineering Fees	\$ 80,000.00
Survey	\$ 30,000.00
Geotechnical	
Estimated Construction Cost	\$ 521,620.00
Construction Inspection	\$ 40,000.00
Construction Administration Fees	\$ 15,000.00
Construction Testing	\$ 5,000.00
Equipment Purchase Cost	
Other: (Grant Administration)	\$ 7,500.00
Other: ()	
<b>Total Estimated Project Cost</b>	<b>\$ 699,120.00</b>

**Funding Sources:**

Source	% Contribution	Funds
Federal Funds	90%	\$ 629,208.00
State Funds	10%	\$ 69,912.00
Local Contribution	0%	
Other: (define)	0%	
<b>Total Estimated Project Cost</b>		<b>\$ 699,120.00</b>

**Attach the following:** (as identified in Louisiana Administrative Code Title 70, Part IX §307 and §315)  
Sketch of Project(s) on the airport's approved Airport Layout Plan  
Any additional information necessary for prioritization, ie. Detailed Construction Cost Estimate, Resolution for Local Funds Contribution, Additional Documentation providing Justification for the Project, Environmental Clearance Documentation



**Engineer's Opinion of Probable Construction Costs (Preliminary)**

**Airfield Perimeter Fence  
St. Tammany Regional Airport  
15-Aug-23**

Item No.	Description	Unit	Quantity	Unit Cost	Extension
C-105	Mobilization	Lump Sum	1	\$20,000.00	\$20,000.00
P-101	Clearing and Grubbing	Lump Sum	1	\$30,000.00	\$30,000.00
P-162	6' Chainlink Fencing w/ Barbed Wire Top	Linear Foot	14200	\$26.00	\$369,200.00
P-162	16' Access Gate	Each	5	\$2,000.00	\$10,000.00
P-162	Ditch Crossing (Special Detail)	Each	5	\$2,000.00	\$10,000.00
P-162	Automated Gate at Terminal	Each	1	\$25,000.00	\$25,000.00
P-162	Pedestrian Gate	Each	2	\$5,000.00	\$10,000.00
<b>Sub-total</b>					<b>\$474,200.00</b>
<b>Construction Contingency 10%</b>					<b>\$47,420.00</b>
<b>Total Estimated Construction Costs</b>					<b>\$521,620.00</b>

Estimated Construction Cost	<b>\$521,620.00</b>
Survey	<b>\$30,000.00</b>
Engineering Design	<b>\$80,000.00</b>
Construction Administration	<b>\$15,000.00</b>
Grant Administration	<b>\$7,500.00</b>
Resident Project Representative	<b>\$40,000.00</b>
Materials Testing	<b>\$5,000.00</b>
Total Estimated Project Budget	<b>\$699,120.00</b>