

NOTES:  
MEASURED BEARINGS BASED ON GRID NORTH  
LOUISIANA STATE PLANE SOUTH ZONE (1702)  
NAD 83 AS DERIVED FROM THE LSU C46 RTK NETWORK (2023.11).

SCALE: 1" = 200'

## LEGEND

- POWERPOLE
- 5/8" CAPPED IRON ROD SET
- OE OVERHEAD ELECTRIC
- PROPERTY LINE
- RIGHT OF WAY LINE
- CENTERLINE
- TOP OF BANK
- TOE OF STREAM

INTERSTATE 10  
60' RIGHT OF WAY  
I-10 SERVICE ROAD

TRACT 1  
45.33 ACRES

TRACT 2  
2.44 +/- ACRES

NOTE:  
BY STATE STATUTE THERE IS A 100' RIGHT OF WAY EACH WAY FROM THE TOP BANK OF AN IDENTIFIED DRAINAGE LATERAL. CONTACT THE JURISDICTIONAL DRAINAGE DISTRICT BEFORE BEGINNING WORK WITHIN THIS RIGHT OF WAY.

ST. TAMMANY PARISH  
FLOOD ZONE A1  
FLOOD ZONE B  
FLOOD ZONE C

# MINOR SUBDIVISION OF A 47 +/- ACRE PARCEL INTO TRACTS 1 & 2

SECTION 1, TOWNSHIP 9 SOUTH -  
RANGE 14 EAST,  
GREENSBURG LAND DISTRICT  
ST. TAMMANY PARISH, LOUISIANA

## OWNERS:

MARY F. POLLARD, ET AL

## REFERENCES:

- 1) LAKE VILLAGE PHASE 2 BY IVAN M. BORGES DATED MAY 27, 1978. FILED MAP# 595A.
- 2) HIDDEN OAKS SUBDIVISION PHASE 2 BY IVAN M. BORGES DATED JUNE 28, 1978. FILED MAP# 641B.
- 3) SURVEY MAP OF A CERTAIN PARCEL OF LAND FOR NATIONAL MEDICAL DEVELOPMENT CORP. BY: BORGES ENGINEERING, DATED: 5/19/1984, INSTRUMENT #544104.
- 4) A 5.474+/- ACRE PARCEL OF LAND LOCATED IN SECTION 1, T9S-R14E, G.L.D., NEAR THE CITY OF SLIDELL, ST. TAMMANY PARISH, LOUISIANA. BY: ALBERT A. LOVELL & ASSOC., INC., DATED: DECEMBER 28, 1982.
- 5) SURVEY MAP OF LOTS 8 & 9, HIDDEN OAKS SUBD., PHASE 2. BY: JOHN E. BONNEAU & ASSOCIATES, INC. DATED: APRIL 8, 1986.
- 6) SUBJECT PROPERTY DESCRIPTION FROM INSTRUMENT #635174.
- 7) DESCRIPTION FROM INSTRUMENT #1927504.

## FLOOD ZONE NOTE:

SURVEYOR HAS CONSULTED THE FEMA FLOOD INSURANCE RATE MAP (F.I.R.M.) FOR THIS LOCATION AND FOUND THAT THE SUBJECT PROPERTY IS PARTIALLY IN A SPECIAL FLOOD HAZARD AREA:

FLOOD ZONE: C, B, & A1,  
BASE FLOOD ELEVATION: NOT INDICATED  
FOR C AND B, 15'-17' FOR A1  
COMMUNITY PANEL NO. - 225205 0040 D  
EFFECTIVE DATE: - APRIL 21, 1999  
(CONTACT ST. TAMMANY PARISH FOR  
ADDITIONAL ELEVATION REQUIREMENTS.)

THE SERVITUDES AND RESTRICTIONS SHOWN HEREON ARE LIMITED TO THOSE SET FORTH IN THE INFORMATION PROVIDED TO US. THERE IS NO REPRESENTATION MADE BY THIS SURVEYOR THAT ALL APPLICABLE SERVITUDES AND RESTRICTIONS ARE SHOWN. TITLE WAS NOT RESEARCHED IN PREPARATION OF THIS SURVEY.

I CERTIFY THAT THIS PLAT REPRESENTS AN ACTUAL GROUND SURVEY MADE BY ME OR UNDER MY DIRECT SUPERVISION, AND IT DOES CONFORM TO THE REQUIREMENTS OF LA R.S. 33.5051 AND THE CURRENT LOUISIANA STANDARDS OF PRACTICE FOR BOUNDARY SURVEYS FOR A CLASS "C" SURVEY.

DATE OF SURVEY: 02/08/2023

P.O.B. TRACT 2 AND P.O.C. TRACT 1  
REPORTED TO BE THE S.E. CORNER  
OF THE S.W. QUARTER OF THE  
N.E. QUARTER, SECTION 1,  
T-9-S, R-14-E (R6)

## APPROVAL

SECRETARY OF THE PLANNING COMMISSION

DIRECTOR OF THE DEPARTMENT OF ENGINEERING

CLERK OF COURT

Monique T. Bringol, Deputy Clerk

DATE FILED

MAP FILE NO.

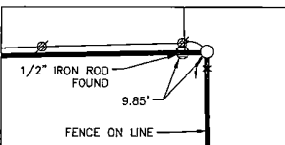

VICINITY MAP

NOT TO SCALE

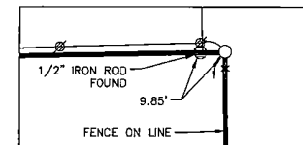

DETAIL

SCALE: 1" = 50'

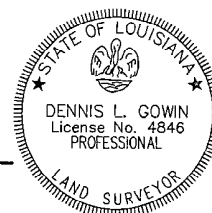
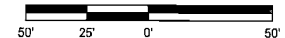

DENNIS L. GOWIN, PLS  
LA REG. 4846  
DGOWIN@DDGPC.COM

REVISION	BY
09/20/2023	DLG
REVISED FOR	
PARISH	
COMMENTS	

DIPLANTIS DESIGN GROUP, PC	SURVEY
15504 Brewer Road, Suite 101	Chalmette, LA 70303
Phone: 981.666.6666	1306 Canal Street, Suite 200
Lafayette, LA 70501	WWW.ddgpc.com



MINOR SUBDIVISION  
SLIDELL, LOUISIANA  
ST. TAMMANY PARISH

DRAWN	CHECKED
DLG	DLG
ISSUED DATE	09/20/2023
ISSUED BY	DLG
REVIEW	DLG
PROJECT NO.	20-238
FILE	20-238_5_09/20/2023
PRINT	

1-1