



51 Essex Street . San Antonio . TX 78210
 P.210.943.3777 E. info@creoarc.com
 www.creoarc.com

Design Team
 Consultant Essential Light Design Studio
 Address 3027 Clover Street
 Address Dallas, TX 75226
 Phone (972)415-8655
 Fax
 e-mail jill@essentiallight.com

Consultant
 Address
 Address
 Phone
 Fax
 e-mail

CLIENT
 NAME: Justin Haschke
 ADDRESS: FM 988 NW & Pecan Hill Dr.

PROJECT
 Stephenville Office



ARCHITECT STAMP

NOT FOR CONSTRUCTION
 FOR PD REGULATORY
 APPROVAL ONLY

REVISIONS		
No.	Description	Date
1	PERMIT ISSUE	05/13/2022

SHEET TITLE
**SITE LIGHTING
 PLANS**

DWG INFO
 PROJECT: 2022-01
 ISSUE DATE: 01/07/2022
 DRAWN BY: DN
 CHECKED BY: DN, JK

SHEET **LT1.1**

Lighting Legend

- Wall Mounted Adjustable
- Wall Mounted Ceiling Wash
- Ceiling Mounted Adjustable
- Ceiling Mounted Wallwash
- Recessed Adjustable Accent
- Recessed Fixture
- Recessed Wall Washer
- Recessed Double Wall Washer
- Recessed Corner Wall Washer
- Wall Mounted Fixture
- Stake Mounted Fixture
- Surface Mounted Fixture
- Decorative Wall Sconce
- Decorative Pendant, Chandelier or Ceiling Mount
- Decorative Table or Floor Lamp
- PAR Cove Lighting
- Linear Lighting (Horizontal)
- Linear Lighting (Vertical)
- Track Fixture
- Fluorescent Strip
- Recessed 1x4
- Recessed 2x2
- Recessed 2x4
- Recessed 1x4 with louver
- Wall Mounted Linear Strip w/Lens
- Suspended Linear
- Fiber Optic Illuminator - must be accessible
- Stem Mounted Rectangular Accent
- Ceiling Mounted Rectangular Accent
- Recessed Rectangular Wall Washer
- Step Light
- Well Light
- Stake Mounted Adjustable
- Stake Mounted Horiz/LinearAdjustable
- Fan with Light Kit
- Pole Mounted Single Head
- Pole Mounted Double Head - Back to Back
- Bollard
- Exit Sign
- Remote Transformer (xxx=VA Rating)
- Dimmed Floor Receptacle (NEMA 6-20R Note 2)
- Dimmed Duplex Receptacle (NEMA 6-20R Note 2)
- Wallbox Dimmer or Switch
- Remote Keypad
- Partition Control
- Lighting Control Panel - Dimmer Rack

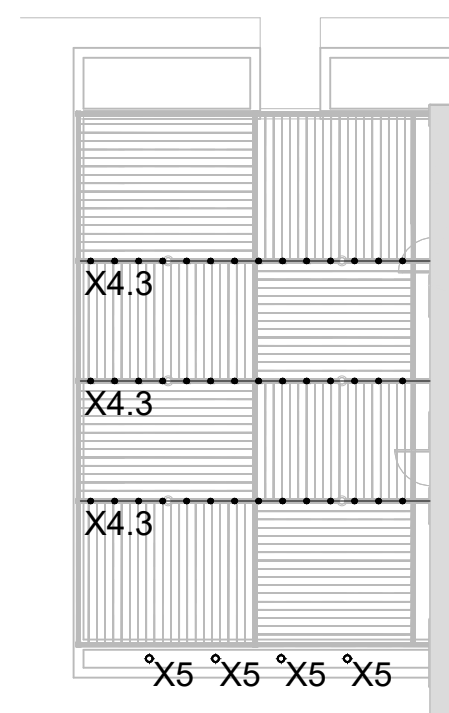
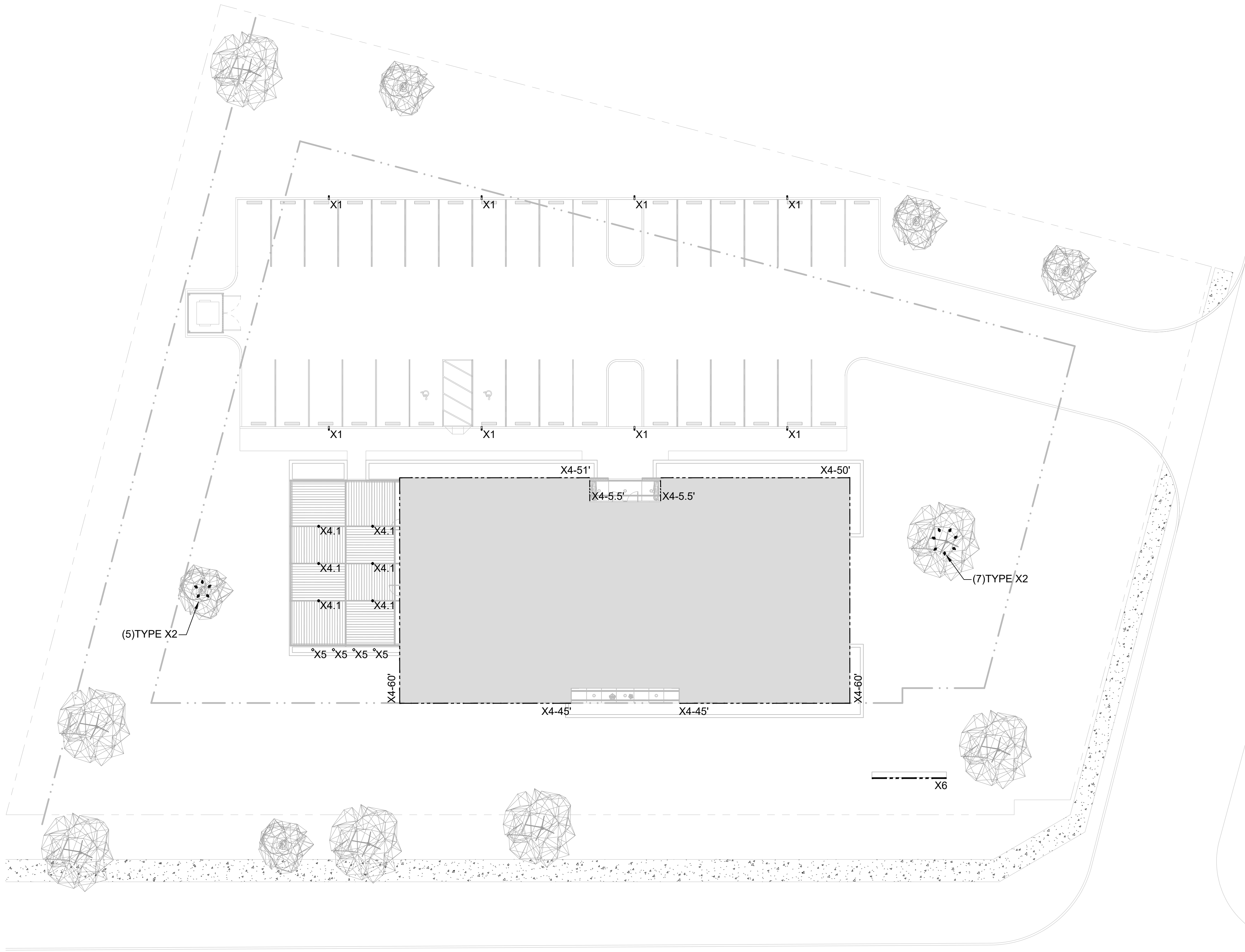

1 PATIO LIGHTING PLAN - OPTION 1
 1/16" = 1'-0"

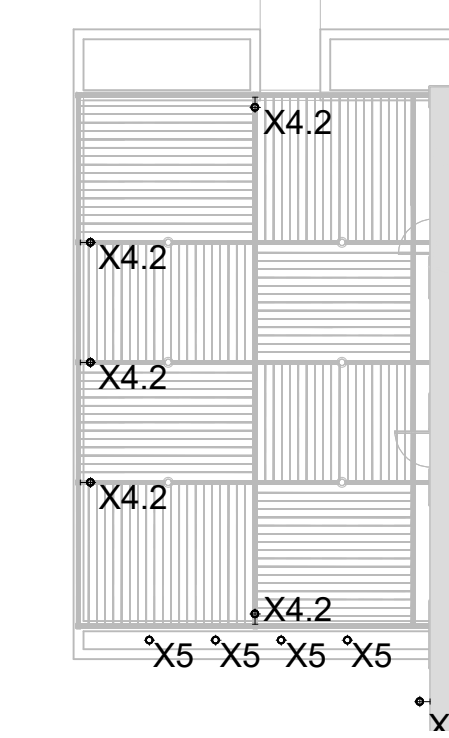

1 PATIO LIGHTING PLAN - OPTION 2
 1/16" = 1'-0"

1 SITE LIGHTING PLAN - BUILDING FACADE OPTION 1
 1/16" = 1'-0"