

CENTERLINE WEST FREY STREET

CENTERLINE NORTH CHARLOTTE AVE.

Asphalt Paving

conc. curb & gutter

Buried Telephone

N 60°00' E 101.0'

530°00' E 90.2'

Fd.I.R.

Lee Edwin Terry  
Vol. 824, Pg 368 D.R. 458, Pg 548  
LOT 8A BLOCK 139 CITY  
S.I.R. 19.5'

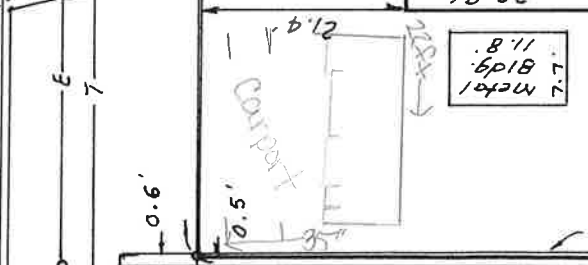

CONC. FOUND  
WOOD FRAME  
BRICK SID  
COMP SGL ROOF

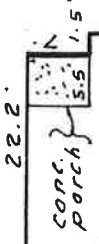

LOT 58  
BLOCK 4  
L.H. GROESBEECK

ADDN.

26.2'

23.5'

6.1'

6.4'

0.4'

S.I.R.

S 60°00' W 101.0'

LOT 57

Notes: Bearings shown  
Are Plot Bearings

Scale 1" = 20'

FOR: LARRY W. MOORE and REDONA G. MOORE  
898 NORTH CHARLOTTE AVENUE  
STEPHENVILLE, TEXAS 76401

I, WAYNE GRAHAM, A REGISTERED PROFESSIONAL LAND SURVEYOR OF THE STATE OF TEXAS DO HEREBY AFFIRM THAT THIS PLAT OF LOT NO. 58, IN BLOCK NO. 4, OF THE L. H. GROESBEECK ADDITION TO THE CITY OF STEPHENVILLE, IN ERATH COUNTY, ACCORDING TO MAP THEREOF RECORDED IN VOLUME 393, PAGE 564, OF THE DEED RECORDS OF ERATH COUNTY, TEXAS IS TRUE AND CORRECT TO THE BEST OF MY KNOWLEDGE AND BELIEF AND REPRESENTS A SURVEY MADE ON THE GROUND AND THAT THERE ARE NO VISIBLE EASEMENTS, ENCROACHMENTS OR PROTRUSIONS EXCEPT AS SHOWN HEREON AND THAT THE IMPROVEMENTS ON SAID PROPERTY DO NOT SHOW TO BE EFFECTED BY THE 100 YEAR FLOOD ZONE AS SHOWN ON THE FIRM FLOOD INSURANCE RATE MAP, COMMUNITY PANEL NO. 480220 0004 C, MAP REVISED JULY 16, 1991.

REGISTERED PROFESSIONAL LAND SURVEYOR  
REGISTRATION NO. 1529  
DATED THIS THE 10TH DAY OF MARCH, 1995.