

STRAND ST & WAPAMA WAY CORNER

ST. HELENS, OREGON



LOT IN QUESTION



IMAGE FROM USEPA AREA-WIDE PLANNING PROJECT RESOLUTION 1765

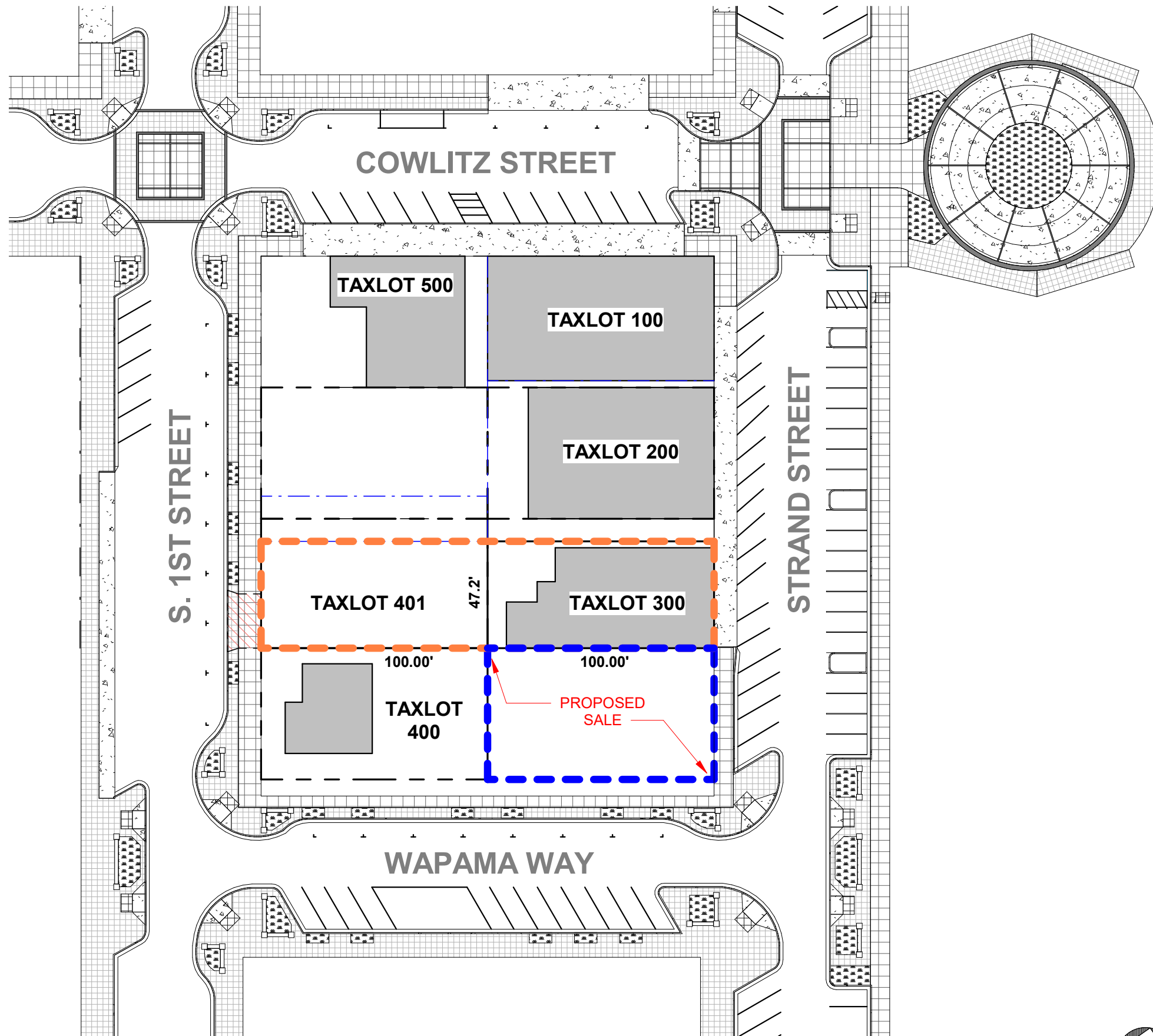

1 (P) SITE PLAN - WATERFRONT DEVELOPMENT
1" = 50'-0"



S. 1ST STREET

STRAND STREET

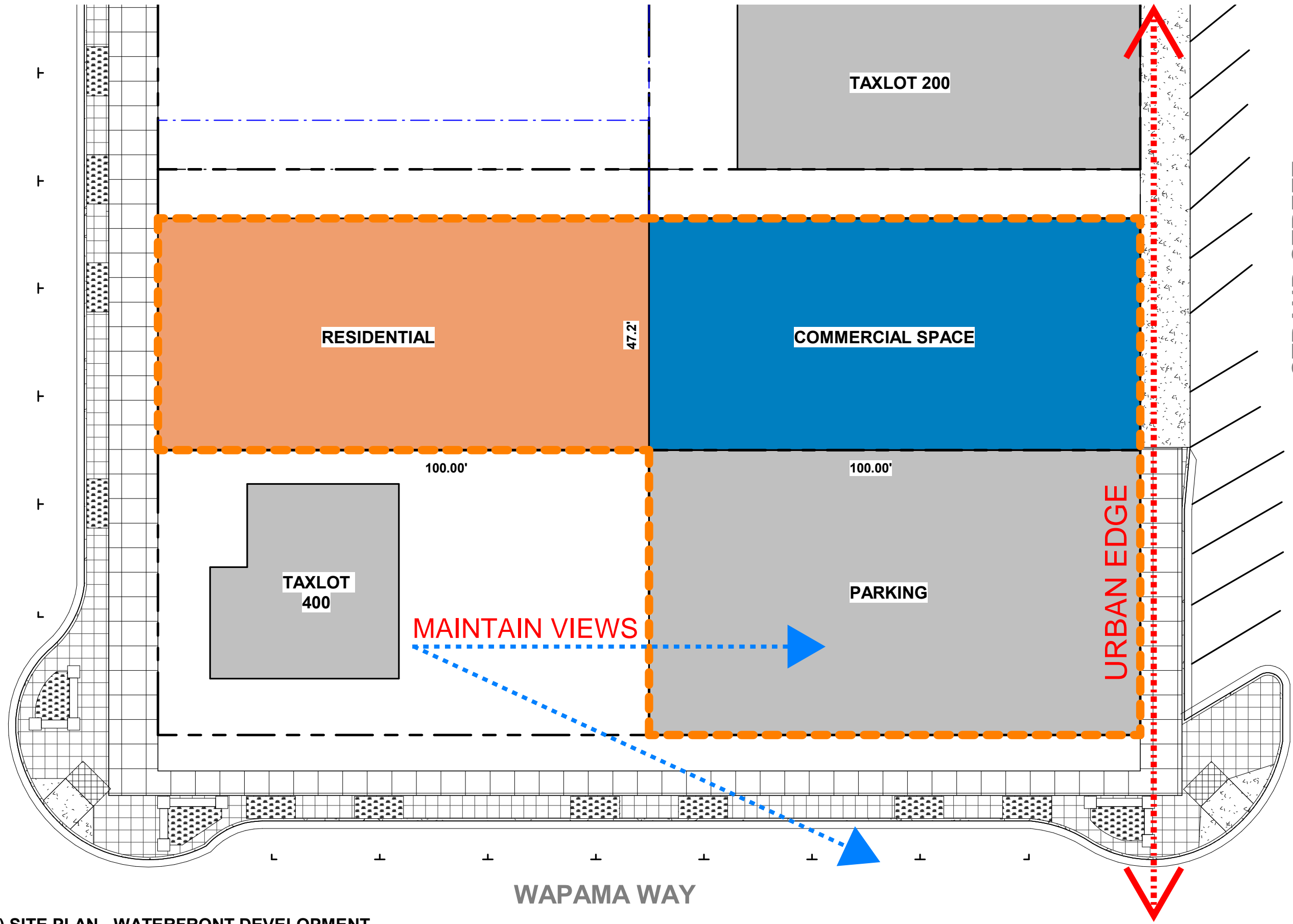

1 (P) SITE PLAN - WATERFRONT DEVELOPMENT
 1" = 20'-0"