





06-14-23

OVERHEAD VIEW

ISSUES & REVISIONS	DATE

I hereby certify that this plan, specification, or report was prepared by me or under my direct supervision and that I am a duly Licensed Architect under the laws of the State of Minnesota

Christine Soma
Date: 12/1/2022 Lic No: 50745

COMMISSION NO: 83771-20130

DRAWN BY: Author

CHECKED BY: Checker

SHEET **A2.**
5



06-14-23

MAIN ENTRY

ISSUES & REVISIONS	DATE

I hereby certify that this plan, specification, or report was prepared by me or under my direct supervision and that I am a duly Licensed Architect under the laws of the State of Minnesota

Christine Soma
Date: 12/1/2022 Lic No: 50745

COMMISSION NO: 83771-20130

DRAWN BY: Author

CHECKED BY: Checker

SHEET **A2.**
6



06-14-23

REAR COURTYARD

ISSUES & REVISIONS	DATE

I hereby certify that this plan, specification, or report was prepared by me or under my direct supervision and that I am a duly Licensed Architect under the laws of the State of Minnesota

Date: 12/1/2022
Christine Soma
Lic No: 50745

COMMISSION NO: 83771-20130

DRAWN BY: Author

CHECKED BY: Checker

SHEET **A2.**

7

SITE PLAN GENERAL NOTES

A) SITE INFORMATION HAS BEEN TAKEN FROM A SITE SURVEY PREPARED BY SABBATEK, 12800 WHITEWATER DRIVE, SUITE 300, MINNETONKA, MN 55343 DATED 12/08/20. GENERAL CONTRACTOR IS TO VERIFY ALL SITE INFORMATION BEFORE STARTING CONSTRUCTION, AND NOTIFY THE ARCHITECT IN WRITING OF ANY DISCREPANCIES.
 B) REFER TO THE GENERAL NOTES FOR OTHER APPLICABLE INFORMATION.



POPE DESIGN GROUP
 767 N. EUSTIS STREET, SUITE 190
 ST. PAUL, MINNESOTA 55114
 651.642.9200
 WWW.POPEDESIGN.COM



VISTAPRAIRIE AT
EAGLE POINTE
 SENIOR LIVING COMMUNITY

VISTA PRAIRIE AT
 EAGLE POINTE
 ST. FRANCIS, MN

PERMIT SET 12-01-2022
 ASI #2 06-19-2023

SITE PLAN

ISSUES & REVISIONS	DATE
3 PERMIT SET	12/1/22
4 ASH#1	2/16/23
5 ASH#2	6/19/23

I hereby certify that this plan, specification, or report was prepared by me or under my direct supervision and that I am a duly Licensed Architect under the laws of the State of Minnesota

Date: 12/1/2022
 Lic No: 50745

COMMISSION NO: 83771-20130

DRAWN BY: JA

CHECKED BY: GW

SHEET

A1.1

TRUE SHEET SCALE

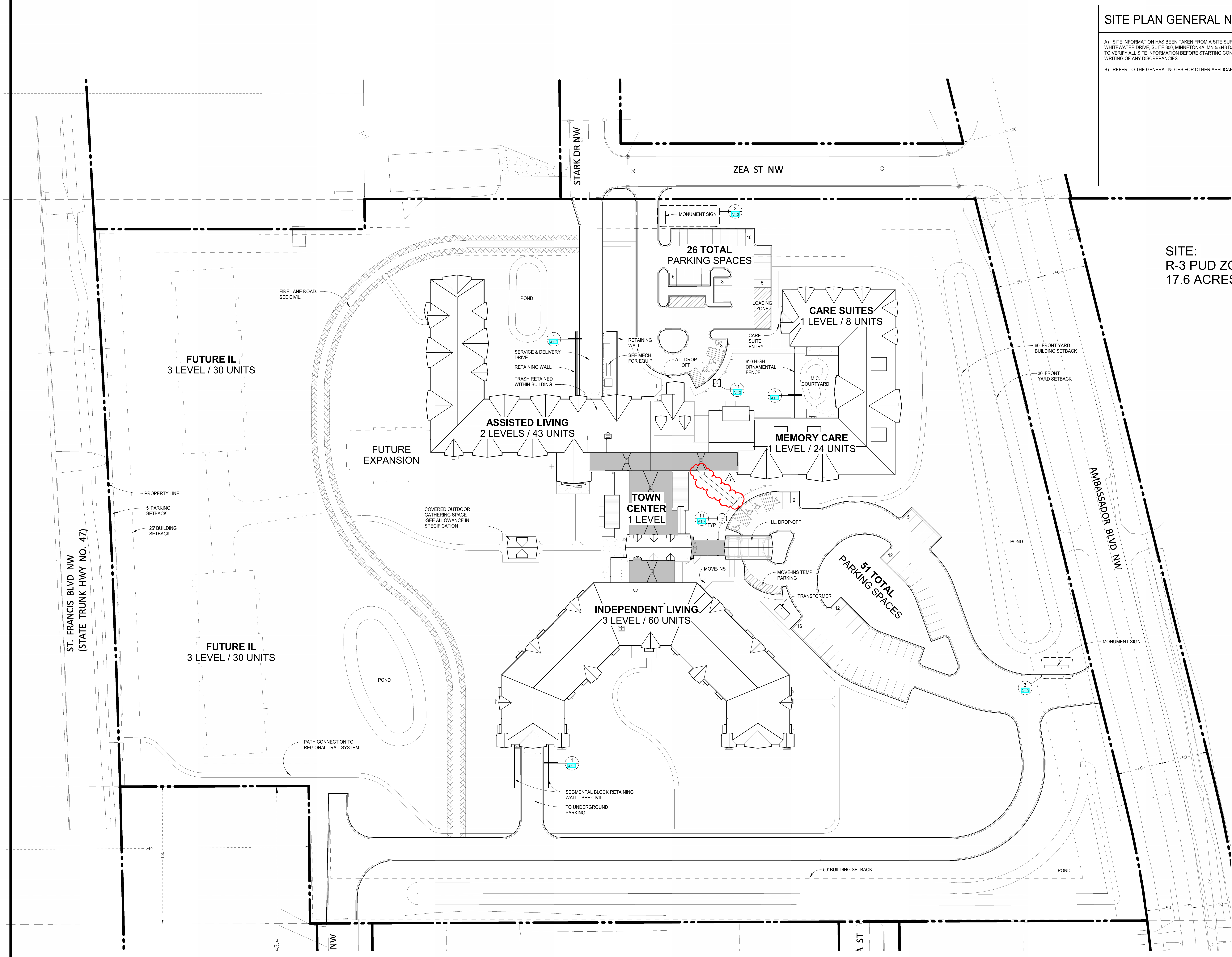

SITE:
 R-3 PUD ZONING
 17.6 ACRES

1 OVERALL MASTER SITE PLAN
 1" = 40'-0"

