

SEAL:

CONSULTANT:

GENERAL PLANTING NOTES: (NS)

- CORRESPONDING SPECIFICATION SECTION(S) HAVE NOT BEEN DEVELOPED FOR THIS PROJECT. ALL PERTINENT INFORMATION HAS BEEN PROVIDED ON THESE PLAN SHEETS. ENSURE THAT ALL RELATED ARCHITECTURAL AND CIVIL SHEETS ARE THOROUGHLY REVIEWED AS REFERENCE TO INFORMATION ON THE LANDSCAPE AND IRRIGATION SHEETS.
- VERIFY LOCATION OF ALL EXISTING AND PROPOSED UTILITIES EITHER ABOVE OR BELOW GRADE PRIOR TO BEGINNING ANY WORK. COORDINATE WITH ALL OTHER CONTRACTORS TO AVOID CONFLICTS BETWEEN IRRIGATION EQUIPMENT AND TREE/SHRUB PLACEMENT, AND/OR OTHER SITE AMENITIES.
- VERIFY THAT SUB GRADE PREPARATION HAS BEEN COMPLETED TO ACCEPTABLE TOLERANCES PRIOR TO BEGINNING ANY WORK.
- ALL WORK COMPLETED SHALL BE GUARANTEED FOR ONE (1) FULL YEAR.
- LANDSCAPED AREAS TO RECEIVE 2" OF APPROVED TOPSOIL IN LAWN AREAS AND 2" IN ALL SHRUB PLANTING AREAS.
- ACCEPTABLE TOPSOIL SHALL BE EITHER TAKEN FROM ON-SITE STRIPPED AND STOCKPILED TOPSOIL, OR IMPORTED FROM LOCAL SUPPLIERS, AND SHALL BE FRIABLE SURFACE SOIL TAKEN ONLY FROM THE "A" HORIZON AS DETERMINED BY THE USDA SOIL CONSERVATION SERVICE. FREE FROM TOXIC MATERIAL, NOXIOUS WEED SEEDS, SUBSOIL, STONES AND OTHER DEBRIS GREATER THAN 1" DIAMETER, MAXIMUM ELECTRICAL CONDUCTIVITY: 2.0 MHO/CM, MAXIMUM EXCHANGEABLE SODIUM PERCENTAGE: 10%, PH: 5.5 TO 6.5, ORGANIC CONTENT: 5-7%. PROVIDE THREE SEPARATE SOIL SAMPLES (TAKEN FROM THREE DIFFERENT LOCATIONS WITHIN THE SOIL SOURCE). SUBMIT TEST RESULTS FOR REVIEW AND APPROVAL BY THE OWNER/LANDSCAPE ARCHITECT PRIOR TO INSTALLATION.
- ALL LANDSCAPE AREAS SHALL BE IRRIGATED BY AN AUTOMATIC IRRIGATION SYSTEM - SEE IRRIGATION NOTES/SEE SHEET ?.
- COORDINATE WITH GENERAL CONTRACTOR FOR THE PROTECTION AND WATERING OF EXISTING PLANT MATERIAL IDENTIFIED AS TO REMAIN UNTIL THE NEW IRRIGATION SYSTEM IS OPERABLE.
- LAWN AREAS SHALL BE EDGED AS INDICATED IN DETAIL?, SHEET ?.
- SHRUB PLANTING AREAS SHALL BE MULCHED WITH 3" OF APPROVED ? UNLESS OTHERWISE NOTED. GROUND COVER AREAS SHALL BE DRESSED WITH 1" - 2" OF APPROVED ? UNLESS OTHERWISE NOTED. FINISHED GRADE OF MULCH SHALL NOT BE ABOVE OR MORE THAN 1" BELOW ADJOINING SURFACES.
- LAWN AREAS SHALL BE SEEDED/SODDED WITH LOCALLY PRODUCED SEED MIX CONSISTING OF A MINIMUM THREE VARIETIES OF BLUE GRASS SEED, AND AN ANNUAL RYE GRASS. HYDRO-SEED AT A RATE PER MANUFACTURER'S RECOMMENDATIONS.
- PLANT SYMBOLS SHALL DICTATE COUNT.

PLANT SCHEDULE L-201

TREES	CODE	BOTANICAL / COMMON NAME	CONT	CAL	HEIGHT	QTY
	ACV	ACER CIRCINATUM / VINE MAPLE	MULTI-STEM		5' MIN	6
	AJ	ACER PALMATUM 'JEDDELOH ORANGE' / JEDDELOH ORANGE JAPANESE MAPLE	15 GAL			2
	AB	ACER RUBRUM 'BRANDYWINE' / BRANDYWINE RED MAPLE	B & B	2.0" CAL		7
	AX	ACER TRUNCATUM X PLATANOIDES 'WARRENRED' / PACIFIC SUNSET® MAPLE	B & B	2.0" CAL		2
	CNP	CHAMAECYPARIS NOOTKATENSIS 'PENDULA' / WEEPING NOOTKA FALSE CYPRESS	B & B		8' HT.	1
	CG	CHAMAECYPARIS OBTUSA 'GRACILIS' / SLENDER HINOKI FALSE CYPRESS	15 GAL			7
	CJ	CORNUS CONTROVERSA 'JUNE SNOW-JFS' / JUNE SNOW™ GIANT DOGWOOD	B & B	2.0" CAL		1
	MY	MAGNOLIA ACUMINATA 'YELLOW BIRD' / YELLOW BIRD MAGNOLIA	2" CAL			3
	MG	METASEQUOIA GLYPTOSTROBILIDES / DAWN REDWOOD	B & B		7' MIN	6
	PO	PINUS NIGRA 'OREGON GREEN' / OREGON GREEN AUSTRIAN PINE	B & B		6' MIN	3
	SG	SEQUIADENDRON GIGANTEUM 'PENDULUM' / WEEPING GIANT SEQUOIA	B & B		8' MIN	2
SHRUBS	CODE	BOTANICAL / COMMON NAME	SIZE			
	AN	AZALEA X 'MAISCHNEE' / KIMONO MAY SNOW AZALEA	5 GAL			54
	CK	CORNUS SERICEA 'KELSEY' / KELSEY'S DWARF RED TWIG DOGWOOD	5 GAL			55
	HD	HAMAMELIS X INTERMEDIA 'DIANE' / DIANE WITCH HAZEL	15 GAL			6
	HR	HYDRANGEA QUERCIFOLIA 'RUBY SLIPPERS' / RUBY SLIPPERS OAKLEAF HYDRANGEA	5 GAL			19
	HS	HYPERICUM X INODORUM 'KOLSAN' / FLORALBERRY® SANGRIA ST. JOHN'S WORT	5 GAL			52
	IS	ILEX CRENATA 'SKY PENCIL' / SKY PENCIL JAPANESE HOLLY	5 GAL			34
	PC	PINUS MUGO 'VALLEY CUSHION' / VALLEY CUSHION MUGO PINE	5 GAL			14
	PH	PINUS SYLVESTRIS 'HILLSIDE CREEPER' / HILLSIDE CREEPER SCOTCH PINE	5 GAL			28
	RR	RHAMNUS FRANGULA 'RON WILLIAMS' / FINE LINE® ALDER BUCKTHORN	5 GAL			30
	RP	RHODODENDRON X 'POLARNACHT' / POLARNACHT RHODODENDRON	5 GAL			12
	RS	RHODODENDRON X 'SEPTEMBER SONG' / SEPTEMBER SONG RHODODENDRON	5 GAL			15
	RX	RHODODENDRON X 'YELLOW PETTICOATS' / YELLOW PETTICOATS RHODODENDRON	5 GAL			16
	RG	RHUS AROMATICA 'GRO-LOW' / GRO-LOW FRAGRANT SUMAC	5 GAL			38
	ST	SPIRAEA BETULIFOLIA 'TOR' / TOR BIRCHLEAF SPIRAEA	5 GAL			80
	TD	TAXUS X MEDIA 'DARK GREEN SPREADER' / DARK GREEN SPREADER YEW	5 GAL			39
ORNAMENTAL GRASSES	CODE	BOTANICAL / COMMON NAME	SIZE			
	PN	PENNISETUM ALOPECUROIDES 'GINGER LOVE' / GINGER LOVE FOUNTAIN GRASS	1 GAL			57
	SP	STIPA TENUISSIMA 'PONY TAILS' / PONY TAILS MEXICAN FEATHER GRASS	1 GAL			45
PERENNIALS	CODE	BOTANICAL / COMMON NAME	SIZE			
	AC	ATHYRIUM FILIX-FEMINA 'CRISTATUM' / CRESTED LADY FERN	1 GAL			34
	AF	ATHYRIUM FILIX-FEMINA 'LADY IN RED' / LADY IN RED FERN	1 GAL			31
	EG	ECHINACEA PURPUREA 'GREEN EYES' / GREEN EYES CONEFLOWER	1 GAL			81
	GR	GERANIUM X 'ROZANNE' / ROZANNE CRANESBILL	1 GAL			72
	HH	HEMEROCALLIS X 'HAPPY RETURNS' / HAPPY RETURNS DAYLILY	1 GAL			75
	LM	LIRIOPE MUSCARI 'MONROE'S WHITE' / MONROE'S WHITE LILYTURF	1 GAL			193
	LS	LIRIOPE MUSCARI 'SILVER DRAGON' / SILVER DRAGON LILYTURF	1 GAL			185
	PM	POLYSTICHUM MUNITUM / WESTERN SWORD FERN	1 GAL			98
GROUND COVERS	CODE	BOTANICAL / COMMON NAME	CONT			
	AU	ARCTOSTAPHYLOS UVA-URSI / KINNIKINNICK	1 GAL		36" o.c.	335
	GO	GALIUM ODORATUM / SWEET WOODRUFF	1 GAL		36" o.c.	191

REFERENCE NOTES SCHEDULE L-201

SYMBOL	DESCRIPTION	QTY
	LAWN EDGING, ALUMINIUM, 3/16" X 5 1/2", COLOR: BLACK	2,826 LF
	18" HIGH SEAT WALL	
	FIRE PIT	
SYMBOL	DESCRIPTION	QTY
	LAWN AREA, HYDROSEED	65,889 SF
	BELGARD FLAGSTONE PAVERS	1,976 SF
	GRASS PAVE	2,081 SF

LIGHTING SCHEDULE L-201

SYMBOL	MANUFACTURER/MODEL/DESCRIPTION	QTY
	36" BASALT BOLLARD PATHWAY LIGHT	46

BOULDER SCHEDULE

SYMBOL	DESCRIPTION	QTY	DETAIL
	BASALT BOULDER 36" X 30" X 30"/286	28	
	BASALT BOULDER 24" X 18" X 24"	29	

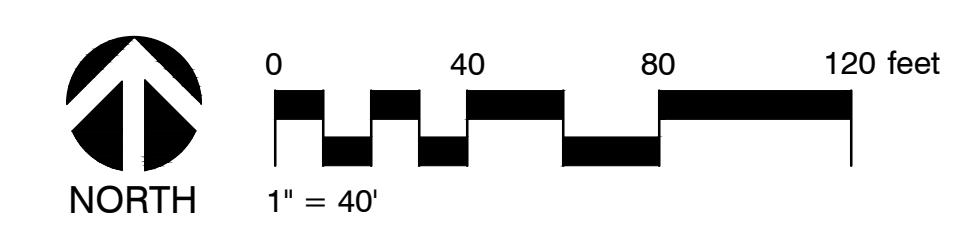
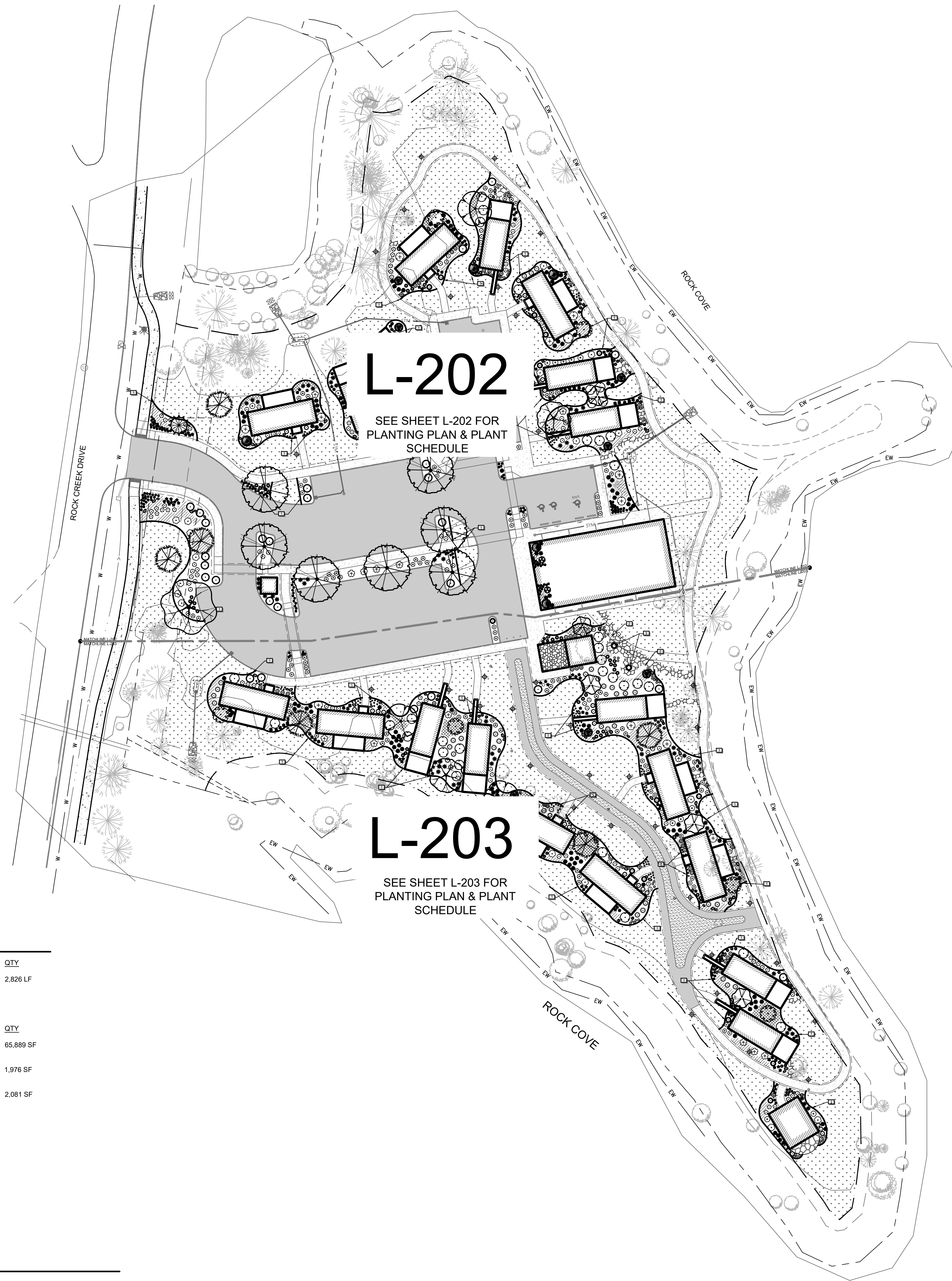

PLOT DATE: Wednesday, May 03, 2023 FILE LOCATION: P:\2334 Rock Creek Bagley\Drawings\2334_Landscape.dwg

PROJECT NUMBER: 2334
ROCK CREEK COVE HOSPITALITY

SHEET TITLE:
OVERALL
LANDSCAPE PLAN

Revisions:

PLANT SCHEDULE L-202

TREES	CODE	BOTANICAL / COMMON NAME	CONT	CAL.	HEIGHT	QTY
	ACV	ACER CIRCINATUM / VINE MAPLE	MULTI-STEM		5' MIN	2
	AJ	ACER PALMATUM 'JEDDELOH ORANGE' / JEDDELOH ORANGE JAPANESE MAPLE	15 GAL			2
	AB	ACER RUBRUM 'BRANDYWINE' / BRANDYWINE RED MAPLE	B & B	2.0' CAL		7
	AX	ACER TRUNCATUM X PLATANOIDES 'WARRENRED' / PACIFIC SUNSET® MAPLE	B & B	2.0' CAL		1
	CNP	CHAMAECYPARIS NOOTKATENSIS 'PENDULA' / WEEPING NOOTKA FALSE CYPRESS	B & B		8' HT.	1
	CG	CHAMAECYPARIS OBTUSA 'GRACILIS' / SLENDER HINOKI FALSE CYPRESS	15 GAL			4
	CJ	CORNUS CONTROVERSA 'JUNE SNOW-JFS' / JUNE SNOW™ GIANT DOGWOOD	B & B	2.0' CAL		1
	MY	MAGNOLIA ACUMINATA 'YELLOW BIRD' / YELLOW BIRD MAGNOLIA	2" CAL			1
	MG	METASEQUOIA GLYPTOSTROBOIDES / DAWN REDWOOD	B & B		7' MIN	3
	PO	PINUS NIGRA 'OREGON GREEN' / OREGON GREEN AUSTRIAN PINE	B & B		6' MIN	3
	SG	SEQUIADENDRON GIGANTEUM 'PENDULUM' / WEEPING GIANT SEQUIA	B & B		8' MIN	2
SHRUBS	CODE	BOTANICAL / COMMON NAME	SIZE			
	AN	AZALEA X 'MAISCHNEE' / KIMONO MAY SNOW AZALEA	5 GAL	29		
	CK	CORNUS SERICEA 'KELSEY' / KELSEY'S DWARF RED TWIG DOGWOOD	5 GAL	25		
	HD	HAMAMELIS X INTERMEDIA 'DIANE' / DIANE WITCH HAZEL	15 GAL	2		
	HR	HYDRANGEA QUERCIFOLIA 'RUBY SLIPPERS' / RUBY SLIPPERS OAKLEAF HYDRANGEA	5 GAL	13		
	HS	HYPERICUM X INODORUM 'KOLSAN' / FLORALBERRY® SANGRIA ST. JOHN'S WORT	5 GAL	21		
	IS	ILEX CRENATA 'SKY PENCIL' / SKY PENCIL JAPANESE HOLLY	5 GAL	13		
	PC	PINUS MUGO 'VALLEY CUSHION' / VALLEY CUSHION MUGO PINE	5 GAL	6		
	PH	PINUS SYLVESTRIS 'HILLSIDE CREEPER' / HILLSIDE CREEPER SCOTCH PINE	5 GAL	21		
	RR	RHAMNUS FRANGULA 'RON WILLIAMS' / FINE LINE® ALDER BUCKTHORN	5 GAL	9		
	RP	RHODODENDRON X 'POLARNACHT' / POLARNACHT RHODODENDRON	5 GAL	8		
	RS	RHODODENDRON X 'SEPTEMBER SONG' / SEPTEMBER SONG RHODODENDRON	5 GAL	8		
	RX	RHODODENDRON X 'YELLOW PETTICOATS' / YELLOW PETTICOATS RHODODENDRON	5 GAL	11		
	RG	RHUS AROMATICA 'GRO-LOW' / GRO-LOW FRAGRANT SUMAC	5 GAL	16		
	ST	SPIRAEA BETULIFOLIA 'TOR' / TOR BIRCHLEAF SPIREA	5 GAL	49		
	TD	TAXUS X MEDIA 'DARK GREEN SPREADER' / DARK GREEN SPREADER YEW	5 GAL	3		
ORNAMENTAL GRASSES	CODE	BOTANICAL / COMMON NAME	SIZE			
	PN	PENNISETUM ALOPECUROIDES 'GINGER LOVE' / GINGER LOVE FOUNTAIN GRASS	1 GAL	28		
	SP	STIPA TENUISSIMA 'PONY TAILS' / PONY TAILS MEXICAN FEATHER GRASS	1 GAL	17		
PERENNIALS	CODE	BOTANICAL / COMMON NAME	SIZE			
	AC	ATHYRIUM FILIX-FEMINA 'CRISTATUM' / CRESTED LADY FERN	1 GAL	19		
	AF	ATHYRIUM FILIX-FEMINA 'LADY IN RED' / LADY IN RED FERN	1 GAL	15		
	EG	ECHINACEA PURPUREA 'GREEN EYES' / GREEN EYES CONEFLOWER	1 GAL	48		
	GR	GERANIUM X 'ROZANNE' / ROZANNE CRANESBILL	1 GAL	31		
	HH	HEMEROCALLIS X 'HAPPY RETURNS' / HAPPY RETURNS DAYLILY	1 GAL	34		
	LM	LIRIOPE MUSCARI 'MONROE'S WHITE' / MONROE'S WHITE LILYTURF	1 GAL	145		
	LS	LIRIOPE MUSCARI 'SILVER DRAGON' / SILVER DRAGON LILYTURF	1 GAL	85		
	PM	POLYSTICHUM MUNITUM / WESTERN SWORD FERN	1 GAL	16		
GROUND COVERS	CODE	BOTANICAL / COMMON NAME	CONT			
	AU	ARCTOSTAPHYLOS LVA-URSI / KINNIKINNICK	1 GAL	36" o.c.		
	GO	GALIUM ODORATUM / SWEET WOODRUFF	1 GAL	36" o.c.		

REFERENCE NOTES SCHEDULE L-202

SYMBOL	DESCRIPTION	QTY	DETAIL
	LAWN EDGING, ALUMINUM, 3/16" X 5 1/2", COLOR: BLACK	1,414 LF	
	LAWN AREA, HYDROSEED	32,540 SF	
	BELGARD FLAGSTONE PAVERS	350 SF	

LIGHTING SCHEDULE L-202

SYMBOL	MANUFACTURER/MODEL/DESCRIPTION	QTY	DETAIL
	36" BASALT BOLLARD PATHWAY LIGHT	18	

BOULDER SCHEDULE

SYMBOL	DESCRIPTION	QTY	DETAIL
	BASALT BOULDER 36" X 30" X 30" 286	28	
	BASALT BOULDER 24" X 18" X 24"	29	

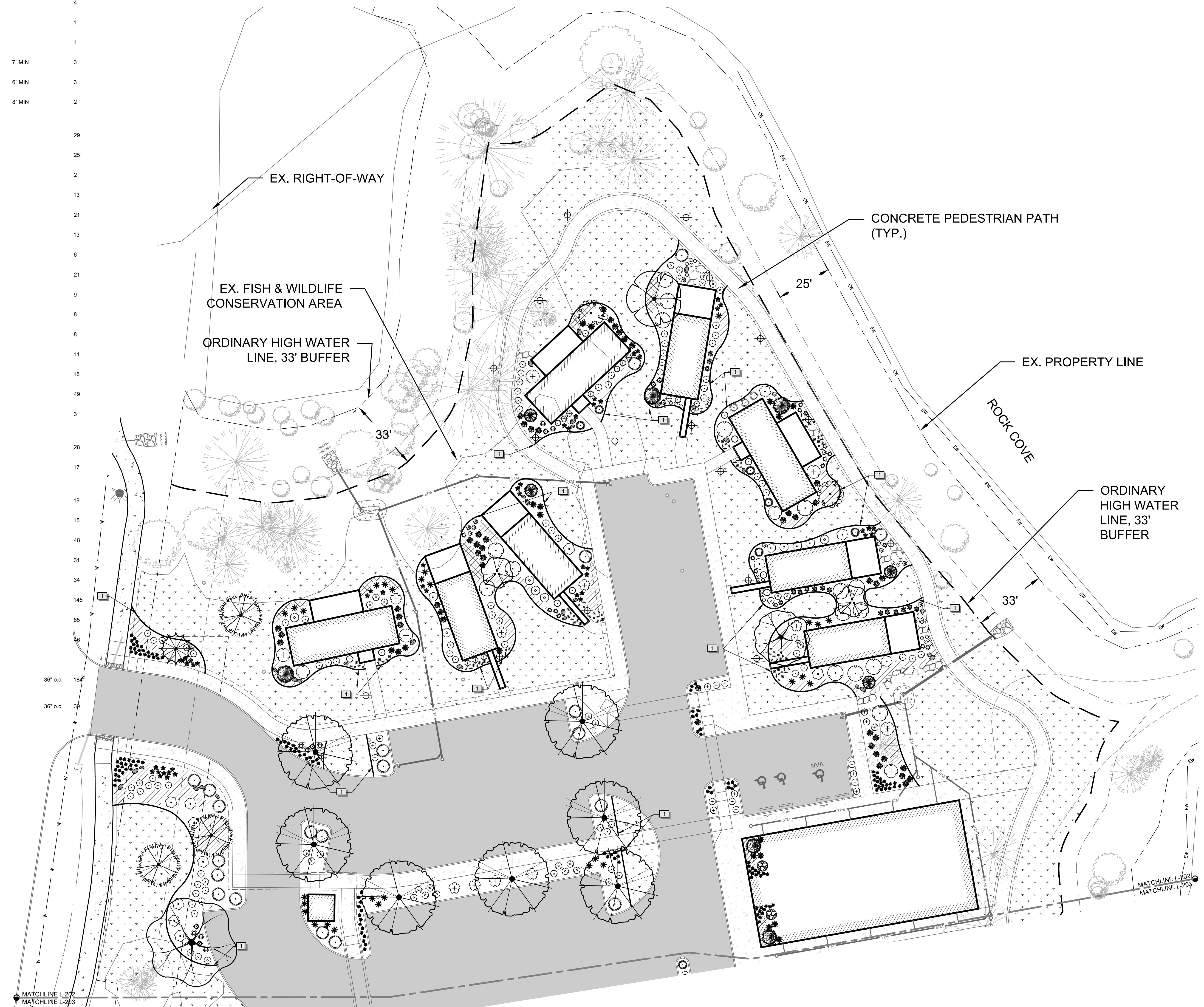

PLOT DATE: Wednesday, May 03, 2023 FILE LOCATION: P:\2334 Rock Creek Bagley\Drawings\2334_Landscape.dwg

CONSULTANT:

PROJECT NUMBER: 2334
ROCK CREEK COVE HOSPITALITY
DRAWN BY: JPL
CHECKED BY: TCS
STEVENS, WA 98648

SHEET TITLE:
NORTH
LANDSCAPE PLAN

Revisions:

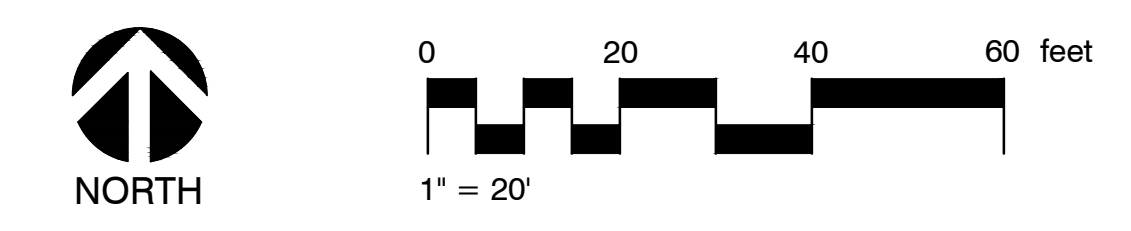



PLANT SCHEDULE L-203

TREES	CODE	BOTANICAL / COMMON NAME	CONT	CAL	HEIGHT	QTY
	ACV	ACER CIRCINATUM / VINE MAPLE	MULTI-STEM		5' MIN	4
	AX	ACER TRUNCATUM X PLATANOIDES 'WARRENRED' / PACIFIC SUNSET® MAPLE	B & B	2.0" CAL		1
	CG	CHAMAECYPARIS OBTUSA 'GRACILIS' / SLENDER HINOKI FALSE CYPRESS	15 GAL			3
	MY	MAGNOLIA ACUMINATA 'YELLOW BIRD' / 'YELLOW BIRD' MAGNOLIA	2" CAL			2
	MG	METASEQUOIA GLYPTOSTROBILIS / DAWN REDWOOD	B & B		7' MIN	3
SHRUBS	CODE	BOTANICAL / COMMON NAME	SIZE			
	AN	AZALEA X 'MAISCHNEE' / KIMONO MAY SNOW AZALEA	5 GAL			25
	CK	CORNUS SERICEA 'KELSEY' / KELSEY'S DWARF RED TWIG DOGWOOD	5 GAL			30
	HD	HAMAMELIS X INTERMEDIA 'DIANE' / DIANE WITCH HAZEL	15 GAL			4
	HR	HYDRANGEA QUERCIFOLIA 'RUBY SLIPPERS' / RUBY SLIPPERS OAKLEAF HYDRANGEA	5 GAL			6
	HS	HYPERICUM X INODORUM 'KOLSAF' / FLORALBERRY® SANGRIA ST. JOHN'S WORT	5 GAL			31
	IS	ILEX CRENATA 'SKY PENCIL' / SKY PENCIL JAPANESE HOLLY	5 GAL			21
	PC	PINUS MUGO 'VALLEY CUSHION' / VALLEY CUSHION MUGO PINE	5 GAL			8
	PH	PINUS SYLVESTRIS 'HILLSIDE CREEPER' / HILLSIDE CREEPER SCOTCH PINE	5 GAL			7
	RR	RHAMNUS FRANGULA 'RON WILLIAMS' / FINE LINE® ALDER BUCKTHORN	5 GAL			21
	RP	RHODODENDRON X 'POLARNACHT' / POLARNACHT RHODODENDRON	5 GAL			4
	RS	RHODODENDRON X 'SEPTEMBER SONG' / SEPTEMBER SONG RHODODENDRON	5 GAL			7
	RX	RHODODENDRON X 'YELLOW PETTICOATS' / YELLOW PETTICOATS RHODODENDRON	5 GAL			5
	RG	RHUS AROMATICA 'GRO-LOW' / GRO-LOW FRAGRANT SUMAC	5 GAL			22
	ST	SPIRAEA BETULIFOLIA 'TOR' / TOR BIRCHLEAF SPIREA	5 GAL			31
	TD	TAXUS X MEDIA 'DARK GREEN SPREADER' / DARK GREEN SPREADER YEW	5 GAL			36
ORNAMENTAL GRASSES	CODE	BOTANICAL / COMMON NAME	SIZE			
	PN	PENNISETUM ALOPECUROIDES 'GINGER LOVE' / GINGER LOVE FOUNTAIN GRASS	1 GAL			29
	SP	STIPA TENUISSIMA 'PONY TAILS' / PONY TAILS MEXICAN FEATHER GRASS	1 GAL			28
PERENNIALS	CODE	BOTANICAL / COMMON NAME	SIZE			
	AC	ATHYRIUM FILIX-FEMINA 'CRISTATUM' / CRESTED LADY FERN	1 GAL			15
	AF	ATHYRIUM FILIX-FEMINA 'LADY IN RED' / LADY IN RED FERN	1 GAL			16
	EG	ECHINACEA PURPUREA 'GREEN EYES' / GREEN EYES CONEFLOWER	1 GAL			33
	GR	GERANIUM X 'ROZANNE' / ROZANNE CRANESBILL	1 GAL			41
	HH	HEMEROCALLIS X 'HAPPY RETURNS' / HAPPY RETURNS DAYLILY	1 GAL			41
	LM	LIRIOPE MUSCARI 'MONROE'S WHITE' / MONROE'S WHITE LILYTURF	1 GAL			48
	LS	LIRIOPE MUSCARI 'SILVER DRAGON' / SILVER DRAGON LILYTURF	1 GAL			100
	PM	POLYSTICHUM MUNITUM / WESTERN SWORD FERN	1 GAL			52
GROUND COVERS	CODE	BOTANICAL / COMMON NAME	CONT			
	AU	ARCTOSTAPHYLOS UVA-URSI / KINKINNICK	1 GAL		36" o.c.	151
	GO	GALIUM ODORATUM / SWEET WOODRUFF	1 GAL		36" o.c.	152

REFERENCE NOTES SCHEDULE L-203

SYMBOL	DESCRIPTION	QTY
	LAWN EDGING, ALUMINUM, 3/16" X 5 1/2", COLOR: BLACK	1,412 LF
	18" HIGH SEAT WALL	
	FIRE PIT	
SYMBOL	DESCRIPTION	QTY
	LAWN AREA, HYDROSEED	33,349 SF
	BELGARD FLAGSTONE PAVERS	1,626 SF
	GRASS PAVE	2,081 SF

LIGHTING SCHEDULE L-203

SYMBOL	MANUFACTURER/MODEL/DESCRIPTION	QTY
	36" BASALT BOLLARD PATHWAY LIGHT	28

BOULDER SCHEDULE

SYMBOL	DESCRIPTION	QTY	DETAIL
	BASALT BOULDER 36" X 30" X 30"/286	28	
	BASALT BOULDER 24" X 18" X 24"	29	

