



CITY OF SPRING LAKE PARK
 1301 Eighty-First Avenue N.E.
 Spring Lake Park, MN 55432
 Ph: 763-784-6491 Fax: 763-792-7257

PUBLIC RIGHT-OF-WAY APPLICATION

SAP# 111035115

MGC# 24-74030

NAME/COMPANY: CENTERPOINT ENERGY

GOPHER 1-CALL REG. NO.: 0029

ADDRESS: 700 LINDEN AVE W, MINNEAPOLIS, MN 55403

CENTERPOINT ENERGY DESIGN TECH (TECH -ROSS BARKER-952-322-0383)

PHONE: (612) 321 - 5564

FAX:

E-MAIL ADDRESS: philip.woutat@centerpointenergy.com

NAME OF REPRESENTATIVE: RON EASON (NPL) -- REason@GoNPL.com

REPRESENTATIVE PHONE NO'S.: 612-363-9698

DESCRIPTION OF PROPOSED WORK: including a start date and completion date:

INSTALL 6 ANODES ON STEEL MAIN. 6 - 10" DRILL HOLES USING VAC TRUCK

START DATE: 03/15/2024

COMPLETION DATE: 12/31/2024

The City of Spring Lake Park reserves the right to modify the schedule as necessary in the issuance of the permit. Therefore, the dates stated on this application may not necessarily match actual approved dates.

EXPLANATION OF RESTORATION:

The site of each 10"-diameter drill hole is to be restored by our contractor, NPL, to each site's previous or better condition. This typically happens right after the hole is refilled, so from beginning of excavation to completion of restoration (if all goes as things should) typically takes 1.5 - 2 hours per hole.

Philip M.E. Woutat
 Authorized Representative Signature

Please waive permit fees per franchise agreement 3/6/2024

Date

FOR OFFICE USE ONLY

- PROOF OF CERTIFICATE OF INSURANCE:
- SCALED DRAWING SHOWING LOCATION
- COPY OF INSURANCE POLICIES (If Corporation; from Secretary of State)

- VERIFICATION DATE: *3/11/24*
- LETTER OF CREDIT OR CONST. BOND
 - COPY OF CERTIFICATE OF AUTHORITY (From M.P.U.C., State, or Federal Agency)

- PERMIT FEES:**
- Excavation Hole - \$150.00
 - Trench - \$70.00/100'+Hole fee
 - Emergency Hole - \$55.00
 - Obstruction Fee - \$50.00+.05/Ft.

Receipt No.:

Date:

Initials:

APPLICANT MUST CONTACT THE SPRING LAKE PARK PUBLIC WORKS DIRECTOR AT 763-792-7227 48 HOURS PRIOR TO COMMENCING WORK

Spring Lake Park, MN

Spring
Lake Park
High School

CP Area #2013
CP Section #35914
SW1/30/24

Ross Barker
952-322-0383
1/130/2023

WO#: 111035115
MGC#: 24-74030

Install 17# Anode
22' NCL 79TH AVE,
162' WCL TYLER ST
NE
(45.11151, -93.24710)

Install 17# Anode
22' NCL 79TH ST NE,
182' ECL TYLER ST
NE
(45.11150, -93.24577)

Install 17# Anode
24' NCL 79TH AVE NE,
90' ECL TAYLOR ST
NE
(45.11149, -93.24449)

Install 17# Anode
236' NCL 79TH AVE NE, 66'
WCL SB CENTRAL AVE
(45.11207, -93.24358)

Install 17# Anode
96' WCL FILMORE ST NE,
30' NNCL PARKING LOT
(45.11327, -93.24363)

Install 17# Anode
86' ECL NW PARKING LOT ENTRANCE RD,
9' NNCL PARKING LOT
(45.11362, -93.24491)

111035115

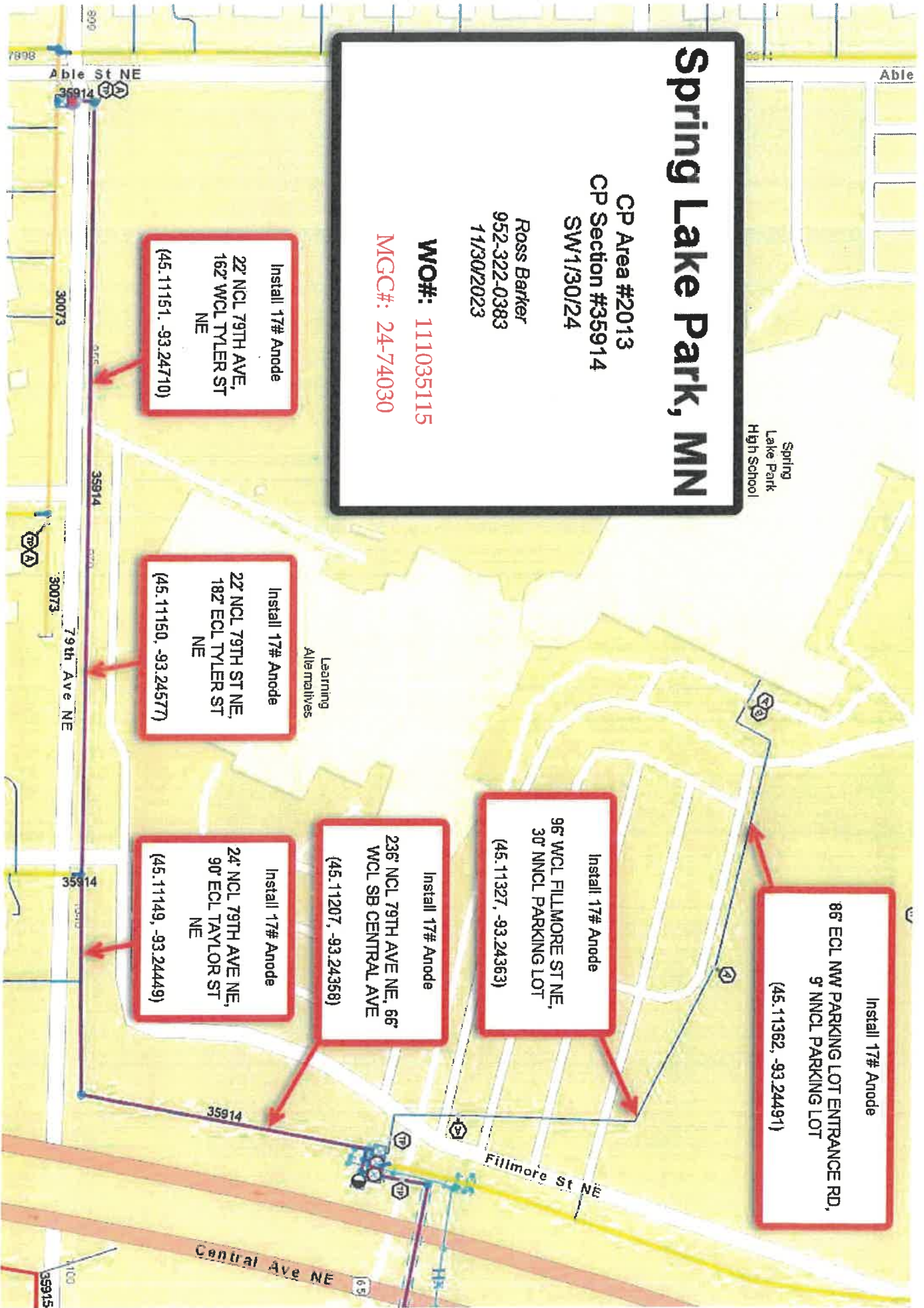

Spring Lake Park, MN

CP Area #2013
CP Section #35914
SW1/30/24

Ross Barker
952-322-0383
11/30/2023

WO#: 111035115
MGC#: 24-74030

Install 17# Anode
86' ECL NW PARKING LOT ENTRANCE RD,
6' BC, NORTH END PARKING LOT
(45.11362, -93.24491)

Install 17# Anode
96' WCL FILLMORE ST NE,
30' NINCL PARKING LOT
(45.11327, -93.24363)

Install 17# Anode
236' NCL 79TH AVE NE, 66'
WCL SB CENTRAL AVE
(45.11207, -93.24358)

Install 17# Anode
24' NCL 79TH AVE NE, 90'
ECL TAYLOR ST NE
(45.11149, -93.24449)

Install 17# Anode
22' NCL 79TH ST NE,
182' ECL TYLER ST NE
(45.11150, -93.24577)

Install 17# Anode
22' NCL 79TH AVE,
162' WCL TYLER ST NE
(45.11151, -93.24710)

1110 35115