



Public Right of Way Application

Applicant Information:

Name of Company: Xcel Energy

Address: 825 Rice St,

City/State/ZIP: St. Paul, MN, 55117

Phone Number: 919-655-5511

Fax Number: _____

Email Address: anne.wagner@xcelenergy.com

Representatives Name: Anne Wagner

Project Information:

Project Name: 114458710

Project Address/Location: 589 Rosedale Rd NE

City/State/ZIP: Minneapolis, MN 55432

Parcel Number(s): _____

Description of Work and restoration plan: (Attach additional pages if necessary)

Replace 1 existing deteriorating power pole
and equipment.

Duration of the Right of Way:

Start Date: 7/7/25

End Date: 12/31/25

The City of Spring Lake Park reserves the right to modify the schedule as necessary in the issuance of the permit. Therefore, the dates stated on this application may not necessarily match actual approved dates.

Attachments Required:

☒ Site Plan/Map

☒ Project Drawings

☒ Traffic Control Plan

☐ Proof of Insurance (copy of policy)

☐ Property Deed or Owner Authorization

☐ Environmental Impact Assessment (if applicable)

☐ Other: _____

Applicant's Certification:

I, the undersigned, certify that I am the owner or authorized agent of the owner, and that the information provided in this application is true and accurate to the best of my knowledge. I agree to comply with all applicable laws and regulations related to the requested right of way.

In lieu of an escrow fee, we will bill the project owner for actual restoration fees if needed.

Signature:  _____

Date: 7/7/25

For Office Use Only:

Application Number: _____

Date Received: 7/7/25

Reviewed By: CR

Approval Status: ☒ Approved ☐ Denied

Conditions of Approval/Reasons for Denial: _____

Signature of Reviewing Officer:  _____

Date: _____

Right of Way Permit - \$150.00

☐ Excavation Hole - \$150.00

☐ Emergency Hole - \$75.00

☐ Trench - \$70/100'

☐ Obstruction Fee - \$150.00

☐ Overhead Obstruction - \$150.00

☐ Boring Holes - \$50.00 per hole

☐ Other: _____

Instructions for Submission:

Complete the application form in its entirety.

Attach all required documents and plans.

Submit the application to info@slpmn.org or wbrown@slpmn.org.

Please verify specific requirements and guidelines with the appropriate agency before submission, as these can vary by location and project type.

APPLICANT MUST CONTACT THE SPRING LAKE PARK PUBLIC WORKS DIRECTOR AT 763-792-7227 48 HOURS PRIOR TO COMMENCING WORK.



NOTES:

1. The Work Vehicle should be pulled over as far off the roadway as possible, and shall display and operate a 360-degree flashing beacon.

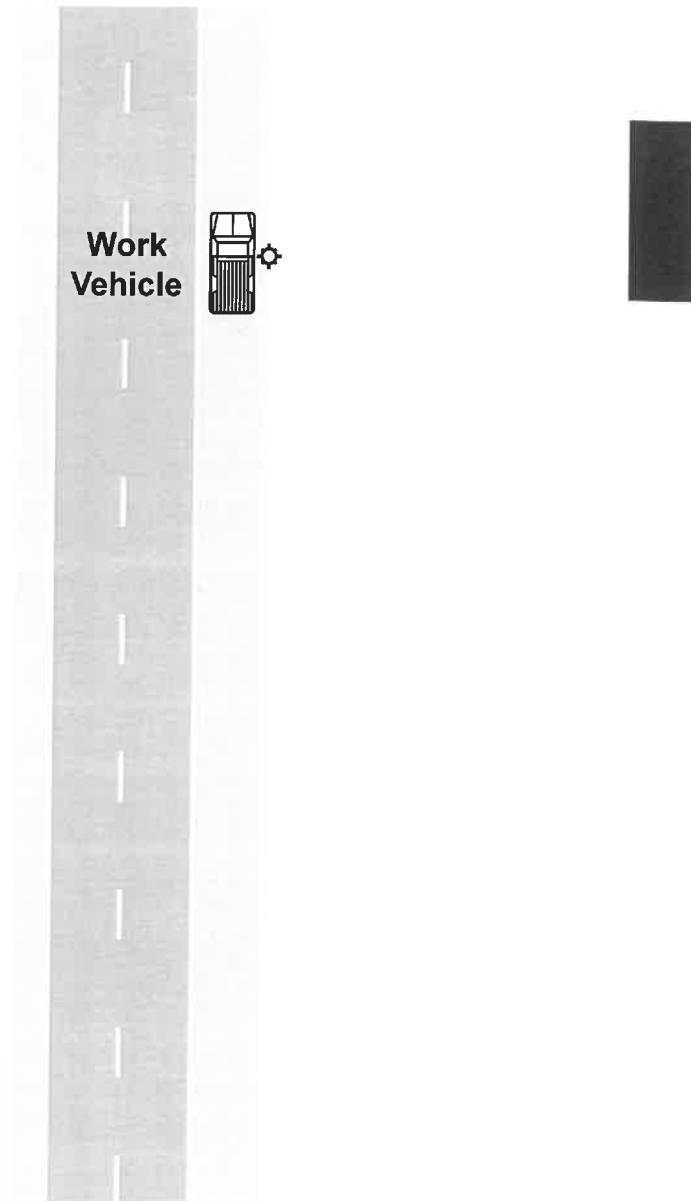
**WORK VEHICLE PARKED ON SHOULDER****1 HOUR or LESS****6K-6****LAYOUT 6**

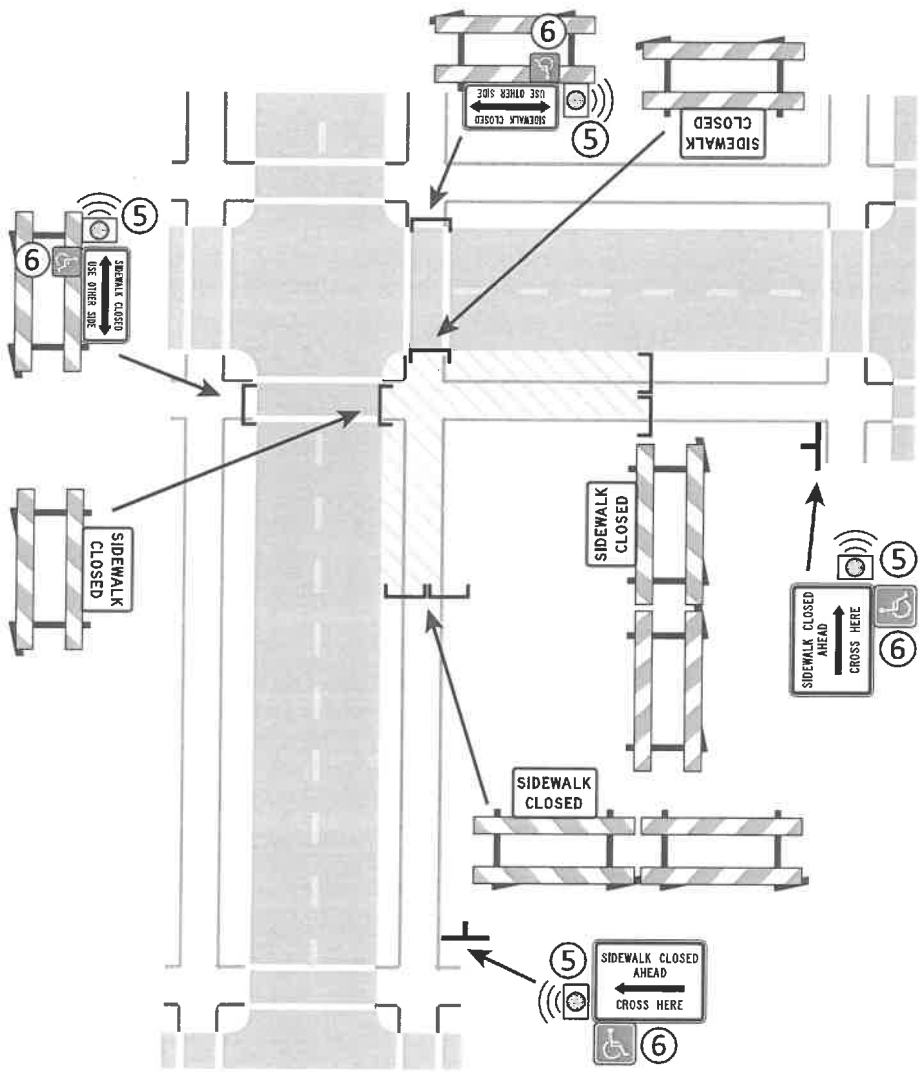

ALTERNATE PEDESTRIAN ROUTE
CROSSWALK CLOSURES AND PEDESTRIAN DETOURS
3 DAYS or LESS **LAYOUT 88b** **LAYOUT 88a & b**
6K-88b