

City of Spring Lake Park
1301 81st Avenue NE
Spring Lake Park, MN 55432

Sign Permit

August 3, 2020

Sign Permit

Precision Tune Auto Care

896 County Rd 10 NE



CITY OF SPRING LAKE PARK

1301 81st Avenue N E
Spring Lake Park, MN 55432
763-784-6491

Sign Permit Application

DATE: 7/27/2020

NAME OF APPLICANT: Roland Johnson / RJK Automotive Service Inc.

ADDRESS OF APPLICANT: 896 County Road 10 NE Spring Lake Park MN 55434

TELEPHONE NUMBER OF APPLICANT: 612-790-7071

NAME OF BUSINESS AND LOCATION of building structure, or lot to which or upon which the sign is to be attached or erected Precision Tune Auto Care

896 County Road 10 NE Spring Lake Park MN 55434

New Construction: _____ Remodel: X Word Change Only: _____

Attach a drawing or sketch showing the position of the sign in relation to the nearest building, structures, public streets, right-of-way and property lines. Said drawing to be prepared to scale.

Attach two (2) blueprints or ink drawings of the plans and specifications and method of construction or attachment to the building or in the ground, including all dimensions. Show location of all light sources, wattage, type and color of lights and details of light shields or shades.

Attach a copy of stress sheets and calculations showing the structure is designed for dead load and wind velocity in the amount required by this and all other Ordinances of the City, if requested by the Building Inspection Department.

Name of person, firm or corporation erecting the structure: G & C Construction Service S.

Address: 13216 Madison Street NE 55434

Is an Electrical Permit required? No

I, the undersigned applicant, do further make the following agreement with the City of Spring Lake Park Mn:

- 1) To authorize and direct the City of Spring Lake Park to remove and dispose of any signs and sign structures on which a Permit has been issued but which was not renewed, if the owner does not remove the same within thirty (30) days following the expiration of the Permit.
- 2) To authorize and direct the City of Spring Lake Park to remove said sign and sign structure, at the expense of the applicant, where maintenance is not furnished, but only after a hearing and after notice of sixty (60) days, specifying the maintenance required by the City.
- 3) To provide any other additional information which may be required by the Building Inspection Department.

SIGNATURE OF APPLICANT

FOR OFFICE USE ONLY:*****

FEE: \$372.50 RECEIPT NUMBER: _____

DATE OF APPROVAL: _____ DATE OF ISSUE: _____

REASON FOR DENIAL: _____

ADDITIONAL REQUIREMENTS FOR SIGN PERMIT:

SQUARE FOOTAGE OF FRONT OF BUILDING: 1744 sq. ft.

SQUARE FOOTAGE OF ALL EXISTING SIGNS: ~~153 sq. ft.~~ pylon 28ft x 4ft x 2 = 138ft

SQUARE FOOTAGE OF PROPOSED SIGN OR SIGNS: ~~67.5 sq. ft.~~ 168 + 90 = 258

INCLUDE A DRAWING SHOWING LOCATION AND MESSAGE ON SIGN.

IF YOU ARE NOT THE OWNER OF THE PROPERTY, INCLUDE A SIGNED LETTER FROM THE OWNER GIVING PERMISSION TO ERECT THE SIGN.

NOTE: ALL APPLICATIONS ARE DUE BY NOON ON THE TUESDAY PRECEEDING THE COUNCIL MEETING.

DRAWING:

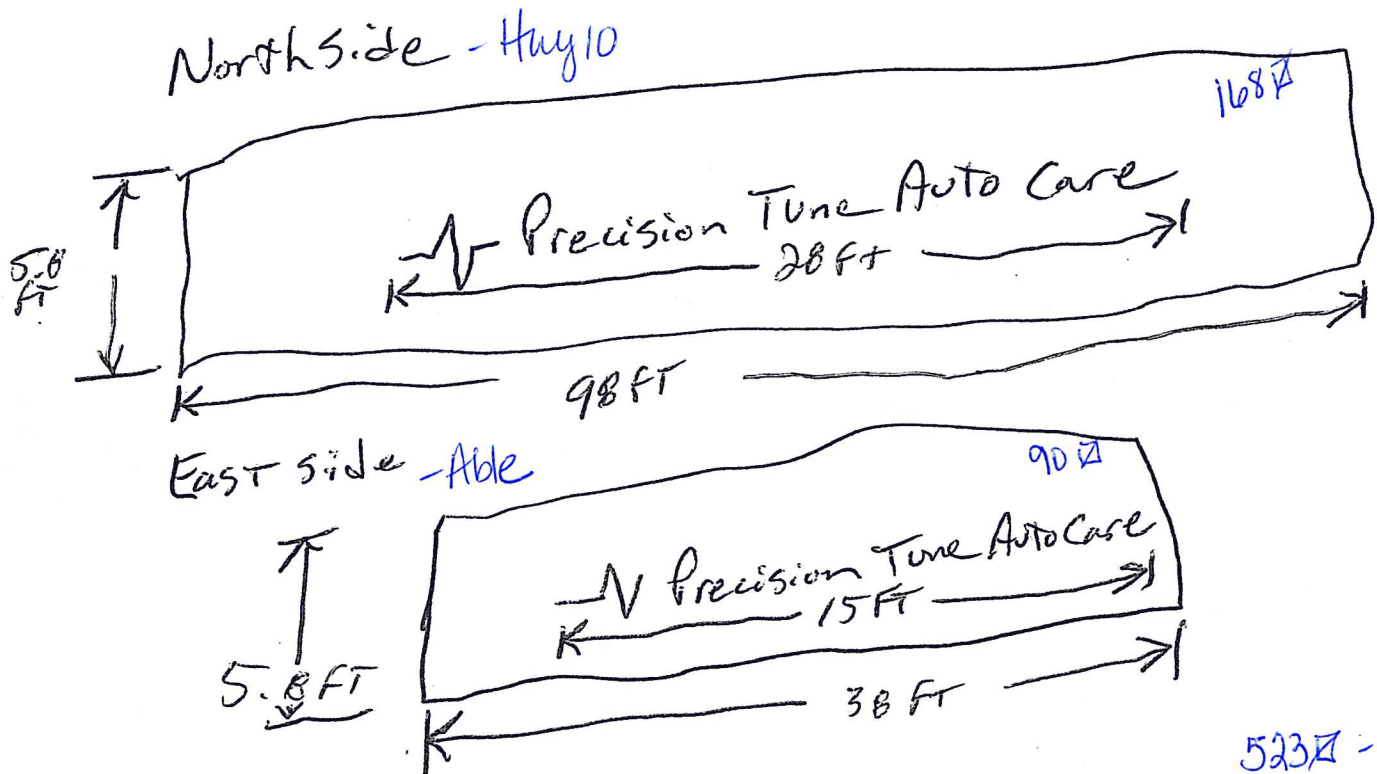

proposed

$$168 \text{ ft} - \$75 + 128(1.25) = \$235$$

$$90 \text{ ft} - \$75 + 50(1.25) = \$137.50$$
$$\$372.50$$

$$523 \text{ ft} - 30\%$$

$$138 \text{ ft} - \text{existing}$$

$$258 \text{ ft} - \text{proposed}$$

$$127 \text{ ft} \text{ Remaining}$$

Brackets on Signs
Holes 1/4" on center

Precision Tune Auto Care

Signs will be attached with preexisting brackets 16" on center with stud bolts (see attached pictures). All electrical is already existing and the new LED signs will use less voltage and fewer circuits than existing lights

proposed



Gliding



Doug Beck <dbeck@fivestarteam.com>

2/11/2020 11:39 AM

RE: Signs

To ROLLIE JOHNSTON <rjohnston4@comcast.net>

Absolutely, go for it and thanks for checking. You are greatly appreciated.

Douglas Beck, Investment Advisory Representative
Five Star Financial Resources
25 N Lake St, Suite 310
Forest Lake, MN 55025
dbeck@fivestarteam.com
Phone: 651-464-1198
Fax: 651-464-1250



Securities and advisory services offered through SagePoint Financial, member FINRA/SIPC. Insurance services offered through Five Star Financial Resources who is not affiliated with SagePoint Financial. This message and any attachments hereto contain information that is confidential and is intended for use only by the addressee. If you are not the intended recipient, or the employee or agent of the intended recipient responsible for delivering the message, you are notified that any review, copying, distribution or use of this transmission is strictly prohibited. If you have received this transmission in error, please (i) notify the sender immediately by email or by telephone and (ii) destroy all copies of this message.

From: ROLLIE JOHNSTON <rjohnston4@comcast.net>
Sent: Tuesday, February 11, 2020 12:36 PM
To: Doug Beck <dbeck@fivestarteam.com>
Subject: Signs

Doug:

The lights that light up my Precision Tune lights are shot, I am looking at installing lighted letter signs similar to Bryan's and I just wanted to check and make sure that was ok with you.

Thanks

Rollie Johnston
Owner
Precision Tune Auto Care
896 County Road 10 NE
Spring Lake Park, MN 55434
763-784-1405
763-784-1074 Fax
rjohnston4@comcast.net

