

City of Spring Lake Park
1301 81st Avenue NE
Spring Lake Park, MN 55432

Sign Permits

December 5, 2022

A-ABCO

7857 Hwy 65 NE

Little Bee's Child Care

1630 Hwy 10 NE



CITY OF SPRING LAKE PARK

1301 81st Avenue N E
Spring Lake Park, MN 55432
763-784-6491

Sign Permit Application

DATE: 11-4-22

NAME OF APPLICANT: Dave Albrecht

ADDRESS OF APPLICANT: 7041 11th Ave SW, Isanti, MN 55040

TELEPHONE NUMBER OF APPLICANT: (612) 710-1210

NAME OF BUSINESS AND LOCATION of building structure, or lot to which or upon which the sign is to be attached or erected A-Alco 7857 MN-65, Spring Lake Park,

New Construction: _____ Remodel: X Word Change Only: _____

Attach a drawing or sketch showing the position of the sign in relation to the nearest building, structures, public streets, right-of-way and property lines. Said drawing to be prepared to scale.

Attach two (2) blueprints or ink drawings of the plans and specifications and method of construction or attachment to the building or in the ground, including all dimensions. Show location of all light sources, wattage, type and color of lights and details of light shields or shades.

Attach a copy of stress sheets and calculations showing the structure is designed for dead load and wind velocity in the amount required by this and all other Ordinances of the City, if requested by the Building Inspection Department.

Name of person, firm or corporation erecting the structure: _____

Structure is already there Replacing digital board with new digital board of same size

Vision Sign Company, LLC
Address: 7041 11th Ave SW, Isanti, MN 55040

Is an Electrical Permit required? _____

I, the undersigned applicant, do further make the following agreement with the City of Spring Lake Park Mn:

- 1) To authorize and direct the City of Spring Lake Park to remove and dispose of any signs and sign structures on which a Permit has been issued but which was not renewed, if the owner does not remove the same within thirty (30) days following the expiration of the Permit.
- 2) To authorize and direct the City of Spring Lake Park to remove said sign and sign structure, at the expense of the applicant, where maintenance is not furnished, but only after a hearing and after notice of sixty (60) days, specifying the maintenance required by the City.
- 3) To provide any other additional information which may be required by the Building Inspection Department.

Dave Albrecht
SIGNATURE OF APPLICANT

FOR OFFICE USE ONLY:*****

FEE: \$215.00

RECEIPT NUMBER: _____

DATE OF APPROVAL: _____

DATE OF ISSUE: _____

REASON FOR DENIAL: _____

ADDITIONAL REQUIREMENTS FOR SIGN PERMIT:

SQUARE FOOTAGE OF FRONT OF BUILDING: 3825

SQUARE FOOTAGE OF ALL EXISTING SIGNS: 474

SQUARE FOOTAGE OF PROPOSED SIGN OR SIGNS: 66 x 2 = 132

INCLUDE A DRAWING SHOWING LOCATION AND MESSAGE ON SIGN.

IF YOU ARE NOT THE OWNER OF THE PROPERTY, INCLUDE A SIGNED LETTER FROM THE OWNER GIVING PERMISSION TO ERECT THE SIGN.

NOTE: ALL APPLICATIONS ARE DUE BY NOON ON THE TUESDAY PRECEEDING THE COUNCIL MEETING.

DRAWING:

Existing

Pylon
 $177 \times 2 = 354$

Awning
 120

$1148 - 30\%$
 132 Proposed
 474 Existing

542 Remaining

Proposed

$66 \times \$75 + 26 \times \overset{32.50}{(1.25)} = \$107.50 \times 2 = \$215$

OPTION 1

17' 11" 1/2" No change to this cabinet, only replacing digital boards.



PYLON REFURBISH

- A: ILLUMINATED D/F CABINET**
 - FABRICATED ALUMINUM CABINET
 - 3" FLAT FLEXIBLE FABRIC FACE RETAINER
 - PAINTED BLACK
 - WHITE LED ILLUMINATION
 - FLEXIBLE FABRIC FACE
 - 3M MATTE BLACK OPAQUE VINYL 220-22
 - 3M RED TRANS. VINYL 230-33
 - ALTERNATE: DIGITAL PRINTED FLEX FACE
 - STEEL MATCH PLATE
- B: ELECTRONIC MESSAGE CENTER**
 - WATCHFIRE 16MM LED RGB
 - CABINET: 6-5H X 11-TL X 8"D
 - VIEWING AREA: 6H X 11L
 - DOUBLE FACE
 - 12 LINES/39.6 CHAR AT 4" TYPE
 - 1,493 LBS
 - 120V, 38 AMPS, (19 PER FACE)

INSTALL:

- BOLT NEW D/F CABINET ONTO EXISTING STRUCTURE WITH MATCHPLATE.
- INSTALL NEW ELECTRONIC MESSAGE CENTER ONTO EXISTING SQ. TUBE VERTS. WITH NEW STEEL ANGLE CLIPS.

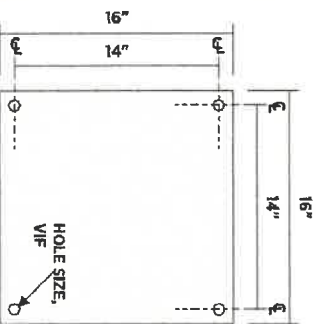

EXISTING MATCHPLATE
SCALE: 1-1/2" = 1'-0"

JOB NAME:

Address:

CLIENT ADDRESS:

JOB LOCATION:

SOUTH LAKE TAHOE, CA

DATE: 09.27.11

DESCRIPTION: Pylon Refurbish

JOB #:

SALES: Dave

DESIGNER: 27 Oct 11

REVISION	DATE:
01	
02	
03	
04	
05	
06	
07	
08	
09	

VISION SIGN
Company LLC

3149 162ND LN NW # 200
ANDOVER, MN 55304
612-710-1210

Customer Signature of Approval

Approval Date

No change on this
 cabinet replacing
 only existing
 Digital board.

OPTION 1



EXISTING CONDITIONS



PROPOSED CONDITIONS

JOB NAME:

4-1833

CLIENT ADDRESS:

JOB LOCATION:

SPRING LAKE, MINN.

DATE: 10/27/20

DESCRIPTION: 10' W 10' H SIGN

JOB #:

SALES: DAV

DESIGNER: JEFF

REVISION DATE:

1	
2	
3	
4	
5	
6	
7	
8	
9	
10	

VISION SIGN
 COMPANY LLC

3149 162ND LN NW # 200
 ANDOVER, MN 55304
 612-710-1210

(Customer Signature or Approval)

X

Signature Here

Existing



Save on New & Recycled Parts
A-ABC
RECYCLED
AUTO PARTS
Parts for all makes models & years
763-784-8890

WELCOME
TO A-ABC





CITY OF SPRING LAKE PARK
1301 81st Avenue N E
Spring Lake Park, MN 55432
763-784-6491

Sign Permit Application

DATE: 11/14/22
NAME OF APPLICANT: Ryan Maxson
ADDRESS OF APPLICANT: 7275 Main St. NE Fridley MN 55432
TELEPHONE NUMBER OF APPLICANT: 651-287-1164

NAME OF BUSINESS AND LOCATION of building structure, or lot to which or upon which the sign is to be attached or erected Little Bees Child Care

1630 County Rd. 10 #3

New Construction: ☒ Remodel: ☐ Word Change Only: ☐

Attach a drawing or sketch showing the position of the sign in relation to the nearest building, structures, public streets, right-of-way and property lines. Said drawing to be prepared to scale.

Attach two (2) blueprints or ink drawings of the plans and specifications and method of construction or attachment to the building or in the ground, including all dimensions. Show location of all light sources, wattage, type and color of lights and details of light shields or shades.

Attach a copy of stress sheets and calculations showing the structure is designed for dead load and wind velocity in the amount required by this and all other Ordinances of the City, if requested by the Building Inspection Department.

Name of person, firm or corporation erecting the structure: Albrecht ^{Sign} ~~Sign~~ Company

Address: 7275 Main St. NE Fridley, MN 55432

Is an Electrical Permit required? Yes

I, the undersigned applicant, do further make the following agreement with the City of Spring Lake Park Mn:

- 1) To authorize and direct the City of Spring Lake Park to remove and dispose of any signs and sign structures on which a Permit has been issued but which was not renewed, if the owner does not remove the same within thirty (30) days following the expiration of the Permit.
- 2) To authorize and direct the City of Spring Lake Park to remove said sign and sign structure, at the expense of the applicant, where maintenance is not furnished, but only after a hearing and after notice of sixty (60) days, specifying the maintenance required by the City.
- 3) To provide any other additional information which may be required by the Building Inspection Department.

SIGNATURE OF APPLICANT

FOR OFFICE USE ONLY:*****
FEE: \$302.50 RECEIPT NUMBER: 1

DATE OF APPROVAL: _____ DATE OF ISSUE: _____

REASON FOR DENIAL: _____

ADDITIONAL REQUIREMENTS FOR SIGN PERMIT:

SQUARE FOOTAGE OF FRONT OF BUILDING: ~~505 FT~~ 2480 ~~FT~~

SQUARE FOOTAGE OF ALL EXISTING SIGNS: ~~unknown~~ ~~229 FT~~

SQUARE FOOTAGE OF PROPOSED SIGN OR SIGNS: ~~70 sq ft~~ 182 ~~FT~~

(44 ~~FT~~ + 69 ~~FT~~ x 2 = 138 ~~FT~~)

All Being
Removed

INCLUDE A DRAWING SHOWING LOCATION AND MESSAGE ON SIGN.

IF YOU ARE NOT THE OWNER OF THE PROPERTY, INCLUDE A SIGNED LETTER FROM THE OWNER GIVING PERMISSION TO ERECT THE SIGN.

NOTE: ALL APPLICATIONS ARE DUE BY NOON ON THE TUESDAY PRECEEDING THE COUNCIL MEETING.

DRAWING:

~~Annings Existing~~
~~96 ~~FT~~~~
~~133 ~~FT~~~~

744 ~~FT~~ - 30%
0 ~~FT~~ ~~229 ~~FT~~~~ - Existing
182 ~~FT~~ Proposed

562 ~~FT~~ Remaining

Proposed
44 ~~FT~~ Building $\$75 + 4(1.25)^5 = \80
69 ~~FT~~ x 2 Sign on post 138 ~~FT~~ $\$75 + 29(1.25)^{36.25} \times 2 = \222.50
\$302.50

Little Bee's
Child Care Center



763-780-0187



ALBRECHT SIGN COMPANY
ENHANCE YOUR IMAGE

Signage Design Rev(4)
November 7th, 2022

7775 MAIN STREET NE, FRIDLEY, MN 55432 | P 763.754.2692 | F 763.787.7916 | WWW.ALBRECHTSIGNCOMPANY.COM

Existing post



Rendering
Scale: 1/4" = 1'

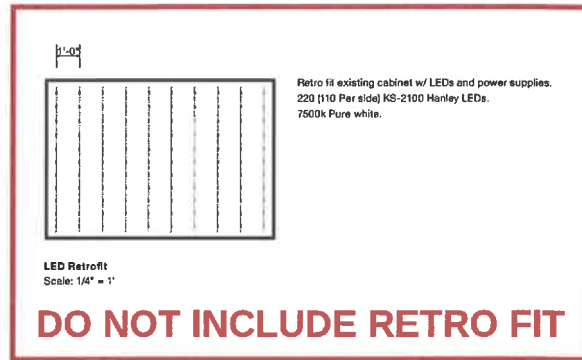

8311



Face View
Scale: 1/4" = 1'

Color:		CMYK	N/A	N/A	N/A	N/A	N/A	N/A	ST-100
Paint Finish:	N/A	N/A	N/A	N/A	N/A	N/A	N/A	N/A	Pylon Retrofit
Vinyl:	N/A	N/A	N/A	N/A	N/A	N/A	N/A	N/A	Quantity: 2 Square Ft: 70
Digital Print:	Clear - Luster	N/A	N/A	N/A	N/A	N/A	N/A	N/A	Single Face: <input type="checkbox"/> Illuminated: <input checked="" type="checkbox"/>
Other:	N/A	N/A	N/A	N/A	N/A	N/A	N/A	N/A	Double Face: <input checked="" type="checkbox"/> Non-Illuminated: <input type="checkbox"/>

VERIFY CUT SIZE



DESIGN | FABRICATION | INSTALLATION | SERVICE

7775 Main St. N.E.,
Friday, MN 55432
P: 783 764 2888 | F: 783 767 7216
www.AbrechtsGrCompany.com

Client:
Little Bee Childcare

Client Address:
1630 County Rd 10 #3,
Spring Lake Park, MN 55432

Start Date: 10/10/2022
Last Revision Date: 11/7/2022
Job Number: N/A
Drawing Revision: 4
Sales Representative: C.J.
Designer: R.C.

Rev on	Update
01	
02	
03	
04	
05	
06	
07	
08	
09	

Customer Signature of Approval



This tag is intended to be utilized in accordance with the requirements of Article 606 of the National Electrical Code and for other applicable local codes. The emphasis upon grounding and bonding of this sign. The location of the sign must be such that emphasis shall comply with Article 606.5(b)(2) of the National Electrical Code.

Copyright 2022, by Altecnic Sign Company, Inc. All designs
provided are the sole property of Altecnic Sign Company Inc.,
and may not be reproduced in part or whole without written
permission from Altecnic Sign Company Inc. Photo renderings
are not to scale. Colors in this drawing are for representation
purposes only and may differ from finished product. Physical
color samples can be provided upon request.



Entrance Elevation: Option 2
Scale: 1/4" = 1'



DESIGN | FABRICATION | INSTALLATION | SERVICE

7775 Main St. N.E.
Fridley, MN 55425
P: 763.764.2888 | F: 763.767.7318
www.albrechtsgn.com

Client:
Little Bee Childcare

Client Address:
1630 County Rd 10 #3,
Spring Lake Park, MN 55432

Start Date: 10/10/2022
Last Revision Date: 11/7/2022
Job Number: N/A
Drawing Revision: 4
Sales Representative: CJ
Designer: RD

Revision	Update
01	
02	
03	
04	81-200 Option 1 Removed
05	
06	
07	
08	
09	

Customer Signature of Approval
X

LED Module	Power Supply
Type	Type
Units	Units



Copyright 2022, by Albrecht Signs Company, Inc. All designs
presented are the property of Albrecht Signs Company, Inc.,
and may not be reproduced in part or whole without written
permission from Albrecht Signs Company, Inc. Photo renderings
are not to scale. Colors in this drawing are for informational
purposes only and may differ from actual product. Photos of
other samples can be provided upon request.



Face View
Scale: 1/2" = 1'

3/4"



End View
Scale: 1/2" = 1'

Extruded aluminum cabinet painted MP White.
Full coverage digital print on clear applied to white PC face.
LI w/ 7600k LEDs.
Flush mount.

Color:	White	CMYK	N/A	N/A	N/A	N/A	N/A	N/A	BT-200: Option 2
Paint Finish:	MP White	N/A	N/A	N/A	N/A	N/A	N/A	N/A	Face Lit Cabinet
Vinyl:	N/A	3751 - Luster	N/A	N/A	N/A	N/A	N/A	N/A	Quantity: 1 Square Ft: 43.8
Digital Print:	N/A	N/A	N/A	N/A	N/A	N/A	N/A	N/A	Single Face: <input checked="" type="checkbox"/> Illuminated: <input checked="" type="checkbox"/>
Other:	N/A	N/A	N/A	N/A	N/A	N/A	N/A	N/A	Double Face: <input type="checkbox"/> Non-Illuminated: <input type="checkbox"/>



DESIGN | FABRICATION | INSTALLATION | SERVICE

7775 Main St. N.E.
Plymouth, MN 55432
P: 763.764.9888 | F: 763.767.7316
www.albrechtsigns.com

Client:
Little Bean Childcare

Client Address:
1630 County Rd 10 E3,
Spring Lake Park, MN 55432

Start Date: 10/16/2022
Last Revision Date: 11/7/2022
Job Number: N/A
Drawing Revision: 4
Sales Representative: C.J.
Designer: RD

Revision	Update
01	
02	
03	
04	BT-200 Opt on 1 Removed
05	
06	
07	
08	
09	

Customer Signature of Approval
X

LED Module	Power Supply
Type	Type
Units	Units

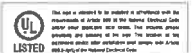

Copyright 2022 by Albrecht Sign Company. All rights reserved. This drawing is the property of Albrecht Sign Company and may not be reproduced in part or whole without written permission from Albrecht Sign Company. All drawings are for informational purposes only and may differ from standard product. Physical color samples will be provided upon request.