



CITY OF SPRING LAKE PARK
 1301 Eighty-First Avenue N.E.
 Spring Lake Park, MN 55432
 Ph: 763-784-6491 Fax: 763-792-7257

PUBLIC RIGHT-OF-WAY APPLICATION

SAP# 103655258

MGC# 22-67033

NAME/COMPANY: CENTERPOINT ENERGY

GOPHER 1-CALL REG. NO.: 0029

ADDRESS: 700 LINDEN AVE W, MINNEAPOLIS, MN 55403

PHONE: 612-321-5302

FAX:

E-MAIL ADDRESS: latanya.lewis@centerpointenergy.com

NAME OF REPRESENTATIVE: LaTanya Lewis

REPRESENTATIVE PHONE NO'S.:

DESCRIPTION OF PROPOSED WORK: including a start date and completion date:

Install new gas service line - 7753 TYLER ST NE

START DATE: 7/18/22

COMPLETION DATE: 12/31/2022

The City of Spring Lake Park reserves the right to modify the schedule as necessary in the issuance of the permit. Therefore, the dates stated on this application may not necessarily match actual approved dates.

EXPLANATION OF RESTORATION: Q3 Contracting 651-224-2424

OK 7-7-22
TL

LaTanya Lewis

Authorized Representative Signature

Please waive permit fees per franchise agreement

7/7/22

Date

FOR OFFICE USE ONLY

- | | |
|--|--|
| <input type="checkbox"/> PROOF OF CERTIFICATE OF INSURANCE: | VERIFICATION DATE: _____ |
| <input type="checkbox"/> SCALED DRAWING SHOWING LOCATION | <input type="checkbox"/> LETTER OF CREDIT OR CONST. BOND |
| <input type="checkbox"/> COPY OF INSURANCE POLICIES (If Corporation; from Secretary of State) | <input type="checkbox"/> COPY OF CERTIFICATE OF AUTHORITY (From M.P.U.C., State, or Federal Agency) |

- PERMIT FEES:**
- | | |
|---|--|
| <input type="checkbox"/> Excavation Hole - \$150.00 | <input type="checkbox"/> Emergency Hole - \$55.00 |
| <input type="checkbox"/> Trench - \$70.00/100'+Hole fee | <input type="checkbox"/> Obstruction Fee - \$50.00+.05/Ft. |

Receipt No.:

Date:

Initials:

APPLICANT MUST CONTACT THE SPRING LAKE PARK PUBLIC WORKS DIRECTOR AT 763-792-7227 48 HOURS PRIOR TO COMMENCING WORK

GENERAL LOCATION ONLY. DO NOT USE TO LOCATE FOR EXCAVATION. CALL 1-800-252-1166 FOR ONSITE LOCATIONS AND STAKING.

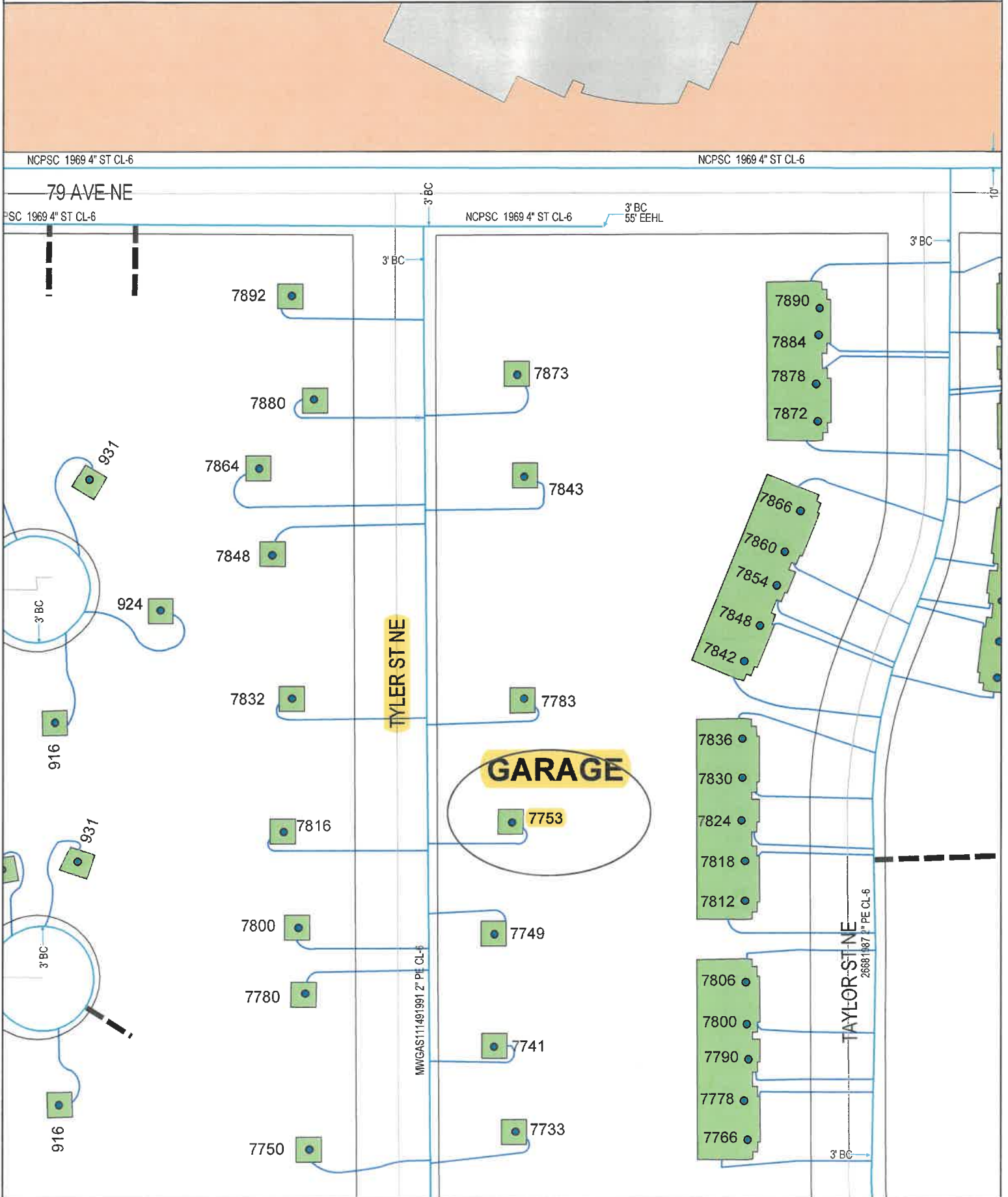

Plotted by: i221539

Plot Date: 6/29/2022

Field1:

Field2:

Scale: 1" : 100'

