



CITY OF SPRING LAKE PARK

1301 Eighty-First Avenue N.E.
Spring Lake Park, MN 55432
Ph: 763-784-6491 Fax: 763-792-7257

PUBLIC RIGHT-OF-WAY APPLICATION

SAP# 111035272

MGC# 24-73893

NAME/COMPANY: CENTERPOINT ENERGY

GOPHER 1-CALL REG. NO.: 0029

ADDRESS: 700 LINDEN AVE W, MINNEAPOLIS, MN 55403

PHONE: 612-321-5325

FAX: _____

E-MAIL ADDRESS: kimberly.ignatowicz@centerpointenergy.com

NAME OF REPRESENTATIVE: RON EASMAN

REPRESENTATIVE PHONE NO'S.: 612-363-9698

DESCRIPTION OF PROPOSED WORK: including a start date and completion date:

INSTALL 6 ANODES ON STEEL MAIN, 6- 10" DRILL HOLES USING VAC TRUCK

START DATE: 4/1/24

COMPLETION DATE: 12/31/24

The City of Spring Lake Park reserves the right to modify the schedule as necessary in the issuance of the permit. Therefore, the dates stated on this application may not necessarily match actual approved dates.

EXPLANATION OF RESTORATION: Restore to previous condition or better

Fee Waived.

Kimberly Ignatowicz

Authorized Representative Signature

Please waive permit fees per franchise agreement

2/22/24

Date

FOR OFFICE USE ONLY

- PROOF OF CERTIFICATE OF INSURANCE:
- SCALED DRAWING SHOWING LOCATION
- COPY OF INSURANCE POLICIES
(If Corporation; from Secretary of State)

VERIFICATION DATE: _____

- LETTER OF CREDIT OR CONST. BOND
- COPY OF CERTIFICATE OF AUTHORITY
(From M.P.U.C., State, or Federal Agency)

PERMIT FEES: Excavation Hole - \$150.00
 Trench - \$70.00/100'+Hole fee

Emergency Hole - \$55.00
 Obstruction Fee - \$50.00+.05/Ft.

Receipt No.: _____

Date: 2/26/24

Initials: CE

APPLICANT MUST CONTACT THE SPRING LAKE PARK PUBLIC WORKS DIRECTOR AT 763-792-7227 48 HOURS PRIOR TO COMMENCING WORK

Spring Lake Park

CP Area #2013
Section #30073
SE2/30/24

Ross Barber
(952) 322-0883
12/14/2023

WO#:

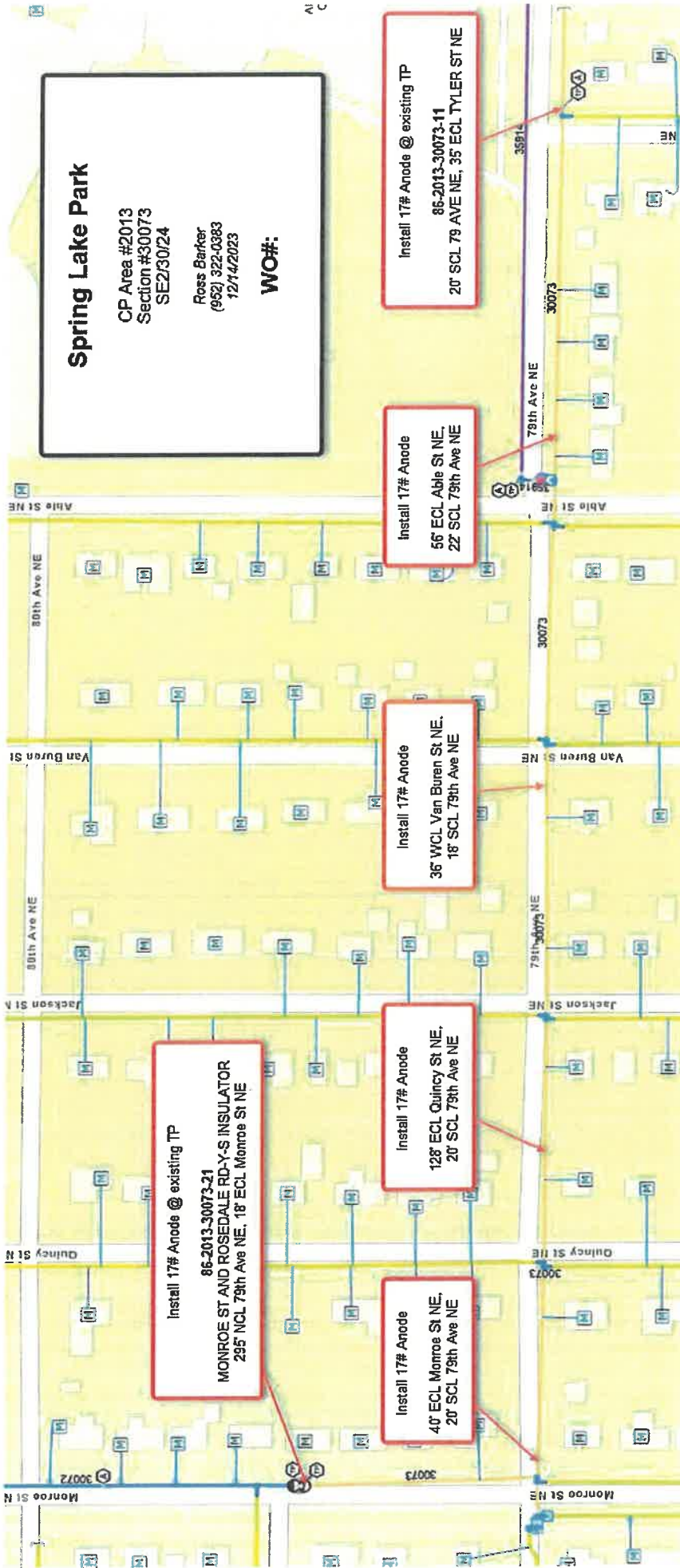

Install 17# Anode @ existing TP
86-2013-30073-21
MONROE ST AND ROSEDALE RD-Y-S INSULATOR
295' NCL 79th Ave NE, 18' ECL Monroe St NE

Install 17# Anode
40' ECL Monroe St NE,
20' SCL 79th Ave NE

Install 17# Anode
128' ECL Quincy St NE,
20' SCL 79th Ave NE

Install 17# Anode
36' WCL Van Buren St NE,
18' SCL 79th Ave NE

Install 17# Anode
56' ECL Able St NE,
22' SCL 79th Ave NE

Install 17# Anode @ existing TP
86-2013-30073-11
20' SCL 79 AVE NE, 35' ECL TYLER ST NE

11095272