

History Innovating for the Future: Initial Development Concept

For generations, the Bonner County Historical Society & Museum has preserved and shared the rich history that defines our community. But as our collection grows and our programs expand, our current facility no longer meets the needs of our mission. To ~~continue~~ safeguarding our shared heritage and making history accessible for all, we must invest in a space that honors our past while embracing our future. By expanding our footprint, we will create a more engaging, inclusive, and dynamic museum experience—one that invites residents and visitors to connect with Bonner County's stories in new and meaningful ways. With the support of the City of Sandpoint Parks & Recreation Commission, we can ensure our history remains a vital part of our thriving community ~~for~~ generations to come.

- The Bonner County History Museum has been a cornerstone of Lakeview Park since 1980. BCHS&M is committed to staying in a location that both serves citizens of Sandpoint and contributes to one of Sandpoint's most beautiful parks as a key amenity and visitor attraction.
- An expansion of the Museum in Lakeview Park would offer more educational opportunities to the community, integrate and enhance the park's connectivity between features, and provide public utilization of an indoor community space. We look forward to working closely with City staff throughout the development process to achieve these goals.
- Our site planning process will incorporate stakeholder meetings with nearby residents, as well as organizations BCHS&M already partners with and serves, including KNPS, the Lions Club, the Library, local schools, KLT, POAC, MCS, and other museums.
- BCHS&M has a donor wishing to make a significant contribution toward a capital campaign, but we cannot secure serious investments in this project without a long-term lease ensuring the viability and sustainability of the project.

Please see the attached concept rendering for a site plan of Lakeview Park incorporating an expanded Museum footprint. Please note this is a preliminary site plan and could change in future versions.

Our Request: A long-term, renewable lease in Lakeview Park

Contact:

Tonya Sherman, President, Bonner County Historical Society Trustees

E-mail: tonyamsherman@gmail.com / Website: <https://bonnercountyhistory.org/>

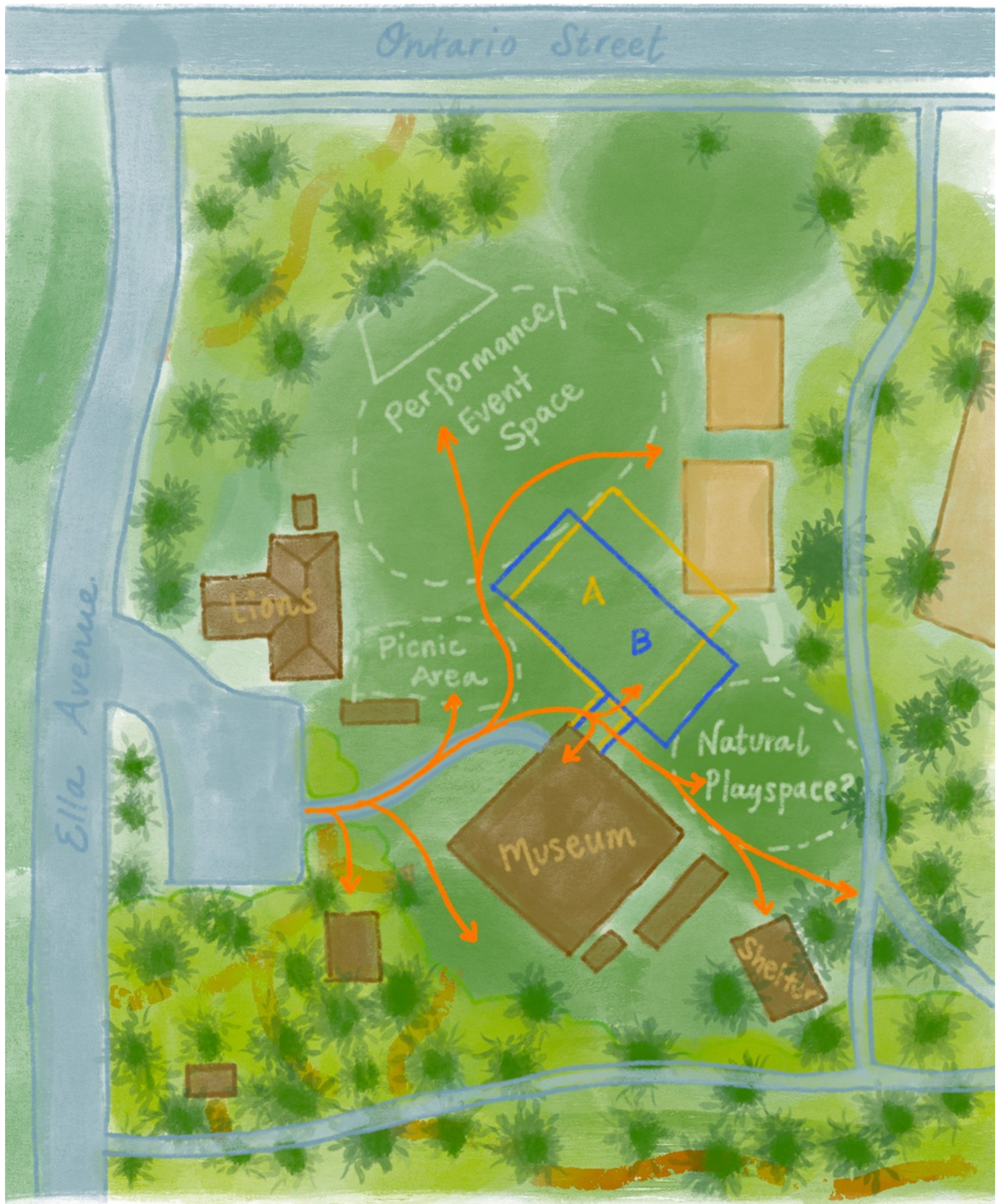

Lakeview Park with Museum Expansion

**Artistic Rendering For Discussion Purposes Only*