



601 Sherman Ave, Suite 1
Coeur d'Alene, ID 83814

(208) 758-8601

August 14, 2025

Attn: Holly Ellis, Public Works Director
City of Sandpoint
1123 W. Lake St.
Sandpoint, ID 83864

Re: Sandpoint WWTP Preliminary Engineer Report (PER) Revision

Dear Holly,

See the below updated Sandpoint WWTP PER overall project cost, which includes high level conceptual solids handling improvements costs that were not previously discussed in the PER. This overall project cost of \$130 Million was previously presented to the City Council and approved to submit for IDEQ SRF funding in January of 2025. The PER will be revised and updated in the future to incorporate this provision.

Item	Estimated Cost
Site Work	\$ 4,355,000
Yard Piping	\$ 1,981,000
Bypass Pumping/Power	\$ 600,000
Generator	\$ 1,200,000
Headworks	\$ 2,848,000
Odor Control	\$ 446,000
Primary Filters and Pump Station	\$ 11,572,000
Process Basins	\$ 12,857,000
Secondary Clarifiers	\$ 13,073,000
UV Disinfection	\$ 3,022,000
Administration Building	\$ 1,745,000
SCADA Integration	\$ 1,000,000
Solids Handling	\$ 6,250,000
Subtotal	\$ 60,949,000
General Conditions (10%)	\$ 6,095,000
Subtotal	\$ 67,044,000
Tariffs, BABA, etc. (8%)	\$ 5,364,000
Subtotal	\$ 72,408,000
Contingency (30%)	\$ 21,723,000
Subtotal	\$ 94,131,000
Contractor OH&P (15%)	\$ 14,120,000
Subtotal	\$ 108,251,000
Professional Services (20%)	\$ 21,700,000
Total Estimated Project Cost	\$ 130,000,000

Sincerely,

Dallin Stephens, PE

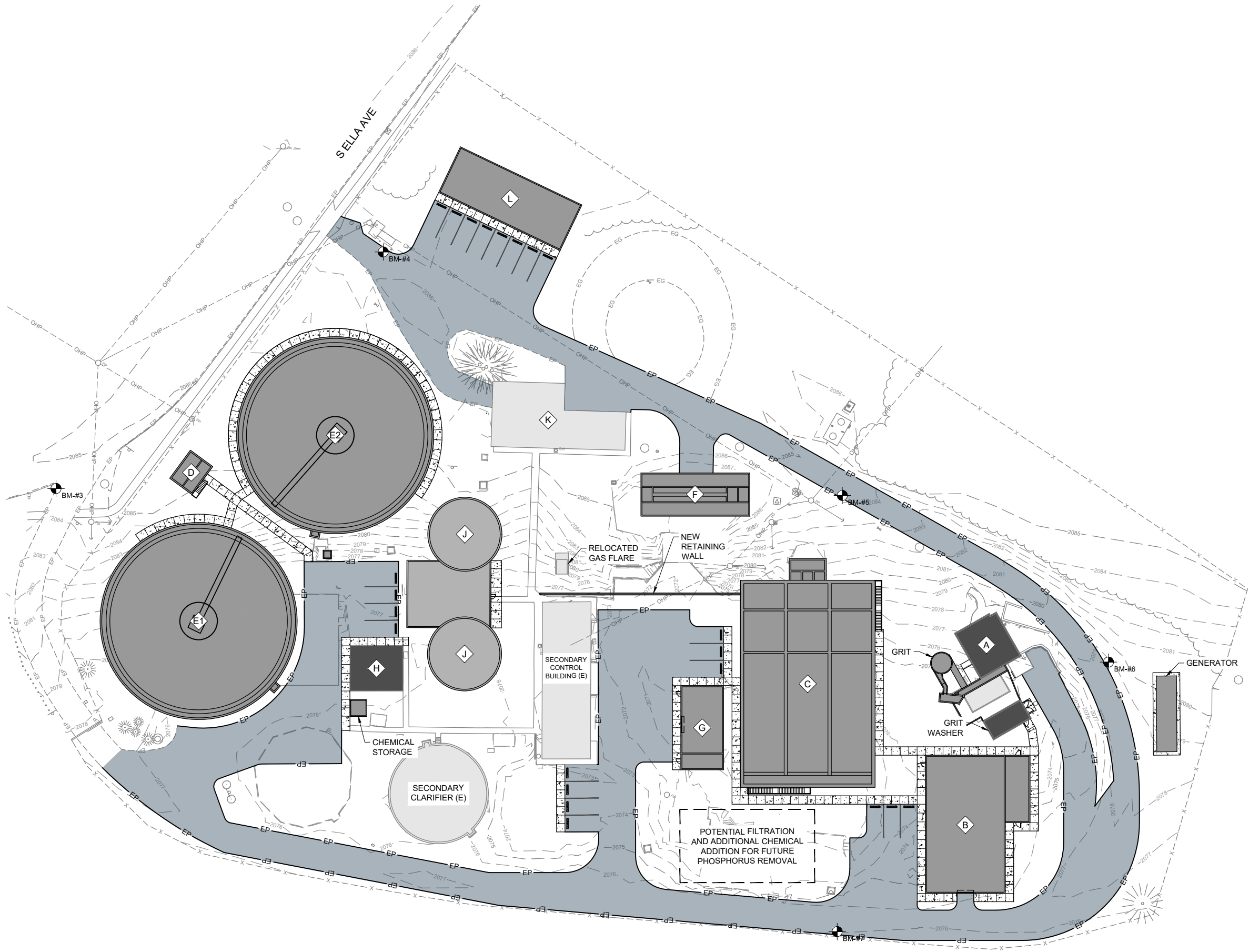

0 30 60

LEGEND

- EXISTING STRUCTURES
- NEW STRUCTURES
- MODIFIED STRUCTURES
- FUTURE STRUCTURES
- NEW ASPHALT PAVING

BENCHMARKS

- BM #1 - NGS POINT CEMETERY (OFF-SITE)
N = 2405038.59
E = 2425584.00
EL = 2084.13
- BM #2 - 5/8" REBAR KELLER CONTROL
N = 2405830.46
E = 2426805.42
EL = 2077.20
- BM #3 - MAGNAIL
N = 2406018.13
E = 2426737.76
EL = 2084.58
- BM #4 - MAGNAIL
N = 2406246.46
E = 2426810.99
EL = 2085.72
- BM #5 - MAGNAIL
N = 2406291.65
E = 2427116.32
EL = 2084.26
- BM #6 - MAGNAIL
N = 2406305.63
E = 2427302.30
EL = 2078.75
- BM #7 - MAGNAIL
N = 2406081.21
E = 2427267.42
EL = 2076.06

BASIS OF DATUMS

THE HORIZONTAL DATUM FOR THIS PROJECT IS BASED UPON NAD83 (2011) IDAHO STATE PLANE COORDINATE SYSTEM (WEST ZONE) BASED UPON NGS POINT DESIGNATION: CEMETERY PID: T00672 (OFF-SITE) KELLER POINT NO. 1. ALL BEARINGS ARE AT GRID AZIMUTH, AND ALL DISTANCES SHOWN REPRESENT GROUND VALUES. IDAHO STATE PLANE COORDINATE SYSTEM (WEST ZONE) WERE MODIFIED USING A COMBINED SCALE FACTOR OF .9998816981 ON KELLER POINT NO. 1

THE VERTICAL DATUM FOR THIS PROJECT IS BASED UPON NGS POINT DESIGNATION: CEMETERY PID: T00672 (OFF-SITE) NAVD 88, KELLER POINT NO. 1

PROJECT BENCH MARK SHOWN AS KELLER POINT NO. 2, ELEVATION 2077.20'

STRUCTURE DESIGNATORS

- A - HEADWORKS (E)
B - PRIMARY FILTERS/LIFT STATION (N)
C - PROCESS BASINS (N)
D - SECONDARY SPLITTER BOX (N)
E1 - SECONDARY CLARIFIER #1 (N)
E2 - SECONDARY CLARIFIER #2 (N)
F - UV DISINFECTION (N)
G - BLOWER BUILDING (N)
H - RAS/WAS BUILDING (E)
J - DIGESTERS AND CONTROL BUILDING (FUTURE)
K - SOLIDS DEWATERING BUILDING (E)
L - ADMINISTRATION BUILDING (N)

PRELIMINARY
Not For
Construction

NO.	REVISIONS	DATE

This document or any part thereof in detail or design concept is the personal property of Keller Associates, Inc. and shall not be copied in any form without the written authorization of Keller Associates, Inc.



WASTEWATER TREATMENT PLANT
REPLACEMENT PROJECT

OVERALL SITE PLAN

DRAWN: EWC	CHECK: DS
VERIFY SCALE: Scales based on 22"x34" prints.	
1-1/2 Inches	
PROJECT NO. 224073	PAGE
SHEET NO.	C-120