

ARPA WATER & SEWER INFRASTRUCTURE GRANT APPLICATION

Table 2. Project Budget

Applicant Entity:	City of Sidney
Project Title:	Phase III Water Improvements - Original

	ARPA - MINIMUM ALLOCATION GRANT	ARPA - COMPETITIVE GRANT	ARPA - LOCAL FISCAL RECOVERY FUNDS	State Revolving Fund Loans	WRF-22493	Local Contribution	Additional Funding - OTHER	Total
Grant Management		\$ 10,000			\$ 6,500	\$ 10,000		\$ 26,500
Bond Counsel						\$ 20,000		\$ 20,000
Legal						\$ 2,000		\$ 2,000
Loan Reserves (Estimated)						\$ 40,000		\$ 40,000
Audit <i>(REQUIRED)</i>		\$ 20,000						\$ 20,000
TOTAL ADMINISTRATION	\$ -	\$ 30,000	\$ -	\$ -	\$ 6,500	\$ 72,000	\$ -	\$ 108,500
Design Engineering					\$ 133,000			\$ 133,000
Construction Engineering				\$ 242,000				\$ 242,000
Geotechnical Investigation					\$ 10,000			\$ 10,000
Construction (original)		\$ 1,202,200		\$ 890,000	\$ 55,000	\$ 53,800		\$ 2,201,000
<i>Construction (new)</i>								\$ -
Contingency <i>(REQUIRED)</i>		\$ 230,100						\$ 230,100
TOTAL ACTIVITY	\$ -	\$ 1,432,300	\$ -	\$ 1,132,000	\$ 198,000	\$ 53,800	\$ -	\$ 2,816,100
TOTAL PROJECT BUDGET	\$ -	\$ 1,462,300	\$ -	\$ 1,132,000	\$ 204,500	\$ 125,800	\$ -	\$ 2,924,600

ARPA WATER & SEWER INFRASTRUCTURE GRANT APPLICATION

Table 2. Project Budget

Applicant Entity:	City of Sidney
Project Title:	Phase III Water Improvements - Schedules I - III (OPTION 1)

	ARPA - MINIMUM ALLOCATION GRANT	ARPA - COMPETITIVE GRANT	ARPA - LOCAL FISCAL RECOVERY FUNDS	State Revolving Fund Loans	WRF-22493	Local Contribution	Additional Funding - OTHER	Total
Grant Management		\$ 10,000			\$ 6,500	\$ 10,000		\$ 26,500
Bond Counsel						\$ 20,000		\$ 20,000
Legal						\$ 2,000		\$ 2,000
Loan Reserves (Estimated)						\$ 40,000		\$ 40,000
Audit (REQUIRED)		\$ 20,000						\$ 20,000
TOTAL ADMINISTRATION	\$ -	\$ 30,000	\$ -	\$ -	\$ 6,500	\$ 72,000	\$ -	\$ 108,500
Design Engineering					\$ 133,000			\$ 133,000
Construction Engineering				\$ 242,000				\$ 242,000
Geotechnical Investigation					\$ 10,000			\$ 10,000
Construction (original)		\$ 1,202,200		\$ 890,000	\$ 55,000	\$ 53,800		\$ 2,201,000
Construction (new)							\$ 349,922	\$ 349,922
Contingency (REQUIRED)		\$ 230,100						\$ 230,100
TOTAL ACTIVITY	\$ -	\$ 1,432,300	\$ -	\$ 1,132,000	\$ 198,000	\$ 53,800	\$ 349,922	\$ 3,166,022
TOTAL PROJECT BUDGET	\$ -	\$ 1,462,300	\$ -	\$ 1,132,000	\$ 204,500	\$ 125,800	\$ 349,922	\$ 3,274,522

ARPA WATER & SEWER INFRASTRUCTURE GRANT APPLICATION

Table 2. Project Budget

Applicant Entity:

City of Sidney

Project Title:

Phase III Water Improvements - Schedules I - VI (OPTION 2)

	ARPA - MINIMUM ALLOCATION GRANT	ARPA - COMPETITIVE GRANT	ARPA - LOCAL FISCAL RECOVERY FUNDS	State Revolving Fund Loans	WRF-22493	Local Contribution	Additional Funding - OTHER	Total
Grant Management		\$ 10,000			\$ 6,500	\$ 10,000		\$ 26,500
Bond Counsel						\$ 20,000		\$ 20,000
Legal						\$ 2,000		\$ 2,000
Loan Reserves (Estimated)						\$ 40,000		\$ 40,000
Audit (REQUIRED)		\$ 20,000						\$ 20,000
TOTAL ADMINISTRATION	\$ -	\$ 30,000	\$ -	\$ -	\$ 6,500	\$ 72,000	\$ -	\$ 108,500
Design Engineering					\$ 133,000			\$ 133,000
Construction Engineering				\$ 242,000			\$ 40,000	\$ 282,000
Geotechnical Investigation					\$ 10,000			\$ 10,000
Construction (original)		\$ 1,202,200		\$ 890,000	\$ 55,000	\$ 53,800		\$ 2,201,000
Construction (new)							\$ 1,005,653	\$ 1,005,653
Contingency (REQUIRED)		\$ 230,100						\$ 230,100
TOTAL ACTIVITY	\$ -	\$ 1,432,300	\$ -	\$ 1,132,000	\$ 198,000	\$ 53,800	\$ 1,045,653	\$ 3,861,753
TOTAL PROJECT BUDGET	\$ -	\$ 1,462,300	\$ -	\$ 1,132,000	\$ 204,500	\$ 125,800	\$ 1,045,653	\$ 3,970,253

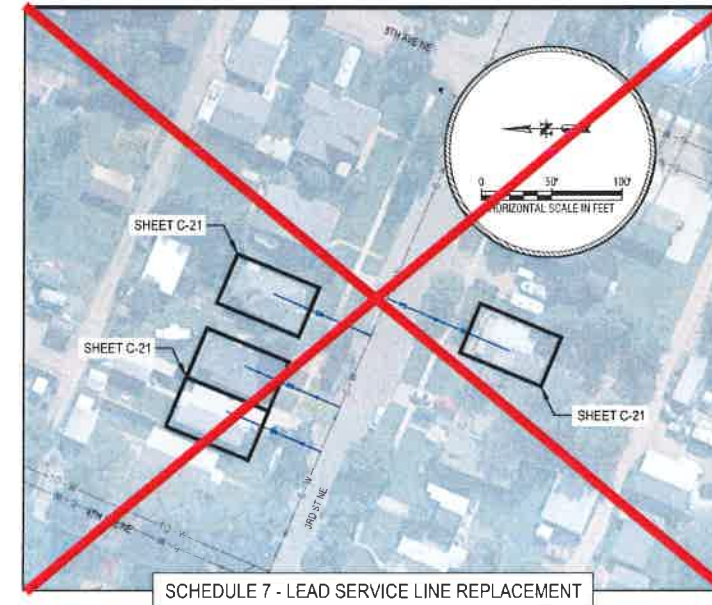
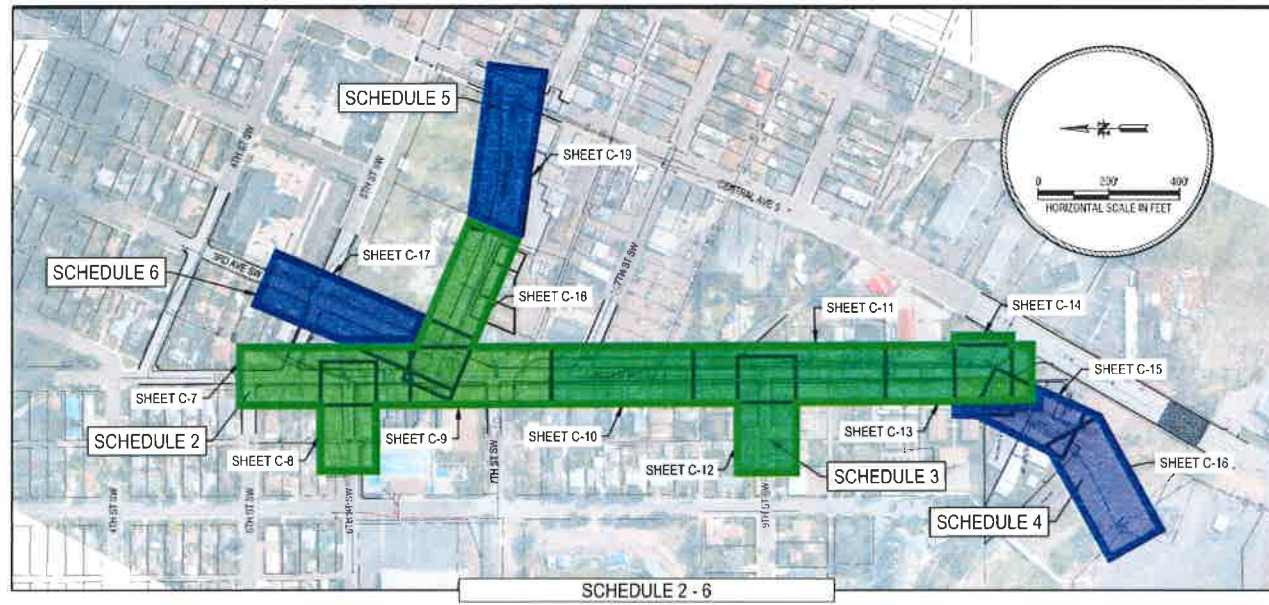
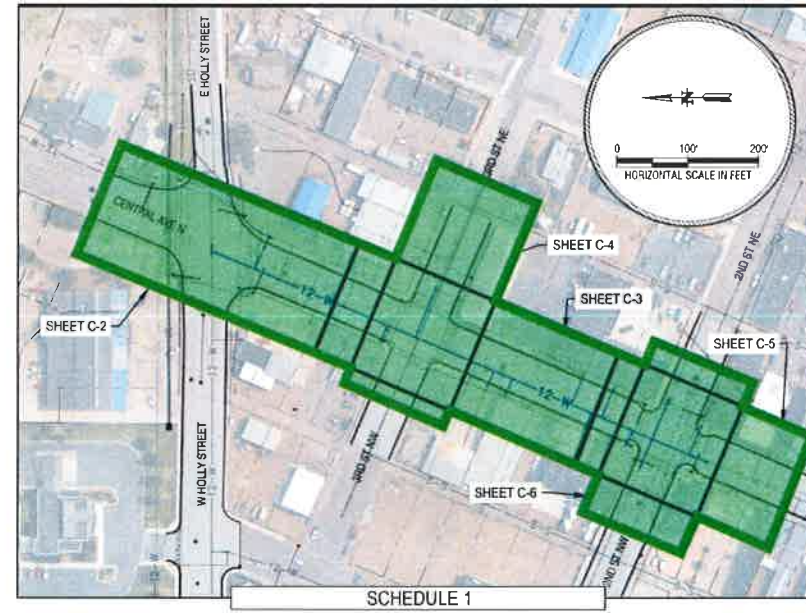
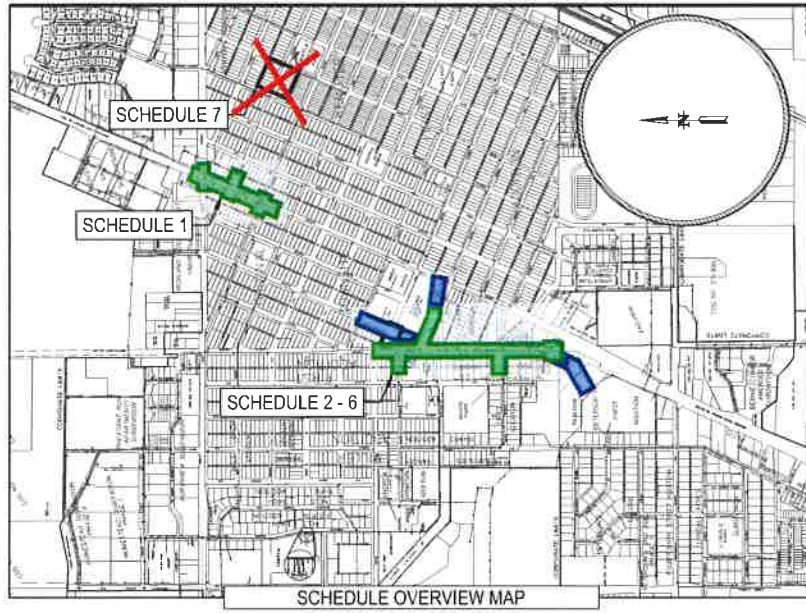

Rev	Date	By	Description
1	08/20/2022	SWW	25% APPROVAL

PHASE III - WATER SYSTEM IMPROVEMENTS
 CITY OF SIDNEY
 RICHLAND COUNTY, MONTANA
 OVERVIEW

Drawn By: SWW
 Checked By: JLM

Surveyed By: JSG, DJL
 Designed By: SWW

Project No: 2021-001-108
 Date: 3/28/2022

Interstate Engineering, Inc.
 P.O. Box 648
 2177 Lincoln Ave SE
 Sidney, MT 59270-0640
 Ph: (406) 433-5617
 www.interstateeng.com

