

PARAMOUNT

ENGINEERING, INC.

March 24, 2026
26106.PE

Crystal Danford
ParID: 21300074
PIN: 1087-1950-7554
Deed Book 5165, Page 211
Tract A

Being a tract of land located in Shallotte Township, Brunswick County, State of North Carolina; being Tract A as shown in Deed Book 5165 at Page 211 of the Brunswick County Register of Deeds; said Tract being more particularly described as follows:

Beginning for reference at an iron rod found on the southern right of way line of Copas Road SW (NC 1146, 60-foot public right of way) and at the northeast corner of Bowen Drive SW (60-foot private right of way). Said iron rod having NC State Plane coordinates of N: 70,623.84, E: 2,185,673.57. Said iron rod is the principal place of beginning for this survey.

Thence with the right of way of Copas Road SW, N 63°44'01" E - a distance of 137.63 feet to an iron rod found;

Thence leaving Copas Road SW and with the lines of Tract A the following courses;
S 04°53'16" E - a distance of 241.61 feet to an iron rod found;
S 64°57'21" W - a distance of 82.59 feet to an iron rod found;
N 17°51'08" W - a distance of 225.66 feet to an iron rod found. Said iron rod is the principal place of beginning for this survey.

Having an area of 24,728 square feet or 0.57 acres, more or less.



PARAMOUNT

ENGINEERING, INC.

March 24, 2026
26106.PE

Crystal Danford
ParID: 21300075
PIN: 1087-1960-0780
Deed Book 5165, Page 211
Tract B

Being a tract of land located in Shallotte Township, Brunswick County, State of North Carolina; being Tract B as shown in Deed Book 5165 at Page 211 of the Brunswick County Register of Deeds; said Tract being more particularly described as follows:

Beginning for reference at an iron rod found on the southern right of way line of Copas Road SW (NC 1146, 60-foot public right of way) and at the northeast corner of Tract A as shown in Deed Book 5165 at Page 211. Said iron rod having NC State Plane coordinates of N: 70,684.75, E: 2,185,796.99. Said iron rod is the principal place of beginning for this survey.

Thence with the right of way of Copas Road SW the following courses;
N 63°45'47" E - a distance of 391.12 feet to a point;
N 64°36'16" E - a distance of 99.39 feet to a point;
N 66°06'28" E - a distance of 98.71 feet to a point;
N 68°19'18" E - a distance of 38.34 feet to an iron pipe found;

Thence leaving Copas Road SW and with the western line of Leisure Acres as shown in Map Cabinet P, at Page 163, S 00°30'28" W - a distance of 256.41 feet to an iron pipe found;

Thence leaving Leisure Acres and with the lines of Tract B the following courses;
S 64°57'21" W - a distance of 462.38 feet to an iron rod found;
S 64°57'21" W - a distance of 137.67 feet to an iron rod found;
N 04°53'16" W - a distance of 241.61 feet to an iron rod found. Said iron rod is the principal place of beginning for this survey.

Having an area of 142,364 square feet or 3.27 acres, more or less.

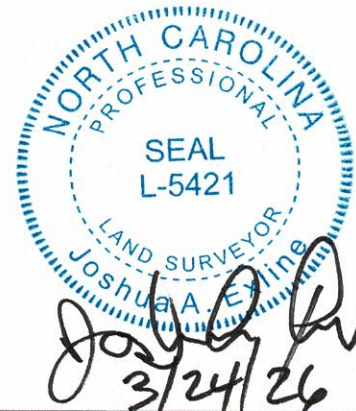

PARAMOUNT

ENGINEERING, INC.

March 24, 2026
26106.PE

Crystal Danford
ParID: 2140005702
PIN: 1087-1960-4374
Deed Book 5165, Page 211
Tract C

Being a tract of land located in Shallotte Township, Brunswick County, State of North Carolina; being Tract C as shown in Deed Book 5165 at Page 211 of the Brunswick County Register of Deeds; said Tract being more particularly described as follows:

Beginning for reference at an iron pipe found on the southwest corner of Leisure Acres as shown in Map Cabinet P, at Page 163. Said iron rod having NC State Plane coordinates of N: 70,698.02, E: 2,186,361.21. Said iron pipe is the principal place of beginning for this survey.

Thence with the southern line of Leisure Acres the following courses;

N 89°32'24" E - a distance of 284.88 feet to an iron pipe found;
N 89°32'24" E - a distance of 74.96 feet to a point;
N 87°56'20" E - a distance of 83.82 feet to an iron pipe found;
N 87°46'10" E - a distance of 32.04 feet to a point;
N 87°35'38" E - a distance of 106.94 feet to a point;
N 88°02'35" E - a distance of 103.55 feet to an iron rod found;

Thence leaving the line of Leisure Acres and with the lines of Tract C the following courses;

S 13°58'37" W - a distance of 966.58 feet to an iron rod found;
S 79°21'54" W - a distance of 404.20 feet to a point;
S 66°50'20" W - a distance of 61.16 feet to a point;
S 61°14'34" W - a distance of 82.12 feet to a point;
S 30°42'44" W - a distance of 50.44 feet to a point;
N 86°18'56" W - a distance of 83.74 feet to a point;
N 88°53'44" W - a distance of 50.05 feet to a point;
S 73°13'06" W - a distance of 19.38 feet to a point;
N 53°02'03" W - a distance of 32.78 feet to a point;
S 61°29'41" W - a distance of 39.22 feet to a point;
S 82°18'37" W - a distance of 103.66 feet to a point;
S 57°45'02" W - a distance of 26.86 feet to an iron rod found;
N 01°06'43" E - a distance of 19.74 feet to an iron rod found;
N 01°06'43" E - a distance of 204.47 feet to an iron rod found;
N 01°06'43" E - a distance of 644.11 feet to an iron rod found;
N 01°05'21" E - a distance of 66.91 feet to an iron rod found;

Thence with the lines of Tract B, N 64°57'21" E - a distance of 462.38 feet to an iron pipe found. Said iron pipe is the principal place of beginning for this survey.

Having an area of 970,699 square feet or 22.28 acres, more or less.



Joshua A. Exline
3/24/26